



New Visitor Services for **MISSION SAN JUAN DEMONSTRATION FARM**



Why Proposed Changes are Needed:

- The San Juan Demonstration Farm will provide visitors an opportunity to experience a simulated Spanish colonial labore (farm field) immediately adjacent to Mission San Juan.
- Changes needed to illustrate Spanish colonial farming technology and practices, with a focus on acequias (irrigation ditches).

Proposed Changes

- Construction of necessary visitor services for the demonstration farm, including a maintenance facility, realignment of roadways and parking, restrooms, offices, and a visitor contact station with exhibit areas.

Environmental Assessment:

- To comply with applicable environmental regulations, the National Park Service (NPS) must analyze effects of these proposed changes on the human and natural environment in an Environmental Assessment (EA).
- The EA requires public input on the proposed changes as well as other alternatives.
- Three alternatives for the changes at the San Juan Demonstration farm are being considered.

For More Information

Susan Snow
Archaeologist
San Antonio Missions
NHP
2202 Roosevelt Ave.
San Antonio, TX 78210
210-534-8875 x243

For further project details and to submit a comment on the project, please visit our website:

http://parkplanning.nps.gov/san_juan_ea



ALTERNATIVE 1

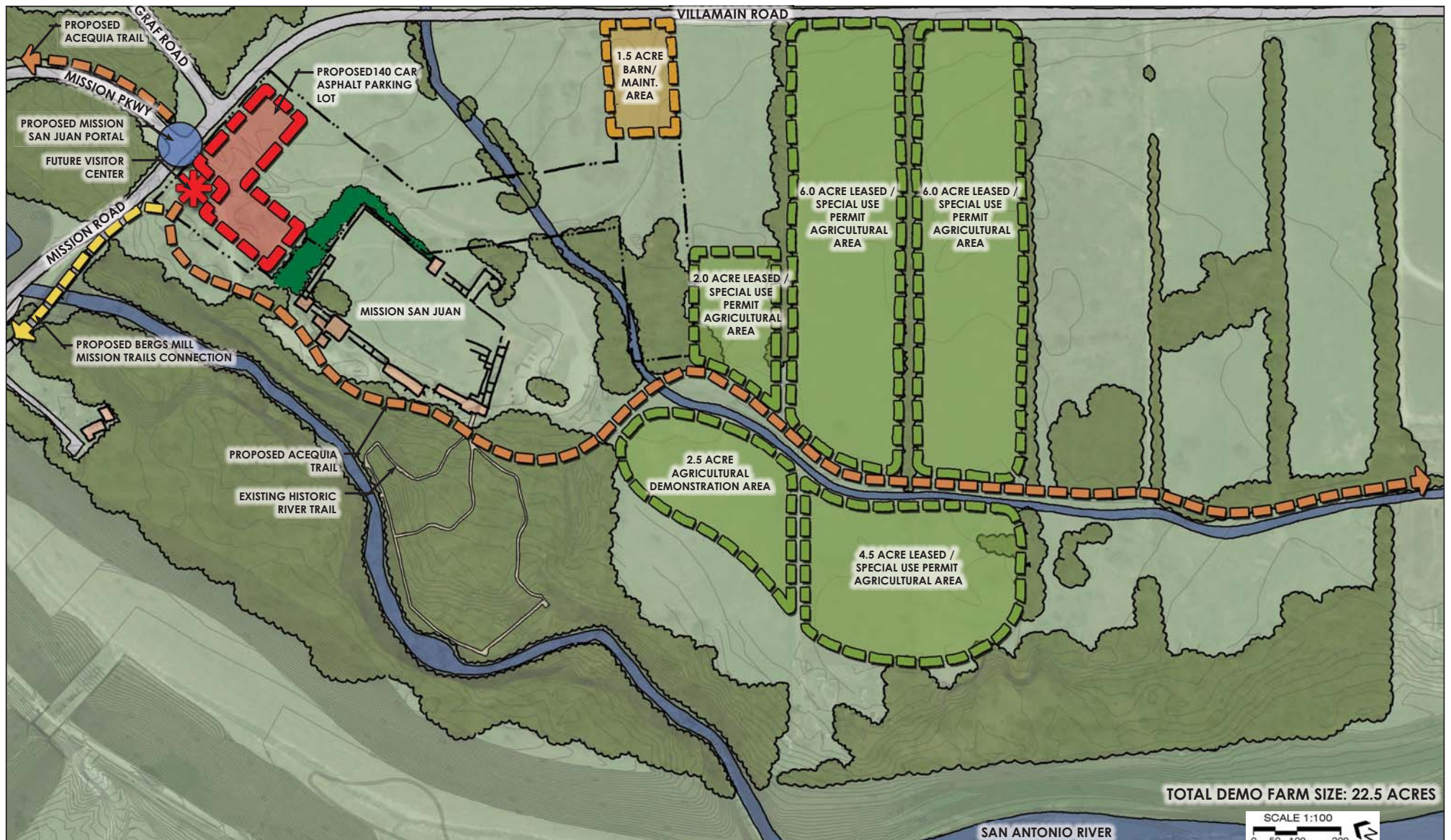

ALTERNATIVE 2



OCTOBER 14, 2010



SAN ANTONIO MISSIONS NATIONAL HISTORICAL PARK
MISSION SAN JUAN de CAPISTRANO DEMONSTRATION FARM



SCHEMATIC LAYOUT DIAGRAMS
PHASE II PLAN

ALTERNATIVE 3

