



IN REPLY REFER TO:
L7615(YOSE-PM)

United States Department of the Interior

NATIONAL PARK SERVICE

Yosemite National Park
P. O. Box 577
Yosemite, California 95389

Memorandum

To: Nancy Pimentel, Project Manager

From: Acting Superintendent, Yosemite National Park

Subject: NEPA and NHPA Clearance: 2009-064 South Entrance Office Reroute Telephone Line (23496)

The Management Team has reviewed the proposed project/action and completed its environmental assessment documentation, and we have determined that there:

- Will not be any effect on threatened, endangered, or rare species and/or their critical habitat.
- Will not be any effect on historical, cultural, or archeological resources.
- Will not be serious or long-term undesirable environmental or visual effects.

The subject proposed project, therefore, is now cleared for all NEPA and NHPA compliance requirements as presented above. Project plans and specifications are approved and construction and/or project implementation can commence.

For the proposed project actions to be within compliance requirements during construction and/or project implementation, the following mitigations must be adhered to:

- No mitigations identified.

//Charles Cuvelier// (acting)
David V. Ueberuaga

Enclosure (with attachments)

cc: Statutory Compliance File

*The signed original of this document is on file at the
Environmental Planning and Compliance Office in
Yosemite National Park.*



National Park Service
U.S. Department of the Interior

Yosemite NP
Date: 07/16/2009

Categorical Exclusion Form

Project: **2009-064 South Entrance Office Reroute Telephone Line**

PEPC ID: **23496**

Project Description: This project involves a reroute of the telephone lines to the South Entrance office/residence (duplex). The removal of an existing overhead line that is unsightly and difficult to maintain. The existing telephone line runs approximately 300' through the trees from the Big Trees parking lot to the duplex. This project would include rerouting the telephone line to the office/ residence by trenching and burying lines underground from outside the office to an access point. The access point would be for AT&T and would be located at the bottom of the intersection of the office/residence driveway and the Wawona Road. This involves excavating a trench 24" deep x 12" wide x 200' long, and 15' across the end of the driveway. The project will include protection of the access point from snow plow damage with a standard green telephone access pedestal (the access point is currently protected by piles of rocks). National Park Service staff and equipment will be used for all trenching activities. The park Archeologist has stated that there are no known archeological resources in the area surrounding the parking lot, roadway, driveway and duplex. It is possible there are buried resources in the area, so the trenching might need to be spot checked by park archeology staff. The Yosemite Telecom shop will remove the telephone lines.

Project Locations:

Mariposa County, CA

Mitigations:

- **No mitigations identified.**

Describe the category used to exclude action from further NEPA analysis and indicate the number of the category (see Section 3-4 of DO-12):

C.15 Installation of underground utilities in previously disturbed areas having stable soils, or in an existing utility right-of-way.

On the basis of the environmental impact information in the statutory compliance file, with which I am familiar, I am categorically excluding the described project from further NEPA analysis. No exceptional circumstances (e.g. all boxes in the ESF are marked "no") or conditions in Section 3-6 apply, and the action is fully described in Section 3-4 of DO-12.

Acting Park Superintendent //Charels Cuvelier// (acting)

Date 11/25/09

*The signed original of this document is on file at
the Environmental Planning and Compliance
Office in Yosemite National Park.*



National Park Service
U.S. Department of the Interior

Yosemite NP
Date: 07/16/2009

ENVIRONMENTAL SCREENING FORM (ESF)
DO-12 APPENDIX 1

Updated May 2007 - per 2004 DM revisions and proposed DO-12 changes

Today's Date: July 16, 2009

Date Form Initiated: 07/16/2009

A. PROJECT INFORMATION

Park Name: Yosemite

Project Title: 2009-064 South Entrance Office Reroute Telephone Line

PEPC Project Number: 23496

Project Type: Install telephone line (OTHER)

Project Location: County, State: Mariposa, California Other: South Entrance Station Office

Project Manager: Nancy Pimentel

B. RESOURCE EFFECTS TO CONSIDER:

Identify potential effects to the following physical, natural, or cultural resources	No Effect	Negligible Effects	Minor Effects	Exceeds Minor Effects	Data Needed to Determine/Notes
1. Geologic resources – soils, bedrock, streambeds, etc.		X			Trenching includes 200 linear feet x 2' deep x 1' wide.
2. From geohazards	X				
3. Air quality	X				
4. Soundscapes		X			Trenching will produce temporary equipment noises.
5. Water quality or quantity	X				
6. Streamflow characteristics	X				
7. Marine or estuarine resources	X				
8. Floodplains or wetlands	X				
9. Land use, including occupancy, income, values, ownership, type of use	X				
10. Rare or unusual vegetation – old growth timber, riparian, alpine	X				

11. Species of special concern (plant or animal; state or federal listed or proposed for listing) or their habitat	X				
12. Unique ecosystems, biosphere reserves, World Heritage Sites		X			Yosemite National Park is a World Heritage site; no historic properties would be adversely affected by implementing this project.
13. Unique or important wildlife or wildlife habitat	X				
14. Unique or important fish or fish habitat	X				
15. Introduce or promote non-native species (plant or animal)	X				
16. Recreation resources, including supply, demand, visitation, activities, etc.	X				
17. Visitor experience, aesthetic resources	X				Aesthetically, underground lines will be more desirable.
18. Archeological resources		X			
19. Prehistoric/historic structure	X				
20. Cultural landscapes	X				South Entrance Historic District.
21. Ethnographic resources	X				
22. Museum collections (objects, specimens, and archival and manuscript collections)	X				
23. Socioeconomics, including employment, occupation, income changes, tax base, infrastructure	X				
24. Minority and low income populations, ethnography, size, migration patterns, etc.	X				
25. Energy resources	X				
26. Other agency or tribal land use plans or policies	X				
27. Resource, including energy, conservation potential, sustainability	X				

28. Urban quality, gateway communities, etc.	X				
29. Long-term management of resources or land/resource productivity	X				
30. Other important environment resources (e.g. geothermal, paleontological resources)?	X				

Comments:

C. MANDATORY CRITERIA

Mandatory Criteria: If implemented, would the proposal:	Yes	No	N/A	Comment or Data Needed to Determine
A. Have significant impacts on public health or safety?		X		
B. Have significant impacts on such natural resources and unique geographic characteristics as historic or cultural resources; park, recreation, or refuge lands; wilderness areas; wild or scenic rivers; national natural landmarks; sole or principal drinking water aquifers; prime farmlands; wetlands (Executive Order 11990); floodplains (Executive Order 11988); national monuments; migratory birds; and other ecologically significant or critical areas?		X		
C. Have highly controversial environmental effects or involve unresolved conflicts concerning alternative uses of available resources (NEPA section 102(2)(E))?		X		
D. Have highly uncertain and potentially significant environmental effects or involve unique or unknown environmental risks?		X		
E. Establish a precedent for future action or represent a decision in principle about future actions with potentially significant environmental effects?		X		
F. Have a direct relationship to other actions with individually insignificant, but cumulatively significant, environmental effects?		X		
G. Have significant impacts on properties listed or eligible for listing on the National Register of Historic Places, as determined by either the bureau or office?		X		

H. Have significant impacts on species listed or proposed to be listed on the List of Endangered or Threatened Species, or have significant impacts on designated Critical Habitat for these species?		X		
I. Violate a federal law, or a state, local, or tribal law or requirement imposed for the protection of the environment?		X		
J. Have a disproportionately high and adverse effect on low income or minority populations (Executive Order 12898)?		X		
K. Limit access to and ceremonial use of Indian sacred sites on federal lands by Indian religious practitioners or significantly adversely affect the physical integrity of such sacred sites (Executive Order 13007)?		X		
L. Contribute to the introduction, continued existence, or spread of noxious weeds or non-native invasive species known to occur in the area or actions that may promote the introduction, growth, or expansion of the range of such species (Federal Noxious Weed Control Act and Executive Order 13112)?		X		

For the purpose of interpreting these procedures within the NPS, any action that has the potential to violate the NPS Organic Act by impairing park resources or values would constitute an action that triggers the DOI exception for actions that threaten to violate a federal law for protection of the environment.

D. OTHER INFORMATION

Are personnel preparing this form familiar with the site? **Yes**

Did personnel conduct a site visit? **No**

Is the project in an approved plan such as a General Management Plan or an Implementation Plan with an accompanying NEPA document? **No**

Are there any interested or affected agencies or parties? **No**

Has consultation with all affected agencies or tribes been completed? **No**

Are there any connected, cumulative, or similar actions as part of the proposed action? (e.g., other development projects in area or identified in GMP, adequate/available utilities to accomplish project)? **No**

E. INTERDISCIPLINARY TEAM SIGNATORIES

<u>Interdisciplinary Team</u>	<u>Field of Expertise</u>
David V. Ueberuaga	Acting Superintendent
Jim Hammett	Acting Deputy Superintendent
Kristina Rylands	Acting Chief of Planning
Mark Butler	Chief of Project Management
Katariina Tuovinen	Chief of Administration Management
Dennis Mattiuzzi	Chief of Facilities Management
Niki Nicholas	Chief of Resources Management & Science
Marty Nielson	Chief of Business and Revenue Management
Tom Medema	Acting Chief of Interpretation and Education

Steve Shackelton Bill Rust Elexis Mayer Jeannette Simons Renea Kennec	Chief Ranger Project Leader Environmental Planning and Compliance Program Manager NHPA Specialist NEPA Specialist
---	---

F. SUPERVISORY SIGNATORY

Based on the environmental impact information contained in the statutory compliance file and in this environmental screening form, environmental documentation for this stage of the subject project is complete.

Recommended:

Compliance Specialist	Date
<u>//Renea Kennec//</u> Compliance Specialist – Renea Kennec	<u>10/21/09</u>
<u>//Elexis Mayer//</u> Compliance Program Manager – Elexis Mayer	<u>11/17/09</u>
<u>//Mark A. Butler//</u> Chief, Project Management – Mark Butler	<u>11/19/09</u>

Approved:

Acting Superintendent	Date
<u>//Charles Cuvelier// (acting)</u> David V. Uberuaga	<u>11/25/09</u>

*The signed original of this document is on file at
the Environmental Planning and Compliance
Office in Yosemite National Park.*

PARK ESF ADDENDUM

Today's Date: July 16, 2009

PROJECT INFORMATION

Park Name: Yosemite NP

Project Number: 23496

Project Type: Install telephone line (OTHER)

Project Location: County, State: Mariposa, California Other: South Entrance Station Office

Project Manager: Nancy Pimentel

Project Title: 2009-064 South Entrance Office Reroute Telephone Line

PARK ESF ADDENDUM QUESTIONS & ANSWERS

ESF Addendum Questions	Yes	No	N/A	Data Needed to Determine/Notes
SPECIAL STATUS SPECIES CHECKLIST				
1. Listed or proposed threatened or endangered species (Federal or State)?		X		
2. Species of special concern (Federal or State)?		X		
3. Park rare plants or vegetation?		X		
4. Potential habitat for any special-status species listed above?		X		
NATIONAL HISTORIC PRESERVATION ACT CHECKLIST				
5. Entail ground disturbance?	X			Trenching includes 200 linear feet x 2' deep x 1' wide.
6. Are any archeological or ethnographic sites located within the area of potential effect?		X		
7. Entail alteration of a historic structure or cultural landscape?		X		
8. Has a National Register form been completed?		X		
9. Are there any structures on the park's List of Classified Structures in the area of potential effect?		X		
WILD AND SCENIC RIVERS ACT CHECKLIST				
10. Fall within a wild and scenic river corridor?		X		
11. Fall within the bed and banks AND will affect the free-flow of the river?		X		
12. Have the possibility of affecting water quality of the area?		X		
13. Remain consistent with its river segment classification?			X	
14. Protect and enhance river ORVs?			X	

15. Fall within the River Protection Overlay?		X		
16. If Yes, remain consistent with conditions of the River Protection Overlay?		X		
17. Remain consistent with the areas Management Zoning?			X	
18. Fall on a tributary of a Wild and Scenic River?		X		
19. Will the project encroach or intrude upon the Wild and Scenic River corridor?		X		
20. Will the project unreasonably diminish scenic, recreational, or fish and wildlife values?		X		
WILDERNESS ACT CHECKLIST				
21. Within designated Wilderness?		X		
22. Within a Potential Wilderness Addition?		X		

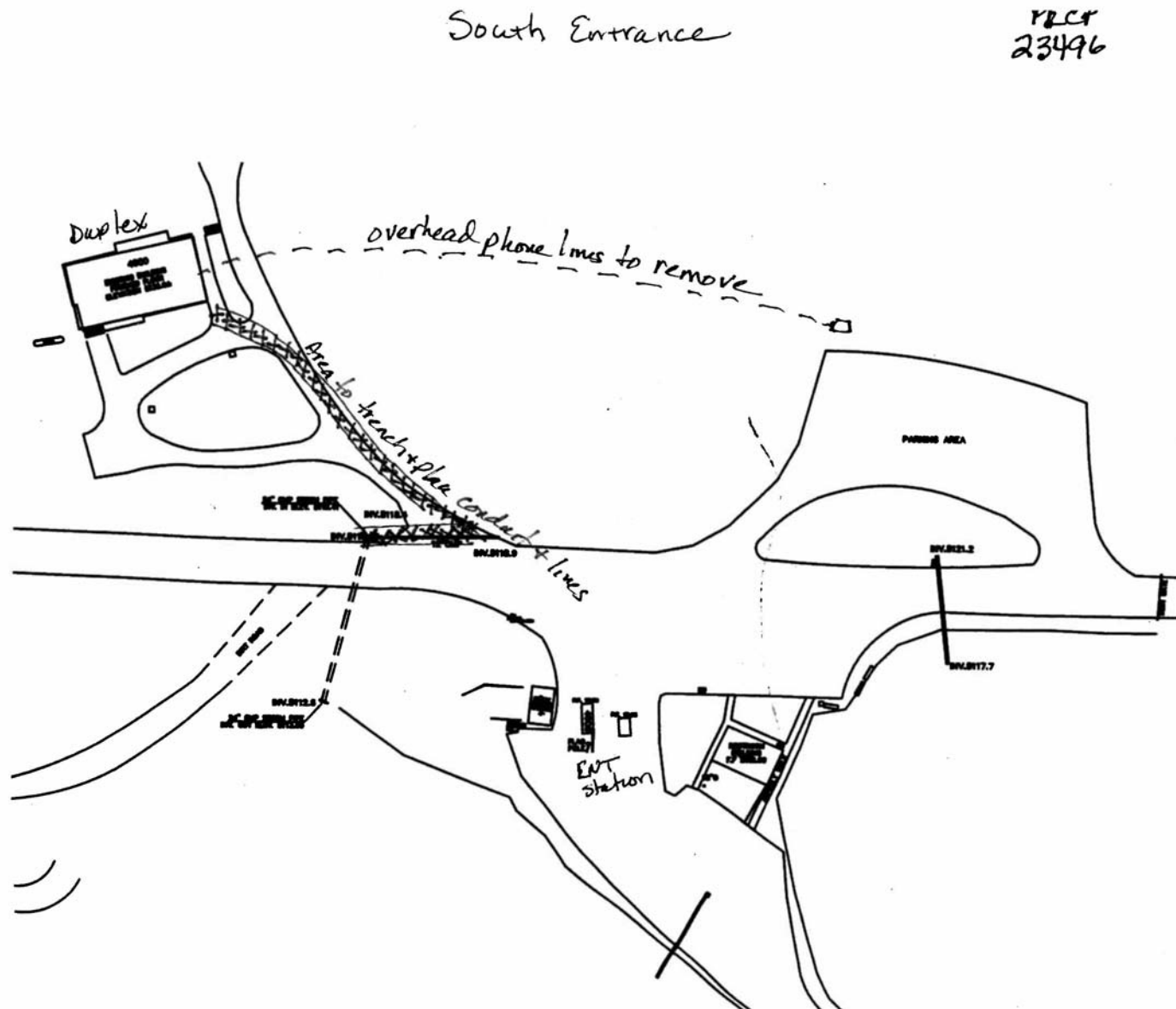









ASSESSMENT OF ACTIONS HAVING AN EFFECT ON CULTURAL RESOURCES

A. DESCRIPTION OF UNDERTAKING

1. Park: **Yosemite NP** Park District: **Wawona**

2. Project Description:

a. Project Name: **2009-064 South Entrance Office Reroute Telephone Line** Date: **July 16, 2009**

PEPC Project ID Number: **23496**

b. Describe project and area of potential effects (as defined in 36 CFR 800.2[c])

This project involves a reroute of the telephone lines to the South Entrance office/residence (duplex). The removal of an existing overhead line that is unsightly and difficult to maintain. The existing telephone line runs approximately 300' through the trees from the Big Trees parking lot to the duplex. This project would include rerouting the telephone line to the office/residence by trenching and burying lines underground from outside the office to an access point. The access point would be for AT&T and would be located at the bottom of the intersection of the office/residence driveway and the Wawona Road. This involves excavating a trench 24" deep x 12" wide x 200' long, and 15' across the end of the driveway. The project will include protection of the access point from snow plow damage with a standard green telephone access pedestal (the access point is currently protected by piles of rocks). National Park Service staff and equipment will be used for all trenching activities. The park Archeologist has stated that there are no known archeological resources in the area surrounding the parking lot, roadway, driveway and duplex. It is possible there are buried resources in the area, so the trenching might need to be spot checked by park archeology staff. The Yosemite Telecom shop will remove the telephone lines.

3. Has the area of potential effects been surveyed to identify cultural resources?

 No

X Yes, Source or reference: **South Entrance Historic District.**

X Check here if no known cultural resources will be affected. (If this is because area has been disturbed, please explain or attach additional information to show the disturbance was so extensive as to preclude intact cultural deposits.)

4. Potentially Affected Resources:

Historical structures/resources affected?

Name and number(s): **South Entrance Historic District**

NR status: **8 - Within a Register-eligible district**

5. The proposed action will: (check as many as apply)

No Destroy, remove, or alter features/elements from a historic structure

- No Replace historic features/elements in kind
No Add non-historic features/elements to a historic structure
No Alter or remove features/elements of a historic setting or environment (inc. terrain)
No Add non-historic features/elements (inc. visual, audible, or atmospheric) to a historic setting or cultural landscape
No Disturb, destroy, or make archeological resources inaccessible
No Disturb, destroy, or make ethnographic resources inaccessible
No Potentially affect presently unidentified cultural resources
No Begin or contribute to deterioration of historic features, terrain, setting, landscape elements, or archeological or ethnographic resources
No Involve a real property transaction (exchange, sale, or lease of land or structures)
_____ Other (please specify)

6. Measures to prevent or minimize loss or impairment of historic/prehistoric properties:
(Remember that setting, location, and use may be relevant.)

No Assessment of Effect mitigations identified.

7. Supporting Study Data:

(Attach if feasible; if action is in a plan, EA or EIS, give name and project or page number.)

8. Attachments:

☐ Maps ☐ Archeological survey, if applicable ☐ Drawings ☐ Specifications ☐ Photographs
☐ Scope of Work ☐ Site plan ☐ List of Materials ☐ Samples ☐ Other:

Prepared by: **Renea Kennec** Date: **July 16, 2009** Title: **Environmental Protection Assistant** Telephone: **209-379-1038**

B. REVIEWS BY CULTURAL RESOURCE SPECIALISTS

The park 106 coordinator requested review by the park's cultural resource specialist/advisors as indicated by check-off boxes or as follows:

☒ Archeologist

Name: **Laura Kirn**

Date: **06/24/2009**

Comments: **YOSE 1999 PA, Stipulation VII.C.2.; a, b, g.**

Check if project does not involve ground disturbance ☐

Assessment of Effect: ☐ No Historic Properties Affected ☒ No Adverse Effect ☐ Adverse Effect ☐ Streamlined Review

Recommendations for conditions or stipulations:

Doc Method: **Park Specific Programmatic Agreement**

☒ Historical Architect

Name: **Sueann Brown**

Date: **06/26/2009**

Comments:

Check if project does not involve ground disturbance ☐

Assessment of Effect: ☐ No Historic Properties Affected ☒ No Adverse Effect ☐ Adverse Effect ☐ Streamlined Review

Recommendations for conditions or stipulations:

Doc Method: **Park Specific Programmatic Agreement**

☒ Historical Landscape Architect

Name: **David Humphrey**

Date: **06/24/2009**

Comments: **YOSE 1999 PA, Stipulation VII.C.2.**

Check if project does not involve ground disturbance ☐

Assessment of Effect: ☐ No Historic Properties Affected ☒ No Adverse Effect ☐ Adverse Effect ☐ Streamlined Review

Recommendations for conditions or stipulations:

Doc Method: **Park Specific Programmatic Agreement**

No Reviews From: **Curator, Historian, 106 Advisor, Other Advisor, Anthropologist**

C. PARK SECTION 106 COORDINATOR'S REVIEW AND RECOMMENDATIONS

1. Assessment of Effect:

☐ No Historic Properties Affected ☒ No Adverse Effect ☐ Adverse Effect

2. Compliance requirements:

☐ A. STANDARD 36 CFR PART 800 CONSULTATION

Further consultation under 36 CFR Part 800 is needed.

☐ B. STREAMLINED REVIEW UNDER THE 2008 SERVICEWIDE PROGRAMMATIC AGREEMENT (PA)

The above action meets all conditions for a streamlined review under section III of the 2008 Servicewide PA for Section 106 compliance.

APPLICABLE STREAMLINED REVIEW Criteria
(Specify 1-16 of the list of streamlined review criteria.)

☐ C. PLAN-RELATED UNDERTAKING

Consultation and review of the proposed undertaking were completed in the context of a plan review process, in accordance with the 2008 Servicewide PA and 36 CFR Part 800.

Specify plan/EA/EIS: _____

☒ D. UNDERTAKING RELATED TO ANOTHER AGREEMENT

The proposed undertaking is covered for Section 106 purposes under another document such as a statewide agreement established in accord with 36 CFR 800.7 or counterpart regulations.

Specify: _____

☐ E. COMPLIANCE REQUIREMENTS SATISFIED BY USE OF NEPA

Documentation is required for the preparation of an EA/FONSI or an EIS/ROD has been developed and used so as also to meet the requirements of 36 CFR 800.3 through 800.6

☐ F. No Potential to Cause Effects [800.3(a)(1)]

☐ G. STIPULATIONS/CONDITIONS

Following are listed any stipulations or conditions necessary to ensure that the assessment of effect above is consistent with 36 CFR Part 800 criteria of effect or to avoid or reduce potential adverse effects.

Recommended by Park Section 106 coordinator:

Signature of Historic Preservation Officer //Jeannette Simons//

Date: 10/5/09

D. SUPERINTENDENT'S APPROVAL

The proposed work conforms to the NPS *Management Policies* and *Cultural Resource Management Guideline*, and I have reviewed and approve the recommendations, stipulations, or conditions noted in Section C of this form.

Signature of Acting Superintendent //Charles Cuvelier// (acting)

Date: 11/25/09

*The signed original of this document is on file at
the Environmental Planning and Compliance
Office in Yosemite National Park.*