



IN REPLY REFER TO:
L7615(YOSE-PM)

United States Department of the Interior NATIONAL PARK SERVICE

Yosemite National Park
P. O. Box 577
Yosemite, California 95389

Memorandum

To: John Chisum, Project Manager, Yosemite National Park

From: Acting Superintendent, Yosemite National Park

Subject: NEPA and NHPA Clearance: 2009-091 Wawona Obsolete Structure Demolition (26894)

The Management Team has reviewed the proposed project/action and completed its environmental assessment documentation, and we have determined that there:

- Will not be any effect on threatened, endangered, or rare species and/or their critical habitat.
- Will not be any effect on historical, cultural, or archeological resources.
- Will not be serious or long-term undesirable environmental or visual effects.

The subject proposed project, therefore, is now cleared for all NEPA and NHPA compliance requirements as presented above. Project plans and specifications are approved and construction and/or project implementation can commence.

For the proposed project actions to be within compliance requirements during construction and/or project implementation, the following mitigations must be adhered to:

- Submit an Accident Prevention Plan to the Safety Office, Roger Farmer, 379-1079 prior to beginning work.
- Ensure that archeological monitoring will occur with the removal of building #4048. Contact park Archeologist, Laura Kirn, 379-1314.

//David V. Uberuaga//
David V. Uberuaga

Enclosure (with attachments)

cc: Statutory Compliance
File

*The signed original of this document is on file at
the Environmental Planning and Compliance
Office in Yosemite National Park.*



Categorical Exclusion Form

Project: 2009-091 Wawona Obsolete Structure Demolition

PEPC Project Number: 26894

Project Description: This project will remove several abandoned structures and other building features from the Wawona housing area in Yosemite National Park. The structures are in extreme disrepair, unusable, and rehabilitation is not economically reasonable.

The structures to be removed include:

- 1) A pump house, building #4161, located at 2591 Van Campen Way (Tract YOSE 012-135).
- 2) A former residence, building #4048, located at 2652 Spelt Road.
- 3) A former residence (Redwoods house) located at 2571 River View Road (Tract YOSE 007-136).
- 4) A foundation from a former residence (Crews house) located at 7975 Forest Drive (Tract YOSE 007-139).
- 5) A chimney located south of the Crews house foundation (Tract YOSE 007-120).

All structures will be thoroughly inspected for bat inhabitation prior to removal. If found, bats would be removed in consultation with the park Wildlife Biologist prior to demolition. The park Archeologist would be offered the opportunity to investigate and monitor the site for soil disturbance. All existing utilities would be removed to at least 18" below grade. Utilities located deeper than 18" would be abandoned in place. All demolition work would be performed by a contractor managed by the National Park Service (NPS). Following demolition, the site would be restored to preconstruction conditions with consultation from park Vegetation and Ecological Restoration staff. Erosion control measures would follow recommendations by the NPS Division I specifications.

History, Architecture, and Landscapes staff have reviewed the above proposed project list and determined that the buildings proposed for demolition have not been identified as historic resources in previous park studies; the buildings appear to lack the historic significance or architectural distinction required for listing on the National Register of Historic Places. The above action ensures consideration and review of the buildings as possible historic resources.

Other structures (listed below) that would be removed with this project are covered under a separate compliance document (tracking #2004-068). However, there is one complex of structures that was approved for removal in 2004 that is excluded from this project - it is the "Vagim House, Garage & Laundry". Any future action regarding this complex of buildings will necessitate additional research to evaluate its historic significance.

- 1) Madden House & Garage
- 2) Putnam House

- 3) Unit 4176
- 4) Unit 4183
- 5) Unit 4156
- 6) Unit 4166
- 7) Unit 4015 (Moon House)
- 8) Unit 4091 (Mark House)
- 9) Unit 4151
- 10) Unit 4205 (Saunders House)
- 11) Unit 4730 (Small slab at Wawona Point)

Project Location:

Mariposa County, CA

Mitigations:

- Prior to beginning work, submit an Accident Prevention Plan to the Safety Office, Roger Farmer, 379-1079.
- Ensure that archeological monitoring will occur with the removal of building #4048. Contact park Archeologist, Laura Kirn, 379-1314.

Describe the category used to exclude action from further NEPA analysis and indicate the number of the category (see Section 3-4 of DO-12):

E.4 - Removal of non-historic materials and structures in order to restore natural conditions.

On the basis of the environmental impact information in the statutory compliance file, with which I am familiar, I am categorically excluding the described project from further NEPA analysis. No exceptional circumstances or conditions in Section 3-6 apply, and the action is fully described in Section 3-4 of DO-12.

Park Acting Superintendent //David V. Uberuaga//

Date 1/12/10

*The signed original of this document is on file at
the Environmental Planning and Compliance
Office in Yosemite National Park.*



National Park Service
U.S. Department of the Interior

Yosemite National Park
Date: 01/08/2010

ENVIRONMENTAL SCREENING FORM (ESF)

DO-12 APPENDIX 1

Date Form Initiated: 01/07/2010

Updated May 2007 - per 2004 Departmental Manual revisions and proposed Director's Order 12 changes

A. PROJECT INFORMATION

Park Name: Yosemite National Park
Project Title: 2009-091 Wawona Obsolete Structure Demolition
PEPC Project Number: 26894
PMIS Number: 109576A
Project Type: Facility Maintenance (FM)
Project Location: **County, State:** Mariposa, California **District:** CA19
Project Leader: John Chisum

Preliminary drawings attached? **Yes**

Is project a hot topic (controversial or sensitive issues that should be brought to attention of Regional Director)? **No**

B. RESOURCE EFFECTS TO CONSIDER:

Identify potential effects to the following physical or natural resources	No Effect	Negligible Effects	Minor Effects	Exceeds Minor Effects	Data Needed to Determine/Notes
1. Geologic resources – soils, bedrock, streambeds, etc.		Negligible			Structure removal will include some soil disturbance, no more than 2 feet.
2. From geohazards	No				
3. Air quality		Negligible			The demolition will include temporary air emissions.
4. Soundscapes		Negligible			Temporary equipment noises are associated with the structure demolition.
5. Water quality or quantity	No				
6. Streamflow characteristics	No				
7. Marine or estuarine resources	No				
8. Floodplains or wetlands	No				

Identify potential effects to the following physical or natural resources	No Effect	Negligible Effects	Minor Effects	Exceeds Minor Effects	Data Needed to Determine/Notes
9. Land use, including occupancy, income, values, ownership, type of use	No				
10. Rare or unusual vegetation – old growth timber, riparian, alpine	No				
11. Species of special concern (plant or animal; state or federal listed or proposed for listing) or their habitat	No				
12. Unique ecosystems, biosphere reserves, World Heritage Sites	No				Yosemite National Park is a World Heritage site;
13. Unique or important wildlife or wildlife habitat		Negligible			Each structure will be inspected for bat habitat by the park Wildlife Biologist prior to removal.
14. Unique or important fish or fish habitat	No				
15. Introduce or promote non-native species (plant or animal)	No				This project is contingent upon ensuring that all equipment and materials brought into the park are free of non-native, invasive plants and animals.
16. Recreation resources, including supply, demand, visitation, activities, etc.	No				
17. Visitor experience, aesthetic resources	No				
18. Museum collections (objects, specimens, and archival and manuscript collections)	No				
19. Socioeconomics, including employment, occupation, income changes, tax base, infrastructure	No				
20. Minority and low income populations, ethnography, size, migration patterns, etc.	No				
21. Energy resources	No				
22. Other agency or tribal land use plans or policies	No				

Identify potential effects to the following physical or natural resources	No Effect	Negligible Effects	Minor Effects	Exceeds Minor Effects	Data Needed to Determine/Notes
23. Resource, including energy, conservation potential, sustainability	No				
24. Urban quality, gateway communities, etc.	No				
25. Long-term management of resources or land/resource productivity	No				
26. Other important environment resources (e.g. geothermal, paleontological resources)?	No				
Identify potential effects to the following cultural resources	No Historic Properties Affected	No Adverse Effect	Adverse Effect		Data Needed to Determine/Notes
1. Archeological resources		X			Wawona Archeological District; the assessment of effect is "No Adverse Effect."
2. Prehistoric/historic structure	X				No Historic Properties affected.
3. Cultural landscapes	X				
4. Ethnographic resources	X				

C. MANDATORY CRITERIA

Mandatory Criteria: If implemented, would the proposal:	Yes	No	N/A	Comment or Data Needed to Determine
A. Have significant impacts on public health or safety?		No		
B. Have significant impacts on such natural resources and unique geographic characteristics as historic or cultural resources; park, recreation, or refuge lands; wilderness areas; wild or scenic rivers; national natural landmarks; sole or principal drinking water aquifers; prime farmlands; wetlands (Executive Order 11990); floodplains (Executive Order 11988); national monuments; migratory birds; and other ecologically significant or critical areas?		No		

Mandatory Criteria: If implemented, would the proposal:	Yes	No	N/A	Comment or Data Needed to Determine
C. Have highly controversial environmental effects or involve unresolved conflicts concerning alternative uses of available resources (NEPA section 102(2)(E))?		No		
D. Have highly uncertain and potentially significant environmental effects or involve unique or unknown environmental risks?		No		
E. Establish a precedent for future action or represent a decision in principle about future actions with potentially significant environmental effects?		No		
F. Have a direct relationship to other actions with individually insignificant, but cumulatively significant, environmental effects?		No		
G. Have significant impacts on properties listed or eligible for listing on the National Register of Historic Places, as determined by either the bureau or office?		No		
H. Have significant impacts on species listed or proposed to be listed on the List of Endangered or Threatened Species, or have significant impacts on designated Critical Habitat for these species?		No		
I. Violate a federal law, or a state, local, or tribal law or requirement imposed for the protection of the environment?		No		
J. Have a disproportionately high and adverse effect on low income or minority populations (Executive Order 12898)?		No		
K. Limit access to and ceremonial use of Indian sacred sites on federal lands by Indian religious practitioners or significantly adversely affect the physical integrity of such sacred sites (Executive Order 13007)?		No		
L. Contribute to the introduction, continued existence, or spread of noxious weeds or non-native invasive species known to occur in the area or actions that may promote the introduction, growth, or expansion of the range of such species (Federal Noxious Weed Control Act and Executive Order 13112)?		No		

For the purpose of interpreting these procedures within the NPS, any action that has the potential to violate the NPS Organic Act by impairing park resources or values would constitute an action that triggers the DOI exception for actions that threaten to violate a federal law for protection of the environment.

D. OTHER INFORMATION

Are personnel preparing this form familiar with the site? Yes

Did personnel conduct a site visit? Yes, Facilities Management and Resources Management and Sciences staff.

Is the project in an approved plan such as a General Management Plan or an Implementation Plan with an accompanying NEPA document? No

Are there any interested or affected agencies or parties? No

Has consultation with all affected agencies or tribes been completed? No

Are there any connected, cumulative, or similar actions as part of the proposed action? (e.g., other development projects in area or identified in GMP, adequate/available utilities to accomplish project)? No

E. INTERDISCIPLINARY TEAM SIGNATORIES

<u>Interdisciplinary Team</u>	<u>Field of Expertise</u>
David V. Uberuaga	Acting Superintendent
Dennis Schramm	Acting Deputy Superintendent
Kristina Rylands	Acting Chief of Planning
Mark Butler	Chief of Project Management
Katariina Tuovinen	Chief of Administration Management
Dennis Mattiuzzi	Chief of Facilities Management
Niki Nicholas	Chief of Resources Management & Science
Marty Nielson	Chief of Business and Revenue Management
Tom Medema	Chief of Interpretation and Education
Steve Shackelton	Chief of Visitor and Resource Protection
John Chisum	Project Leader
Elexis Mayer	Environmental Planning and Compliance Program Manager
Jeannette Simons	NHPA Specialist
Renea Kennec	NEPA Specialist

F. SUPERVISORY SIGNATORY

Based on the environmental impact information contained in the statutory compliance file and in this environmental screening form, environmental documentation for this stage of the subject project is complete.

Recommended:

Compliance Specialists	Date
<u>//Renea Kennec//</u> Compliance Specialist – Renea Kennec	<u>1/12/10</u>
<u>//Elexis Mayer//</u> Compliance Program Manager – Elexis Mayer	<u>1/12/10</u>
<u>//Mark A. Butler//</u> Chief, Project Management – Mark Butler	<u>1/12/10</u>

Approved:

Acting Superintendent	Date
<u>//David V. Uberuaga//</u> David V. Uberuaga	<u>1/12/10</u>

*The signed original of this document is on file at
the Environmental Planning and Compliance
Office in Yosemite National Park.*



National Park Service
U.S. Department of the Interior

Yosemite National Park
Date: 01/07/2010

PARK ESF ADDENDUM

Today's Date: **January 7, 2010**

PROJECT INFORMATION

Park Name: Yosemite National Park
Project Title: 2009-091 Wawona Obsolete Structure Demolition
PEPC Project Number: 26894
Project Type: Facility Maintenance (FM)
Project Location: **County, State:** Mariposa, California **District:** CA19
Project Leader: John Chisum

PARK ESF ADDENDUM QUESTIONS & ANSWERS

ESF Addendum Questions	Yes	No	N/A	Data Needed to Determine/Notes
SPECIAL STATUS SPECIES CHECKLIST				
1. Listed or proposed threatened or endangered species (Federal or State)?		No		
2. Species of special concern (Federal or State)?	Yes			There are potentially bat populations in the proposed structures to be demolished. Structures will be inspected prior to any demolition work.
3. Park rare plants or vegetation?		No		
4. Potential habitat for any special-status species listed above?		No		
NATIONAL HISTORIC PRESERVATION ACT CHECKLIST				
5. Entail ground disturbance?	Yes			Structure removal will include some soil disturbance, approximately 2 feet.
6. Are any archeological or ethnographic sites located within the area of potential effect?		No		
7. Entail alteration of a historic structure or cultural landscape?	Yes			
8. Has a National Register form been completed?		No		

ESF Addendum Questions	Yes	No	N/A	Data Needed to Determine/Notes
9. Are there any structures on the park's List of Classified Structures in the area of potential effect?		No		
WILD AND SCENIC RIVERS ACT CHECKLIST				
10. Fall within a wild and scenic river corridor? (Name the river corridor)	Yes			South Fork of the Merced River.
11. Fall within the bed and banks AND will affect the free-flow of the river?		No		
12. Have the possibility of affecting water quality of the area?		No		
13. Remain consistent with its river segment classification?	Yes			The Wawona segment is classified as "Recreational."
14. Protect and enhance river ORVs?			N/A	
15. Fall on a tributary of a Wild and Scenic River?		No		
16. Will the project encroach or intrude upon the Wild and Scenic River corridor?		No		
17. Will the project unreasonably diminish scenic, recreational, or fish and wildlife values?		No		
18. Consistent with the provisions in the Merced River Plan Settlement Agreement?	Yes			
WILDERNESS ACT CHECKLIST				
19. Within designated Wilderness?		No		
20. Within a Potential Wilderness Addition?		No		

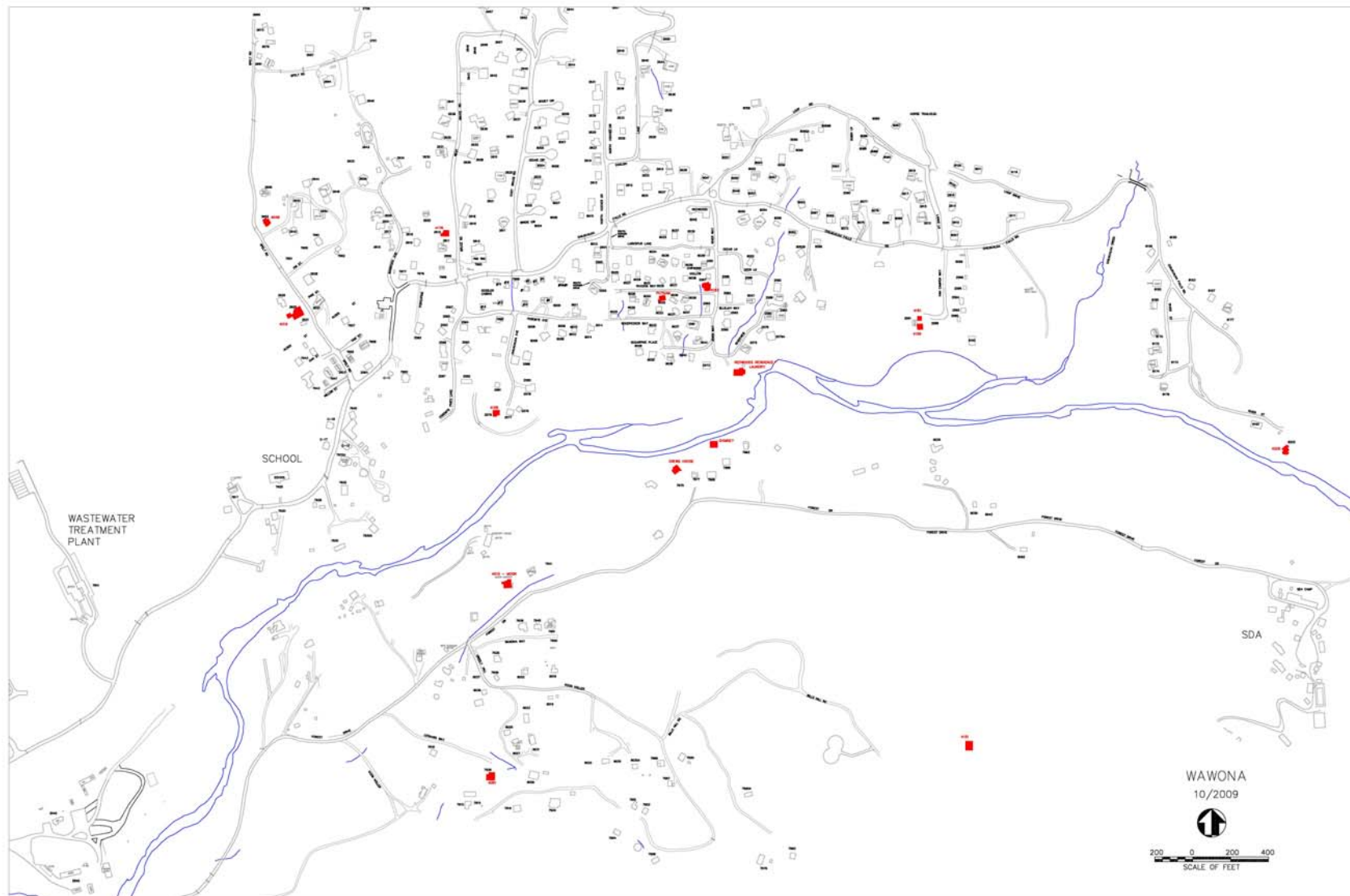



Pump house building #4161 - 2591 Van Campen Way



Building #4048- 2652 Spelt Road



Redwoods House #2571 - River View Road



Building #4205- 8202 River Street



Crew's House – 7975 Forest Drive



Veneer Chimney South of the Crews House



National Park Service
U.S. Department of the Interior

Yosemite National Park
Date: 01/07/2010

ASSESSMENT OF ACTIONS HAVING AN EFFECT ON CULTURAL RESOURCES

A. DESCRIPTION OF UNDERTAKING

1. **Park:** Yosemite National Park **Park District:** CA19

2. Project Description:

a. **Project Name:** 2009-091 Wawona Obsolete Structure Demolition

b. **Date:** January 7, 2010

c. **PEPC Project ID Number:** 26894

3. Has the area of potential effects been surveyed to identify cultural resources?

☐ No

☒ Yes, Source or reference: Wawona Cultural Landscape Inventory; Wawona Archeological District

☒ Check here if no known cultural resources will be affected. (If this is because area has been disturbed, please explain or attach additional information to show the disturbance was so extensive as to preclude intact cultural deposits.)

4. Potentially Affected Resource(s):

Archeological resources affected?

Name and number(s): Wawona Archeological District

NR status: 1 - Listed in Register and documented

5. The proposed action will: (check as many as apply)

☐ No Destroy, remove, or alter features/elements from a historic structure

☐ No Replace historic features/elements in kind

☐ No Add non-historic features/elements to a historic structure

☐ No Alter or remove features/elements of a historic setting or environment (inc. terrain)

☐ No Add non-historic features/elements (inc. visual, audible, or atmospheric) to a historic setting or cultural landscape

☐ No Disturb, destroy, or make archeological resources inaccessible

☐ No Disturb, destroy, or make ethnographic resources inaccessible

☐ No Potentially affect presently unidentified cultural resources

☐ No Begin or contribute to deterioration of historic features, terrain, setting, landscape elements, or archeological or ethnographic resources

☐ No Involve a real property transaction (exchange, sale, or lease of land or structures)

☐ Other (please specify)

6. Measures to prevent or minimize loss or impairment of historic/prehistoric properties:

(Remember that setting, location, and use may be relevant.)

No Assessment of Effect mitigations identified

7. Supporting Study Data:

(Attach if feasible; if action is in a plan, EA or EIS, give name and project or page number.)

8. Attachments:

☐ Maps ☐ Archeological survey, if applicable ☐ Drawings ☐ Specifications ☐ Photographs
☐ Scope of Work ☐ Site plan ☐ List of Materials ☐ Samples ☐ Other:

Prepared by: Jeannette Simons **Date:** January 7, 2010 **Title:** Historic Preservation
Officer **Telephone:** 209-379-1372

B. REVIEWS BY CULTURAL RESOURCE SPECIALISTS

The park 106 coordinator requested review by the park's cultural resource specialist/advisors as indicated by check-off boxes or as follows:

☒ Archeologist

Name: Laura Kirn

Date: 01/04/2010

Comments: Removal of #4048 will occur directly adjacent to known archeological resources. YOSE 1999 PA, stipulation VII.C.2.e., g., h.

Check if project does not involve ground disturbance ☐

Assessment of Effect: ☐ No Historic Properties Affected ☒ No Adverse Effect ☐ Adverse Effect ☐ Streamlined Review

Recommendations for conditions or stipulations:

Conduct archeological monitoring in conjunction with removal of building #4048.

Doc Method: Park Specific Programmatic Agreement

☒ Historical Architect

Name: Sueann Brown

Date: 01/07/2010

Comments:

Check if project does not involve ground disturbance ☐

Assessment of Effect: ☒ No Historic Properties Affected ☐ No Adverse Effect ☐ Adverse Effect ☐ Streamlined Review

Recommendations for conditions or stipulations:

Doc Method: No Potential to Cause Effects [800.3(a)(1)]

[☒] 106 Advisor

Name: Jeannette Simons

Date: 01/11/2010

Comments: No Adverse Effect determination is based on archeological monitoring designed to avoid/minimize potential impacts.

Check if project does not involve ground disturbance [☐]

Assessment of Effect: ☐ No Historic Properties Affected ☒ No Adverse Effect ☐ Adverse Effect ☐ Streamlined Review

Recommendations for conditions or stipulations:

[☒] Anthropologist

Name: Jeannette Simons

Date: 01/11/2010

Comments: American Indian traditional cultural resources will not be impacted by this project.

Check if project does not involve ground disturbance [☐]

Assessment of Effect: ☒ No Historic Properties Affected ☐ No Adverse Effect ☐ Adverse Effect ☐ Streamlined Review

Recommendations for conditions or stipulations:

[☒] Historical Landscape Architect

Name: David Humphrey

Date: 01/07/2010

Comments: None.

Check if project does not involve ground disturbance [☐]

Assessment of Effect: ☐ No Historic Properties Affected ☒ No Adverse Effect ☐ Adverse Effect ☐ Streamlined Review

Recommendations for conditions or stipulations: None.

Doc Method: Park Specific Programmatic Agreement

No Reviews From: Curator, Historian, 106 Advisor, Other Advisor, Anthropologist

C. PARK SECTION 106 COORDINATOR'S REVIEW AND RECOMMENDATIONS

1. Assessment of Effect:

☐ No Historic Properties Affected ☒ No Adverse Effect ☐ Adverse Effect

2. Compliance requirements:

☐ A. STANDARD 36 CFR PART 800 CONSULTATION

Further consultation under 36 CFR Part 800 is needed.

☐ B. STREAMLINED REVIEW UNDER THE 2008 SERVICEWIDE PROGRAMMATIC AGREEMENT (PA)

The above action meets all conditions for a streamlined review under section III of the 2008 Servicewide PA for Section 106 compliance.

APPLICABLE STREAMLINED REVIEW Criteria
(Specify 1-16 of the list of streamlined review criteria.)

☐ C. PLAN-RELATED UNDERTAKING

Consultation and review of the proposed undertaking were completed in the context of a plan review process, in accordance with the 2008 Servicewide PA and 36 CFR Part 800.

Specify plan/EA/EIS: _____

☐ D. UNDERTAKING RELATED TO ANOTHER AGREEMENT

The proposed undertaking is covered for Section 106 purposes under another document such as a statewide agreement established in accord with 36 CFR 800.7 or counterpart regulations.

Specify: _____

☐ E. COMPLIANCE REQUIREMENTS SATISFIED BY USE OF NEPA

Documentation is required for the preparation of an EA/FONSI or an EIS/ROD has been developed and used so as also to meet the requirements of 36 CFR 800.3 through 800.6

☐ F. No Potential to Cause Effects [800.3(a)(1)]

☐ G. STIPULATIONS/CONDITIONS

Following are listed any stipulations or conditions necessary to ensure that the assessment of effect above is consistent with 36 CFR Part 800 criteria of effect or to avoid or reduce potential adverse effects.

Recommended by Park Section 106 coordinator:

Signature of Historic Preservation Officer //Jeannette Simons//

Date: 1/11/10

D. SUPERINTENDENT'S APPROVAL

The proposed work conforms to the NPS *Management Policies* and *Cultural Resource Management Guideline*, and I have reviewed and approve the recommendations, stipulations, or conditions noted in Section C of this form.

Signature of Acting Superintendent //David V. Uberuaga//

Date: 1/12/10

*The signed original of this document is on file at
the Environmental Planning and Compliance
Office in Yosemite National Park.*