

**National Capital Parks – East
Reimagine Anacostia Park
A Concept Plan for Sections D and E
Public Comment Analysis Report**

January 2024

PROJECT INTRODUCTION

The National Park Service (NPS) has begun the planning process for *Reimagine Anacostia Park, A Concept Plan for Sections D and E*. The overall purpose of this project is to provide a framework for future development and use of these sections of the park. The NPS is creating a plan to study the existing conditions and develop a set of recommendations for park improvements that will provide an enhanced visitor experience, while continuing to protect natural and cultural resources. The goal of the plan is to provide recommendations to revitalize recreational opportunities at the park in a way that builds off the 2017 Management Plan for Anacostia Park. The NPS invited the public to participate in the planning process through an open public comment period and virtual public meeting. Below is a summary of the public participation outreach as well as a summary of public comments received during the open comment period.

PUBLIC OUTREACH SUMMARY

On September 15, 2023, the NPS issued a press release and posted project information to the Planning, Environment, and Public Comment (PEPC) website. The press release and PEPC website provided a project overview and invited the public to participate in the planning process. Members of the public were invited to join a virtual public meeting (discussed below) and submit comments on the project electronically via PEPC or email, via voicemail through a toll-free phone number, or via mail. The press release and PEPC website included notification of the public comment period and provided notice of the public meeting. The public meeting presentation slides and video recording were posted on the PEPC website. See attachment A for a copy of the presentation slides. The public comment period was initially open from September 25, 2023, through December 1, 2023.

A virtual public meeting was held on Tuesday, June 29, 2021, from 6:00 pm to 7:30 pm via Zoom. Attachment A includes the presentation given at this meeting. After the presentation, a Q&A session was held for members of the public to ask questions. A recording of the meeting was subsequently posted on the NPS website at: <https://www.nps.gov/media/video/view.htm?id=C7187A85-79B1-44F1-9482-D5CAF938A7D8>. A total of 26 individuals attended the virtual public meeting.

A total of 192 pieces of correspondence were received from the public, organizations, and other interested parties. The breakdown for how they were received is as follows:

- 173 of these were entered directly into PEPC
- 2 were received via email
- 3 were received via letter
- 14 were received via voicemail message, none of which contained audio

A piece of *correspondence* is considered the entire document received from a commenter. This includes letters, e-mails, comments entered directly into PEPC, voicemails, and any other written comments provided by postal mail. Those pieces of correspondence were reviewed, and individual comments were

distilled, which are individual ideas, issues, and suggestions that address a single subject within the correspondence. A summary of comments received is presented below.

The National Park Service provided updates on the Anacostia Park Development Concept Plan and directions on how to comment on at the following meetings:

- October 19 at 6:30 pm, ANC 7B Virtual Monthly Meeting
- October 20 at 10:30 am, Anacostia Parks & Community Collaborative General Meeting
- October 31 at 11:30 am, Anacostia Coordinating Council Monthly Meeting at Martha's Table
- November 7 at 7 pm, ANC 8A Hybrid Monthly Meeting

The National Park Service together with Friends of Anacostia Park tabled at in-park events, including:

- September 30th from 3 pm to 7 pm, Late Skate at Anacostia Park
- October 14th from 11 to 4 pm, Frederick Douglass Family Day
- October 28th from 3 pm to 7pm, Late Skate at Anacostia Park

Three additional targeted outreach sessions with senior groups, hand dancers, and teens were held during the comment period. Of the 192 correspondences, 81 originated from in-park outreach and engagement events.

SUMMARY OF PUBLIC COMMENTS RECEIVED

Within the 192 pieces of correspondence, a total of 985 individual comments were identified. The comments received were responses to questions in the PEPC and grouped accordingly. The following provides a summary of the comments received from the public during the open comment period, followed by the more detailed concern statements.

Overall, the public supported the preliminary concept designs for the project. Eight topic questions were asked to commentors based on the four project goal areas, Active Recreation, Community Fellowship, Waterfront Activation, and Access and Connectivity, as well as a general question to capture any additional ideas or concerns that may not be captured in the project goal areas. Commentors provided countless examples of facilities and programming they would like to see as it fits in the project goal areas. Commentor responses includes ideas for new programming as well as revamping existing facilities and programming in Anacostia Park. Some comments were outside the scope of this project, but the NPS may take them into consideration as part of future planning. Comments from government agencies and community organizations have also been included and summarized.

TOPIC QUESTION RESPONSES

Commentors were asked, in respect to Active Recreation, “what in your view offers the best mix of playing fields, sport courts, and other amenities for active recreation?” Responses included a large variety of recreational facilities, including some related to water recreation. These responses include the following:

- Commentors expressed a desire for converting tennis courts to dedicated pickleball courts. Pickleball seems to be a growing and popular sport.
- Commentors expressed the desire for multi-use fields that can accommodate various sports and activities, such as soccer, baseball, kickball, and ultimate frisbee.

- Commentors emphasize the importance of community gardens and urban farms for active recreation, particularly for addressing food insecurity issues.
- Commentors mentioned the need for better maintenance and upgrades for existing facilities, such as tennis courts, basketball courts, and playgrounds.
- Commentors requested activities such as rowing, paddling, and boathouses.
- Commentors expressed a desire for outdoor fitness equipment, workout stations, and areas for individual exercise.
- Commentors expressed a desire for a dog park.
- Commentors expressed a need for more trails, jogging/biking paths, and areas for walking.
- Commentors suggested a balance between active recreation and natural spaces, with an emphasis on ecologically beneficial features like more trees, native grasses, and shade.
- Commentor suggested areas conducive to social gatherings, concerts, and events.

Commentors were asked, in respect to Community Fellowship, “how can we improve opportunities for social, cultural, community gatherings and events?”. Commentor responses to this question were the following:

- Make it accessible and affordable.
- Build a band shell for community events.
- Introduce more furniture like tables, benches, and chairs
- More bathrooms throughout the park.
- Establish community gardens and urban farms.
- Develop an event lawn near the skating pavilion.
- Create a dog park.
- Build senior citizens facilities for board games and recreation activities.
- Add more restroom facilities.
- Incorporate shade and more intimate gathering spaces.
- Increase events to attract people to the park.

Commentors were asked, in respect to Waterfront Activation, “What experiences on or by the water are important to you?” Commentor responses included the following:

- Interaction with nature.
- Playing tennis along the waterfront.
- Biking along the waterfront.
- Swimming (desired by multiple commentors).
- Boathouse facilities for rowing and paddling.
- Fishing opportunities with added amenities like tables, benches, and bleachers.
- Kayaking and canoeing with rental options.
- Water taxi station or transportation to other docks.
- Walking, bird watching, and biking.
- Enhanced educational programs and tours on the water.

Commentors were asked, in respect to Waterfront Activation, “would you prefer a natural shoreline, the historic seawall, or combination of both?” There are a range of perspectives, with some favoring the environmental benefits of a natural shoreline, others valuing the historic elements of a seawall, and a significant number advocating for a balanced combination to address various needs and concerns.

- 38 commentors expressed a preference for a natural shoreline.
- 14 commentors indicated a preference for a historic seawall.
- 60 commentors preferred a combination of both, recognizing the benefits of a mix.
- Commentors express a preference for a natural shoreline reasoning ecological benefits, habitat restoration, and consideration for the environment are important.
- Commentors expressed a preference for maintaining or restoring the historic seawall reasoning concerns about flooding, rowing racecourse straightness, and historical significance are important.
- Commentors that advocated for a combination of natural shoreline and historic seawall valued balancing flood mitigation, ecological considerations, and public access.
- Some commentors express no strong feelings or do not specify a clear preference.

Commentors provided additional input about what they valued with no indication of a preference of restoring the seawall or having a natural shoreline. Following is a summary of those values:

- Commentors suggested to utilize sections of the seawall for educational purposes, emphasizing the river's history and environmental significance.
- Commentors suggested considering creating access points, beach areas, and docks for various activities.
- Commentors recognized the importance of maintaining views and easy access to the water.
- Commentors stated a preference for designs that promote environmental sustainability, wetland stormwater management, and biodiversity.
- Commentors suggested to make Anacostia Park a destination for cherry blossoms.

Commentors were asked, in respect to Waterfront Activation, “would you like to enhance existing wetlands and introduce new, nature-based stormwater facilities to help with flooding?” Commentors showed support for enhancing existing wetlands.

- 68 commentors expressed a clear desire to enhance existing wetlands.
- 75 commentors were in favor of introducing new, nature-based stormwater facilities to address flooding issues.
- Commentors emphasized the importance of wetlands, stating that they are critical and should be protected and restored whenever possible.
- Many commentors express the need for natural solutions to address flooding, viewing wetlands to manage stormwater effectively.
- Commentors mentioned that their support for wetland restoration is grounded in environmental stewardship, with an understanding that these features contribute to the health of the river and its banks.

Commentors provided additional input about what they valued with no indication of a preference of enhancing existing wetlands or introducing new stormwater facilities. Following is a summary of those values:

- Commentors included the idea of DC becoming a "sponge city" and indicated a desire for sustainable and nature-based approaches to water management.
- Commentors recognize the potential for wetlands to offer recreational opportunities, such as fishing and other nature-based activities.
- Some commentors highlight the educational benefits of wetlands, especially for students, and express enthusiasm for features like signage to provide information.
- Commentors acknowledge that flooding is a problem, and they are supportive of measures, such as wetland enhancement, to address this issue.
- Commentors valued maximizing existing wetlands and introducing new wetlands is seen as an unprecedented opportunity for ecosystem restoration, resilience to climate change, and mitigation of flood risks.
- Some commentors express support for the daylighting of buried streams, recognizing the benefits of surface streams in improving water quality and reducing pollution.
- Commentors valued wetland enhancement and stormwater management are viewed as critical features for the future park, aligning with goals related to sustainability and ecological diversity.
- Commentors appreciate the potential for wetlands and stormwater facilities to provide additional quiet and educational spaces, fostering a stronger connection between the community and the park's ecology.

Commentors were asked, in respect to Access and Circulation, "what specific improvements would you like to see around access? What is your experience getting to different features of the park? What would you like to have better access to?" Commentors provided suggestions for ways the NPS could increase pedestrian safety and accessibility. These suggestions included:

- Reduced fossil fuel use by considering reducing and discouraging fossil fuel use and include vehicle charging stations.
- Commentors suggested less focus on vehicle movement and parking, and more on bike and pedestrian movement. Commentors would like to see rehabilitation of pedestrian/bike access to the park. Commentors suggested consideration of adding pedestrian bridges for improved connectivity and removing obstacles like old CSX tracks to facilitate walking to the park. Commentors would like to see dedicated bike lanes added on main thoroughfares to and from the park and the prioritizations of pedestrians and bikers in paved areas.
- Commentors would like to see improved metro access to the park. Introduce bus or electric trolley services. Consider a free shuttle from Anacostia Metro and Capital Bike Share stations. Add a bus stop in the park and introduce a shuttle bus service. Explore the possibility of a WMATA Riverpolitan Express Shuttle connecting various locations. Enhance bus and biking access for people living east of 295.
- Install proper lighting for safety. Improve underpasses with better aesthetics and maintenance. Ensure better signage for motor vehicles, pedestrians, and bikers. Include ADA accessibility measures. Implement traffic-calming measures like speed humps, road curves, or narrowing.
- Provide more entrances to the park. Add new entrances and expand sidewalk access. Explore the creation of a loop road at the northern end.
- Upgrade and maintain existing recreational facilities, including tennis courts. Install permanent pickleball courts. Include dedicated bike and running lanes. Environmental Considerations:

Enhance access to the river and natural wetlands with features like boardwalks. Consider a boardwalk for better access to the river.

- Explore bike and electric scooter rentals. Introduce a shuttle service with frequent stops and checkpoints. Consider adding more bike trails and activities.
- Include public, clean, gender-neutral restrooms. Add more drinking water fountains. Consider incorporating food vendors and food preparation demonstrations.

Commentors were asked, in respect to Access and Circulation, “would you prefer to keep Anacostia Drive in its existing location or locate away from the river for portions of the park?” The majority of Commentors preferred to move the roadway away from the river. A lot of commentors supporting relocating the road included concerns about environmental impacts, making space for recreation near the water, and maintaining bike and pedestrian facilities and increasing safety for bikers and pedestrian by limiting interactions between them and cars. There were also concerns in support of keeping the location of the road about accessibility to the waterfront, loading and unloading, and access for public transit.

- 47 commentors expressed a preference for keeping Anacostia Drive in its current location or a similar location.
- 64 commentors indicated a preference for relocating Anacostia Drive away from the river or to a different location.
- 40 commentors mentioned no strong preference, express indifference, or state no opinion.

Commentors were also asked for any additional thoughts for the project team. Commentors touch on a large number of topics. The following is a summary of those additional thoughts and topics:

- Multiple commentors emphasize the importance of addressing the climate and extinction crises. Suggestions include phasing out fossil fuels, protecting natural habitats, and promoting biodiversity. Calls for the National Park Service (NPS) to provide leadership in environmental stewardship.
- Commentors raised concerns about automobile traffic safety within the park. Proposals for strategic installation of speed bumps, especially on long, straight stretches. Recommendation to turn the Good Hope Road and Anacostia Drive intersection into a 3-way stop for pedestrian safety. Emphasis on improving accessibility for neighboring communities.
- Commentors would like to see a proposal for a boathouse next to the skating pavilion and basketball courts to enhance water access and suggested that the Anacostia Community Boathouse (ACBA) may contribute financially.
- Commentors requested for additional bathrooms and water fountains in specific areas.
- Commentors expressed a desire for barriers to prevent cars from driving on the trail.
- Some commentors valued reducing lawns, introducing native plants, and increasing native grasses.
- While the Design addresses many communal desires, commentors urge NACE to prioritize the following:
 - Incorporating handicap accessibility at the Pavilion and other park attraction access points.
 - Installing and regularly maintaining new restroom facilities.

- Improving and maintaining built surfaces such as the Pavilion floor, sidewalks, and parking lots.
 - Upgrading and maintaining all existing recreational courts that allow for multi-sport use.
 - Constructing additional drinking water fountains around the Pavilion.
- Commentors included recommendations for climate-resilient designs, permeable surfaces, and dark-sky lighting. Calls for large native shade trees, meadows, and riparian reforestation to enhance ecological resilience. Suggestions for nature observation opportunities, birding, river ecology activities, and an Anacostia Park mini arboretum.

Out of Scope Comments

Some suggestions were out of scope of this project, though NPS may take them into consideration as part of future planning. These suggestions included the following:

- Commentor would like to see more security around recreational facilities. Suggestions included CCTV coverage to enhance park security.
- Commentors would like to see stalls for seasonal concessions – food, equipment rental, etc.—could be located against the roadway on the east edge of the site.
- Commentors suggested to improve the skating pavilion by potential allowing for local artists to work on the floor.

Public Engagement Process

Come commentors expressed different views with the public engagement process and suggested some ways to improve it. These suggestions included the following:

- Proposals for ongoing programs, internships, and work opportunities for youth.
- Calls for public art, lights, and improved park cleanliness.
- Desire for more yoga, meditation, dance classes, and board games.
- Emphasis on engaging the local community and supporting local artists.
- Commentors desired the decision-making process be completely transparent and the community has a seat at the table at every step of the way.
- Calling upon the local arts community to provide designs to be curated by the local community will provide unique and long overdue connections to this beloved Park.
- Public meetings should be held as soon as possible to discuss this effort in an open forum. Tours and discussions open to the public should take place to visit and discuss options on site.
- In addition to other repairs to existing facilities, appropriate space and facilities must be provided for the Friends of Anacostia Park whose efforts make this Park the heart of the communities it serves.
- While the ongoing planning and design process continues to evolve, we strongly urge NACE to respect the requests and triple bottom-line needs of the community. Additionally, we ask that NACE notify residents far in advance of planned infrastructure implementations, particularly ones that impact on them already limited access points of the Park.
- To that end, one vital feature that has not been addressed in the Design is a safe and maintained location for senior activities, in particular hand dancing hosted in partnership with local community groups. Participating seniors have been utilizing space in the Section E parking lot to

engage in these activities, and any revitalization efforts should include the creation of a space for such activities.

- Commentors want to see acknowledgement of the importance of respecting the voices of the existing community and emphasis on prioritizing the preferences of the community members with proximity and historical connections to the park.
- Commentors expressed appreciation for the work done on the proposed options for the park, requested ongoing community engagement and responsiveness to feedback and would like to provide additional comments at a later date.

Demographic data showed that respondents submitted from four known locations, Maryland, Washington DC, Utah, and Virginia, and one unknown location. 103 responses came from 20020, 18 responses from 20003, 15 responses from 20002. Washington DC made up 70 percent of respondents.

AGENCY AND COMMUNITY ORGANIZATION RESPONSES

Below are responses from organizations and agencies representing community and government interests. The following is a summary of the responses. Responses were received from the National Capital Planning Commission, the Anacostia Parks and Community Collective, the Anacostia Watershed Community Advisory Committee, Washington DC Pickleball, and The Committee of 100 on the Federal City.

National Capital Planning Commission

National Capital Planning Commission (NCPC) staff strongly support the proposed planning vision to ensure “the park is resilient, safe, and well-maintained with strong connections to communities, partners, and the river ecosystem.” Based on our review of the available project materials, staff would like to provide the following comments:

- **Access and Connectivity:** I-295 is a significant physical barrier between local neighborhoods and the river. Staff strongly supports the proposals to increase pedestrian and bike access to the park from adjacent neighborhoods through improved entrances and proposed new entrance access points as well as increased lighting, art and signage. The pedestrian and bike connections to the planned 11th Street Bridge Park highlighted will be particularly important to creating a seamless experience for park users. We also see benefits to shifting Anacostia Drive to open up the waterfront, preferably as configured in Potential Option 3 to provide the larger community open spaces and numerous access areas along the waterfront.
- **Waterfront and Resilience:** We would be interested to learn more about NPS’s plans for the future of these sections of the park in response to climate change and sea level rise. The information provided indicates that both a rehabilitated sea wall and natural shoreline could provide needed flood protection and stormwater management, and if so, staff support creating a natural shoreline where possible to soften the park edge and provide environmental educational opportunities.

We look forward to discussing the timeline for NCPC review of future Anacostia Park projects in Sections D and E that are developed as the next phase of implementation.

Anacostia Parks & Community Collaborative

Our membership, which includes environmental experts and diverse local voices, reflects our community-based vision for how the Anacostia Park and River system can support the well-being of the surrounding communities. We appreciate the opportunity to comment on the Anacostia Park Preliminary Concept Designs (“the Design”).

Anacostia Park offers a wealth of recreational opportunities from hiking, biking, and fishing to court sports such as basketball, tennis, pickleball. Most notably, roller skating at the park’s Skating Pavilion has a storied history and continues to be the cornerstone attraction for the park’s many visitors. However, most visitors are Ward 7 & 8 residents, who not only rely on the Park as a hub for physical activity, but also as an important resource for mental and social well-being.

We strongly urge NACE to respect the requests and triple bottom-line needs of the community. Additionally, we ask that NACE notify residents far in advance of planned infrastructure implementations, particularly ones that impact on the already limited access points of the Park.

One vital feature that has not been addressed in the Design is a safe and maintained location for senior activities, in particular hand dancing hosted in partnership with local community groups. Participating seniors have been utilizing space in the Section E parking lot to engage in these activities, and any revitalization efforts should include the creation of a space for such activities.

While waterfront access deserves serious consideration, residents would like the entirety of Section D & E to be easily accessible by car. While we encourage community members to take advantage of public transportation and environmentally friendly modes of transit, any changes to Anacostia Drive should ensure that recreation spaces and other attraction points can be reached easily by personal vehicle.

While the Design addresses many communal desires, we urge NACE to prioritize the following:

- Incorporating handicap accessibility at the Pavilion and other park attraction access points.
- Installing and regularly maintaining new restroom facilities.
- Improving and maintaining built surfaces such as the Pavilion floor, sidewalks, and parking lots.
- Upgrading and maintaining all existing recreational courts that allow for multi-sport use.
- Constructing additional drinking water fountains around the Pavilion.

APACC would like to applaud NACE’s engagement efforts with the community, particularly the Superintendent’s willingness to meet with community stakeholders to discuss the Design and solicit feedback.

Anacostia Watershed Community Advisory Committee

With the prospect of funds becoming available in the near future via activities around the Natural Resources Damage Assessment and Restoration Plan, it is essential that opportunities be identified and preserved for these activities so that they are not overwhelmed by other development pressures.

The immense investment in restoration by all the Anacostia jurisdictions will soon pay off in attainment of the criterion for safe swimming. This is a gamechanger for the Anacostia Parks, and water safety must come to the forefront of Park planning activities.

The asphalt road and vehicular traffic, including bicycles, should be located to the east side of the site to activate the shore as a recreation area accommodating strolling, relaxing, water contact, fishing.

It would be beneficial to use the daylighting of the Ft Dupont Tributary as an opportunity to establish a natural edge on the north end of the park. A generous riparian buffer on the south bank of the stream would simultaneously protect the stream and screen the CSX facilities. A rustic structure, such as a sylvan theater (not “the” Sylvan Theater) would provide further screening and a flexible facility which could be used to support various activities such as performances and sporting events which could take place in the field north of the Skate Pavilion.

Daylighting Pope Branch would provide an organizing element for a picnic area and adjacent playground. Both would benefit from the shade, beauty and comfort of a restored riparian area. Pine groves are particularly beneficial in spaces of this kind for practical and aesthetic reasons. Wetlands could be created along the shoreline between the two tributaries and extended to provide a natural barrier on the bridge side of the dock. Due to its location so close to the “chute” under the CSX Bridge, the dock is a hazard to boaters. A natural buffer would reduce the potential for damage to the dock and watercraft.

Pavement should be minimized on the river side of the Pavilion to enhance view and connection to the River front. A permanent bandstand or other wood surface should be provided for the hand dancers in a prominent and shaded location. A boardwalk bordered by native grasses and natural shoreline should replace the seawall and would enliven and enhance the river front. The southern field could be planted as a meadow and ringed with native grasses and shrubs. The meadow could be mowed occasionally to accommodate special events.

Section E of the Park could be connected to Section D by continuing the boardwalk and living shoreline/planting, then organized around a sandy beach along the southern river front. On the east bank south of the CSX bridge, the seawall should be removed entirely. The adjacent grades are such that retaining walls of any kind are unnecessary. Stalls for seasonal concessions – food, equipment rental, etc. – could be located against the roadway on the east edge of the site. An appropriate transition will need to be designed to provide continuity and connectivity to the 11th Street Bridge Park.

AWCAC is encouraged to learn that the project planners are dedicated to providing physical connections to neighborhoods brutally cut off from the river by transportation infrastructure. Appropriate agencies must be engaged to design monumental, safe and inviting entrances to the Park. This is of the utmost priority. Calling upon the local arts community to provide designs to be curated by the local community will provide unique and long overdue connections to this beloved Park. Public meetings should be held as soon as possible to discuss this effort in an open forum. Tours and discussions open to the public should take place to visit and discuss options ON SITE.

In addition to other repairs to existing facilities, appropriate space and facilities must be provided for the Friends of Anacostia Park whose efforts make this Park the heart of the communities it serves. AWCAC offer these recommendations and our sincere commitment to support this and all efforts to restore and enhance the health of the Anacostia and all the communities - human, plant and animals - and to establish the “world class” park system promised in the Anacostia Parks Management Plan.

Washington DC Pickleball

Pickleball is the fastest growing sport in the US, with participation increasing exponentially over the past 3 years. Pickleball is accessible and equitable and requires very little gear or training to get started. Pickleball fosters community fellowship, with people of all ages, backgrounds, and athletic ability sharing the joy of the game on the courts and socializing with each other between games.

Washington DC Pickleball has partnered with Friends of Anacostia Park to activate pickleball in Anacostia Park. With NPS-NACE permission, WDCP created dual-use pickleball courts at Anacostia Recreation Center. A pickleball event held on July 4th, 2023, attracted over 80 players from DC, Maryland, and Virginia, many of whom had never visited Anacostia Park. Since then, the number of players in the park has grown steadily. Open play is available during daylight hours, with nets and supplies available in a lockbox, all provided by WDCP.

We ask that in your plans to renovate the tennis courts at the Anacostia Recreation Center, NPS consider converting the majority of this space to pickleball. Twelve or more dedicated pickleball courts can be accommodated, while maintaining two or three tennis courts, which would be dual use. In addition to regular open community play, the availability of a pickleball “hub” would provide space for events for community groups such as youth and students, seniors, veterans, church groups, LGBTQ groups, alumni groups, and returning citizens. The space would be attractive for city-wide tournaments, which would draw business to historic Anacostia. Given the large and growing number of pickleball players, and the diverse player population, the usage of the courts and benefit to the community would be much greater than maintaining the current tennis configuration. No existing green space would need to be sacrificed, as adequate hard surface already exists, with easy bike access, and plenty of parking. Any renovation should include adequate shade (critically important in the era of climate change), and access to bathrooms – both factors which currently limit play at the site. Lighted courts would allow evening play, facilitating access to recreation by working adults. Bleachers would provide seating for players between games, and a place for spectators to watch the competition. Due to its location and terrain, Anacostia Park would be an ideal location for wheelchair pickleball.

The Committee of 100 on the Federal City

WATERFRONT ACTIVATION: Fishing piers. Fishing piers provide year-round recreation for all ages. Adding fishing piers in Anacostia Park will mitigate the loss of the two fishing piers at the 11th Street Bridge Park. Anglers can catch invasive blue catfish, common carp, largemouth bass, assorted sunfish, and invasive northern snakeheads. We note that DOEE, the District agency charged with protecting and restoring the environment, encourages catch and release.¹

WATERFRONT ACTIVATION: Natural shoreline. C100 supports maximizing the natural shoreline and minimizing the seawall (Potential options 2 and 3). While the seawalls are “historic,” they were built as a response to a perceived need in the early twentieth century to dredge the Anacostia River for improved navigation, to eliminate mosquito habitat, and for Combined Sewer Outflows. Photographs in the NPS 2020 report show that the seawall, including CSOs, is deteriorating in many places. One option would be to remove seawalls in certain locations or allow the seawalls to continue deteriorate, disappear, to be replaced by living shorelines.

DOEE encourages creating living shorelines: At the founding of the city, the Anacostia River was bounded by broad floodplains and large marshes. Throughout the District’s development, seawalls have been constructed along the shorelines of the Anacostia and Potomac Rivers. Prior to the construction of

seawalls, the Anacostia River meandered through a broad floodplain that contained large marshes. Seawalls severely restrict habitat for aquatic and terrestrial species, remove the ability of the river to connect with its floodplain, and do little to reduce wave energy. Seawalls also prevent the predicted landward migration of wetlands resulting from climate change, thereby reducing the District's climate change resiliency. DOEE should encourage stakeholders to consider the establishment of living shorelines, where appropriate, as options for best management practices for future development projects and restoration projects along the river. Living shorelines are a bank-stabilization technique that utilizes materials similar to natural shorelines and may include wetland plants, submerged aquatic vegetation, and a variety of structural material such as fiber logs, sand, rock and stone. Living shorelines provide shoreline stabilization, create habitat for aquatic and terrestrial wildlife, and improve water quality by filtering stormwater runoff. Living shorelines may be a preferred approach for adapting to sea level rise where there is space for landward migration of wetlands. Some living shoreline designs involve incorporating wetland plants and creating wetlands, which would help increase the number of District wetlands. Coordination between DOEE, US Army Corps of Engineers, NPS, and other stakeholders, as well as public outreach and public acceptance, will be necessary to encourage living shorelines within the along the Anacostia and elsewhere in the District.

WATERFRONT ACTIVATION: Enhance and enlarge wetlands. DOEE is working with NPS to preserve existing wetlands (approximately 300 acres), and create new wetlands.⁶ As noted, wetlands provide the opportunity for recreation and habitat for wildlife. C100 supports the proposal to enhance existing wetlands and introduce new, nature-based stormwater facilities to help with flooding.⁷

WATERFRONT ACTIVATION: Daylighting Pope Branch within Anacostia Park. Pope Branch is a first-order tributary of the Anacostia River. The entire stream lies within DC, running from the Twining and Penn Branch neighborhoods to Anacostia Park. In 2016 DOEE completed stream restoration of Pope Branch *outside* the borders of Anacostia Park. Daylighting this remaining section will restore all of Pope Branch to its original condition.

Loss of surface streams. Of the streams that flowed through the District of Columbia at the start of the 19th century, only about 30% remain today. The other 70% have been filled in, diverted into pipes, or have disappeared as a natural response to widespread construction reducing infiltration of rainfall.

Benefits of daylighting streams: Streams, including ephemeral streams that do not have water year-round, mitigate damage from floods, and provide habitat and food for aquatic species, semi-aquatic species, waterfowl, and other wildlife. Headwater streams are a source of water, nitrogen, organic carbon, and sediment to downstream waters. Despite their small individual size and distance from downstream waters, headwater streams, including ephemeral streams, cumulatively supply most of the water in rivers. Downstream waters are the time-integrated result of all waters contributing to them.

DOEE's stream restoration at Pope Branch The primary land uses of the 250-acre Pope Branch watershed are parkland and residential lands yet the impervious area in the residential neighborhoods surrounding the stream caused high rates of bank erosion and channel incision erosion which caused a sanitary sewer line in the upper reaches of the stream valley to become exposed and compromised. DOEE partnered with the Department of Parks and Recreation (DPR) and DC Water and Sewer Authority (DCWATER) to do a joint sewer line and stream restoration project with DCWATER as the lead contracting agency. DCWATER first fixed the sewer line along the stream followed by the stream restoration work. In total, over 4,400 feet of stream were restored using regenerative stream design which filled in the incised stream and raised the stream bed about 3-4 feet so that it reconnected with its historic floodplain. A series of pools and riffles/cascades were installed to ensure both the lateral and vertical stability of the stream so it can remain stable even in high flow events. 663 native trees, 170 native shrubs, over 13lbs. of native grass seed, and over 100 native aquatic plants were planted as part of the restoration project.

ACCESS & CONNECTIVITY. Lighting improvement. Light pollution should be minimized.¹² All lighting should comply with the International Dark-Sky Association's standards. To insure that the lighting satisfies the most rigorous dark sky standards, we suggest that the NPS specify that all lighting fixtures must meet the standards for a seal of approval from the International Dark-Sky Association (IDA). Fixtures approved by IDA employ warm-toned (3000 K or lower) white light sources or employ amber light sources or filtered LED light sources, are full-shielded, emit no light above the horizontal plane, have no sag or drop lenses, side light panels, or uplight panels, etc.

ACCESS & CONNECTIVITY. Anacostia Drive. C100 supports moving Anacostia Drive away from the river as far as possible, to create more space for natural shorelines and river access.

ATTACHMENT A
PUBLIC MEETING PRESENTATION



REIMAGINE! ANACOSTIA PARK!

A Concept Plan for Sections D & E

Public Informational Meeting

September 27, 2023

MEETING WITH YOU TODAY

<https://qr.link/xzauvj>



TARA MORRISON

SUPERINTENDENT

NATIONAL CAPITAL
PARKS - EAST



JESSI BARNES

LANDSCAPE
ARCHITECT

VHB



DONZELL ROBINSON

PRINCIPAL

JUSTICE &
SUSTAINABILITY
ASSOCIATES



ALEXIS ROBINSON

ASSOCIATE

JUSTICE &
SUSTAINABILITY
ASSOCIATES

AGENDA

<https://qr.link/xzauvj>



- 1) Introductions
- 2) How to Provide Comments
- 3) What is a Concept Plan
- 4) Design Process
- 5) Vision & Goals
- 6) Design Elements:
 - Active Recreation
 - Community Fellowship
 - Waterfront Activation
 - Access & Connectivity
- 7) Wrap-up



MEETING ETIQUETTE

<https://qr.link/xzauvj>



NPS wants to hear from you. Here are a few guidelines to keep this meeting productive and to maintain respect for all participants:

- You will have an opportunity to ask questions at the end of the presentation
- To ensure we hear from as many community members as possible, please follow the Q&A protocol:

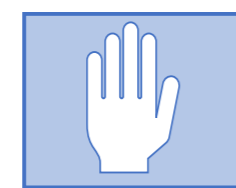

Raise your hand if you'd like to ask a question



Request to speak by typing your name in the chat



Type questions directly into the chat

- When speaking, maintain a civil tone and be mindful of time so that your fellow community members can share their feedback
- You may type questions into the Q&A at any point during the meeting, questions will be answered at the end of the presentation

Meeting facilitators may mute participants to reduce background noise or to enforce meeting etiquette guidelines.

HOW TO PROVIDE COMMENTS ONLINE

Please visit:

https://parkplanning.nps.gov/Reimagine_AnacostiaPark_PrelimDesign

Comments
can be
submitted to
the Park via
QR Code:



<https://qr.link/xzauvj>

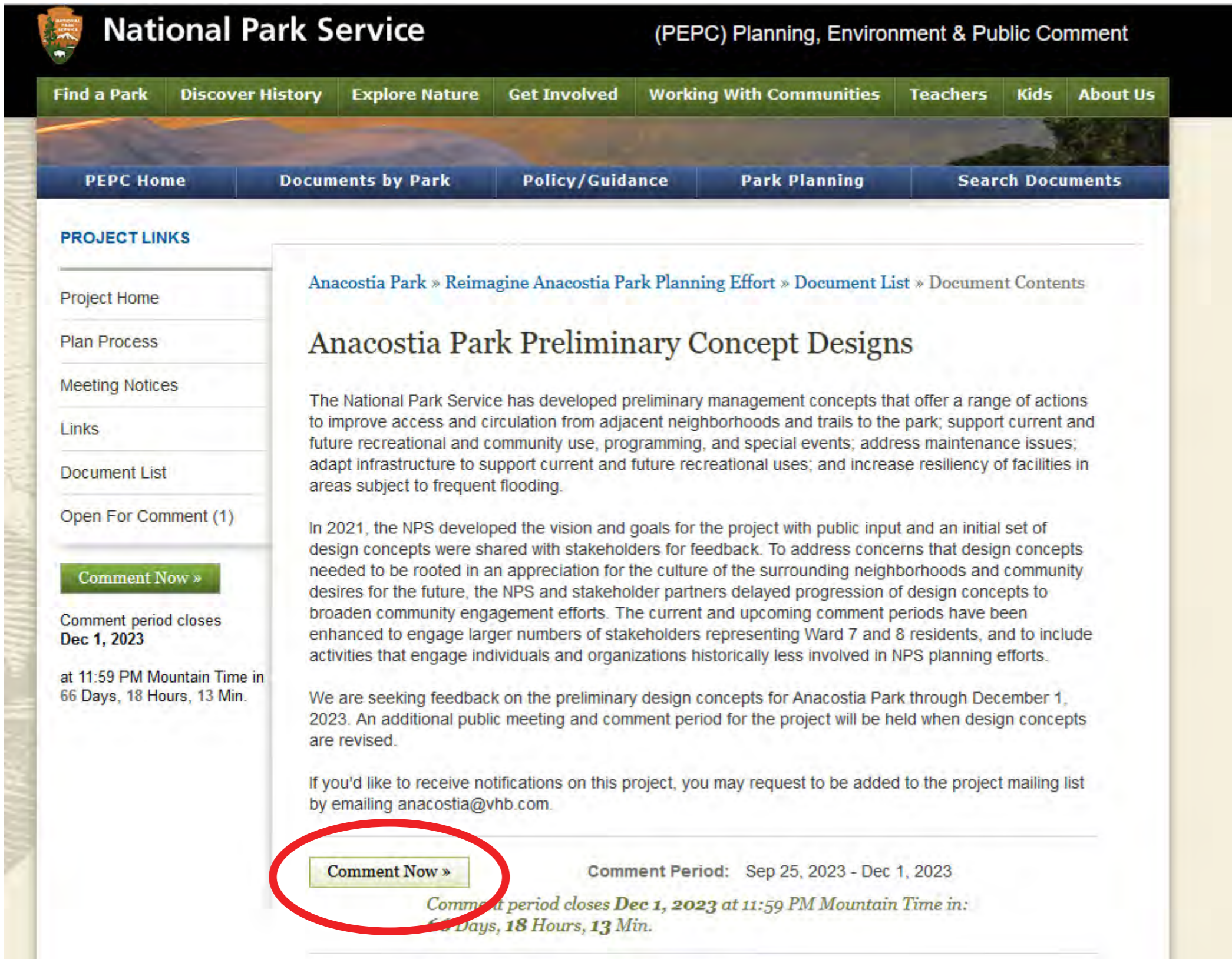

National Park Service (PEPC) Planning, Environment & Public Comment

Find a Park Discover History Explore Nature Get Involved Working With Communities Teachers Kids About Us

PEPC Home Documents by Park Policy/Guidance Park Planning Search Documents

PROJECT LINKS

- Project Home
- Plan Process
- Meeting Notices
- Links
- Document List
- Open For Comment (1)

Comment Now »

Comment period closes **Dec 1, 2023** at 11:59 PM Mountain Time in 66 Days, 18 Hours, 13 Min.

Anacostia Park » Reimagine Anacostia Park Planning Effort » Document List » Document Contents

Anacostia Park Preliminary Concept Designs

The National Park Service has developed preliminary management concepts that offer a range of actions to improve access and circulation from adjacent neighborhoods and trails to the park; support current and future recreational and community use, programming, and special events; address maintenance issues; adapt infrastructure to support current and future recreational uses; and increase resiliency of facilities in areas subject to frequent flooding.

In 2021, the NPS developed the vision and goals for the project with public input and an initial set of design concepts were shared with stakeholders for feedback. To address concerns that design concepts needed to be rooted in an appreciation for the culture of the surrounding neighborhoods and community desires for the future, the NPS and stakeholder partners delayed progression of design concepts to broaden community engagement efforts. The current and upcoming comment periods have been enhanced to engage larger numbers of stakeholders representing Ward 7 and 8 residents, and to include activities that engage individuals and organizations historically less involved in NPS planning efforts.

We are seeking feedback on the preliminary design concepts for Anacostia Park through December 1, 2023. An additional public meeting and comment period for the project will be held when design concepts are revised.

If you'd like to receive notifications on this project, you may request to be added to the project mailing list by emailing anacostia@vhb.com.

Comment Now » Comment Period: Sep 25, 2023 - Dec 1, 2023

Comment period closes **Dec 1, 2023** at 11:59 PM Mountain Time in 66 Days, 18 Hours, 13 Min.

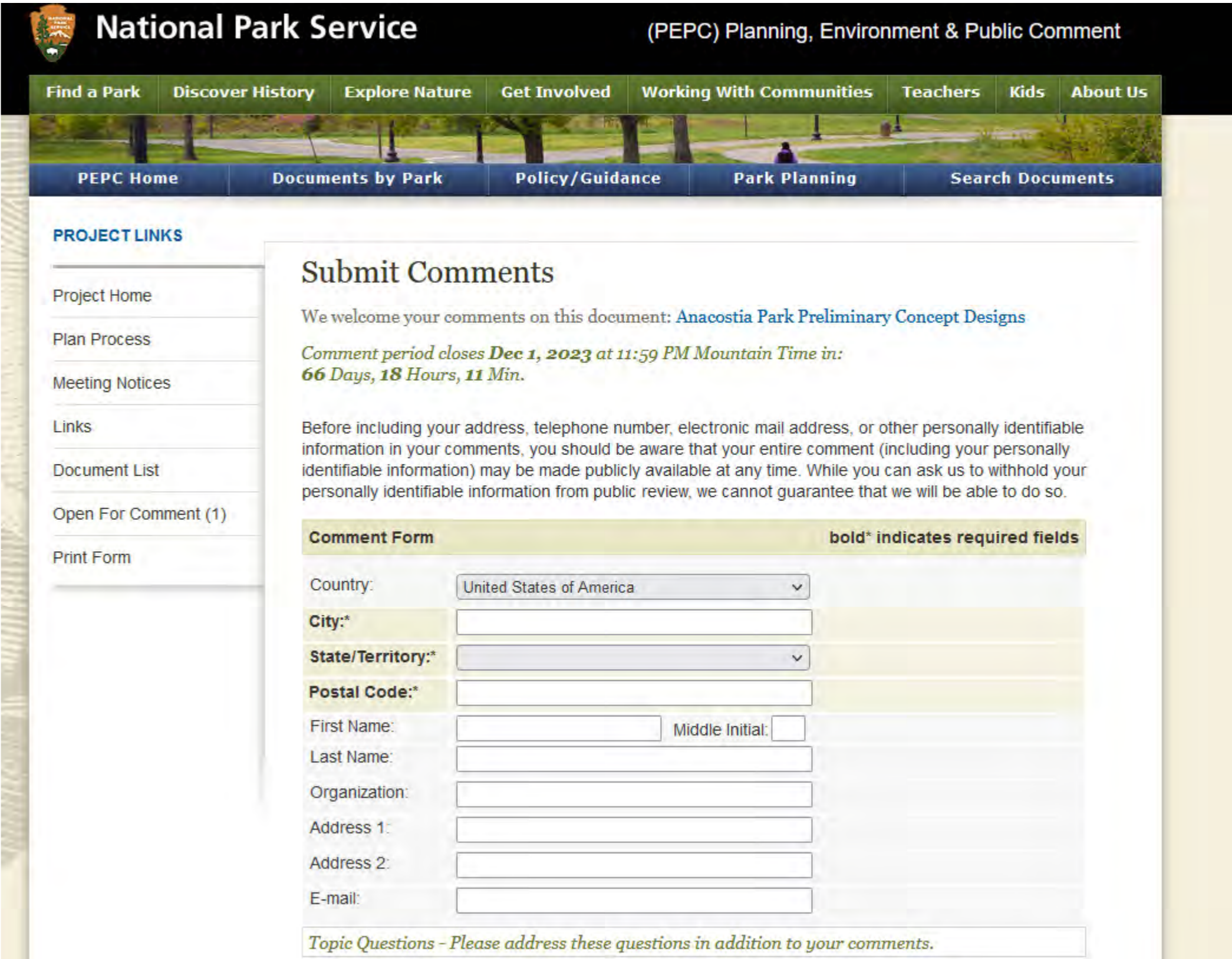

National Park Service (PEPC) Planning, Environment & Public Comment

Find a Park Discover History Explore Nature Get Involved Working With Communities Teachers Kids About Us

PEPC Home Documents by Park Policy/Guidance Park Planning Search Documents

PROJECT LINKS

- Project Home
- Plan Process
- Meeting Notices
- Links
- Document List
- Open For Comment (1)
- Print Form

Submit Comments

We welcome your comments on this document: [Anacostia Park Preliminary Concept Designs](#)

Comment period closes **Dec 1, 2023** at 11:59 PM Mountain Time in: **66 Days, 18 Hours, 11 Min.**

Before including your address, telephone number, electronic mail address, or other personally identifiable information in your comments, you should be aware that your entire comment (including your personally identifiable information) may be made publicly available at any time. While you can ask us to withhold your personally identifiable information from public review, we cannot guarantee that we will be able to do so.

Comment Form **bold* indicates required fields**

Country:

City:*

State/Territory:*

Postal Code:*

First Name: Middle Initial:

Last Name:

Organization:

Address 1:

Address 2:

E-mail:

Topic Questions - Please address these questions in addition to your comments.

Step 1: Click “Comment Now”

Step 2: Fill Out the Form with Your Comments

WHAT IS A CONCEPT PLAN?

<https://qr.link/xzauvj>



A plan that presents **specific opportunities** to meet the **goals and vision for a park**, or section of a park, at a conceptual level.

Examples of concept drawings below from the *Buzzard Point Concept Plan*:



ANACOSTIA PARK CONCEPT PLAN

<https://qr.link/xzauvj>



The legislation that created Anacostia Park identified the following purposes for the park, parkway, and playground system:

- **Prevent pollution** of the Anacostia River (as well as Rock Creek and the Potomac River)
- **Preserve the forest and natural scenery** in and about Washington, DC
- **Meet the park and recreation needs** of Washington, DC, residents

The concept plan is the first step in the overall decision-making process for the future of Anacostia Park. Certain proposed actions in the concept plan will require additional environmental and historical preservation compliance prior to implementation. Implementation may occur over time as funds become available.

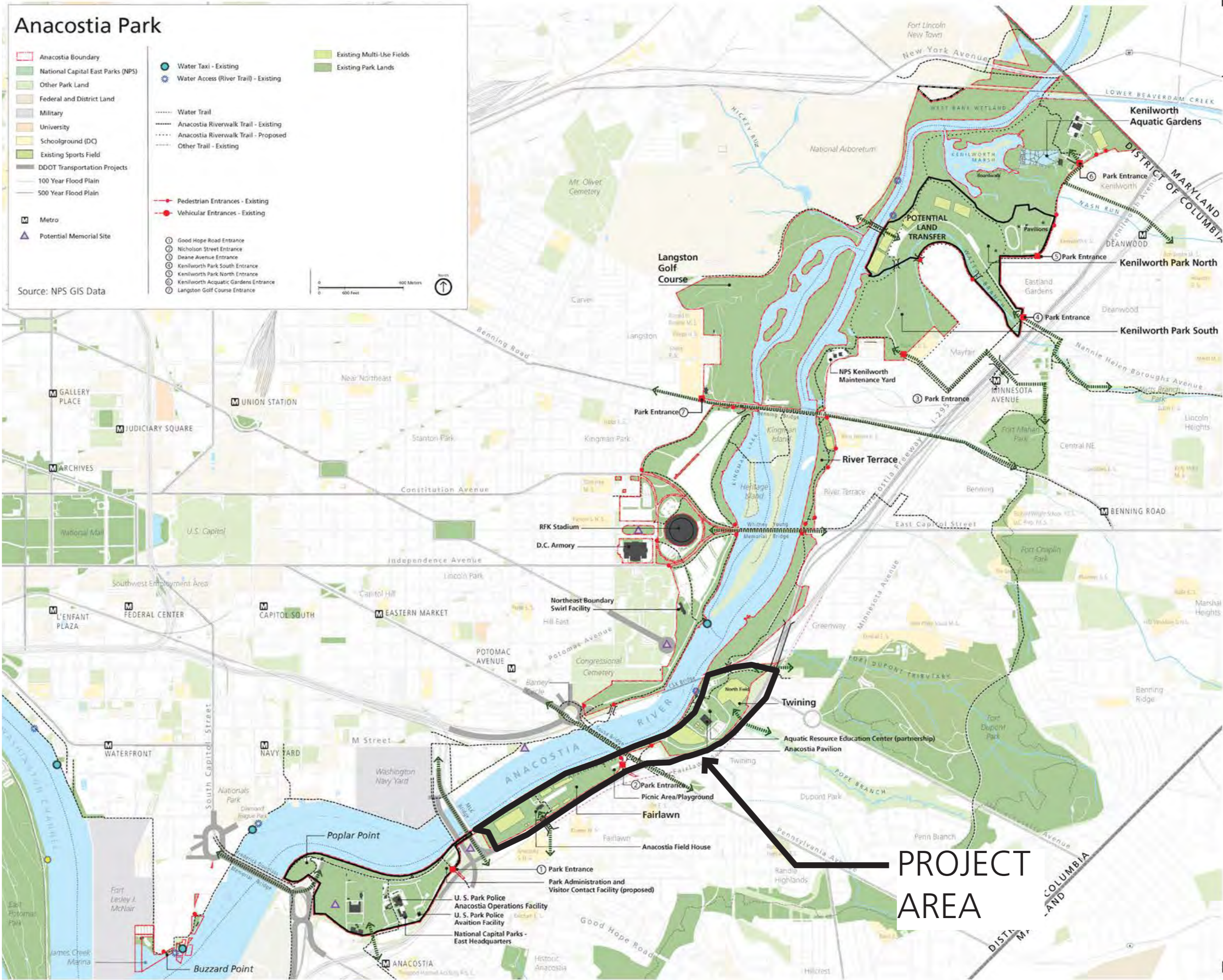

CONCEPT PLAN AREA

<https://qr.link/xzauvj>



PURPOSE OF THE PLANNING PROCESS

<https://qr.link/xzauvj>



Evaluate the existing conditions of Sections D & E of Anacostia Park and develop a set of recommendations that improve access from nearby neighborhoods and trails; support current and future community use, park programming, and special events; address maintenance issues, adapt infrastructure to support use and improve accessibility; and increase resiliency of facilities in areas of frequent flooding.

THESE RECOMMENDATIONS SHOULD:

- Be consistent with the legislative purpose for Anacostia Park
- Be rooted in an appreciation for the culture of the surrounding neighborhoods and community desires for the future
- Advance the *2017 Anacostia Park Management Plan* preferred alternative:
 - Land and water-based recreation would be expanded to meet needs of communities; river landscape ecology to be improved
 - Infrastructure supporting sports play would be consolidated, with current capacity retained or slightly expanded; no major new additions
 - Public access to river would be enhanced



WHERE ARE WE IN THE PROCESS?

<https://qr.link/xzauvj>



Develop Vision & Goals

- Stakeholder Workshop
(March 2021)
- NPS Refinement of Vision & Goals
(Spring 2021)
- 45-Day Public Review
(June-August 2021)

Early Concept Development

- Strategies Identified & Early Framework Created
(Fall 2021)
- Stakeholder Workshop
(December 2021)
- Revisit Stakeholder Engagement Strategy & Re-Engage, and Break Out Potential Concept Elements
(2022)

Concept Refinement

- Focus Group Meetings
(March 2023)
- Agency Coordination Meetings
(March-April 2023)
- Public Engagement Strategy & Materials Developed
(Summer 2023)
- 60-Day Public Review
(September-November 2023)
- [WE ARE HERE]

Concept Plan Produced

- Concept Options Developed
(Late 2023/Early 2024)
- Stakeholder & Public Review
(Summer 2024)
- Concept Options Refined
(Fall 2024)
- Concept Plan Published
(Late 2024)

FUNDING INFORMATION

<https://qr.link/xzauvj>



- \$2.2 million in remaining mitigation funds can be used towards design or implementation of this concept plan.
- \$11.8 million in Great American Outdoors Act funding for Anacostia, River Terrace, Kenilworth, Fort Dupont parks, the Parkland area of Shepherd Parkway, and more. The projects include replacing or rehabilitating:
 - Tennis and basketball courts
 - Playgrounds
 - Picnic pavilions
 - Restrooms
 - Fencing and lighting.
- The NPS will also use this funding for the design of the Anacostia Park Skating Pavilion rehabilitation and plans to seek additional funding for the full rehabilitation.
- \$25 million Rebuilding American Infrastructure with Sustainability and Equity (RAISE) grant awarded by U.S. Department of Transportation to a regional partnership investing in trails.
 - The funding will help complete the Anacostia Riverwalk Trail. With this funding, we can realize our vision of a fully connected, 28-mile Anacostia Riverwalk Trail.



OTHER ONGOING PROJECTS

<https://qr.link/xzauvj>



The concept plan takes into account other ongoing projects.

Projects

The following areas will be rehabilitated:

- Tennis Courts
- Playgrounds
- Picnic Areas
- Basketball Courts
- Restrooms

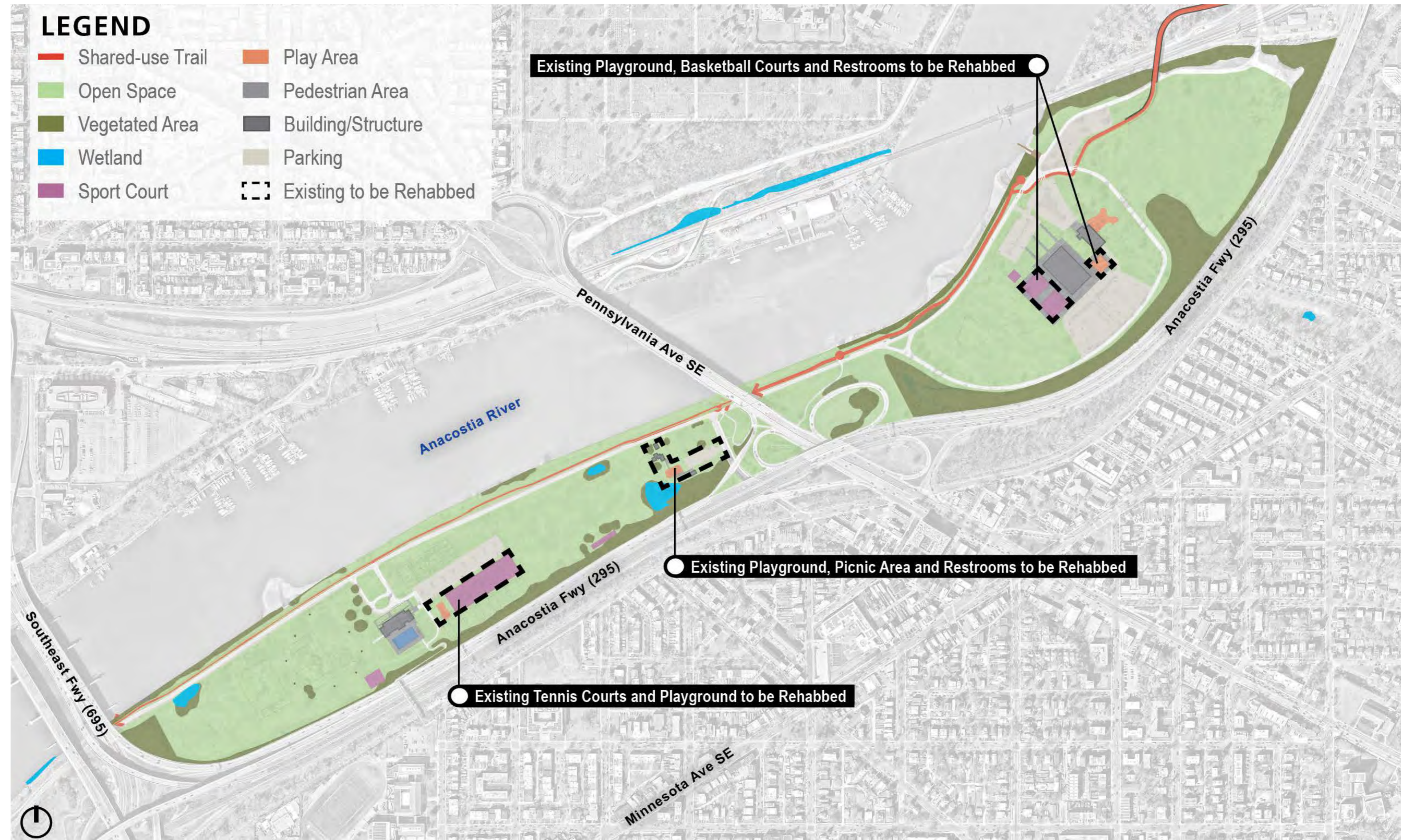

VISION STATEMENT

<https://qr.link/xzauvj>



This reimagined portion of Anacostia Park welcomes and inspires a wide range of users while providing opportunities to connect with others and engage with the Anacostia River. The site's nationally significant natural, cultural, and recreational resources are part of daily life in Washington, D.C., and promote community wellbeing. The park is resilient, safe, and well-maintained with strong connections to communities, partners, and the river ecosystem. Park users feel a sense of belonging and therefore value the park, engage in its programming and serve as active stewards of its future.



PROJECT GOALS

<https://qr.link/xzauvj>



ACTIVE RECREATION

Restore and improve the active recreation fields and other organized sport amenities within the project area.



COMMUNITY FELLOWSHIP

Increase the quality and quantity of passive recreation opportunities within the project area, focused on social, cultural, and community gathering spaces and hosting events.



WATERFRONT ACTIVATION

Enhance the visitor experience and connectivity to and from the Anacostia River by celebrating the site's history, ecology, and restoration efforts through educational and recreational opportunities.



ACCESS & CONNECTIVITY

Improve the safety, accessibility, and directness to the project area from neighboring communities, and within the park between activity nodes and park areas.



ACTIVE RECREATION

GOAL: Restore and improve the active recreation fields and other organized sport amenities within the project area.

ACTIVE RECREATION

<https://qr.link/xzauvj>



Early comments show visitors want to play in the park differently:

- Enhance, renovate, and/or expand court sports in the park
- Include space for lawn games like horseshoes, bocce ball, etc.
- Keep basketball courts visible (not at the back of the park)
- Repair & update soccer & football fields
- Update tennis courts
- Add a pickleball court
- Renovate skate pavilion to allow for beginners to skate safely
- Provide parking adjacent to recreation fields and courts
- Preserve as much grass as possible

ACTIVE RECREATION

<https://qr.link/xzauvj>



What in your view offers the best mix of playing fields, sport courts, and other amenities for active recreation?

The Park is considering improving and adding to active recreation options in the park.

CONSIDERATIONS:

- Some fields that flood or have soggy soils might benefit from adding drainage and/or relocating them to drier areas of the park.
- Some active recreation can be noisy and might interfere with contemplative areas.
- Locating active recreation near community fellowship spaces offers the opportunity for people to enjoy watching the game.

HOW THIS MIGHT CHANGE YOUR PARK EXPERIENCE:

- Park visitors would see improvements to active recreation spaces like sports fields.
- Park visitors would have more options and varieties of recreational experiences for active recreation with friends and family at the park.
- Locations of existing sports fields may be relocated to more suitable areas of the park.



ACTIVE RECREATION

<https://qr.link/xzauvj>



ACTIVE RECREATION

<https://qr.link/xzauvj>



POTENTIAL OPTION 1

- NO IMPACT TO EXISTING ROADWAY OR PARKING
- NO IMPACT TO EXISTING WATERFRONT ACCESS
- OPPORTUNITY FOR LARGE COMMUNITY SPACES AT NORTH FIELD
- REMOVES A LARGE FIELD AREA BUT MAINTAINS 3 LARGE FIELD AREAS CLOSEST TO PARKING



POTENTIAL OPTION 2

- RELOCATES LOOP ROAD NEAR SKATE PAVILION, BUT NO IMPACT TO EXISTING PARKING
- NO IMPACT TO EXISTING WATERFRONT ACCESS
- OPPORTUNITY FOR LARGE COMMUNITY SPACES ALONG WATERFRONT AND AT REC CENTER
- REMOVES A LARGE FIELD AREA BUT MAINTAINS 3 LARGE FIELD AREAS



POTENTIAL OPTION 3

- MIGHT REQUIRE ROADWAY AND SOME PARKING AREAS TO MOVE
- NO IMPACT TO EXISTING WATERFRONT ACCESS
- OPPORTUNITY FOR LARGE COMMUNITY SPACES ALONG WATERFRONT AND AT PENN. AVE.
- CREATES 4 LARGE FIELD AREAS





COMMUNITY FELLOWSHIP

GOAL: Increase the quality and quantity of passive recreation opportunities within the project area, focused on social, cultural, and community gathering spaces and hosting events.

COMMUNITY FELLOWSHIP

<https://qr.link/xzauvj>



Early comments show that park visitors want to enjoy the park differently:

- 
- Preserve & teach the river's history & ties to the community
 - Provide educational signage
 - Create outdoor classrooms
 - Offer more places to sit and rest in the park
 - Plant more trees for shade in the park
 - Provide space to be in nature (peace & quiet desired)
 - Provide more covered spaces like pavilions
 - Offer indoor, air-conditioned spaces
 - Build an amphitheater or pavilion for performances & meetings
 - Offer more flexible-use spaces
 - Install public art, especially sculptures
 - Offer opportunities for local concessions
 - Dedicate spots to empty coals
 - Provide spaces that can be reserved
 - Provide places to refill water bottles
 - Provide more picnic shelters and BBQ grill areas
 - Provide a space for community gardens
 - Provide additional play areas for all age groups

COMMUNITY FELLOWSHIP

<https://qr.link/xzauvj>



How can we improve opportunities for social, cultural, community gatherings and events?

The Park is considering improving community fellowship spaces in the park and adding new ones for the community to enjoy. Examples include: picnic pavilions, an amphitheater area, gathering areas, outdoor classrooms, event lawns, and rest areas.

CONSIDERATIONS:

- Community spaces can be scattered throughout the park or grouped together.
- Improvements like lighting, shade, and access are all being considered.
- An amphitheater will be part of the 11th St Bridge project; however, there is room for a second amphitheater in the park.

HOW THIS MIGHT CHANGE YOUR PARK EXPERIENCE:

- Park visitors would see improvements to existing community gathering spaces.
- Park visitors would have more opportunities for gathering with friends and family at the park.
- Existing community areas may be relocated to provide larger spaces and better access.



COMMUNITY FELLOWSHIP

<https://qr.link/xzauvj>



LARGE PICNIC
PAVILIONS



SMALL PICNIC
PAVILIONS



PLAYGROUND



AMPHITHEATER /
STAGE AREAS



INTIMATE
GATHERING
AREAS



OUTDOOR
CLASSROOM



WATERFRONT
GATHERING
AREA



EVENT
LAWN



SHADED
REST AREAS

COMMUNITY FELLOWSHIP

<https://qr.link/xzauvj>



POTENTIAL OPTION 1

- MIGHT REQUIRE NEW ROADWAYS AND REMOVES PARKING NEAR FRONT OF SKATE PAVILION
- NO IMPACT TO EXISTING WATER ACCESS
- PROVIDES A VARIETY OF COMMUNITY GATHERING AREAS THROUGHOUT THE PARK
- REMOVES A LARGE FIELD AREA BUT MAINTAINS 3 LARGE FIELD AREAS CLOSEST TO PARKING

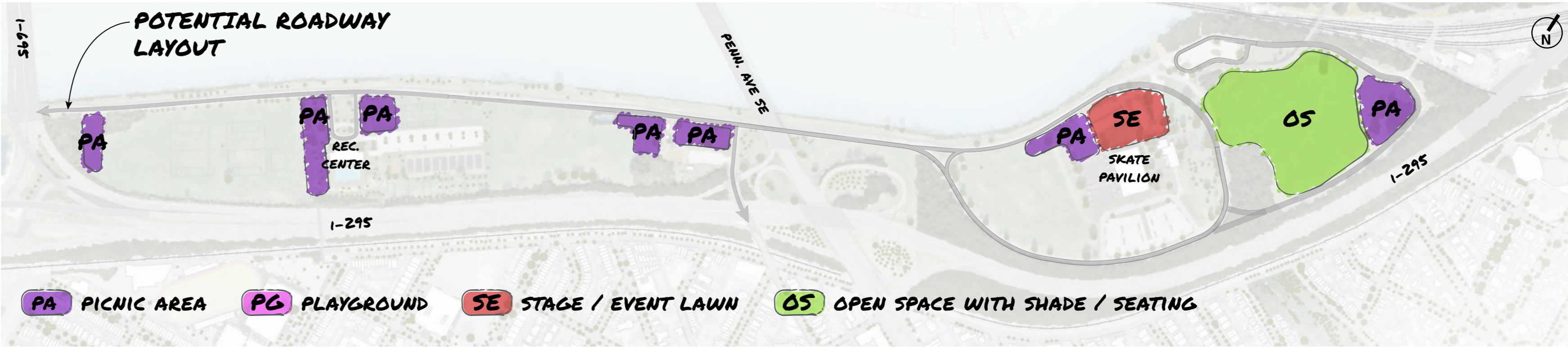

POTENTIAL OPTION 2

- REQUIRES THE ROADWAY TO SHIFT NEAR REC. CENTER AND REMOVES PARKING NEAR SKATE PAVILION
- CREATES OPPORTUNITY FOR COMMUNITY WATERFRONT SPACES NEAR REC. CENTER
- OPPORTUNITY FOR LARGE COMMUNITY SPACES NEAR REC. CENTER AND SKATE PAVILION
- REMOVES A LARGE FIELD AREA BUT MAINTAINS 3 LARGE FIELD AREAS

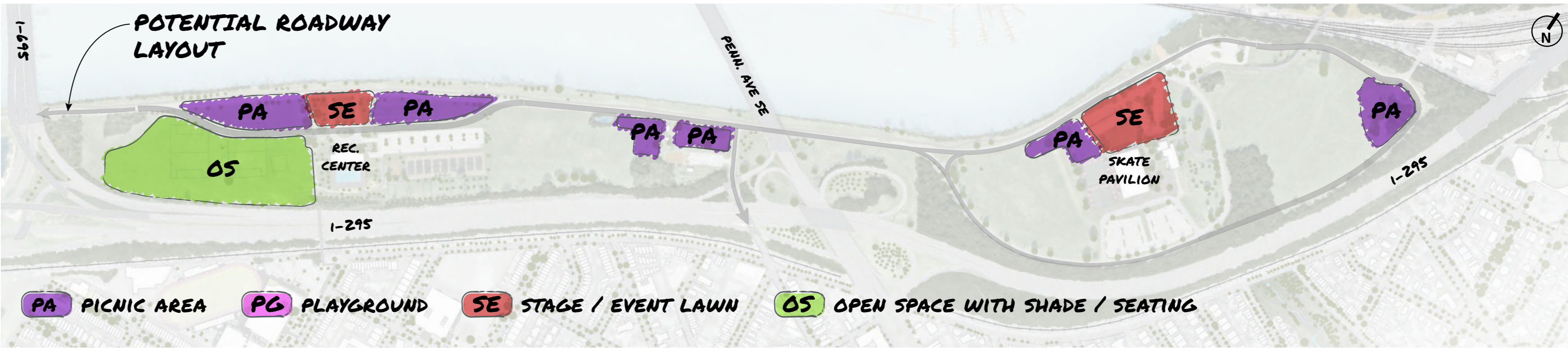

POTENTIAL OPTION 3

- ROADWAY AND PARKING WOULD NEED TO BE RELOCATED IN SOME AREAS OF THE PARK
- PROVIDES WATERFRONT ACCESS AT THE REC CENTER AND IN FRONT OF THE SKATE PAVILION
- CREATES OPPORTUNITIES FOR COMMUNITY GATHERING ALONG THE WATERFRONT
- REMOVES A SMALL FIELD AREA BUT MAINTAINS 3 LARGE FIELD AREAS

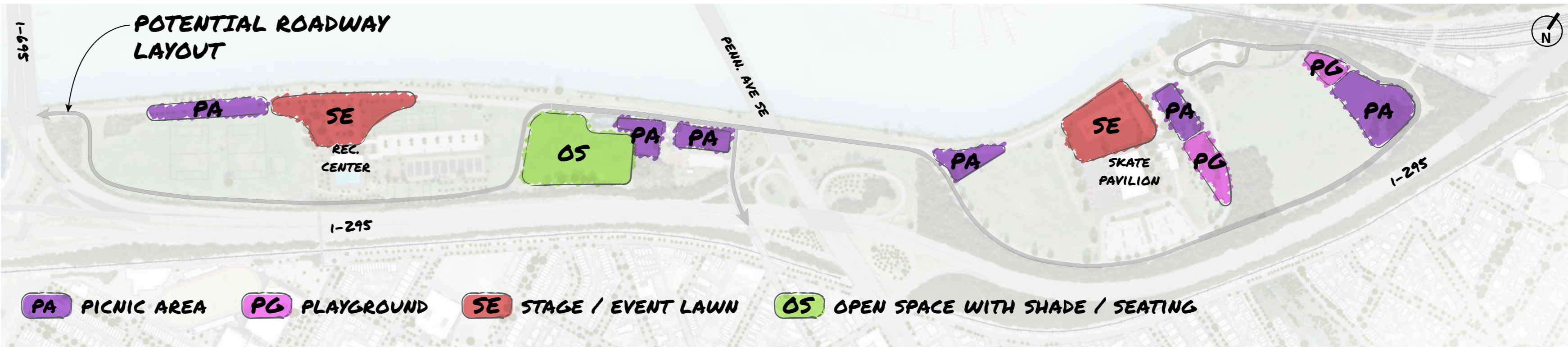

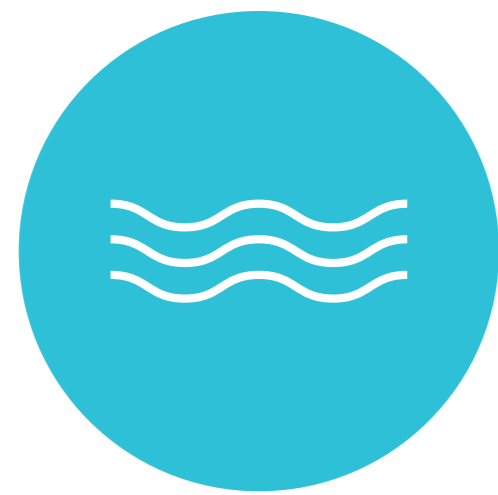

WATERFRONT ACTIVATION

GOAL: Enhance the visitor experience and connectivity to and from the Anacostia River by celebrating the site's history, ecology, and restoration efforts through educational and recreational opportunities.

WATERFRONT ACTIVATION

<https://qr.link/xzauvj>



Early comments show park visitors want to engage with the river differently:

- Provide additional boat launches
- Provide kayak / paddle-board launches
- Provide fishing piers
- Restore and preserve wetlands
- Create a living shoreline
- Preserve & teach the river's history and ties to the community
- Renovate seawall
- Remove seawall
- Transform excess fields into wetlands
- Daylight underground stream
- Provide more space to be in nature
- Provide a river pool
- Provide more places to sit & rest near the river
- Expand trails so that bicyclists are separated from walkers
- Widen the Anacostia River Trail

WATERFRONT ACTIVATION

<https://qr.link/xzauvj>



Would you prefer a natural shoreline, the historic seawall, or a combination of both?

The park is considering options for the waterfront edge that might include a natural shoreline and repairing and replacing portions of the historic seawall.

CONSIDERATIONS:

- Both natural shorelines and seawalls can provide recreational access to the water, including fishing, wading, and kayak/canoe launch points
- Both natural shorelines and seawalls can provide flood protection and stormwater management for the park
- Natural shorelines offer educational opportunities to learn about native landscapes, wildlife, and ecologies
- The seawall is a character-defining feature of the park's cultural landscape
- The road and trail could follow a natural shoreline, though in some locations, the road or trail might need to move inland to accommodate the design of naturalized shoreline conditions (depending on site-specific conditions)
- The seawall could be repaired to its original condition or could be rehabilitated to a higher elevation in response to sea level rise

HOW THIS MIGHT CHANGE YOUR PARK EXPERIENCE:

- The visual character of the waterfront could vary greatly, depending on the waterfront treatment. For example, a seawall would be a hardened (human-made) edge to the river while a natural shoreline would have a softer edge with more vegetation.

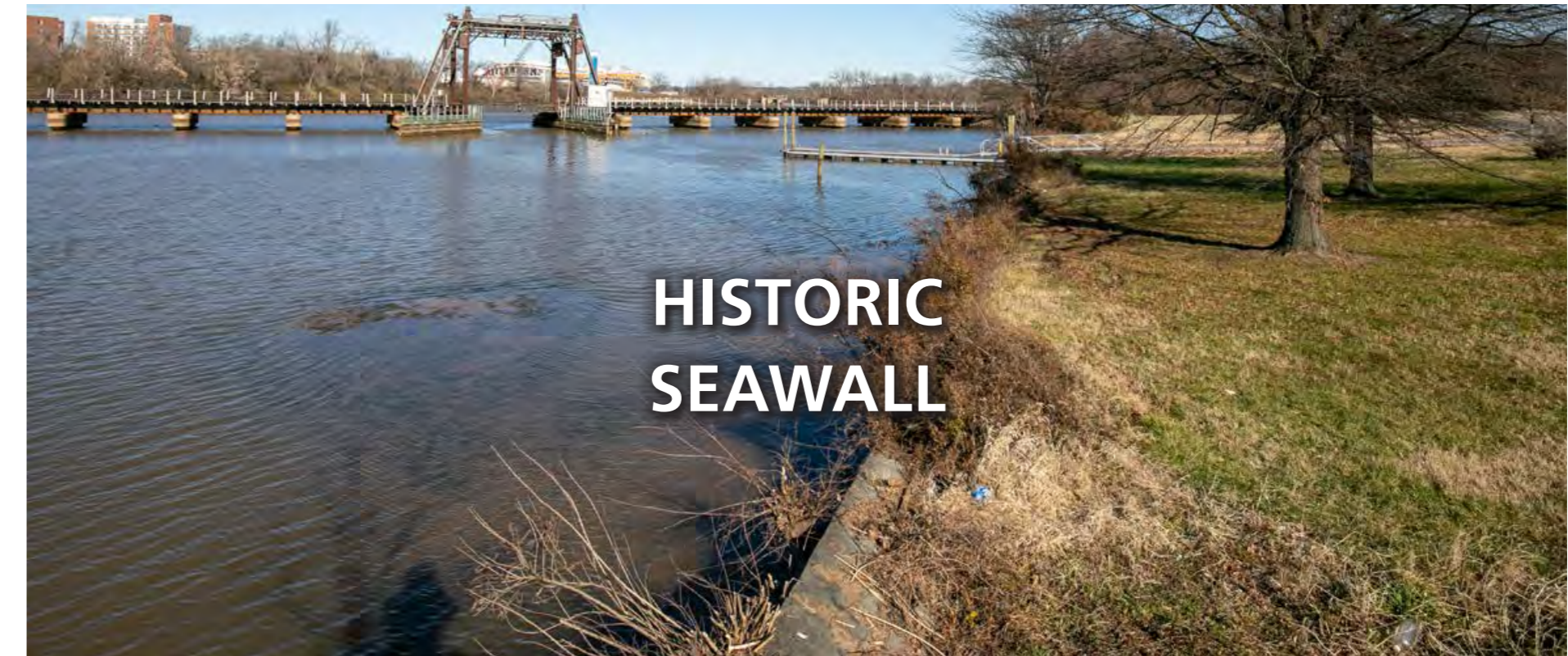

**HISTORIC
SEAWALL**

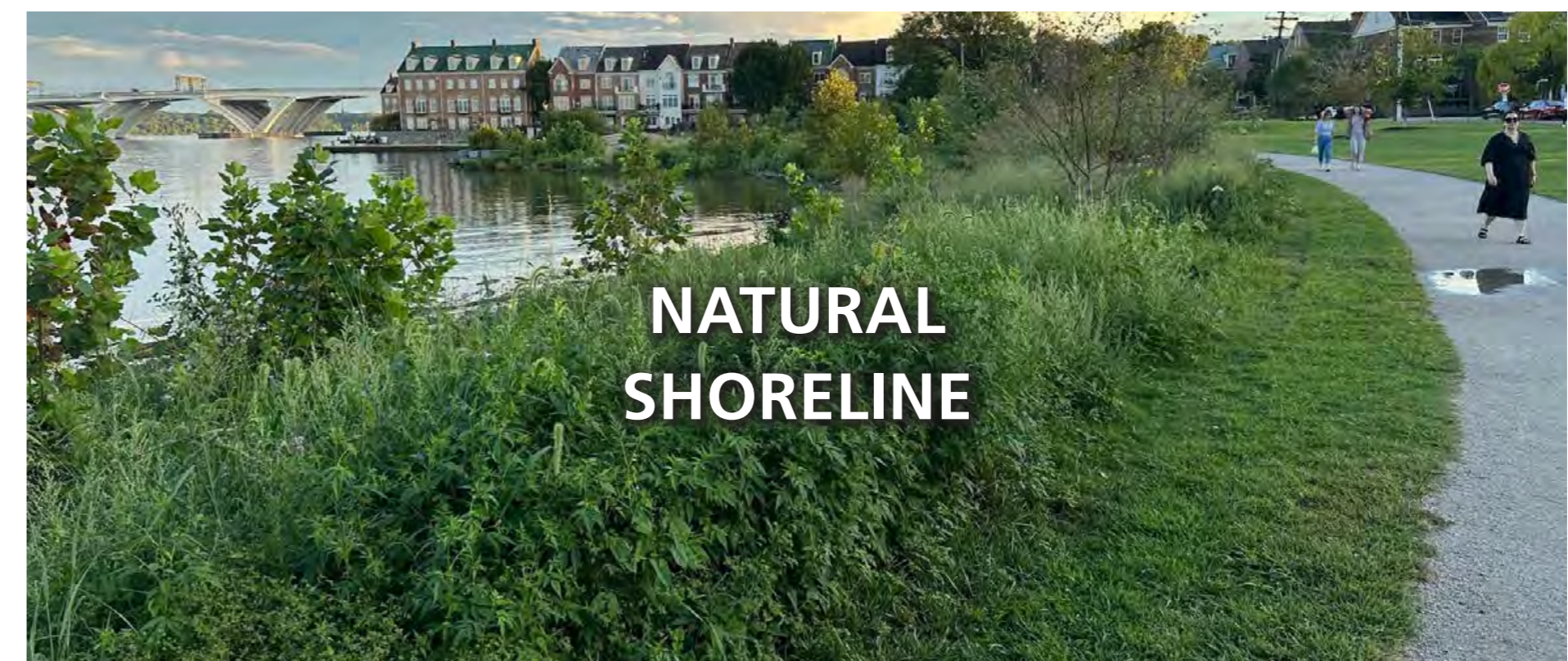

**NATURAL
SHORELINE**



**NATURAL
SHORELINE**

WATERFRONT ACTIVATION

<https://qr.link/xzauvj>



POTENTIAL OPTION 1

-  NO CHANGES TO TRAIL OR ROADWAY
-  SHORELINE GENERALLY REMAINS AS-IS
-  NO IMPACTS TO COMMUNITY FELLOWSHIP
-  NO IMPACTS TO ACTIVE RECREATION

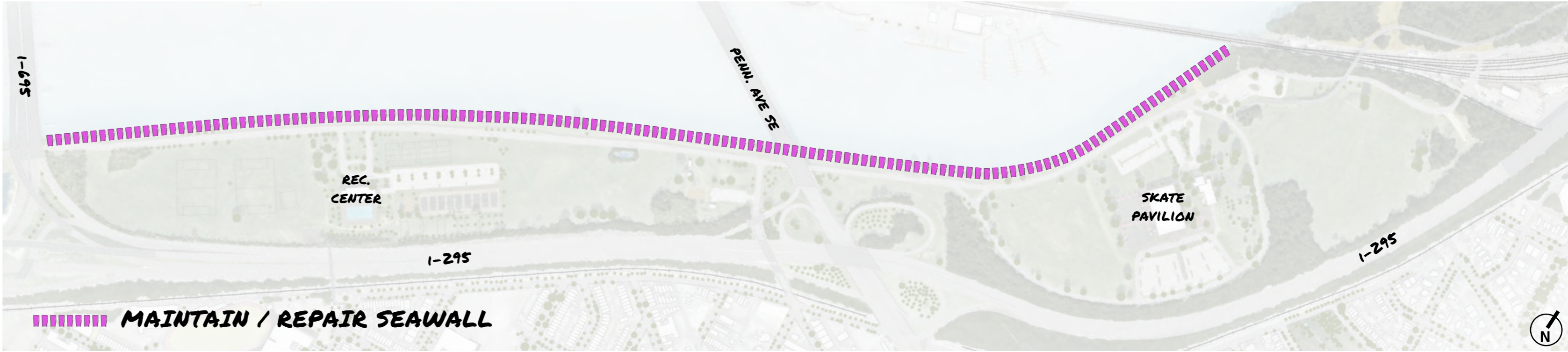

POTENTIAL OPTION 2

-  ROADWAY MAY NEED TO MOVE NEAR REC. CENTER TO MAKE SPACE FOR NATURAL SHORELINE
-  OPPORTUNITY FOR EXPANDED BOAT RAMP AREA AND NEW PIERS NEAR REC. CENTER
-  OPPORTUNITY FOR NEW WATERFRONT COMMUNITY SPACES NEAR REC. CENTER
-  SLIGHT CHANGES NEEDED TO MAKE ROOM FOR NEW WATERFRONT SPACES NEAR REC. CENTER



POTENTIAL OPTION 3

-  ROADWAY MIGHT NEED TO MOVE ALONG PARTS OF THE WATERFRONT
-  PROVIDES OPPORTUNITY FOR WATERFRONT GATHERING AREAS AND ACCESS THROUGHOUT PARK
-  CREATES MANY OPPORTUNITIES FOR COMMUNITY SPACES ALONG THE WATERFRONT
-  CHANGES NEEDED TO MAKE ROOM FOR NEW WATERFRONT SPACES



WATERFRONT ACTIVATION

<https://qr.link/xzauvj>



Would you like to enhance existing wetlands and introduce new, nature-based stormwater facilities to help with flooding?

The park is considering restoring the existing wetlands on site and introducing additional nature-based stormwater facilities in low areas of the park that are prone to flooding.

CONSIDERATIONS:

- Enhanced wetlands and new stormwater facilities could create recreation opportunities for additional walking trails, seating areas, and natural play areas
- These facilities provide natural flood protection and stormwater management for the park
- These facilities are habitat for wildlife
- These facilities help to keep sports fields dry
- Space from existing sports fields may need to be used, which might require relocating some of the fields

HOW THIS MIGHT CHANGE YOUR PARK EXPERIENCE:

- Park visitors would notice drier grass areas for the sports fields
- Existing sport field locations may change and minor impacts to existing picnic table areas. These areas would be replaced and relocated nearby

RESTORE EXISTING WETLANDS

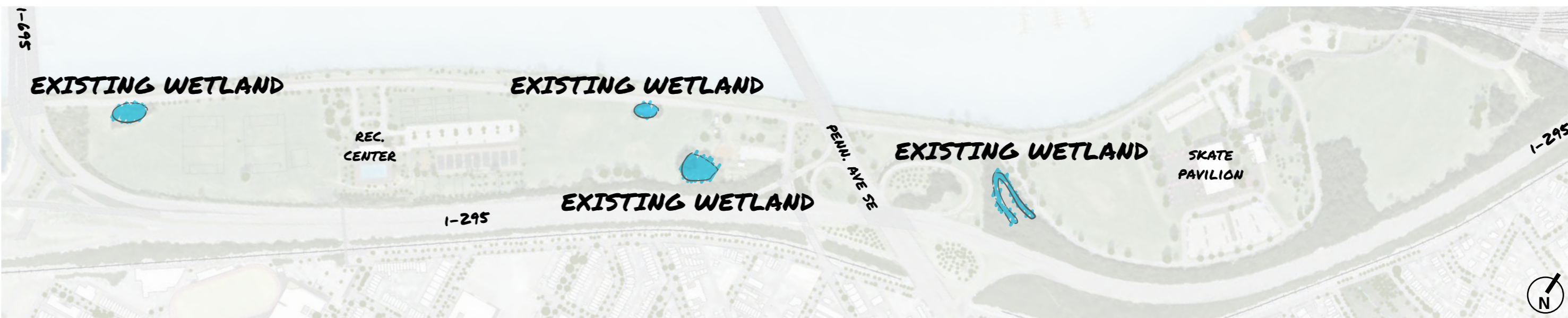

RESTORE AND EXPAND EXISTING WETLANDS AND INTRODUCE NEW WETLANDS IN KEY AREAS

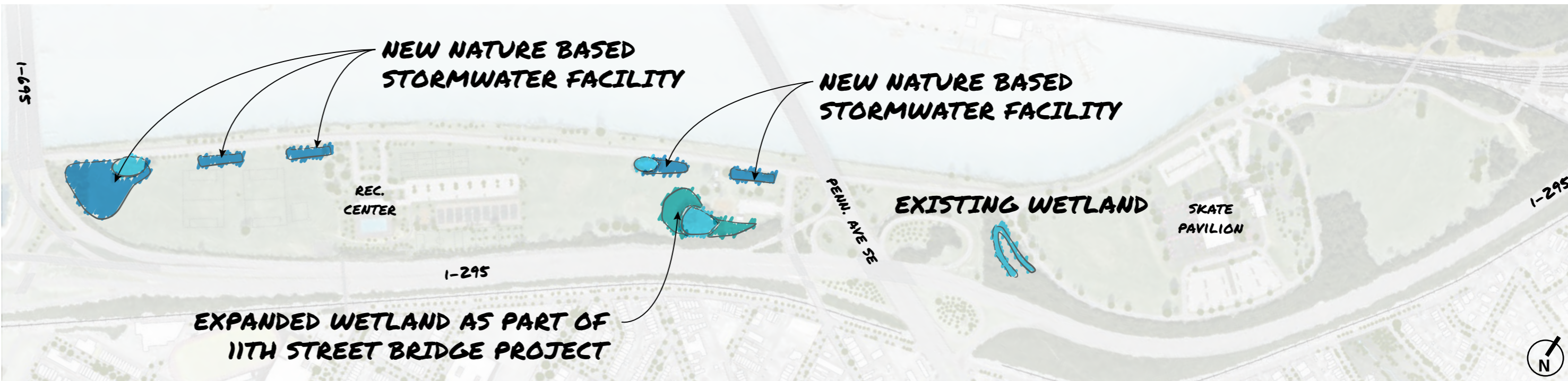

FLOOD RISK AREAS



EDUCATION OPPORTUNITIES



ADDITIONAL WALKING TRAILS

WATERFRONT ACTIVATION

<https://qr.link/xzauvj>



What experiences on or by the water are important to you?

The park is considering enhancing the existing dock and boat ramp and maybe adding additional docks or piers to the park.

CONSIDERATIONS:

- Piers and boat ramps offer direct access to the water.
- Some activities benefit from different kinds of water access (for example: piers, seawalls, and natural shorelines all provide different fishing experiences).
- Additional piers and/or trails create stronger connections to the water.
- Parts of Anacostia Drive and the Anacostia River Trail might move in some locations to make space for new waterfront activities

HOW THIS MIGHT CHANGE YOUR PARK EXPERIENCE:

- With additional piers and/or boat ramps, park visitors would have more recreation options along the river.
- Some parking along the river might be removed.
- Expanding the boat ramp provides an opportunity to relocate and expand the Aquatic Resources Education Center (AREC) to be closer to the river.

REHAB EXISTING BOAT LAUNCH AND PIER



REHAB EXISTING BOAT LAUNCH AND PIER ADD NEW WATER ACCESS POINT NEAR REC CENTER



REIMAGINE EXISTING BOAT RAMP AREA AND ADD WATER ACCESS NEAR REC CENTER AND UNDER BRIDGE

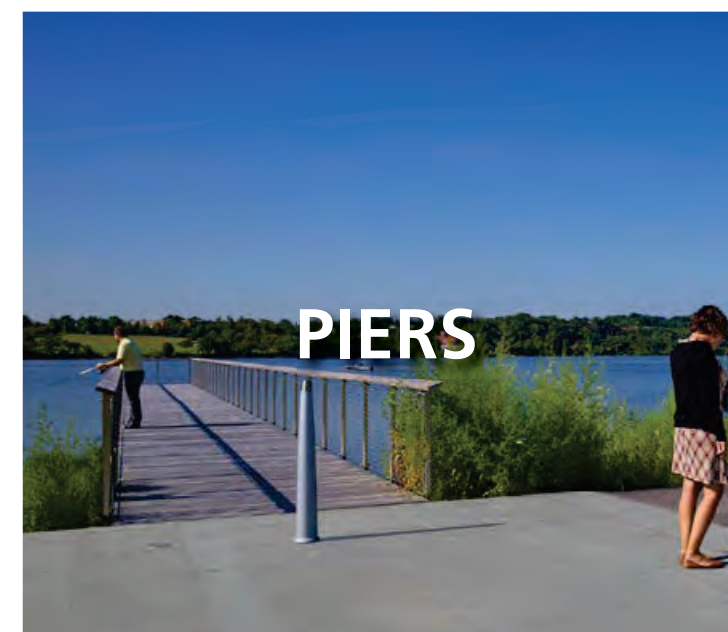
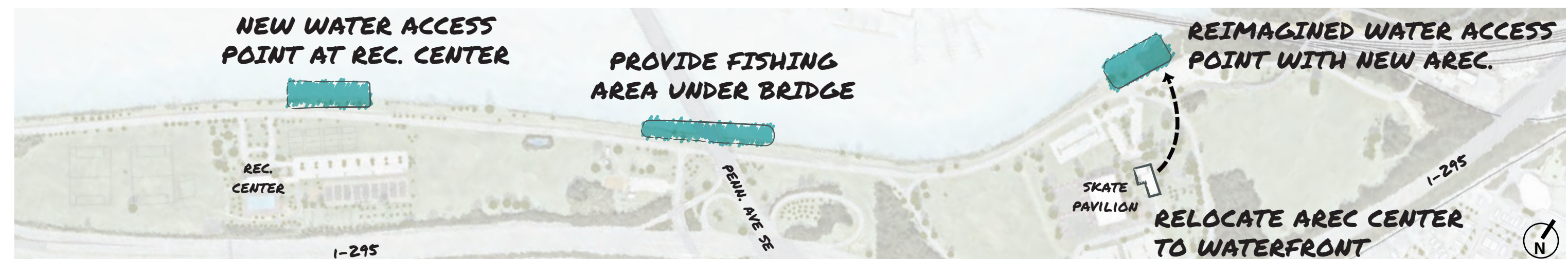

WATERFRONT ACTIVATION

<https://qr.link/xzauvj>



Would you like to see Pope Branch Stream flow through your park?

Pope Branch is currently hidden beneath Anacostia Park in a pipe. Daylighting would reveal the Pope Branch Stream once again through a naturalized corridor, providing new wildlife habitat, educational opportunities, and improved stormwater and flood management.

CONSIDERATIONS:

- Daylighting the stream creates recreation opportunities for additional walking trails, seating areas, natural play areas, and community spaces next to the stream.
- Daylighting the stream creates additional habitat for wildlife
- The park could add educational opportunities to learn about the value of urban streams.
- Some open lawn area around the Anacostia Resources Education Center (AREC) would be changed to the stream

HOW THIS MIGHT CHANGE YOUR PARK EXPERIENCE:

- Park visitors would notice slightly less lawn area and more natural habitat for birds and other wildlife to enjoy.
- Park visitors would get to experience a small, urban stream and a large, urban river.

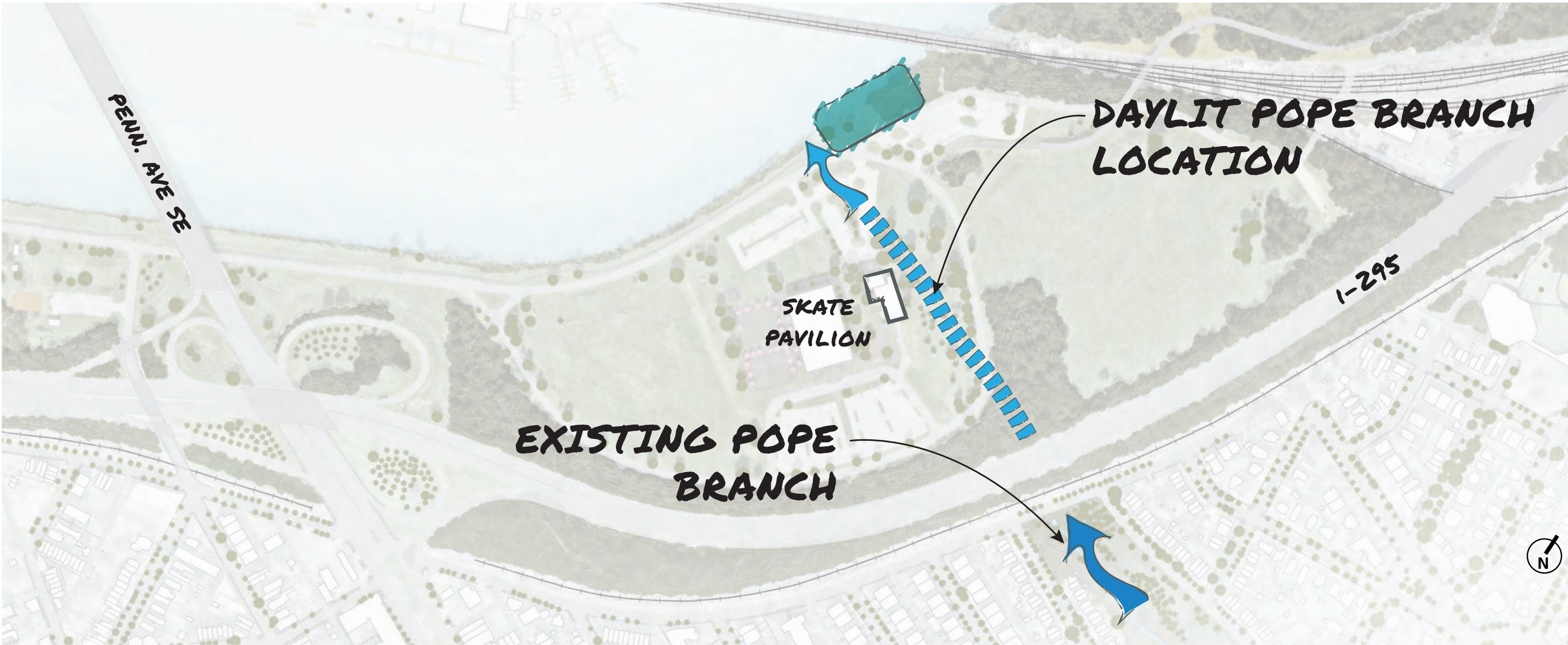



ACCESS & CONNECTIVITY

GOAL: Improve the safety, accessibility, and directness to the project area from neighboring communities and within the park between activity nodes and park areas.

ACCESS & CONNECTIVITY

<https://qr.link/xzauvj>



Early comments show people want to access the park in different ways:

- Add signage announcing you're entering a national park
- Install more streetlamps along trails, especially under the overpasses
- Create a fully accessible park
- Provide easy access for vehicles
- Repair Good Hope Road at the railroad tracks
- Provide an internal transportation system like a trolley
- Provide a safe access point from the Arboretum
- Add additional pedestrian bridges or tunnels to cross I-295
- Enhance and/or increase entrance portals
- Provide parking adjacent to the recreation fields & courts
- Remove some parking
- Increase parking
- Disperse parking
- Add additional parking under the Sousa Bridge
- Keep Anacostia Drive in current location
- Relocate parts of Anacostia Drive

ACCESS & CONNECTIVITY

<https://qr.link/xzauvj>



What specific improvements would you like to see around access? What is your experience getting to different features of the park? What would you like to have better access to?

There are two pedestrian access points that connect to the local neighborhoods, which forces many people in the surrounding area to have to drive to the park. The few access points that exist today have poor infrastructure for people walking or biking and can make the experience of entering the park uncomfortable.

CONSIDERATIONS:

- Improving sidewalks and lighting promotes pedestrian safety and universal accessibility when entering the park from sidewalks and trails.
- Additional signage will help visitors navigate the park easier
- Opportunity for additional access points for bicycles and walkers with stronger links to the surrounding communities.
- Coordination with other government authorities will be needed to make updates to entrance areas not owned by the Park.

HOW THIS MIGHT CHANGE YOUR PARK EXPERIENCE:

- Park visitors would have more options for how they want to access the park, whether by foot, bicycle, or vehicle.
- Park visitors would be able to navigate the park more easily with landmarks and way-finding signage.

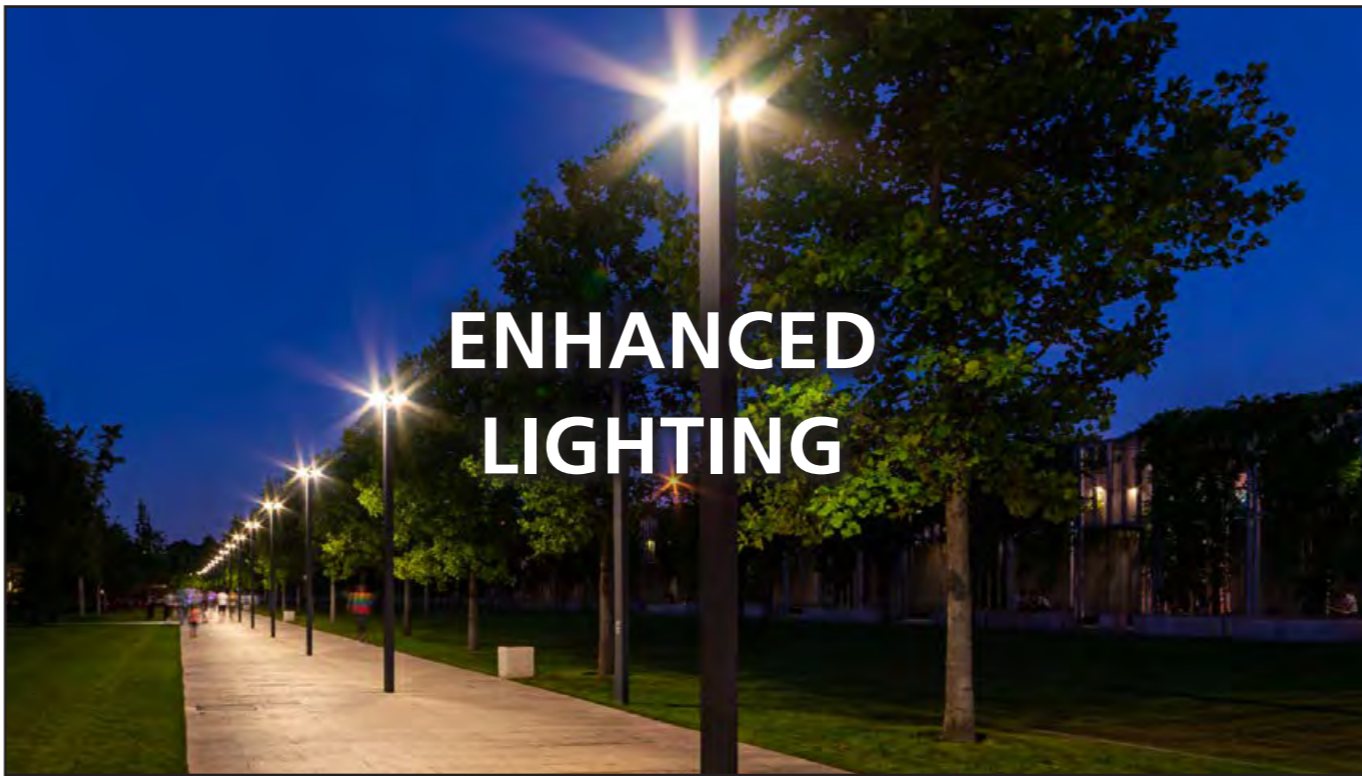

ACCESS & CONNECTIVITY

EXISTING ENTRANCES

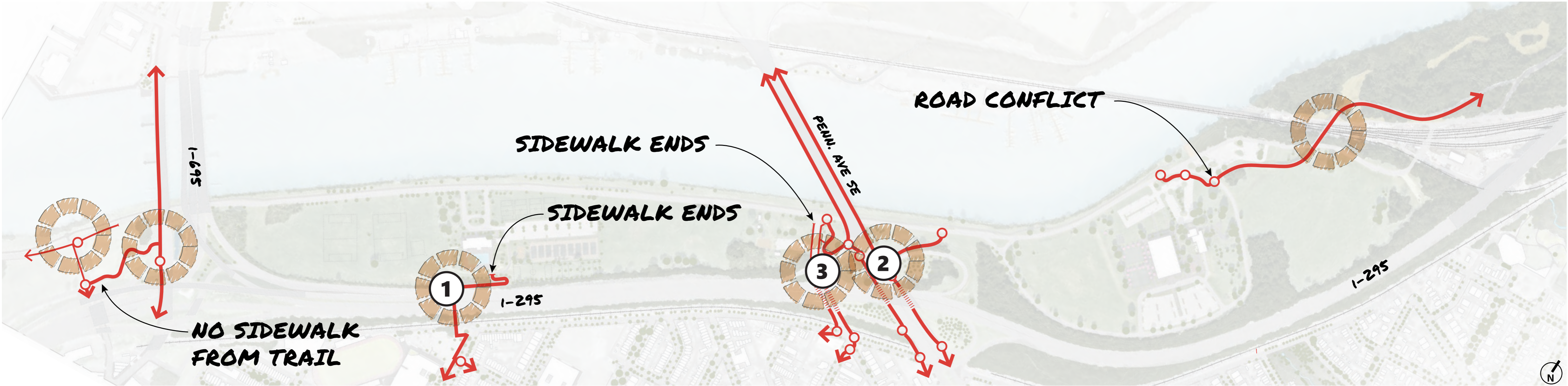

Deteriorated infrastructure | Steep ramps | No sidewalk connection inside park



Minimal signage | Overgrown landscaping | Poor lighting



Narrow sidewalks | Poor lighting | Harsh infrastructure

ACCESS & CONNECTIVITY

<https://qr.link/xzauvj>



POTENTIAL IMPROVEMENTS AT EXISTING ENTRANCES AND POTENTIAL NEW ENTRANCE LOCATIONS

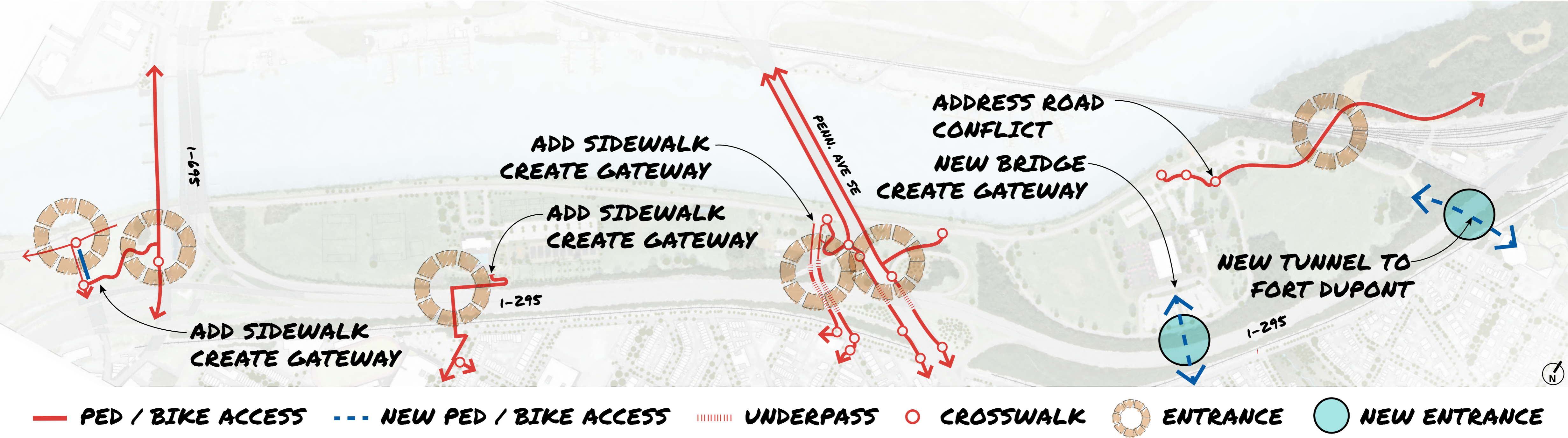

EXAMPLES OF PARK GATEWAYS



ACCESS & CONNECTIVITY

<https://qr.link/xzauvj>



Would you prefer to keep Anacostia Drive in its existing location or locate it away from the river for portions of the park?

The Park is considering realigning parts of Anacostia Drive. Currently, Anacostia Drive runs along the waterfront through the park. Moving the road would make space for waterfront activities and a natural shoreline and would provide vehicular access to more areas of the park.

CONSIDERATIONS:

- Moving parts of Anacostia Drive near or away from the river makes space for other waterfront activities and a natural shoreline.
- Keeping parts of Anacostia Drive near the river preserves vehicular parking and access to the water.
- Moving or adding parts of the road could help with pedestrian and biker safety by reducing crosswalks.

HOW THIS MIGHT CHANGE YOUR PARK EXPERIENCE:

- Moving parts of the road away from the river would provide more choices for waterfront activities for park visitors and provide closer vehicular access to other parts of the park.
- Keeping parts of the road near the river would preserve a park visitor's current riverfront experience.



ACCESS & CONNECTIVITY

<https://qr.link/xzauvj>



POTENTIAL OPTION 1

-  CONNECTION TO NEW TUNNEL ENTRANCE. REMOVES TRAIL CONFLICT
-  ROAD AND TRAIL USE WOULD REMAIN AS IS WITH AN UPDATED BOAT RAMP AREA
-  OPPORTUNITIES FOR PICNIC TABLES ALONG WATERFRONT AND NEW ROAD
-  NO IMPACTS TO EXISTING FIELDS. EASIER CONNECTIONS TO FIELDS WITH NEW ROAD

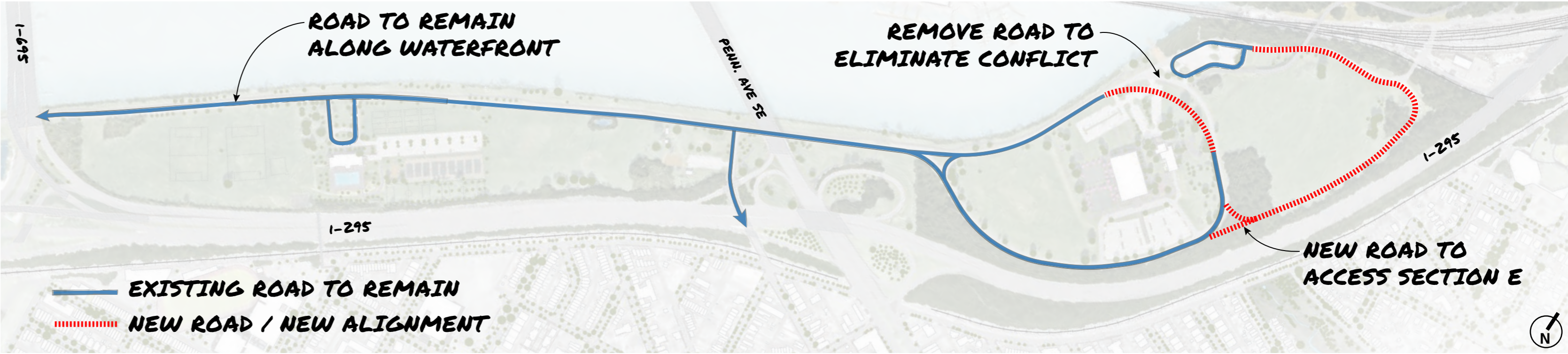

POTENTIAL OPTION 2

-  CONNECTION TO NEW TUNNEL ENTRANCE. DOES NOT REMOVE TRAIL CONFLICT
-  PROVIDES OPPORTUNITY FOR WATERFRONT ACCESS OUTSIDE OF REC. CENTER
-  OPPORTUNITIES FOR PICNIC TABLES ALONG WATERFRONT AND NEW ROAD
-  RELOCATE/SHIFT EXISTING FIELDS NEAR REC. CENTER. EASIER CONNECTIONS TO FIELDS WITH NEW ROAD

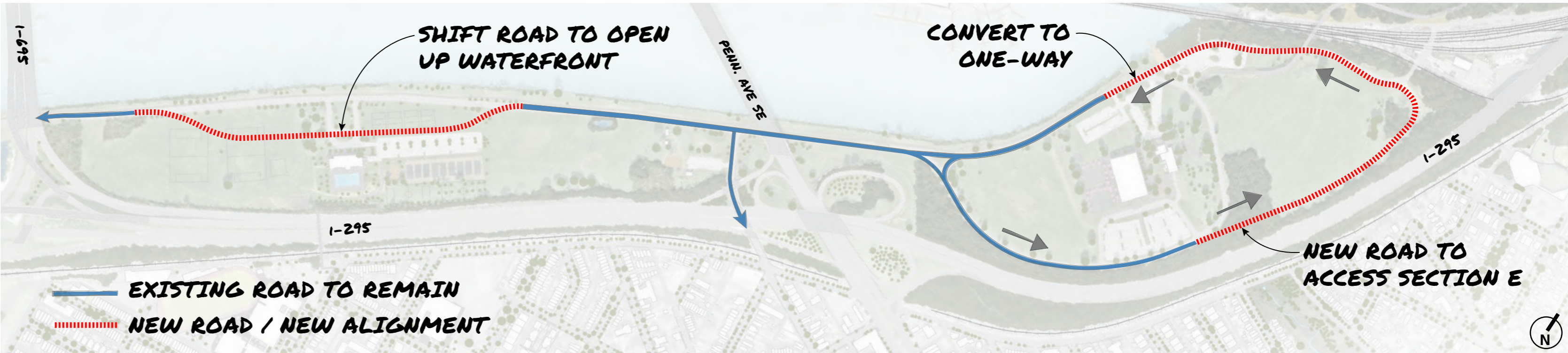

POTENTIAL OPTION 3

-  CONNECTION TO NEW TUNNEL ENTRANCE. REMOVES TRAIL CONFLICT
-  PROVIDES OPPORTUNITY FOR NUMEROUS WATERFRONT ACCESS AREAS THROUGHOUT PARK.
-  OPPORTUNITIES FOR PICNIC TABLES ALONG WATERFRONT AND NEW ROAD
-  MINIMAL IMPACT TO EXISTING FIELDS. EASIER CONNECTION TO FIELDS WITH NEW ROAD.

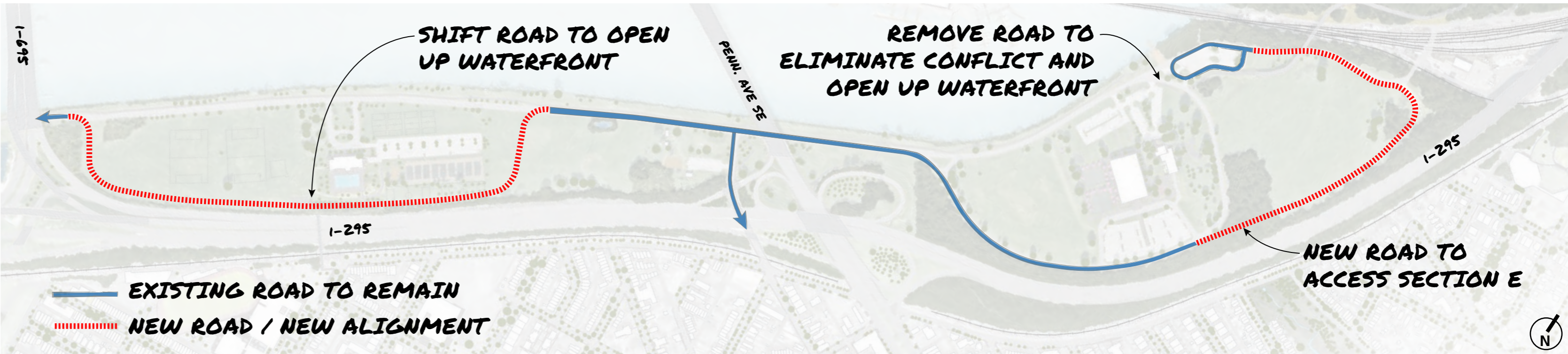

HOW TO PROVIDE COMMENTS ON PEPC

Please visit:

https://parkplanning.nps.gov/Reimagine_AnacostiaPark_PrelimDesign

Comments can be submitted to the Park via QR Code:



<https://qr.link/xzauvj>

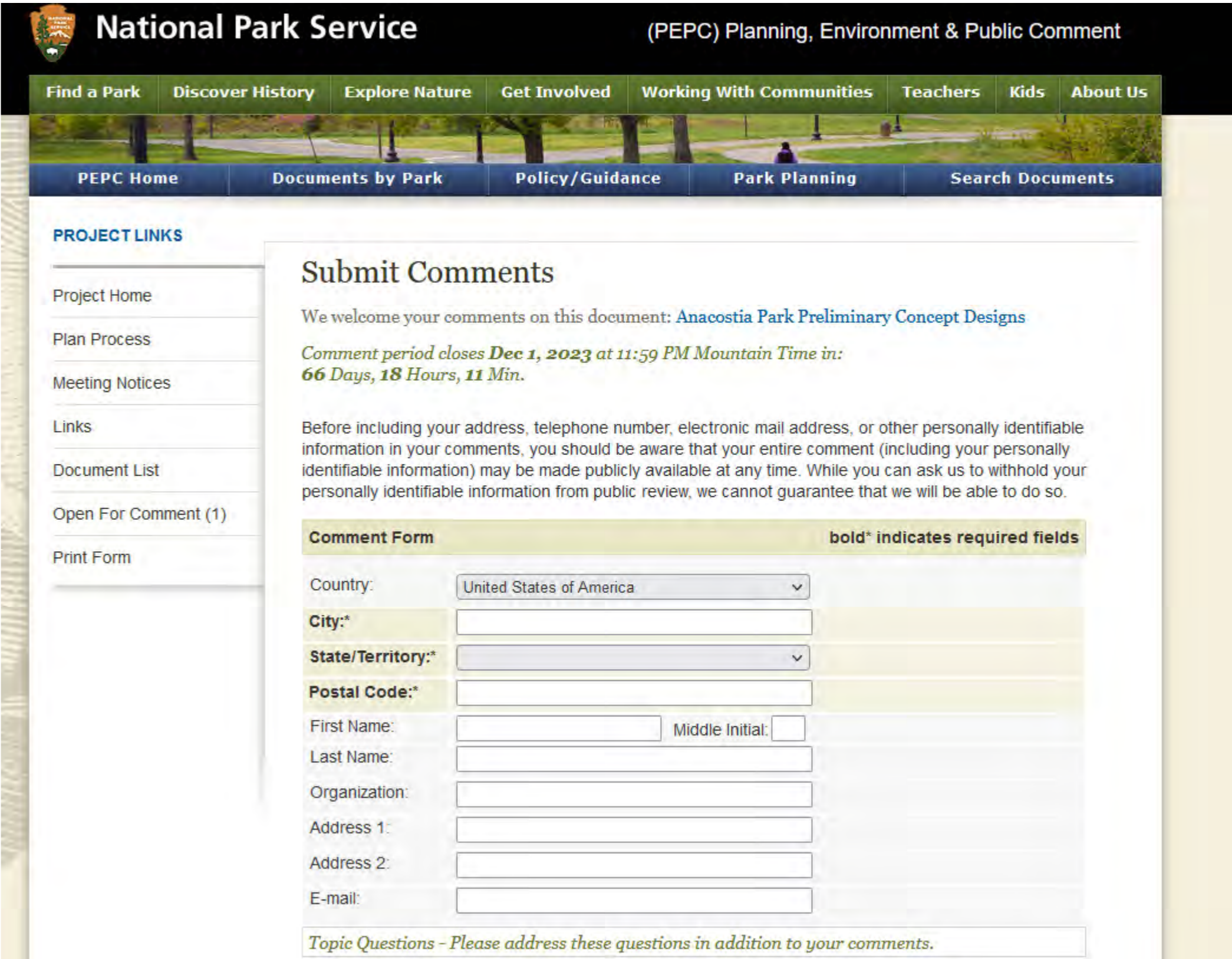
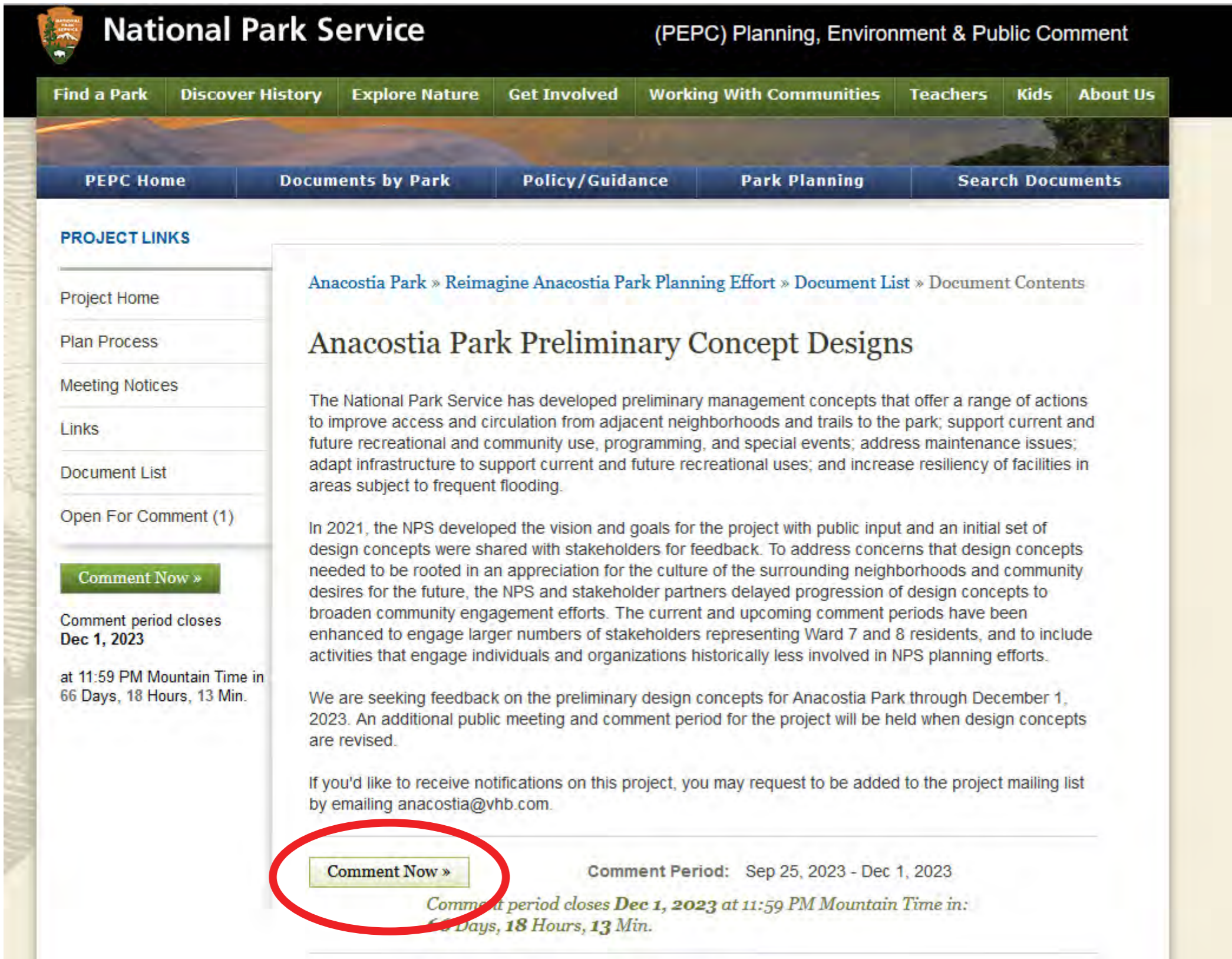

Step 1: Click “Comment Now”

Step 2: Fill Out the Form with Your Comments

THANK YOU FOR JOINING US!

<https://qr.link/xzauvj>



Upcoming events to learn more about the project:

- September 27 at 6 p.m. – [Development concept plan virtual meeting](#)
- September 30 at 3 to 7 p.m. – [Late Skate at Anacostia Park](#)
- October 14 at 11 a.m. to 4 p.m. – [Frederick Douglass Family Day](#) at Frederick Douglass National Historic Site located at 1411 W St SE, Washington, DC 20020
- October 28 at 3 p.m. to 7 p.m. – [Late Skate at Anacostia Park](#)

Next steps:

- 60 days for public comment period (September-December 1, 2023)
- NPS and the design team will use feedback to develop three concepts (late 2023-early 2024)
- The concepts will be presented to the public for review in summer 2024



THANK YOU FOR JOINING US!

<https://qr.link/xzauvj>



Q&A