



DAUGHTERS OF THE REPUBLIC OF TEXAS

LEGATION MEMORIAL
WASHINGTON, D. C.

NATIONAL CAPITAL MEMORIAL ADVISORY COMMISSION

DAUGHTERS OF THE REPUBLIC OF TEXAS

LEGATION MEMORIAL
WASHINGTON, D. C.

PROJECT OVERVIEW

DETAILED PROJECT INFORMATION AND DRAWINGS

VICINITY MAP

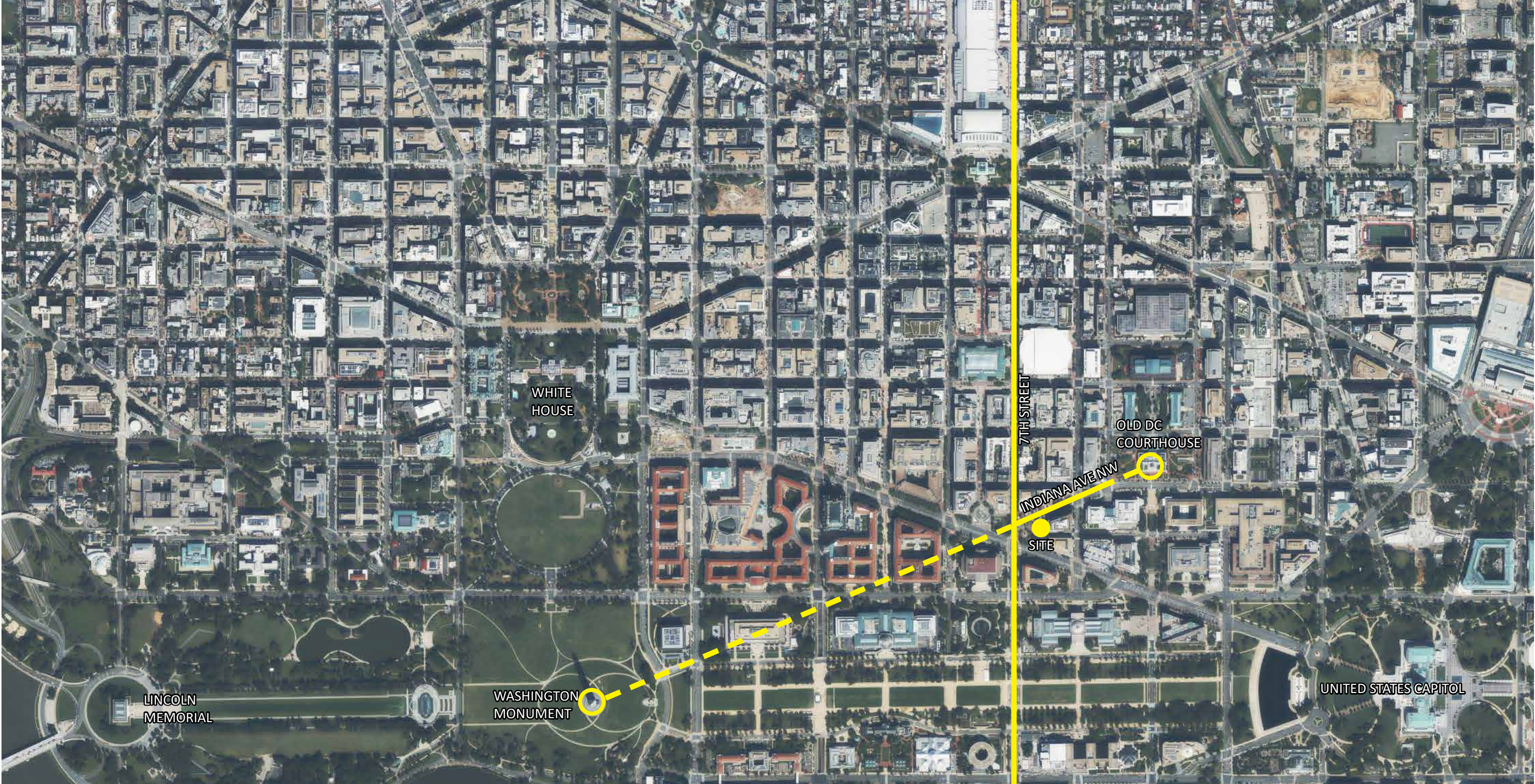

PROJECT OVERVIEW

PROJECT AREA

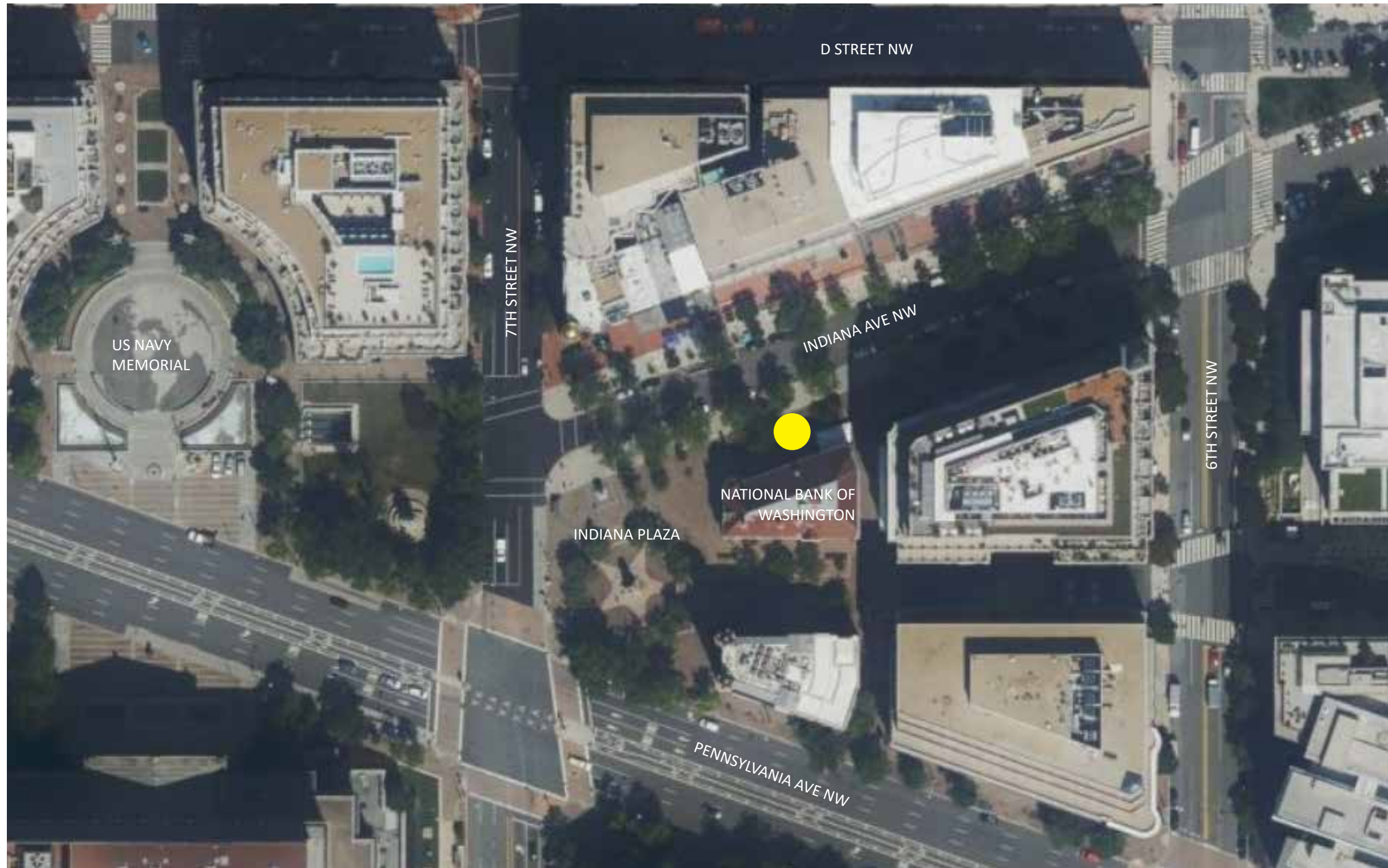

MEMORIAL SITE SELECTION

PROJECT OVERVIEW

PROJECT AREA

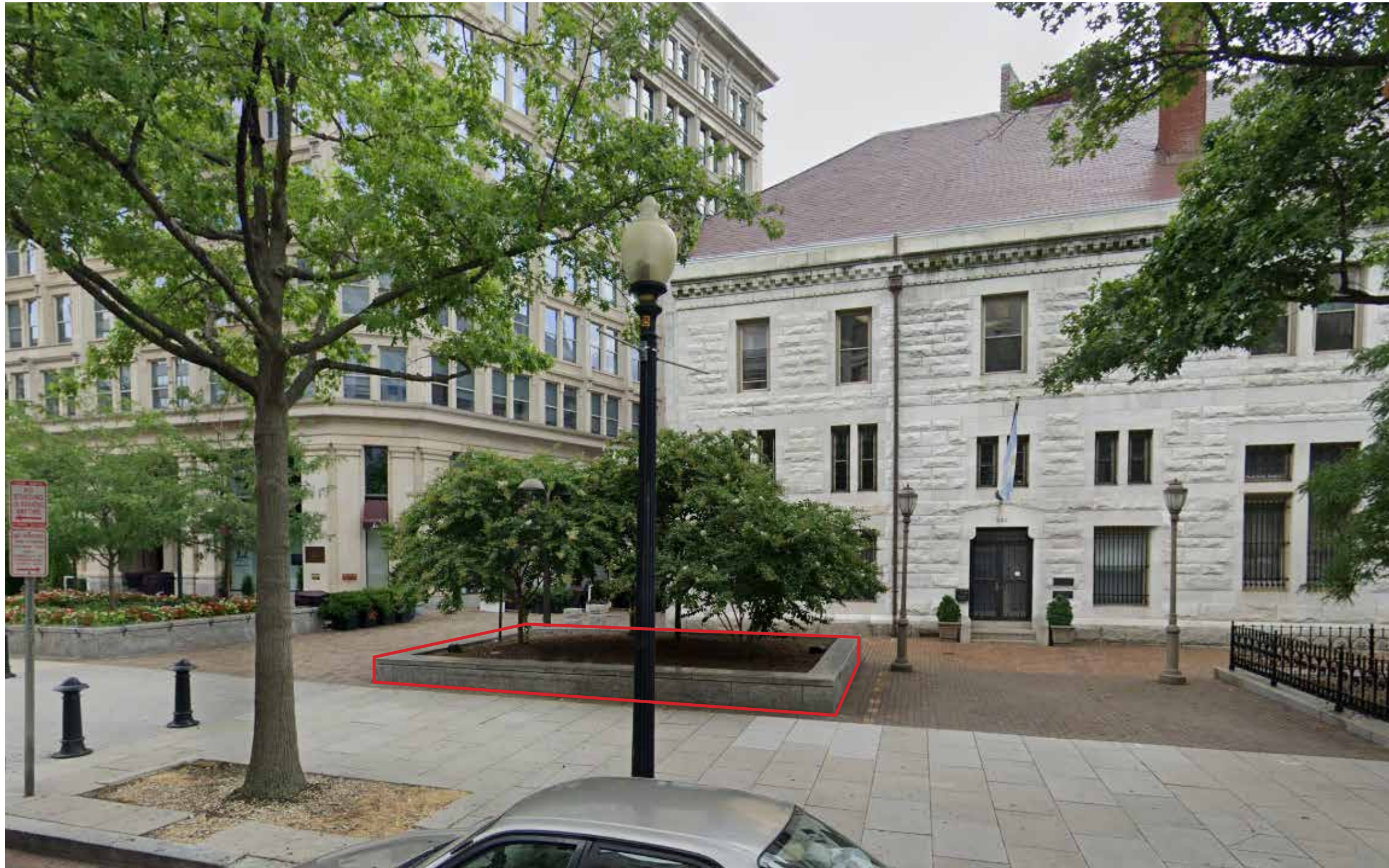

EXISTING CONDITIONS

The project site is an existing granite planter located on the southern side of Indiana Avenue NW, just north of the National Bank of Washington Building.

This site was carefully selected for the Texas Legation Memorial because of its location in relationship to historical sites pertaining to the Republic of Texas Legation to the United States.

PROJECT OVERVIEW

PROJECT AREA

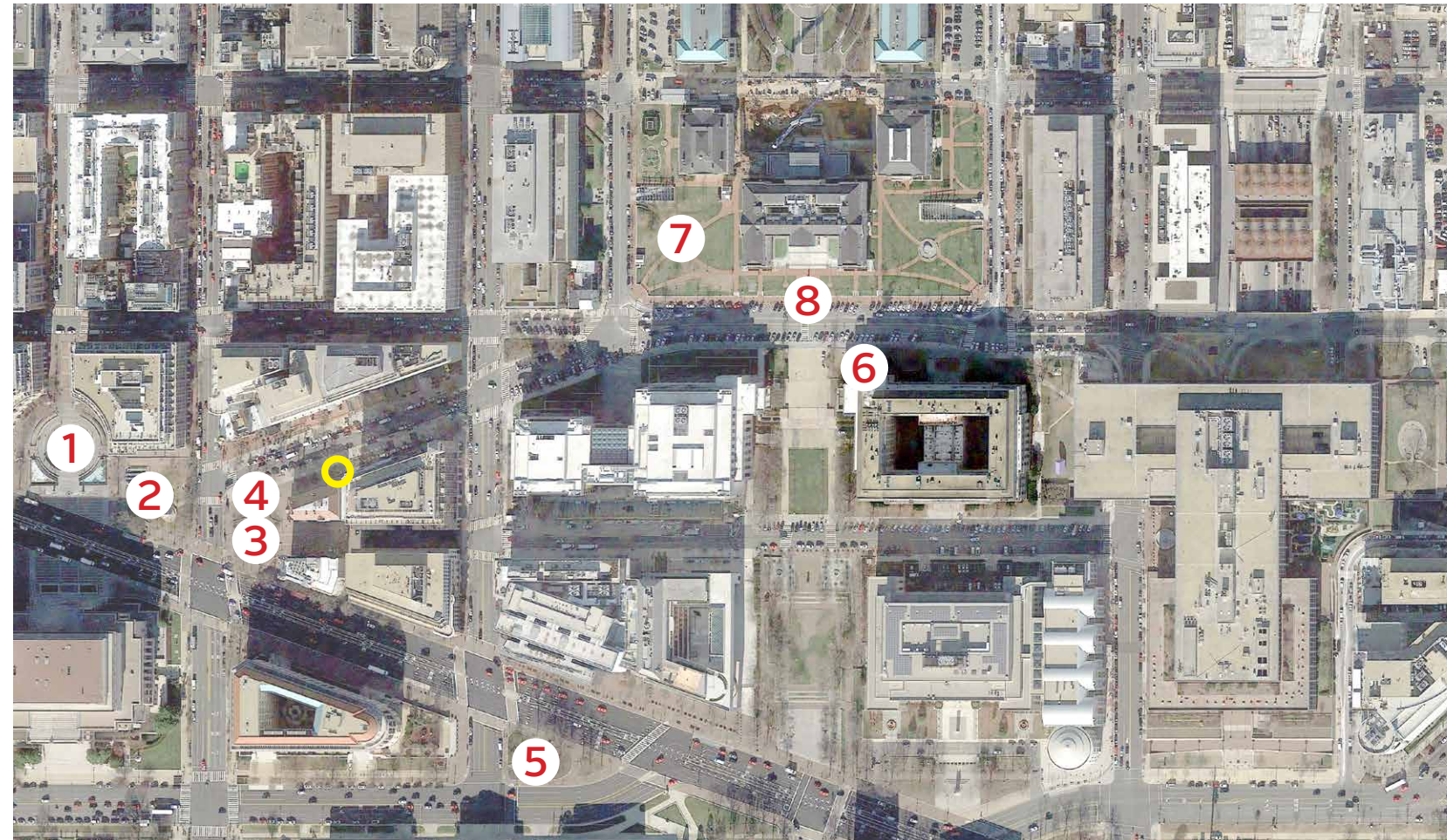

SURROUNDING AREA

The project site, indicated in yellow, is surrounded by existing memorials and sculptures of significance, listed below.

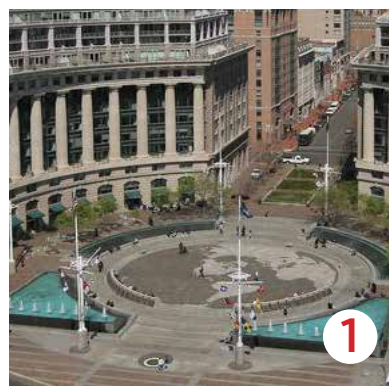

US NAVY MEMORIAL PLAZA



GENERAL WINFIELD SCOTT HANCOCK STATUE
Sculptor: Henry Ellicot



GRAND ARMY OF THE REPUBLIC MEMORIAL
Sculptor: J. Massey Rhind



TEMPERANCE FOUNTAIN



BRIGADIER GENERAL ALBERT PIKE
Artist: Gaetano Trentanove

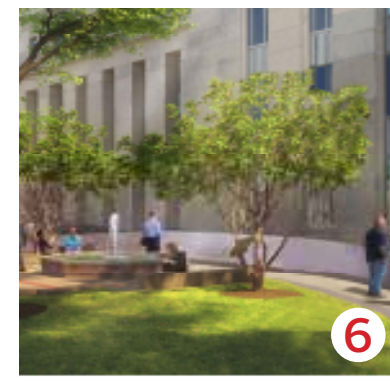

OLD DC COURTHOUSE



DARLINGTON MEMORIAL FOUNTAIN
Artist: C. Paul Jennewein



ABRAHAM LINCOLN STATUE
Sculptor: Lot Flannery

PROJECT OVERVIEW

PROPOSED PROGRAM

IN COMPLIANCE WITH H.R. 3349 REPUBLIC OF TEXAS LEGATION MEMORIAL ACT-116TH CONGRESS (2019-2020)

*THE DAUGHTERS OF THE REPUBLIC OF TEXAS WILL DESIGN A COMMEMORATIVE WORK
TO HONOR THOSE WHO, AS REPRESENTATIVES OF THE REPUBLIC OF TEXAS,
SERVED IN THE DISTRICT OF COLUMBIA AS DIPLOMATS TO THE US AND
MADE POSSIBLE THE ANNEXATION OF TEXAS AS THE 28TH STATE OF THE UNITED STATES.*

THE MEMORIAL WILL INCLUDE:

- *STONE PLINTH WITH INFORMATIVE ETCHING*
- *OFFICIAL DRT MEDALLION*
- *IMPROVED LANDSCAPING INSIDE EXISTING GRANITE SURROUND*

GOALS/ OBJECTIVES:

- *THE GOAL OF THE MEMORIAL IS TO PROVIDE INFORMATION ABOUT THE HISTORY OF THE ANNEXATION OF TEXAS INTO THE UNITED STATES AND HONOR THOSE DIPLOMATS WHO MADE THIS POSSIBLE. THE LOCATION IS IMPORTANT BECAUSE IT SITS IN THE MIDDLE OF MULTIPLE LOCATIONS WHERE THESE DIPLOMATS LIVED AND WORKED.*

DOCUMENTED HISTORICAL LOCATIONS ASSOCIATED WITH THE REPUBLIC OF TEXAS LEGATION TO THE U.S.



1	2	3	4	5	6	7	8
MEMUCAN HUNT MINISTER PLENIPOTENTIARY AND ENVOY EXTRAORDINARY	ANSON JONES MINISTER PLENIPOTENTIARY	ANSON JONES MINISTER PLENIPOTENTIARY	BERNARD E. BEE, SR. CHARGES D 'AFFAIRS	ISAAC VAN ZANDT CHARGES D 'AFFAIRS	ISAAC VAN ZANDT CHARGES D 'AFFAIRS	ISAAC VAN ZANDT CHARGES D 'AFFAIRS	C.H. RAYMOND ACTING CHARGES D 'AFFAIRS
Mrs. Page's boardinghouse Today it is the Navy Memorial	Mrs. Pittman's boardinghouse Today it is the William B. Bryant Annex to the US Courthouse	Gadsby's Hotel Today it is the John's Hopkins Campus	M. Lawrence's, near Gadsby's Today it is the Canadian Embassy	Mrs. Bowen's boardinghouse Today it is the Patrick Henry Building	Boardinghouse Today it is a commercial office building	F street between 13th and 14th streets Today it is a commercial office building on F street	Mr. Underwood's Today it is the Cannon House Office Building
1837-1838	1839	1839	1840-1842	1843	1843-1844	1844	1845

PROPOSED PROGRAM

EXISTING CONDITIONS



REMOVE EXISTING
TREES (3)

REMOVE EXISTING
LIGHT POLES

DETAILED PROJECT INFORMATION AND DRAWINGS

SITE PHOTOS

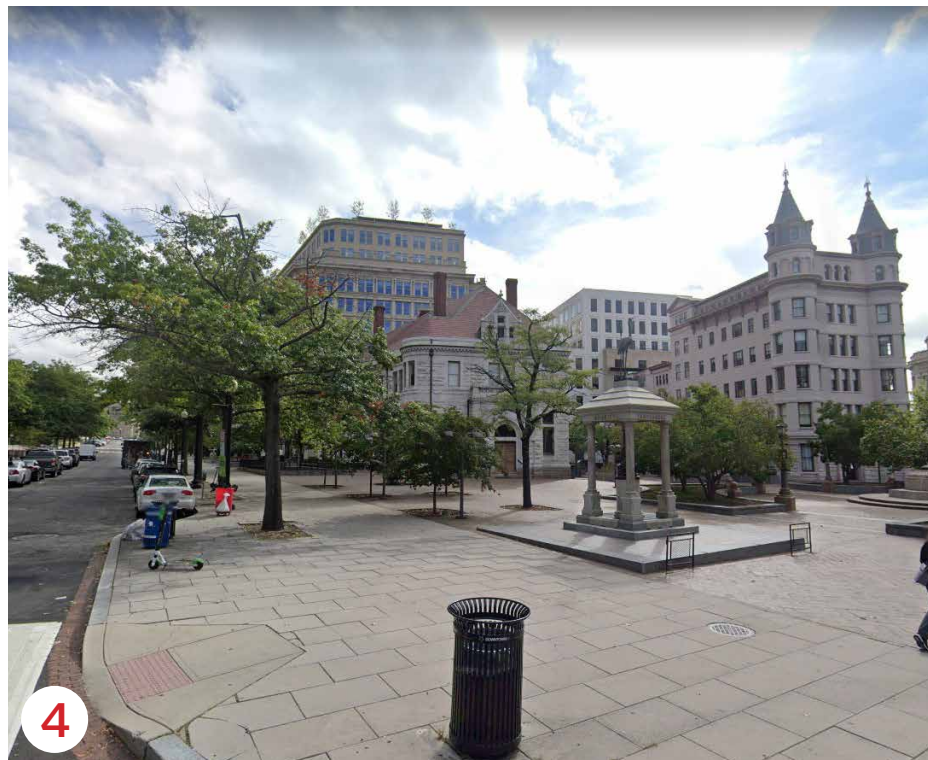
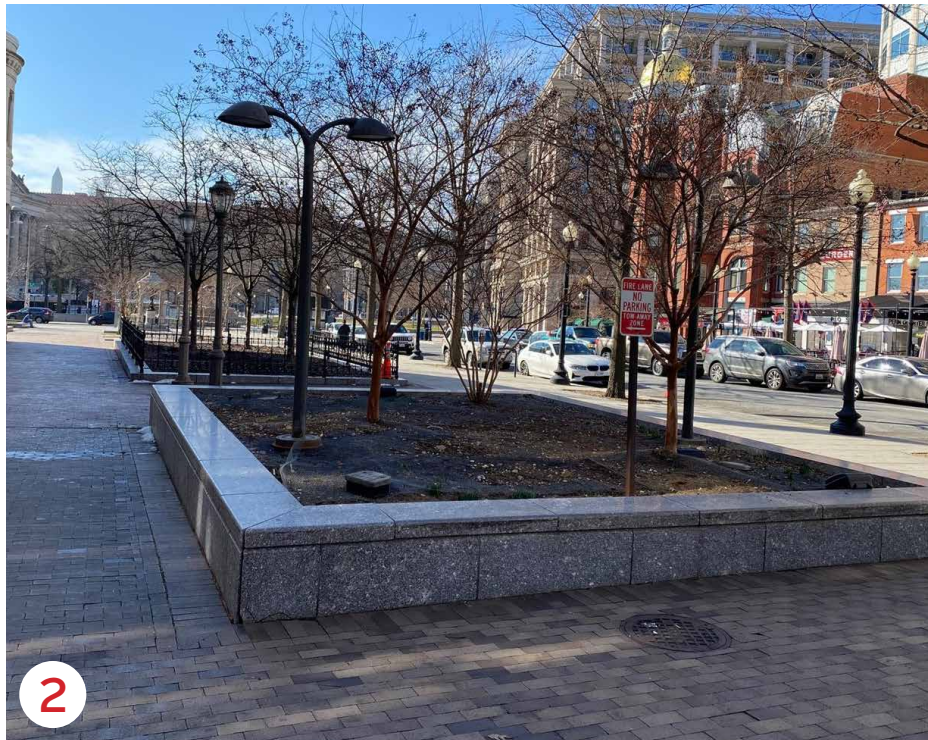
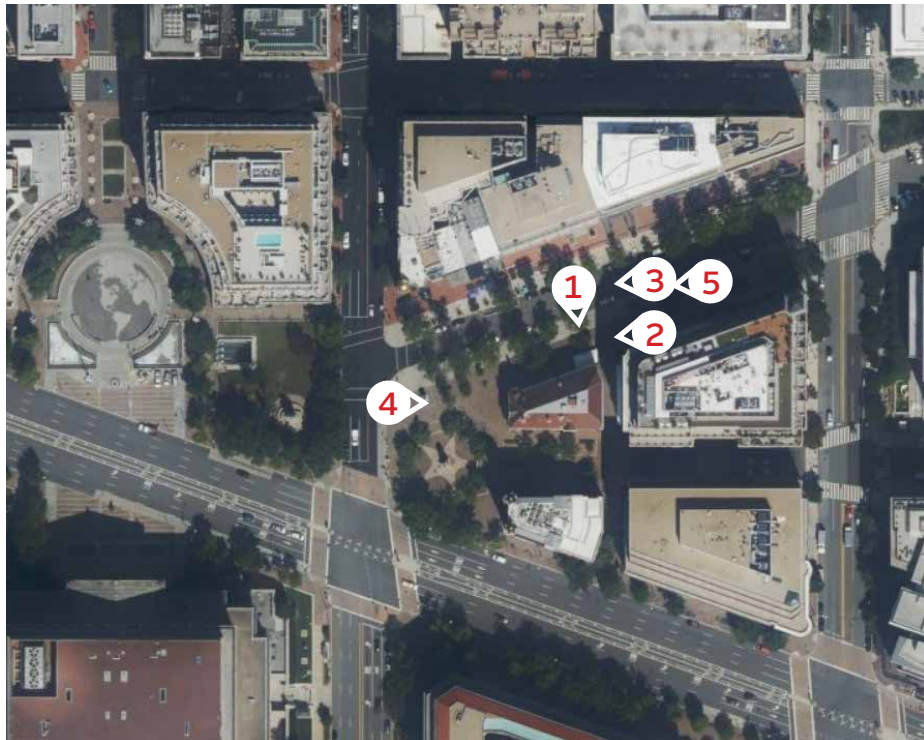

SITE PLAN



DETAILED PROJECT INFORMATION AND DRAWINGS

EXISTING CONDITIONS

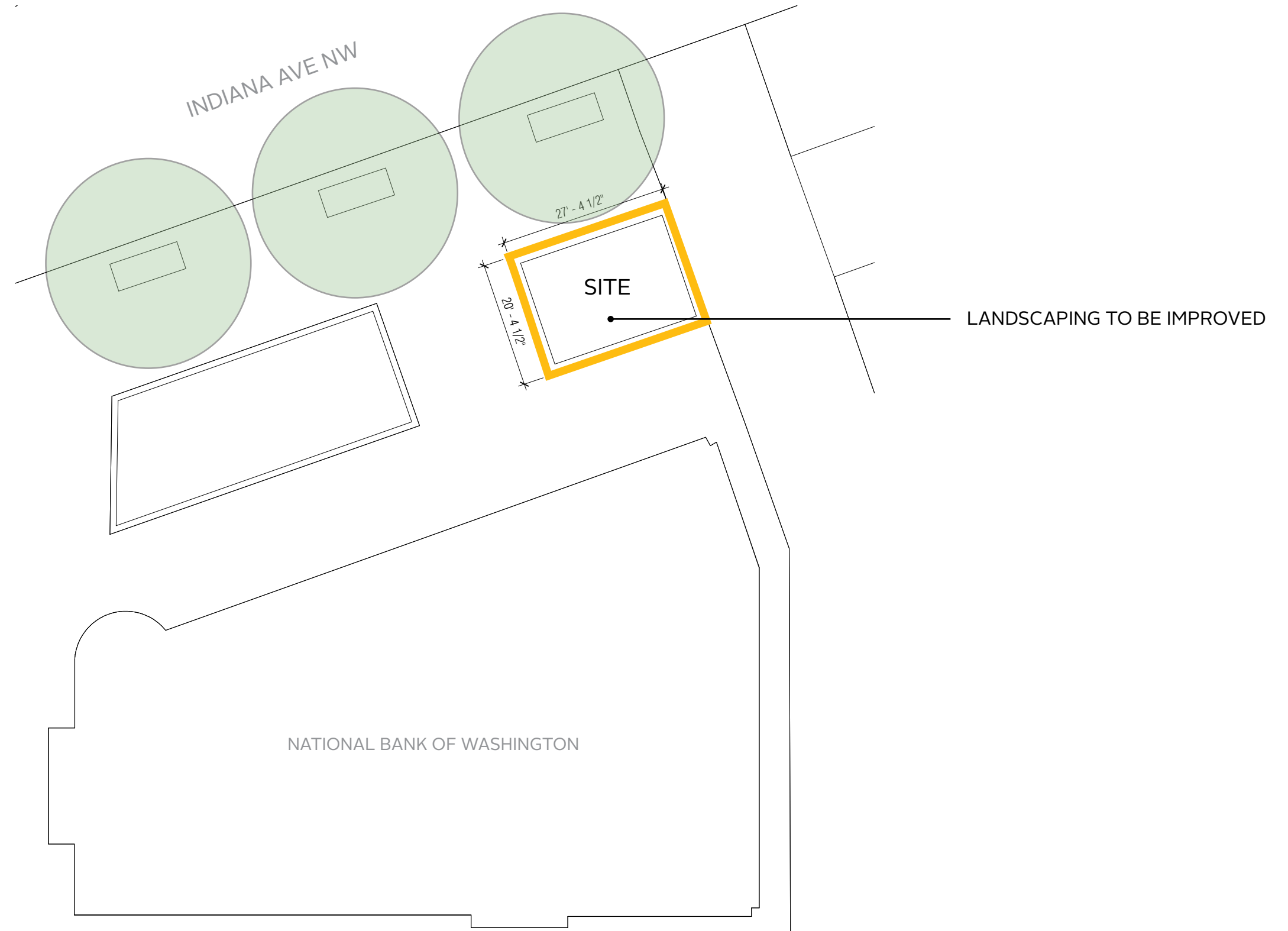

DETAILED PROJECT INFORMATION AND DRAWINGS

ARCHITECTURAL AND DESIGN PROGRAM

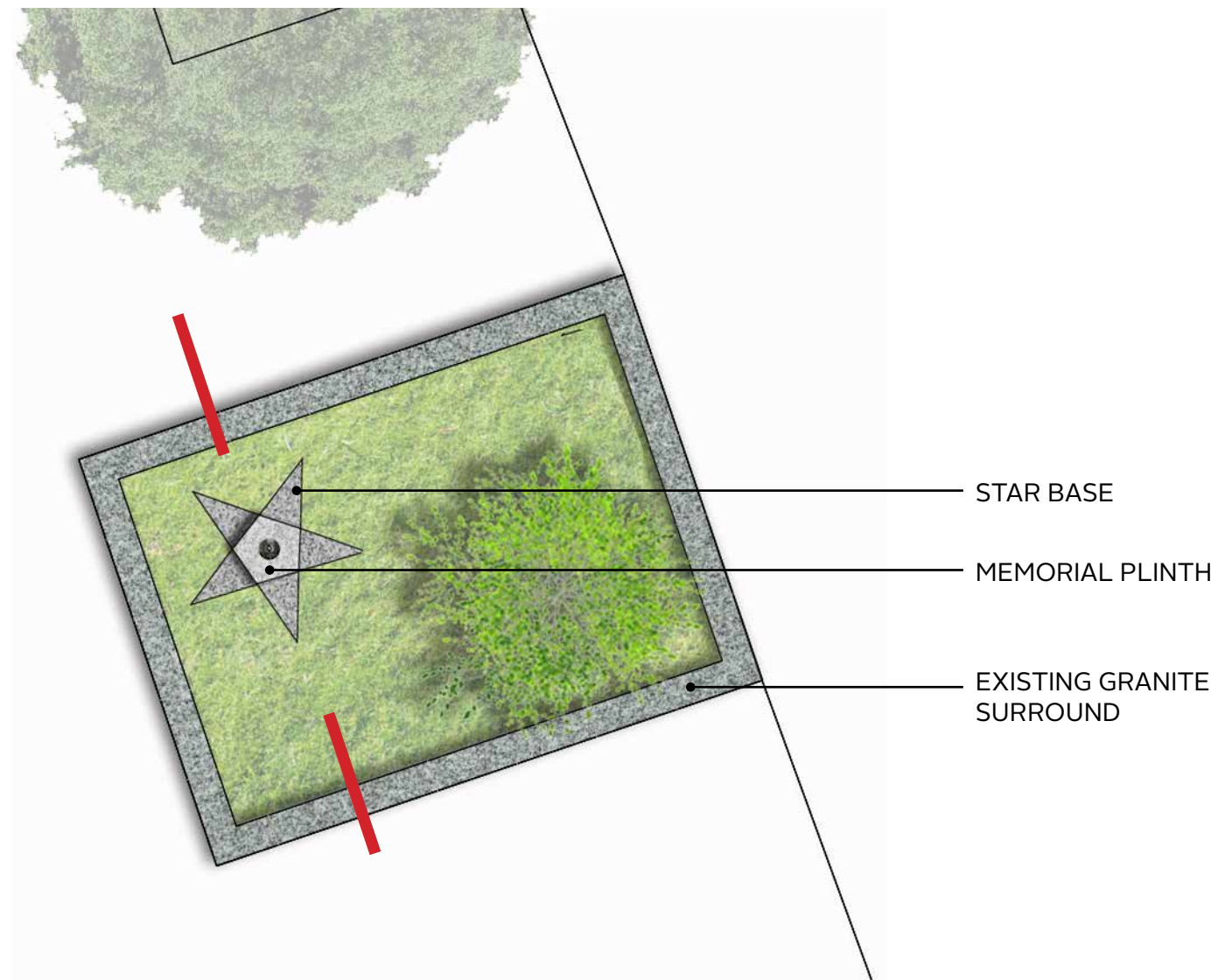

PLAN



RENDERING

(SHOWN FOR SCALE PURPOSES ONLY. SEE LANDSCAPE DESIGN FOR PROPOSED PLANTINGS)

DETAILED PROJECT INFORMATION AND DRAWINGS

ELEVATION

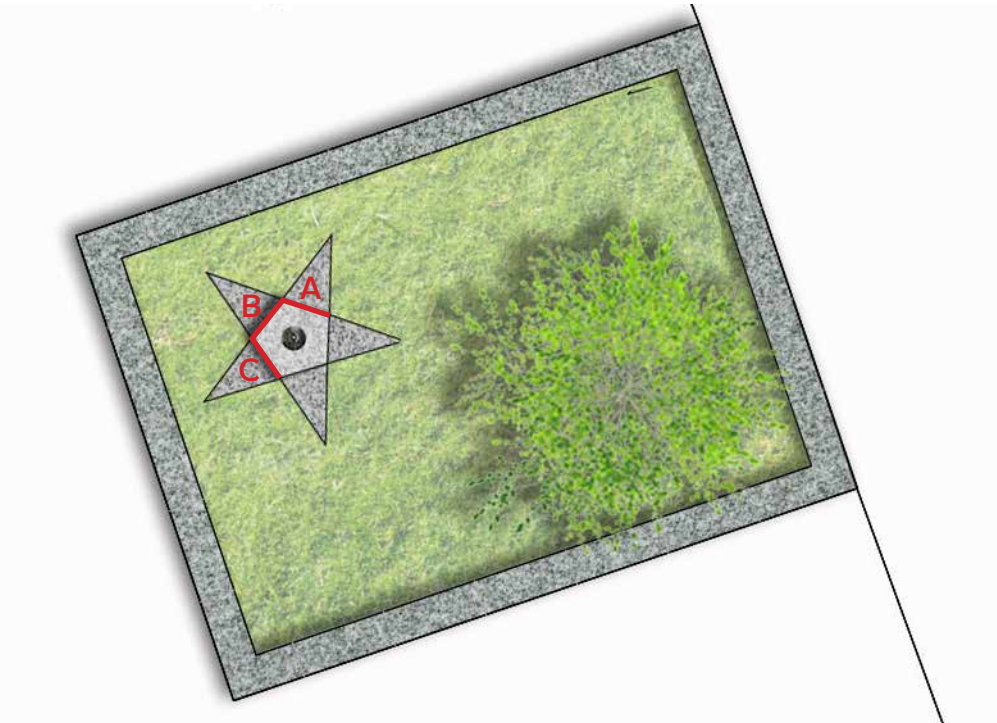
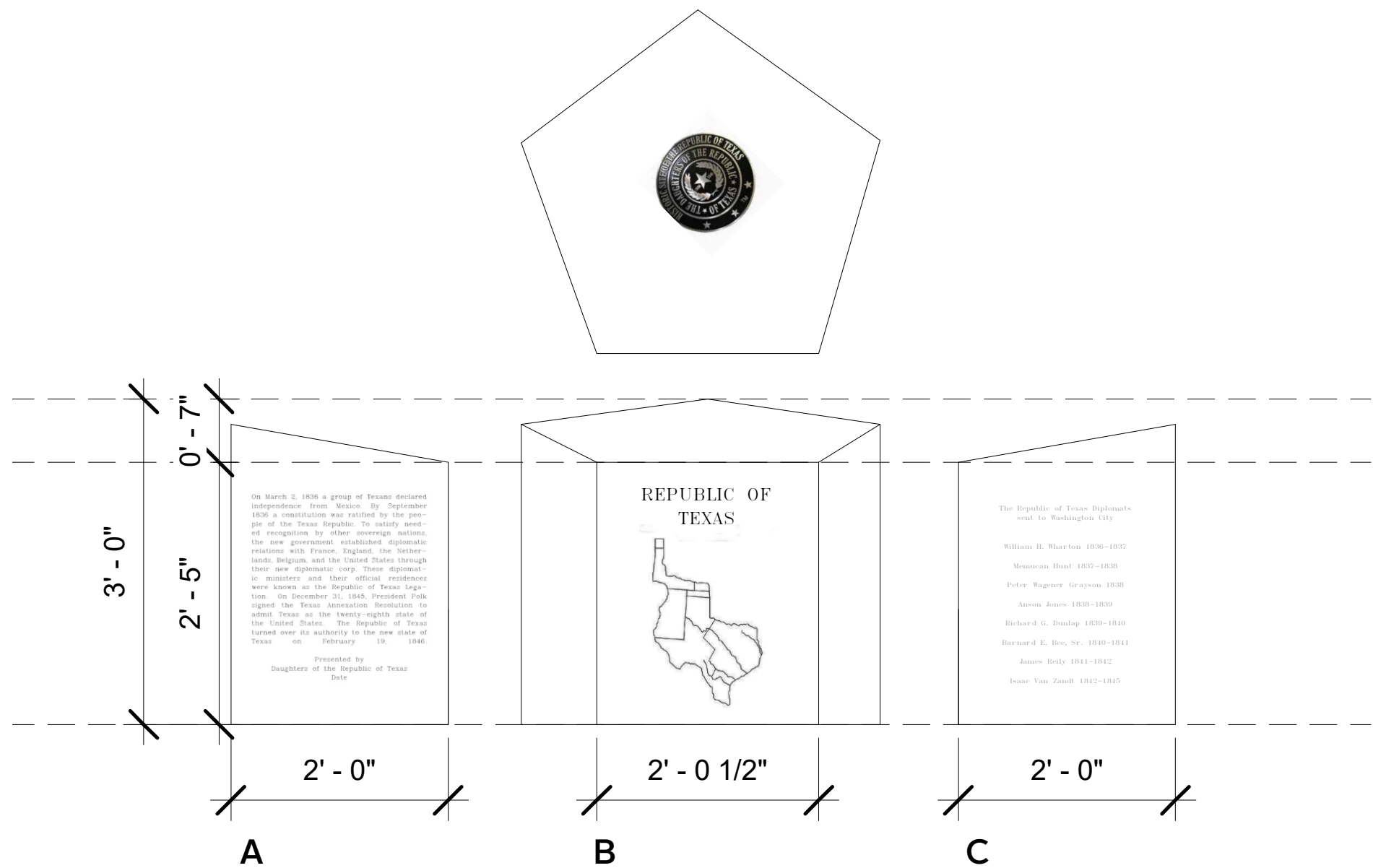

DETAILED PROJECT INFORMATION AND DRAWINGS

MEMORIAL ENGRAVING DETAILS

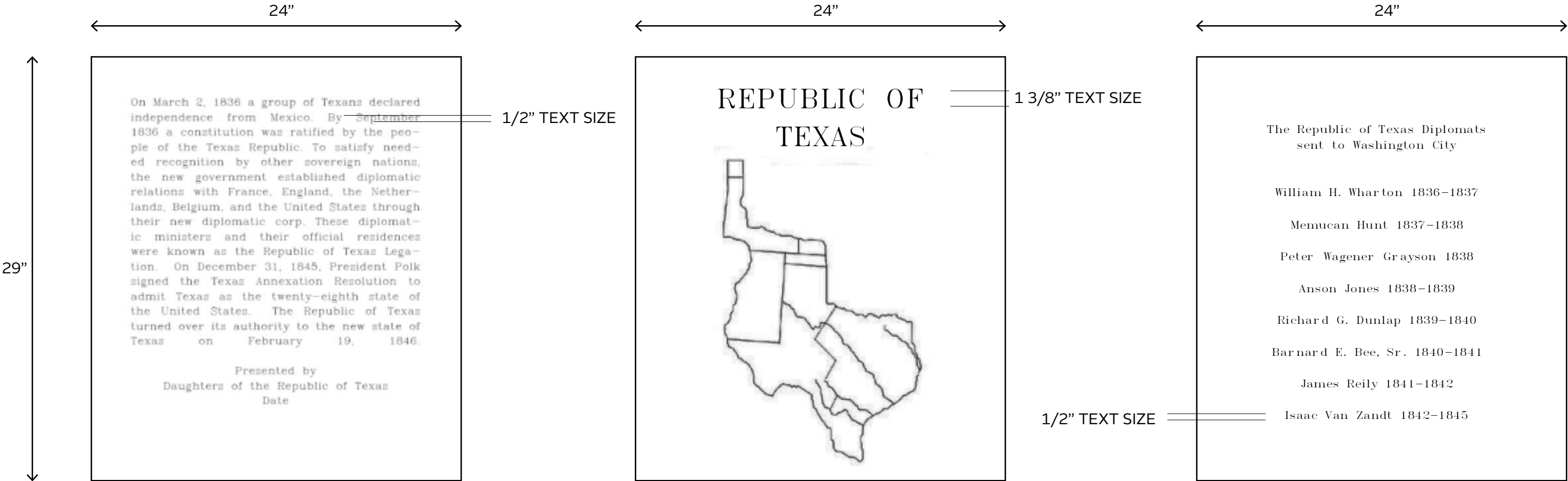

DETAILED PROJECT INFORMATION AND DRAWINGS

MEMORIAL MATERIAL AND DRT MEDALLION

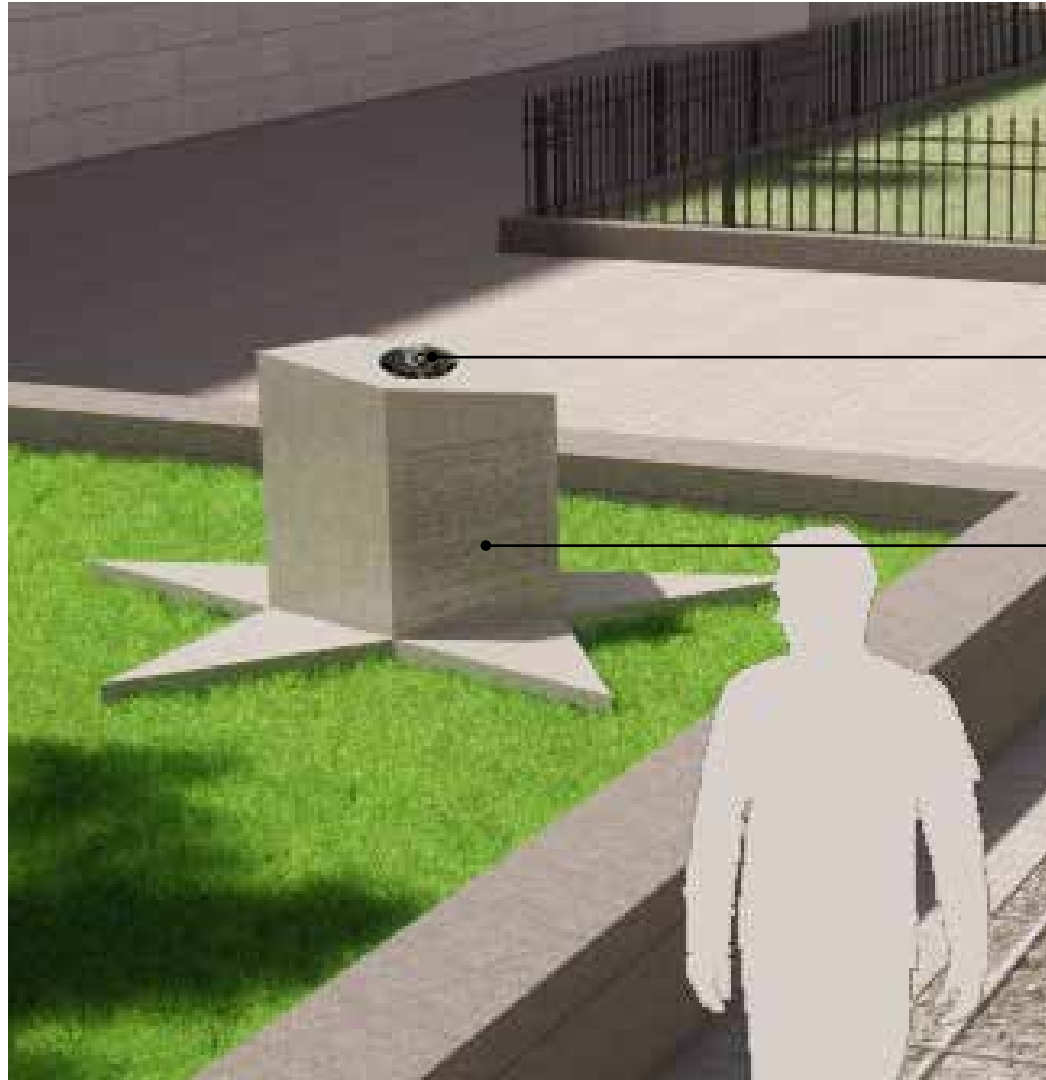

11" DRT HISTORIC SITES MEDALLION
(PROVIDED BY THE DRT)



MEMORIAL PLINTH AND STAR BASE
WHITE MT. AIRY GRANITE

DETAILED PROJECT INFORMATION AND DRAWINGS

CROSS SECTION

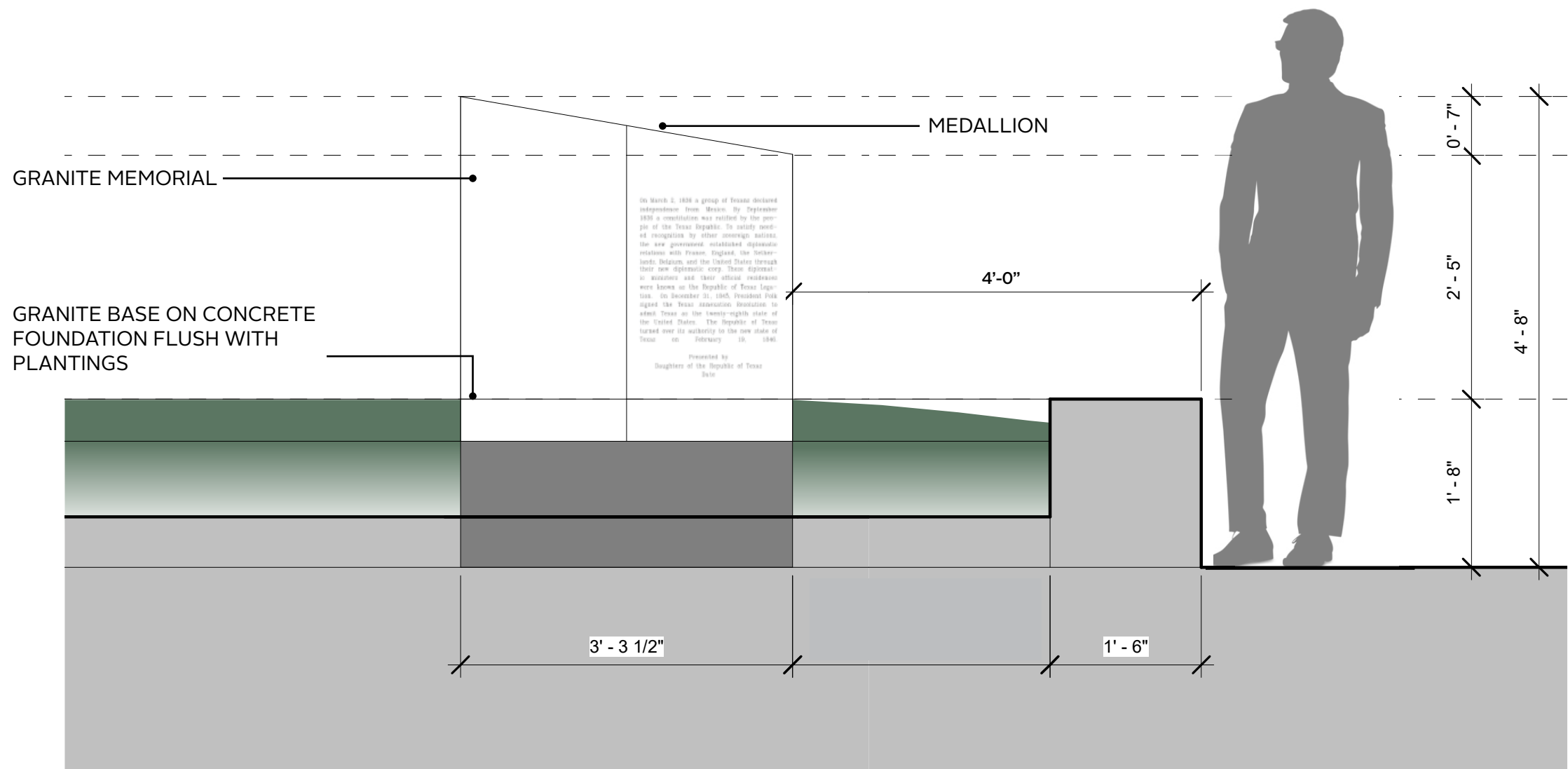

MEDALLION
SHOWN HERE
IS AT THE SAME
SCALE AS THE
SECTION

CONCEPT DEVELOPMENT: CULTURAL HISTORY

1821

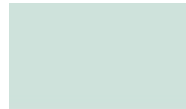

1836



1845



Pre-Republic

By 1821, Texas was part of Mexico after Mexico had gained independence from Spain. Tensions between Mexico and the United States began to intensify in the following decade.

Republic

Texas became an independent republic in 1836, and remained so for almost 10 years. The Lone Star flag was adopted in 1839.

Joining the Union

As part of the Texas Annexation Act in 1845, Texas was admitted as the 28th State of the United States of America. The formal transfer of power took place in February 1846.

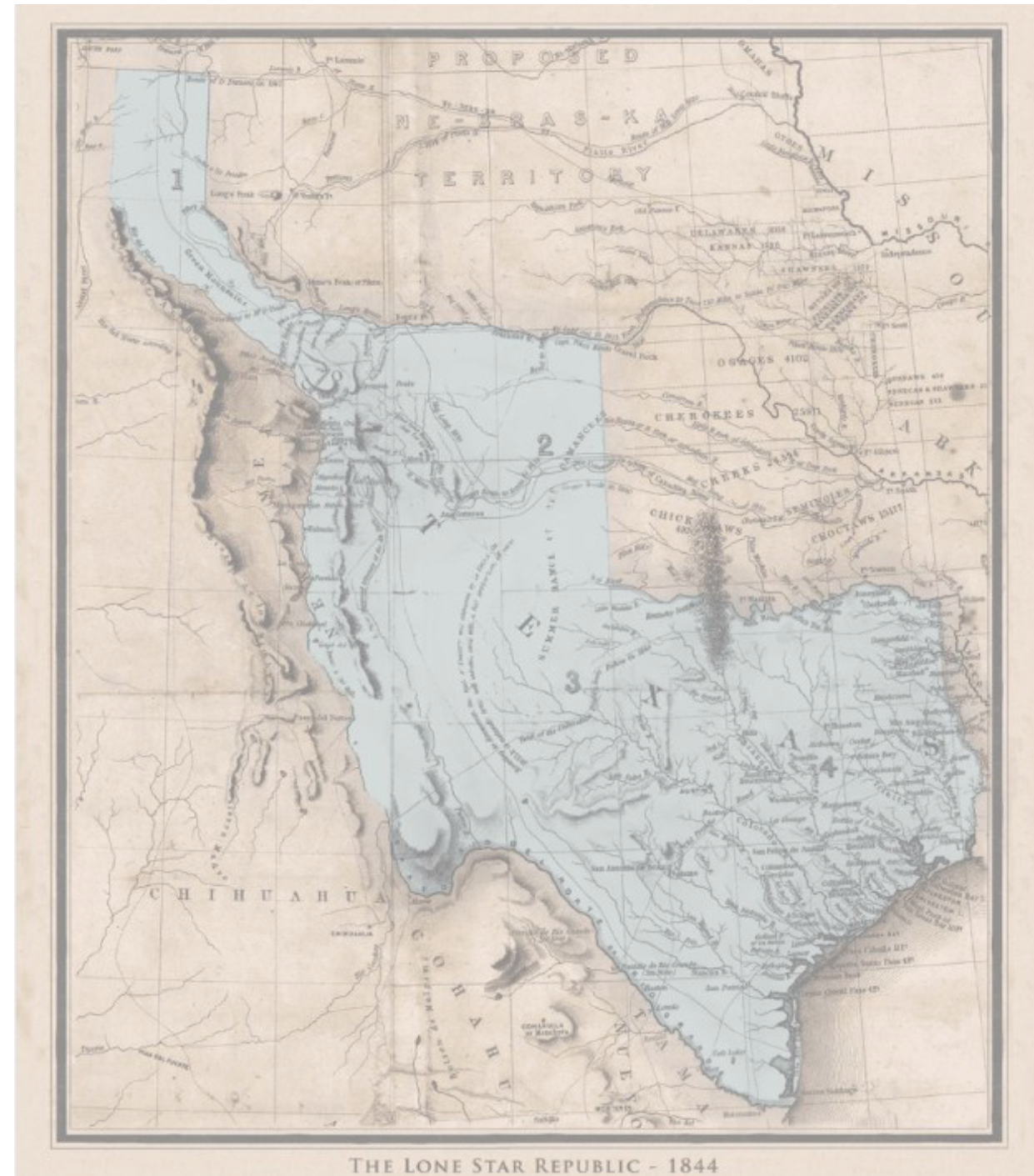

William H. Emory and William James Stone. *Map of Texas and the countries adjacent* (detail, boundaries highlighted). Washington, D.C., War Department, 1844

CONCEPT DEVELOPMENT: ECOLOGICAL REGIONS

Ecoregions

Texas covers 266,807 square miles of land, incorporating areas of huge diversity in climate, landscape and wildlife.

Given size and geographical location, **Texas is located at a unique crossroads of regional habitats**, where eastern continental habitats meet western ones and where northern habitats meet southern ones.

West Texas typically ranges from **semi-arid to arid desert**.

East Texas is typically defined by the “Piney woods” region with **rich bottomlands**.

Washington-On-The-Brazos

The **Brazos River basin** divides East from West Texas, spanning 45,000 square miles through the center of the state.

Toward the mouth of the river, Washington, Texas is situated along the Brazos. It was in this town, 60 years after the United States signed its Declaration of Independence in Philadelphia, where **Texas signed its Declaration of Independence from Mexico in March, 1836**.

After the Civil War, the unincorporated community became known as “*Washington-on-the-Brazos*” to distinguish the integral settlement from “*Washington-on-the-Potomac*,” Washington, D.C.



SOLAR STUDIES

10:00 AM

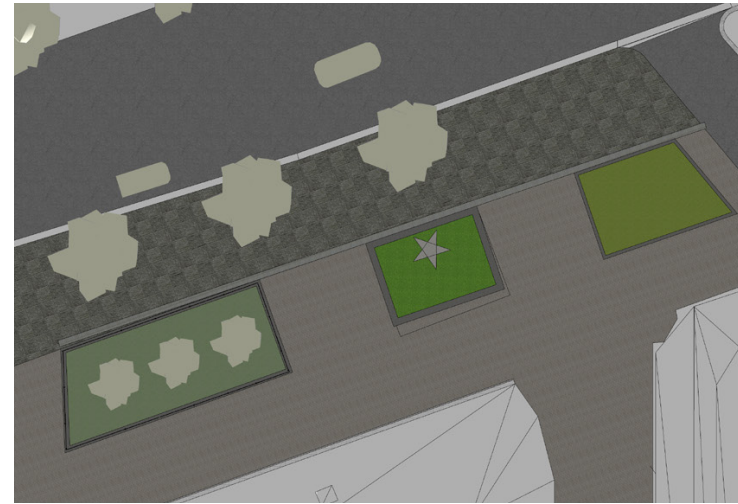
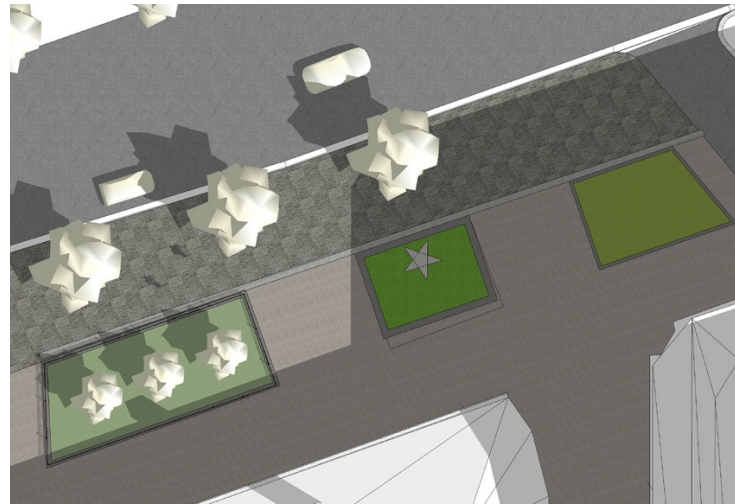
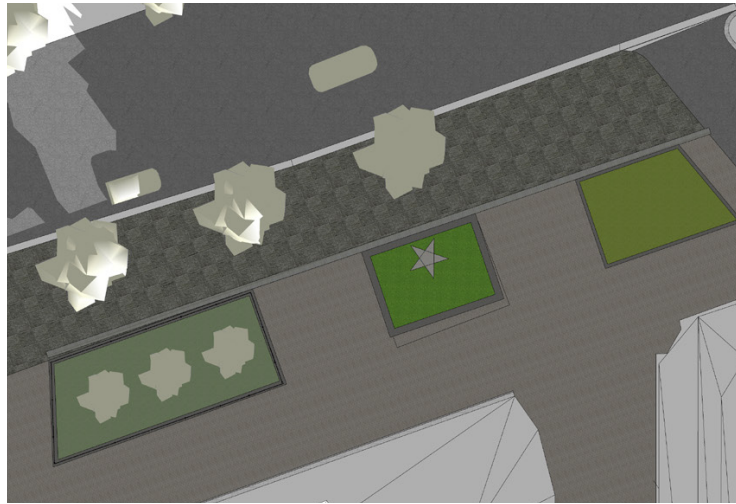

NOON

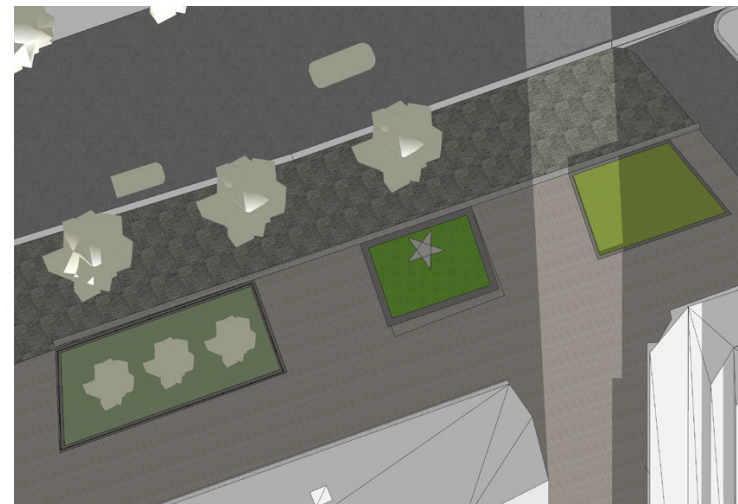
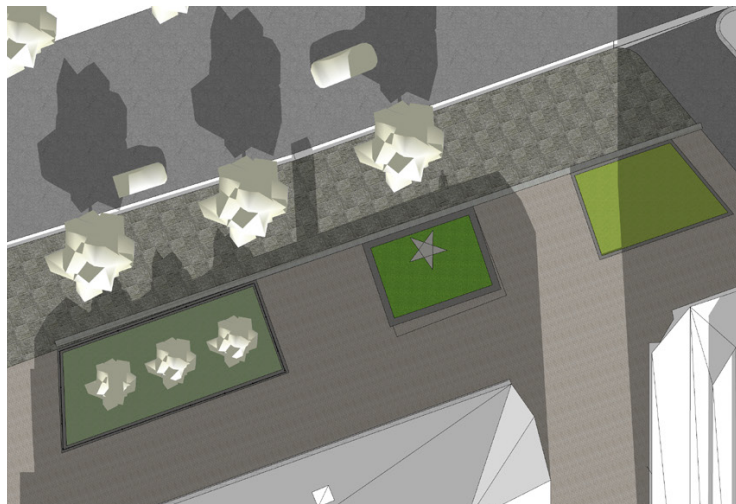

03:00 PM

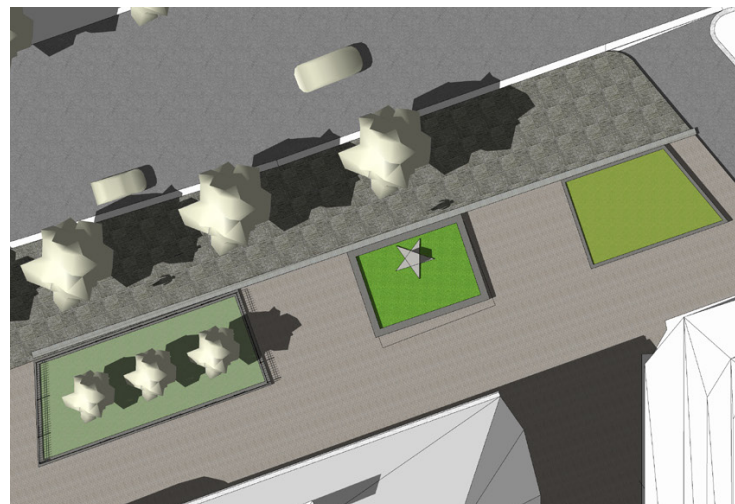
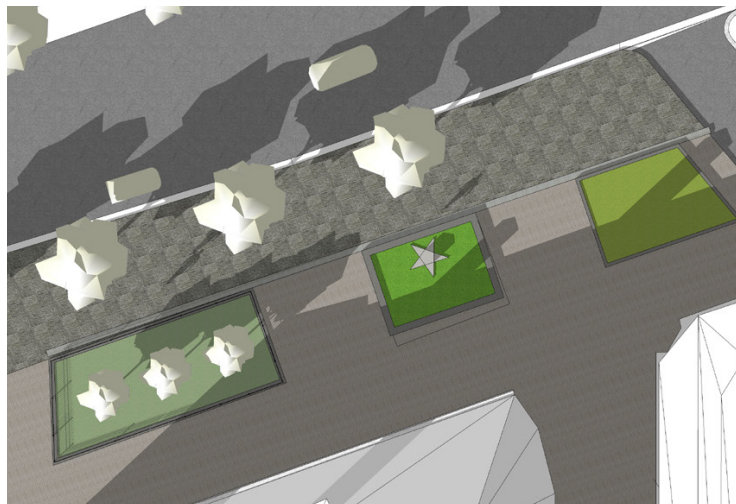

SPRING EQUINOX

SUMMER SOLSTICE

WINTER SOLSTICE

DETAILED PROJECT INFORMATION AND DRAWINGS SURROUNDING CANOPY

LEGEND:

- *Koelreuteria paniculata*
Golden Rain Tree
- *Lagerstroemia* sp.
Crape Myrtle
- *Quercus bicolor*
Swamp White Oak
- *Quercus lyrata*
Overcup Oak
- *Quercus palustris*
Pin Oak
- *Quercus imbricaria*
Shingle Oak
- *Quercus texana*
Nuttall Oak
- *Quercus rubra*
Red Oak
- *Gleditsia triacanthos*
Honey Locust
- *Magnolia x soulangeana*
Saucer Magnolia



DETAILED PROJECT INFORMATION AND DRAWINGS

LANDSCAPE PLAN: PREFERRED CONCEPT

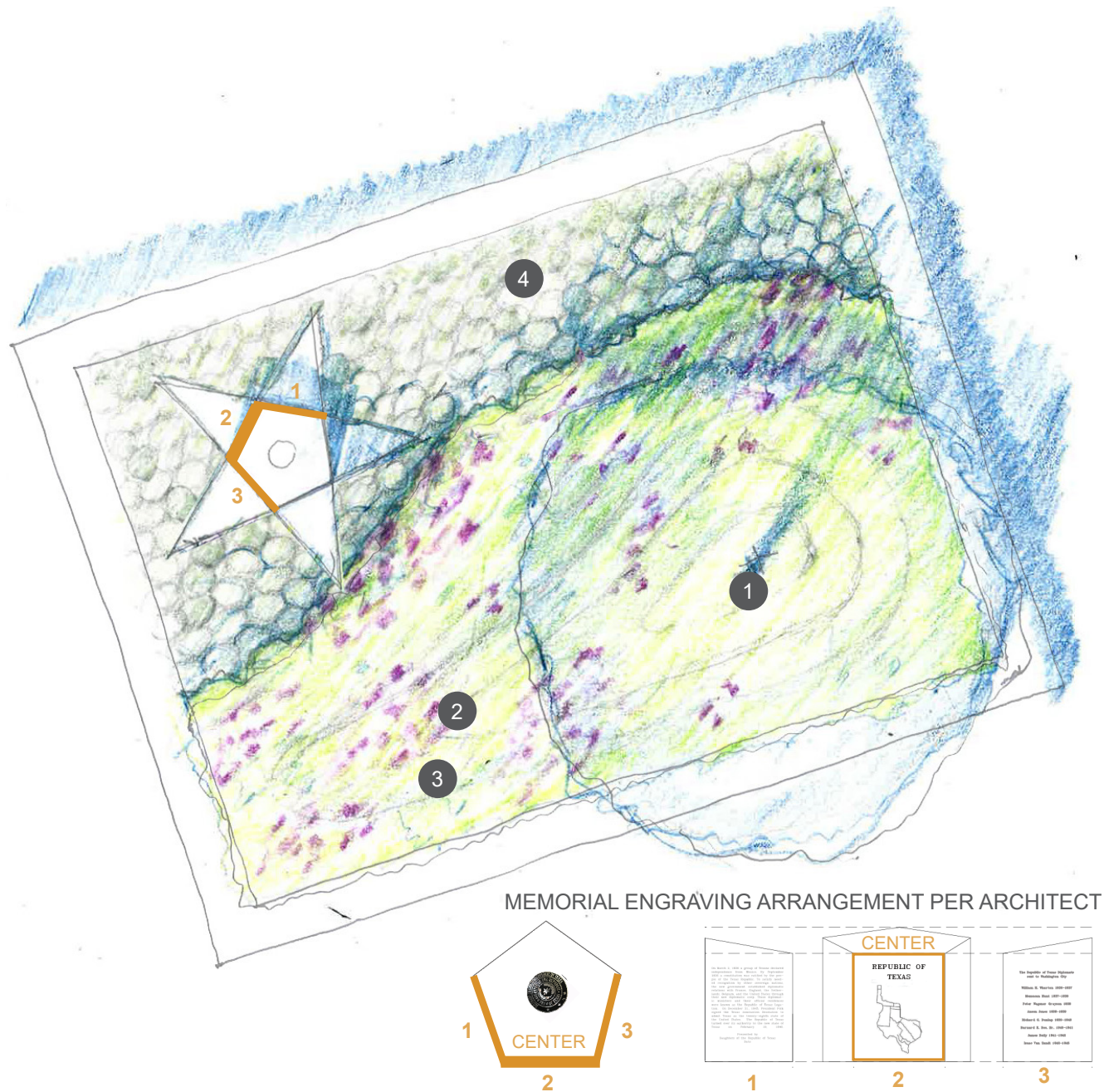

The memorial planter is organized by two asymmetrical plant palettes, oriented to the NW corner where the memorial signage is located. A field of low-growing, native evergreen sedge makes up the foreground, maintaining visual access to the plinth. Beyond, an interplanted field of native meadow plants, Blue Grama grass and Blazing star, create a taller backdrop. The organic shape relates to the Brazos River Basin that defines the two distinct landscapes of Texas.

Soil bermed at the rear (southeast) corner of the planter creates a subtle high point where a Sweetbay Magnolia tree is located on a visual axis from the memorial plinth. The solitary tree with its singular, pronounced white blossoms represents the lone star state and Texas's time period as a republic. The two juxtaposed native planting zones recall the diversity, orientation, and unique breadth of Texas's ecological regions across the state. The selection of plants that comprise the memorial are both native to Texas and native to the mid-Atlantic milieu of Washington, DC.



1 ALTERNATIVE A: *MAGNOLIA VIRGINIANA*
Sweetbay Magnolia - TREE & FLOWER



2 *BOUPELOUA GRACILIS* 'BLONDE AMBITION'
Blue Grama Grass



3 *LIATRIS SPICATA* 'KOBOLD'
Blazing Star



4 *CAREX LAXICULMIS* 'HOBB'
Bunny Blue Sedge

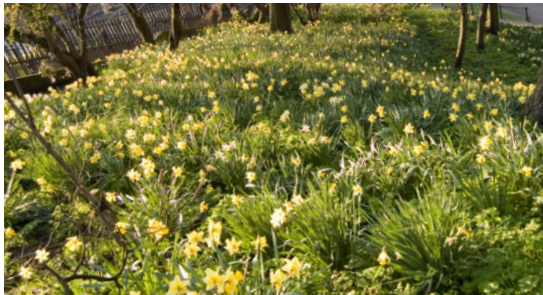

BULB PLANTING CHARACTER IMAGE
Provides early-mid Spring seasonal interest.

*See Appendix 1 for information on plant material and Appendix 4 for bulb alternatives.

DETAILED PROJECT INFORMATION AND DRAWINGS

LANDSCAPE DESIGN: PLANTS



Magnolia virginiana
(Sweetbay Magnolia)

Semi-Evergreen Understory Tree

Height 15 - 30 ft.
Width 8 - 12 ft.

Native Status: Native on the US East Coast Coastal Plain. Native in East Texas.

Flower: Single saucer-like white lemon-scented flowers in late spring and early summer.

Description: Small, multistemmed compact upright habit. Lustrous dark green leaves with silver tones beneath. A graceful specimen tree that works well in a smaller area and requires minimal maintenance.



Bouteloua gracilis 'Blonde Ambition'
(Blue Grama Grass)

Deciduous Ornamental Grass

Height 0.75 - 2.5 ft.
Width 0.75 - 1.5 ft.

Native Status: A dominant shortgrass prairie species, native in north and west Texas.

Flower: Horizontal chartreuse inflorescences in early to mid-summer, persisting into winter when they become blonde/brown.

Description: Drought tolerant grass with blue/gray blades that grows in prairies, plains and open woodlands. Feathery grass tips catch the sunlight and provide drama when planted in mass. Grass turns straw-colored in Fall.



Liatris spicata 'Kobold'
(Blazing Star)

Deciduous Perennial

Height 1.5 - 2.5 ft.
Width 0.5 - 1 ft.

Native Status: Native to the eastern United States as far west as Louisiana. Though not native in Texas, it is in the same genus as the native *Liatris punctata* (dotted blazing star).

Flower: Light purple flowers bloom in late summer through to September.

Description: Drought tolerant and pollinator friendly. The prominent, dramatic flower spikes provide nectar for wildlife, while the later seedheads provide food for birds.



Carex laxiculmis 'Hobb'
(Bunny Blue Sedge)

Evergreen Sedge

Height 8 - 12 in.
Width 12 - 16 in.

Native Status: Native to the eastern United States.

Flower: Insignificant creamy white flowers appear in May - June.

Description: A small compact grass that will slowly spread over time. The silvery-blue leaves are predominantly evergreen, but benefit from a cutback in late winter.



DETAILED PROJECT INFORMATION AND DRAWINGS

LANDSCAPE PLAN: ALTERNATE SCHEME 1

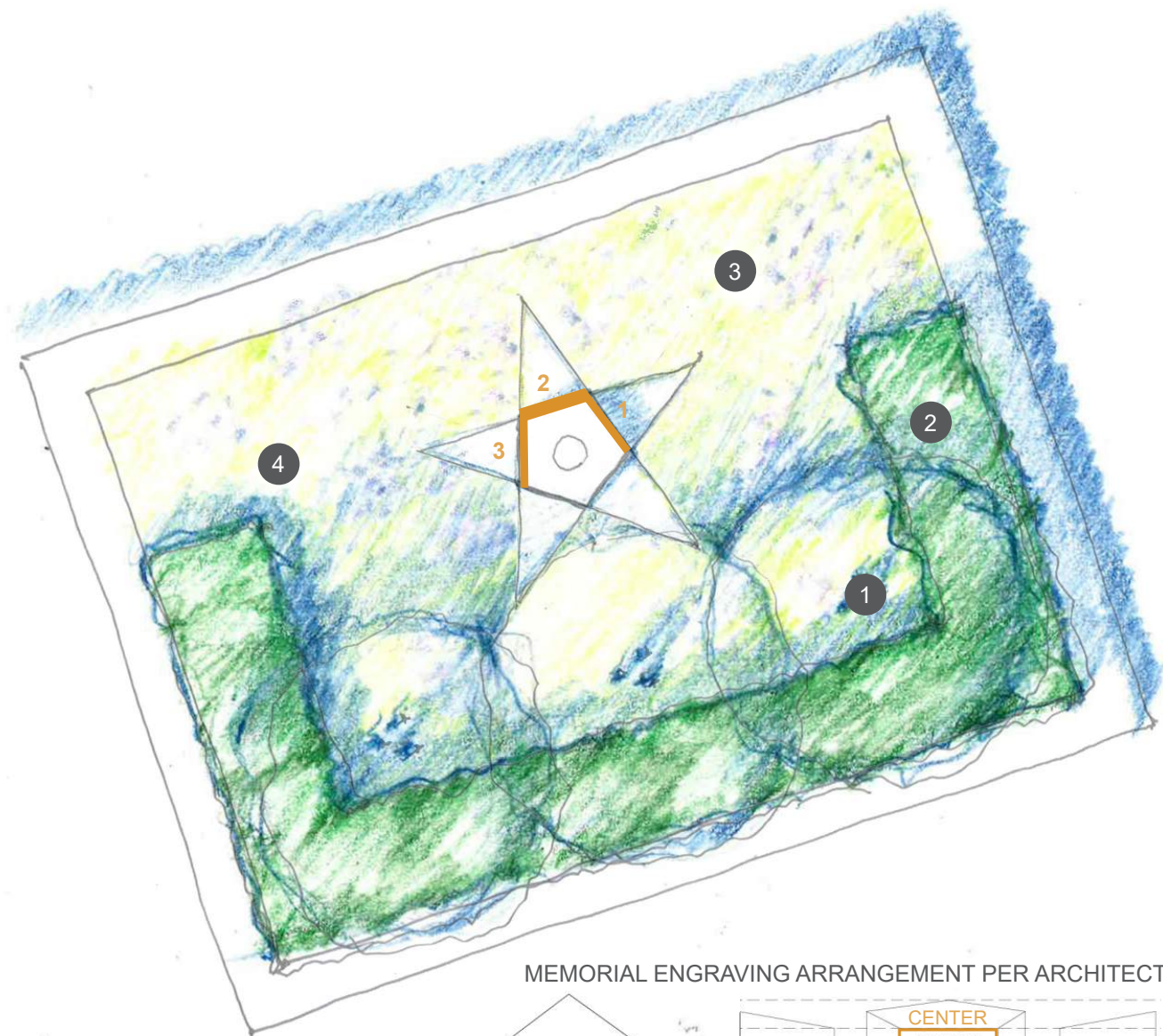

MEMORIAL ENGRAVING ARRANGEMENT PER ARCHITECT

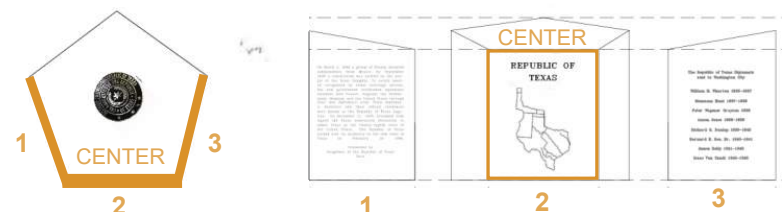

Foreground: Low-growing mixture of native Eastern Blue star and non-native Autumn Moor grass evokes the unique mixture of influences in Texas stemming from periods of European colonization.

Hedge: Dwarf Yaupon Holly, native to both Texas and the mid-Atlantic, evokes protection and surrounds the rear of the planter, providing an evergreen backdrop for the memorial plinth.

Rear/Small Trees: Three witch hazels represent the three time periods of significance related to the Legation of Texas



1 *HAMAMELIS VIRGINIANA*
Witch Hazel

*See Appendix 2 for information on plant material



2 *ILEX VOMITORIA 'SCHILLINGS'*
Yaupon Holly



3 *SESLERIA AUTUMNALIS*
Autumn Moor Grass



4 *AMSONIA 'BLUE ICE'*
Eastern Bluestar

DETAILED PROJECT INFORMATION AND DRAWINGS

LANDSCAPE PLAN: ALTERNATE SCHEME 2

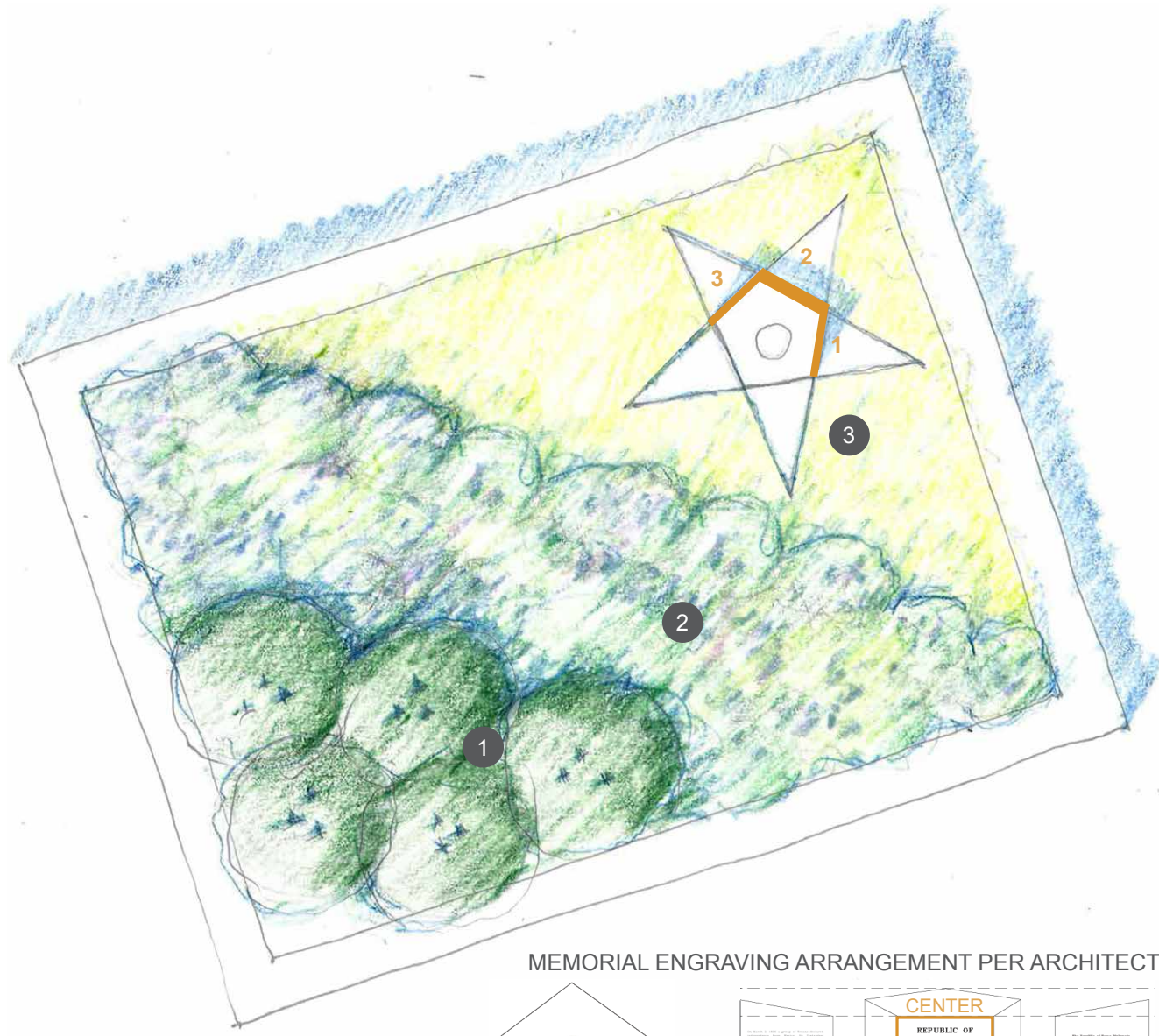

MEMORIAL ENGRAVING ARRANGEMENT PER ARCHITECT

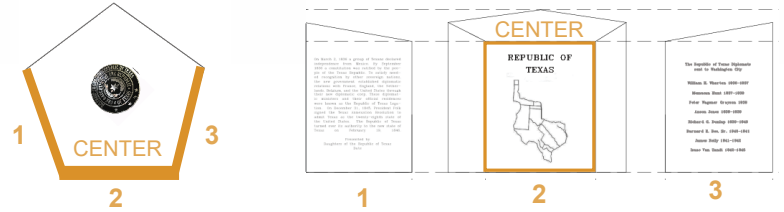

Foreground: Low-growing Mexican Feather Grass evokes the arid climate of Texas's SW ecological region.

Transitional Zone: A zone of native Hubricht's Blue Star provides a mid-height planting layer and cuts across the planter diagonally like the Brazos River Basin, which divides arid and wet regions of the state.

Rear/Small Shrubs: A mass of Winterberry shrubs provides the final backdrop layer for the memorial and recalls the wetter climate of the NE portion of the state. Red berries provide winter interest.



1 ALTERNATIVE A: *VIBURNUM DENTATUM* 'BLUE MUFFIN' / Arrowwood Viburnum



1 ALTERNATIVE B: *ILEX VERTICILLATA* 'NANA' / Red Sprite Winterberry



2 *AMSONIA HUBRICHTII* Threadleaf Bluestar

*See Appendix 3 for information on plant material



3 *NASSELLA TENUISSIMA* Mexican Feather Grass

DESIGN CONCEPT: REPRESENTATIVE BULB PALETTE



Scilla sibirica
(Siberian Squill)

Spring Flowering Bulb

Height 5 - 7 in.
Flower Early / Mid Spring



Ipheion 'White Star'
(Mexican Star)

Spring Flowering Bulb

Height 3 - 6 in.
Flower Mid Spring



Narcissus 'Las Vegas'
(Daffodil)

Spring Flowering Bulb

Height 18 - 20 in.
Flower Early / Mid Spring



Narcissus 'Mount Hood'
(Daffodil)

Spring Flowering Bulb

Height 15 - 17 in.
Flower Mid Spring



Narcissus 'Actaea'
(Daffodil)

Spring Flowering Bulb

Height 15 - 17 in.
Flower Mid / Late Spring

**Final bulb palette to be coordinated with selected planting concept.*

DETAILED PROJECT INFORMATION AND DRAWINGS

PREFERRED CONCEPT RENDERING

