



revised Preliminary Alternative 5 - Park into the City

Extending the visitor's experience of the Memorial into downtown St. Louis and the surrounding neighborhoods, including East St. Louis, is the essence of this alternative. The alternative emphasizes enhanced services and visual themes that begin and continue into adjacent neighborhoods and areas, while reconsidering the transportation and access challenges in the park. The "edge" of the park is softened by the removal of Memorial Drive, and the transformation of that space into a welcoming community plaza.

The lead preservation goal is to protect the National Historic Landmark and the fundamental resources and values of the Memorial. The Memorial grounds remain, on the whole, unchanged. Sensitive rehabilitation of the designed landscape and structures is allowed to improve accessibility and security so long as the integrity of the National Historic Landmark is protected. The largest change in the look and feel of the Memorial is caused by the removal and rerouting of Memorial Drive traffic northbound along 4th Street and southbound on Broadway, between Poplar and Locust streets. The vacated corridor of Memorial Drive will be renovated into a series of large civic/community gathering plazas, increasing connectivity between the Old Courthouse and the Gateway Arch at Luther Ely Smith Square.

The NPS strengthens educational and interpretive programs currently offered at the Memorial, and expands opportunities for visitors to participate in more interactive experiences. The grounds surrounding the Gateway Arch accommodate and promote more visitor activity and special events than are currently provided. Museum collections and archives are moved into a state-of-the-art storage facility in the new education and research facility at the south end of the park, when not on exhibit in the Museum of Westward Expansion or in the Old Courthouse. The exhibits at the Old Courthouse and in the museum under the Arch are redesigned to engage visitors in more active participation. The north and south ends of the Memorial are zoned to allow for new visitor amenities and educational/cultural facilities. On the north, the existing parking garage is renovated to provide for visitor orientation and some heritage education, as well as for a multi-modal gateway and transit center that would provide a transportation system linking visitor attractions within and outside of the Memorial. On the south end, the NPS maintenance facility is moved outside of the Memorial boundary to make way for a new education and research center, increasing the number of visitors to that portion of the park.

The NPS will continue to work with the City of St. Louis to proactively encourage compatible riverfront improvements on the west bank of the Mississippi River, and initiates similar partnerships for the east bank of the Mississippi River. The NPS continues existing partnerships for the provision of educational and interpretive programs, visitor services and transportation, and develops new partnerships to assist in the new education and research center, the multi-modal transit center and the management of the East St. Louis addition.

Barrier-free routes from the Arch grounds to the riverfront are established within the Memorial, and existing entrances to the visitor center and museum under the Arch are redesigned to meet ADA/universal design standards. Visitor screening for security under the Arch stays at the current entrances. Any new facilities developed under this alternative include barrier-free access and heightened security requirements.

On-site visitor parking is eliminated at the north end of the park and adjacent to the Old Cathedral. Visitors are directed to use existing parking lots and garages outside the Memorial. An improved bus/shuttle drop-off and pick-up is added adjacent to the Old Cathedral. The food service (vending) currently available in the existing visitor center under the Arch is expanded, and may be provided for elsewhere at the Memorial.

The 91-acre boundary of the Memorial is amended to add approximately 65 acres in East St. Louis. Any acquisitions are by willing seller only.

How We Got Here

In June 2008, the National Park Service (NPS) released a set of preliminary alternatives outlining potential management scenarios for Jefferson Expansion National Memorial. Thousands of comments were received and subsequently analyzed by the NPS. As a result of public input, Alternative 2 was dropped and the remaining preliminary alternatives were revised. These alternatives will be described in more detail in the Draft General Management Plan / Environmental Impact Statement (GMP/EIS) to be released for public review and comment during January 2009.



revised Preliminary Alternative 5 - Park into the City

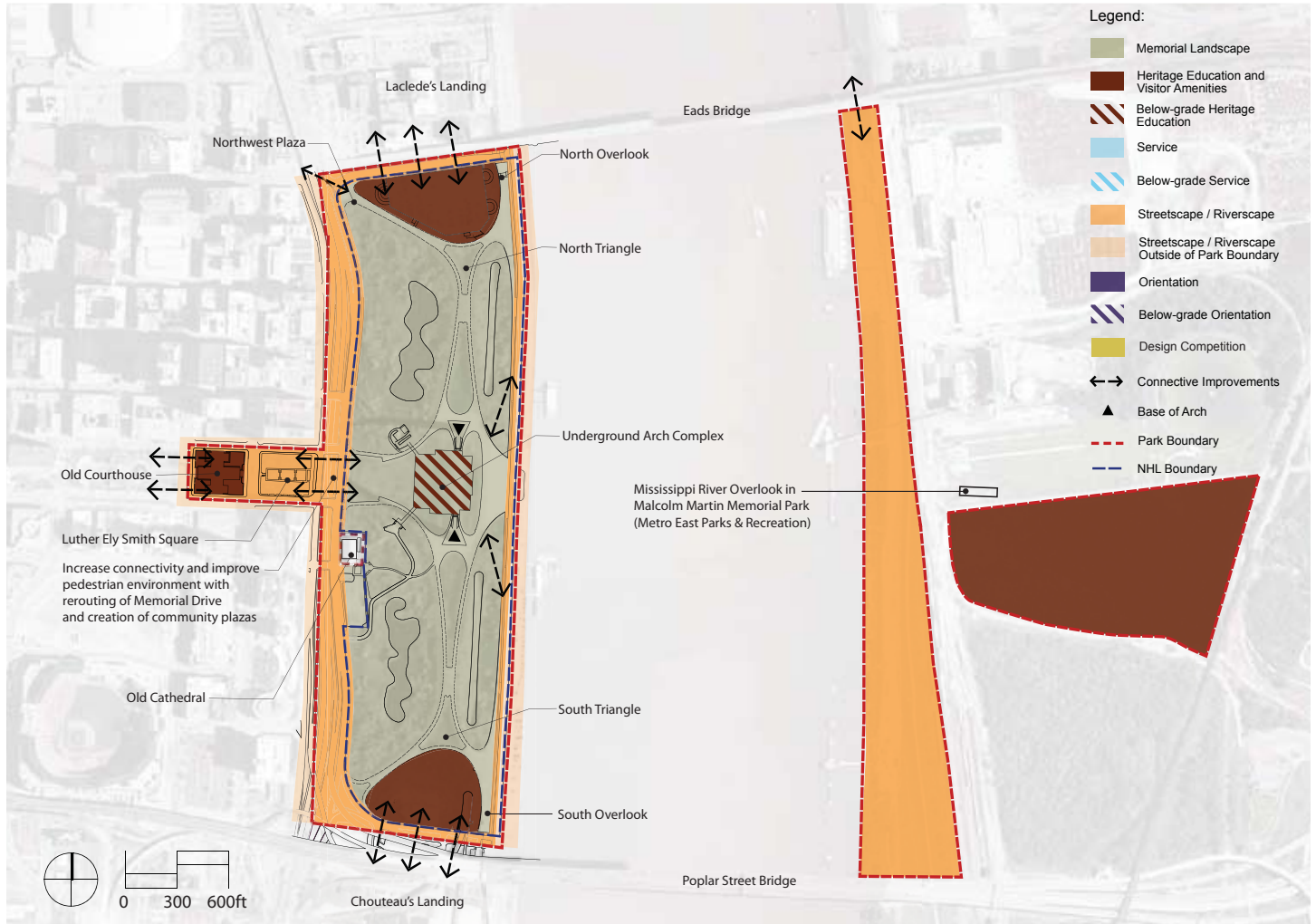

Heritage Education and Visitor Amenities	Original Landscape	Orientation	Streetscape	Service	Design Competition
Provide visitor orientation, interpretation, education and amenities.	Preservation of the National Historic Landmark (NHL).	Provide visitor orientation, enhance visual and physical connectivity and support Memorial operations (parking).	Create visual and physical connectivity between the city streets, waterfront and the Memorial.	Support Memorial operations.	Provide a canvass for a design competition to explore creative approaches to revitalizing the Memorial.

Next Steps

The No Action alternative and alternatives 3, 4 and 5 will be carried forward into the Draft Jefferson National Expansion Memorial GMP/EIS, to be released in Winter 2009. In the draft plan, each of the alternatives will be more fully described and the financial and environmental consequences of each alternative will be presented. The public will have 45 days to review the document, and during this time, the NPS will host public meetings in order to provide the public an opportunity to speak directly with park managers and members of the planning team. I encourage everyone to comment on the document and provide ways the alternatives can be strengthened.

Following the close of public review, each of your comments will be read and considered carefully. The team will respond to all substantive comments and document any changes to the plan before issuing a final GMP/EIS.

Sincerely,