

TOWN OF BROOKHAVEN, NEW YORK

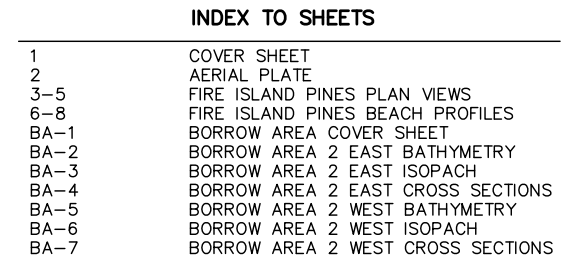

FIRE ISLAND PINES, FIRE ISLAND, NEW YORK			
PROFILE	RANGE 00 (COMMENCEMENT POINT)		
	EASTING	NORTHING	AZIMUTH
FIP-1+310	1240154.9	181621.2	159.0
FIP-2	1240301.0	181663.0	159.0
FIP-3	1240795.0	181848.0	159.0
FIP-4	1241331.0	181991.0	159.0
FIP-5	1241860.0	182179.0	159.0
F-40	1242413.1	182337.2	159.0
FIP-7	1242896.0	182550.0	159.0
FIP-8	1243352.0	182672.0	159.0
FIP-9	1243771.2	182806.4	159.0
FIP-10	1244305.0	183017.0	159.0
FIP-11	1244710.0	183215.0	159.0
FIP-12	1245296.0	183331.0	159.0
FIP-13	1245761.0	183606.0	159.0
FIP-13+435	1246209.5	183651.7	159.0

COASTAL PLANNING & ENGINEERING OF NY PC
2481 N.W. BOCA RATON BOULEVARD
BOCA RATON, FLORIDA 33431
PH. (561) 391-8102
FAX (561) 391-9116
C.O.A. NY #4582
www.CoastalPlanning.net

[illegible]

FINE ISLAND FINES SEGMENT
FIRE ISLAND, NEW YORK
2008 BEACH RENOURISHMENT PROJECT
COVER SHEET

DRAWING NO.

S

SHEET 1 OF 15

THOMAS J CAMPBELL P.E. NO. 56457

DATE _____

FIRE ISLAND PINES

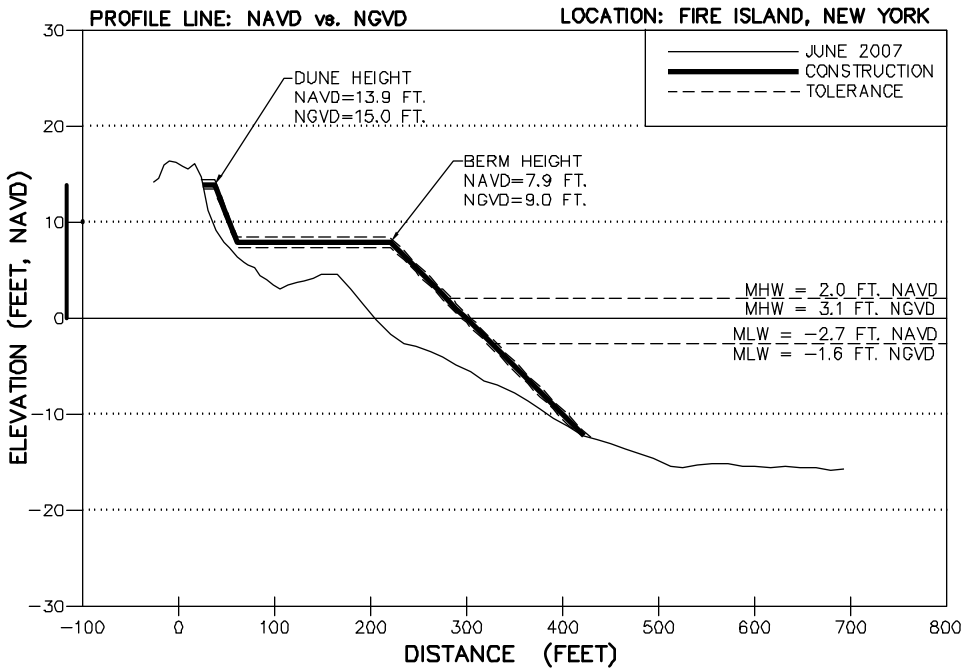

- NOTES:**
1. DATE OF AERIAL PHOTOGRAPH: 12/18/2007.
 2. AERIAL FLOWN BY GEOMAPS INTERNATIONAL AERIAL PHOTOGRAMMETRY.

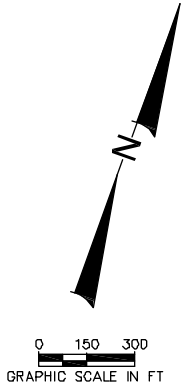

THOMAS J CAMPBELL P.E. NO. 56457

DATE

COASTAL PLANNING & ENGINEERING OF NY PC
2481 M.W. BOCA RATON BOULEVARD
BOCA RATON, FLORIDA 33431
PH: (561) 391-8102
FAX (561) 391-8116
C.O.A. NY #4582
www.CoastalPlanning.net



No.	Date	Description
1	5/20/04	RESPONSE TO USACE RFI

Designed by:	Checked by:
SK	AMB
Drawn by:	Reviewed by:
JRC	SK
Date:	Submitted by:
2/22/08	SK
Plot Scale:	Comm. No:
AS NOTED	7300.32

Reference Files:
2008_Aerial_Photogrammetry

FIRE ISLAND PINES SEGMENT
FIRE ISLAND, NEW YORK
2008 BEACH RENOVATION PROJECT
AERIAL PLATES

DRAWING NO.

AP

SHEET 2 OF 15

N:\NEW YORK\FIRE ISLAND PINES CONSTRUCTION\2008-FIRE ISLAND PINES-PLAN VIEW.dwg

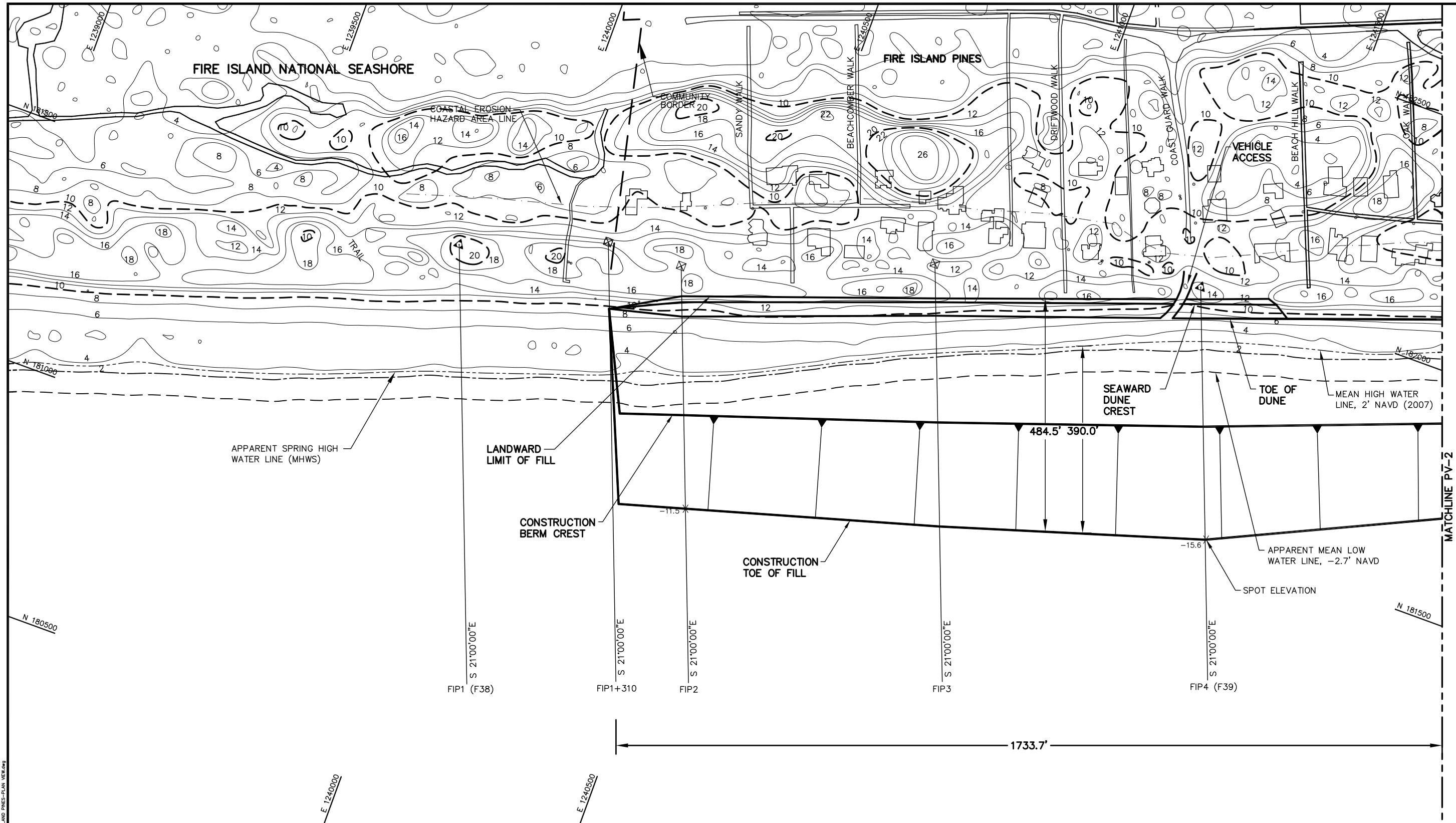

- NOTES:**
- COORDINATES ARE BASED ON NEW YORK LONG ISLAND LAMBERT STATE PLANE COORDINATE SYSTEM, NORTH AMERICAN DATUM 1983 (NAD83).
 - TOPOGRAPHIC CONTOURS SHOWN ARE IN FEET NAVD88 FROM A LIDAR SURVEY FLOWN APRIL 29, 2007 BY THE USGS EAARL SYSTEM.
 - THE PROJECT WILL DREDGE APPROXIMATELY 942,000± CUBIC YARDS FROM BORROW AREA 2-EAST FOR THE FIRE ISLAND PINES AND DAVIS PARK SEGMENT BEACHES. A CUTTER HEAD OR HOPPER DREDGE WILL BE USED TO TAKE THE SAND FROM THE OFFSHORE BORROW AREA AND PUMP IT TO THE BEACH USING A COMBINATION OF SUBMERGED AND BEACH PIPELINES. THE BEACH/DUNE WILL BE SHAPED AND GRADED USING BULLDOZERS, FRONT END LOADERS, AND SIMILAR HEAVY CONSTRUCTION EQUIPMENT. THE FILL MATERIAL IS 98% SAND AND 2% SILT.
 - ALONG SHORE CURRENTS ARE WAVE DOMINATED IN AN EAST TO WEST DIRECTION.
 - THE BEACH VOLUME FOR FIRE ISLAND PINES IS APPROXIMATELY 500,000 C.Y., WITH 189,200 C.Y. SEAWARD OF THE SPRING TIDE LINE. IF TAPERS CANNOT BE PLACED ON FINS PROPERTY, THE TAPER VOLUME WILL BE PLACED WITHIN THE FIRST 1000 FEET WITHIN THE COMMUNITY.
- LEGEND:**
- ☒ COMMENCEMENT POINT
RNG 00
 - ▲ USACE SURVEY MONUMENTS
 - CONTOURS
 - 10' & 20' CONTOURS
 - - - MEAN HIGH WATER LINE
 - - - SPRING HIGH WATER LINE
 - 4.7X SPOT ELEVATION

COASTAL PLANNING & ENGINEERING OF NY PC

2481 N.W. BOCA RATON BOULEVARD
BOCA RATON, FLORIDA 33431

PH. (561) 391-8102
FAX (561) 391-9116

www.CoastalPlanning.net

C.O.A. NY #4592

Reference Files:	Designed by:	Checked by:	Submitted by:	Comm. No:	No.	Date	Description
73002_000000	SK	AMB	SK	7300.32			
	Drawn by:	Reviewed by:	Submitted by: <td></td> <td></td> <td></td> <td></td>				
	JRC	SK	SK				
	Date:						
	2/22/08						
	Print Scale:						
	AS NOTED						

FIRE ISLAND PINES SEGMENT
FIRE ISLAND, NEW YORK
2008 BEACH RENOURISHMENT PROJECT

PLAN VIEW

DRAWING NO.

PV-1

SHEET 3 OF 15

N:\NEW YORK\PIES\2008\FI PINES CONSTRUCTION\2008-FIRE ISLAND PINES-PLAN VIEW.dwg

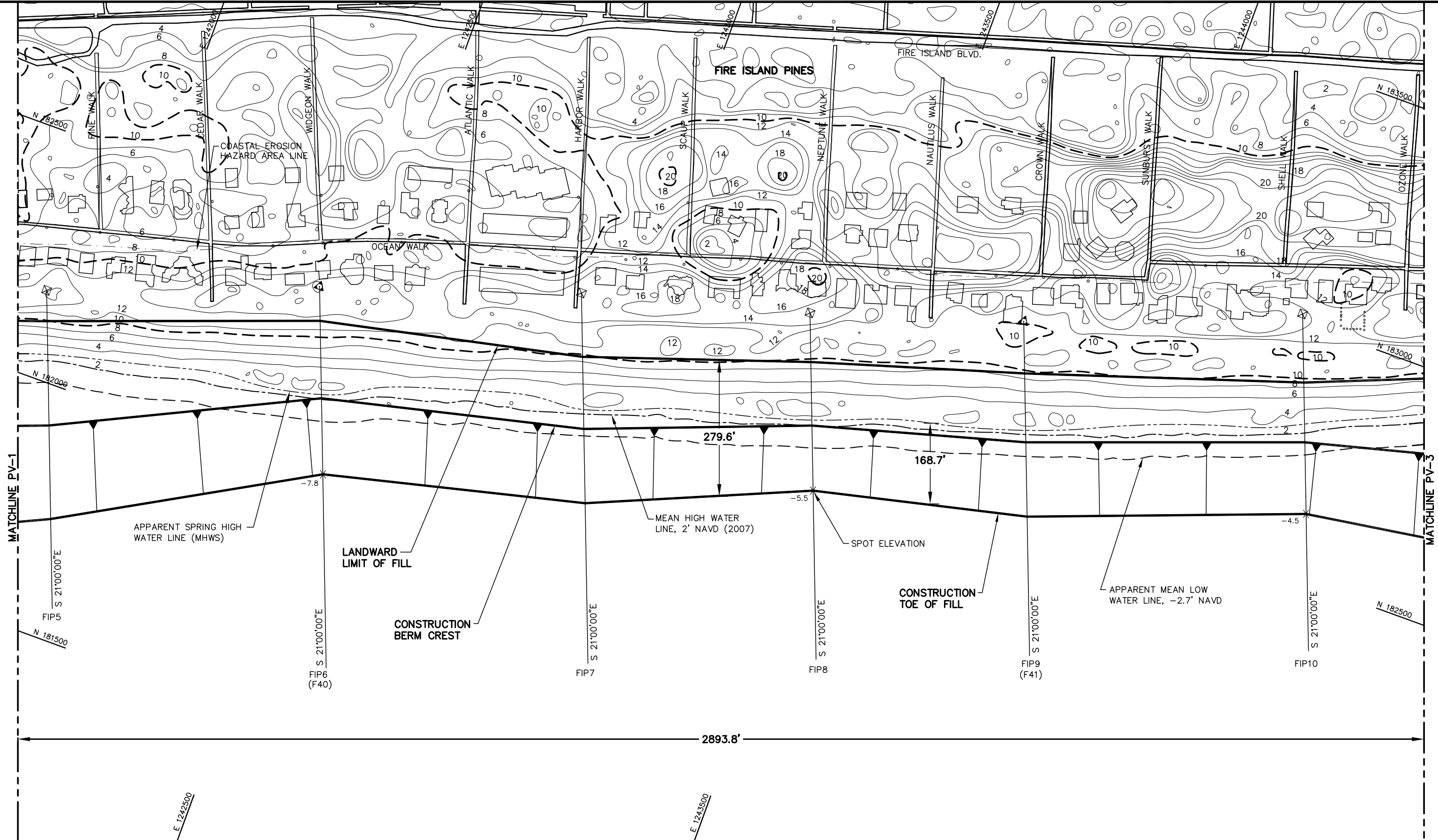

NOTES:

- COORDINATES ARE BASED ON NEW YORK LONG ISLAND LAMBERT STATE PLANE COORDINATE SYSTEM, NORTH AMERICAN DATUM 1983 (NAD83).
- TOPOGRAPHIC CONTOURS SHOWN ARE IN FEET NAVD88 FROM A LIDAR SURVEY FLOWN APRIL 29, 2007 BY THE USGS EAARL SYSTEM.
- THE PROJECT WILL DREDGE APPROXIMATELY 942,000± CUBIC YARDS FROM BORROW AREA 2-EAST FOR THE FIRE ISLAND PINES AND DAVIS PARK SEGMENT BEACHES. A CUTTER HEAD OR HOPPER DREDGE WILL BE USED TO TAKE THE SAND FROM THE OFFSHORE BORROW AREA AND PUMP IT TO THE BEACH USING A COMBINATION OF SUBMERGED AND BEACH PIPELINES. THE BEACH/DUNE WILL BE SHAPED AND GRADED USING BULLDOZERS, FRONT END LOADERS, AND SIMILAR HEAVY CONSTRUCTION EQUIPMENT. THE FILL MATERIAL IS 98% SAND AND 2% SILT.
- ALONG SHORE CURRENTS ARE WAVE DOMINATED IN AN EAST TO WEST DIRECTION.
- THE BEACH VOLUME FOR FIRE ISLAND PINES IS APPROXIMATELY 500,000 C.Y., WITH 189,200 C.Y. SEAWARD OF THE SPRING TIDE LINE.

LEGEND:

- ☒ COMMENCEMENT POINT
- RNG 00
- ▲ USACE SURVEY MONUMENTS
- CONTOURS
- 10' & 20' CONTOURS
- MEAN HIGH WATER LINE
- SPRING HIGH WATER LINE
- 4.7' X SPOT ELEVATION

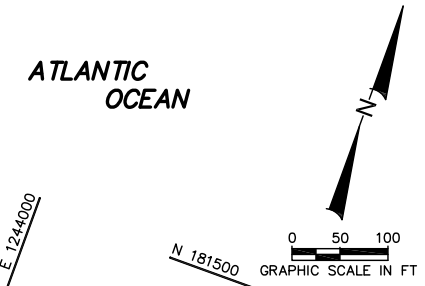

THOMAS J CAMPBELL P.E. NO. 56457

DATE

COASTAL PLANNING & ENGINEERING OF NY PC

2481 N.W. BOCA RATON BOULEVARD
BOCA RATON, FLORIDA 33431

PH. (561) 391-8102
FAX (561) 391-9116

www.CoastalPlanning.net

C.O.A. NY #4592

Reference Files:	Designed by:	Checked by:	Drawn by:	Reviewed by:	Submitted by:	Date:	Print Scale:	Comm. No.:	No.:	Date:	Description:
73052_000.dwg	SK	AMB	JRC	SK	SK	2/22/08	AS NOTED	7300.32			

FIRE ISLAND PINES SEGMENT
FIRE ISLAND, NEW YORK
2008 BEACH RENOURISHMENT PROJECT

PLAN VIEW

DRAWING NO.

PV-2

SHEET 4 OF 15

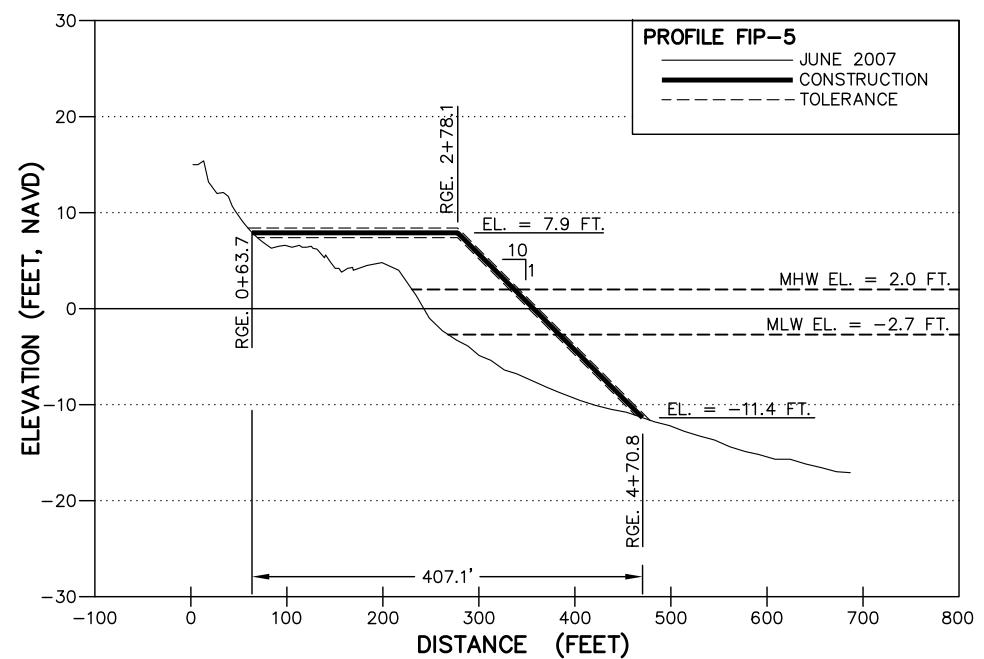
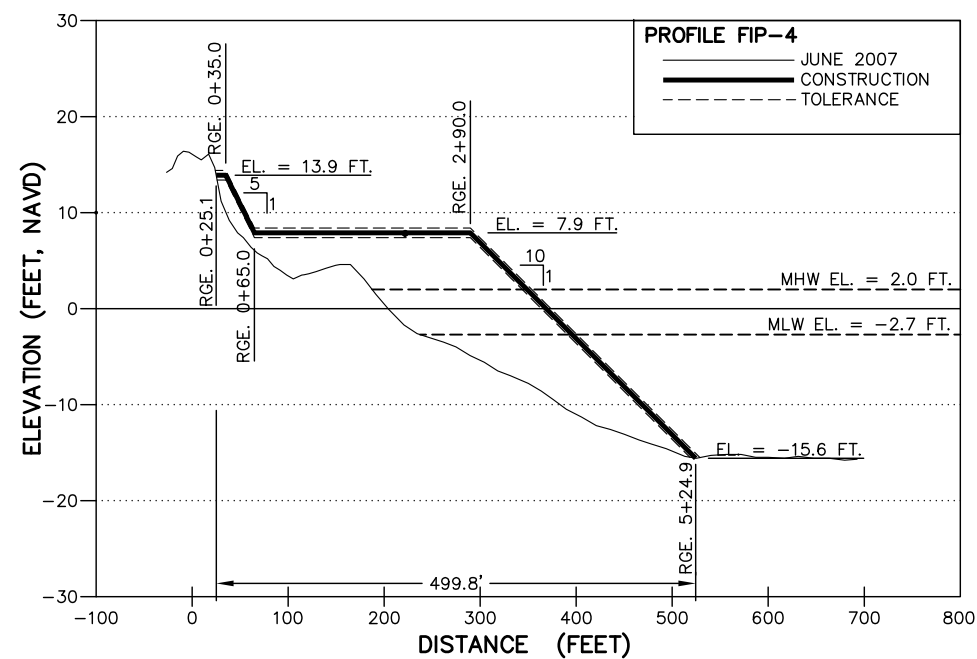
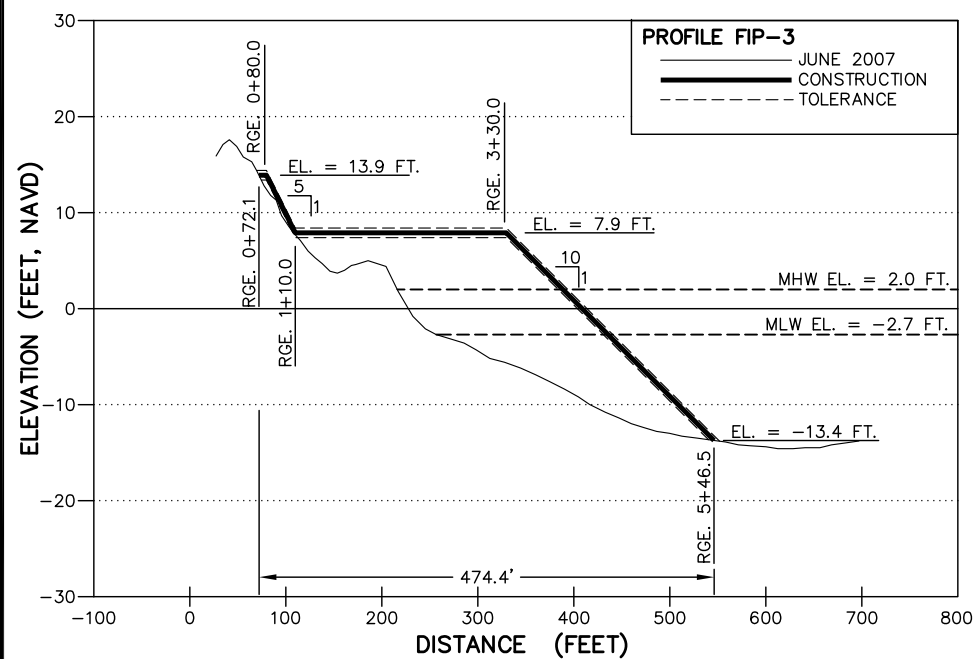
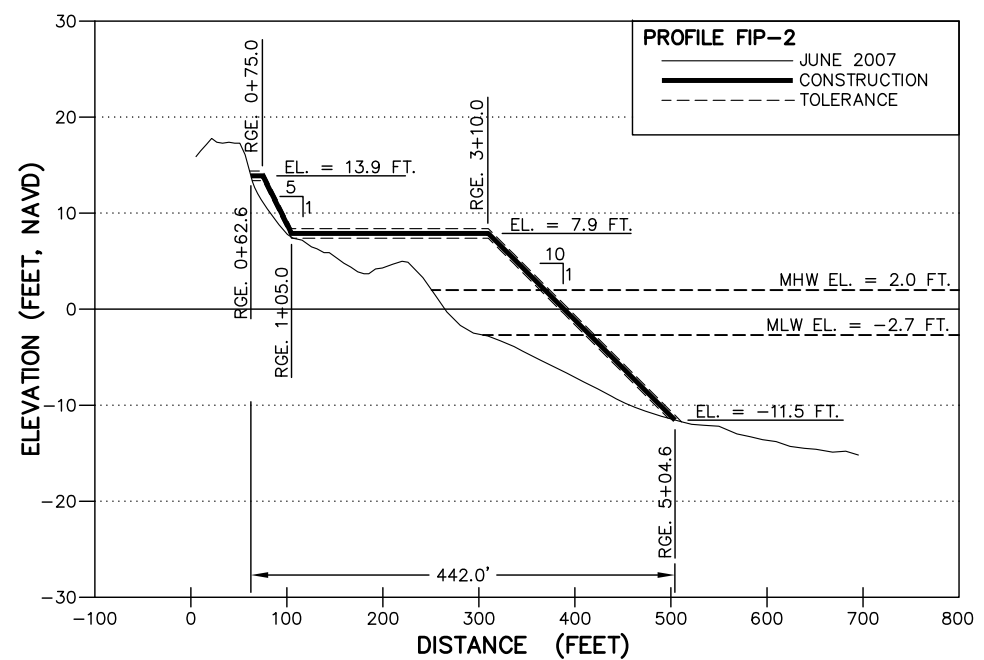
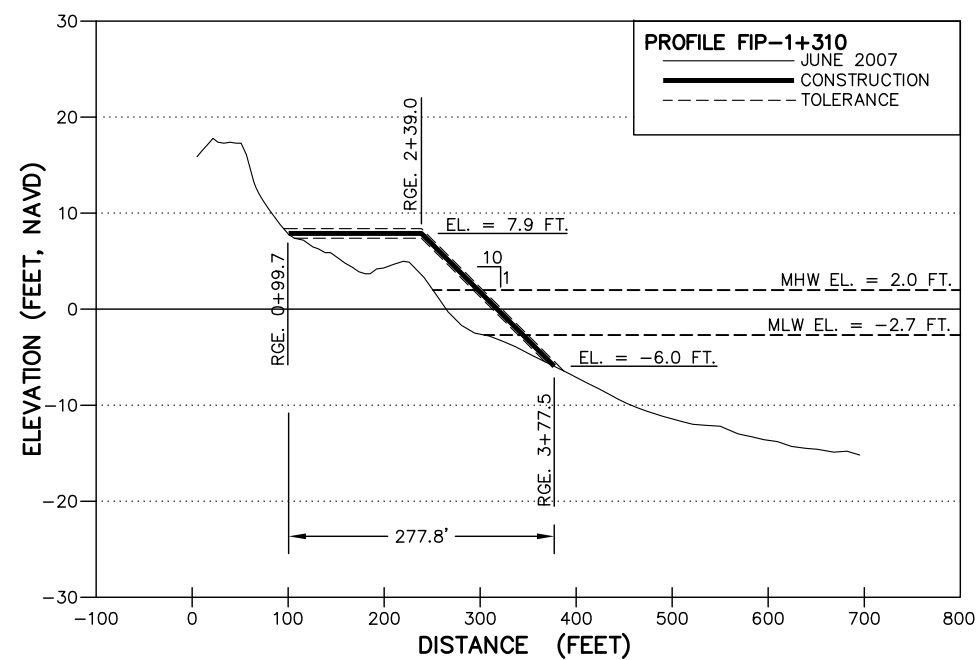
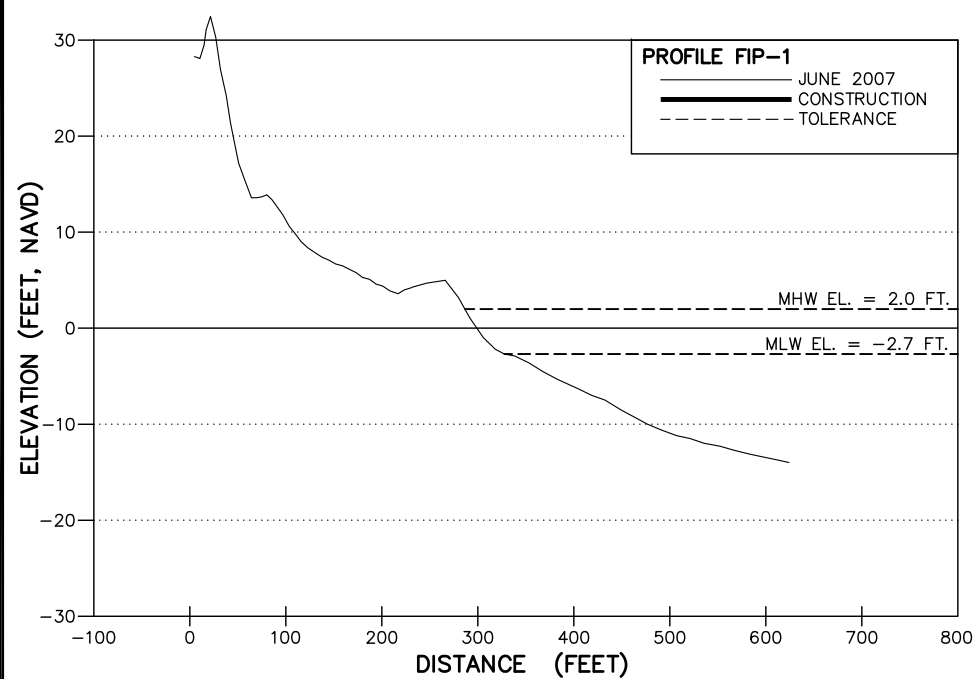

NOTES:

1. ELEVATIONS ARE IN FEET BASED ON THE NORTH AMERICAN VERTICAL DATUM OF 1988 (NAVD,88).
2. TOLERANCE: ± 0.5 FT.

HORIZONTAL SCALE:  GRAPHIC SCALE IN FT

VERTICAL SCALE:  GRAPHIC SCALE IN FT

THOMAS J CAMPBELL P.E. NO. 56457

DATE _____

COASTAL PLANNING & ENGINEERING OF NY PC
PH, (561) 391-8102
FAX (561) 391-9116
C.O.A. NY #4582
www.CoastalPlanning.net

[illegible]

Designed by: SK	Checked by: AMB
Drawn by: TM	Reviewed by: SK
Date: 2/22/08	Submitted by: SK
Plot Scale: AS NOTED	Comm. No.: 7300.32

Reference Files:
30032_BORDER.DWG

**FIRE ISLAND PINES SEGMENT
FIRE ISLAND, NEW YORK
2008 BEACH RENOURISHMENT PROJECT**

DRAWING NO.

PR-1

SHEET 6 OF 15

H:\New York\PROJECTS\2003\CONSTRUCTION\FIRE ISLAND PINES\2003\FIP_Profiles.dwg - Jul 01, 2008 @ 3:15pm - addden

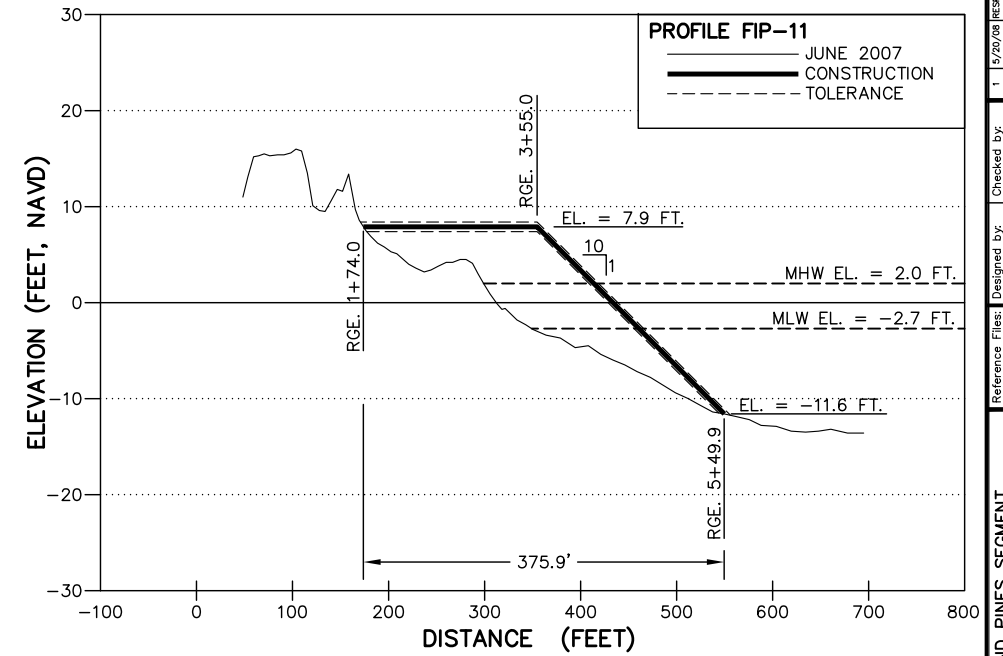
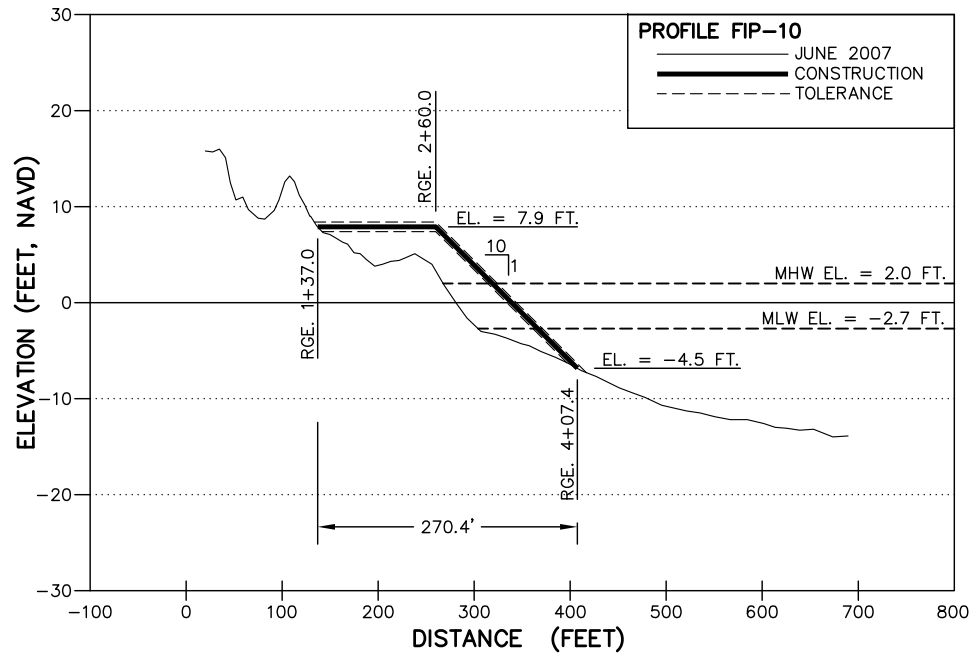
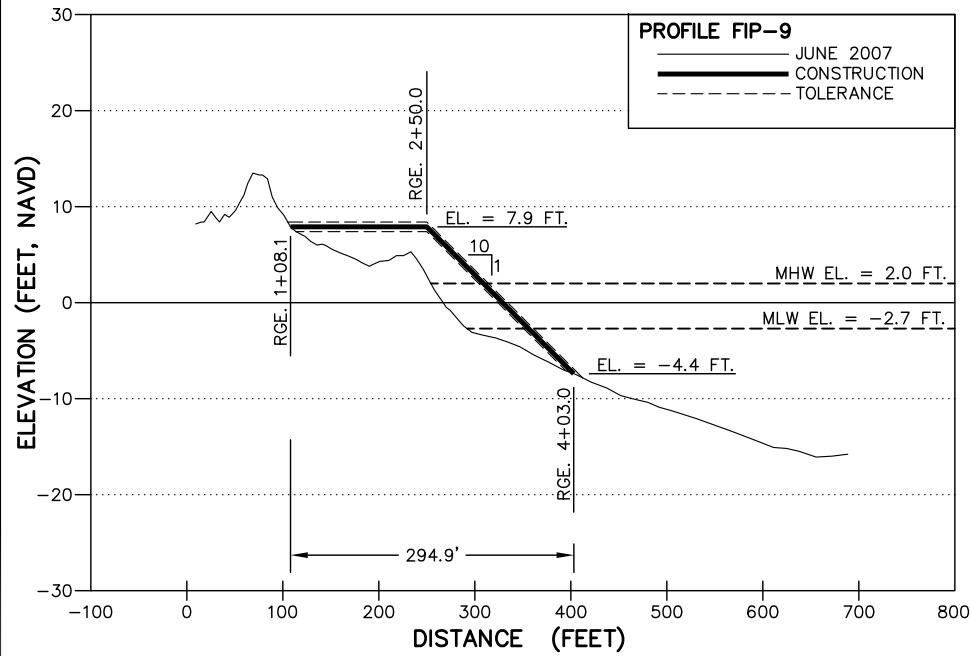
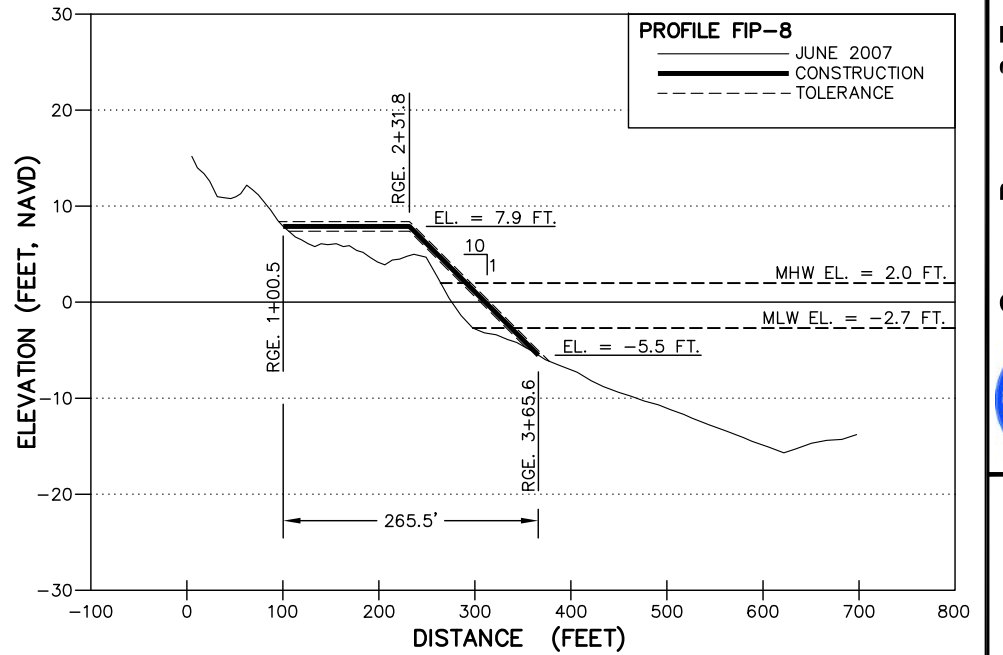
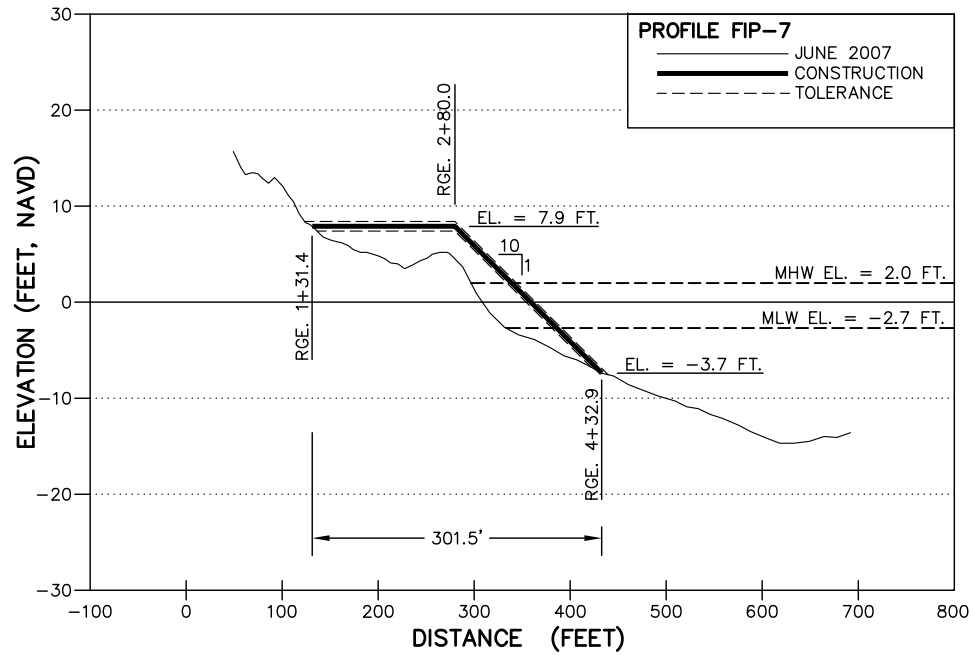
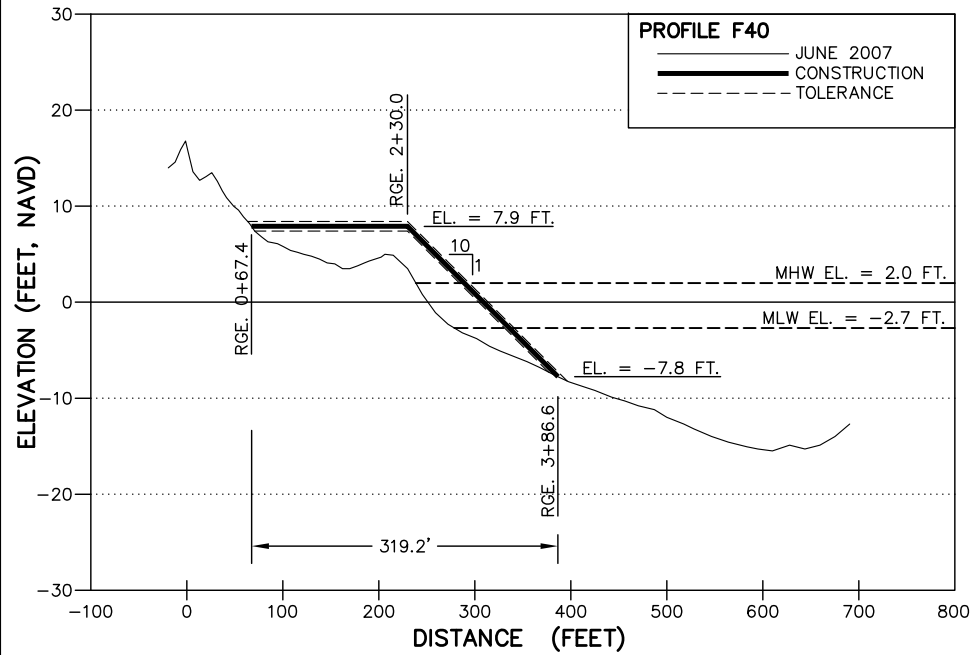

NOTES:

- ELEVATIONS ARE IN FEET BASED ON THE NORTH AMERICAN VERTICAL DATUM OF 1988 (NAVD,88).
- TOLERANCE: ± 0.5 FT.

HORIZONTAL SCALE: 0 50 100
GRAPHIC SCALE IN FT
VERTICAL SCALE: 0 5 10
GRAPHIC SCALE IN FT

THOMAS J CAMPBELL P.E. NO. 56457

DATE



2	6/25/08	FMS EA
No.	Date	Description

SK	Drawn by: TM	Reviewed by: SK	AMB
	Date: 2/22/08	Submitted by: SK	
	Plot Scale: AS NOTED	Comm. No.: 7300.32	

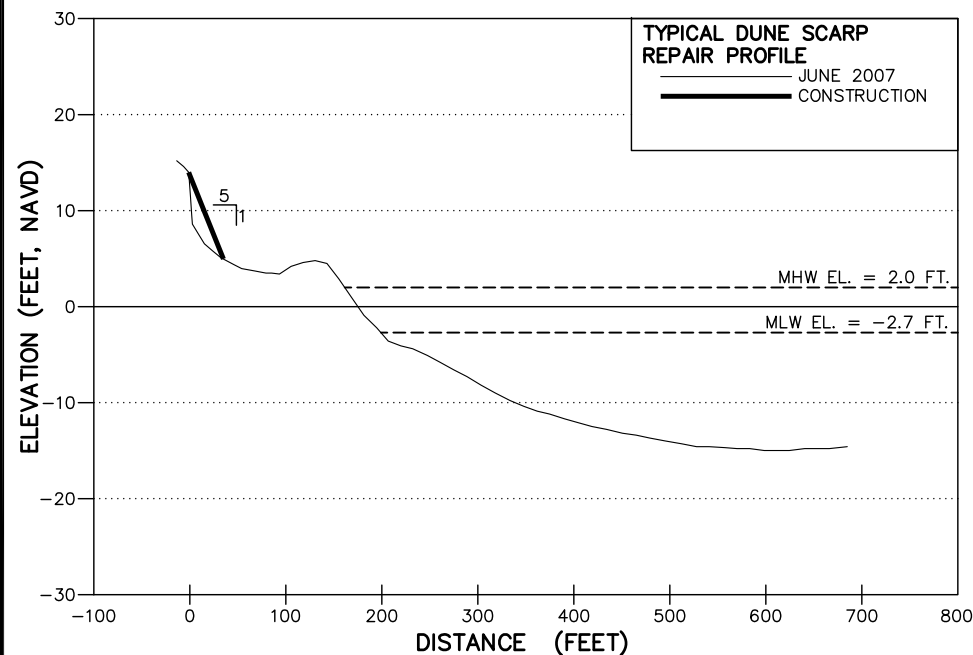
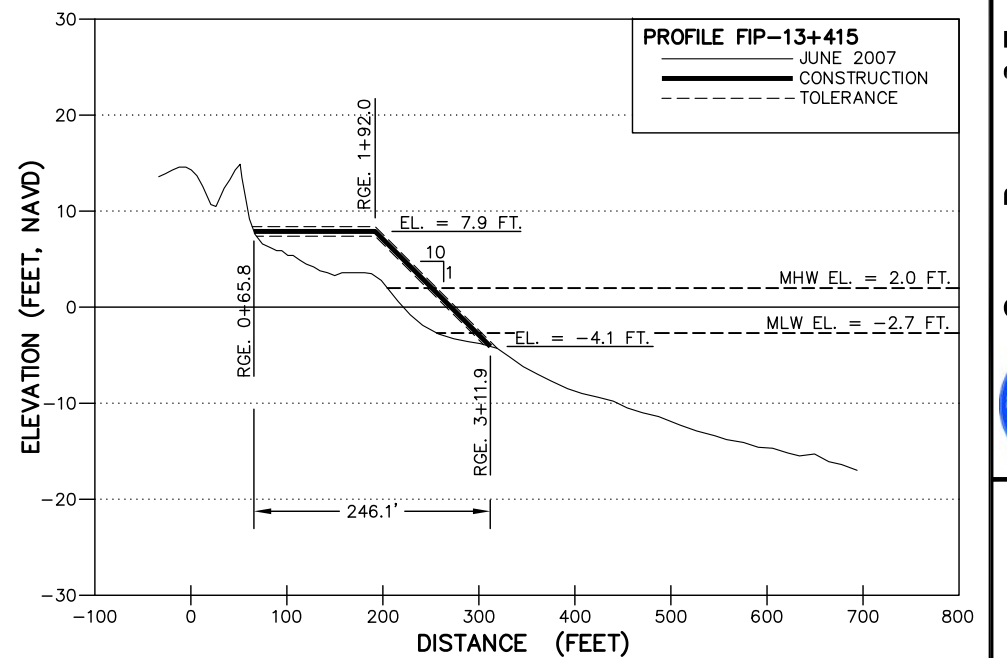
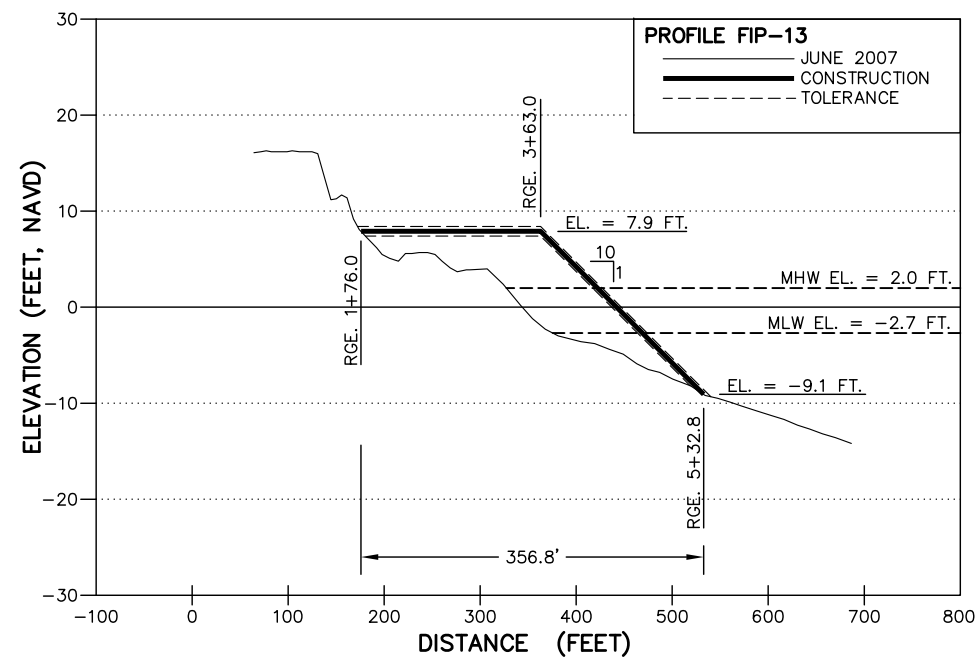
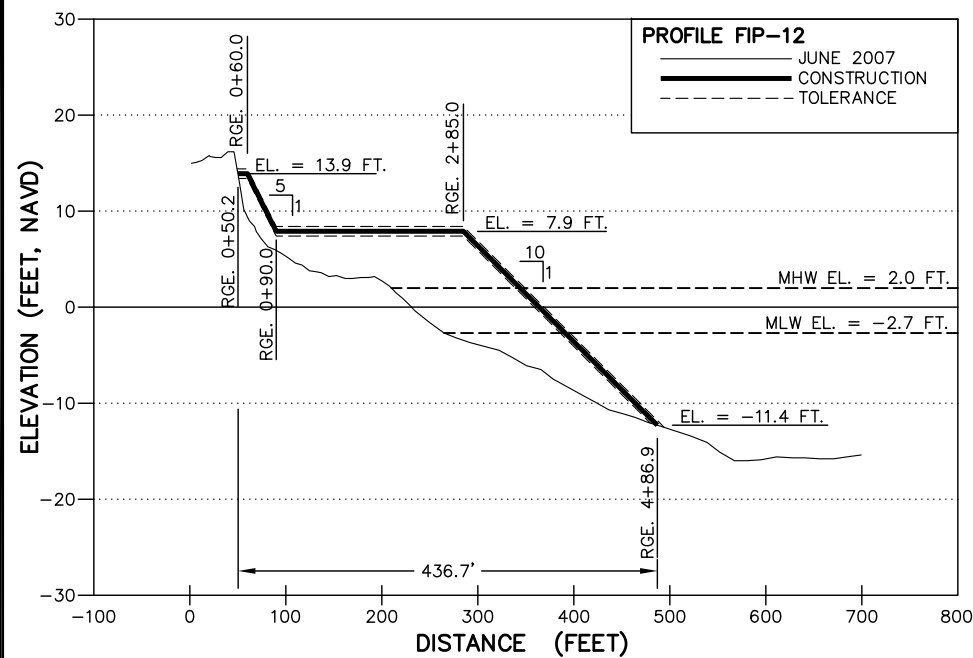



TYPICAL DUNE SCARP REPAIR PROFILE:

THE SCARP WILL BE REPAIRED BY PUSHING SAND INTO A 1V:5H SLOPE TO COVER THE SCARPED FACE OF THE DUNE. THE REPAIR WILL NOT INCREASE THE DUNE WIDTH.

NOTES:

1. ELEVATIONS ARE IN FEET BASED ON THE NORTH AMERICAN VERTICAL DATUM OF 1988 (NAVD,88).
2. TOLERANCE: ± 0.5 FT.

HORIZONTAL SCALE:  0 50 100
GRAPHIC SCALE IN FT

VERTICAL SCALE:  0 5 10
GRAPHIC SCALE IN FT

THOMAS J CAMPBELL P.E. NO. 56457

DATE _____

COASTAL PLANNING & ENGINEERING OF NY PC
2481 N.W. BOCA RATON BOULEVARD
BOCA RATON, FLORIDA 33431
PH. (561) 391-8102
FAX (561) 391-9116
C.O.A. NY #4582
www.CoastalPlanning.net



DRAWING NO.		PR-3	
SHEET 8 OF 15			
FIRE ISLAND PINES FIRE ISLAND RENOURNISHMENT PROJECT		730032_BORDER.DWG	
SK	AMB	Reviewed by:	
TM	SK	Drawn by:	
Date:	2/22/08	Submitted by:	
Plot Scale:	AS NOTED	Comm. No.:	
		No.	Date
		Description	