

SURPLUS SAND FROM THE SEAWARD EDGE OF THE "SUMMER" BEACH PROFILE PROPOSED TO BE RELOCATED TO AUGMENT THE PRIMARY DUNE (APPROX. 2.2 CUBIC YARDS PER LINEAR FOOT)

PROPOSED BORROW AREA IN THE SEAWARD EDGE OF "SUMMER" BEACH PROFILE (MAX. 60' WIDE), (AVERAGE 1' DEEP), APPROX. 2.2 CUBIC YARDS PER LINEAR FOOT

AREA OF AUGMENTED DUNE TO BE ESTABLISHED WITH CAPE AMERICAN BEACHGRASS (*Ammophila brevifolius*) ON 18" CENTERS

MONITOR STATION (4" X 4" POST BEHIND PRIMARY DUNE) (REFERENCED TO NGVD '29)

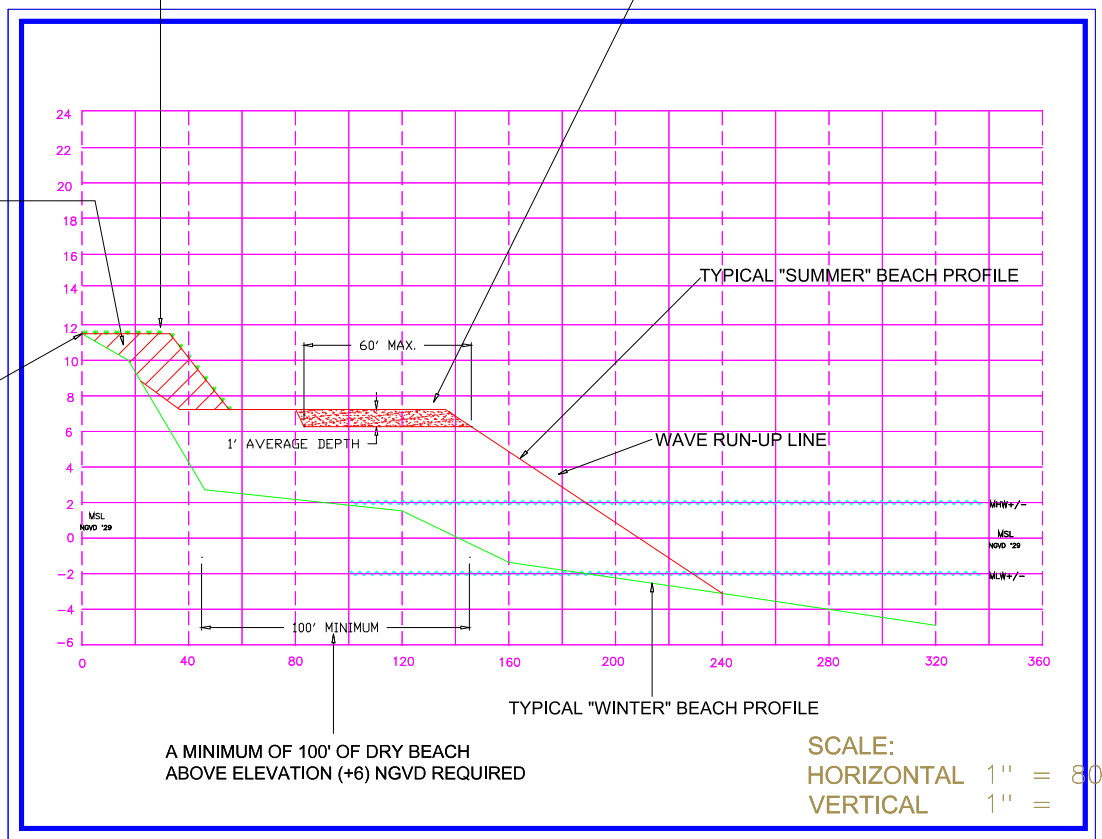

TYPICAL SECTION VIEW:

SURPLUS SAND FROM THE SEAWARD EDGE OF THE "SUMMER" BEACH PROFILE PROPOSED TO BE RELOCATED TO AUGMENT THE PRIMARY DUNE (APPROX. 2.2 CUBIC YARDS PER LINEAR FOOT)

PROPOSED BORROW AREA IN THE SEAWARD EDGE OF "SUMMER" BEACH PROFILE (MAX. 60' WIDE), (AVERAGE 1' DEEP), APPROX. 2.2 CUBIC YARDS PER LINEAR FOOT

AREA OF AUGMENTED DUNE TO BE ESTABLISHED WITH CAPE AMERICAN BEACHGRASS (*Ammophila brevigulata*) ON 18" CENTERS

MONITOR STATION (4" X 4" POST BEHIND PRIMARY DUNE) (REFERENCED TO NGVD '29)

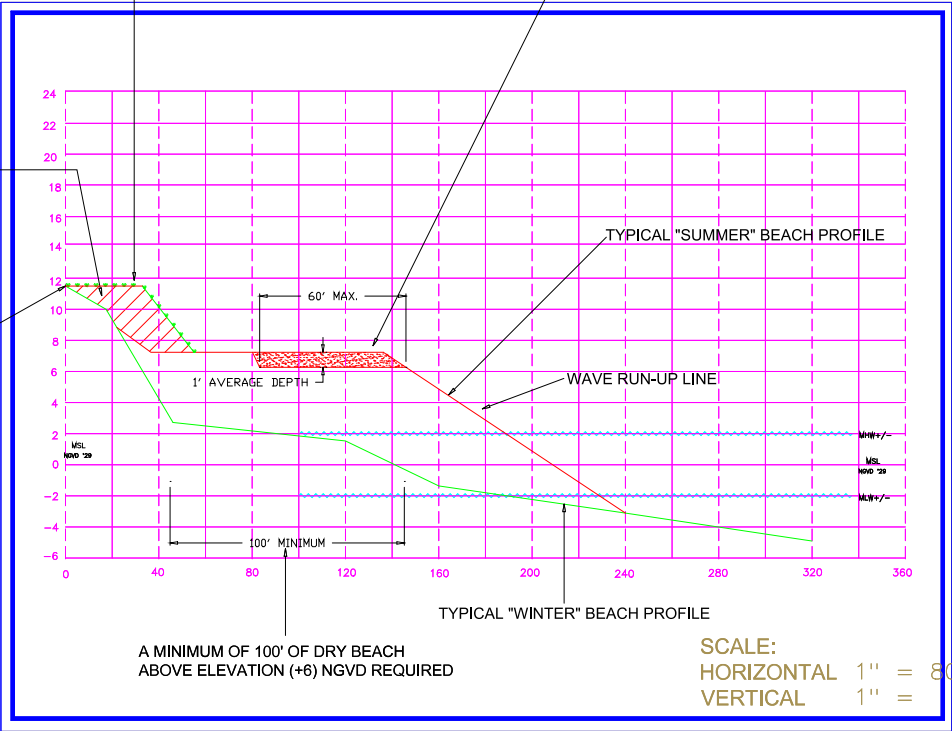

SECTION VIEW:	PROPOSED: BEACH SCRAPING PROJECT	DATE: 03-25-08
SCALE: AS NOTED	AT FIRE ISLAND COMMUNITIES	S.C.F.M.#
LAND USE ECOLOGICAL SERVICES INC.	PURPOSE: EROSION CONTROL	DWG.#
		R-045
		SHEET 2 OF 2

**NOTES:**

- 1.SURPLUS SAND FROM THE SEAWARD EDGE OF THE "SUMMER" BEACH PROFILE PROPOSED TO BE RELOCATED TO AUGMENT THE PRIMARY DUNE (APPROX. 2.2 CUBIC YARDS PER LINEAR FOOT)
- 2.PROPOSED BORROW AREA IN THE SEAWARD EDGE OF "SUMMER" BEACH PROFILE (MAX. 60' WIDE), (AVERAGE 1' DEEP), APPROX. 2.2 CUBIC YARDS PER LINEAR FOOT
- 3.AREA OF AUGMENTED DUNE TO BE ESTABLISHED WITH CAPE AMERICAN BEACHGRASS (*Ammophila brevigulata*) ON 18" CENTERS
- 4.A MINIMUM OF 100' OF DRY BEACH ABOVE ELEVATION (+6) NGVD REQUIRED
- 5.MONITOR STATION (4" X 4" POST BEHIND PRIMARY DUNE) (REFERENCED TO NGVD '29)

**PLAN VIEW:**  
SCALE: 1" = 200'

**LAND USE ECOLOGICAL SERVICES INC.**  
PO BOX 1060  
RIVERHEAD, N.Y. 11901  
PHONE (631)-727-2400 FAX (631)-727-2605

PROPOSED: BEACH SCRAPING PROJECT  
PURPOSE: EROSION CONTROL  
AT: VLG. OF KISMET BEACH  
KISMET, F.I.- SUFFOLK COUNTY N.Y.  
APPLICANT: VLG. OF KISMET

DATE:  
03-25-08  
S.C.T.M.#

DWG. #  
B-045

SHEET 1 OF 2

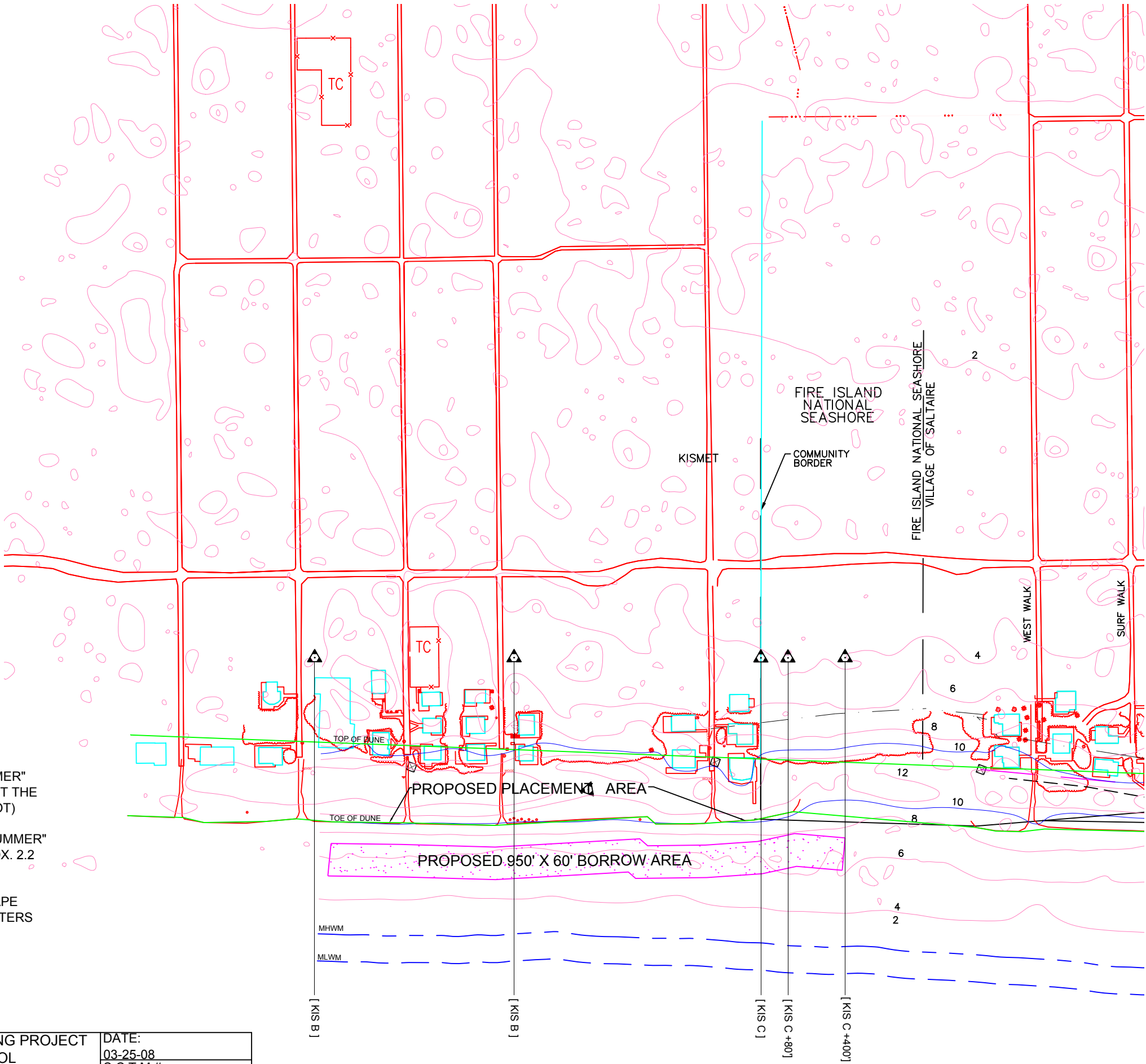

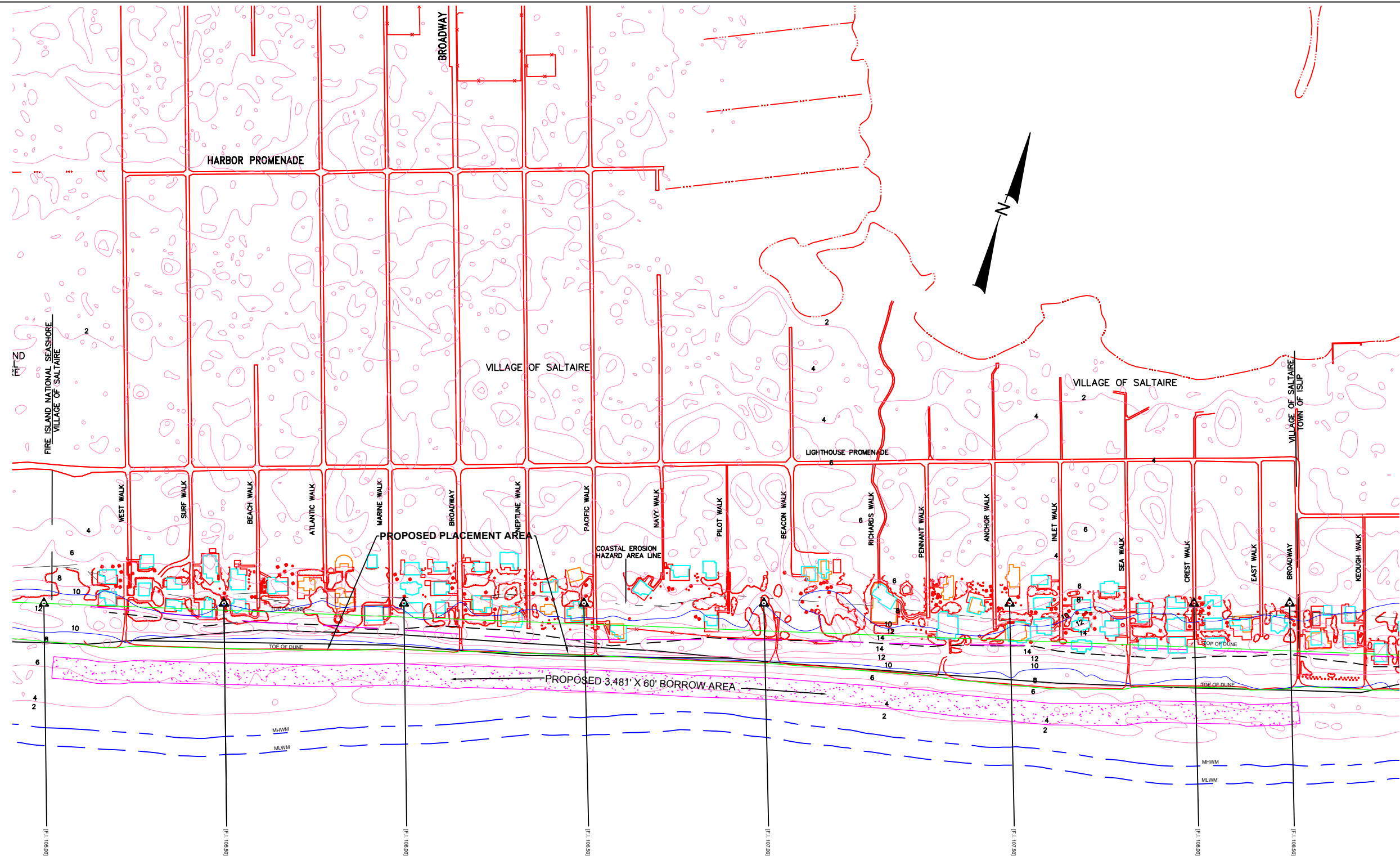

NOTES:

1. SURPLUS SAND FROM THE SEAWARD EDGE OF THE "SUMMER" BEACH PROFILE PROPOSED TO BE RELOCATED TO AUGMENT THE PRIMARY DUNE (APPROX. 2.2 CUBIC YARDS PER LINEAR FOOT)
2. PROPOSED BORROW AREA IN THE SEAWARD EDGE OF THE "SUMMER" BEACH PROFILE (MAX. 60' WIDE). (AVERAGE 1' DEEP), APPROX. 202 CUBIC YARDS PER LINEAR FOOT
3. AREA OF THE AUGMENTED DUNE TO BE ESTABLISHED WITH CAPE AMERICAN BEACH GRASS (*Ammophila brevigulata*) ON 18" CENTERS
4. A MINIMUM OF 100' OF DRY BEACH ABOVE ELEVATION (6+) NGVD REQUIRED
5. MONITOR STATION (4" X 4" POST BEHIND PRIMARY DUNE REFERENCED TO NGVD '29)

**PLAN VIEW:**  
SCALE: 1" = 300'  
**LAND USE ECOLOGICAL SERVICES INC.**  
PO BOX 1060  
RIVERHEAD, N.Y. 11901  
PHONE (631)-727-2400 FAX (631)-727-2605

PROPOSED: BEACH SCRAPING PROJECT  
PURPOSE: EROSION CONTROL  
AT: VLG. OF SALTARE BEACH  
SALTARE, F.I.- SUFFOLK COUNTY N.Y.  
APPLICANT: VLG. OF SALTARE

DATE:  
03-25-08  
S.C.T.M.#  
  
SHEET 1 OF 2



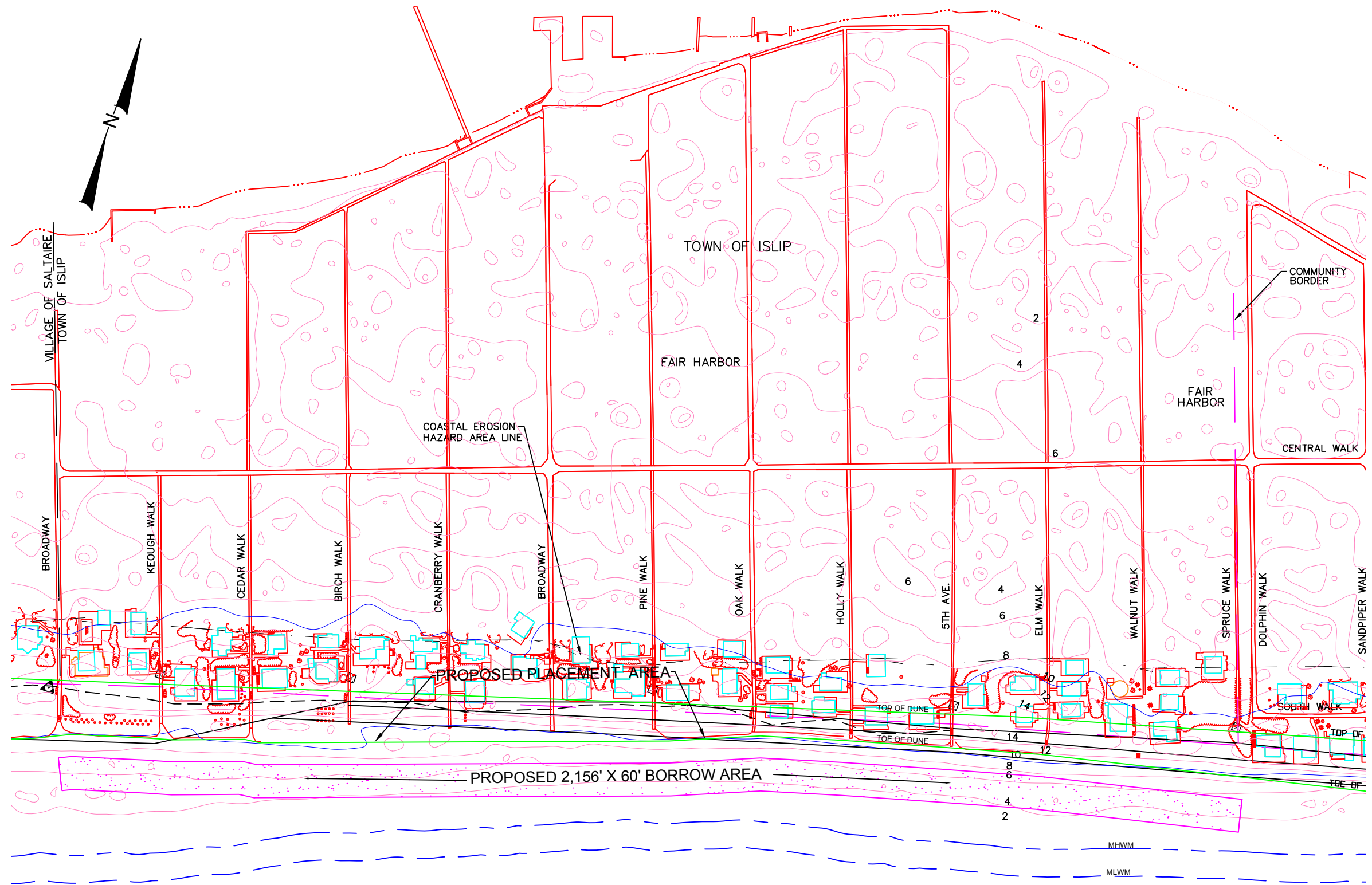

**NOTES:**

- 1.SURPLUS SAND FROM THE SEAWARD EDGE OF THE "SUMMER" BEACH PROFILE PROPOSED TO BE RELOCATED TO AUGMENT THE PRIMARY DUNE (APPROX. 2.2 CUBIC YARDS PER LINEAR FOOT)
- 2.PROPOSED BORROW AREA IN THE SEAWARD EDGE OF "SUMMER" BEACH PROFILE (MAX. 60' WIDE), (AVERAGE 1' DEEP), APPROX. 2.2 CUBIC YARDS PER LINEAR FOOT
- 3.AREA OF AUGMENTED DUNE TO BE ESTABLISHED WITH CAPE AMERICAN BEACHGRASS (*Ammophila brevigulata*) ON 18" CENTERS
- 4.A MINIMUM OF 100' OF DRY BEACH ABOVE ELEVATION (+6) NGVD REQUIRED
- 5.MONITOR STATION (4" X 4" POST BEHIND PRIMARY DUNE) (REFERENCED TO NGVD '29)

**PLAN VIEW:**  
SCALE: 1" = 200'

**LAND USE ECOLOGICAL SERVICES INC.**  
PO BOX 1060  
RIVERHEAD, N.Y.11901  
PHONE (631)-727-2400 FAX (631)-727-2605

PROPOSED: BEACH SCRAPING PROJECT  
PURPOSE: EROSION CONTROL  
AT: FAIR HARBOR BEACH  
TOWN OF ISLIP- SUFFOLK COUNTY N.Y.  
APPLICANT: FAIR HARBOR BECD

DATE:  
03-25-08  
S.C.T.M.#

SHEET 1 OF 2

**NOTES:**

1.SURPLUS SAND FROM THE SEAWARD EDGE OF THE "SUMMER" BEACH PROFILE PROPOSED TO BE RELOCATED TO AUGMENT THE PRIMARY DUNE (APPROX. 2.2 CUBIC YARDS PER LINEAR FOOT)

2.PROPOSED BORROW AREA IN THE SEAWARD EDGE OF "SUMMER" BEACH PROFILE (MAX. 60' WIDE), (AVERAGE 1' DEEP), APPROX. 2.2 CUBIC YARDS PER LINEAR FOOT

3.AREA OF AUGMENTED DUNE TO BE ESTABLISHED WITH CAPE AMERICAN BEACHGRASS (*Ammophila brevigulata*) ON 18" CENTERS

4.A MINIMUM OF 100' OF DRY BEACH ABOVE ELEVATION (+6) NGVD REQUIRED

5.MONITOR STATION (4" X 4" POST BEHIND PRIMARY DUNE) (REFERENCED TO NGVD '29)

**PLAN VIEW:**

SCALE: 1" = 200'

**LAND USE ECOLOGICAL SERVICES INC.**

PO BOX 1060  
RIVERHEAD, N.Y.11901  
PHONE (631)-727-2400 FAX (631)-727-2605

PROPOSED: BEACH SCRAPING PROJECT  
PURPOSE: EROSION CONTROL  
AT: DUNEWOOD BEACH  
F.I.- SUFFOLK COUNTY N.Y.  
APPLICANT: DUNEWOOD ASSOC.

DATE:

03-25-08  
S.C.T.M.#

SHEET 1 OF 2

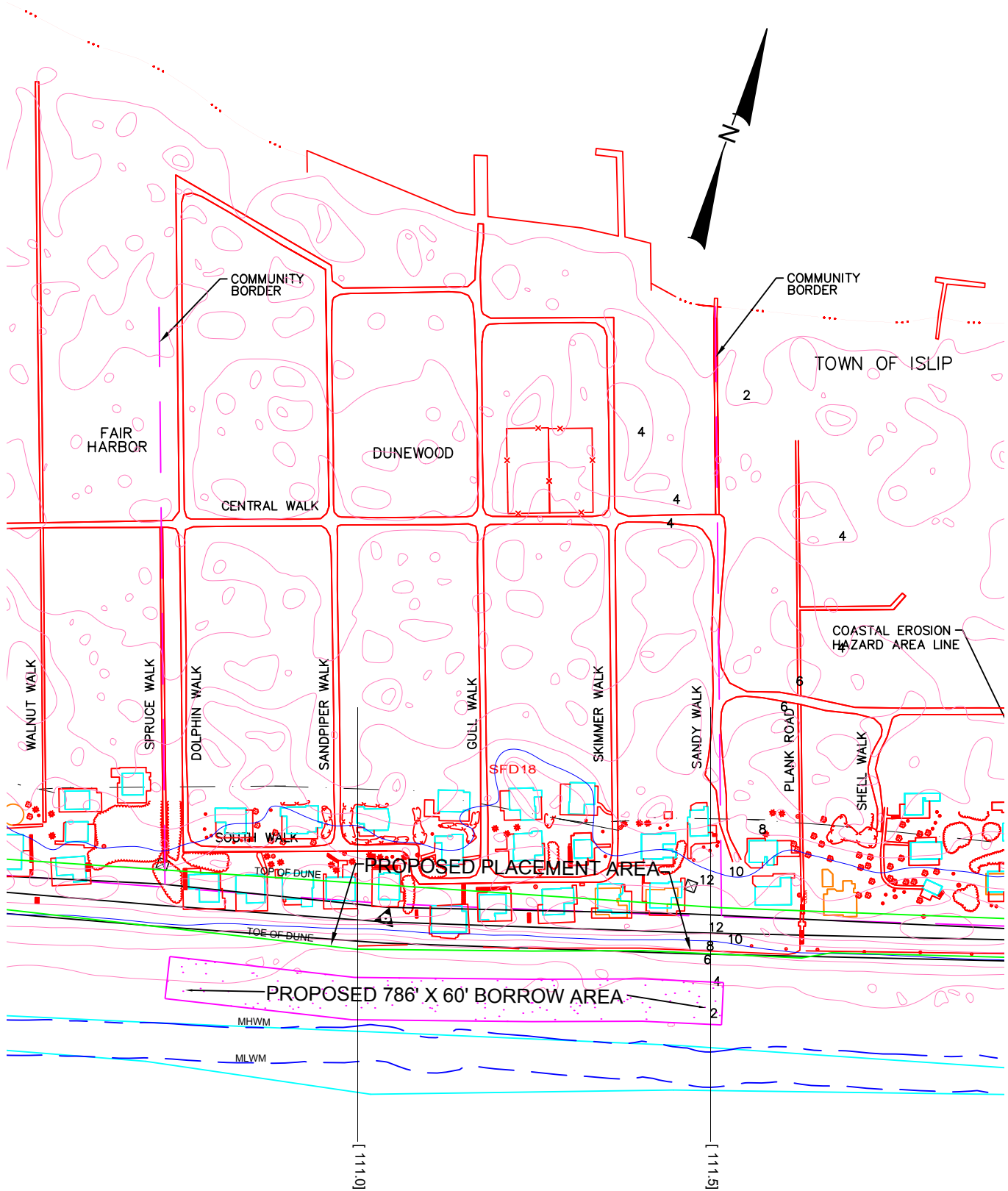

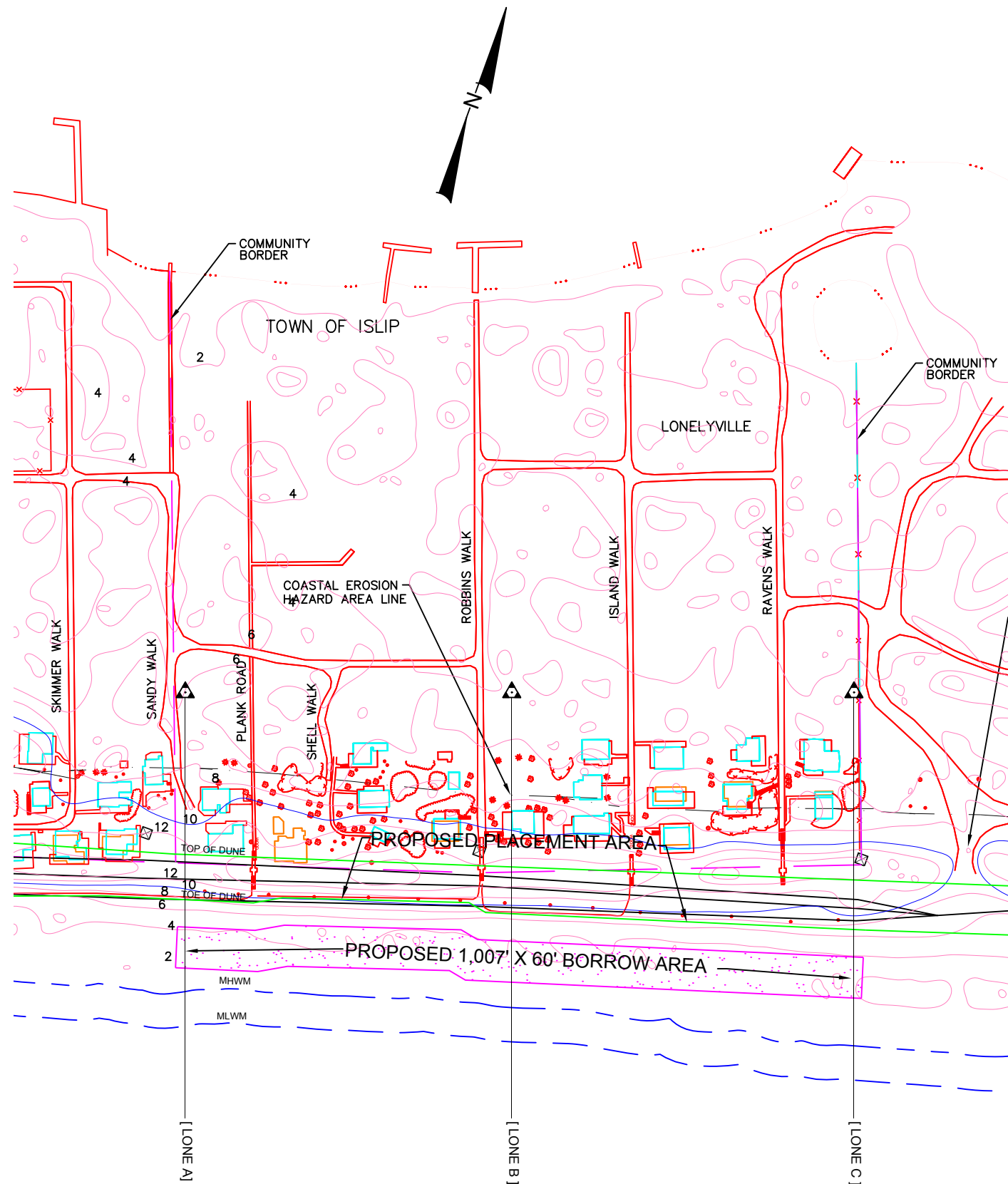

#### NOTES:

- 1.SURPLUS SAND FROM THE SEAWARD EDGE OF THE "SUMMER" BEACH PROFILE PROPOSED TO BE RELOCATED TO AUGMENT THE PRIMARY DUNE (APPROX. 2.2 CUBIC YARDS PER LINEAR FOOT)
- 2.PROPOSED BORROW AREA IN THE SEAWARD EDGE OF "SUMMER" BEACH PROFILE (MAX. 60' WIDE), (AVERAGE 1' DEEP), APPROX. 2.2 CUBIC YARDS PER LINEAR FOOT
- 3.AREA OF AUGMENTED DUNE TO BE ESTABLISHED WITH CAPE AMERICAN BEACHGRASS (*Ammophila brevigulata*) ON 18" CENTERS
- 4.A MINIMUM OF 100' OF DRY BEACH ABOVE ELEVATION (+6) NGVD REQUIRED
- 5.MONITOR STATION (4" X 4" POST BEHIND PRIMARY DUNE) (REFERENCED TO NGVD '29)

#### PLAN VIEW:

SCALE: 1" = 200'

#### LAND USE ECOLOGICAL SERVICES INC.

PO BOX 1060  
RIVERHEAD, N.Y.11901  
PHONE (631)-727-2400 FAX (631)-727-2605

PROPOSED: BEACH SCRAPING PROJECT  
PURPOSE: EROSION CONTROL  
AT: LONELYVILLE BEACH  
LONELYVILLE, F.I.- SUFFOLK COUNTY N.Y.  
APPLICANT:LONELYVILLE B.E.C.D

DATE:  
03-25-08  
S.C.T.M.#

SHEET 1 OF 2



**NOTES:**

- 1.SURPLUS SAND FROM THE SEAWARD EDGE OF THE "SUMMER" BEACH PROFILE PROPOSED TO BE RELOCATED TO AUGMENT THE PRIMARY DUNE (APPROX. 2.2 CUBIC YARDS PER LINEAR FOOT)
- 2.PROPOSED BORROW AREA IN THE SEAWARD EDGE OF "SUMMER" BEACH PROFILE (MAX. 60' WIDE), (AVERAGE 1' DEEP), APPROX. 2.2 CUBIC YARDS PER LINEAR FOOT
- 3.AREA OF AUGMENTED DUNE TO BE ESTABLISHED WITH CAPE AMERICAN BEACHGRASS (*Ammophila brevifoliosa*) ON 18" CENTERS
- 4.A MINIMUM OF 100' OF DRY BEACH ABOVE ELEVATION (+6) NGVD REQUIRED
- 5.MONITOR STATION (4" X 4" POST BEHIND PRIMARY DUNE) (REFERENCED TO NGVD '29)

<b>PLAN VIEW:</b> SCALE: 1" = 300'	PROPOSED: BEACH SCRAPING PROJECT PURPOSE: EROSION CONTROL AT: VLG. OF ATLANTIQUE BEACH ATLANTIQUE, F.I.- SUFFOLK COUNTY N.Y. APPLICANT: VLG. OF ATLANTIQUE	DATE: 03-25-08 S.C.T.M.#
		SHEET 1 OF 2

**LAND USE ECOLOGICAL SERVICES INC.**  
PO BOX 1060  
RIVERHEAD, N.Y.11901  
PHONE (631)-727-2400 FAX (631)-727-2605



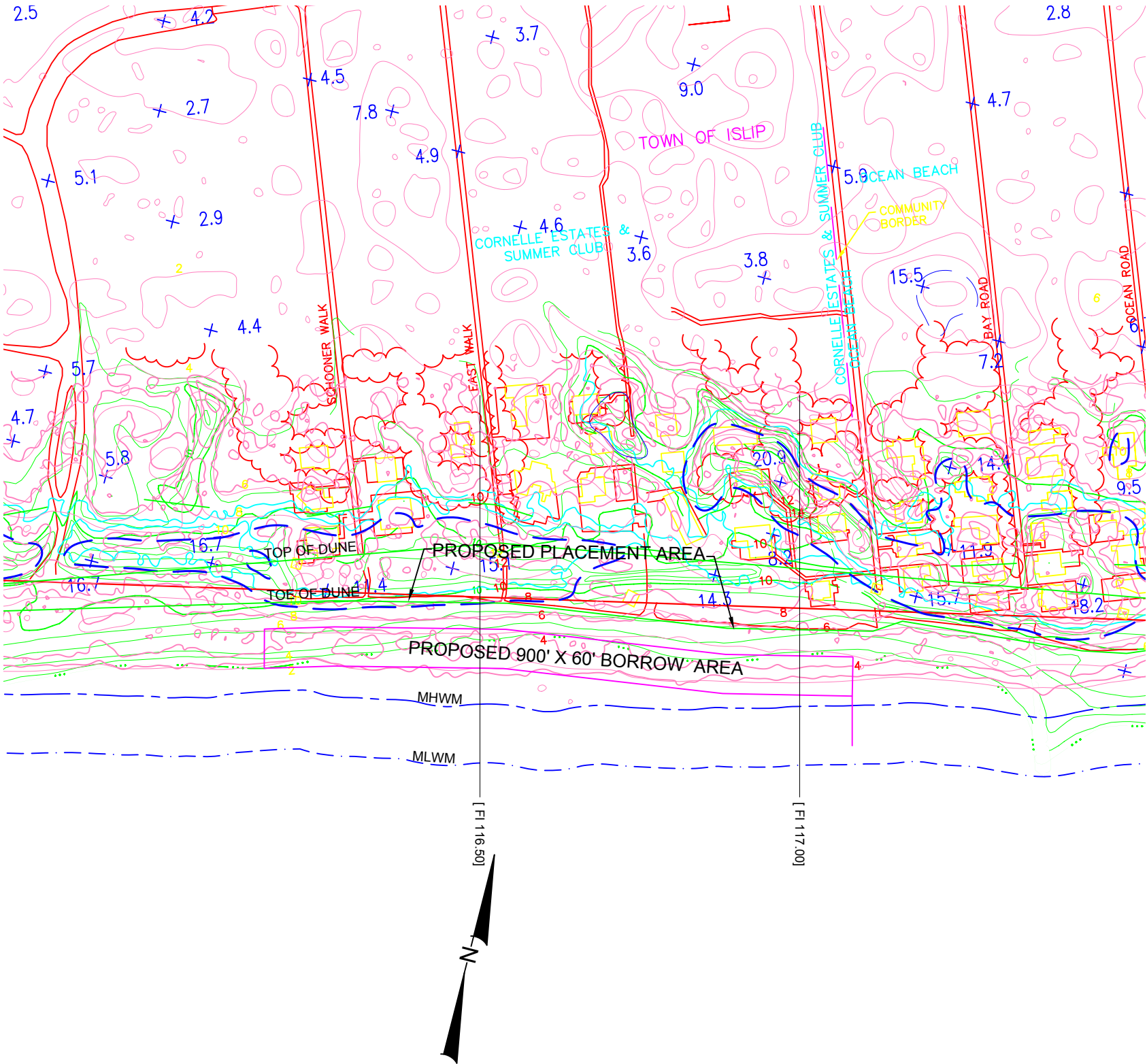

- NOTES:**
- 1.SURPLUS SAND FROM THE SEAWARD EDGE OF THE "SUMMER" BEACH PROFILE PROPOSED TO BE RELOCATED TO AUGMENT THE PRIMARY DUNE (APPROX. 2.2 CUBIC YARDS PER LINEAR FOOT)
  - 2.PROPOSED BORROW AREA IN THE SEAWARD EDGE OF "SUMMER" BEACH PROFILE (MAX. 60' WIDE), (AVERAGE 1' DEEP), APPROX. 2.2 CUBIC YARDS PER LINEAR FOOT
  - 3.AREA OF AUGMENTED DUNE TO BE ESTABLISHED WITH CAPE AMERICAN BEACHGRASS (*Ammophila breviculata*) ON 18" CENTERS
  - 4.A MINIMUM OF 100' OF DRY BEACH ABOVE ELEVATION (+6) NGVD REQUIRED
  - 5.MONITOR STATION (4" X 4" POST BEHIND PRIMARY DUNE) (REFERENCED TO NGVD '29)

PLAN VIEW: SCALE: 1" = 200'	PROPOSED: BEACH SCRAPING PROJECT PURPOSE: EROSION CONTROL	DATE: 03-25-08
	AT: CORNEILLE ESTATES BEACH CORNEILLE ESTATES, F.I.- SUFFOLK COUNTY N.Y. APPLICANT: CORNEILLE ESTATES	S.C.T.M.#
LAND USE ECOLOGICAL SERVICES INC. PO BOX 1060 RIVERHEAD, N.Y. 11901 PHONE (631)-727-2400 FAX (631)-727-2605		SHEET 1 OF 2







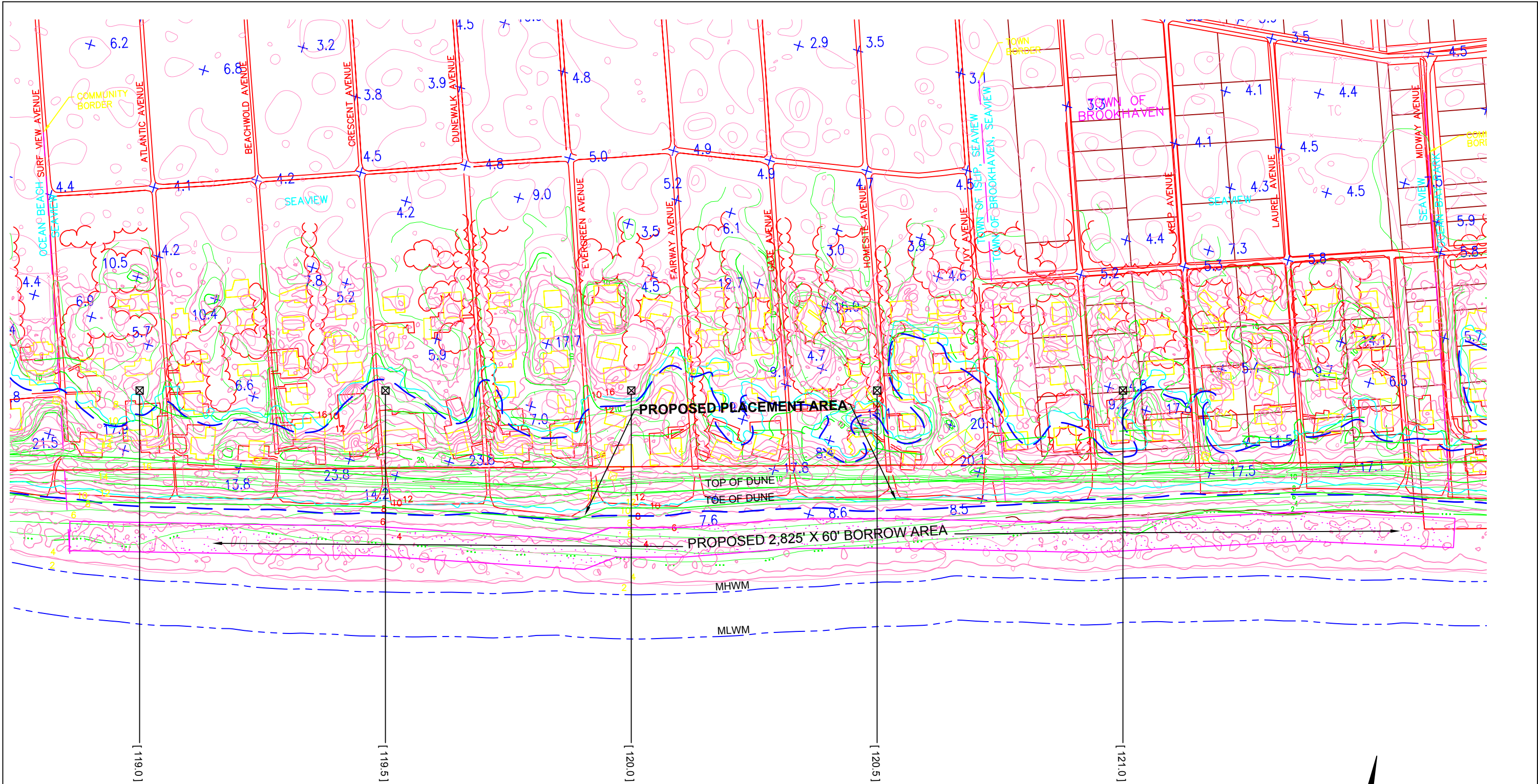

**NOTES:**

- 1.SURPLUS SAND FROM THE SEAWARD EDGE OF THE "SUMMER" BEACH PROFILE PROPOSED TO BE RELOCATED TO AUGMENT THE PRIMARY DUNE (APPROX. 2.2 CUBIC YARDS PER LINEAR FOOT)
- 2.PROPOSED BORROW AREA IN THE SEAWARD EDGE OF "SUMMER" BEACH PROFILE (MAX. 60' WIDE), (AVERAGE 1' DEEP), APPROX. 2.2 CUBIC YARDS PER LINEAR FOOT
- 3.AREA OF AUGMENTED DUNE TO BE ESTABLISHED WITH CAPE AMERICAN BEACHGRASS (*Ammophila breviculata*) ON 18" CENTERS
- 4.A MINIMUM OF 100' OF DRY BEACH ABOVE ELEVATION (+6) NGVD REQUIRED
- 5.MONITOR STATION (4" X 4" POST BEHIND PRIMARY DUNE) (REFERENCED TO NGVD '29)

**PLAN VIEW:**  
SCALE: 1" = 200'

**LAND USE ECOLOGICAL SERVICES INC.**  
PO BOX 1060  
RIVERHEAD, N.Y.11901  
PHONE (631)-727-2400 FAX (631)-727-2605

PROPOSED: BEACH SCRAPING PROJECT  
PURPOSE: EROSION CONTROL  
AT: SEAVIEW BEACH  
SEAVIEW, F.I.- SUFFOLK COUNTY N.Y.  
APPLICANT: SEAVIEW B.E.C.D.

DATE:  
03-25-08  
S.C.T.M.#

SHEET 1 OF 2



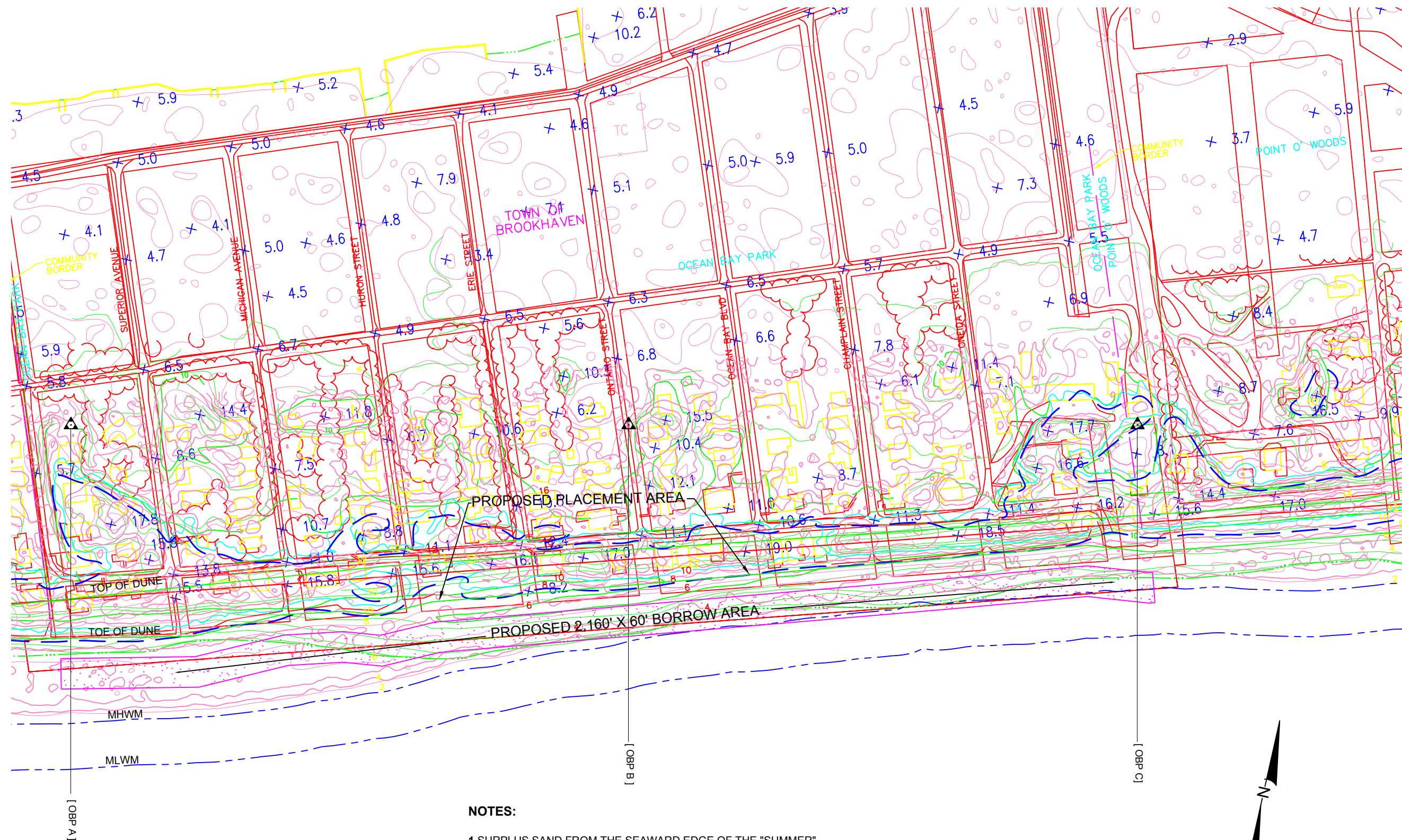

**NOTES:**

- 1.SURPLUS SAND FROM THE SEAWARD EDGE OF THE "SUMMER" BEACH PROFILE PROPOSED TO BE RELOCATED TO AUGMENT THE PRIMARY DUNE (APPROX. 2.2 CUBIC YARDS PER LINEAR FOOT)
- 2.PROPOSED BORROW AREA IN THE SEAWARD EDGE OF "SUMMER" BEACH PROFILE (MAX. 60' WIDE), (AVERAGE 1' DEEP), APPROX. 2.2 CUBIC YARDS PER LINEAR FOOT
- 3.AREA OF AUGMENTED DUNE TO BE ESTABLISHED WITH CAPE AMERICAN BEACHGRASS (*Ammophila breviflora*) ON 18" CENTERS

- 4.A MINIMUM OF 100' OF DRY BEACH ABOVE ELEVATION (+6) NGVD REQUIRED
- 5.MONITOR STATION (4" X 4" POST BEHIND PRIMARY DUNE) (REFERENCED TO NGVD '29)

<b>PLAN VIEW:</b> SCALE: 1" = 200'	PROPOSED: BEACH SCRAPING PROJECT PURPOSE: EROSION CONTROL	DATE: 03-25-08
<b>LAND USE ECOLOGICAL SERVICES INC.</b>	AT: OCEAN BAY PARK F.I.- SUFFOLK COUNTY N.Y.	S.C.T.M.#
PO BOX 1060 RIVERHEAD, N.Y. 11901 PHONE (631)-727-2400 FAX (631)-727-2605	APPLICANT: OCEAN BAY PARK	SHEET 1 OF 2



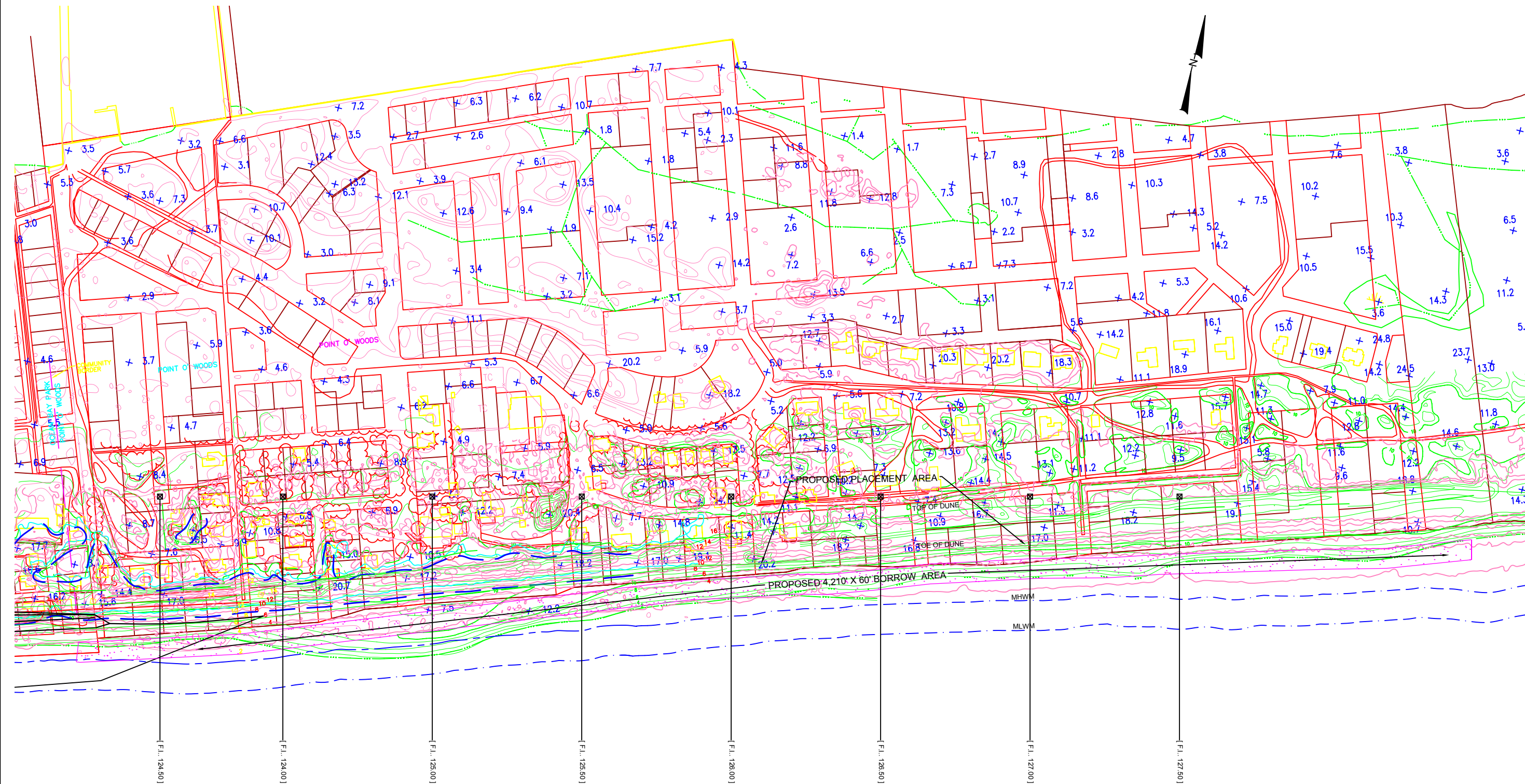

**NOTES:**

1. SURPLUS SAND FROM THE SEAWARD EDGE OF THE "SUMMER" BEACH PROFILE PROPOSED TO BE RELOCATED TO AUGMENT THE PRIMARY DUNE (APPROX. 2.2 CUBIC YARDS PER LINEAR FOOT)
2. PROPOSED BORROW AREA IN THE SEAWARD EDGE OF "SUMMER" BEACH PROFILE (MAX. 60' WIDE). (AVERAGE 1' DEEP), APPROX. 2.2 CUBIC YARDS PER LINEAR FOOT
3. AREA OF THE AUGMENTED DUNE TO BE ESTABLISHED WITH CAPE AMERICAN BEACH GRASS (*Ammophila brevigulata*) ON 18" CENTERS
4. A MINIMUM OF 100' OF DRY BEACH ABOVE ELEVATION (+6) NGVD REQUIRED
5. MONITOR STATION (4" X 4" POST BEHIND PRIMARY DUNE) REFERENCED TO NGVD '29)

**PLAN VIEW:**  
SCALE: 1" = 300'  
**LAND USE ECOLOGICAL SERVICES INC.**  
PO BOX 1060  
RIVERHEAD, N.Y. 11901  
PHONE (631)-727-2400 FAX (631)-727-2605

PROPOSED: BEACH SCRAPING PROJECT  
PURPOSE: EROSION CONTROL  
AT: POINT OF WOODS  
F.I.- SUFFOLK COUNTY N.Y.  
APPLICANT: POINT OF WOODS

DATE:  
03-25-08  
S.C.T.M.#  
  
SHEET 1 OF 2

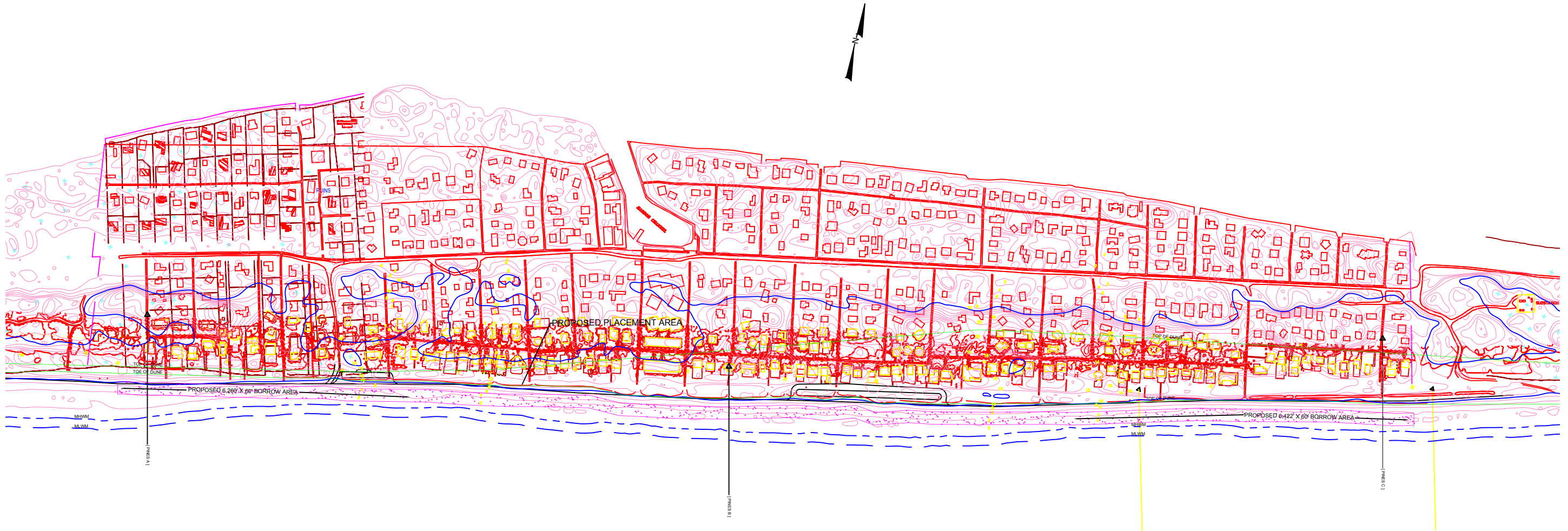

**NOTES:**

- 1.SURPLUS SAND FROM THE SEAWARD EDGE OF THE "SUMMER" BEACH PROFILE PROPOSED TO BE RELOCATED TO AUGMENT THE PRIMARY DUNE (APPROX. 2.2 CUBIC YARDS PER LINEAR FOOT)
- 2.PROPOSED BORROW AREA IN THE SEAWARD EDGE OF "SUMMER" BEACH PROFILE (MAX. 60' WIDE), (AVERAGE 1' DEEP), APPROX. 2.2 CUBIC YARDS PER LINEAR FOOT
- 3.AREA OF AUGMENTED DUNE TO BE ESTABLISHED WITH CAPE AMERICAN BEACHGRASS (*Ammophila brevigulata*) ON 18" CENTERS
- 4.A MINIMUM OF 100' OF DRY BEACH ABOVE ELEVATION (+6) NGVD REQUIRED
- 5.MONITOR STATION (4" X 4" POST BEHIND PRIMARY DUNE) (REFERENCED TO NGVD '29)

<b>PLAN VIEW:</b> SCALE: 1" = 500'	PROPOSED: BEACH SCRAPING PROJECT PURPOSE: EROSION CONTROL AT: F.I. PINES B.E.C.D F.I.- SUFFOLK COUNTY N.Y. APPLICANT: F.I. PINES B.E.C.D.	DATE: 03-25-08 S.C.T.M.#
		SHEET 1 OF 2

**LAND USE ECOLOGICAL SERVICES INC.**  
PO BOX 1060  
RIVERHEAD, N.Y.11901  
PHONE (631)-727-2400 FAX (631)-727-2605



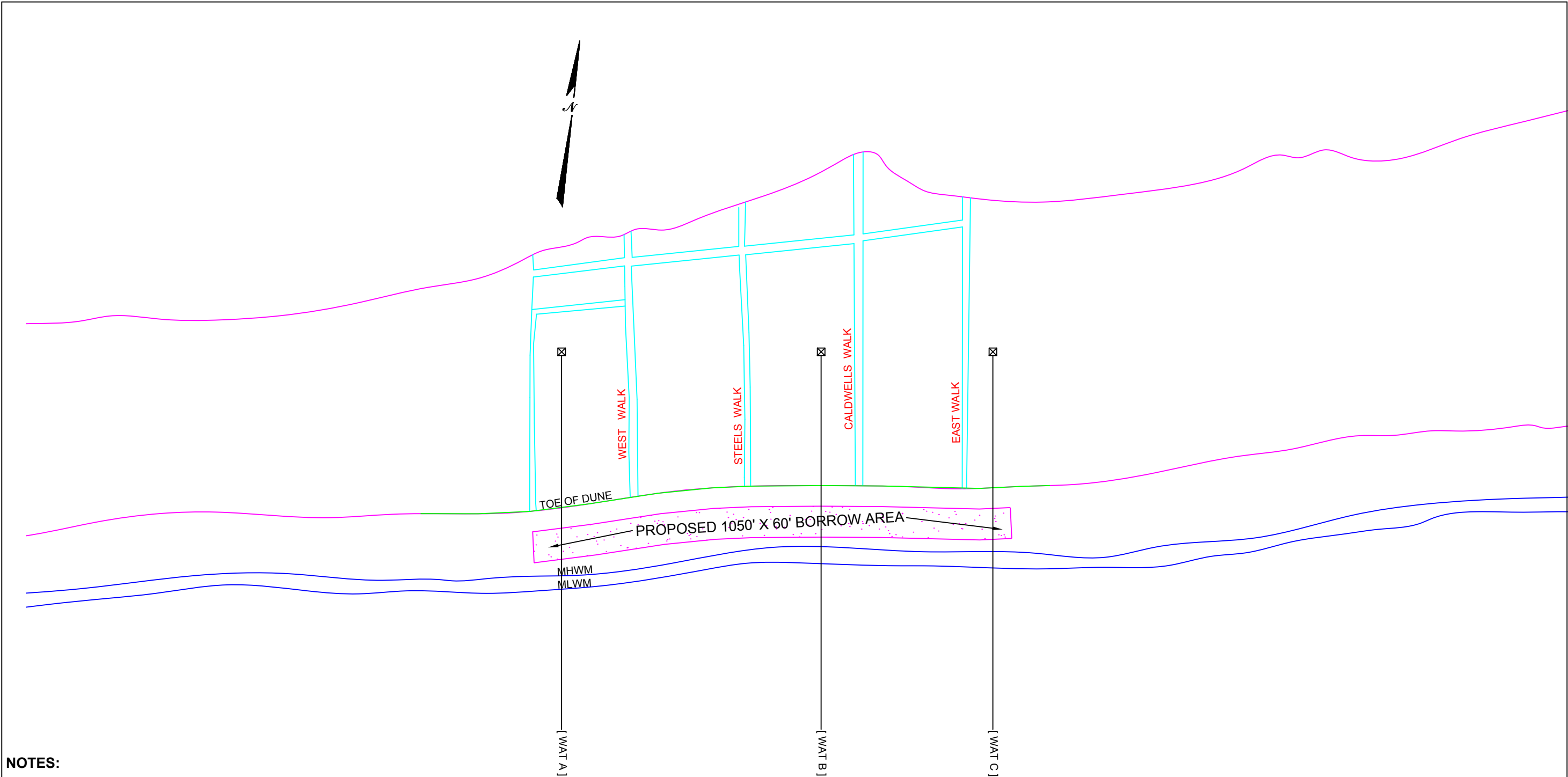

**NOTES:**

- 1. SURPLUS SAND FROM THE SEAWARD EDGE OF THE "SUMMER" BEACH PROFILE PROPOSED TO BE RELOCATED TO AUGMENT THE PRIMARY DUNE (APPROX. 2.2 CUBIC YARDS PER LINEAR FOOT)
- 2. PROPOSED BORROW AREA IN THE SEAWARD EDGE OF "SUMMER" BEACH PROFILE (MAX. 60' WIDE). (AVERAGE 1' DEEP), APPROX. 2.2 CUBIC YARDS PER LINEAR FOOT
- 3. AREA OF THE AUGMENTED DUNE TO BE ESTABLISHED WITH CAPE AMERICAN BEACH GRASS (*Ammophila brevigulata*) ON 18" CENTERS
- 4. A MINIMUM OF 100' OF DRY BEACH ABOVE ELEVATION (+6) NGVD REQUIRED
- 5. MONITOR STATION (4" X 4" POST BEHIND PRIMARY DUNE) REFERENCED TO NGVD '29)

<b>PLAN VIEW:</b> SCALE: 1" = 200'	PROPOSED: BEACH SCRAPING PROJECT	DATE:
	PURPOSE: EROSION CONTROL	03-25-08
	AT: WATER ISLAND COMMUNITIES	S.C.T.M.#
	WATER ISLAND, F.I.- SUFFOLK COUNTY N.Y.	DWG. #
<b>LAND USE ECOLOGICAL SERVICES INC.</b> <small>PO BOX 1060 RIVERHEAD, N.Y. 11901 PHONE (631)-727-2400 FAX (631)-727-2605</small>	APPLICANT: VLG. OF WATER ISLAND	B-045
		SHEET 1 OF 2

G R E A T  
S O U T H  
B A Y

VILLAGE OF SALTAIRE  
TOWN OF ISLIP

DAVIS PARK

JRE

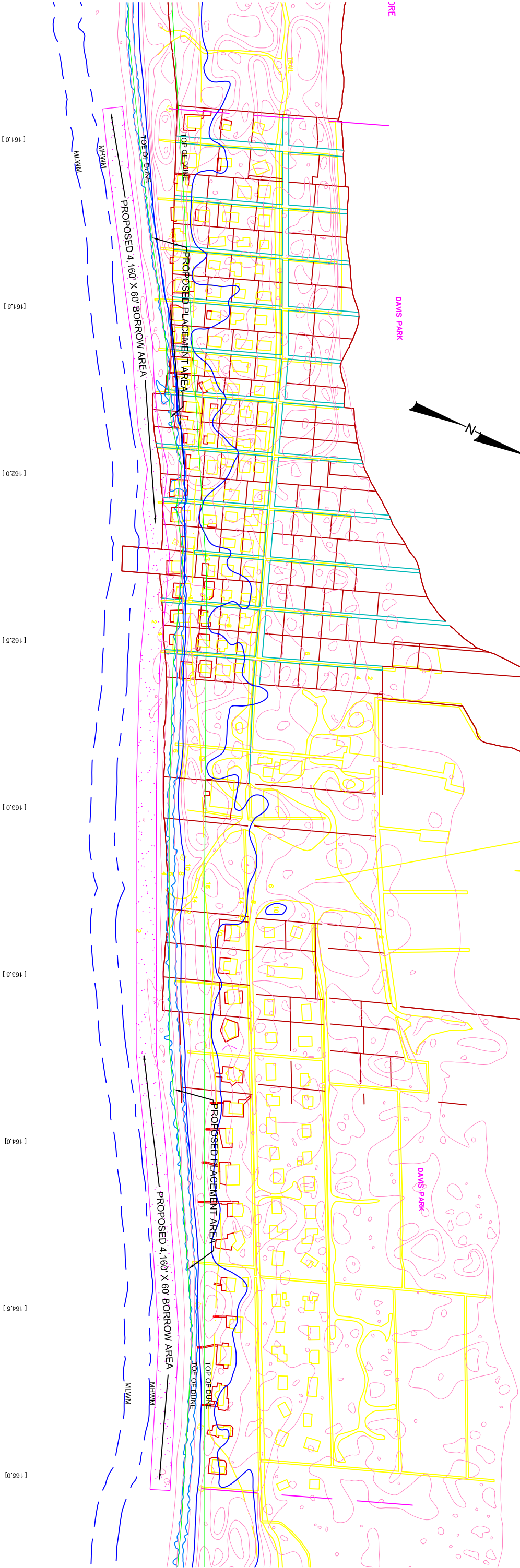

NOTES:

- 1.SURPLUS SAND FROM THE SEAWARD EDGE OF THE "SUMMER" BEACH PROFILE PROPOSED TO BE RELOCATED TO AUGMENT THE PRIMARY DUNE (APPROX. 2.2 CUBIC YARDS PER LINEAR FOOT)
- 2.PROPOSED BORROW AREA IN THE SEAWARD EDGE OF "SUMMER" BEACH PROFILE (MAX. 60' WIDE), (AVERAGE 1' DEEP), APPROX. 2.2 CUBIC YARDS PER LINEAR FOOT
- 3.AREA OF AUGMENTED DUNE TO BE ESTABLISHED WITH CAPE AMERICAN BEACHGRASS (Ammophila breviflata) ON 18" CENTERS
- 4.A MINIMUM OF 100' OF DRY BEACH ABOVE ELEVATION (+6) NGVD REQUIRED
- 5.MONITOR STATION (4" X 4" POST BEHIND PRIMARY DUNE) (REFERENCED TO NGVD '29)

PLAN VIEW: SCALE: 1" = 300'	PROPOSED: BEACH SCRAPING PROJECT PURPOSE: EROSION CONTROL	DATE: 03-25-08
LAND USE ECOLOGICAL SERVICES INC.	AT: DAVIS PARK BEACH F.I.- SUFFOLK COUNTY N.Y. APPLICANT: DAVIS PARK BEACH	S.C.T.M.#
PO BOX 1060 RIVERHEAD, N.Y. 11901 PHONE (631)-727-2400 FAX (631)-727-2605		SHEET 1 OF 2