



United States Department of the Interior

NATIONAL PARK SERVICE

Yosemite National Park
P.O. Box 577
Yosemite, California 95389

IN REPLY REFER TO:
L7617 (YOSE-PM)

Memorandum

To: Tom Darcy, Project Manager, Facilities Management, Yosemite National Park

From: Superintendent, Yosemite National Park

Subject: Notice to Proceed, 2007-010 Yosemite Valley, El Portal and Wawona Housing Roof Replacement

Your proposed project is an action that has been determined to result in no measurable environmental effects. It is therefore categorically excluded from further National Environmental Policy Act analysis under Categorical Exclusion: DO12 3.4 C (3) - *Routine maintenance and repairs to non-historic structures, facilities, utilities, grounds, and trails; or, for historic structures, C (4) - Routine maintenance and repairs to cultural resource sites, structures, utilities, and grounds if the action falls under an approved Historic Structures Preservation Guide or would not adversely affect the cultural resource.*

Necessary compliance coordination has been completed regarding the National Historic Preservation Act, the Wilderness Act, the Wild and Scenic Rivers Act, and the Endangered Species Act, as applicable. This project clearance is valid providing that you adhere to the conditions stipulated in the enclosed *Categorical Exclusion Form* and associated documents when implementing this project.

//MJTollefson//
Michael J. Tollefson, Superintendent

12/5/06
Date

Enclosure (with attachments)

cc: Statutory Compliance File

The signed original of this document is on file at the Environmental Planning and Compliance Office in Yosemite National Park.

Categorical Exclusion

(Version: OCT06)

Compliance Tracking Number: 2007-010

PEPC Project Number: 17113

A. PROJECT INFORMATION

Title: Yosemite Valley, El Portal and Wawona Housing Roof Replacement

Location: Yosemite Valley, El Portal and Wawona, Mariposa County, California

Project Manager: Tom Darcy, Facilities Management, Yosemite National Park

B. COMPLIANCE DETERMINATION

This project is an action that has been determined to result in no measurable environmental effects. It is therefore categorically excluded from further National Environmental Policy Act analysis under Categorical Exclusion: DO12 3.4 C (3) - *Routine maintenance and repairs to non-historic structures, facilities, utilities, grounds, and trails; or, for historic structures, C (4) - Routine maintenance and repairs to cultural resource sites, structures, utilities, and grounds if the action falls under an approved Historic Structures Preservation Guide or would not adversely affect the cultural resource.*

Necessary compliance coordination has been completed regarding the National Historic Preservation Act, the Wilderness Act, the Wild and Scenic Rivers Act, and the Endangered Species Act, as applicable. Environmental impacts will be negligible or less when the project is implemented with the conditions stipulated under **Project Mitigations and Conditions** in **Section I** at the end of the attached *Environmental Screening Form*.

Additional supporting information for this determination and the stipulated conditions can be found in the following attachments (when checked):

- Environmental Screening Form*
- Preservation Assessment Form (YOSE-XXX)*
- Wilderness Minimum Requirement Analysis*
- Wild and Scenic River Section 7 Determination*
- Other:

C. DECISION

On the basis of the environmental impact information in the statutory compliance file, with which I am familiar, I am categorically excluding the described project from further NEPA analysis. No exceptional circumstances or conditions in DO12 3.5 or 3.6 apply and the action is fully described in DO12, Section 3.4.

//MJTollefson//

Michael J. Tollefson, Superintendent

12/5/06

Date

Original: Statutory Compliance File
cc: Project Proponent

*The signed original of this document is on file at
the Environmental Planning and Compliance
Office in Yosemite National Park.*

Attachments (2)

Environmental Screening Form

(Version: NOV06)

Compliance Tracking Number: 2007-010

PEPC Project Number: 17113

5. 2PROJECT INFORMATION

Title: Yosemite Valley, El Portal and Wawona Housing Roof Replacement

Location: Yosemite Valley, El Portal and Wawona, Mariposa County, California

Project Manager: Tom Darcy, Facilities Management, Yosemite National Park

B. PROJECT DESCRIPTION AND BACKGROUND

The purpose of this project is to replace deteriorated roofing and roof sheeting on various National Park Service (NPS) housing units. Structural repairs would be made if necessary. Damaged overhangs would be repaired and re-painted as needed. Each roof would be evaluated individually: although general roof specifications guidelines are used for reference for NPS replacement/repair projects, in the case of listed historic cultural properties, consultation with NPS cultural resource staff determines the type of roofing and other specifications needed to protect and preserve the historic character of these buildings.

Roofs scheduled for replacement in 2006-2007 are listed in Attachment B.

Table B1 – Background Information

	Yes	No	N/A	Explanation/Notes
1. Did NPS staff conduct a site visit? If yes, list attendees. If no, explain.	<input checked="" type="checkbox"/>	<input type="checkbox"/>	<input type="checkbox"/>	Facilities Management staff.
2a. Is the project providing compliance for an action associated with but not covered by an approved plan? (Identify the plan and provide a section or page citation.); OR	<input type="checkbox"/>	<input checked="" type="checkbox"/>	<input type="checkbox"/>	
2b. Is the project in an approved plan? (Identify the plan and provide a section or page citation.	<input type="checkbox"/>	<input type="checkbox"/>	<input checked="" type="checkbox"/>	
2c. Is the project consistent with that plan?	<input type="checkbox"/>	<input type="checkbox"/>	<input checked="" type="checkbox"/>	
2d. Is the Plan's CE, FONSI, or ROD current?	<input type="checkbox"/>	<input type="checkbox"/>	<input checked="" type="checkbox"/>	
3a. Are there any interested or affected parties?	<input type="checkbox"/>	<input checked="" type="checkbox"/>	<input type="checkbox"/>	
3b. Has a diligent effort been made to communicate with them?	<input type="checkbox"/>			
4a. Are there any affected agencies or tribes?	<input type="checkbox"/>	<input checked="" type="checkbox"/>	<input type="checkbox"/>	
4b. Has consultation been completed?	<input type="checkbox"/>			

Table B2 – Environmental Screening Form Attachments (provide Attachment letter—A, B, etc.)

	Yes	No	N/A	Explanation/Notes
1. Maps: 2 required (vicinity map & site map)	<input checked="" type="checkbox"/>			Yosemite Valley, El Portal and Wawona vicinity maps.
2. Drawings (e.g., design, construction)	<input type="checkbox"/>	<input checked="" type="checkbox"/>	<input type="checkbox"/>	
3. Site Plans	<input type="checkbox"/>	<input checked="" type="checkbox"/>	<input type="checkbox"/>	
4. Photographs	<input type="checkbox"/>	<input checked="" type="checkbox"/>	<input type="checkbox"/>	
5. Non-NEPA/NHPA Approvals (Explain)	<input type="checkbox"/>	<input checked="" type="checkbox"/>	<input type="checkbox"/>	
6. Other (Explain)	<input checked="" type="checkbox"/>	<input type="checkbox"/>	<input type="checkbox"/>	Building information list; see Attachment B.

**Yosemite National Park
Environmental Screening Form**

C. ASSESSMENT OF POTENTIAL RESOURCE EFFECTS

Are any impacts possible on the following resources?	Yes	No	N/A	Data Needed to Determine/Notes
1. Geologic resources: soils, bedrock, streambeds, etc	<input type="checkbox"/>	<input checked="" type="checkbox"/>	<input type="checkbox"/>	
2. From geohazards	<input type="checkbox"/>	<input checked="" type="checkbox"/>	<input type="checkbox"/>	
3. Air quality	<input checked="" type="checkbox"/>	<input type="checkbox"/>	<input type="checkbox"/>	Temporary air emissions during re-roofing.
4. Soundscapes	<input checked="" type="checkbox"/>	<input type="checkbox"/>	<input type="checkbox"/>	Temporary construction noises during re-roofing.
5. Water quality or quantity	<input type="checkbox"/>	<input checked="" type="checkbox"/>	<input type="checkbox"/>	
6. Stream flow characteristics	<input type="checkbox"/>	<input checked="" type="checkbox"/>	<input type="checkbox"/>	
7. Marine or estuarine resources	<input type="checkbox"/>	<input type="checkbox"/>	<input checked="" type="checkbox"/>	
8. Floodplains or wetlands	<input type="checkbox"/>	<input checked="" type="checkbox"/>	<input type="checkbox"/>	
9. Land use, including occupancy, income, values, ownership, type of use	<input type="checkbox"/>	<input checked="" type="checkbox"/>	<input type="checkbox"/>	
10. Rare or unusual vegetation – old growth timber, riparian, alpine	<input type="checkbox"/>	<input checked="" type="checkbox"/>	<input type="checkbox"/>	
11. Species of special concern (plant or animal; state or federal listed or proposed for listing) or their habitat	<input type="checkbox"/>	<input checked="" type="checkbox"/>	<input type="checkbox"/>	
12. Unique ecosystems, biosphere reserves, World Heritage Sites	<input checked="" type="checkbox"/>	<input type="checkbox"/>	<input type="checkbox"/>	Yosemite National Park is a World Heritage site; no historic properties would be adversely affected by implimenting this project; see Section F, National Historic Preservation Act Checklist, below.
13. Unique or important wildlife or wildlife habitat	<input type="checkbox"/>	<input checked="" type="checkbox"/>	<input type="checkbox"/>	
14. Unique or important fish or fish habitat	<input type="checkbox"/>	<input checked="" type="checkbox"/>	<input type="checkbox"/>	
15. Introduce or promote non-native species (plant or animal)	<input checked="" type="checkbox"/>	<input type="checkbox"/>	<input type="checkbox"/>	Negligible; see Condition 2, Section D. Mandatory Criteria, below.
16. Recreation resources, including supply, demand, visitation, activities, etc.	<input type="checkbox"/>	<input checked="" type="checkbox"/>	<input type="checkbox"/>	
17. Visitor experience, aesthetic resources	<input type="checkbox"/>	<input checked="" type="checkbox"/>	<input type="checkbox"/>	
18. Cultural resources including cultural landscapes, ethnographic resources	<input type="checkbox"/>	<input checked="" type="checkbox"/>	<input type="checkbox"/>	
19. Socioeconomics, including employment, occupation, income changes, tax base, infrastructure	<input type="checkbox"/>	<input checked="" type="checkbox"/>	<input type="checkbox"/>	
20. Minority and low income populations, ethnography, size, migration patterns, etc.	<input type="checkbox"/>	<input checked="" type="checkbox"/>	<input type="checkbox"/>	
21. Energy resources	<input type="checkbox"/>	<input checked="" type="checkbox"/>	<input type="checkbox"/>	
22. Other agency or tribal land use plans or policies	<input type="checkbox"/>	<input checked="" type="checkbox"/>	<input type="checkbox"/>	
23. Resource, including energy, conservation potential	<input type="checkbox"/>	<input checked="" type="checkbox"/>	<input type="checkbox"/>	
24. Urban quality, gateway communities, etc.	<input type="checkbox"/>	<input checked="" type="checkbox"/>	<input type="checkbox"/>	
25. Long-term management of resources or land/resource productivity	<input type="checkbox"/>	<input checked="" type="checkbox"/>	<input type="checkbox"/>	
26. Other important environment resources (e.g. geothermal, paleontological resources)?	<input type="checkbox"/>	<input checked="" type="checkbox"/>	<input type="checkbox"/>	

Comments, Mitigations and Conditions:

- None

**Yosemite National Park
Environmental Screening Form**

D. MANDATORY CRITERIA

If implemented, would the proposed action:	Yes	No	N/A	Data Needed to Determine/Notes
1. Have material adverse effects on public health or safety?	<input type="checkbox"/>	<input checked="" type="checkbox"/>	<input type="checkbox"/>	Mitigated: see Condition 1, below.
2. Have adverse effects on such unique characteristics as historic or cultural resources; park, recreation, or refuge lands; wilderness areas; wild or scenic rivers; national natural landmarks; sole or principal drinking water aquifers; prime farmlands; wetlands; floodplains; or ecologically significant or critical areas, including those listed on the National Register of Natural Landmarks?	<input type="checkbox"/>	<input checked="" type="checkbox"/>	<input type="checkbox"/>	Mitigated: see Section F, Historic Preservation Act Checklist, below.
3. Have highly controversial environmental effects?	<input type="checkbox"/>	<input checked="" type="checkbox"/>	<input type="checkbox"/>	
4. Have highly uncertain and potentially significant environmental effects or involve unique or unknown environmental risks?	<input type="checkbox"/>	<input checked="" type="checkbox"/>	<input type="checkbox"/>	
5. Establish a precedent for future action or represent a decision in principle about future actions with potentially significant environmental effects?	<input type="checkbox"/>	<input checked="" type="checkbox"/>	<input type="checkbox"/>	
6. Be directly related to other actions with individually insignificant, but cumulatively significant, environmental effects?	<input type="checkbox"/>	<input checked="" type="checkbox"/>	<input type="checkbox"/>	
7. Have adverse effects on properties listed or eligible for listing on the National Register of Historic Places?	<input type="checkbox"/>	<input checked="" type="checkbox"/>	<input type="checkbox"/>	
8. Have adverse effects on species listed or proposed to be listed on the List of Endangered or Threatened Species or have adverse effects on designated Critical Habitat for these species?	<input type="checkbox"/>	<input checked="" type="checkbox"/>	<input type="checkbox"/>	
9. Require compliance with Executive Order 11988 (Floodplain Management), Executive Order 11990 (Protection of Wetlands), or the Fish and Wildlife Coordination Act?	<input type="checkbox"/>	<input checked="" type="checkbox"/>	<input type="checkbox"/>	
10. Threaten to violate a federal, state, local, or tribal law or requirement imposed for the protection of the environment?	<input type="checkbox"/>	<input checked="" type="checkbox"/>	<input type="checkbox"/>	
11. Involve unresolved conflicts concerning alternative uses of available resources (NEPA sec. 102(2)(E))?	<input type="checkbox"/>	<input checked="" type="checkbox"/>	<input type="checkbox"/>	
12. Have a disproportionate, significant adverse effect on low-income or minority populations (EO 12898)?	<input type="checkbox"/>	<input checked="" type="checkbox"/>	<input type="checkbox"/>	
13. Restrict access to and ceremonial use of Indian sacred sites by Indian religious practitioners or adversely affect the physical integrity of such sacred sites (EO 130007)?	<input type="checkbox"/>	<input checked="" type="checkbox"/>	<input type="checkbox"/>	
14. Contribute to the introduction, continued existence, or spread of federally listed noxious weeds (Federal Noxious Weed Control Act)?	<input type="checkbox"/>	<input checked="" type="checkbox"/>	<input type="checkbox"/>	Mitigated: see Condition 2, below.
15. Contribute to the introduction, continued existence, or spread of non-native invasive species or actions that may promote the introduction, growth or expansion of the range of non-native invasive species (EO 13112)?	<input type="checkbox"/>	<input checked="" type="checkbox"/>	<input type="checkbox"/>	Mitigated: see Condition 2, below.
16. Require a permit from a federal, state, or local agency to proceed, unless the agency from which the permit is required agrees that a CE is appropriate?	<input type="checkbox"/>	<input checked="" type="checkbox"/>	<input type="checkbox"/>	
17. Have the potential for significant impact as indicated by a federal, state, or local agency or Indian tribe?	<input type="checkbox"/>	<input checked="" type="checkbox"/>	<input type="checkbox"/>	
18. Have the potential to be controversial because of disagreement over possible environmental effects?	<input type="checkbox"/>	<input checked="" type="checkbox"/>	<input type="checkbox"/>	
19. Have the potential to violate the NPS Organic Act by impairing park resources or values?	<input type="checkbox"/>	<input checked="" type="checkbox"/>	<input type="checkbox"/>	

Comments, Mitigations and Conditions:

1. Develop and submit a Safety Plan and a Job Hazard Analysis to the park Safety Officer (Roger Farmer, 379-1079) for review and approval before beginning any project work.
2. Ensure that all equipment and materials brought into the park are free of non-native, invasive plants and animals, and noxious weeds. All staff working on site shall be informed of and follow best management practices for preventing the introduction and spread of non-native, invasive species as described in Division 1 Specifications, Section 1355. (Environmental Planning and Compliance)

**Yosemite National Park
Environmental Screening Form**

E. SPECIAL STATUS SPECIES CHECKLIST

Within the area of potential effect, are there:	Yes	No	N/A	Data Needed to Determine/Notes
1. Listed or proposed threatened or endangered species (Federal or State)?	<input type="checkbox"/>	<input checked="" type="checkbox"/>	<input type="checkbox"/>	
2. Species of special concern (Federal or State)?	<input type="checkbox"/>	<input checked="" type="checkbox"/>	<input type="checkbox"/>	
3. Park rare plants or vegetation?	<input type="checkbox"/>	<input checked="" type="checkbox"/>	<input type="checkbox"/>	
4. Potential habitat for any special-status species listed above?	<input type="checkbox"/>	<input checked="" type="checkbox"/>	<input type="checkbox"/>	
If "yes" to any of the above questions, a Special-Status Species Checklist must be completed and attached.				
Comments, Mitigations and Conditions:				
1. None				

F. NATIONAL HISTORIC PRESERVATION ACT CHECKLIST

Within the area of potential effect:	Yes	No	N/A	Data Needed to Determine/Notes
1. Will there be ground disturbance?	<input type="checkbox"/>	<input checked="" type="checkbox"/>	<input type="checkbox"/>	
2. Are there any archeological sites?	<input type="checkbox"/>	<input checked="" type="checkbox"/>	<input type="checkbox"/>	
3. Are there any Native American Indian traditional cultural resources?	<input type="checkbox"/>	<input checked="" type="checkbox"/>	<input type="checkbox"/>	
4. Is there a historic property (a building, structure, feature, or all or any part of an archeological district or site, or a historic district or site, or any associated landscape element) that is listed or eligible for listing on the <i>National Register</i> ?	<input type="checkbox"/>	<input checked="" type="checkbox"/>	<input type="checkbox"/>	
5. Is there a National Historic Landmark?	<input type="checkbox"/>	<input checked="" type="checkbox"/>	<input type="checkbox"/>	
6. Is there a structure(s) on the park's <i>List of Classified Structures</i> ?	<input checked="" type="checkbox"/>	<input type="checkbox"/>	<input type="checkbox"/>	LCS #05747 and #55763; the assessment of effect is "No Adverse Effect," see Condition 1 below, and the attached XXX.
7. Is there any cultural resource requiring an evaluation of eligibility as a historic property under NHPA, Section 106, before an affect determination can be made?	<input checked="" type="checkbox"/>	<input type="checkbox"/>	<input type="checkbox"/>	Structures built in the 1950s or 1960s (see Attachment B), the assessment of effect is "No Adverse Effect," see Condition 2 below, and the attached XXX.
8. Would there be alteration of any historic property or associated landscape element covered by 2-7, above?	<input checked="" type="checkbox"/>	<input type="checkbox"/>	<input type="checkbox"/>	The assessment of effect is "No Adverse Effect," see Condition 1 below, and the attached XXX.
If "yes" to <u>any</u> of the above, then an Assessment of Effects form (YOSE-XXX) must be completed and attached.				
Mitigations and Conditions:				
1. Consult with the park Historic Architect (Sueann Brown, 379-1222) to determine the type of roofing material and other specifications needed to protect and preserve the historic character of buildings that are historic properties.				
2. Consult with park Historic Architect (Sueann Brown, 379-1222) concerning any structures built in the 1950s or 1960s for potential National Register eligibility.				

G. WILDERNESS ACT CHECKLIST

Is the proposed project:	Yes	No	N/A	Data Needed to Determine/Notes
1. Within designated Wilderness?	<input type="checkbox"/>	<input checked="" type="checkbox"/>	<input type="checkbox"/>	
2. Within a Potential Wilderness Addition?	<input type="checkbox"/>	<input checked="" type="checkbox"/>	<input type="checkbox"/>	
If "yes" to either of the above, then a Wilderness Minimum Requirements Analysis must be completed and attached.				
Mitigations and Conditions:				
1. None				

**Yosemite National Park
Environmental Screening Form**

H. WILD AND SCENIC RIVERS ACT CHECKLIST

Does the proposed project:	Yes	No	N/A	Data Needed to Determine/Notes
1. Fall within a wild and scenic river corridor? If "yes", name the river(s)	<input checked="" type="checkbox"/>	<input type="checkbox"/>	<input type="checkbox"/>	Merced River
2. Fall within the bed and banks AND affect the free-flow of the river?	<input type="checkbox"/>	<input checked="" type="checkbox"/>	<input type="checkbox"/>	
3. Potentially affect water quality of the area?	<input type="checkbox"/>	<input checked="" type="checkbox"/>	<input type="checkbox"/>	
4. Diminish or other wise change the values for which the river was designated as a Wild and Scenic River? If "yes", explain.	<input type="checkbox"/>	<input checked="" type="checkbox"/>	<input type="checkbox"/>	
5a. Fall on a tributary of a Wild and Scenic River?	<input type="checkbox"/>	<input checked="" type="checkbox"/>	<input type="checkbox"/>	
5b. If 5a is "yes", will the project affect the Wild and Scenic River corridor?	<input type="checkbox"/>	<input type="checkbox"/>	<input checked="" type="checkbox"/>	
5c. If 5a is "yes", will the project unreasonably diminish scenic, recreational, or fish and wildlife values?	<input type="checkbox"/>	<input type="checkbox"/>	<input checked="" type="checkbox"/>	

If "yes" to questions 2, 5b, or 5c, then a WSRA Section 7 determination must be completed and attached.

Mitigations and Conditions:

1. None
-

I. NEPA Analysis and Approval Conditions

When implemented as detailed in the project description and following all Project Mitigations and Conditions listed below, this project meets the terms and conditions of a categorical exclusion to NEPA.

Applicable Categorical Exclusion:

Depending on the historic character of the structure, these actions would be covered by either DO12 C (3) - Routine maintenance and repairs to non-historic structures, facilities, utilities, grounds, and trails; or, for historic structures, C (4) - Routine maintenance and repairs to cultural resource sites, structures, utilities, and grounds if the action falls under an approved Historic Structures Preservation Guide or would not adversely affect the cultural resource.

Project Mitigations and Conditions:

- 1. Develop and submit a Safety Plan and a Job Hazard Analysis to the park Safety Officer (Roger Farmer, (379-1079) for review and approval before beginning any project work. (Safety Office)**
- 2. Ensure that all equipment and materials brought into the park are free of non-native, invasive plants and animals, and noxious weeds. All staff working on site shall be informed of and follow best management practices for preventing the introduction and spread of non-native, invasive species as described in Division 1 Specifications, Section 1355. (Environmental Planning and Compliance)**
- 3. Consult with the park Historic Architect (Sueann Brown, 379-1222) to determine the type of roofing material and other specifications needed to protect and preserve the historic character of buildings that are historic properties. (Resource Management and Science)**
- 4. Consult with park Historic Architect (Sueann Brown, 379-1222) concerning any structures built in the 1950s or 1960s for potential National Register eligibility. (Resource Management and Science)**

This project has been reviewed in accordance with the above criteria and it has been determined that the project will result in no or minimal environmental effects. Therefore, it is categorically excluded from further environmental review required under the National Environmental Policy Act. Additionally, the necessary compliance coordination has been completed with regard to the National Historic Preservation Act, the Wilderness Act, the Wild and Scenic Rivers Act, and the Endangered Species Act.

//GWColliver// *11/30/06*

Compliance Specialist **Date**

//Mark A Butler// *11/30/06*

Compliance Program Manager **Date**

//Bill Delaney// *12/1/06*

Chief, Project Management **Date**

*The signed original of this document is on file at
the Environmental Planning and Compliance
Office in Yosemite National Park.*

Attachment A

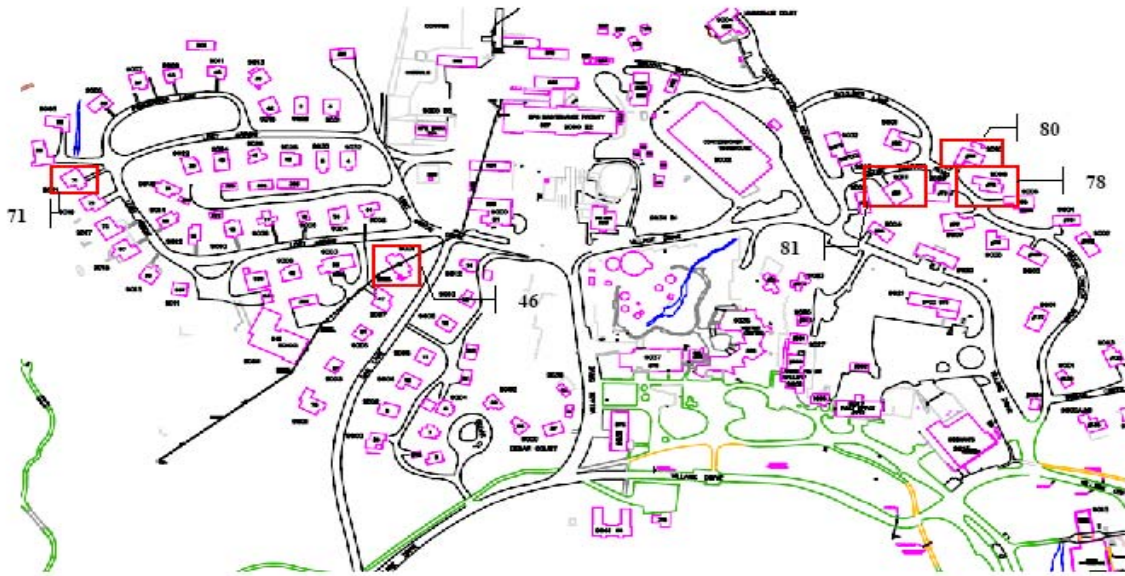

Map 1 - Valley Housing Roof Replacement

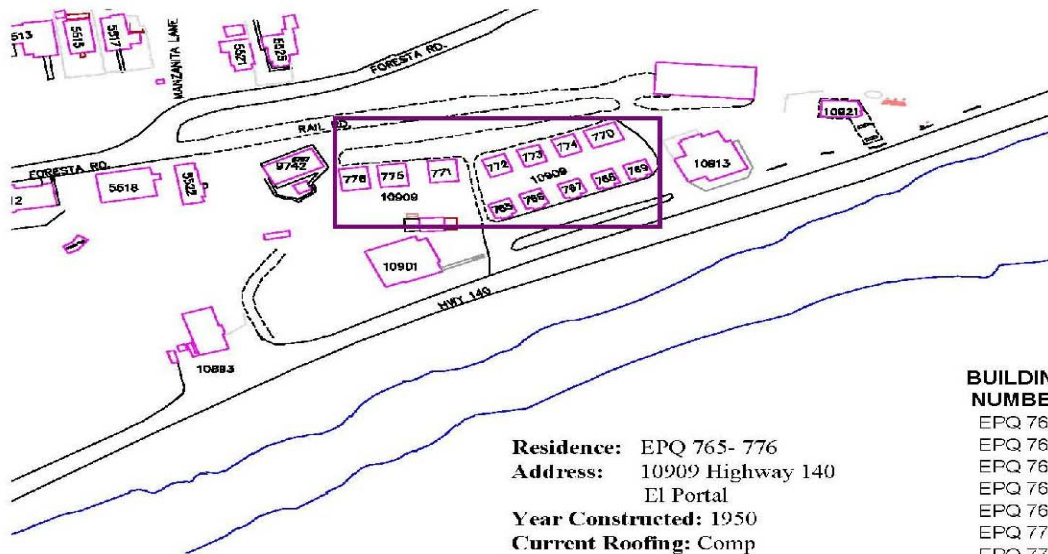

Residence: EPQ 765- 776
Address: 10909 Highway 140
 El Portal
Year Constructed: 1950
Current Roofing: Comp
Proposed Roofing: Comp

BUILDING NUMBER	SQ
EPQ 765	6
EPQ 766	6
EPQ 767	6
EPQ 768	6
EPQ 769	6
EPQ 770	6
EPQ 771	6
EPQ 772	6
EPQ 773	6
EPQ 774	6
EPQ 775	7
EPQ 776	6

El Portal Housing Roof Replacement

Yosemite National Park
Environmental Screening Form

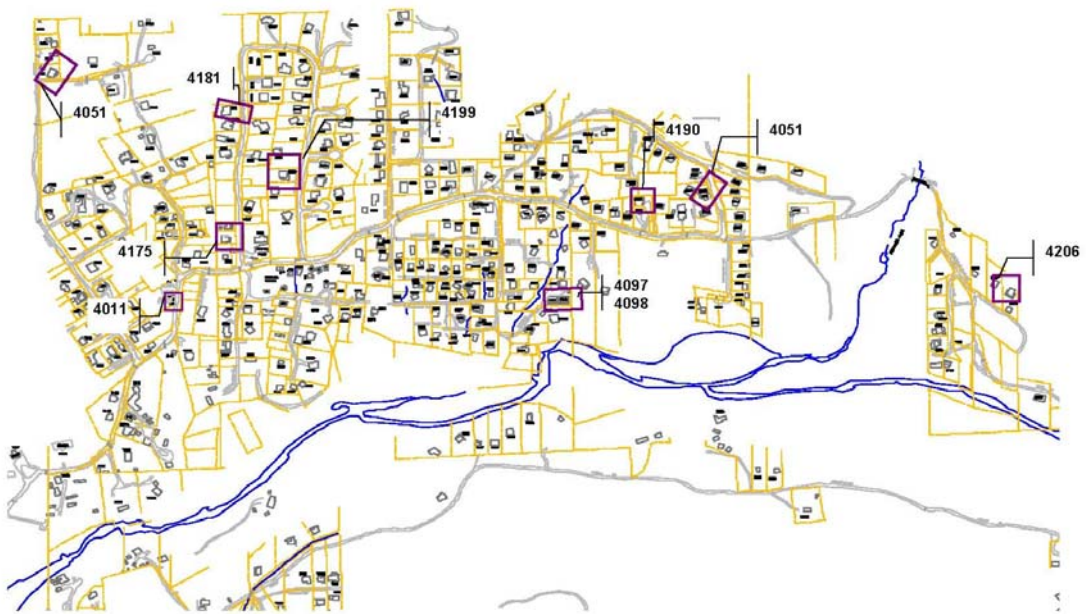

Wawona Roofing Replacement Map

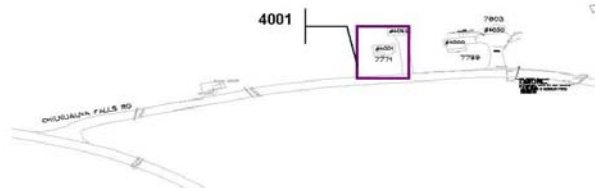

Attachment B

BUILDING NUMBER	ADDRESS	DESCRIPTION	BUILT	LCS NUM	ASSET NUM	ROOF TYPE	SQ
VaQ 0046	9001 Lost Arrow Drive	Yosemite Valley Apartment	1931	5747	10568	Cedar Shingles	37
VaQ 0080	9010 Indian Canyon Road	Yosemite Valley Quarters	1958	n/a	10599	Modified	20
VaQ 0081	9011 Indian Canyon Road	Yosemite Valley Quarters	1958	n/a	10600	Modified	17
VaQ 0078	9008 Indian Canyon Road	Yosemite Valley Quarters	1958	n/a	10598	Modified	17
VaQ 0071	9021 Lost Arrow Drive	Yosemite Valley Quarters	1956	n/a	10591	Modified	20
WaQ 4001	7771 Chilnualna Falls Road	Wawona Quarters	1938	55763	10044	Royals	18
WaQ 4175	2611 W. Bruce Road	Wawona Quarters	1966	n/a	10078	Metal	16
WaQ 4095	2615 Larke Lane	Wawona Quarters	1971	n/a	10966	Metal	28
WaQ 4097	2580 River View Road	Wawona Quarters	1969	n/a	10059	Metal	21
WaQ 4098	2582 River View Road	Wawona Quarters	1971	n/a	10060	Metal	21
WaQ 4199	2625 E. Bruce Road	Wawona Quarters	1965	n/a	10093	Metal	19
WaQ 4011	2609 Spelt Road	Wawona Quarters	1955	n/a	10046	Metal	10
WaQ 4051	2681 Spelt Road	Wawona Quarters	1966	n/a	95829	Metal	10
WaQ 4190	8077 Chilnualna Falls Road	Wawona Quarters	1970	n/a	10102	Metal	20
WaQ 4181	2641 W. Bruce Road	Wawona Quarters	1965	n/a	10540	Metal	20
WaQ 4206	8177 Chilnualna Falls Road	Wawona Quarters	1972	n/a	10096	Metal	22
EPQ 765	10909 Highway 140	EP Motor Inn Cabin	1950	n/a	8476	Composition	6
EPQ 766	10909 Highway 140	EP Motor Inn Cabin	1950	n/a	8544	Composition	6
EPQ 767	10909 Highway 140	EP Motor Inn Cabin	1950	n/a	8555	Composition	6
EPQ 768	10909 Highway 140	EP Motor Inn Cabin	1950	n/a	8569	Composition	6
EPQ 769	10909 Highway 140	EP Motor Inn Cabin	1950	n/a	8593	Composition	6
EPQ 770	10909 Highway 140	EP Motor Inn Cabin	1950	n/a	8636	Composition	6
EPQ 771	10909 Highway 140	EP Motor Inn Cabin	1950	n/a	8640	Composition	6
EPQ 772	10909 Highway 140	EP Motor Inn Cabin	1950	n/a	8650	Composition	6
EPQ 773	10909 Highway 140	EP Motor Inn Cabin	1950	n/a	8661	Composition	6
EPQ 774	10909 Highway 140	EP Motor Inn Cabin	1950	n/a	8672	Composition	6
EPQ 775	10909 Highway 140	EP Motor Inn Cabin	1950	n/a	8681	Composition	7
EPQ 776	10909 Highway 140	EP Motor Inn Cabin	1950	n/a	8684	Composition	6

Preservation Assessment Form (YOSE XXX)

(Version: AUG06)

Compliance Tracking Number: 2007-010

PEPC Project Number: 17113

A. DESCRIPTION OF UNDERTAKING

Title: Yosemite Valley, El Portal, Wawona Housing Roof Replacement

Project Location and Area of Potential Effect:

Wawona, Mariposa County, California

Yosemite Valley, El Portal, Wawona

Project Manager: Tom Darcy, Facilities Management, Yosemite National Park

Project Description: The purpose of this project is to replace deteriorated roofing and roof sheeting on various National Park Service (NPS) housing units. Structural repairs would be made if necessary. Damaged overhangs would be repaired and re-painted as needed. Each roof would be evaluated individually: although general roof specifications guidelines are used for reference for NPS replacement/repair projects, in the case of listed historic cultural properties, consultation with NPS cultural resource staff determines the type of roofing and other specifications needed to protect and preserve the historic character of these buildings.

Roofs scheduled for replacement in 2006-2007 are listed in Attachment B.

1. Attached Sensitive Information**	Yes	No	Explanation/Source/Notes
a. Maps	<input type="checkbox"/>	<input checked="" type="checkbox"/>	
b. Drawings	<input type="checkbox"/>	<input checked="" type="checkbox"/>	
c. Site Plans	<input type="checkbox"/>	<input checked="" type="checkbox"/>	
d. Photographs	<input type="checkbox"/>	<input checked="" type="checkbox"/>	
e. Sample	<input type="checkbox"/>	<input checked="" type="checkbox"/>	
f. List of Materials	<input type="checkbox"/>	<input checked="" type="checkbox"/>	
g. Other (Explain)	<input type="checkbox"/>	<input checked="" type="checkbox"/>	

** Sensitive documents not for duplication or distribution beyond park management, subject matter experts, and the project statutory compliance file.

B. DESCRIPTION OF EFFECTS

	Yes	No	N/A	Explanation/Notes
1. Has the Area of Potential Effect been surveyed to identify historic properties? If Yes, provide reference for the Survey (s).	<input checked="" type="checkbox"/>	<input type="checkbox"/>	<input type="checkbox"/>	Various documents and LCS records.
a. Would the proposed action affect a known historic property?	<input checked="" type="checkbox"/>	<input type="checkbox"/>	<input type="checkbox"/>	Some historic properties are listed for repair.

2. List all Historic Properties in the Area of Potential Effect:	Affected?		Explanation/Notes
	Yes	No	
a. LCS #05747	<input checked="" type="checkbox"/>	<input type="checkbox"/>	Roof replacement.
b. LCS #55763	<input checked="" type="checkbox"/>	<input type="checkbox"/>	Roof replacement.
c.	<input type="checkbox"/>	<input type="checkbox"/>	

3. List resources in the Area of Potential Effect to which American Indians attach cultural and religious significance:	Affected?		Explanation/Notes
	Yes	No	
a.	<input type="checkbox"/>	<input type="checkbox"/>	
b.	<input type="checkbox"/>	<input type="checkbox"/>	
c.	<input type="checkbox"/>	<input type="checkbox"/>	

4. The proposed action will:	Yes	No	N/A	Explanation/Note
• Destroy, remove, or alter features or elements from a historic structure	<input type="checkbox"/>	<input checked="" type="checkbox"/>	<input type="checkbox"/>	
• Replace historic features/elements in kind	<input checked="" type="checkbox"/>	<input type="checkbox"/>	<input type="checkbox"/>	
• Add nonhistoric features/elements to a historic structure	<input type="checkbox"/>	<input checked="" type="checkbox"/>	<input type="checkbox"/>	
• Alter or remove features/elements of a historic setting or environment (including terrain)	<input type="checkbox"/>	<input checked="" type="checkbox"/>	<input type="checkbox"/>	
• Add nonhistoric features/elements (including visual, audible, or atmospheric) to a historic setting or cultural landscape	<input type="checkbox"/>	<input checked="" type="checkbox"/>	<input type="checkbox"/>	
• Disturb, destroy, or make archeological resources inaccessible, or alter associated terrain	<input type="checkbox"/>	<input checked="" type="checkbox"/>	<input type="checkbox"/>	
• Disturb, destroy, or make ethnographic resources inaccessible, or alter associated terrain	<input type="checkbox"/>	<input checked="" type="checkbox"/>	<input type="checkbox"/>	
• Begin or contribute to the deterioration of historic fabric, terrain, setting, landscape elements, or archeological or ethnographic resources	<input type="checkbox"/>	<input checked="" type="checkbox"/>	<input type="checkbox"/>	
• Involve a real property transaction affecting historic cultural properties (i.e., the exchange, sale, or lease of land or structures)	<input type="checkbox"/>	<input checked="" type="checkbox"/>	<input type="checkbox"/>	
• Potentially affect presently unidentified historic resources	<input type="checkbox"/>	<input checked="" type="checkbox"/>	<input type="checkbox"/>	
• Other	<input type="checkbox"/>	<input checked="" type="checkbox"/>	<input type="checkbox"/>	

5. Describe any measures that are incorporated as part of this project that will be taken to prevent or minimize loss or impairment of prehistoric or historic fabric, setting, integrity, or data:

NPS cultural resource staff will be consulted to determine the type of roofing material and other specifications needed to protect and preserve the historic character of buildings that are historic properties.

Checklist prepared by: Jeannette Simons

Date: 11/7/06

Title: Historic Preservation Officer

C. SPECIALIST SECTION

Specialists: Your comments here (or attached) show that you have reviewed this proposal for conformity with requirements of *National Historic Preservation Act, Section 106*; with the 1995 *Service-wide Programmatic Agreement* (if applicable); with applicable parts of the *Secretary of the Interior's Standards and Guidelines for Archeology and Historic Preservation*; with the *NPS Management Policies* and *Cultural Resource Management Guideline*; and have given your best professional advice about this project and the issues relevant to the Section 106 process, including identification and evaluation of historic properties and further consultation needs.

Archeologist

Name: **Laura Kirn**

Date: 11/8/06

Comments:

Ground Disturbance Involved Yes: No:

Assessment of Effect: "**No Effect**"

Recommended Conditions:

Signature of Archeologist: //signed original on file//

Cultural Anthropologist

Name: **Sonny Montague**

Date:

Comments:

Assessment of Effect: <**Choose Effect**> or write it here >>

Recommended Conditions:

Signature of Cultural Anthropologist: _____

Curator

Name: **Jonathan Bayless**

Date:

Comments:

Assessment of Effect: <**Choose Effect**> or write it here >>

Recommended Conditions:

Signature of Curator: _____

Historian

Name: **Charles Palmer**

Date: 11/08/06

Comments:

Assessment of Effect: "**No Adverse Effect**"

Recommended Conditions:

Signature of Historian: //signed original on file//

Historic Architect

Name: **Sueann Brown**

Date: 11/7/06

Comments:

Assessment of Effect: "**No Adverse Effect**"

Recommended Conditions:

Signature of Historic Architect: //signed original on file//

Historic Landscape Architect Name: **Danny Schaible**

Date: 11/8/06

Comments:

Assessment of Effect: "**No Adverse Effect**"

Recommended Conditions:

Signature of Historic Landscape Architect: //signed original on file//

Preservation Specialist

Name: **Rod Kenec**

Date: 11/8/06

Comments:

Assessment of Effect: "**No Adverse Effect**"

Recommended Conditions: Recommended Conditions

Signature of Preservation Specialist: //signed original on file//

Native American Liaison

Name: **Jeannette Simons**

Date:

Comments:

Assessment of Effect: <**Choose Effect**> or write it here >>

Recommended Conditions:

Signature of Native American Liaison: _____

<**Enter Specialist Title**>

Name:

Date:

Comments:

Assessment of Effect: <**Choose Effect**> or write it here >>

Recommended Conditions:

Signature of <Enter Specialist's Title>: _____

**D. RESOURCES MANAGEMENT AND SCIENCE DIVISION AND PARK 106
COORDINATOR REVIEWS AND RECOMMENDATIONS**

- 1. Review by specialists:** The appropriate subject-matter experts have reviewed the project and entered their comments and recommendations in Section C, above.

The foregoing assessment is adequate: the proposed action is consistent with all applicable NPS management policies, standards, guidelines, or US DOI standards and guidelines, Rehabilitation of Historic Buildings, or others, and incorporates measures to avoid Adverse Effects.

Reviewed and Accepted by:

Signature: //Niki Stephanie Nicholas// **Date:** 11/27/06
Chief of Resources Management & Science Division

- 2. Compliance Requirements:** The following is the park's assessment of Section 106 process needs and requirements for this undertaking.

Standard 36 CFR Part 800 Consultation

Consultation under 36 CFR is needed subsequent to the preparation of this form and its review by appropriate historic resource management advisors.

Undertaking related to the 1995 NPS Programmatic Agreement

The above action meets all conditions for a programmatic exclusion under Stipulation IV. A of the 1995 NPS programmatic agreement, and is listed in Stipulation IV. B, as:

<Choose Type of Undertaking>

Plan-Related Undertaking

Consultation and review of the proposed undertaking were completed in the context of a plan review process, in accordance with the 1995 NPS programmatic agreement and 36 CFR Part 800.

Undertaking Related to Another Agreement

The proposed undertaking is covered for Section 106 purposes under a document such as a statewide agreement written in accordance with 37 CFR Part 800.7 or counterpart regulations.

Agreement: <Enter Agreement Information>

Flood-Recovery Related Undertaking

The proposed undertaking is covered for Section 106 purposes under the letter-based agreement between the NPS, the State Historic Preservation Office, and the Council for Historic Preservation for "Highwater 97" flood repair and recovery

Undertaking Related to the 1999 Yosemite Programmatic Agreement

The proposed undertaking is covered for Section 106 purposes under the park's 1999 programmatic agreement for planning, design, construction, operations and maintenance; the undertaking meets the stipulations identified in Article VII.C.2.

3. Assessment of Effects: No Adverse Effect

4. Project Stipulations and Conditions

Following are listed any stipulations or conditions necessary to ensure that the assessment of effects above is consistent with 36 CFR 800 criteria of effect or to mitigate potential adverse effects:

- a. See Section B 5.
- b. Consult with Park Architect concerning structures built in 1950s and 60s for potential National Register eligibility.

Recommended by Park Section 106 Coordinator:

Name: **Jeannette Simons**

Title: **Historic Preservation Officer**

Signature: //Jeannette Simons// Date: 11/28/06

E. SUPERINTENDENT'S APPROVAL

The proposed work conforms to NPS Management Policies and NPS-28 and I approve the recommendations, stipulations, and conditions noted in Section B of this form.

Signature of Superintendent: //MJTollefson// Date: 12/5/06

Michael J. Tollefson

*The signed original of this document is on file at
the Environmental Planning and Compliance
Office in Yosemite National Park.*