

**For illustrative purposes ONLY.**

Jones Point Park  
Environmental Assessment

**Alternative 1**  
**Alexandria City Council's "Scheme A"**  
dated 6/28/05

June, 2007

Not To Scale

Figure 5



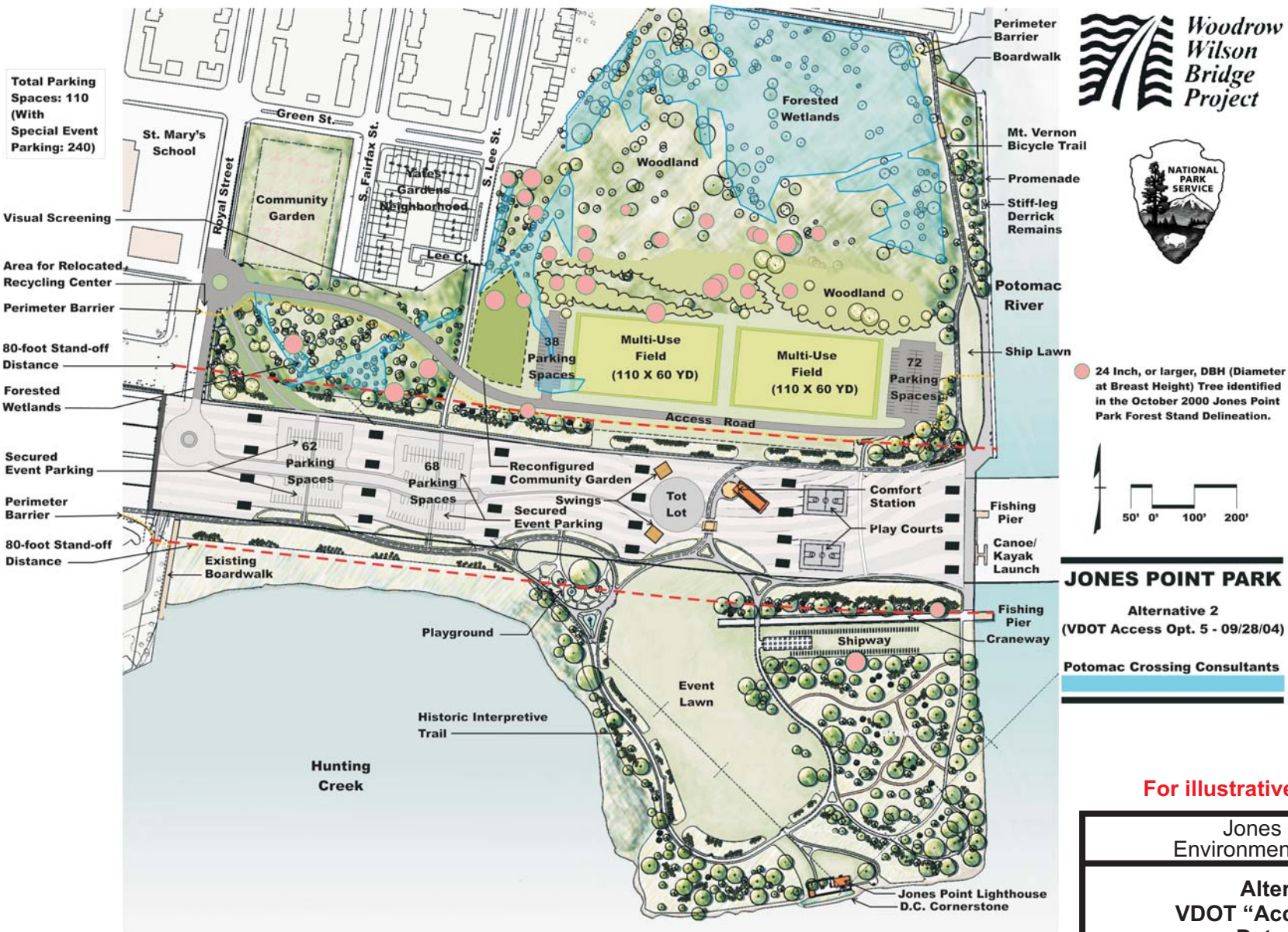

**For illustrative purposes ONLY.**

Jones Point Park  
Environmental Assessment

**Alternative 2**  
**VDOT "Access Option 5"**  
**Dated 9/28/04**

June, 2007

Scale As Shown

Figure 6



Total Parking  
Spaces: 110  
(With  
Special Event  
Parking: 240)



**Woodrow  
Wilson  
Bridge  
Project**



● 24 Inch, or larger, DBH (Diameter at Breast Height) Tree identified in the October 2000 Jones Point Park Forest Stand Delineation.

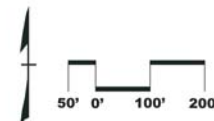

## JONES POINT PARK

**Alternative 3**  
(Former "Alt. 2" from JPP EA: 09/10/01)

Potomac Crossing Consultants

**For illustrative purposes ONLY.**

Jones Point Park  
Environmental Assessment

**Alternative 3**  
Based on "Alternative 2" from JPP EA  
Dated 9/10/01

June, 2007

Scale As Shown

Figure 7



