

Appendix E. Historic Resource Documentation, Morning Star Mines Interpretive Area, Rush Historic District

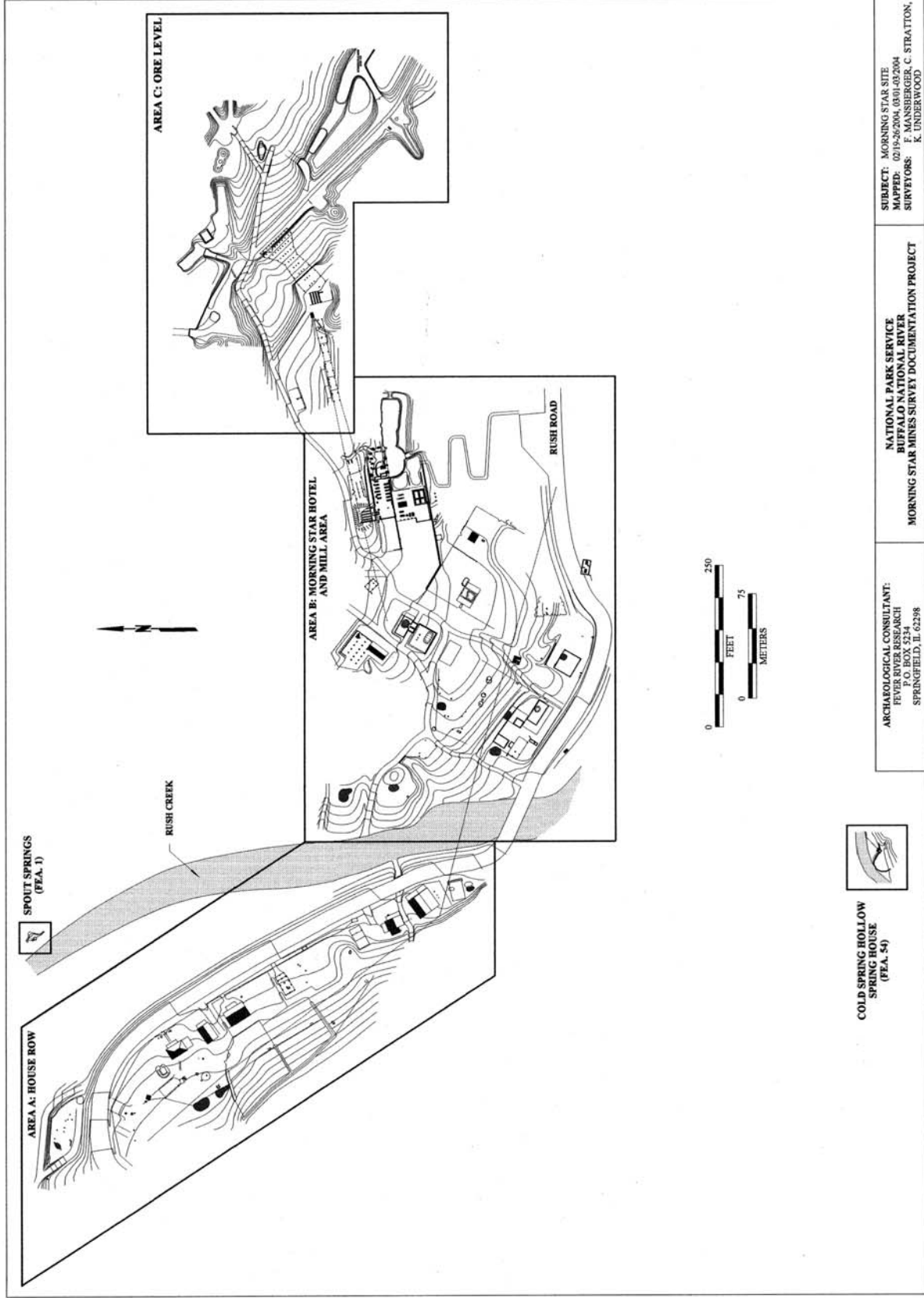

Figure 39. Map showing the sections of the Morning Star Site mapped in detail during the project (FRR 2004).

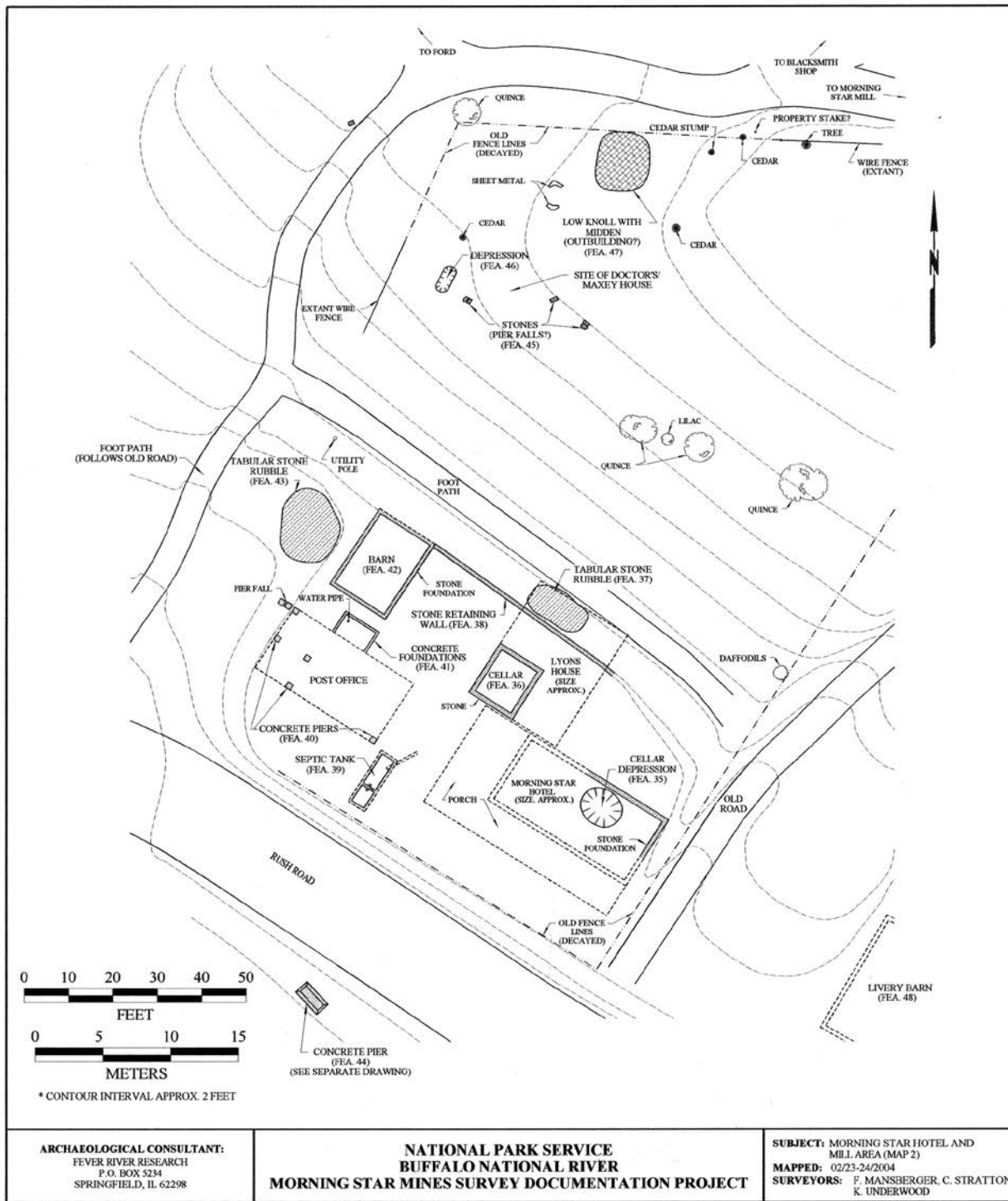

Figure 130. Map 2 of Area "B" of the Morning Star Site, showing the Morning Star Hotel lot. The size and configuration of some of the building footprints shown are approximate, due to the absence of above-grade structural evidence (FRR 2004).

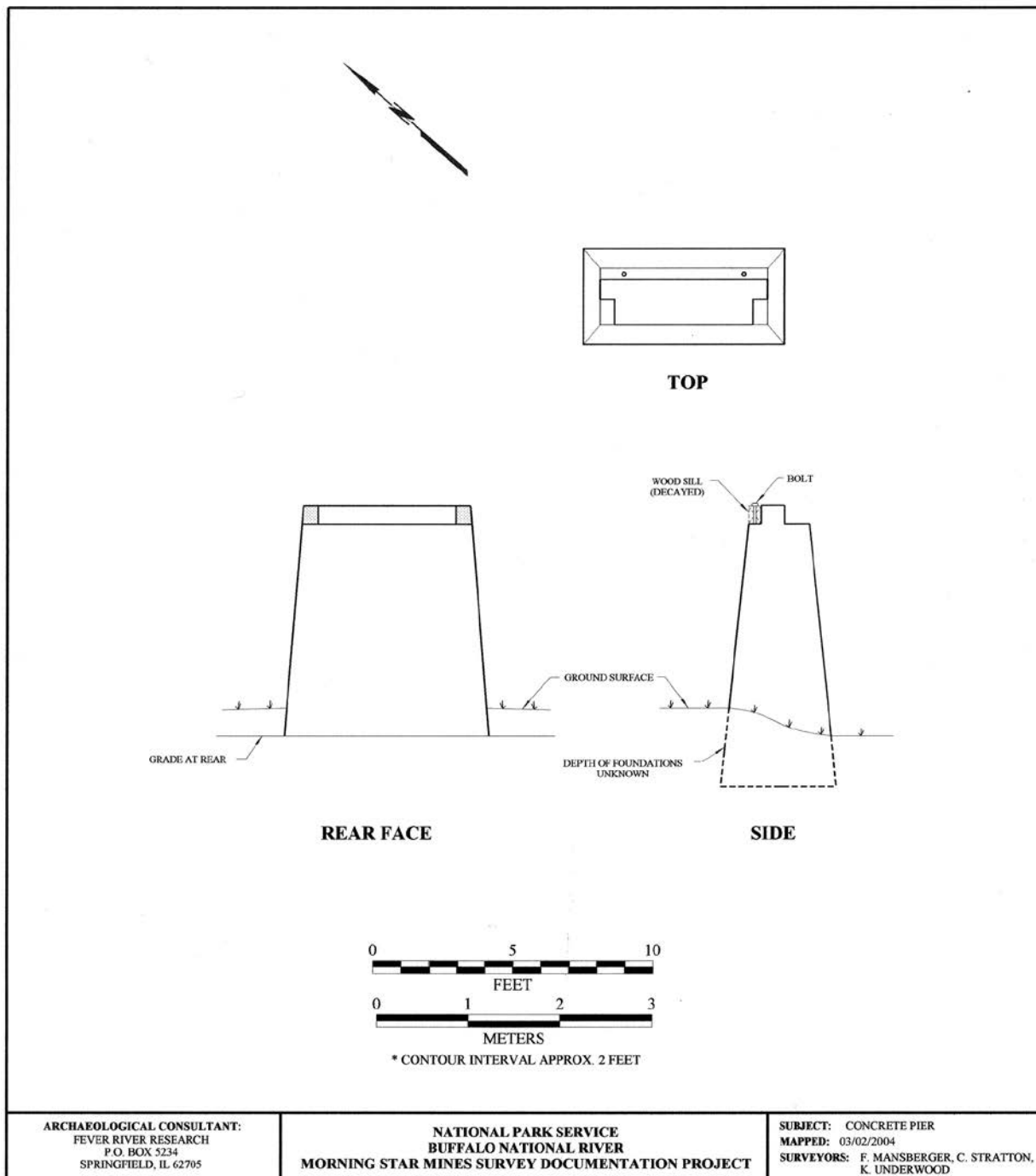

Figure 136. Plan and sectional views of Feature 44 (FRR 2004).

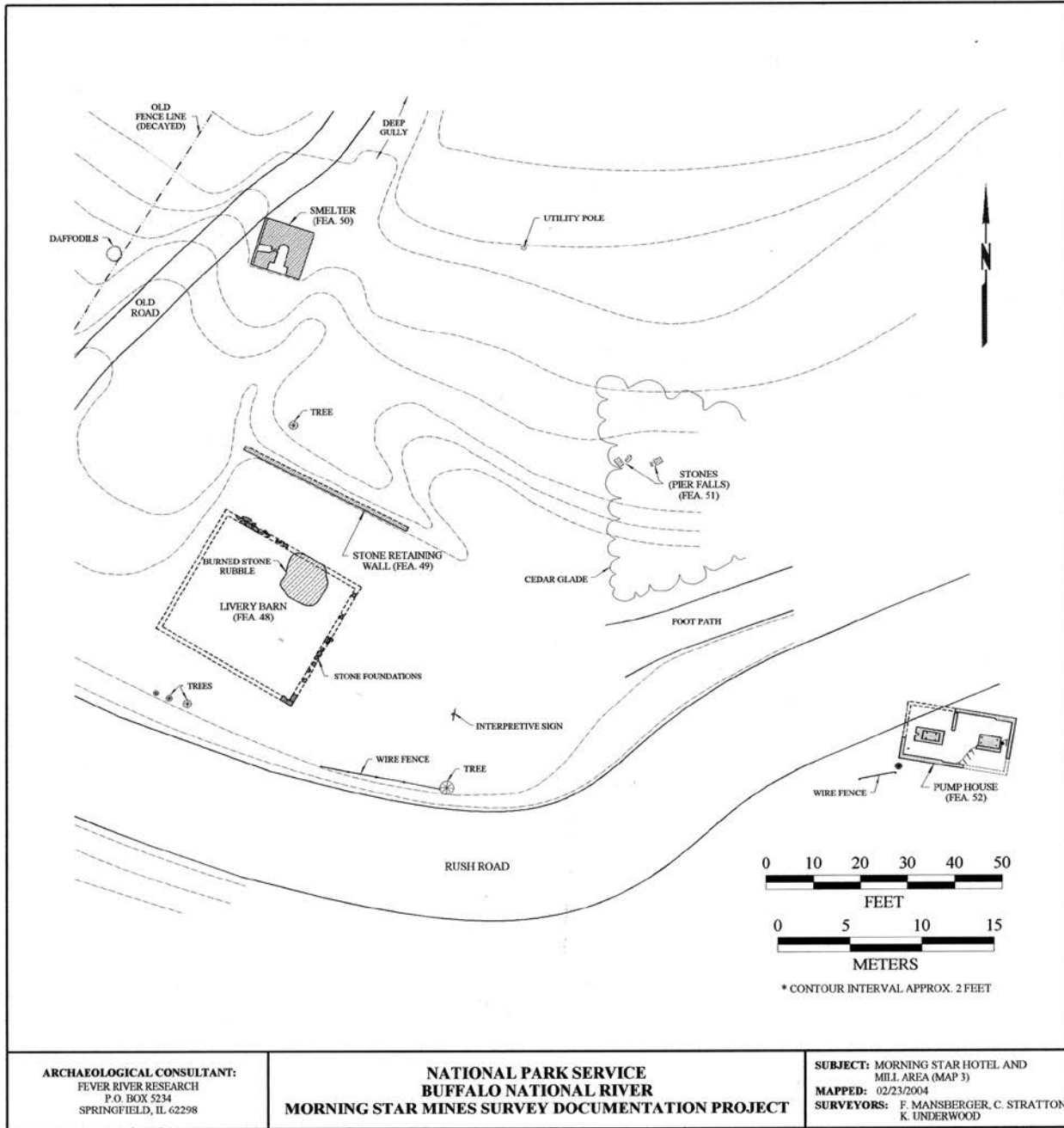

Figure 141. Map 3 of Area "B" of the Morning Star Site, showing the smelter and livery barn locations (FRR 2004).

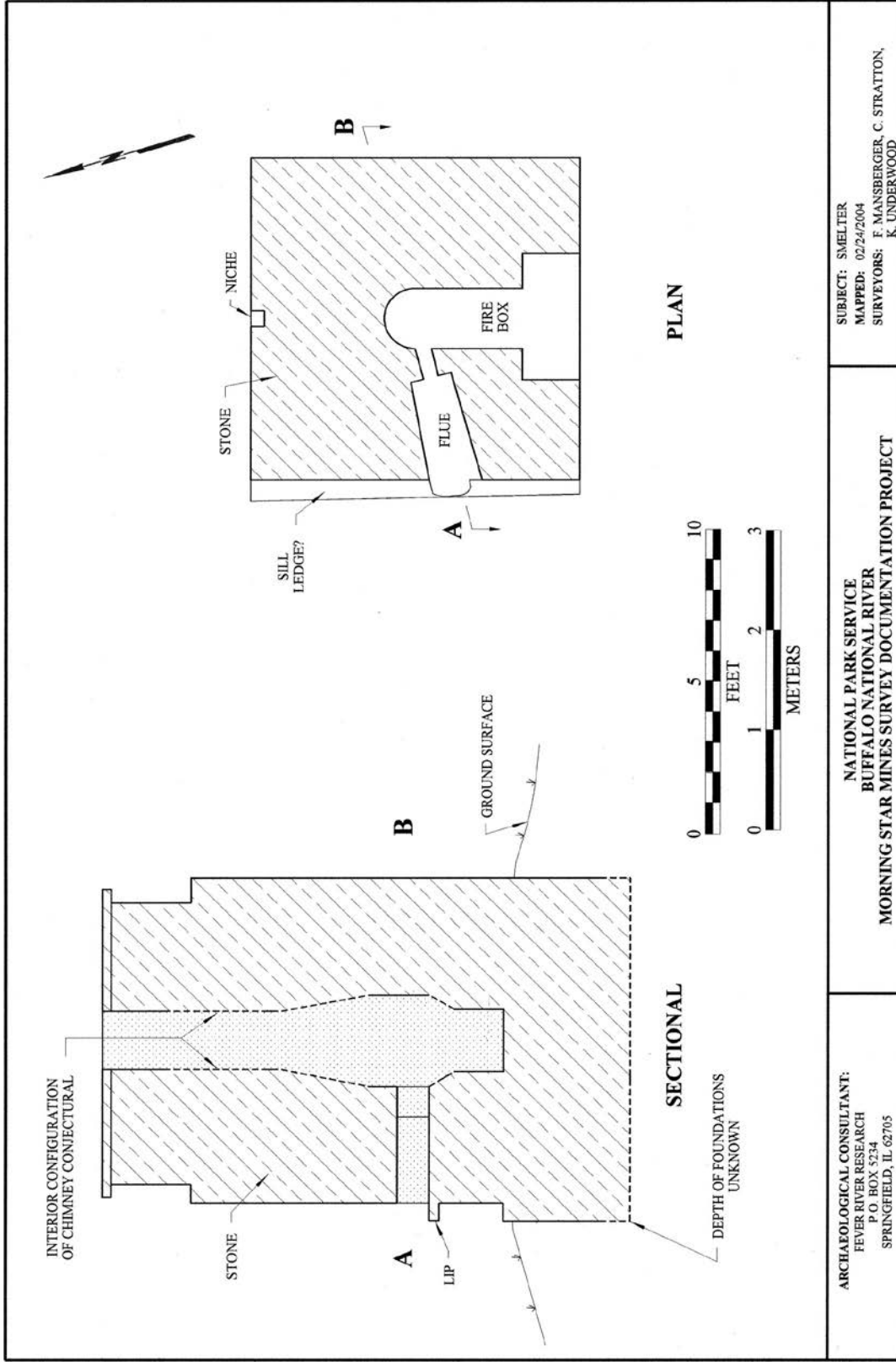

Figure 147. Plan and sectional views of the smelter (Feature 50) (FRR 2004).

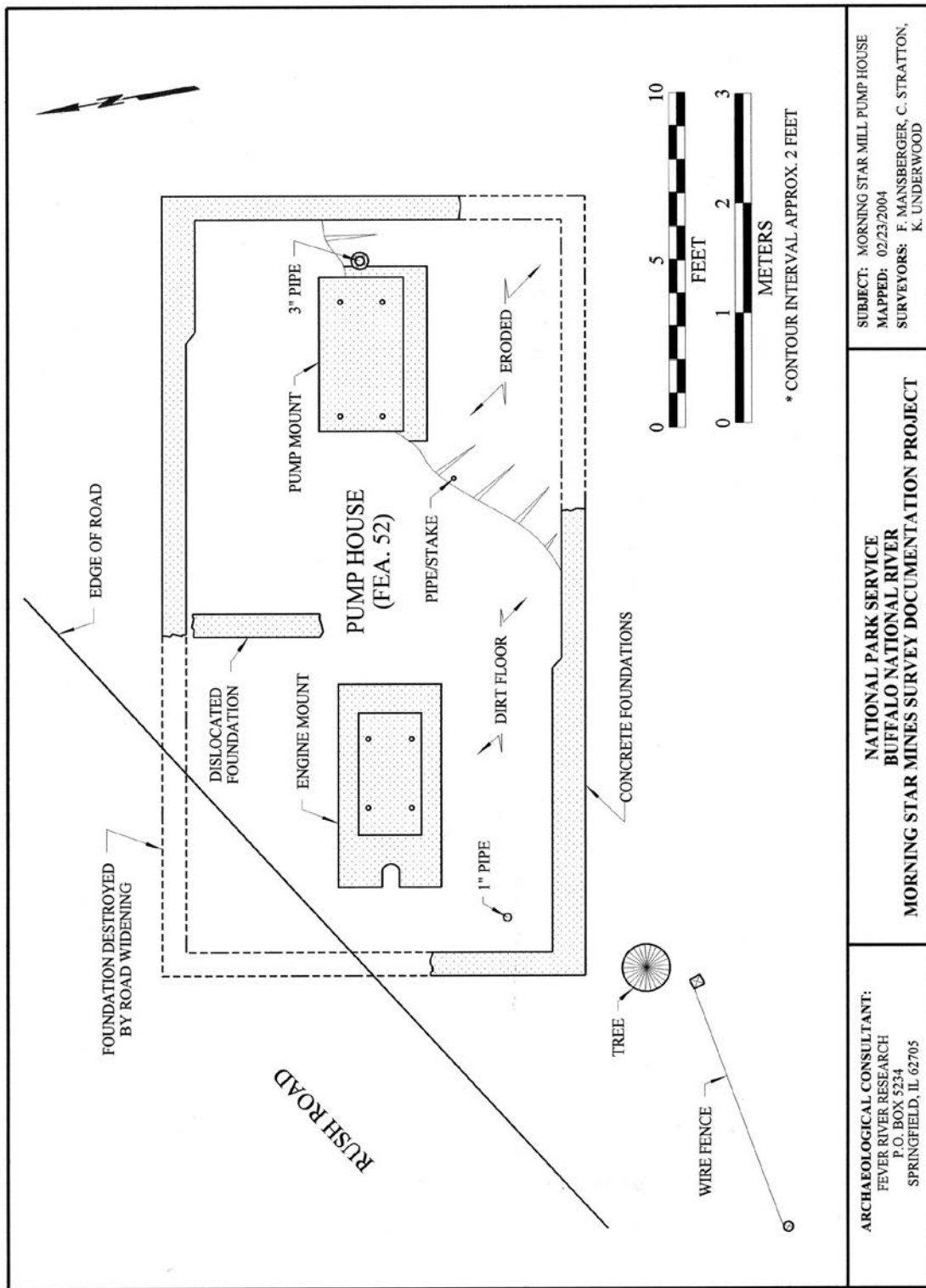

Figure 149. Plan of the pump house ruins (FRR 2004).

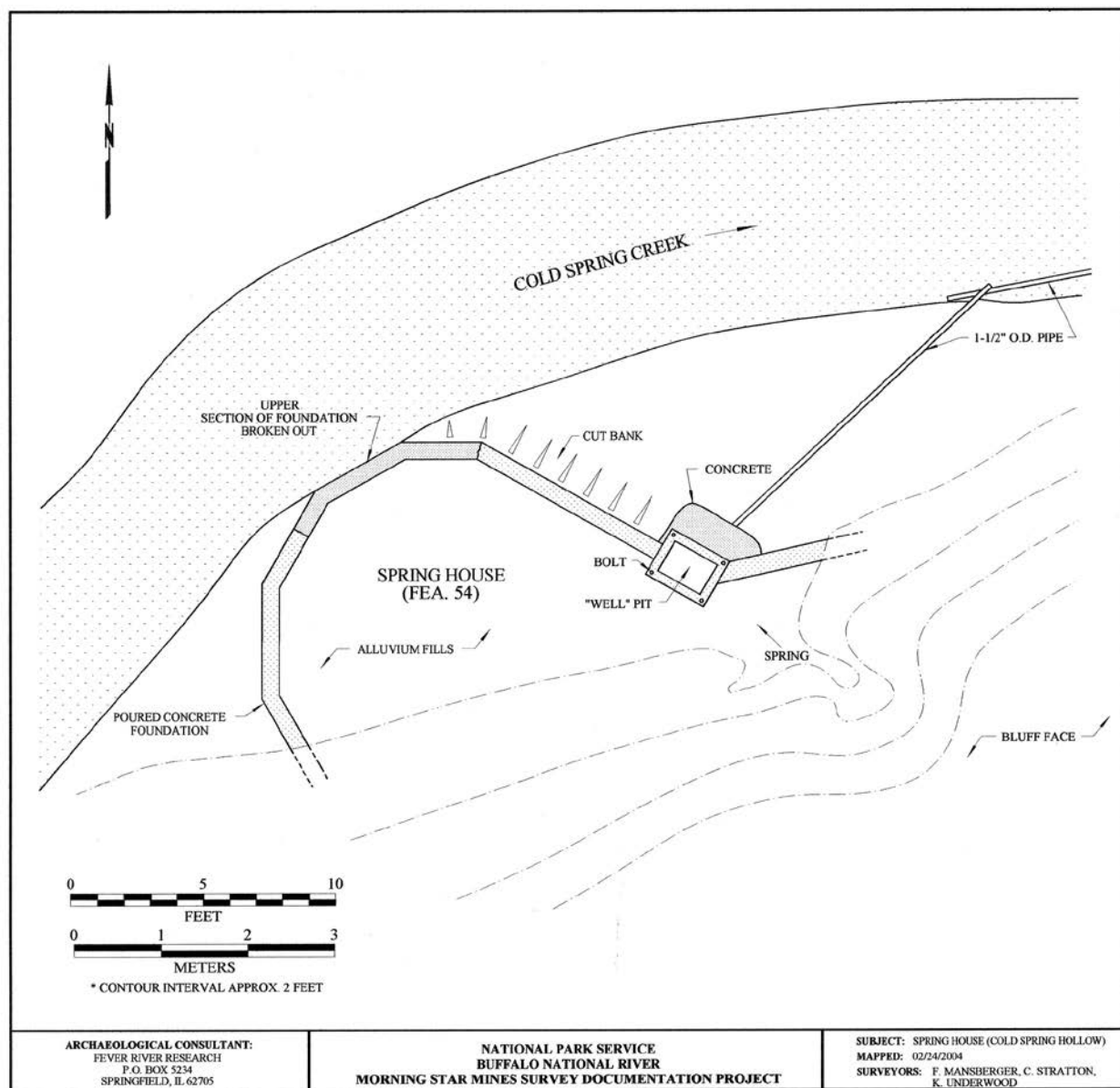

Figure 152. Plan of the Cold Spring Hollow spring house (FRR 2004).

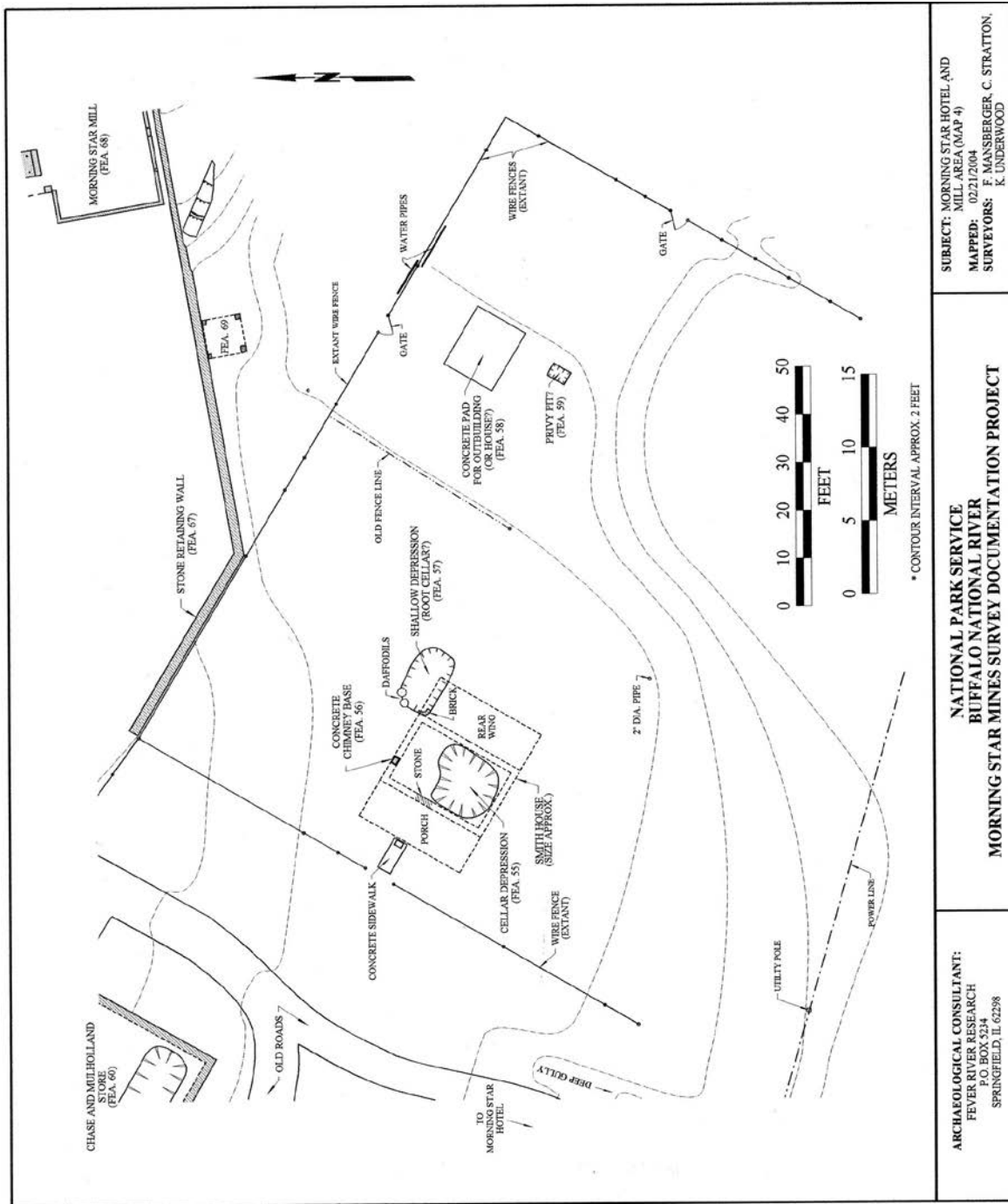

Figure 157. Map 4 of Area "B" of the Morning Star Site, showing the Smith House lot (FRR 2004).

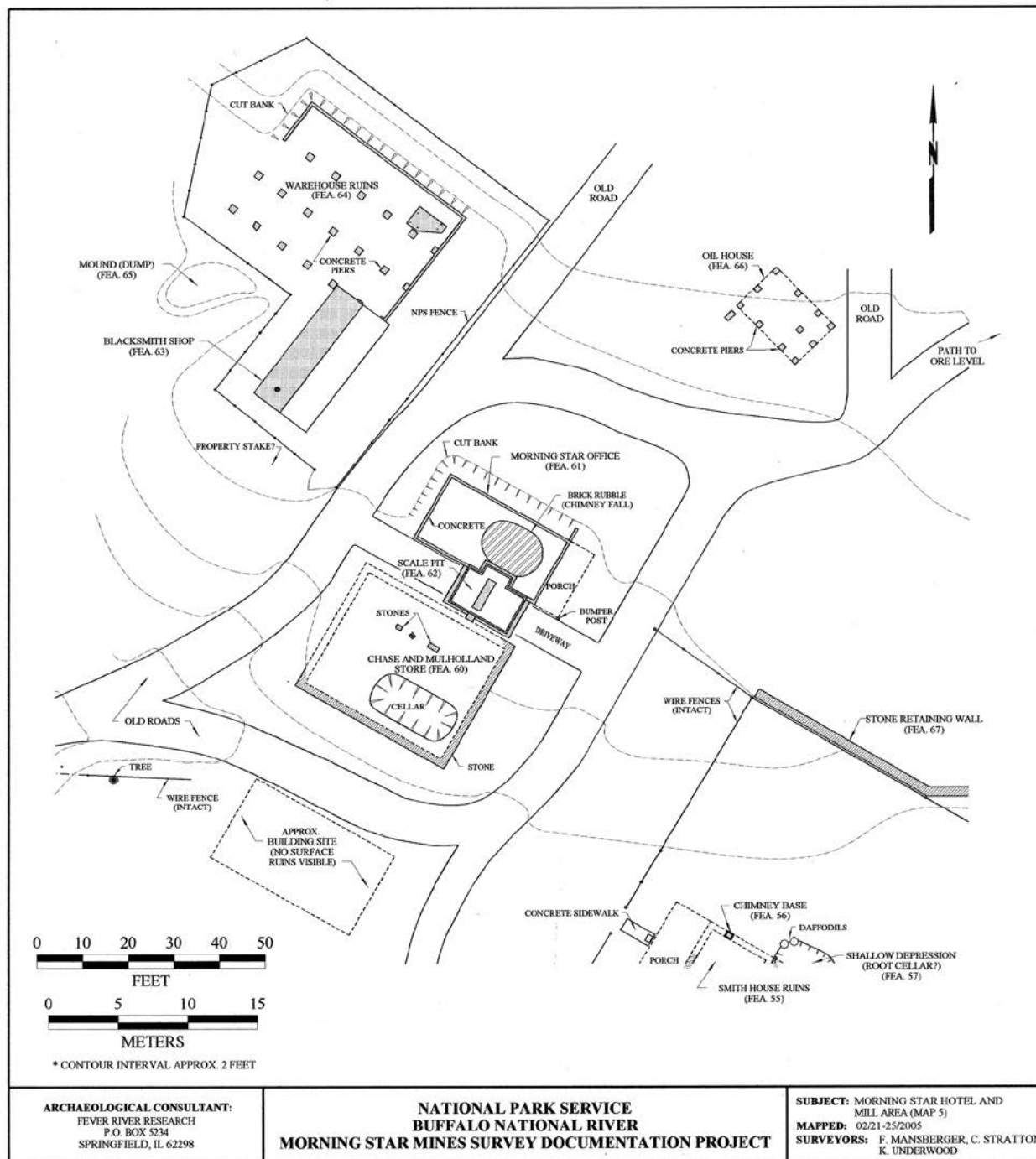

Figure 166. Map 5 of Area "B" of the Morning Star Site, showing the area around the Morning Star Office and Medley Blacksmith Shop (FRR 2004).

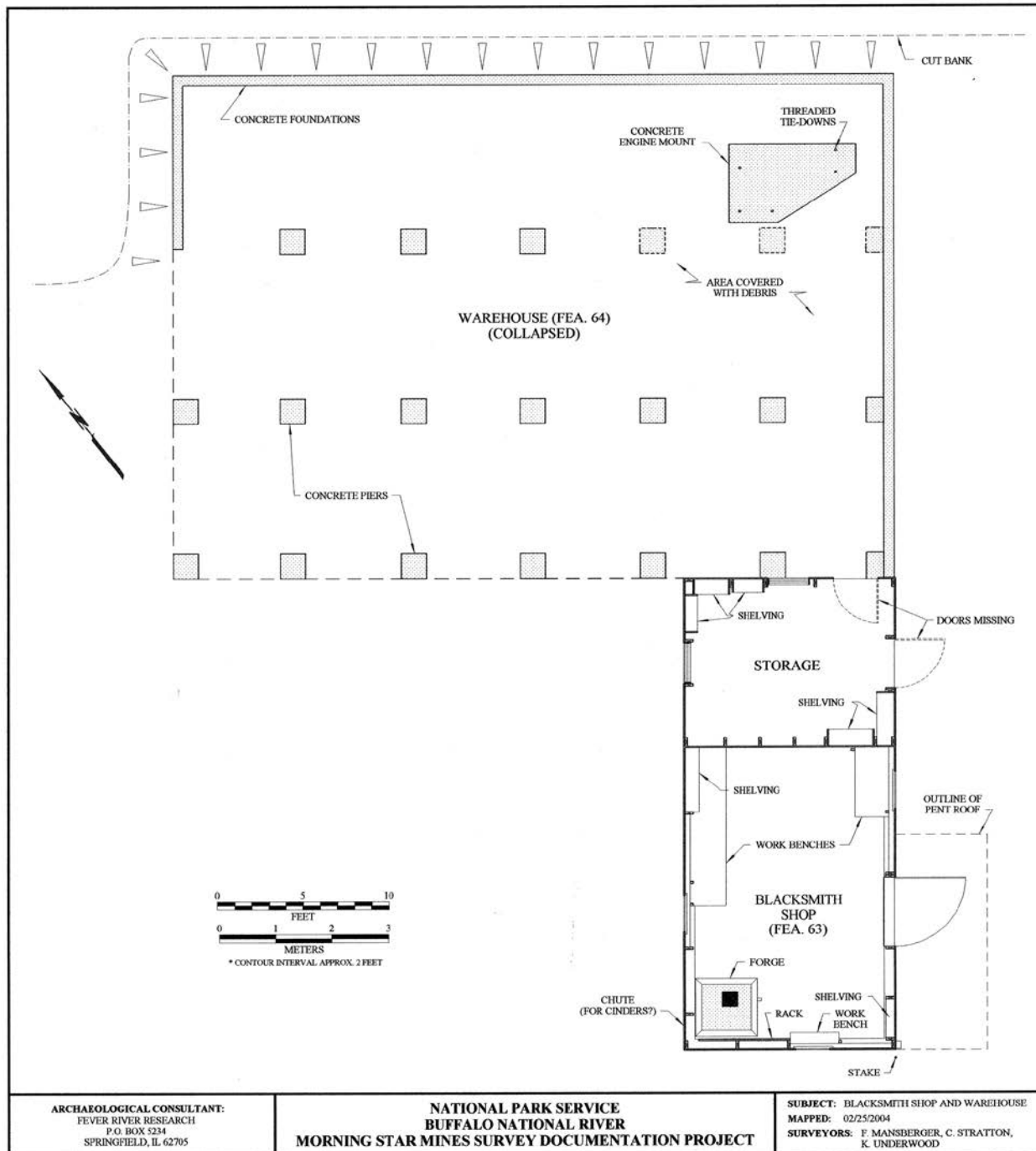

Figure 177. Plan of blacksmith shop and warehouse (Features 63 and 64) showing existing conditions (FRR 2004).

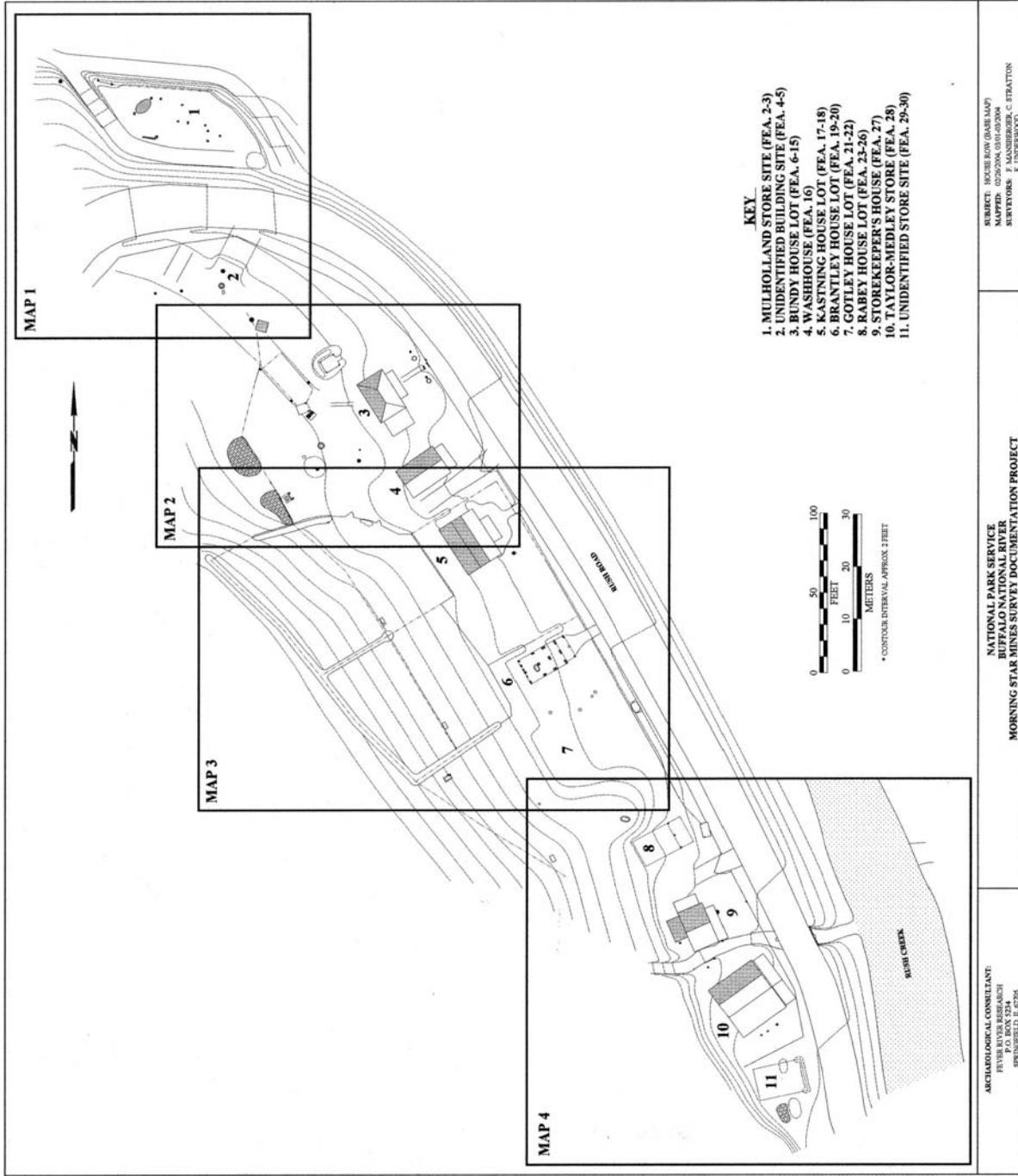

Figure 44. Areas mapped along House Row by Fever River Research in 2004. Detailed maps of these areas are attached below (FRR 2004).

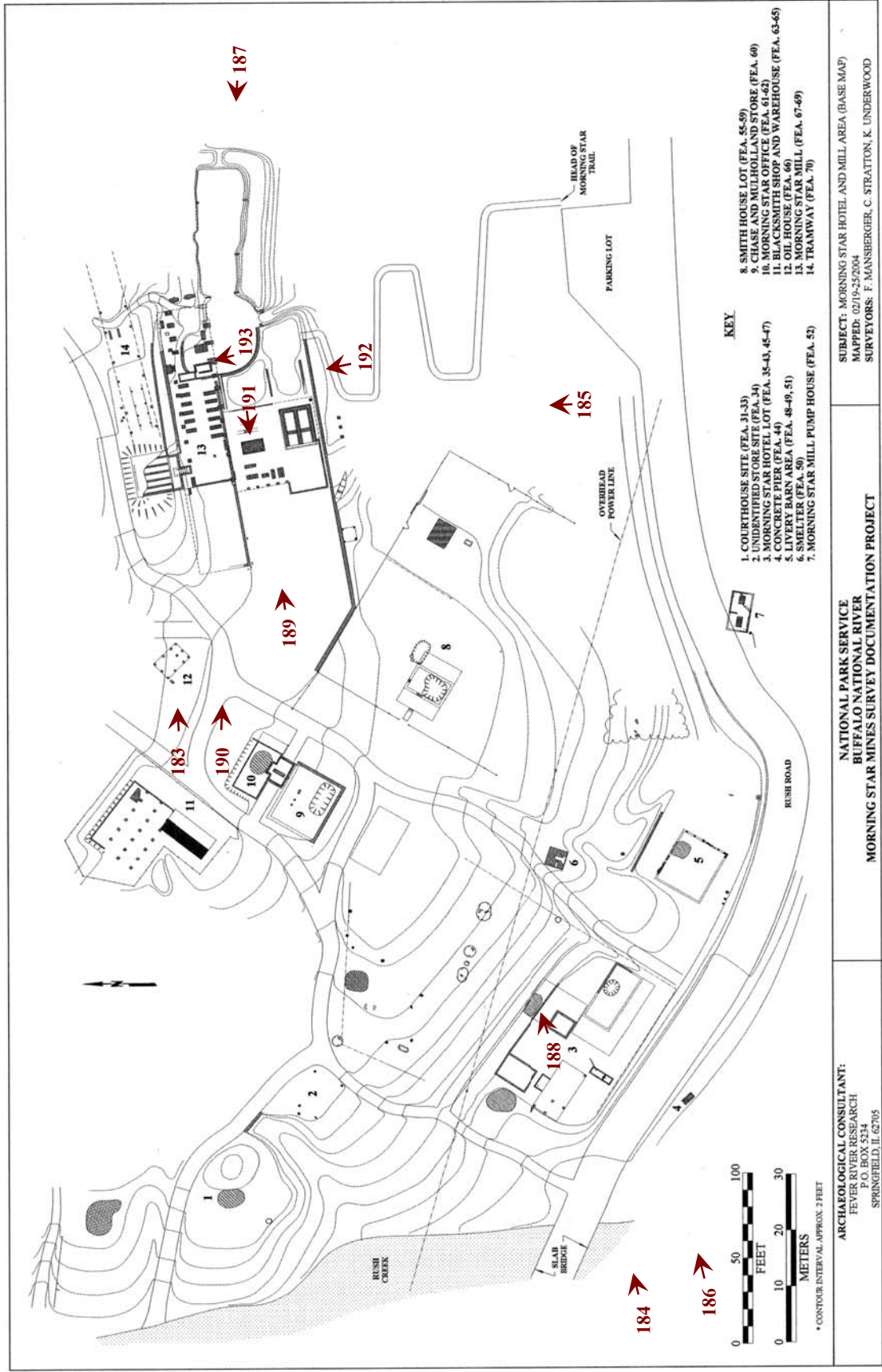
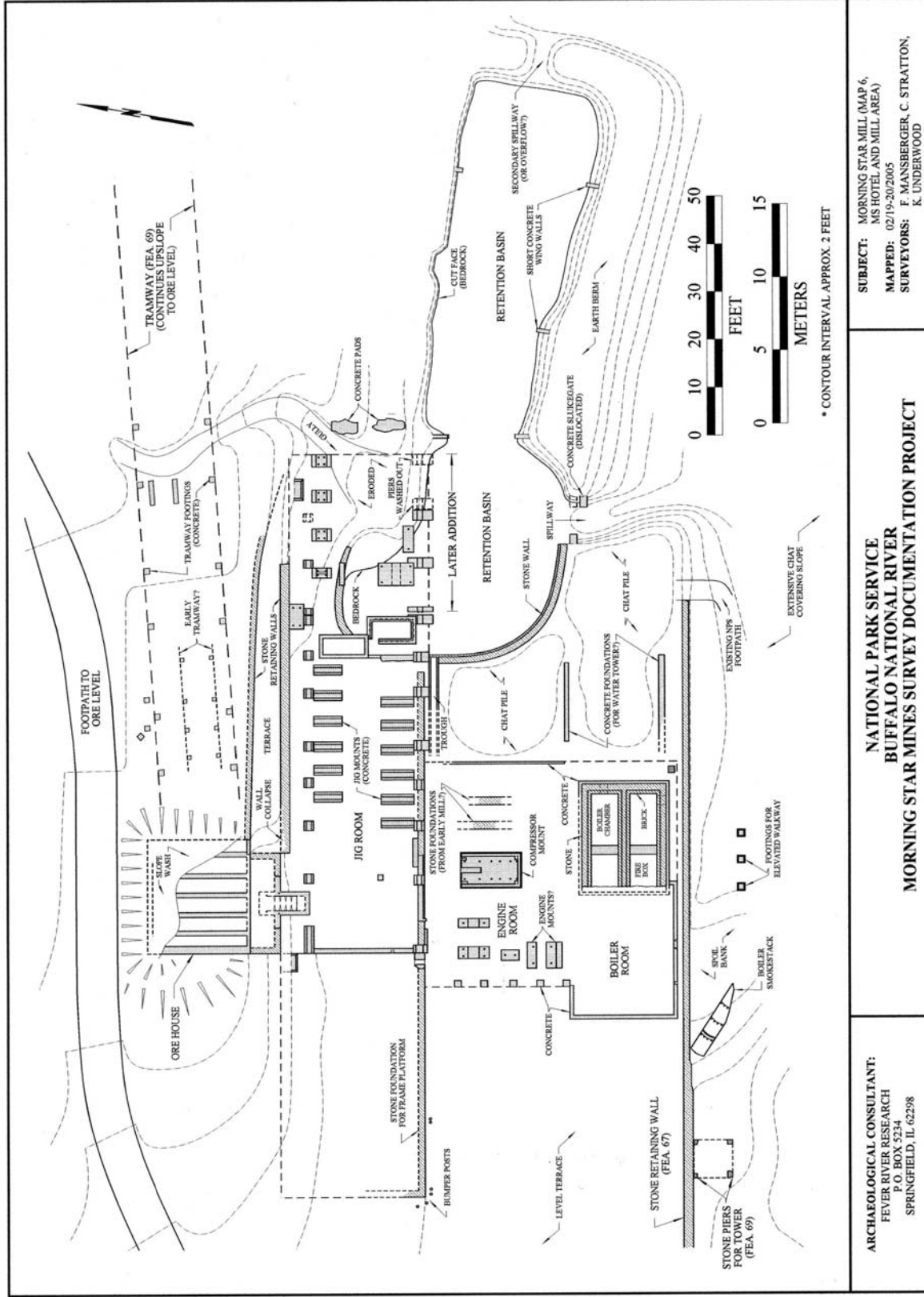

Figure 195. Map illustrating the locations and perspectives of historic photographs showing the Morning Star Mill. The numbered arrows refer to figure numbers in the report (FRR 2004).



ARCHAEOLOGICAL CONSULTANT:
FEVER RIVER RESEARCH
P.O. BOX 5234
SPRINGFIELD, IL 62298

**NATIONAL PARK SERVICE
BUFFALO NATIONAL RIVER
MORNING STAR MINES SURVEY DOCUMENTATION PROJECT**

SUBJECT: MORNING STAR MILL (MAP 6,
MS HOTEL AND MILL AREA)
MAPPED: 02/19-20/2005
SURVEYORS: F. MANSBERGER, C. STRATTON,
K. UNDERWOOD

Figure 196. Map 6 of Area "B" of the Morning Star Site, showing the remains of the Morning Star Mill (FRR 2004).

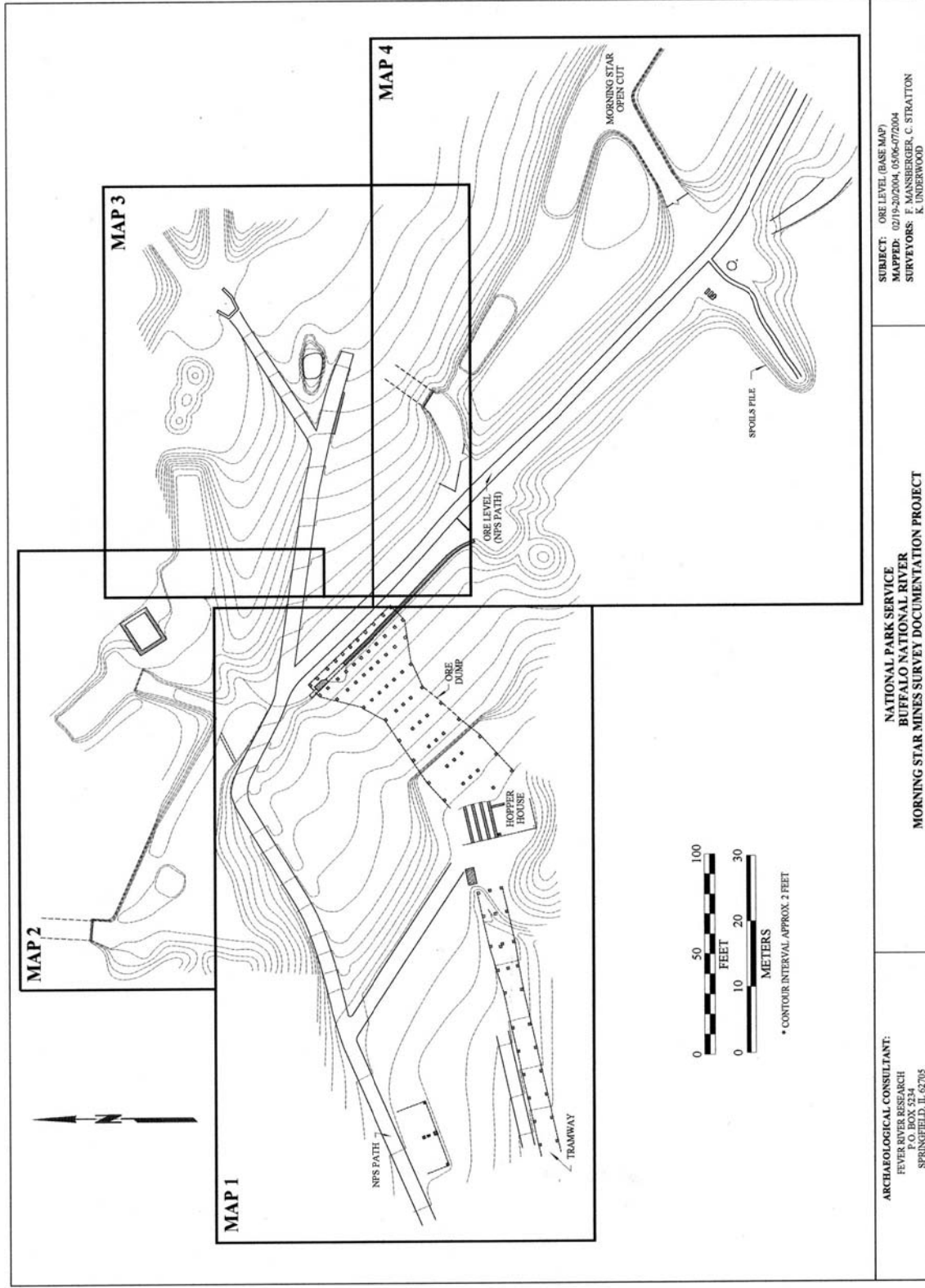

Figure 206. Map illustrating the sections of the Morning Star Mine and ore level mapped in detail during the survey (FRR 2004).

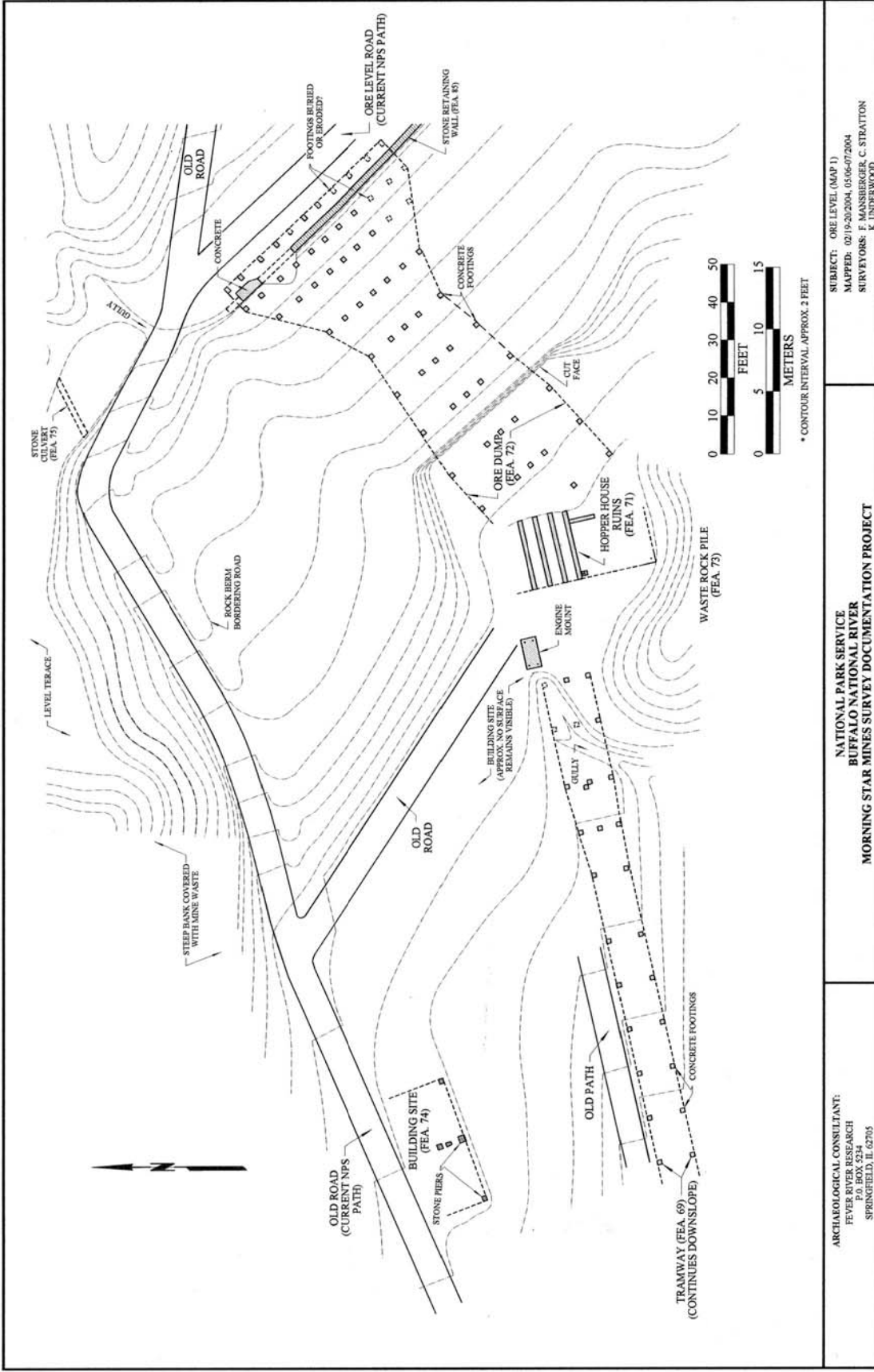
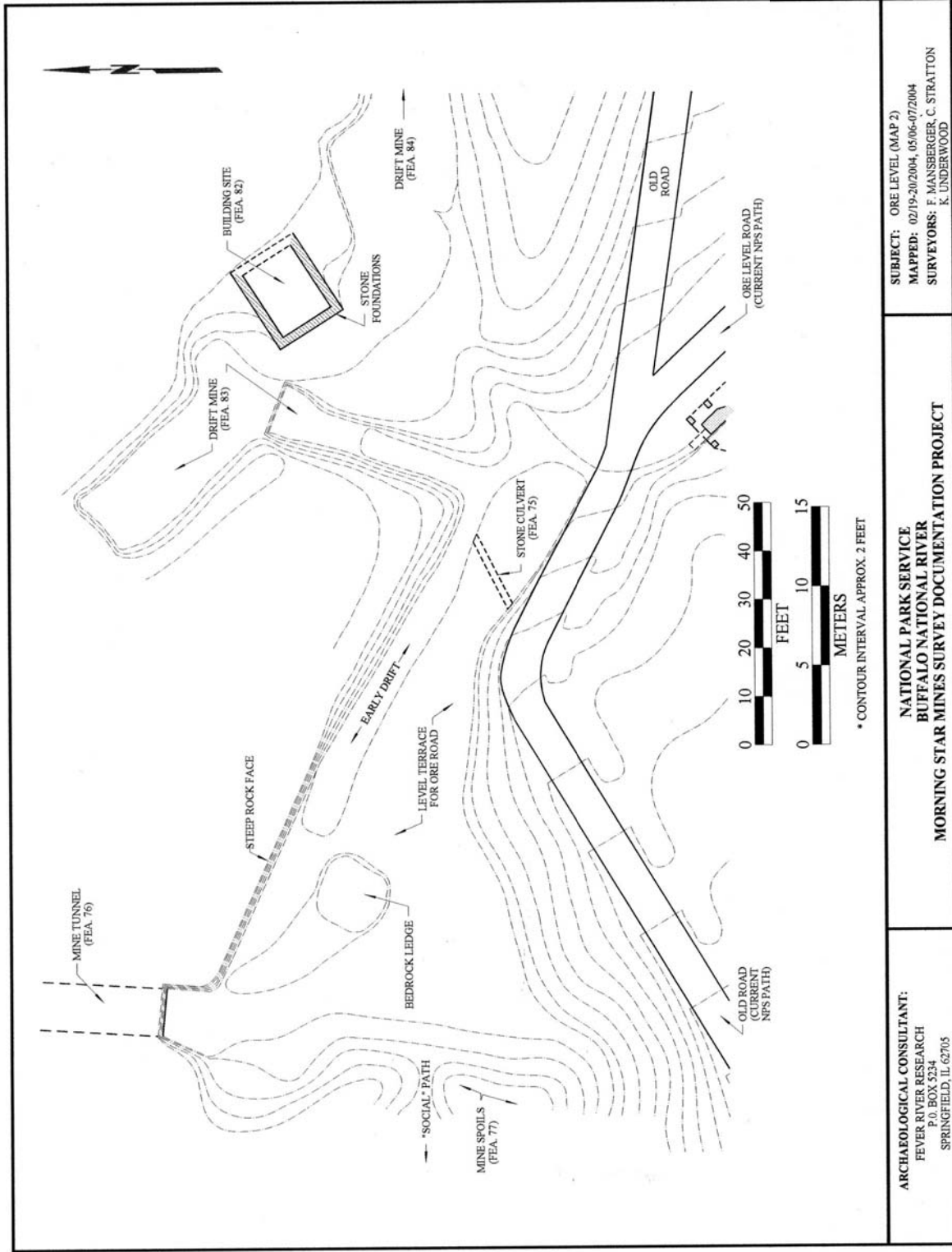

Figure 211. Map 1 of the ore level, showing the area around the hopper house and ore dump (FRR 2004).



<p>ARCHAEOLOGICAL CONSULTANT: FEVER RIVER RESEARCH P.O. BOX 3234 SPRINGFIELD, IL 62705</p>	<p>NATIONAL PARK SERVICE BUFFALO NATIONAL RIVER MORNING STAR MINES SURVEY DOCUMENTATION PROJECT</p>	<p>SUBJECT: ORE LEVEL (MAP 2) MAPPED: 02/19-20/2004, 05/06-07/2004 SURVEYORS: F. MANSBERGER, C. STRATTON K. UNDERWOOD</p>
--	---	---

Figure 214. Ore level Map 2, showing the locations of Features 75 through 84 (FRR 2004).

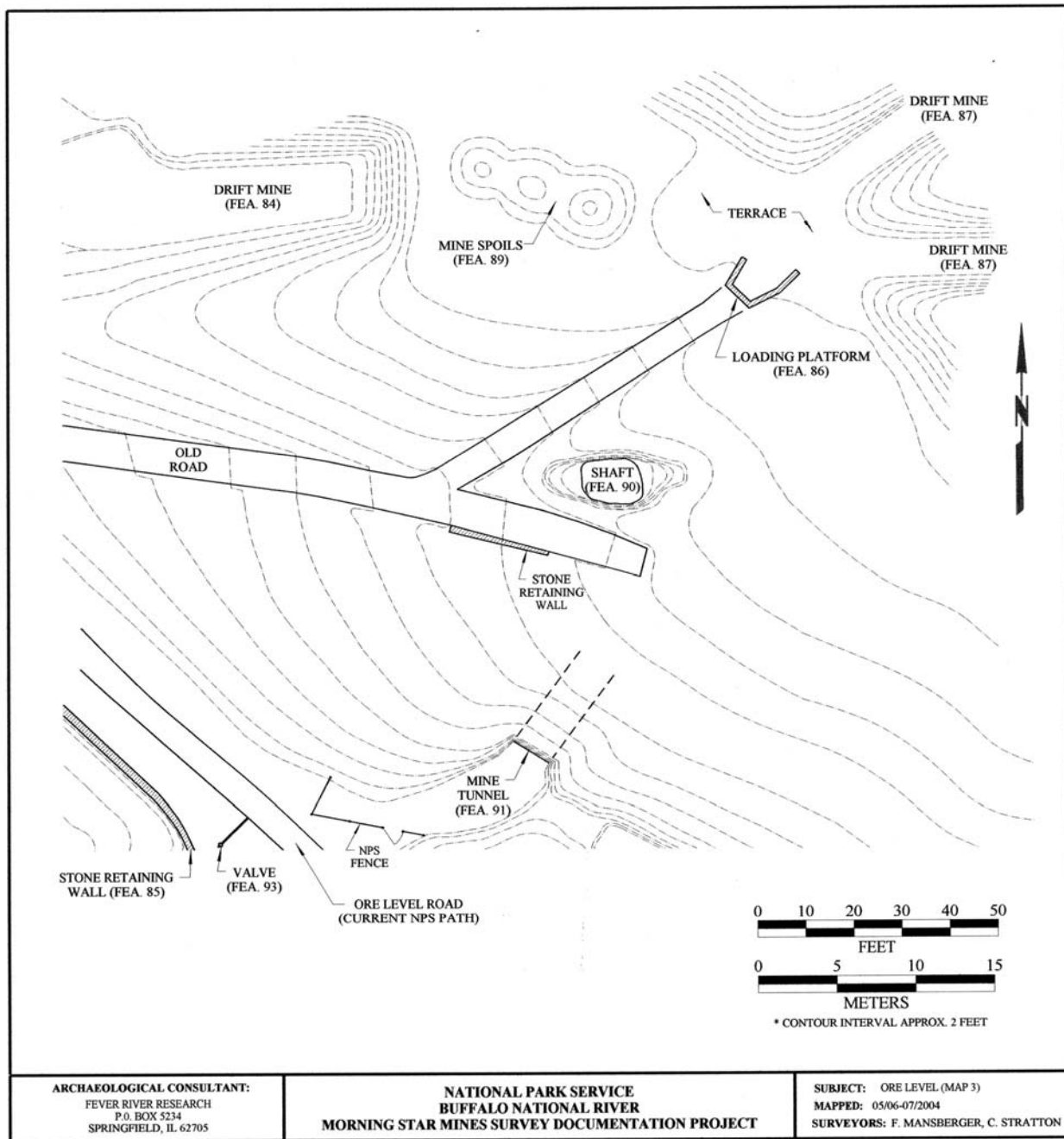

Figure 222. Ore level Map 3, showing the locations of Features 84 through 91 (FRR 2004).

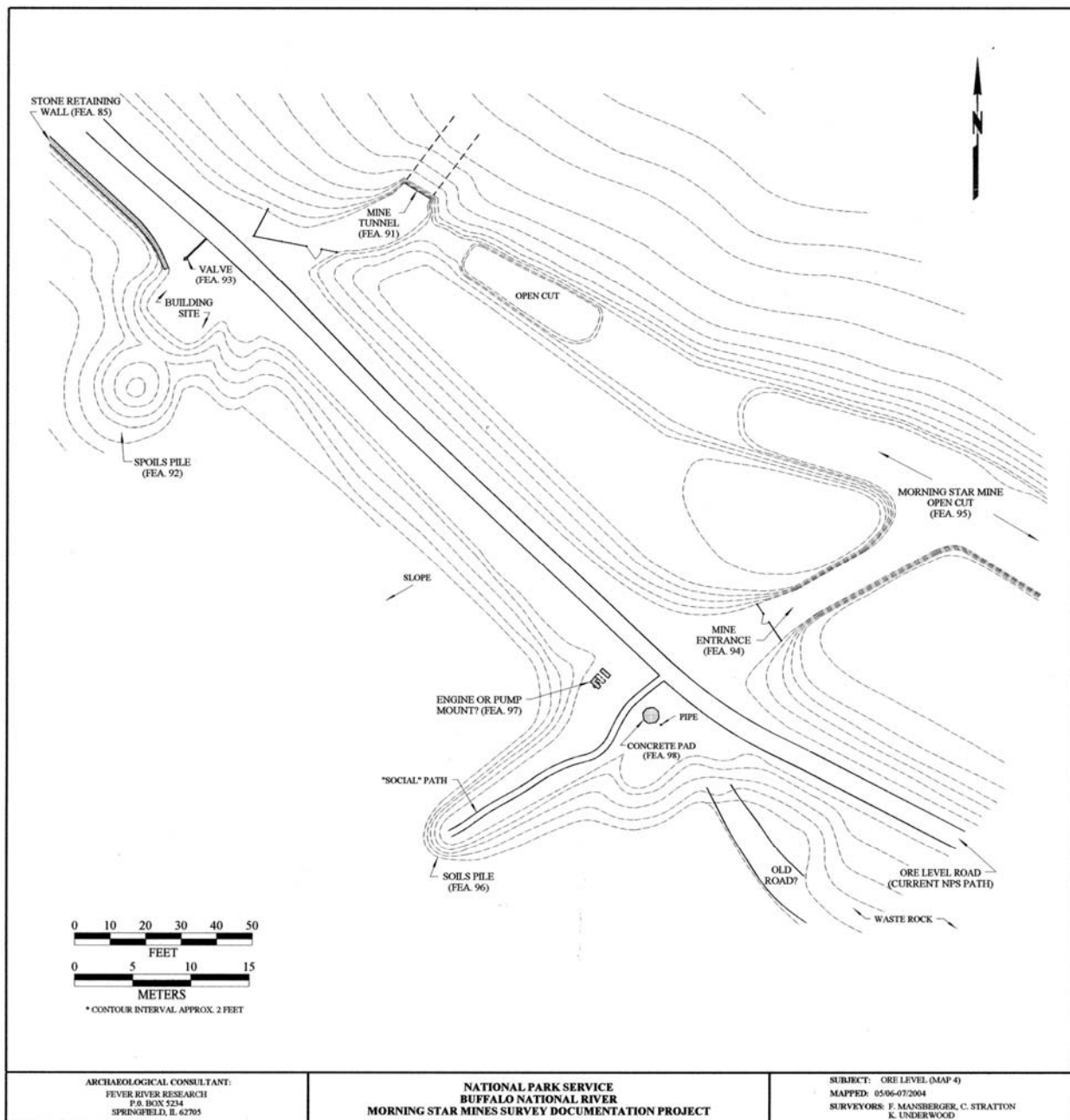

Figure 225. Ore level Map 4, showing the locations of Features 91 through 95 (FRR 2004).

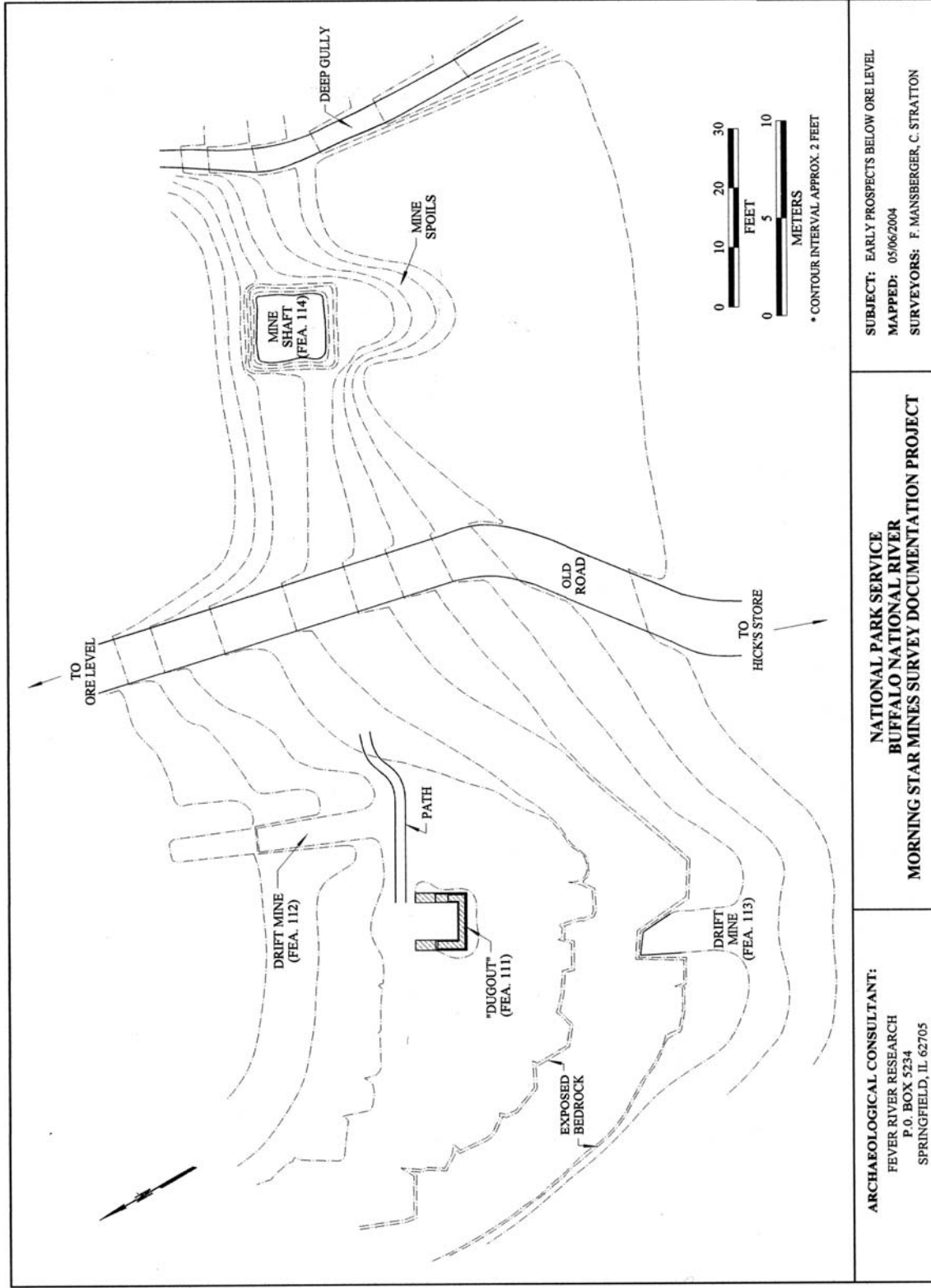

Figure 247. Map showing the early mining area located between the ore level and Hicks Site (FRR 2004).

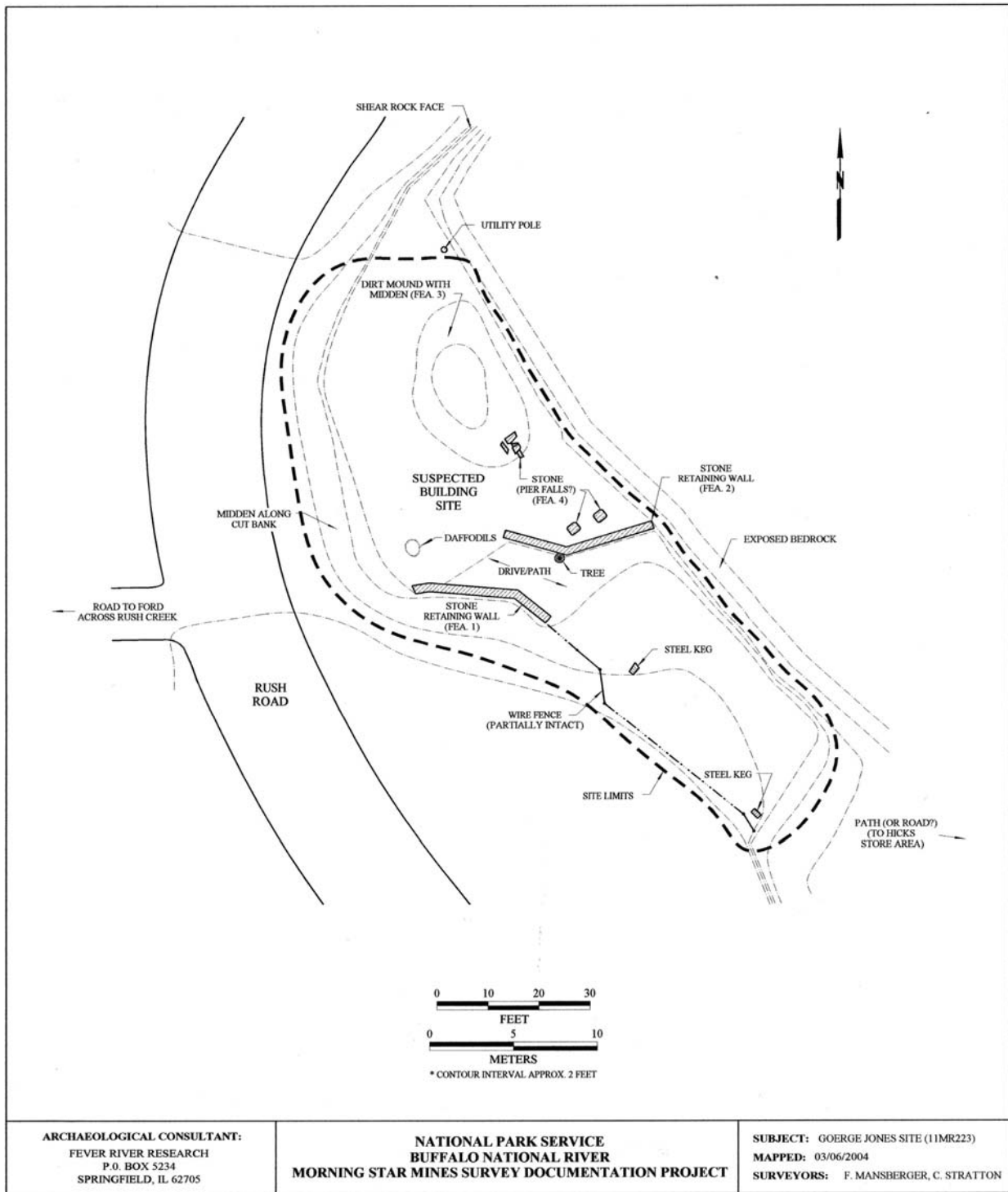

Figure 256. Site plan for the George Jones Site (3MR223) (FRR 2004).

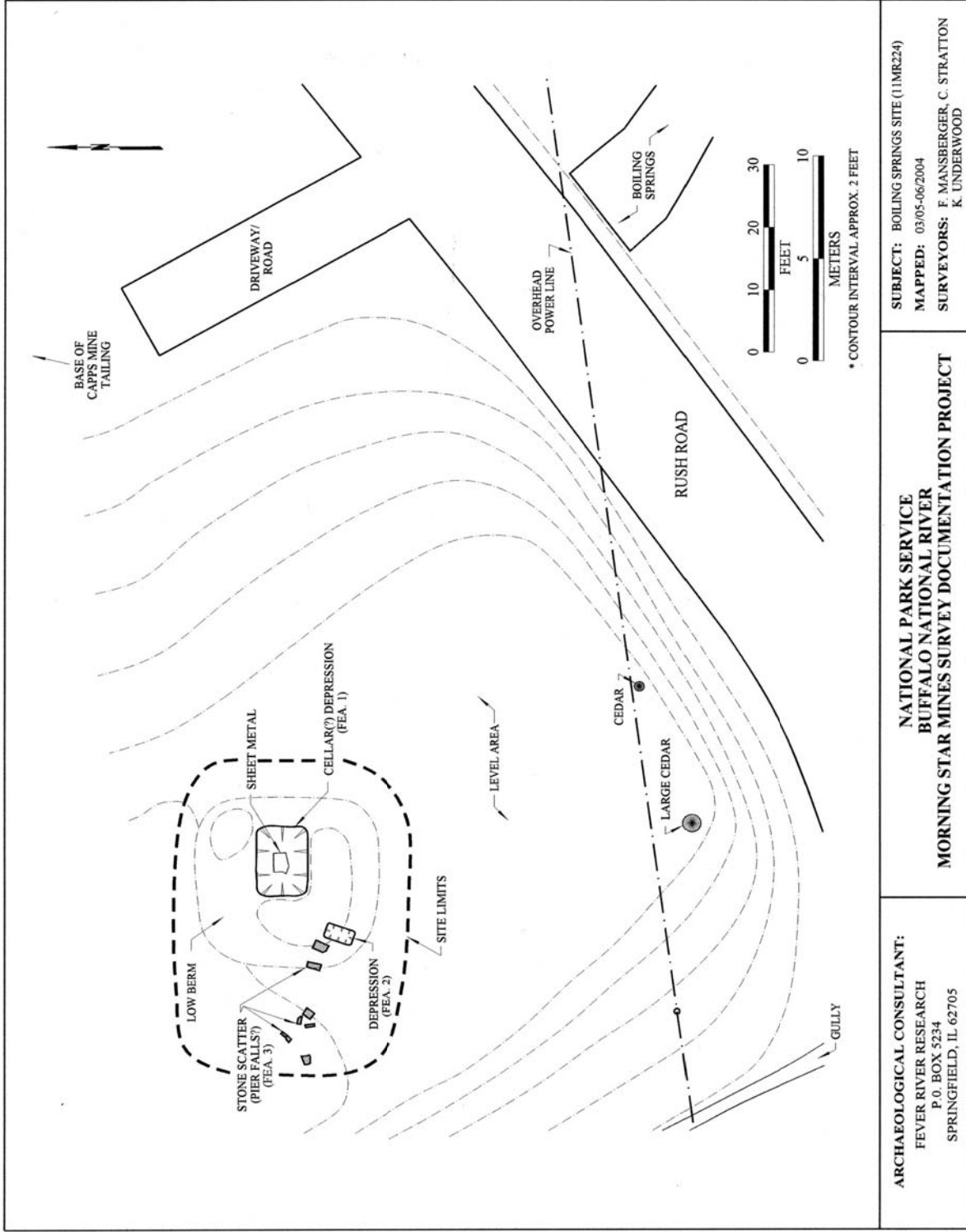

Figure 261. Site plan for the Boiling Springs Site (3MR224) (FRR 2004).

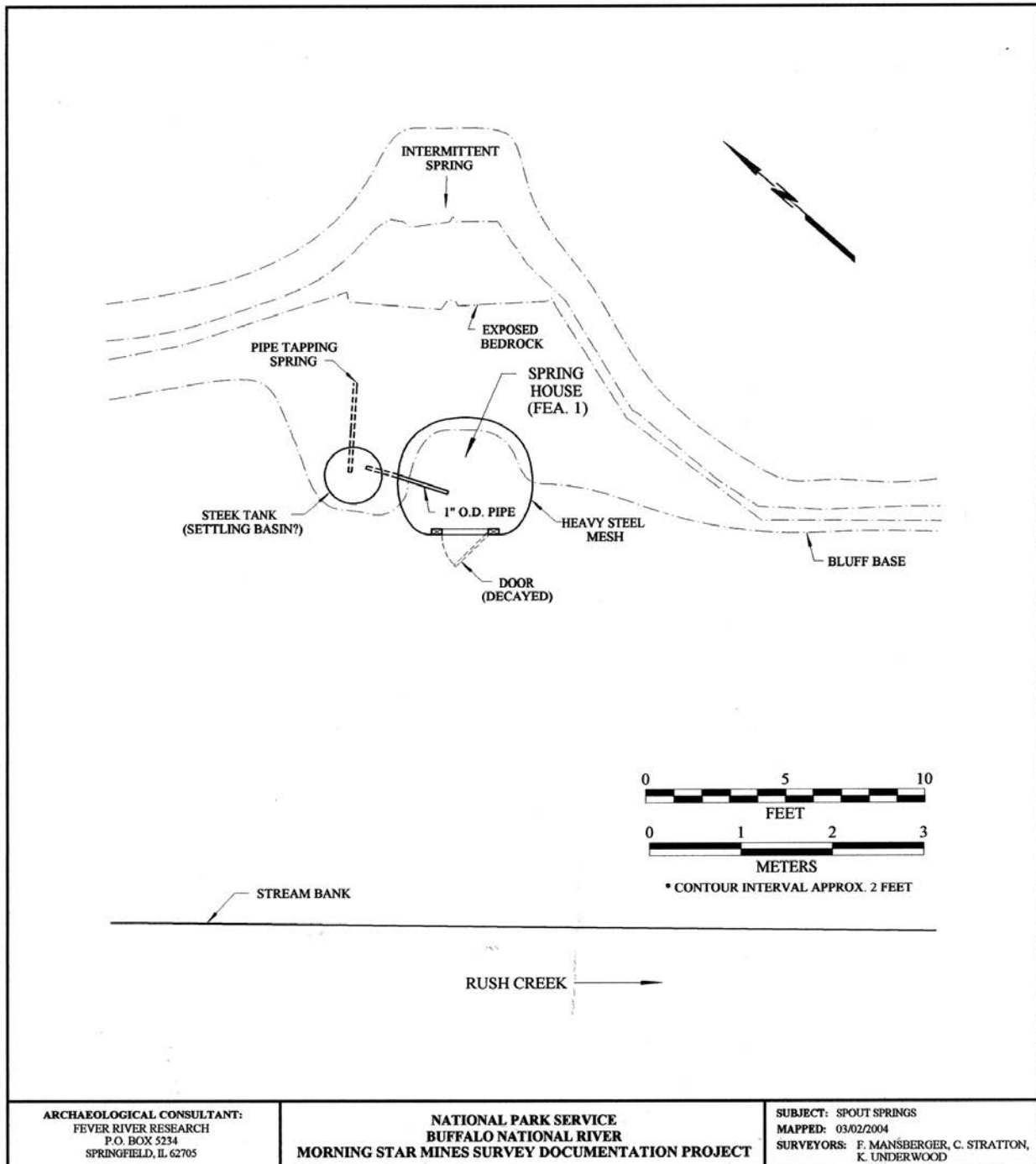

Figure 50. Plan of Spout Springs (Feature 1) (FRR 2004).

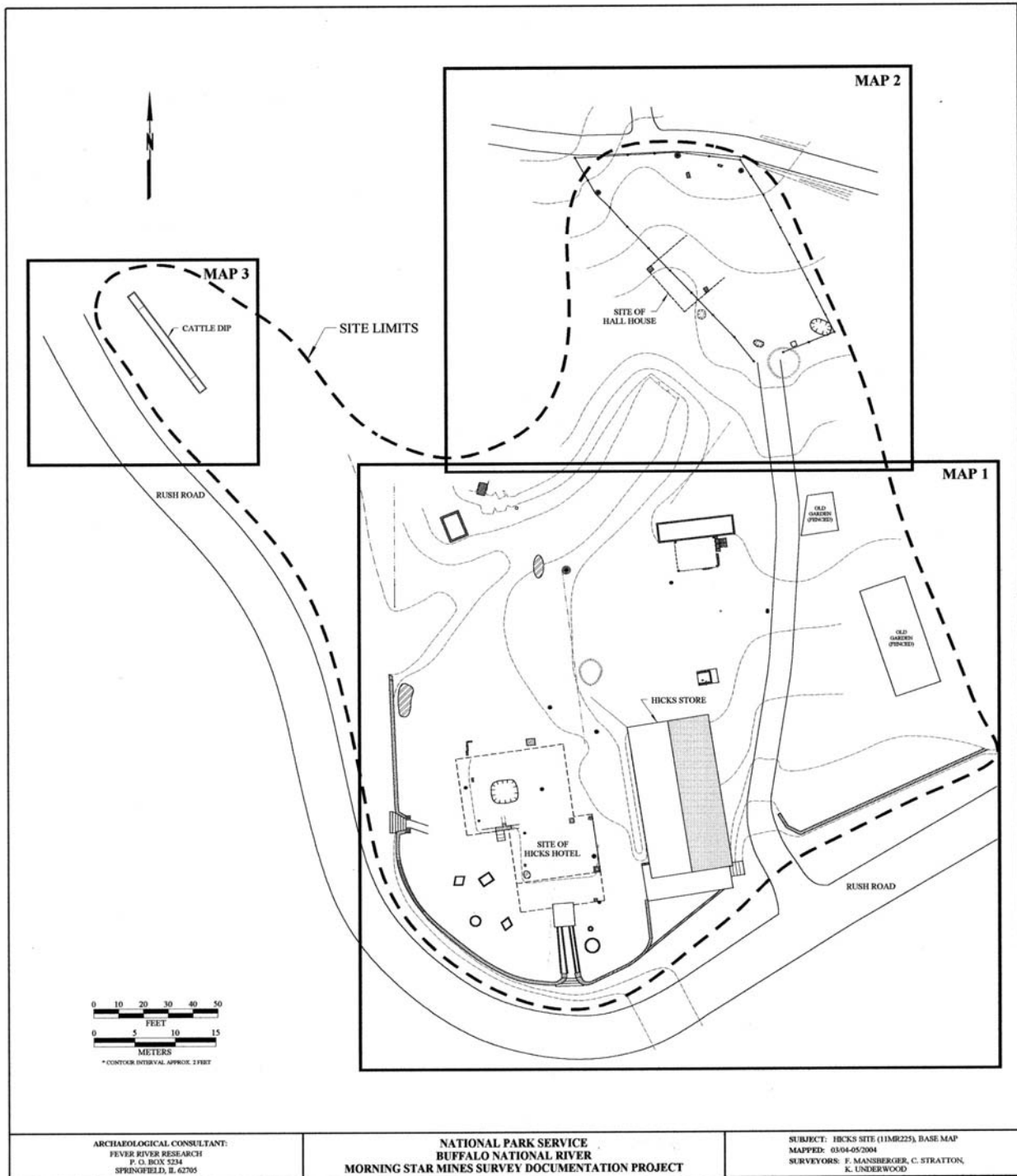

Figure 268. Plan of Hicks Site showing the three mapping areas (FRR 2004).

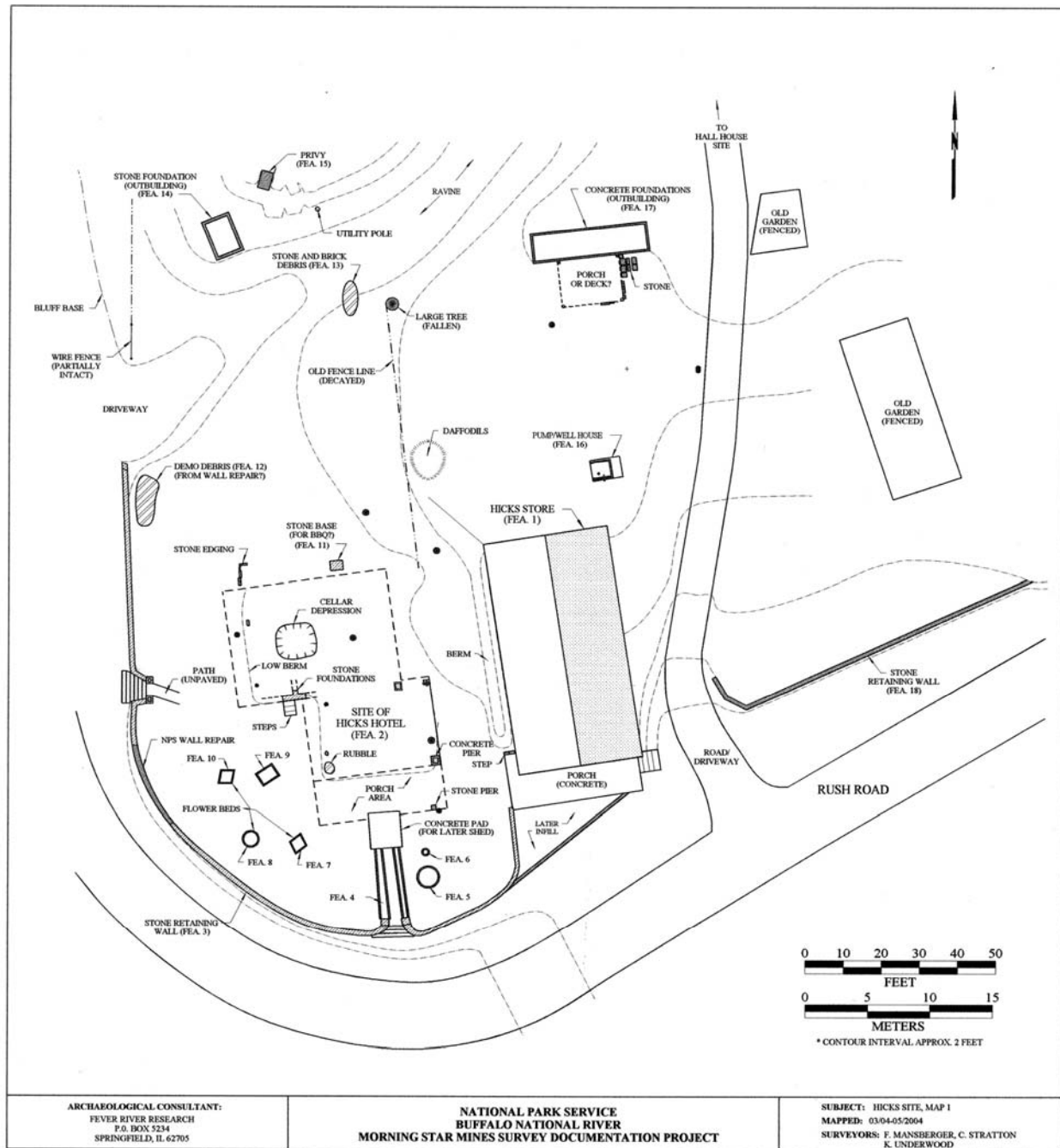

Figure 269. Map 1 for the Hicks Store Site, showing location of hotel and store, along with adjacent features (FRR 2004).

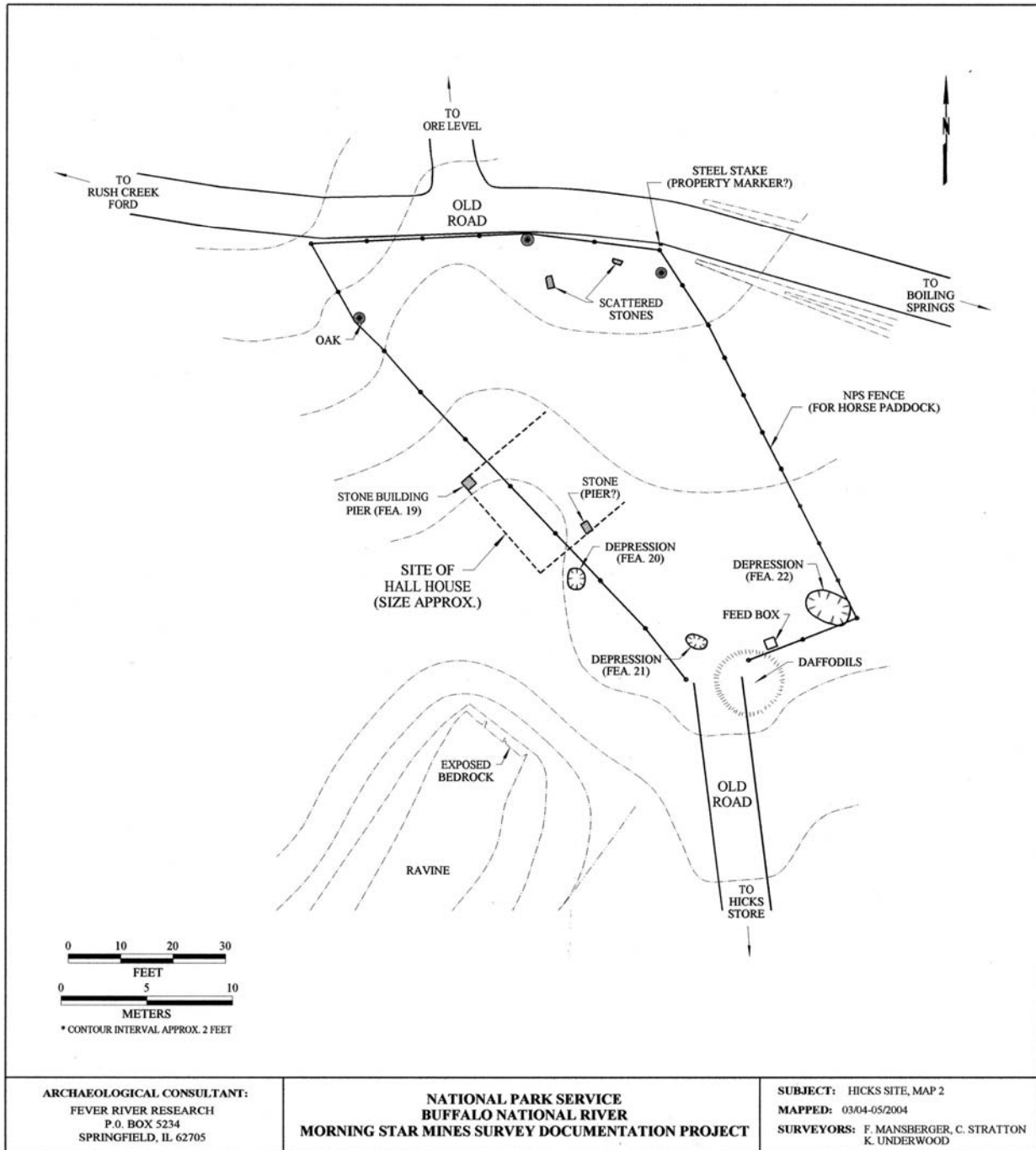

Figure 279. Hicks Site Map 2, showing the northern end of the site where the Hall House was located (FRR 2004).

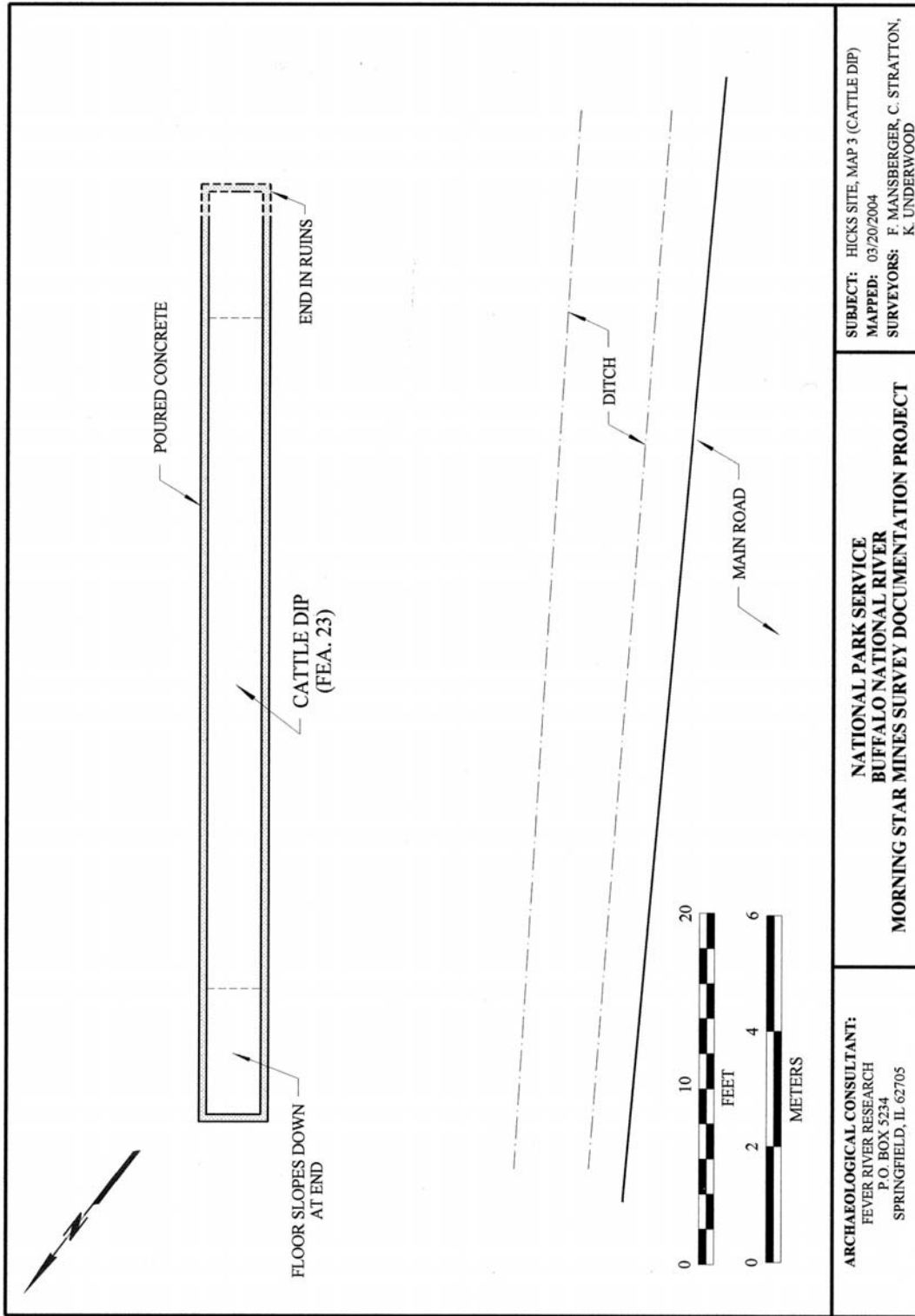

Figure 281. Hicks Site Map 3, showing Feature 138, a cattle dip located on the northwest corner of the site (FRR 2004).

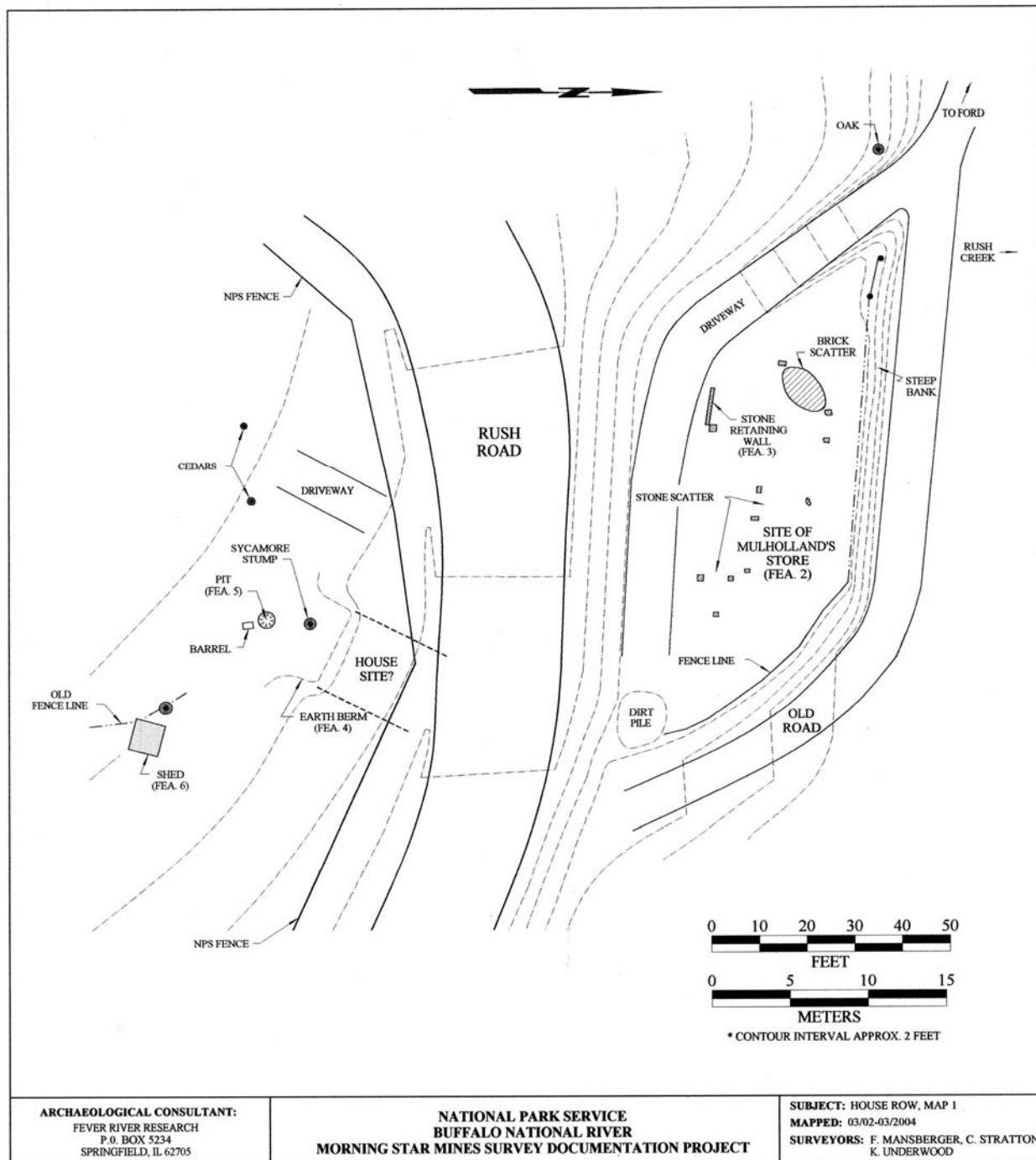

Figure 53. Map 1 of the House Row area, showing the sites of the Mulholland Store and unidentified dwelling (FRR 2004).

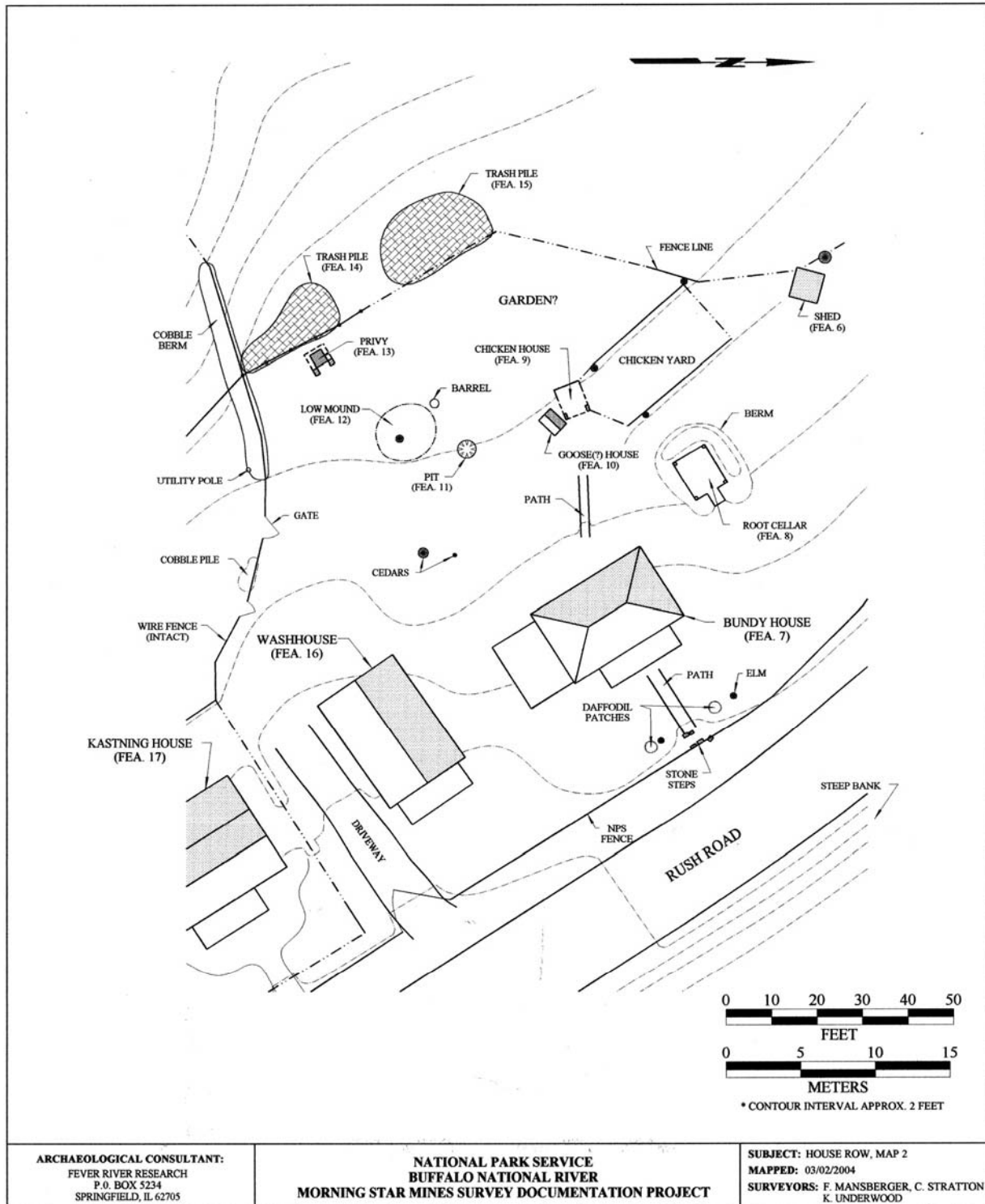

Figure 56. Map 2 of the House Row area, showing the Bundy House, Washhouse, and associated features (FRR 2004).

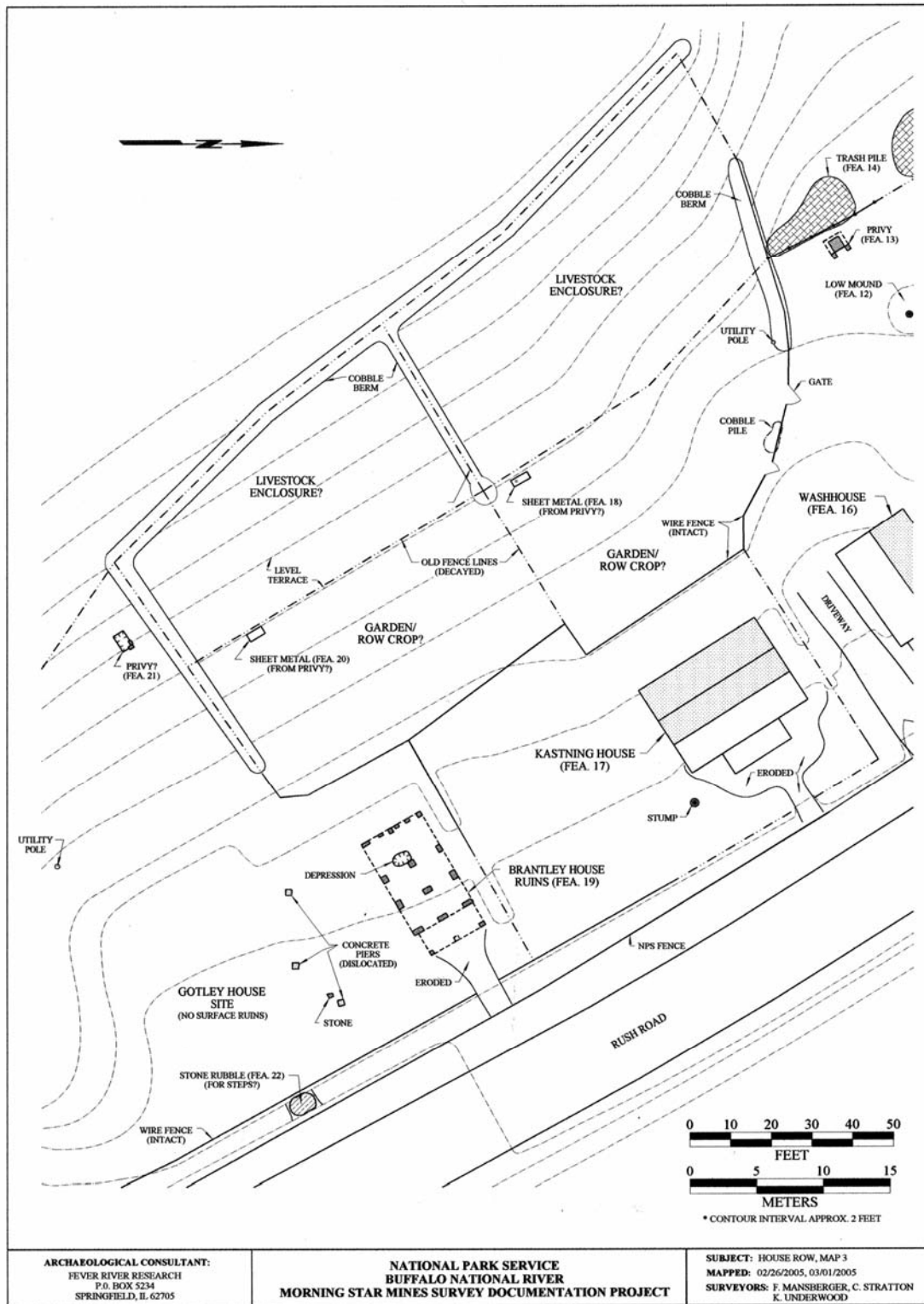

Figure 69. Map 3 of the House Row area, showing the Kastning and Brantley house lots (FRR 2004).

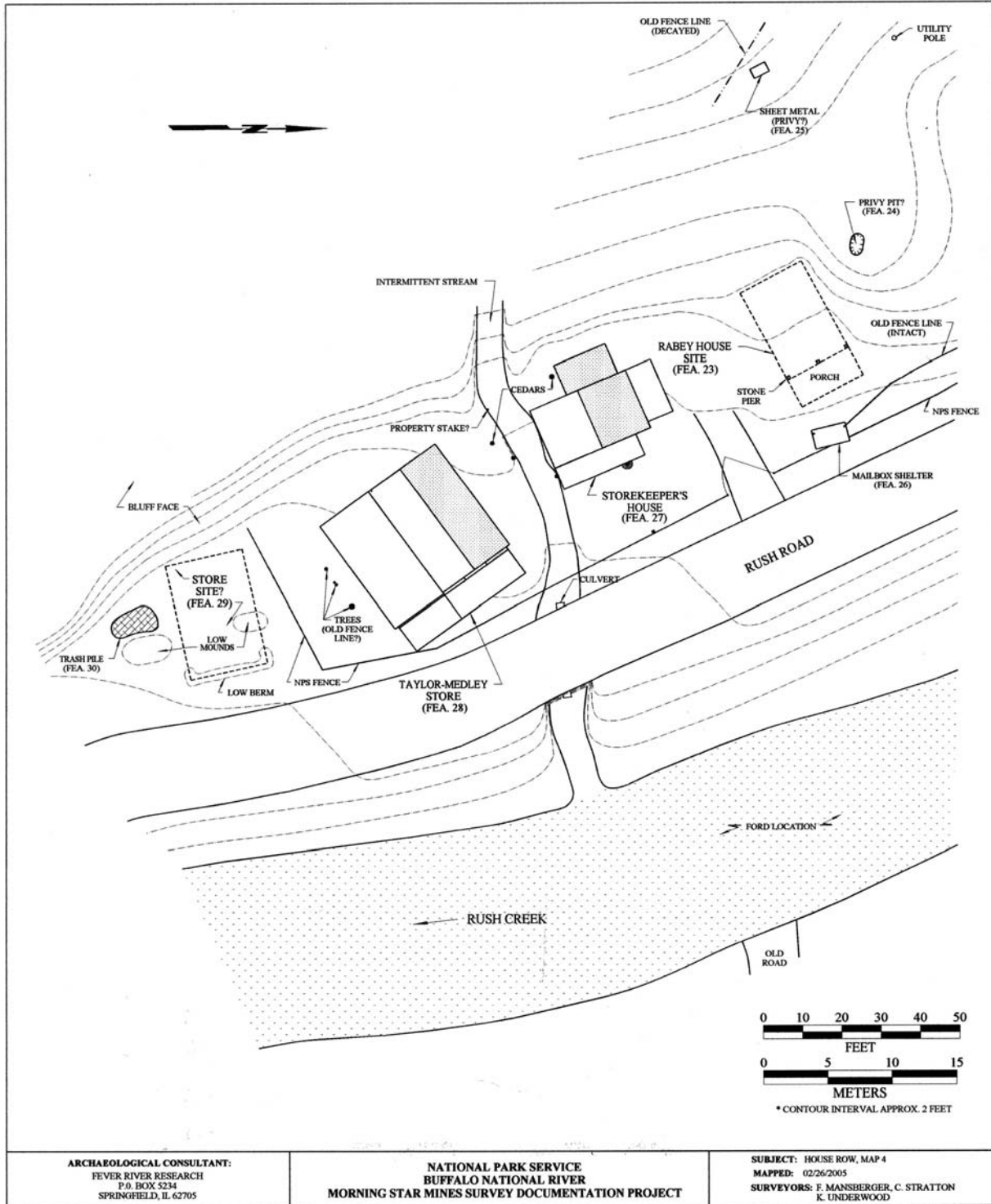

Figure 80. Map 4 of the House Row area, showing the Taylor-Medley Store, Storekeeper's House, and Rabey House site (FRR 2004).

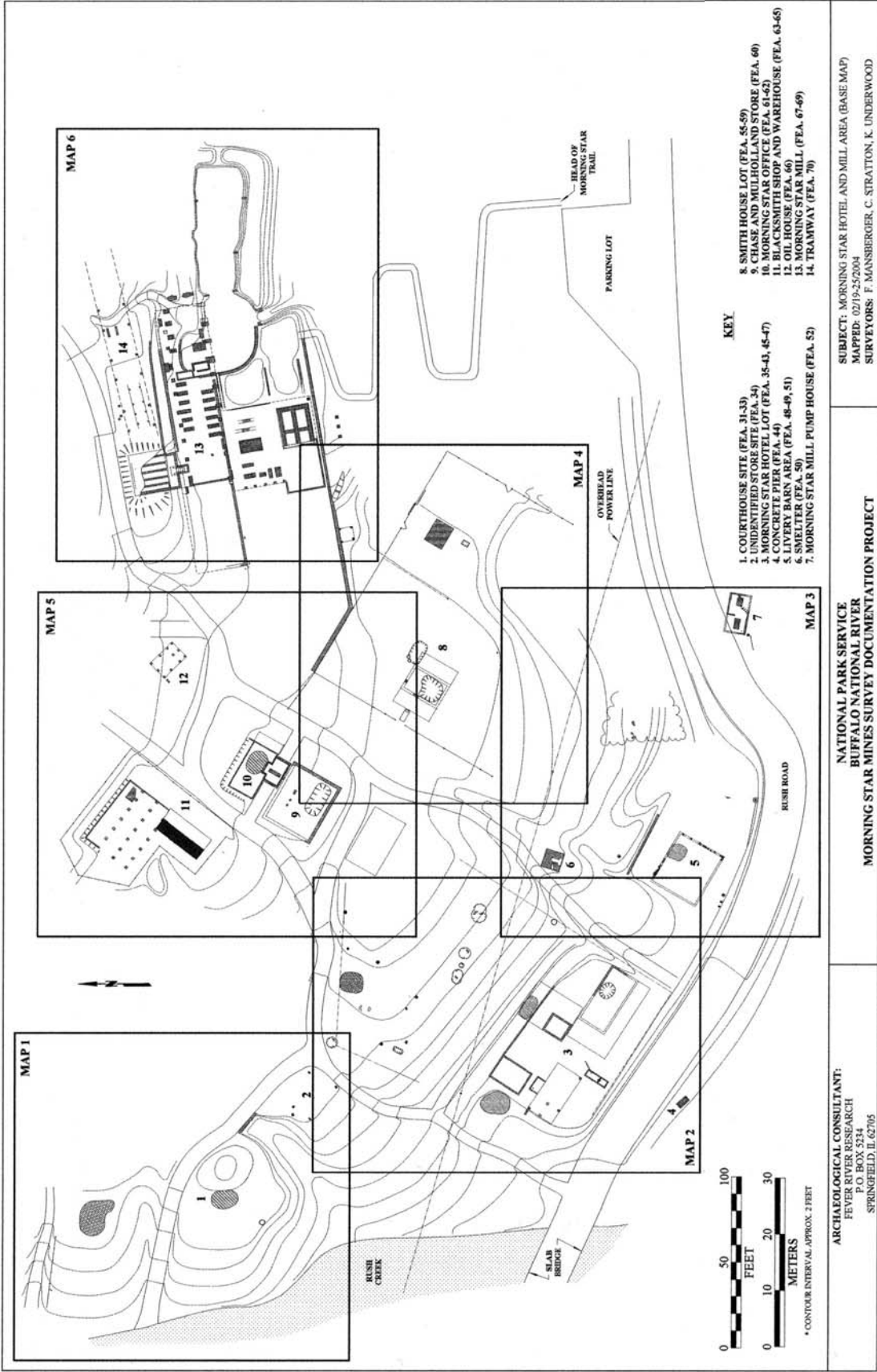

Figure 112. Site plan of Area "B" of the Morning Star Site. Maps of the six sub-areas noted are attached below (FRR 2004).

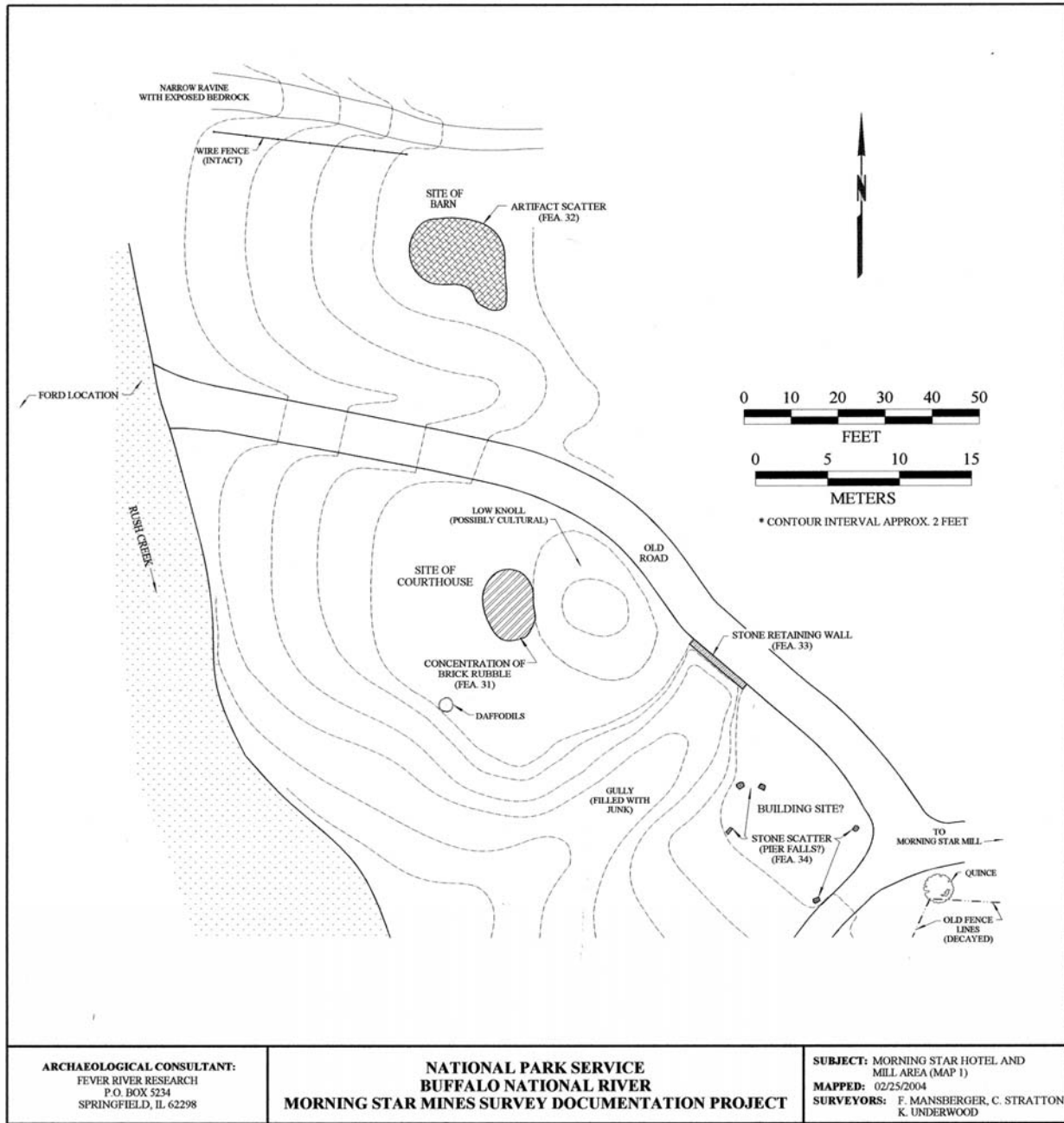

Figure 117. Map 1 of Area "B" of the Morning Star Site, showing the locations of the courthouse and associated barn and an unidentified commercial building (FRR 2004).

Page left intentionally blank.