

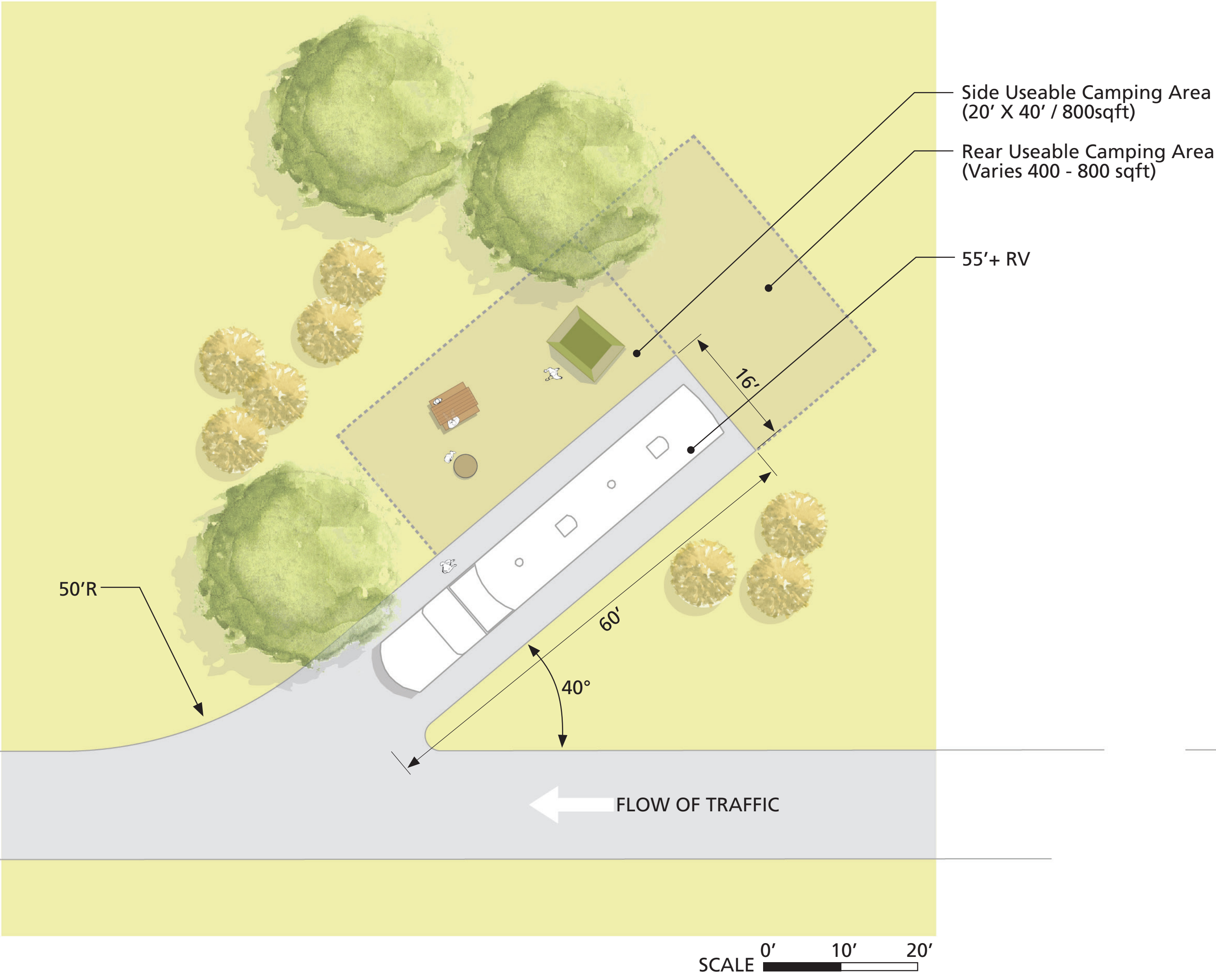

EXAMPLE CAMPSITE ILLUSTRATIONS

LARGE RV CAMPSITE



- NOTES:
- All dimensions shown are typical
 - The type of useable camping area at the site will change from site to site due to differing site conditions
 - Campsites may be located on either side of a one-way road
 - Campsites located on the left hand side of the road within a loop will more likely have a rear useable camping area due to space constraints
 - Present in RV Areas and Mixed-Use Areas

MEDIUM-SMALL TRADITIONAL/TENT CAMPSITE

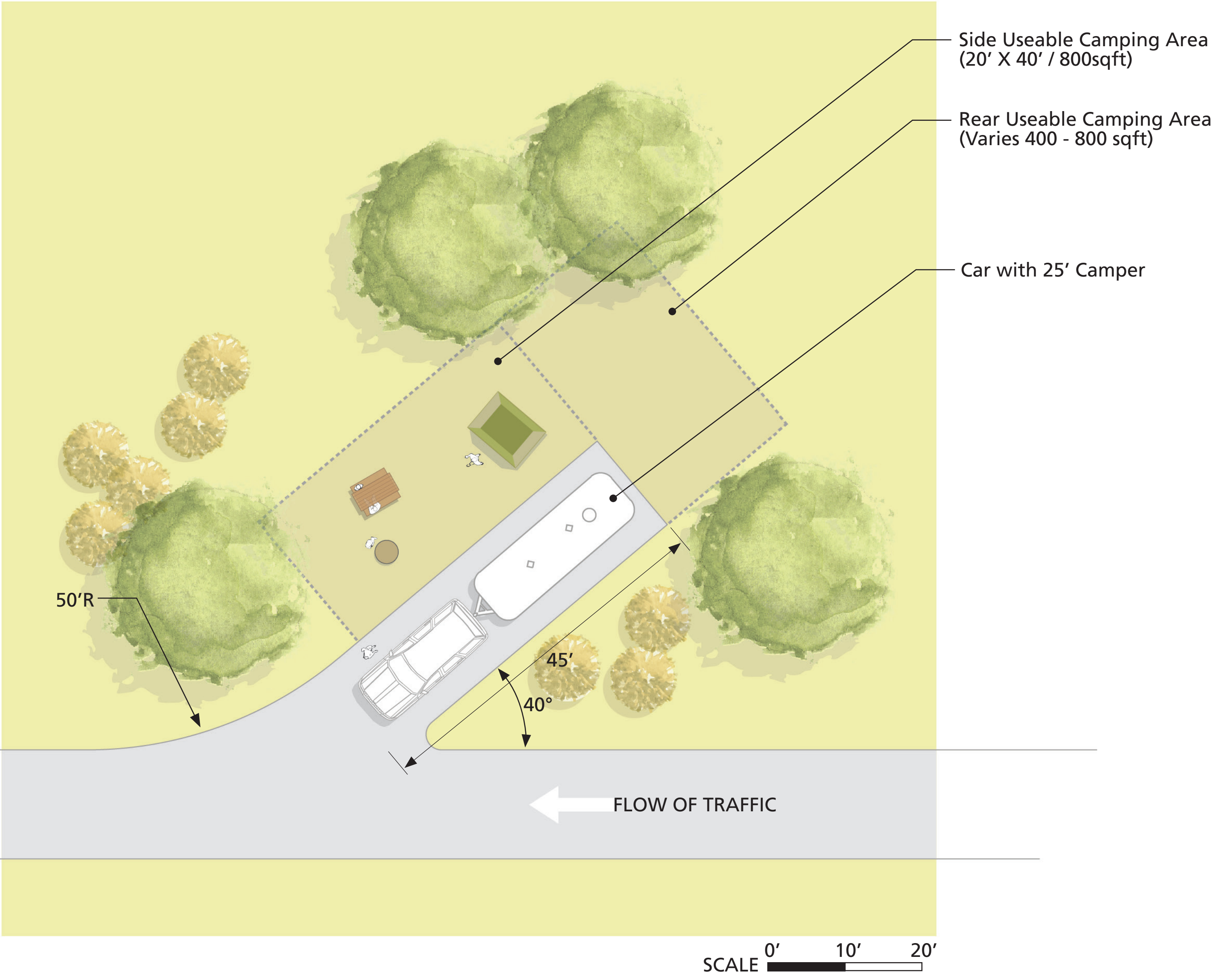

- NOTES:
- All dimensions shown are typical
 - The type of useable camping area at the site will change from site to site due to differing site conditions
 - Campsites may be located on either side of a one-way road
 - Campsites located on the left hand side of the road within a loop will more likely have a rear useable camping area due to space constraints
 - Present in Traditional/Tent Areas and Mixed-Use Areas

LARGE RV DOUBLE CAMPSITE (LEFT)

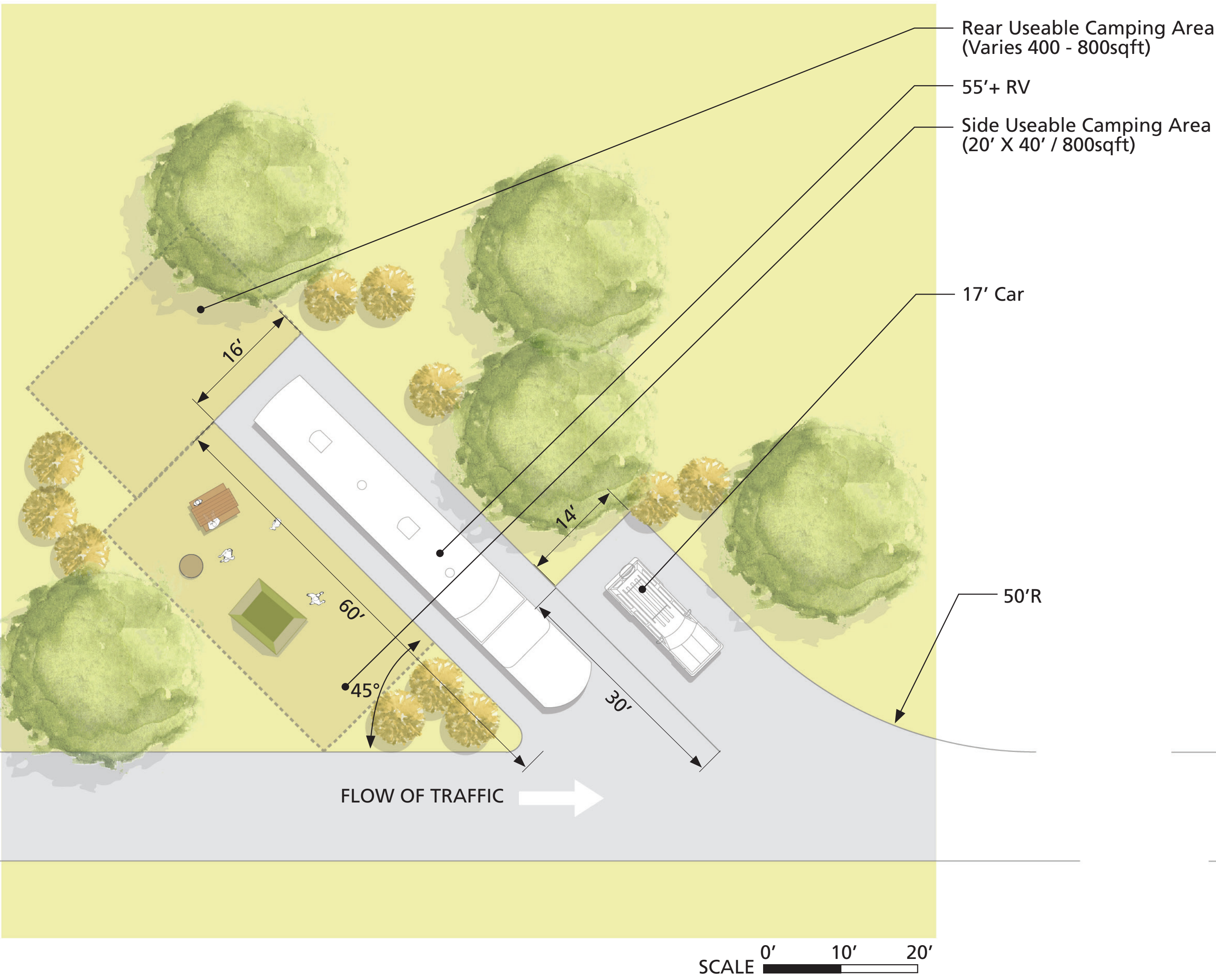

- NOTES:
- All dimensions shown are typical
 - The type of useable camping area at the site will change from site to site due to differing site conditions
 - Campsites may be located on either side of a one-way road
 - Campsites located on the left hand side of the road within a loop will more likely have a rear useable camping area due to space constraints
 - Double campsites will always have the 60' stall passenger's side located on the exterior of the two stalls for ease of access to the useable camping area
 - Present in RV Areas and Mixed-Use Areas

LARGE RV DOUBLE CAMPSITE (RIGHT)

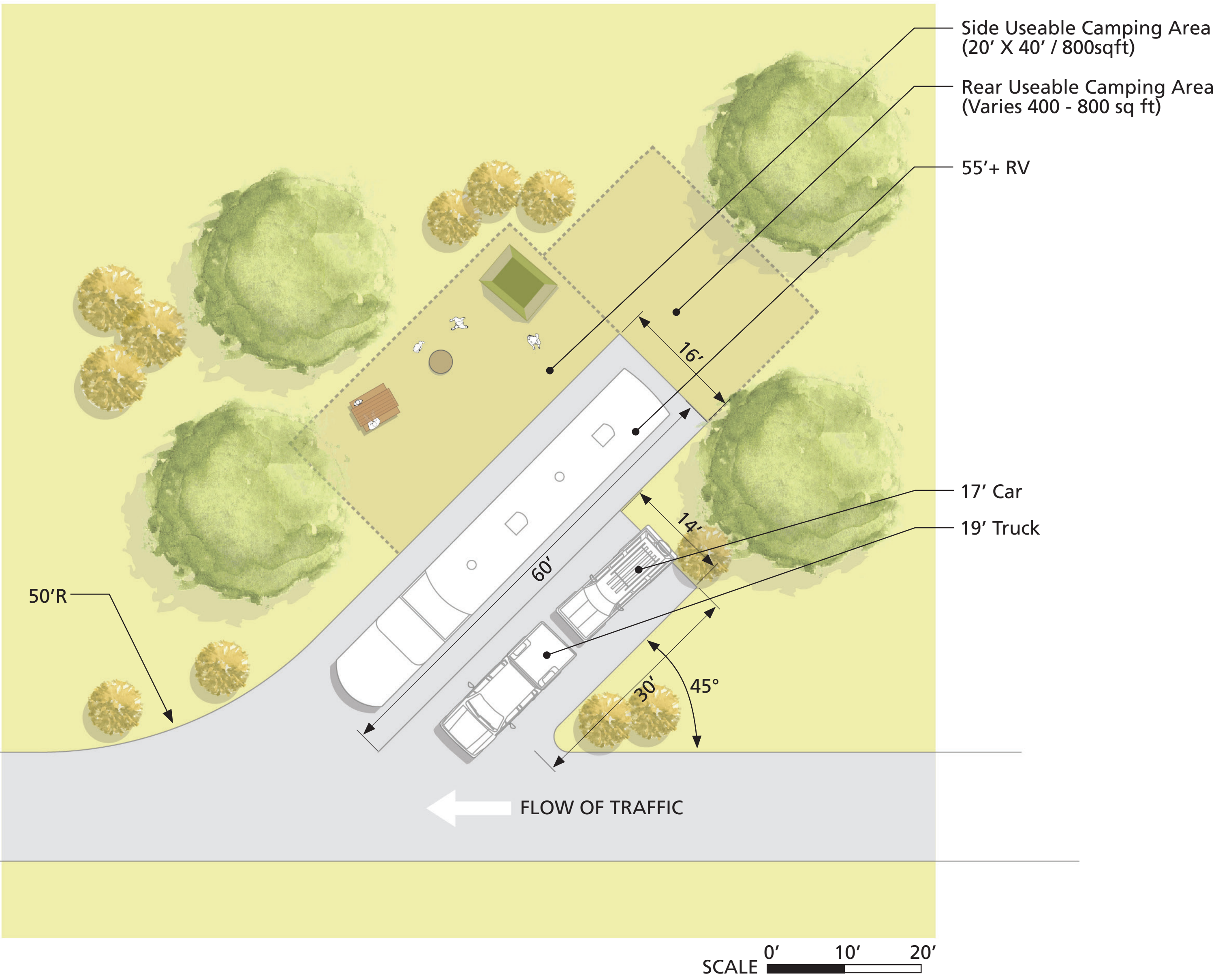

- NOTES:
- All dimensions shown are typical
 - The type of useable camping area at the site will change from site to site due to differing site conditions
 - Campsites may be located on either side of a one-way road
 - Campsites located on the left hand side of the road within a loop will more likely have a rear useable camping area due to space constraints
 - Double campsites will always have the 60' stall passenger's side located on the exterior of the two stalls for ease of access to the useable camping area
 - Present in RV Areas and Mixed-Use Areas



EXAMPLE ACCESSIBLE REGULAR CAMPSITE



Side Useable Camping Area
(20' X 40' / 800sqft)
Accessible Picnic Table

Accessible Fire Ring

ACCESSIBLE REGULAR CAMPSITE

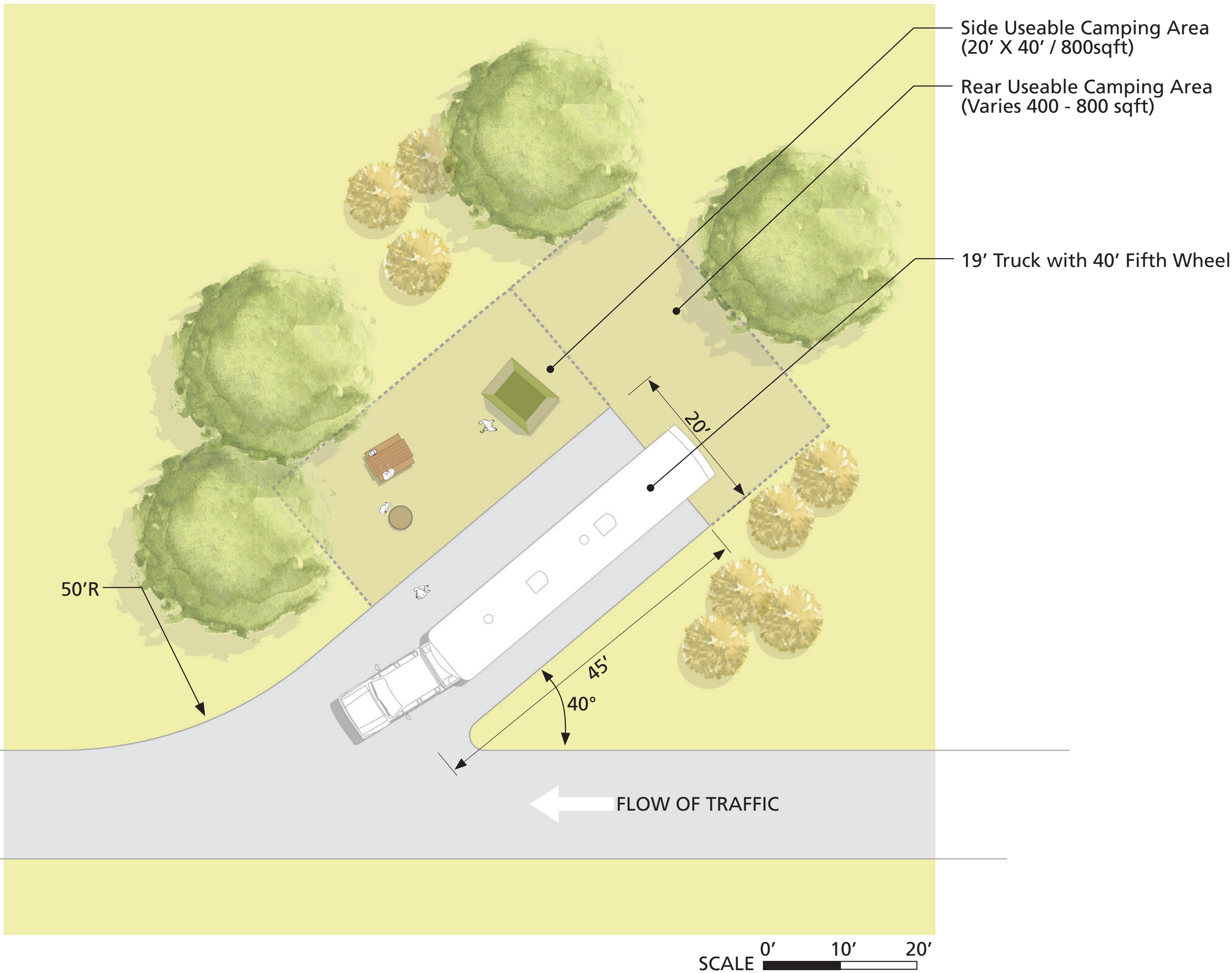

- NOTES:
- All dimensions shown are typical
 - The type of useable camping area present at the site will change from site to site due to differing site conditions
 - Campsites may be located on either side of a one-way road
 - Campsites located on the left hand side of the road within a loop will more likely have a rear useable camping area due to space constraints
 - Accessible campsites should be easily accessible to and from park facilities (restrooms, etc.)
 - Present in Traditional/Tent Areas and Mixed-Use Areas

ACCESSIBLE USEABLE CAMPING AREA

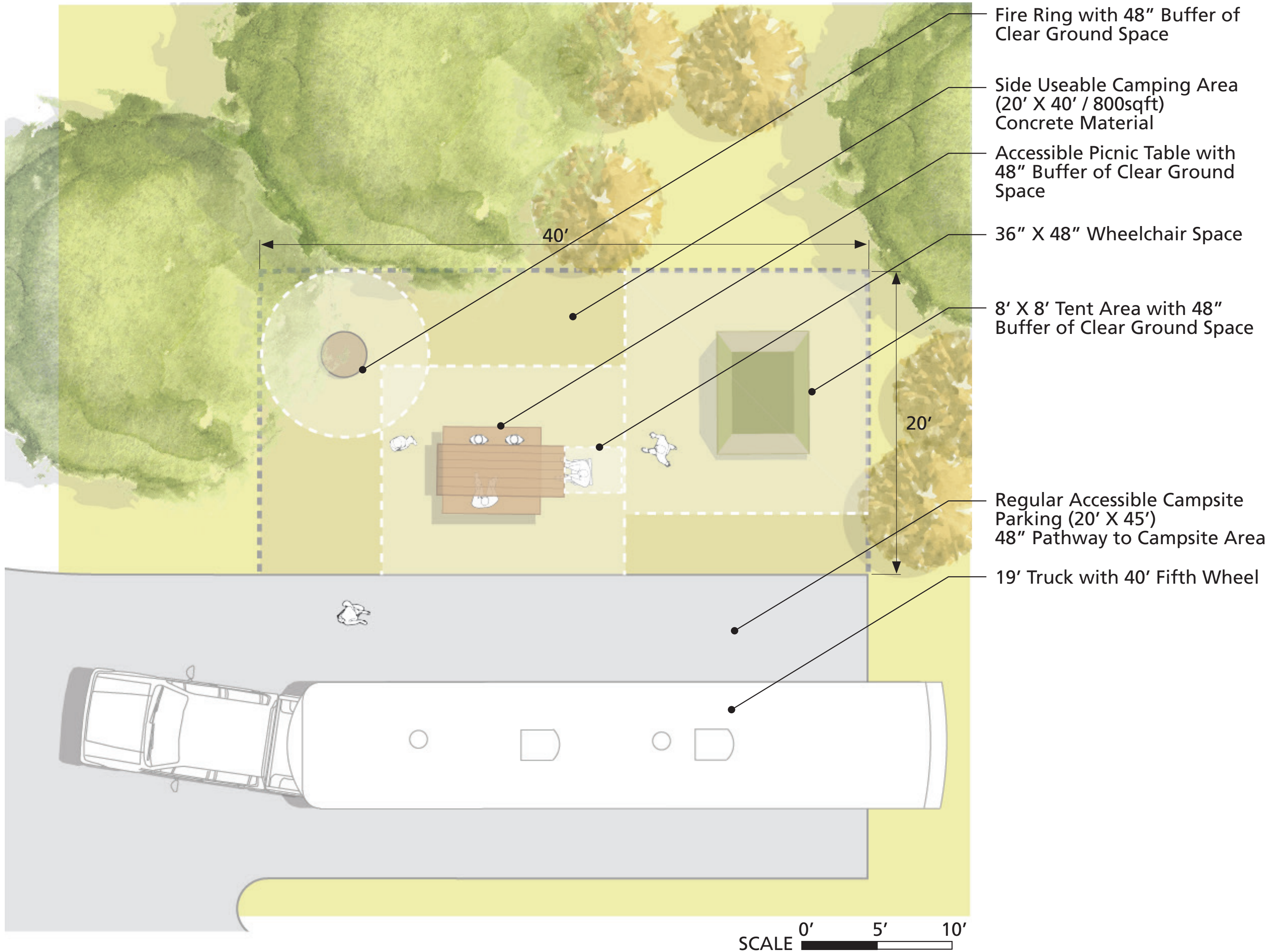

- NOTES:
- All dimensions shown are typical
 - The type of useable camping area (side or back) present at the site will change from site to site due to differing site conditions
 - Circulation buffers may overlap with one another
 - Accessible campsites should be easily accessible to and from park facilities (restrooms, etc.)
 - Present in Walk-In Campsites, RV Areas, Traditional/Tent Areas, and Mixed-Use Areas



EXAMPLE ACCESSIBLE PULL-THROUGH CAMPSITE



Accessible Useable Camping Area
(20' X 40' / 800sqft)
Accessible Fire Ring

PULL-THROUGH CAMPSITE

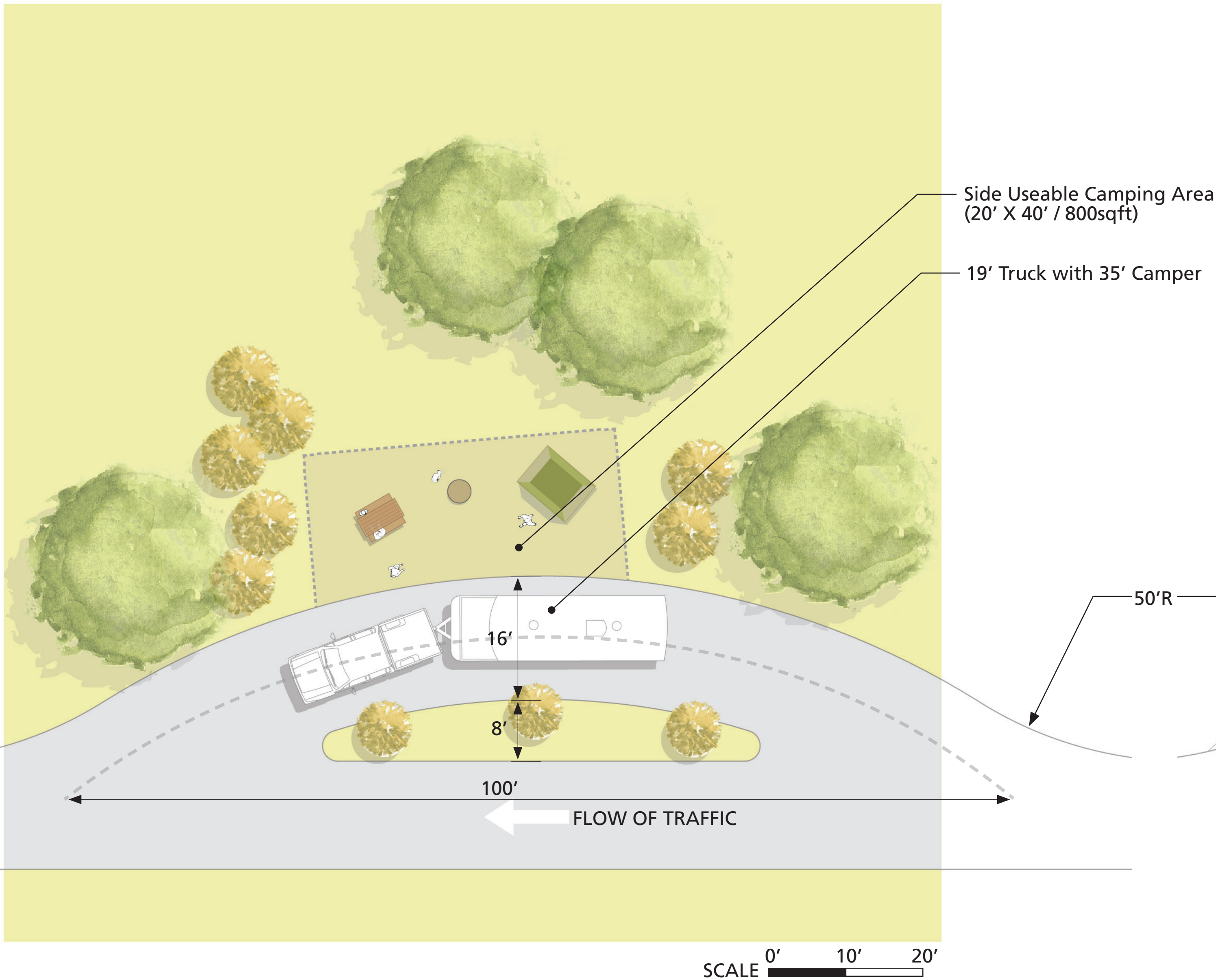

NOTES:

- All dimensions shown are typical
- Pull-through campsites will always have a side useable camping area present at the site
- Pull-through campsites should be located only on the right side of the road as trailer and RV doors open on the right side of the car
- Present in RV Areas, Mixed-Use Areas, and Traditional/Tent Areas

ACCESSIBLE PULL-THROUGH CAMPSITE

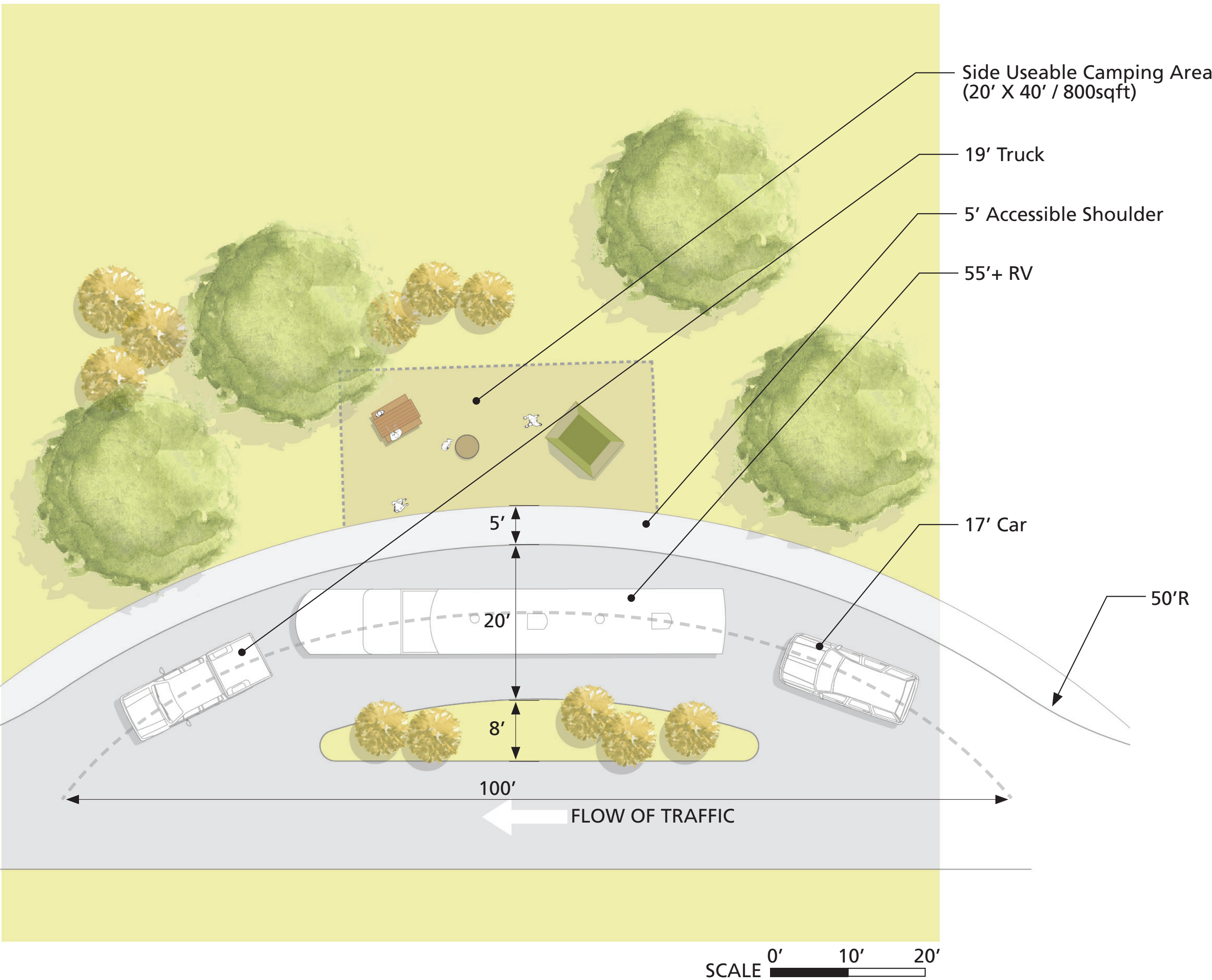

NOTES:

- All dimensions shown are typical
- Pull-through campsites will always have a side useable camping area present at the site
- Pull-through campsites should be located only on the right side of the road as trailer and RV doors open on the right side of the car
- Accessible campsites should be easily accessible to and from park facilities (restrooms, etc.)
- Present in RV Areas, Mixed-Use Areas, and Traditional/Tent Areas



EXAMPLE CAMPSITE AND AREA ILLUSTRATIONS

ACCESSIBLE DOUBLE CAMPSITE

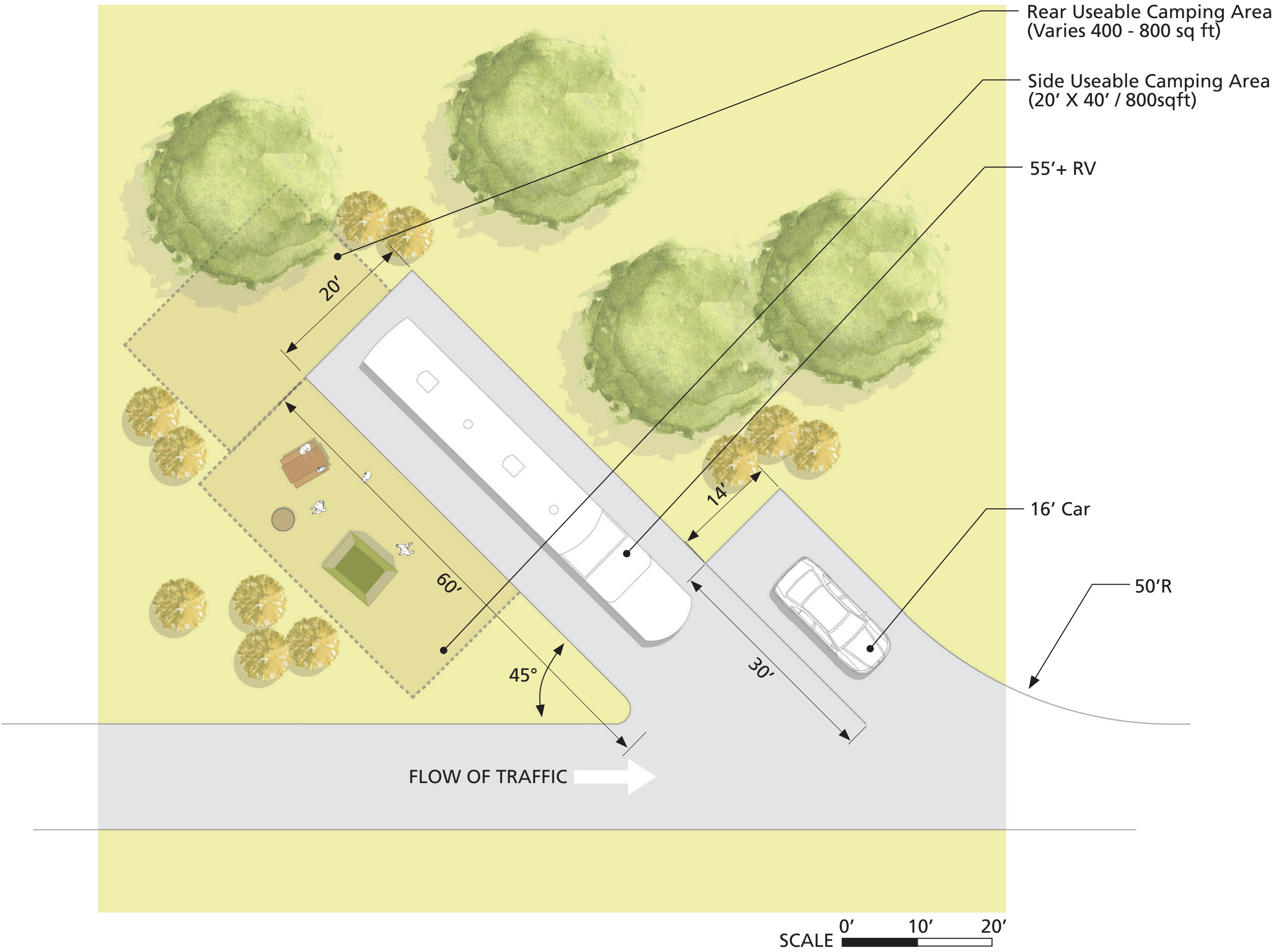

- NOTES:
- All dimensions shown are typical
 - The type of useable camping area present at the site will change from site to site due to differing site conditions
 - Campsites may be located on either side of a one-way road
 - Campsites located on the left hand side of the road within a loop will more likely have a rear useable camping area due to space constraints
 - Double campsites will always have the 60' stall passenger's side located on the exterior of the two stalls for ease of access to the useable camping area
 - Accessible campsites should be easily accessible to and from park facilities (restrooms, etc.)
 - Present in RV Areas and Mixed-Use Areas

TRADITIONAL/TENT AREA

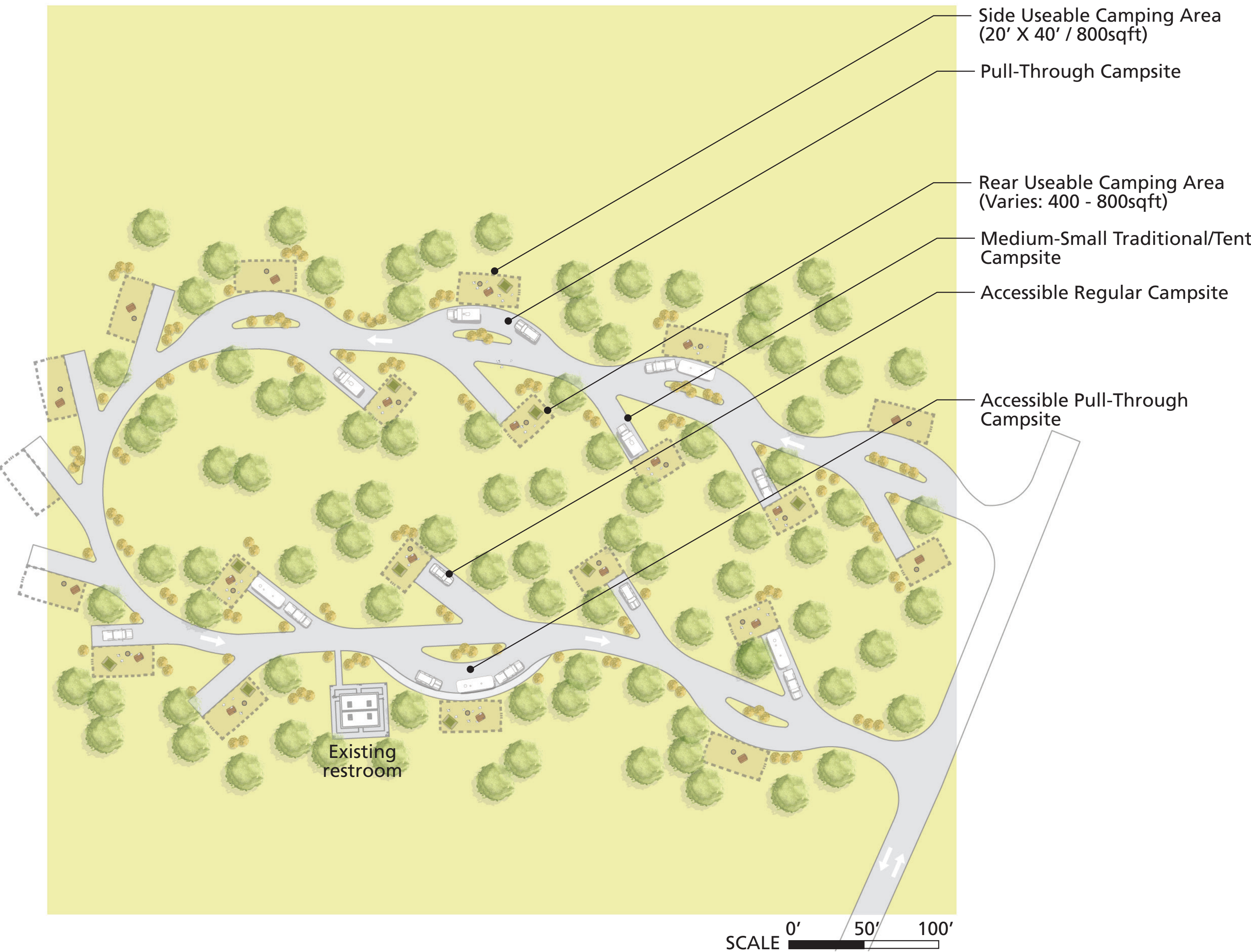

- NOTES:
- All useable camping areas shall have a fire ring, picnic table, and tent pad
 - Campsites located on the left hand side of the road within a loop will more likely have a rear useable camping area due to space constraints
 - Pull-through campsites should be located only on the right side of the road as trailer and RV doors open on the right side of the car
 - Accessible campsites should be easily accessible to and from park facilities (restrooms, etc.)
 - Campsite types accommodated: Medium-Small Traditional/Tent Campsite, Pull-Through Campsite, and Accessible

RV AREA

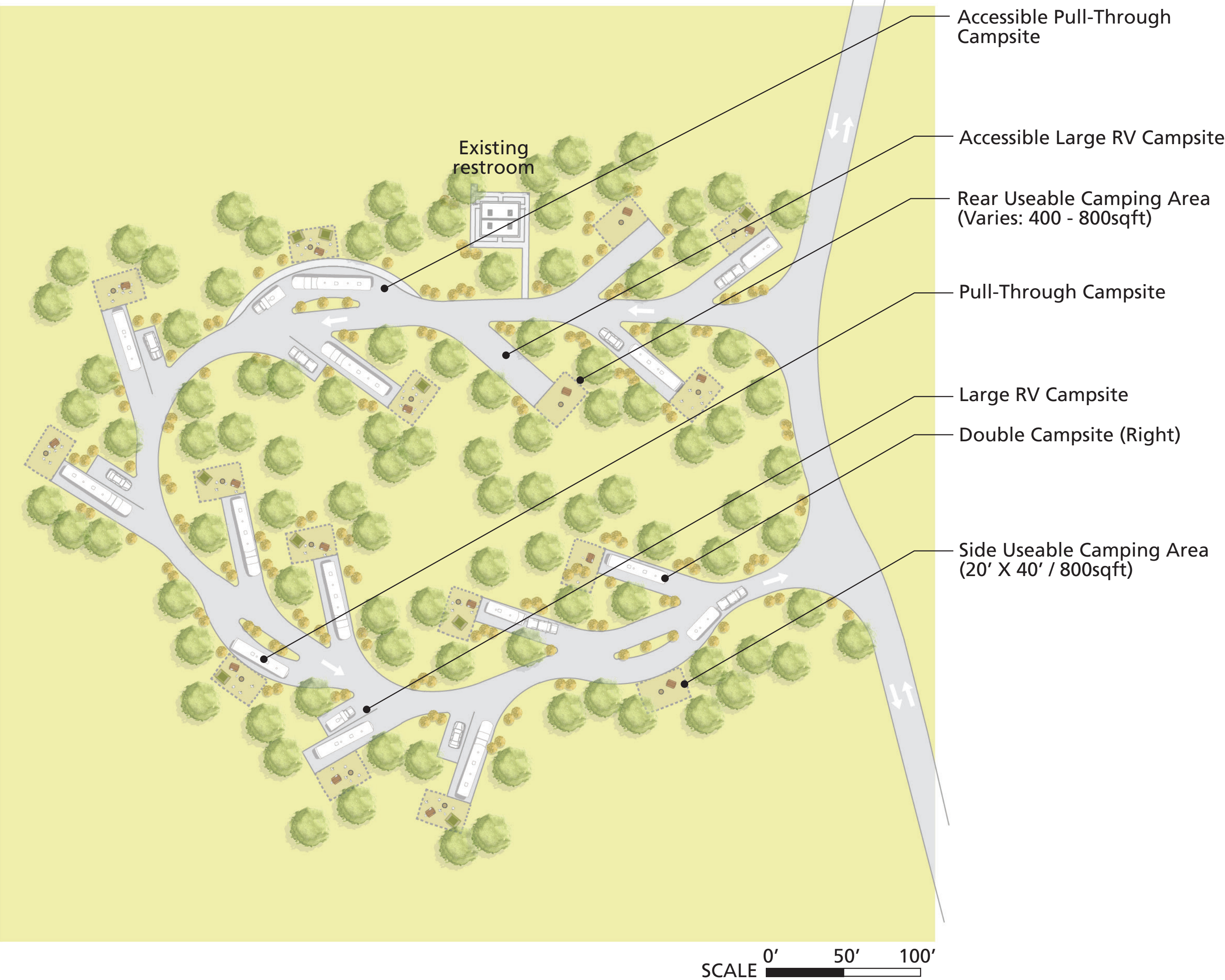

- NOTES:
- All useable camping areas shall have a fire ring, picnic table, and tent pad
 - Campsites located on the left hand side of the road within a loop will more likely have a rear useable camping area due to space constraints
 - Pull-through campsites should be located only on the right side of the road as trailer and RV doors open to the right side of the car
 - Accessible campsites should be easily accessible to and from park facilities (restrooms, etc.)
 - Campsite types accommodated: Large RV Campsite, Large RV Double Campsite, Pull-Through Campsite, and Accessible



EXAMPLE MIXED-USE AREA



Walk-In Campsite Parking

Medium-Small
Traditional/Tent
Campsite

WALK-IN CAMPSITES

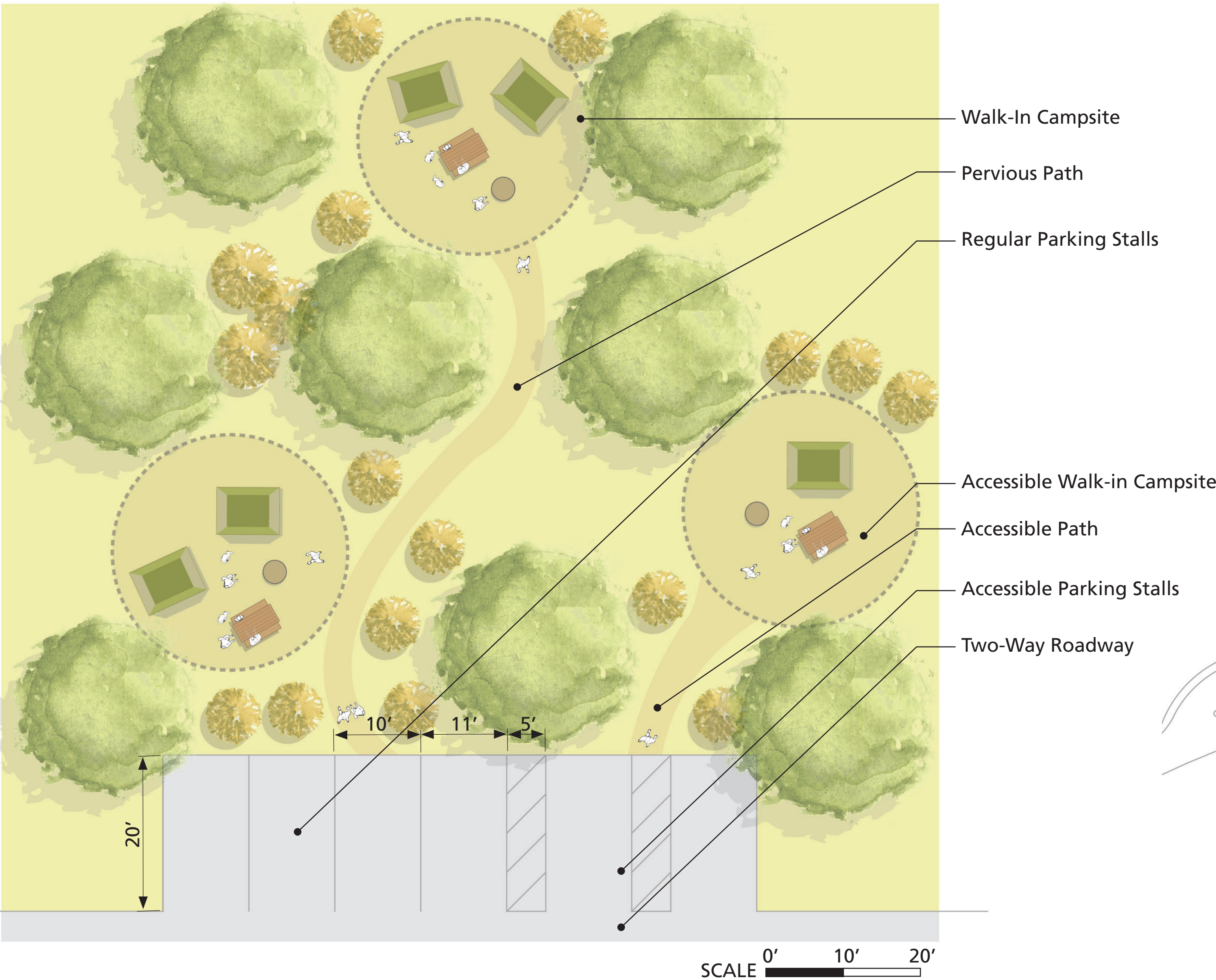

- NOTES:
- All dimensions shown are typical
 - All useable camping areas shall have a fire ring, picnic table, and tent pad
 - Parking shall accommodate for a minimum of one stall per site with one additional accessible stall per area
 - Paths shall be constructed with pervious accessible surface materials
 - Accessible campsites should be easily accessible to and from park facilities (restrooms, accessible parking etc.)
 - Present in Mixed-Use Areas
 - Vehicle types accommodated: Car

MIXED-USE AREA

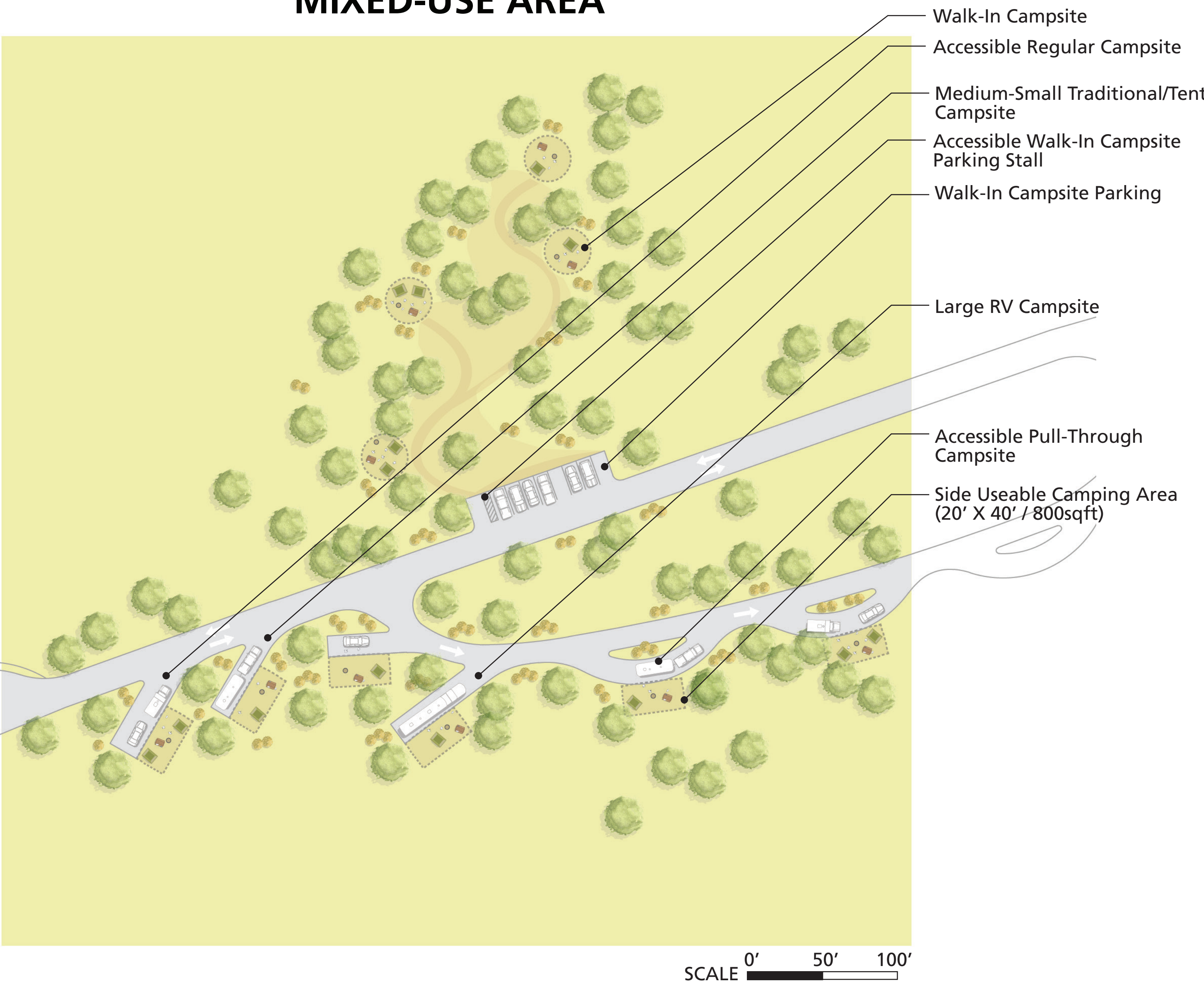

- NOTES:
- All useable camping areas shall have a fire ring, picnic table, and tent pad
 - Campsites located on the left hand side of the road within a loop will more likely have a rear useable camping area due to space constraints
 - Pull-through campsites should be located only on the right side of the road as trailer and RV doors open on the right side of the car
 - Accessible campsites should be easily accessible to and from park facilities (restrooms, etc.)
 - Campsite types accommodated: All