

## **Appendix B. Upper Alley Cross Sections**

---

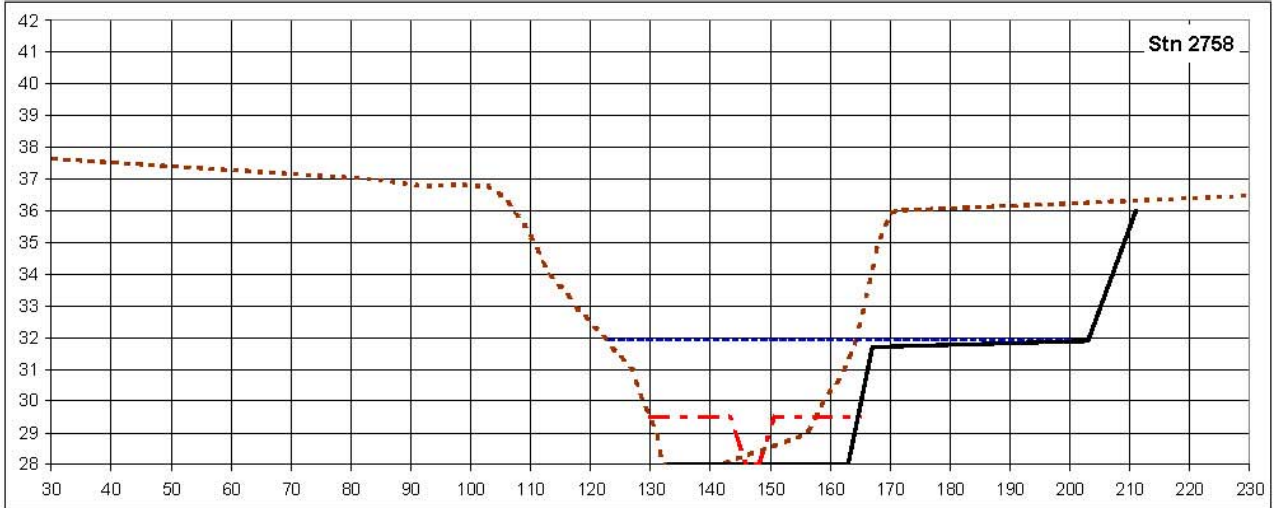
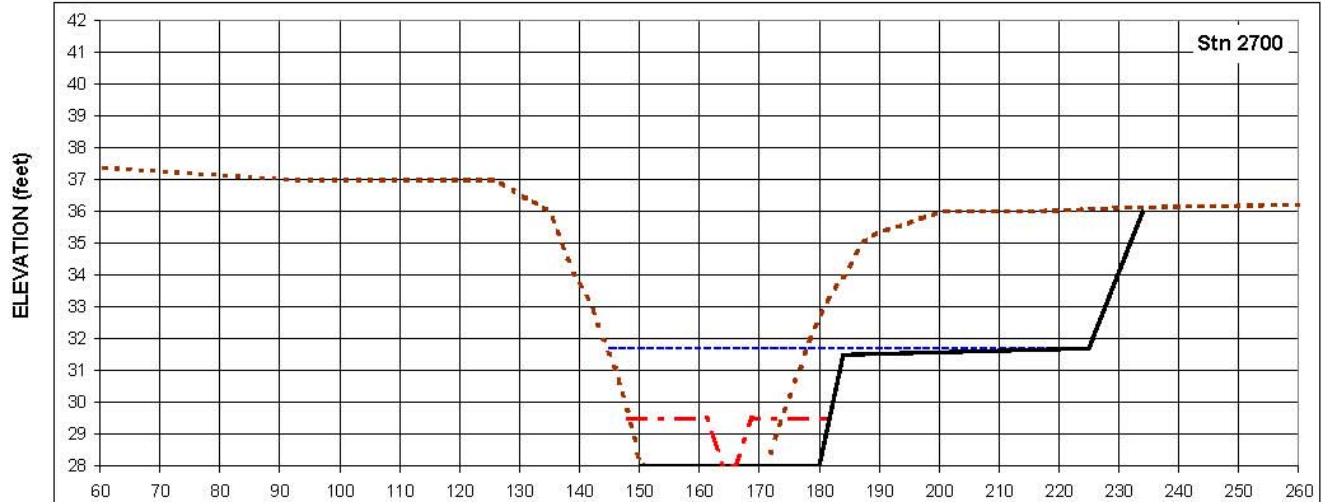
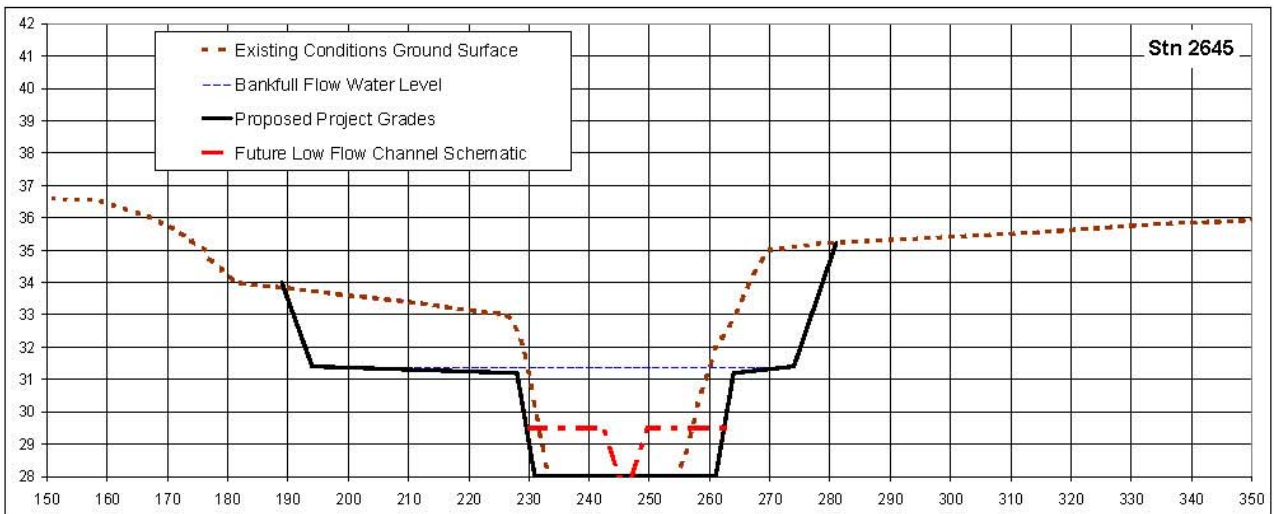

STATION (feet originating from left bank)

Kamman Hydrology & Engineering, Inc.



**UPPER ALLEY EXISTING & PROPOSED PROFILES**  
 Design Report for Lower Redwood Creek Floodplain and Salmonid  
 Habitat Restoration at the Banducci Site

FIGURE

5a

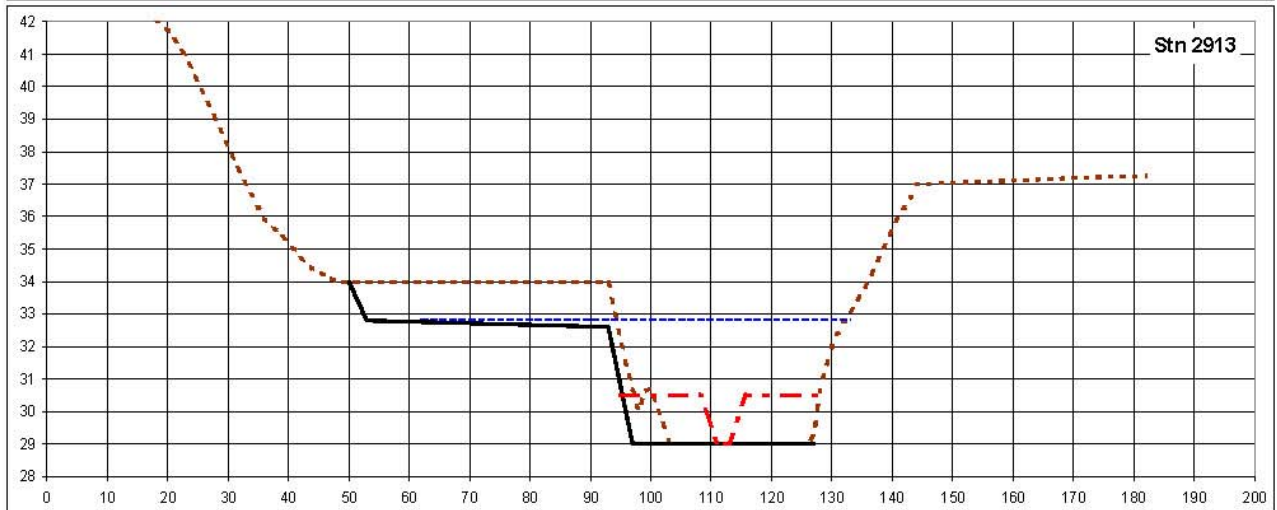
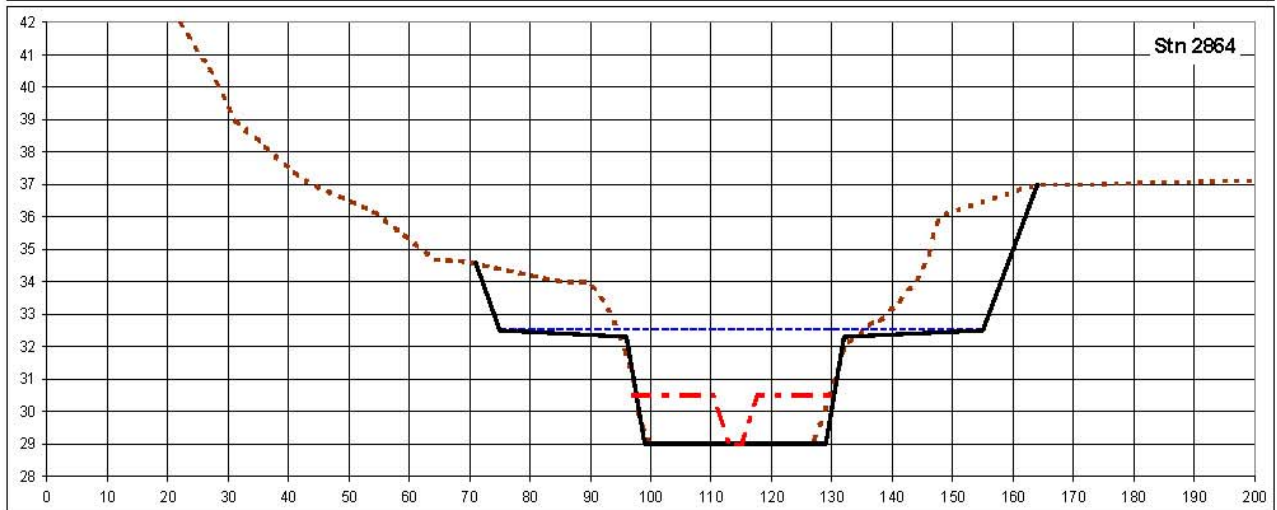
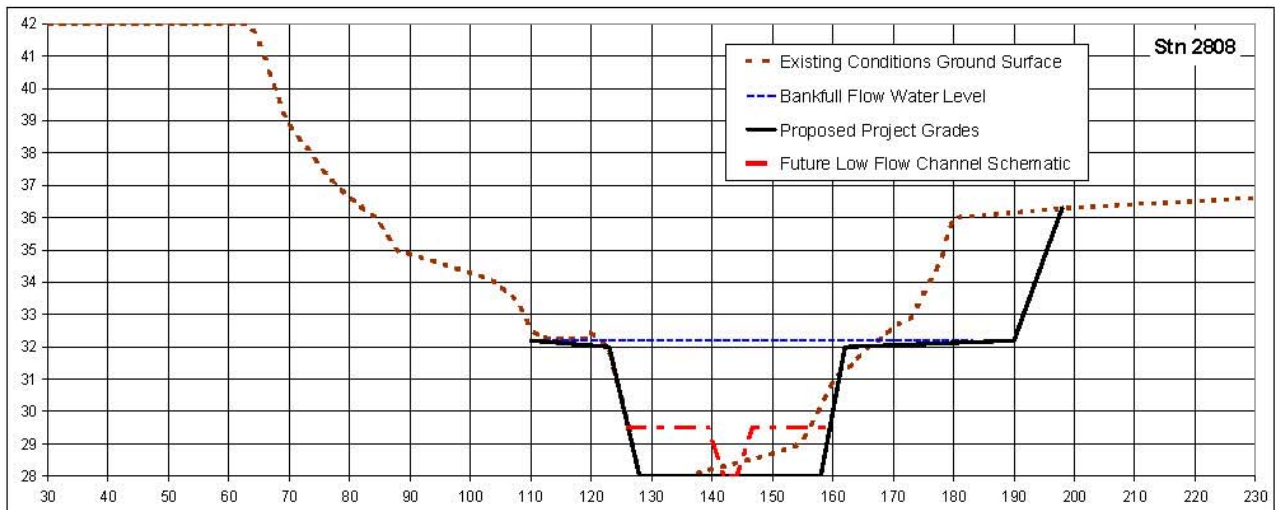

STATION (feet originating from left bank)

Kamman Hydrology  
& Engineering, Inc.



**UPPER ALLEY EXISTING & PROPOSED PROFILES**  
 Design Report for Lower Redwood Creek Floodplain and Salmonid  
 Habitat Restoration at the Banducci Site

FIGURE

5b

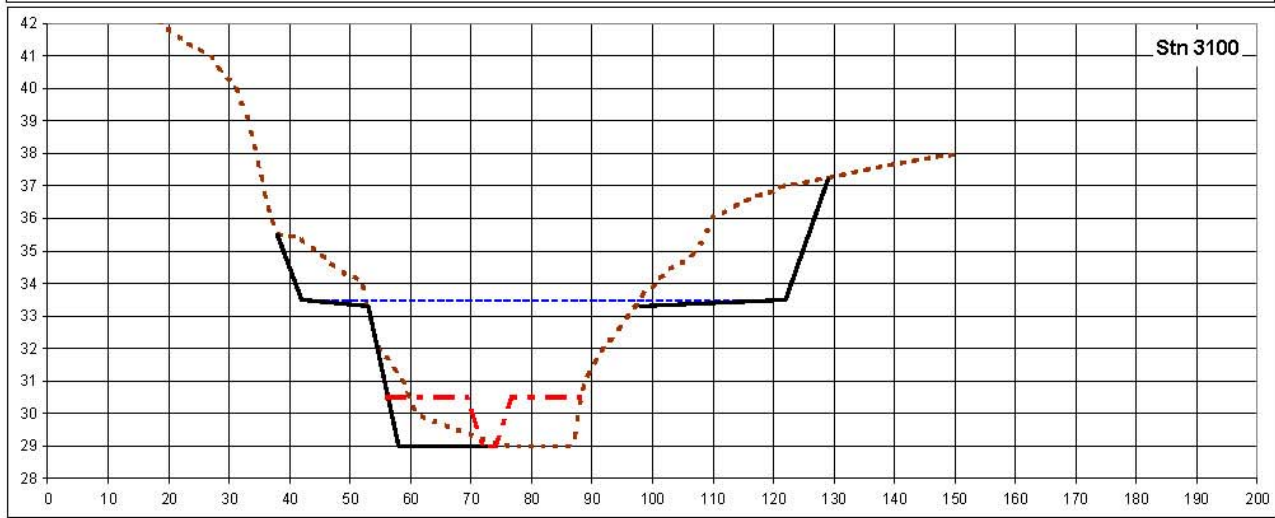
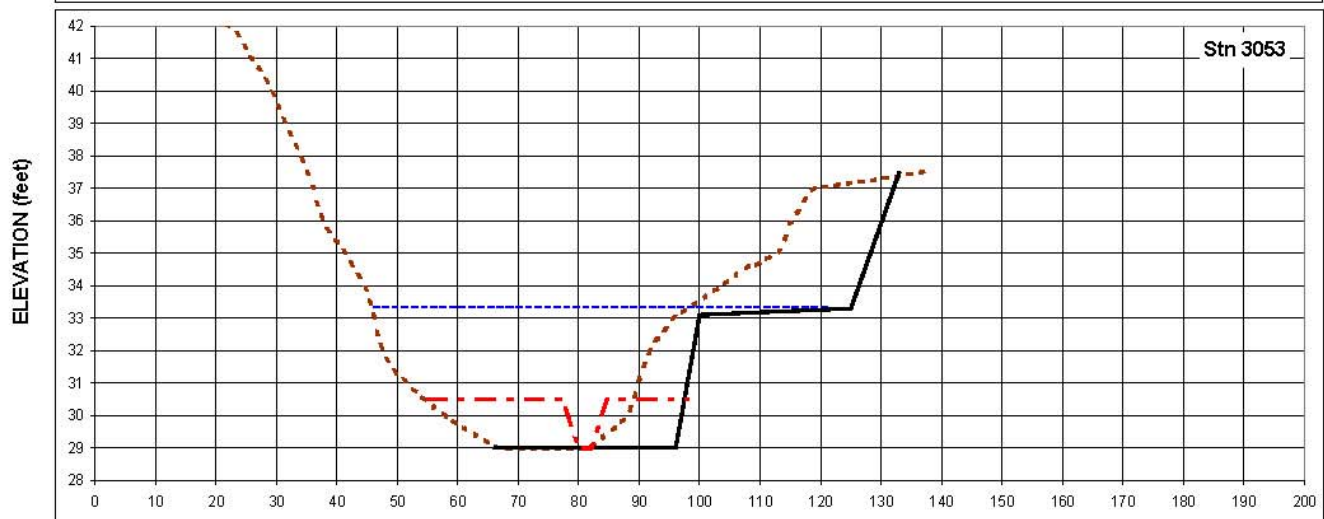
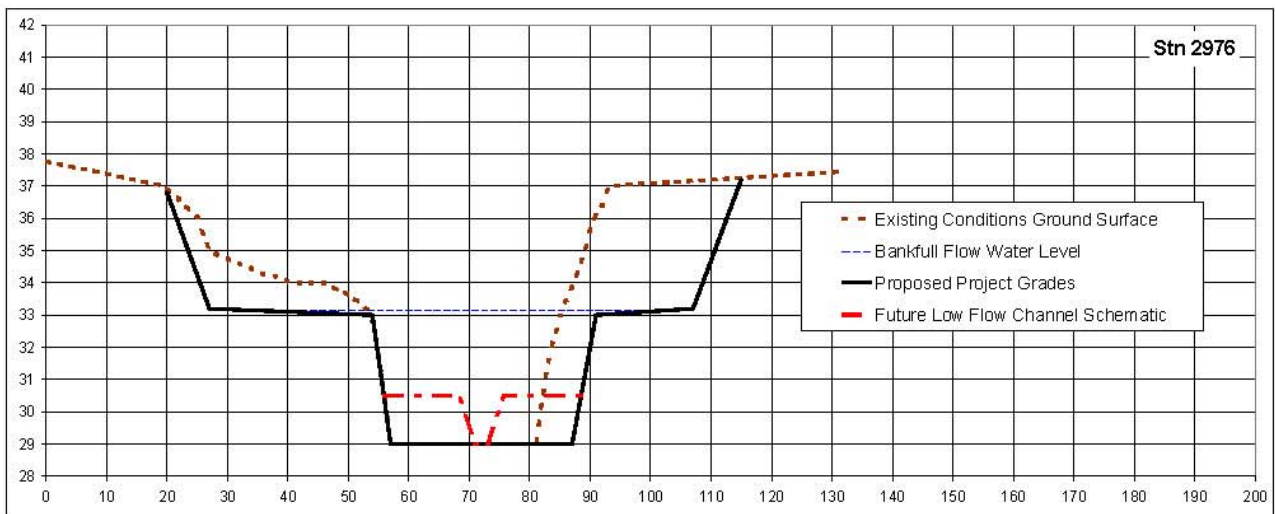

STATION (feet originating from left bank)

Kamman Hydrology  
& Engineering, Inc.



**UPPER ALLEY EXISTING & PROPOSED PROFILES**  
 Design Report for Lower Redwood Creek Floodplain and Salmonid  
 Habitat Restoration at the Banducci Site

FIGURE

5c

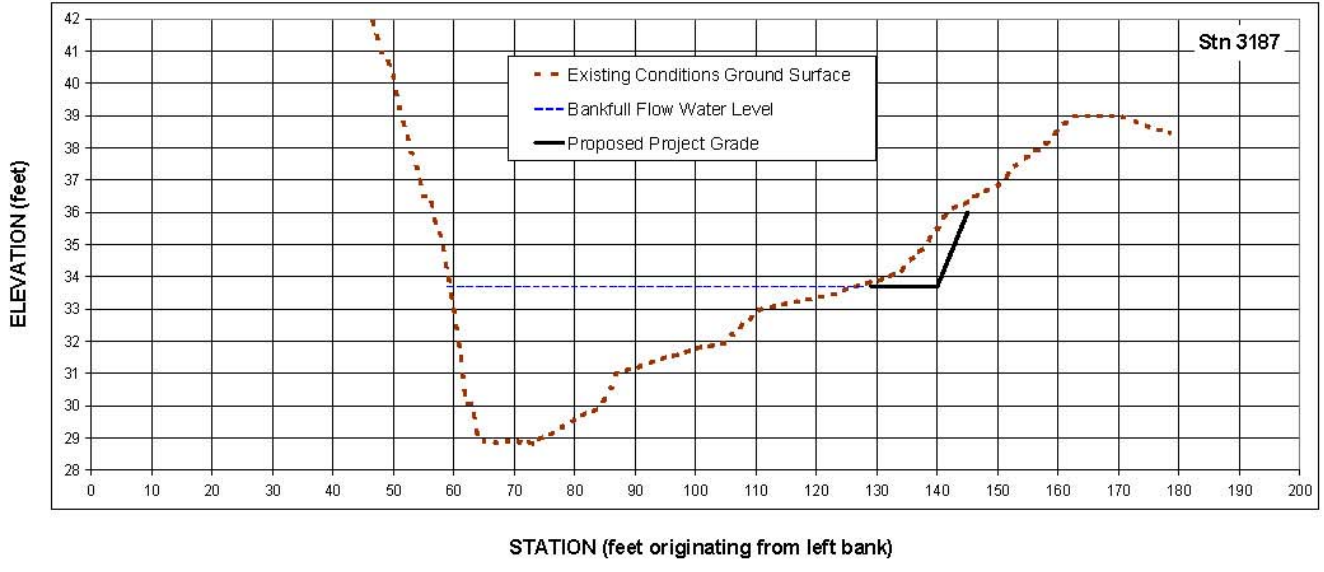

Kamman Hydrology  
& Engineering, Inc.



**UPPER ALLEY EXISTING & PROPOSED PROFILES**

Design Report for Lower Redwood Creek Floodplain and Salmonid  
Habitat Restoration at the Banducci Site

FIGURE

5d