



## **National World War I Memorial**

Washington D.C.

U.S. World War I Centennial Commission

UU+ Studio

Forge Landscape Architecture

GWWO, Inc./Architects

**Section 106 Meeting**

**June 28, 2017**



# Site Location





# Area of Potential Effects

- Pennsylvania Avenue is the ceremonial physical and visual corridor connecting the Capitol to the White House
- The site is located within Pennsylvania Avenue National Historic Site
- Pennsylvania Avenue streetscape materials and alignments have been integrated into the design of the park

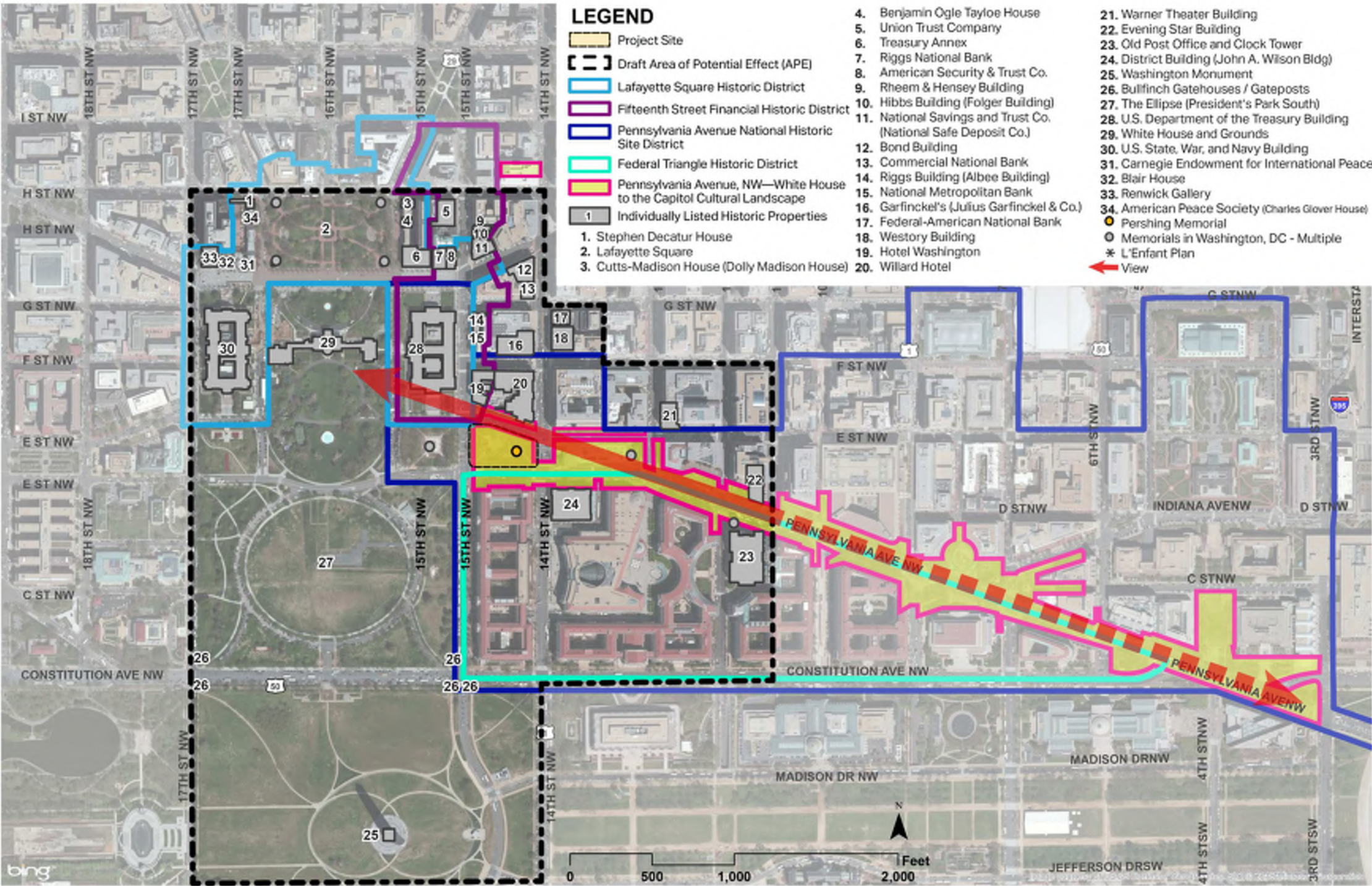



Site Context

Existing Park Photographs



Existing Park - View Looking Northeast



Existing Park - View Looking West



Existing Park - View of Pershing Statue



Existing Park - View Looking East



Existing Park - View of Kiosk



# Existing Park Analysis

## Rooms and Focal Points

In response to NCPC comments, the design team revisited analysis of the M. Paul Friedberg and Partners, Wallace K. Harrison, and Oehme van Sweden designs for the existing Pershing Park.

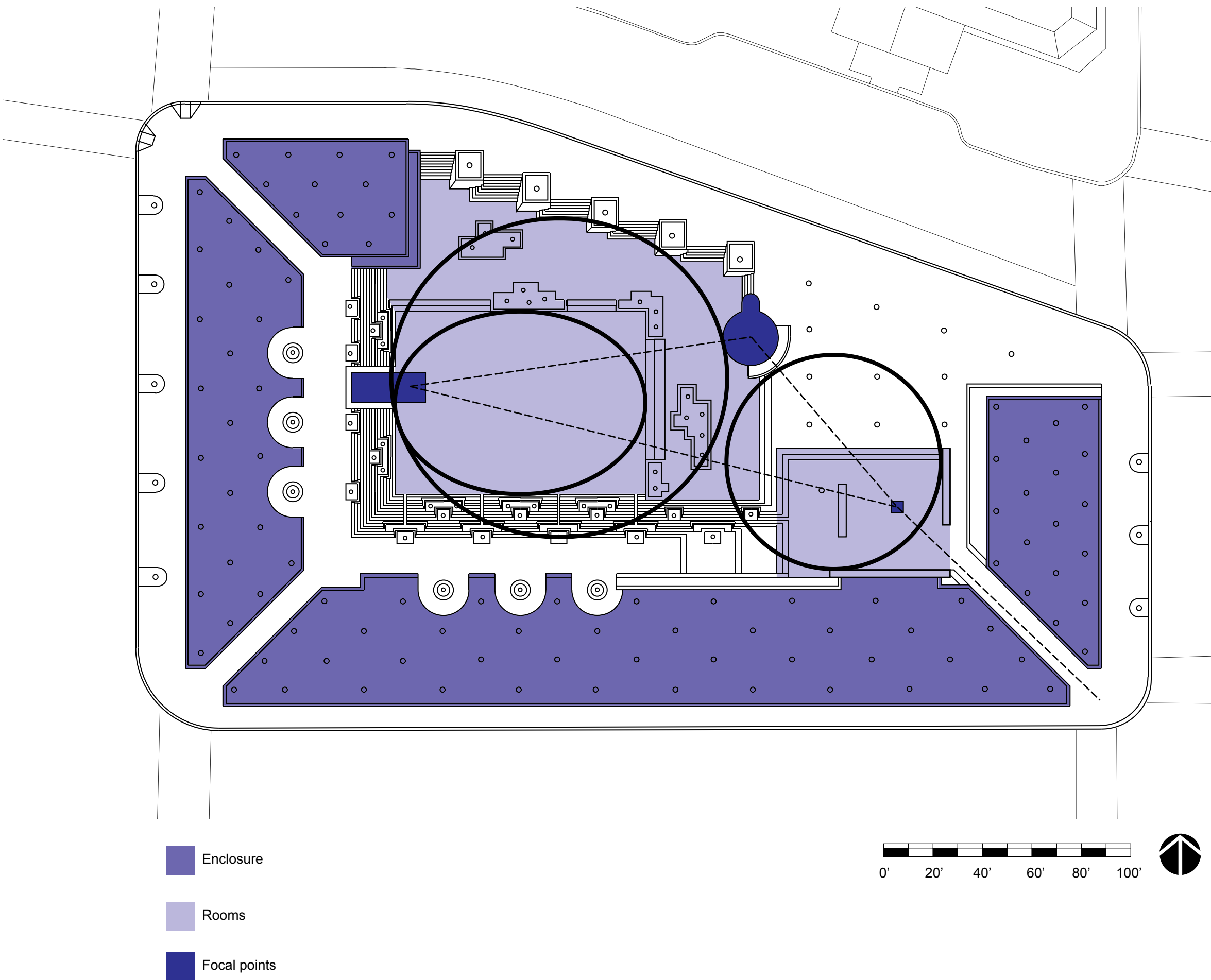
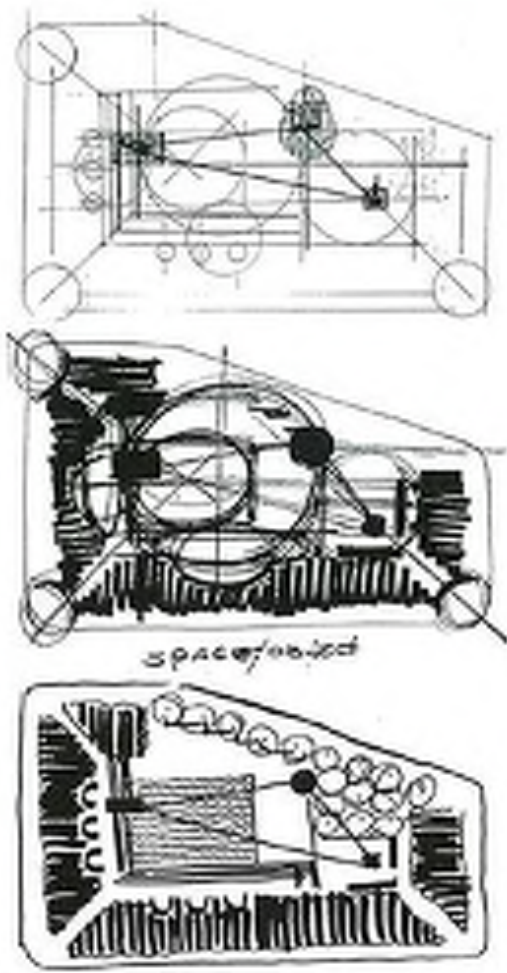



# Concept Comparisons Plans

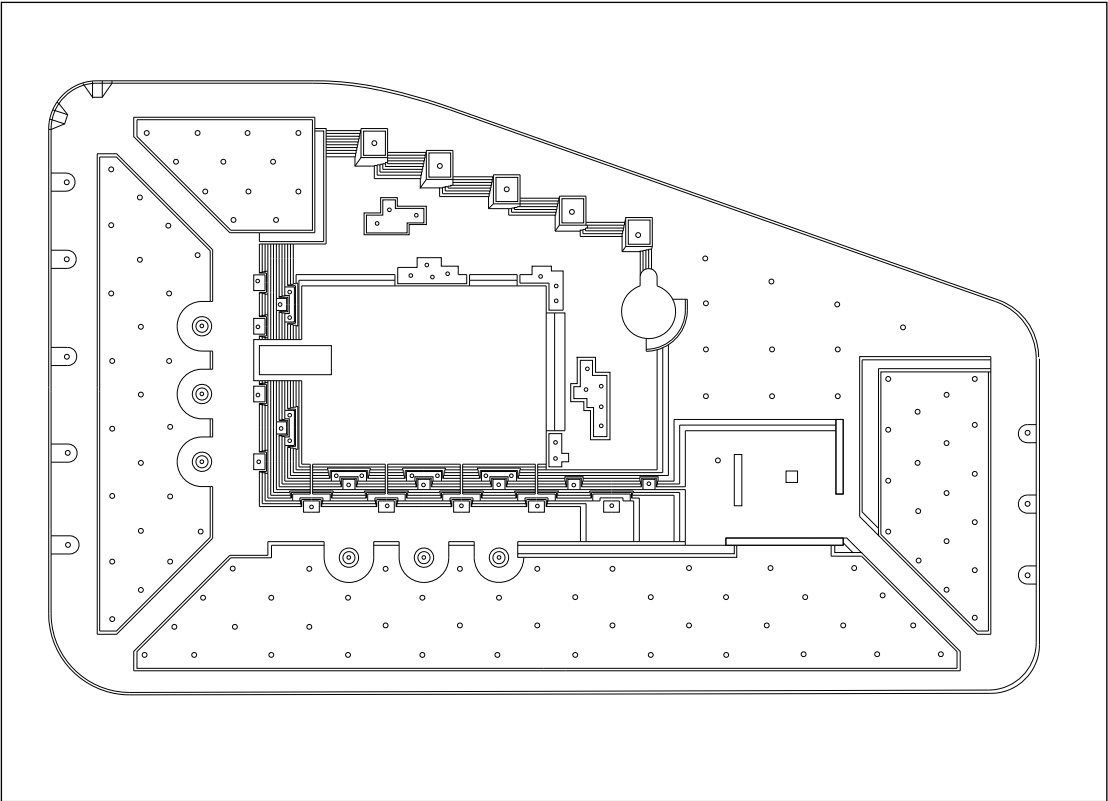

EXISTING PARK DESIGN



JANUARY 2016 COMPETITION SCHEME



OCTOBER 2016 CONCEPT

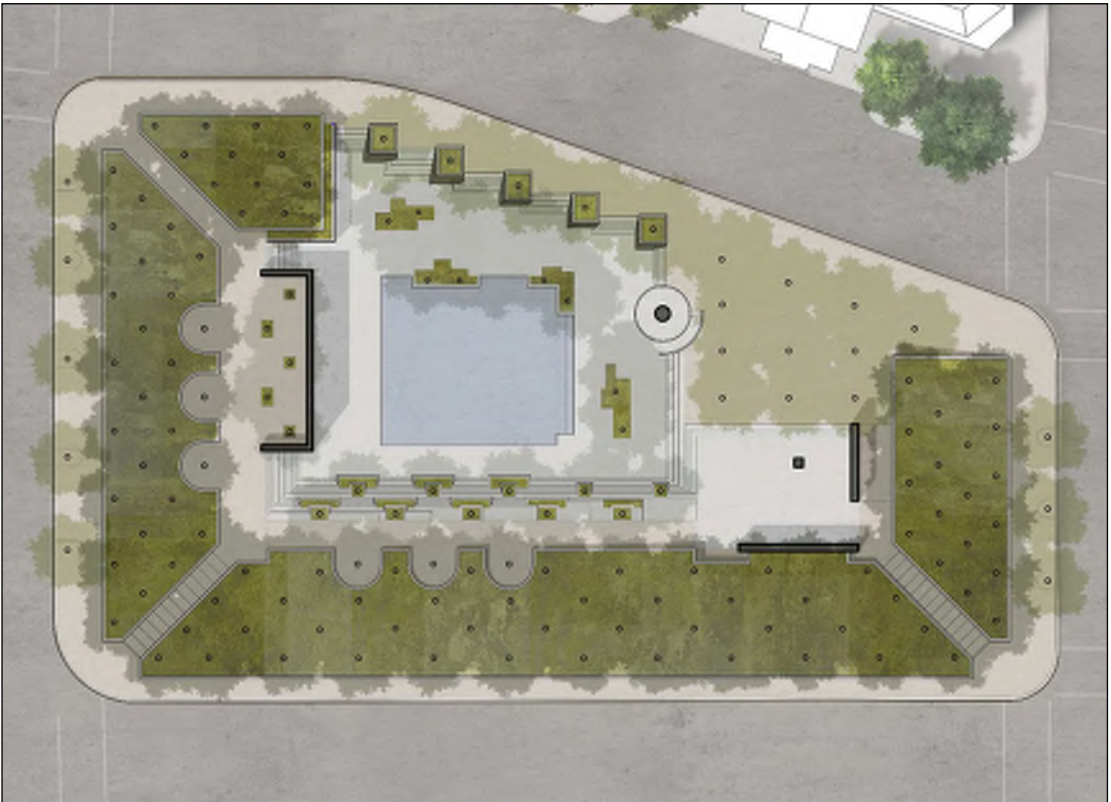

FEBRUARY 2017 POOL AND PLAZA CONCEPT



# Design Evolution

Through the pursuit of multiple design iterations and revisions the design team concluded that the most appropriate location and expression for a memorial which meets the initially stated goals of the WWICC and best mitigates the adverse effects to the existing park is a solution which modifies the existing fountain element located within the western terrace. The select solutions shown here were attempts to create a design which met the aforementioned goals and each scheme represents a larger course of study. Each of the solutions was evaluated and ultimately dismissed because it either failed to meet the commemorative goals of the WWICC, caused significant change to the existing park features, or resulted in a design which had overall negative consequences on the experience and function of the park.

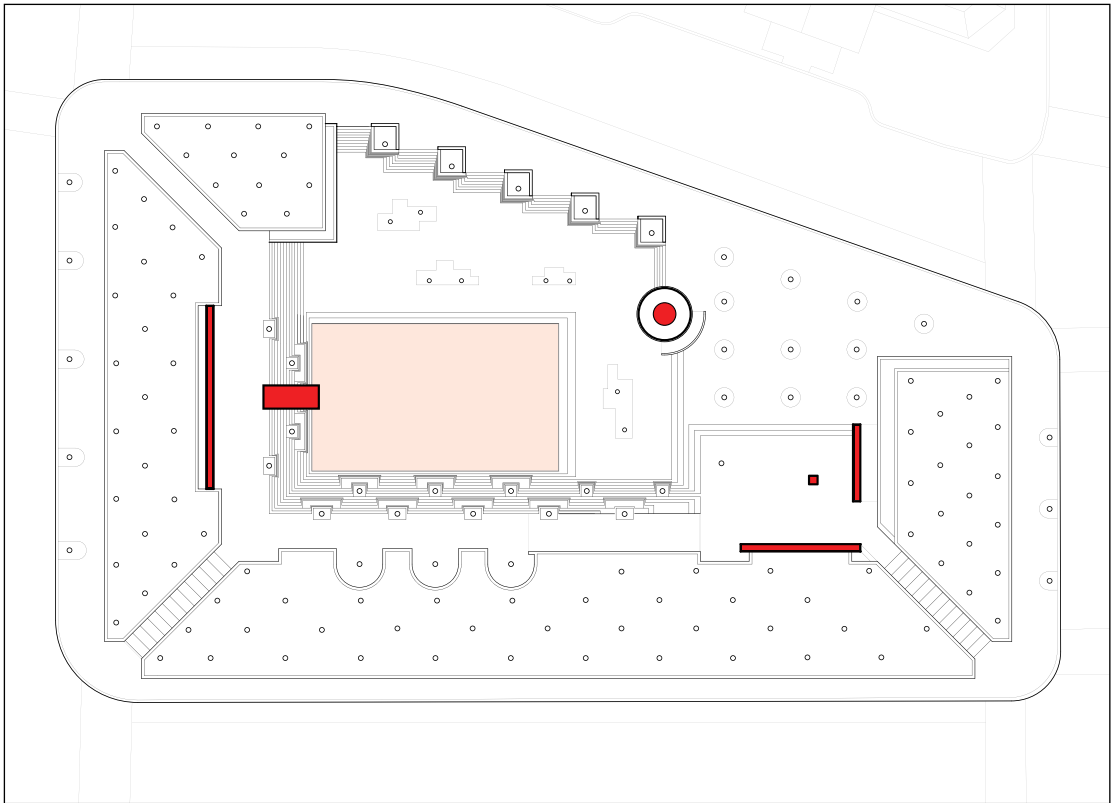

UPPER WALL DESIGN

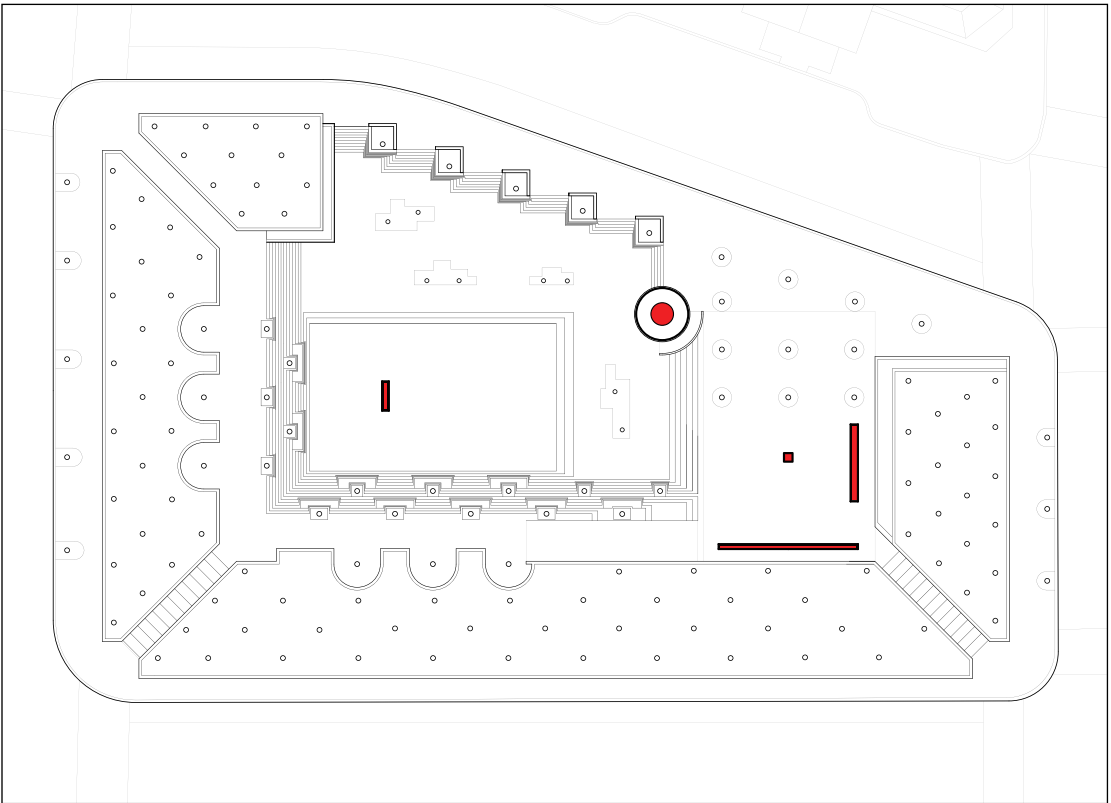

TRIUMPHAL COLUMN DESIGN

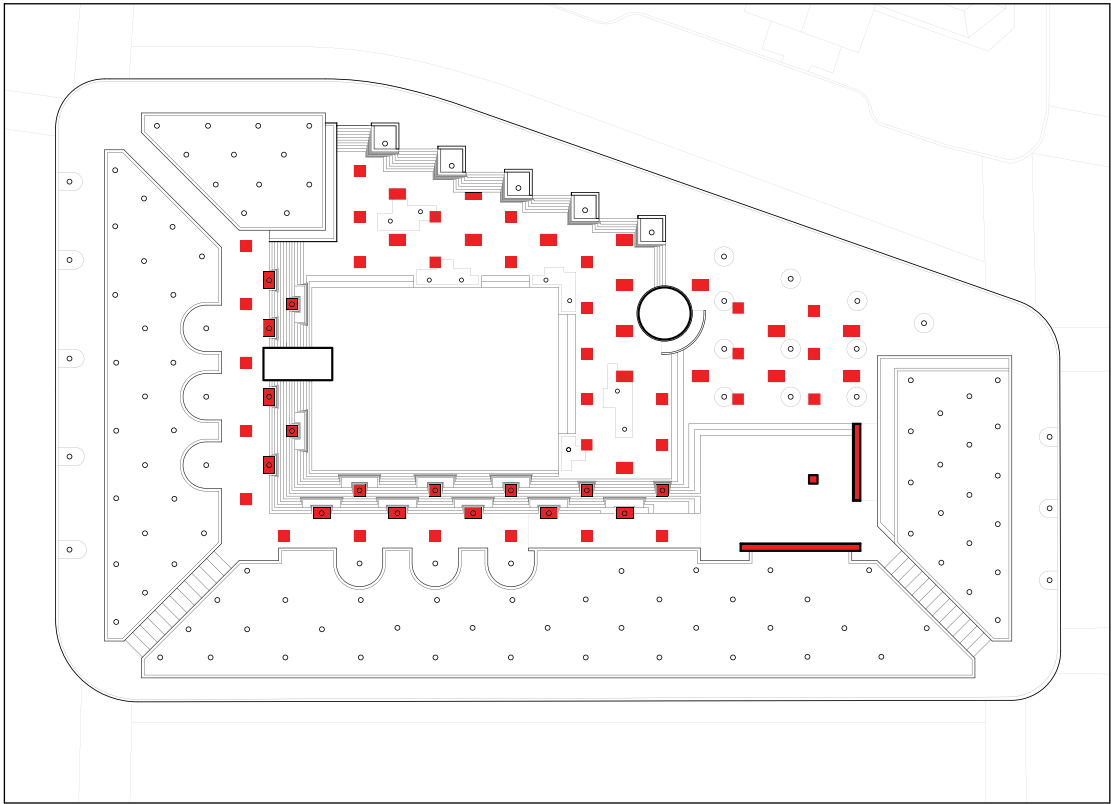

DISTRIBUTED MEMORIAL PAVING

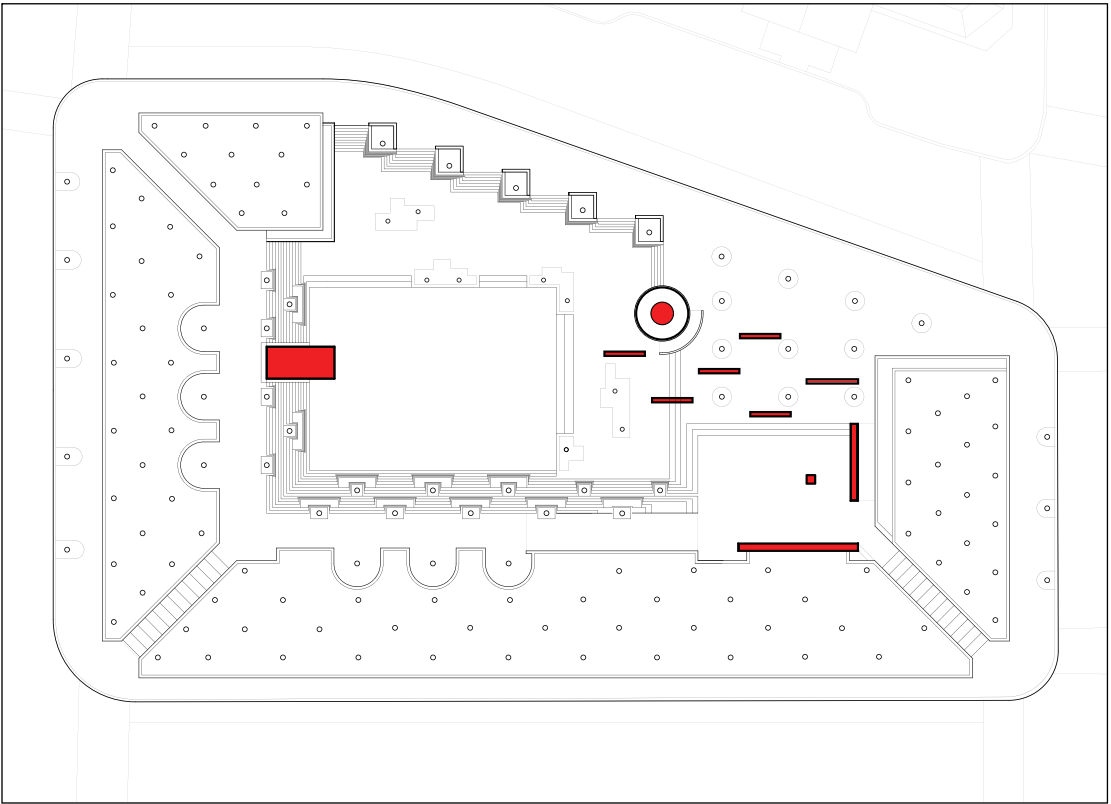

DISTRIBUTED MEMORIAL WALLS



# June 2017 Restored Pool Concept

The intent of this design is to create a memorial which shares a symbiotic relationship with the existing park. The fountain provides the water, sound, and ambiance to the park while the water in the pool reflects the fountain, trees, and the sky. By joining these two features together the memorial becomes as much about the narrative of life and war depicted above the water as it becomes about the loss reflected below.

In order to accomplish this, the existing fountain element is expanded equally north and south to become a larger 65' wide art object nestled in the western terrace stair. Similar to the functionality of the existing fountain, a pool of water wells up from the fountain and cascades over the sides and back into troughs which bring it down to the pool. The side of the fountain facing the pool includes the bronze bas relief and only has water running down the left and right edges of the sculpture. A pathway has been created within the pool to allow for visitors to access the artwork.

## ASSESSMENT

- Redefines the existing fountain and pool as the primary commemorative expression
- Redefines circulation of the lower pool area while maintaining pool integrity
- Requires a change to the western terrace seating





# Sculptural Artwork

The central memorial feature is a monumental work of sculpture in bronze bas-relief, conceived of as a visual and emotional narrative. The work is meant to convey feelings of honor, pride, and loss.

“The soldier will journey from the arms of his family, through the brutality of battle, past figures representing death and madness, into the care of a nurse, and finally return home forever changed.” -The Wall Street Journal

The narrative consists of a series of scenes depicting five “acts” of the war: the call to arms, the departure, the battle, the aftermath, and the return. A recurring figure appears throughout, as the man takes leave of his family, joins the march to war and then the battle, suffers the shock of casualty, and then returns home. In the first scene the man takes his helmet from his young daughter; in the last, he returns his helmet to his older, wiser child, a symbol of American coming-of-age in World War I and a harbinger of the war that the next generation would fight twenty years later.

On another level, the central battle scene conveys the courage and heroism of American forces in the war, which was as profound as that in better-remembered wars. The scene of aftermath depicts the physical and mental toll of the war, followed by a scene of proud return recognizing the accomplishments of American troops, with a parade of soldiers marching into “the American century.”





# June 2017 Restored Pool Concept



View Looking South West



June 2017 Restored Pool Concept



View Looking West



# Restored Pool Concept

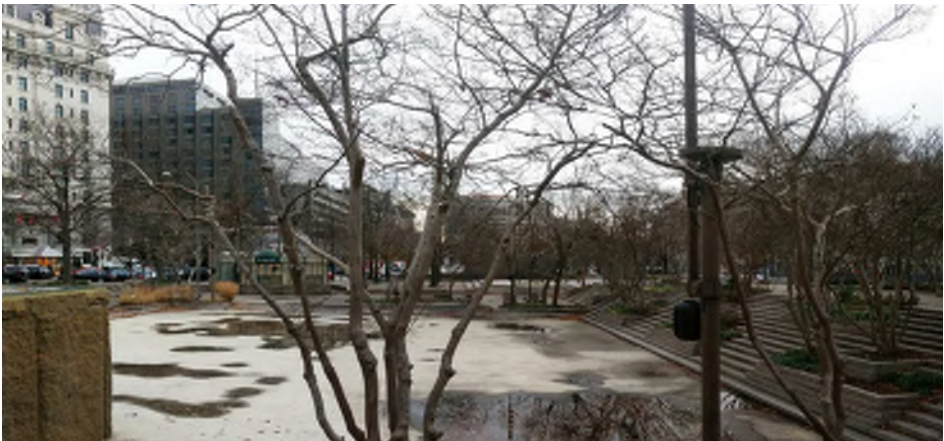

View Looking East from Upper Terrace



# June 2017 Restored Pool Concept

The “Restored Pool Concept” requires that some means of pathway be created in order to facilitate visitors with an accessible route from the lower terrace region to the sculptural bas relief wall. By merging the materiality of this route with an appropriate pool bottom covering the design team intends that the entire pool region will read as a single continuous surface. The pathway through the water is only revealed by the presence of water within the pool basin. Examples of similar design strategies can be found on page 25.

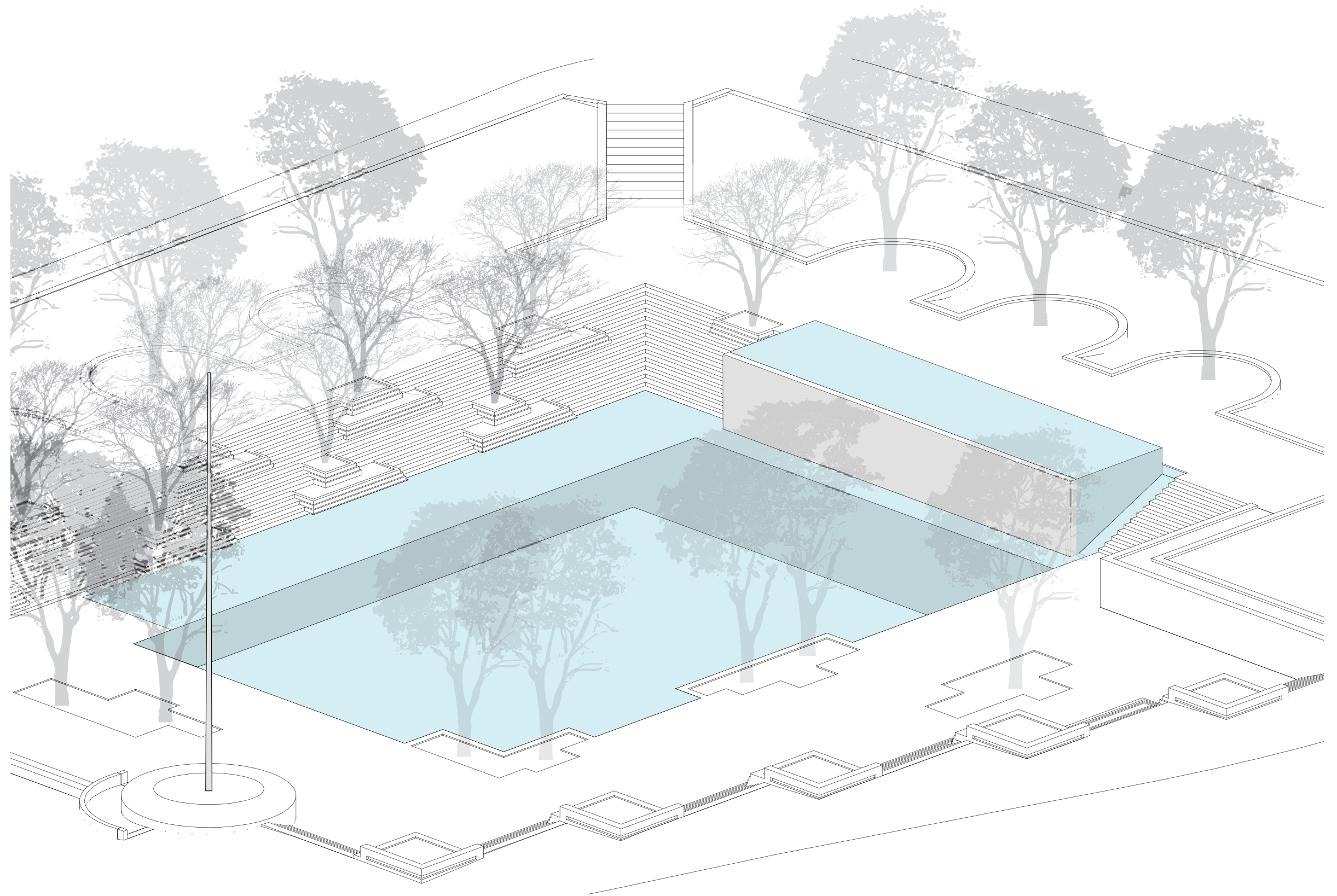



# June 2017 Restored Pool Concept

## Assessment of Effects

The following character-defining features of the L'Enfant Plan of the City of Washington, the Pennsylvania Avenue National Historic Site historic district, and the contributing features of the Pennsylvania Avenue NW-White House Cultural Landscape would be maintained:

- Use of park as open space, recreation, and transportation
- PADC streetscape, including Pennsylvania Avenue street trees and lights
- Views and vistas retained between U.S. Capitol and U.S. Treasury Building and along L'Enfant Plan streets
- Spatial organization retained, including access to the adjacent streets
- Pershing Memorial retained
- Terraced seating and planters mostly retained
- Pershing Memorial
- The location of the Bex Eagle is yet to be determined.
- The Restored Pool Concept would result in no adverse effect on the L'Enfant Plan of the City of Washington, the Pennsylvania Avenue National Historic Site historic district, and the contributing features of the Pennsylvania Avenue NW-White House Cultural Landscape

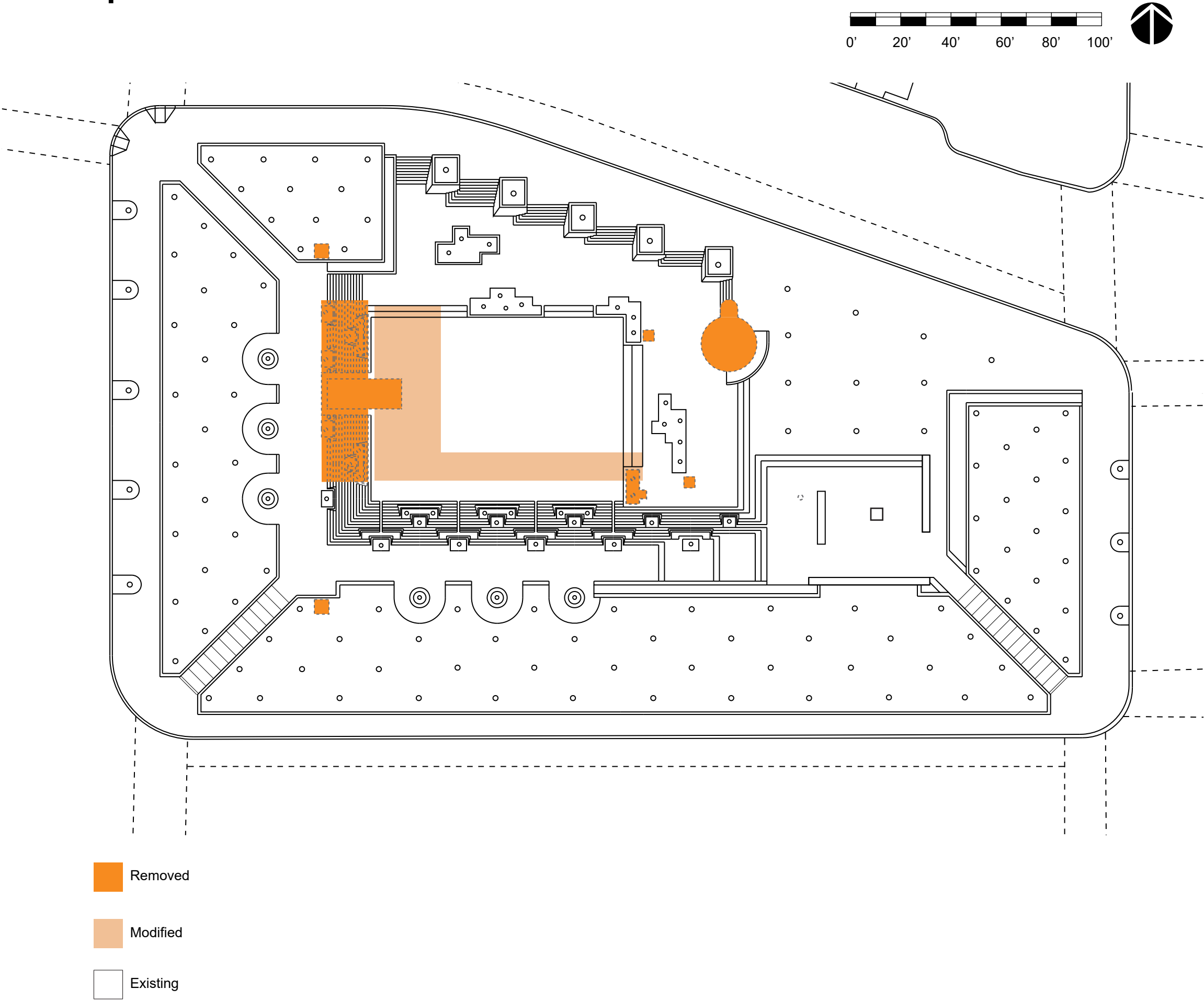



# June 2017 Restored Pool Concept

## Assessment of Effects for L'Enfant Plan, Pennsylvania Avenue NHS Historic District, and Pennsylvania Avenue NW-White House Cultural Landscape

The following contributing features of the L'Enfant Plan of the City of Washington, the Pennsylvania Avenue National Historic Site historic district, and the Pennsylvania Avenue NW-White House cultural landscape would be retained:



- Reservation 617
- Pennsylvania Avenue, including sidewalks, street trees, and PADC street lights
- Views and vistas between U.S. Capitol and U.S. Treasury Building and along L'Enfant Plan streets
- Pershing Memorial

The following contributing features of the L'Enfant Plan of the City of Washington, the Pennsylvania Avenue National Historic Site historic district, and the Pennsylvania Avenue NW-White House cultural landscape would be modified:

- Spatial organization, including access to the adjacent streets
- Use of park as commemorative, recreation, and transportation land use

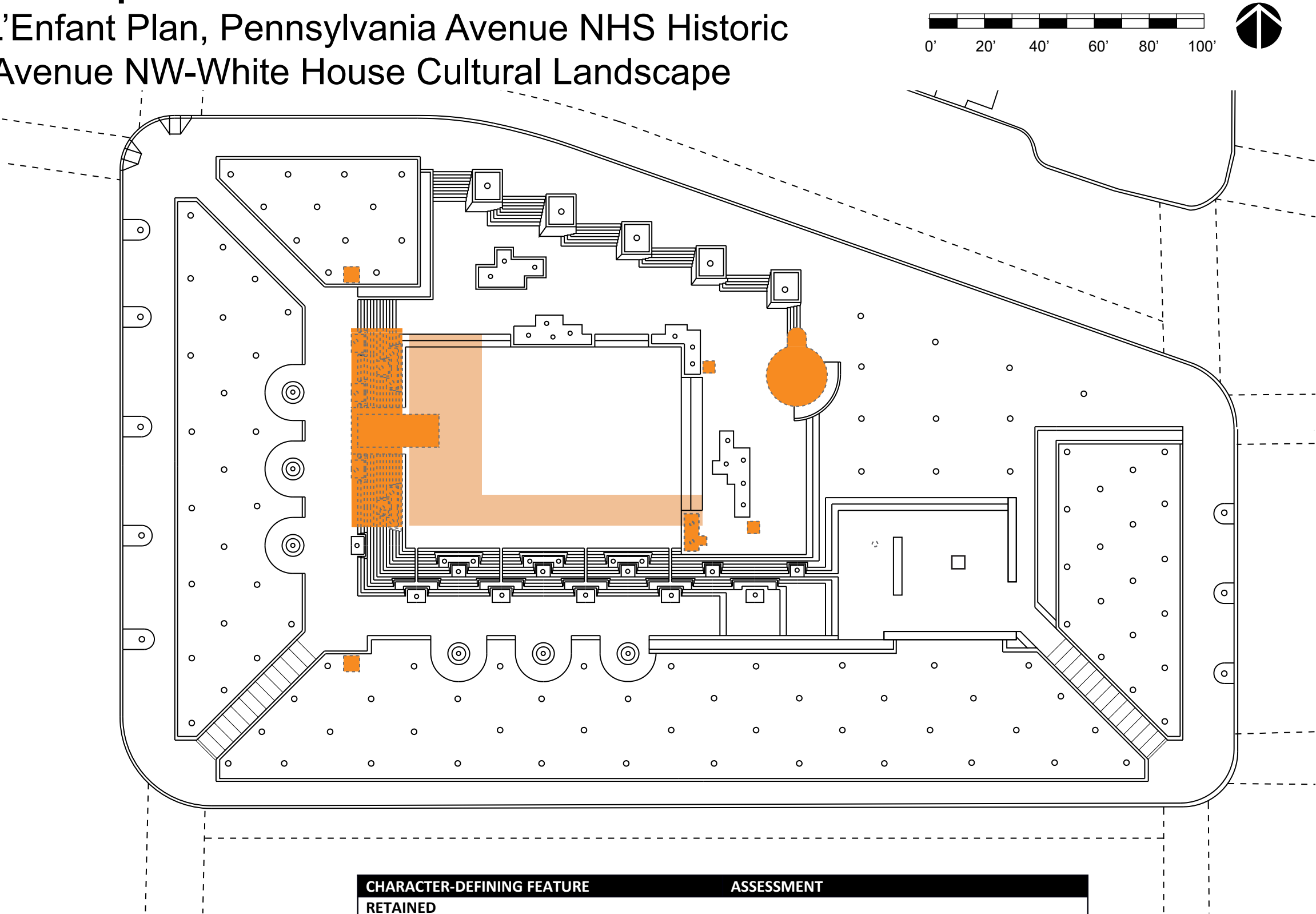
Note: The name Restored Pool Concept is not intended to reflect the term “restoration” as described in the Secretary of Interior’s Standard for Treatment of Historic Properties



-  Removed
-  Modified
-  Existing

CHARACTER-DEFINING FEATURE	ASSESSMENT
<b>RETAINED</b>	
Reservation 617	No adverse effect
Pennsylvania Avenue streetscape	No adverse effect
Views and vistas	No adverse effect
Pershing Memorial	
<b>MODIFIED</b>	
Spatial organization	No adverse effect
Use of park	No adverse effect



# June 2017 Restored Pool Concept

## Assessment of Effects for Pershing Park: Spatial Organization

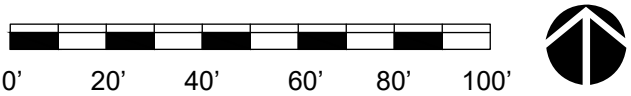

The following spatial organization character-defining features would be retained:

- Entrances to the park from the four corners
- Pershing Memorial separation from the street through walls
- Pershing Memorial connection to other park spaces with steps

The following spatial organization character-defining features would be modified:

- Design with sunken pool at the center, earthen berms on three sides, elevated walks on the south and west, and Pershing Memorial at the southeast corner
- Free flow of space between the activity zone

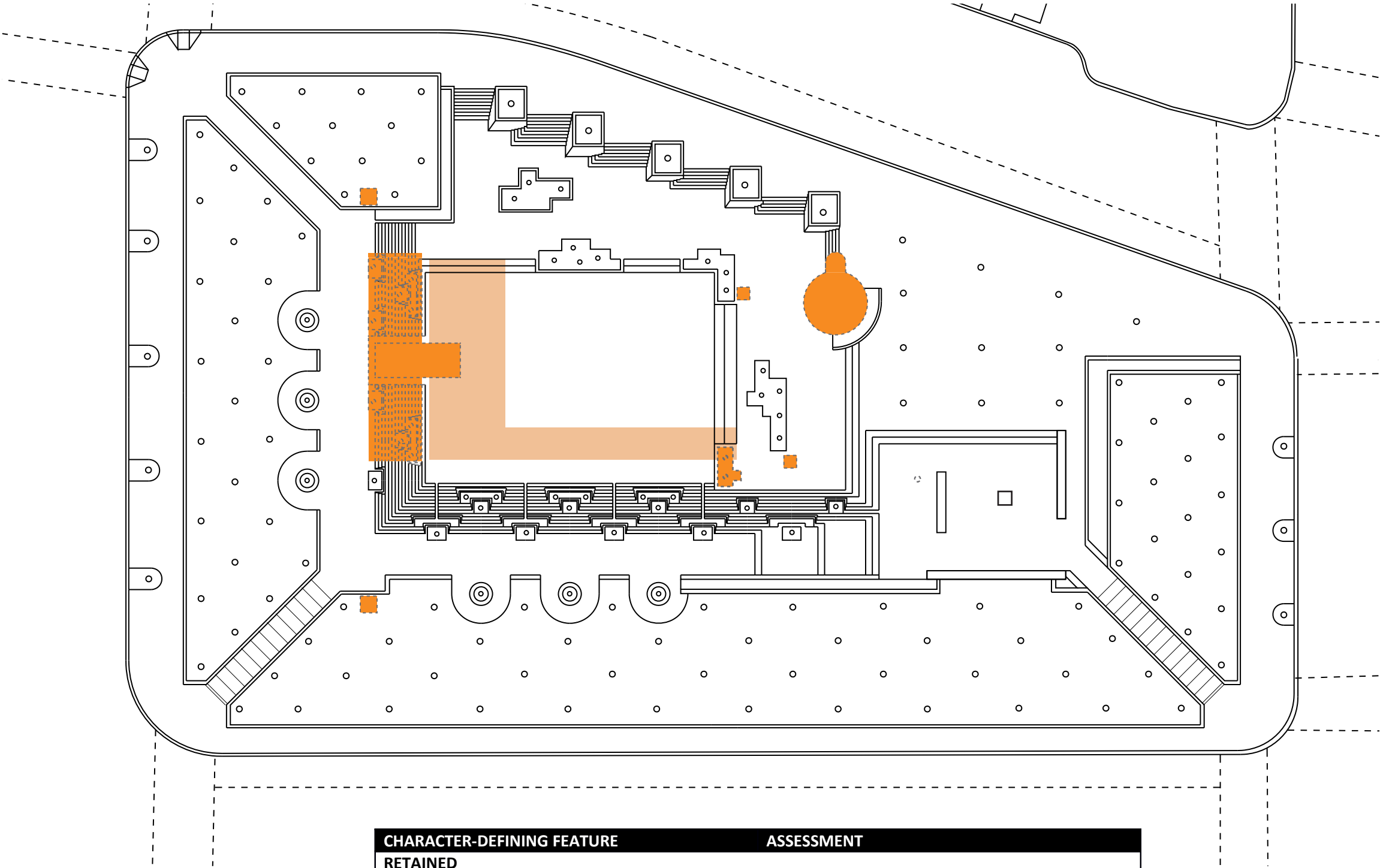

- Removed
- Modified
- Existing

Note: The name Restored Pool Concept is not intended to reflect the term “restoration” as described in the Secretary of Interior’s Standard for Treatment of Historic Properties

CHARACTER-DEFINING FEATURE	ASSESSMENT
RETAINED	
Entrances	No adverse effect
Pershing Memorial	No adverse effect
MODIFIED	
Design (sections)	Adverse effect
Free flow of space	Adverse effect



# June 2017 Restored Pool Concept

## Assessment of Effects for Pershing Park: Views and Vistas

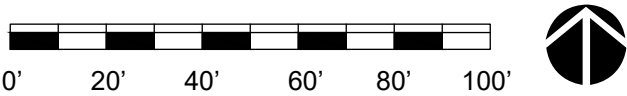

The following view and vista character-defining features would be retained:

- Omnidirectional views between park spaces

The following view and vista character-defining feature would be modified:

- Park's focal points

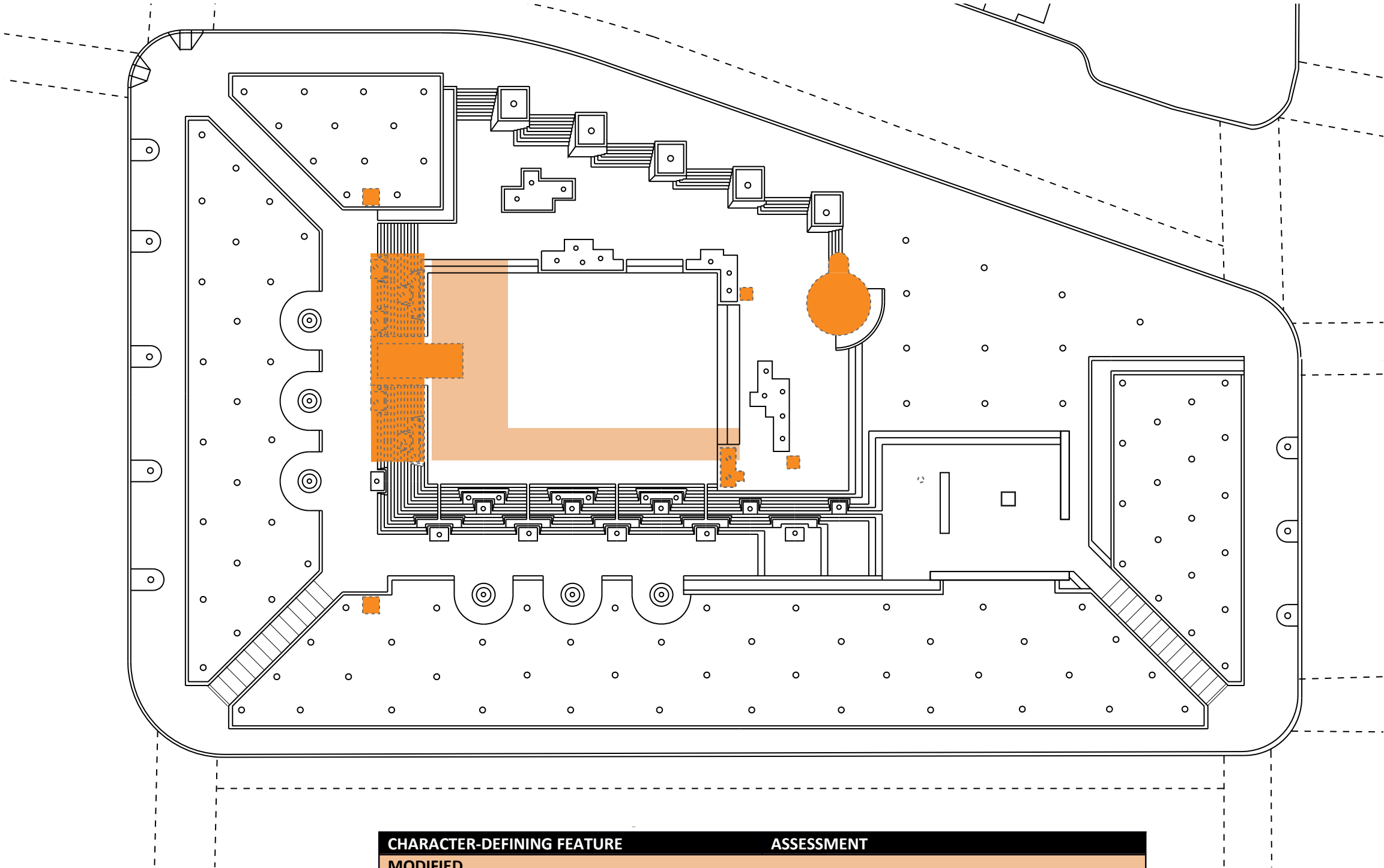

CHARACTER-DEFINING FEATURE	ASSESSMENT
MODIFIED	
Omnidirectional views (sections)	Adverse effect

- Removed
- Modified
- Existing

Note: The name Restored Pool Concept is not intended to reflect the term “restoration” as described in the Secretary of Interior’s Standard for Treatment of Historic Properties



# June 2017 Restored Pool Concept

## Assessment of Effects for Pershing Park: Built Features

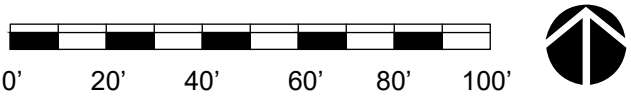

The following built character-defining features would be retained:

- Pershing Memorial granite walls
- Terra-cotta pavers along Pennsylvania
- Avenue and around the northeast bosque of trees
- Square granite flooring of memorial plaza
- Belgian block paving
- Terra-cotta pavers with granite edging creating steps, ramp, and elevated walks
- Semi-circular alcoves

The following built character-defining features would be modified:

- Granite planters in seating areas and along pool
- Granite steps creating amphitheater seating around pool
- Pool basin

The following built character-defining features would be removed:

- Kiosk
- Cascade fountain structure

Note: The name Restored Pool Concept is not intended to reflect the term “restoration” as described in the Secretary of Interior’s Standard for Treatment of Historic Properties

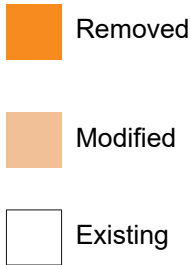
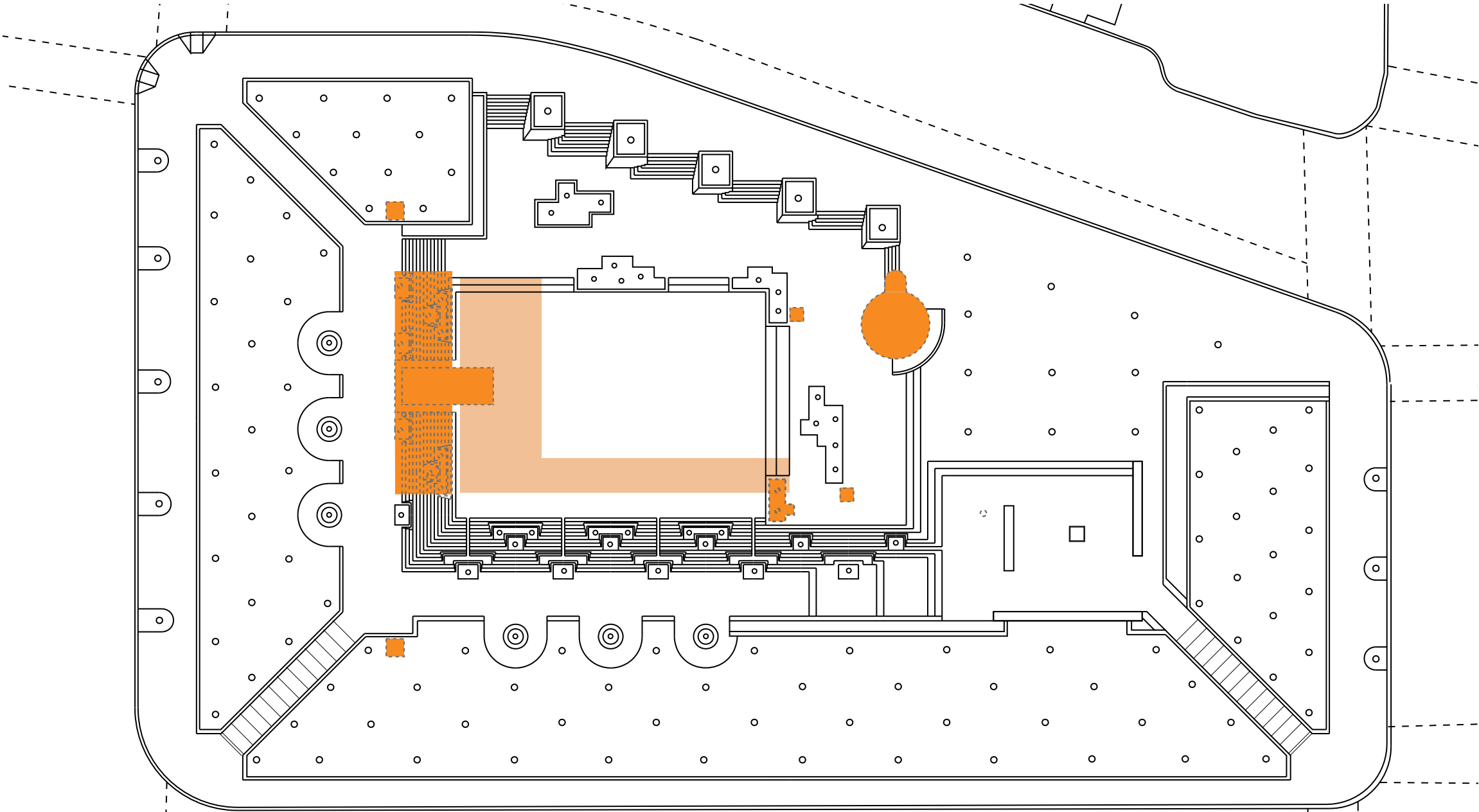

CHARACTER-DEFINING FEATURE		ASSESSMENT
RETAINED		
Pershing Memorial granite walls		No adverse effect
Terra-cotta pavers		No adverse effect
Memorial plaza granite flooring		No adverse effect
Belgian block paving		No adverse effect
Semi-circular alcoves		No adverse effect
MODIFIED		
Granite planters		Adverse effect
Granite steps		Adverse effect
Granite cascade pool structure		Adverse effect
REMOVED		
Kiosk and Cascade Fountain Structure		Adverse effect



# June 2017 Restored Pool Concept

## Assessment of Effects for Pershing Park: Water Features

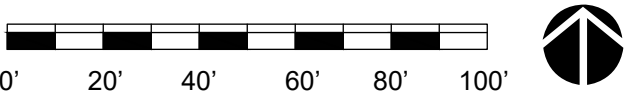

The following water character-defining feature would be modified:



- Pool basin

The following water character-defining feature would be removed:

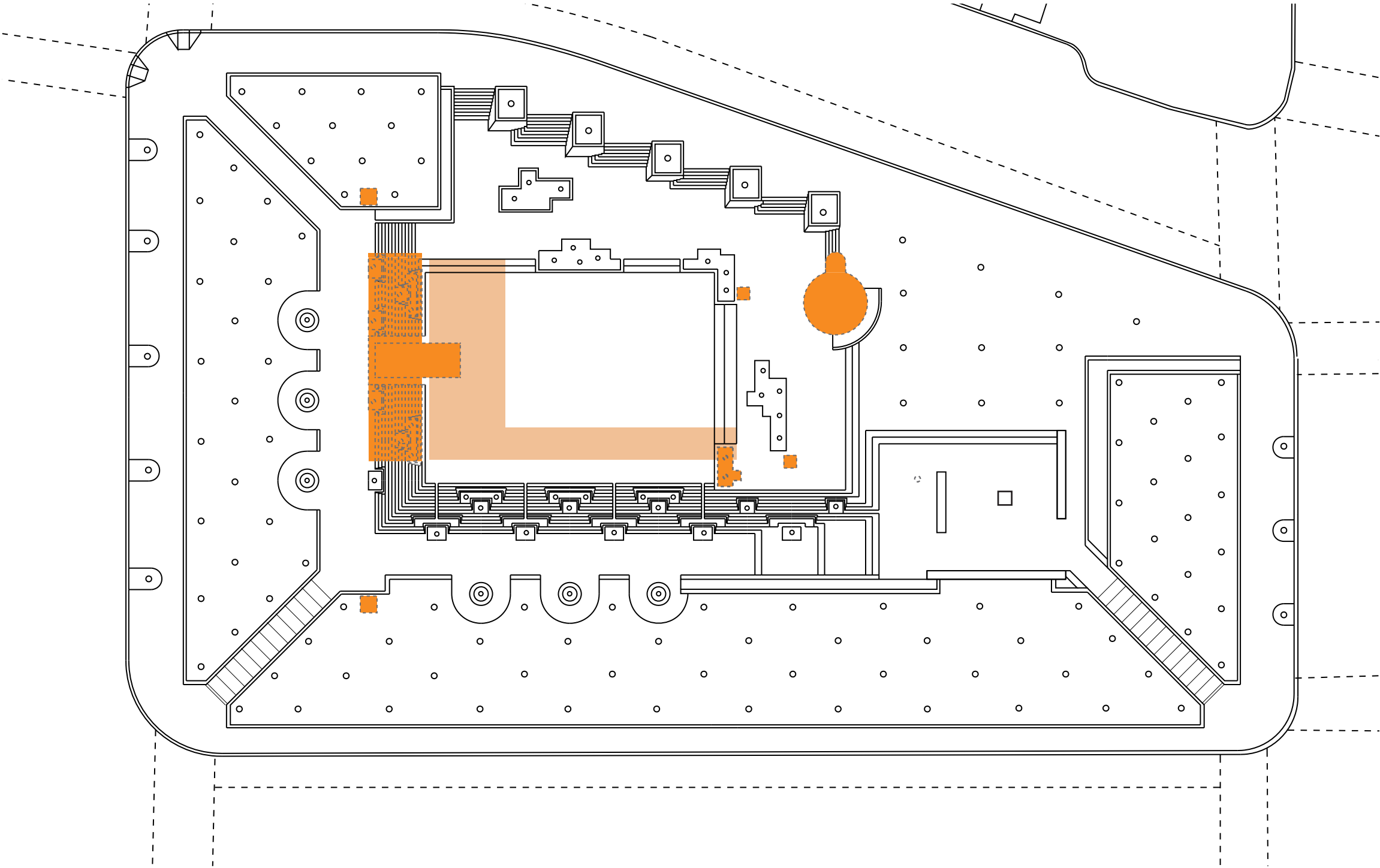
- Cascade fountain structure



Note: The name Restored Pool Concept is not intended to reflect the term “restoration” as described in the Secretary of Interior’s Standard for Treatment of Historic Properties

-  Removed
-  Modified
-  Existing

CHARACTER-DEFINING FEATURE		ASSESSMENT
MODIFIED		
Pool basin		Adverse effect
REMOVED		
Cascade fountain		Adverse effect



# June 2017 Restored Pool Concept

## Assessment of Effects for Pershing Park: Vegetation

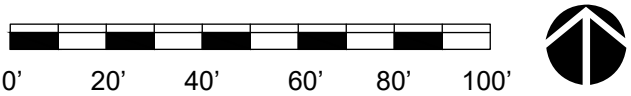

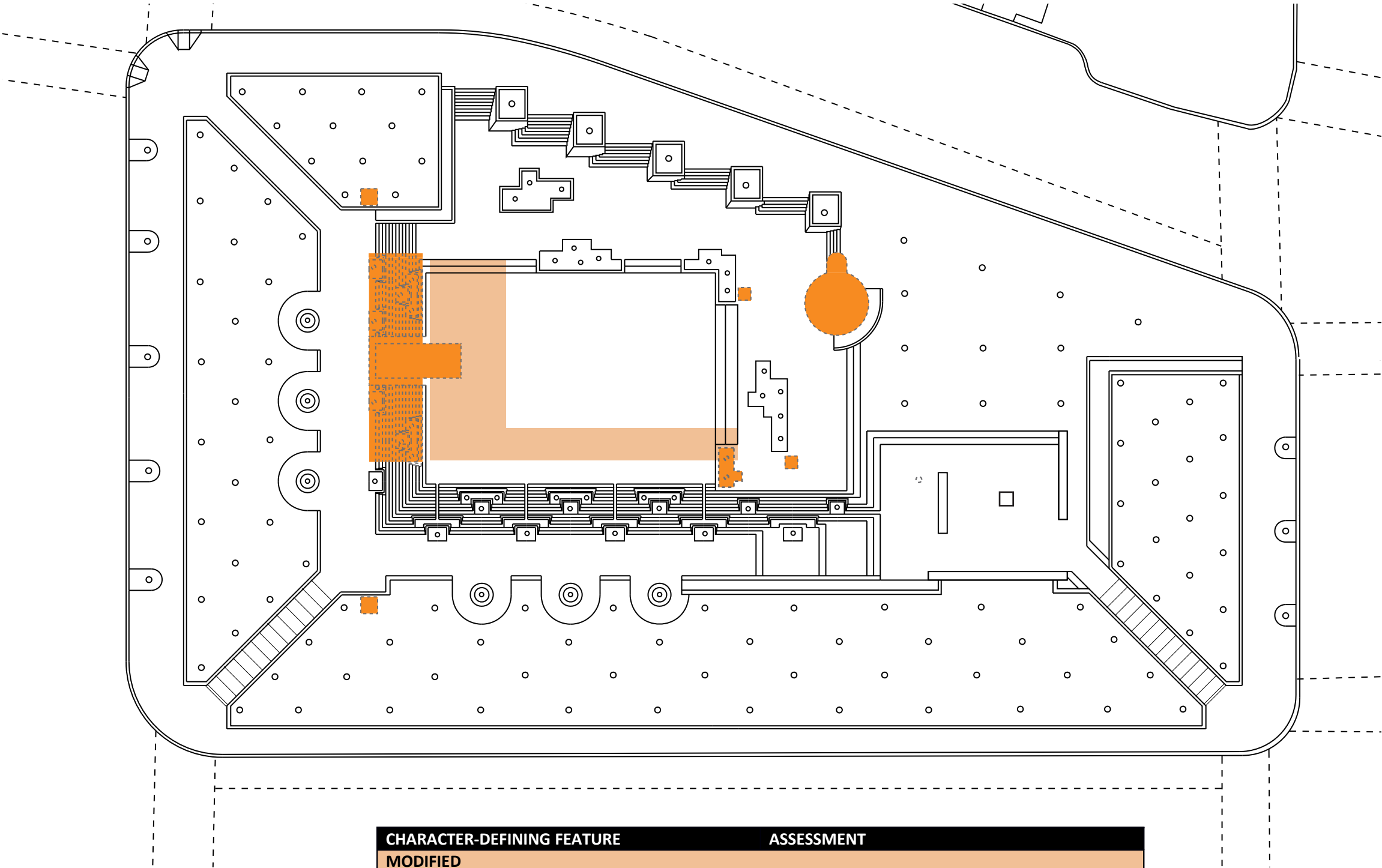

The following vegetation character-defining feature would be modified:

- Honey locust trees over lawn on east, south, and west berms
- Willow oaks above paving at northeast corner
- Willow oaks in planters with English ivy ground cover on north side of pool
- Multi-trunked crape myrtle trees in alcoves
- Multi-trunked crape myrtle and birch trees
- Native and naturalized grasses and perennial flowering



Note: The name Restored Pool Concept is not intended to reflect the term “restoration” as described in the Secretary of Interior’s Standard for Treatment of Historic Properties

-  Removed
-  Modified
-  Existing

CHARACTER-DEFINING FEATURE		ASSESSMENT
MODIFIED		
Honey locust trees over lawn on berms		Likely no adverse effect
Willow oaks above paving at NE corner		Likely no adverse effect
Willow oaks in planters on north side of pool		Likely no adverse effect
Crape myrtle trees in alcoves		Likely no adverse effect
Crape myrtle and birch trees		Likely no adverse effect
Native and naturalized grasses and perennial flowering		Likely no adverse effect



# June 2017 Restored Pool Concept

## Assessment of Effects for Pershing Park: Small Scale Features

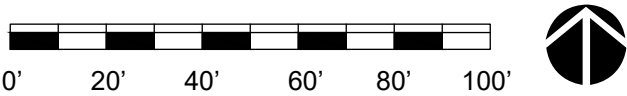

The following small-scale character-defining features would be retained:

- Pershing Memorial statue
- PADC lighting on Pennsylvania Avenue

The following small-scale character-defining features would be removed:

- Drinking fountain
- Granite trash can enclosures

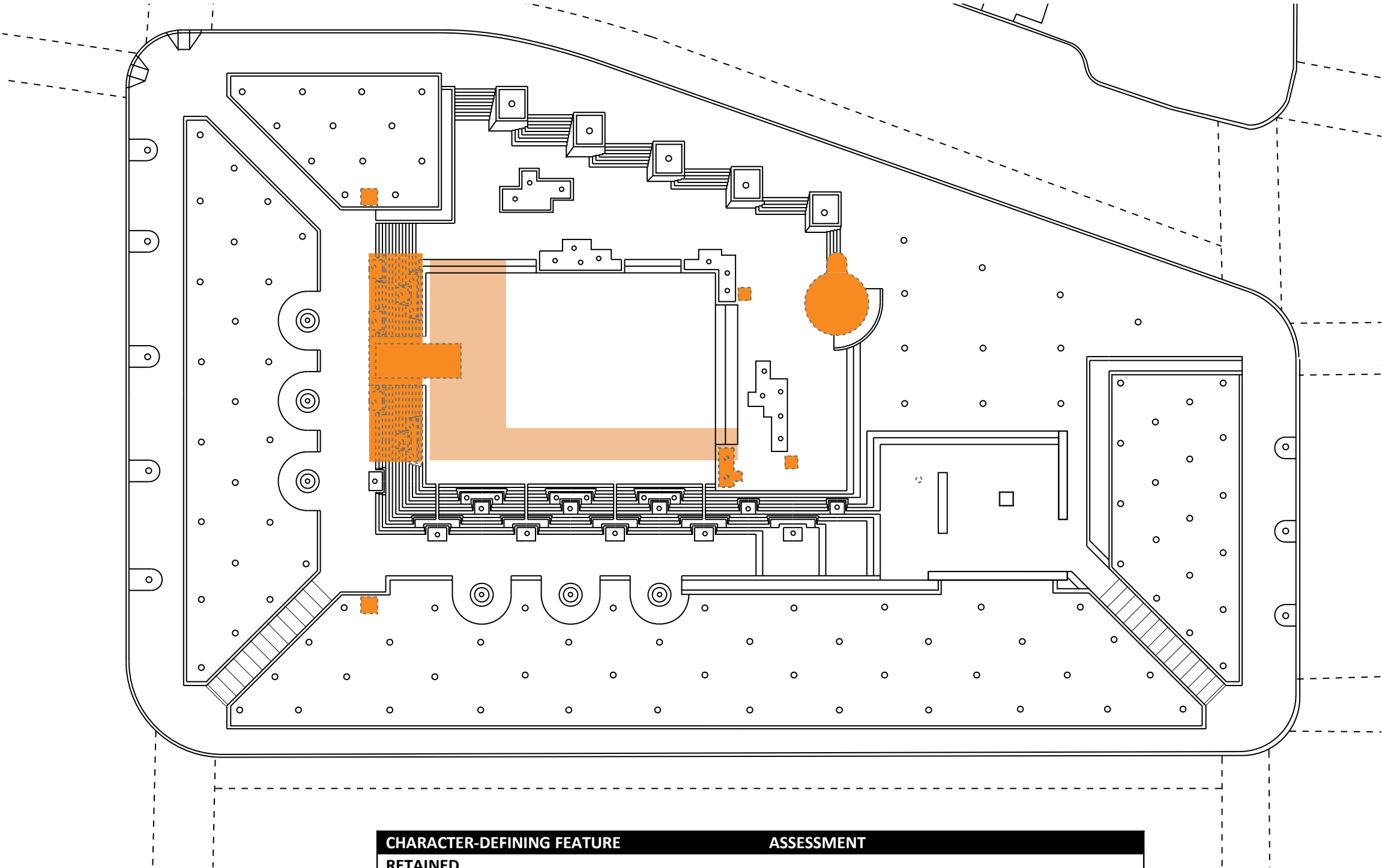

Note: The name Restored Pool Concept is not intended to reflect the term “restoration” as described in the Secretary of Interior’s Standard for Treatment of Historic Properties

- Removed
- Modified
- Existing

CHARACTER-DEFINING FEATURE	ASSESSMENT
RETAINED	
Pershing Memorial statue	No adverse effect
PADC lighting	No adverse effect
REMOVED	
Drinking fountain	No adverse effect
Granite trash can enclosures	No adverse effect



# Balancing Preservation and Commemoration

## Design Iterations

- Incremental explorations of commemoration starting with minimal changes to existing park
- Iterative process facilitates evaluation of level of modification required to achieve commemorative purpose
- Effort to protect and maintain critical character defining features, according to Secretary of the Interior’s Standards for the Treatment of Historic Properties with Guidelines for Treatment of Cultural Landscapes:
  - Views and vistas
  - Spatial organization
  - Pershing Memorial
  - PADC streetscape
  - Terraced seating and planters
  - Granite materials
  - Distinct rooms bounded by steps
  - Three focal points
  - Water cascade, including sound

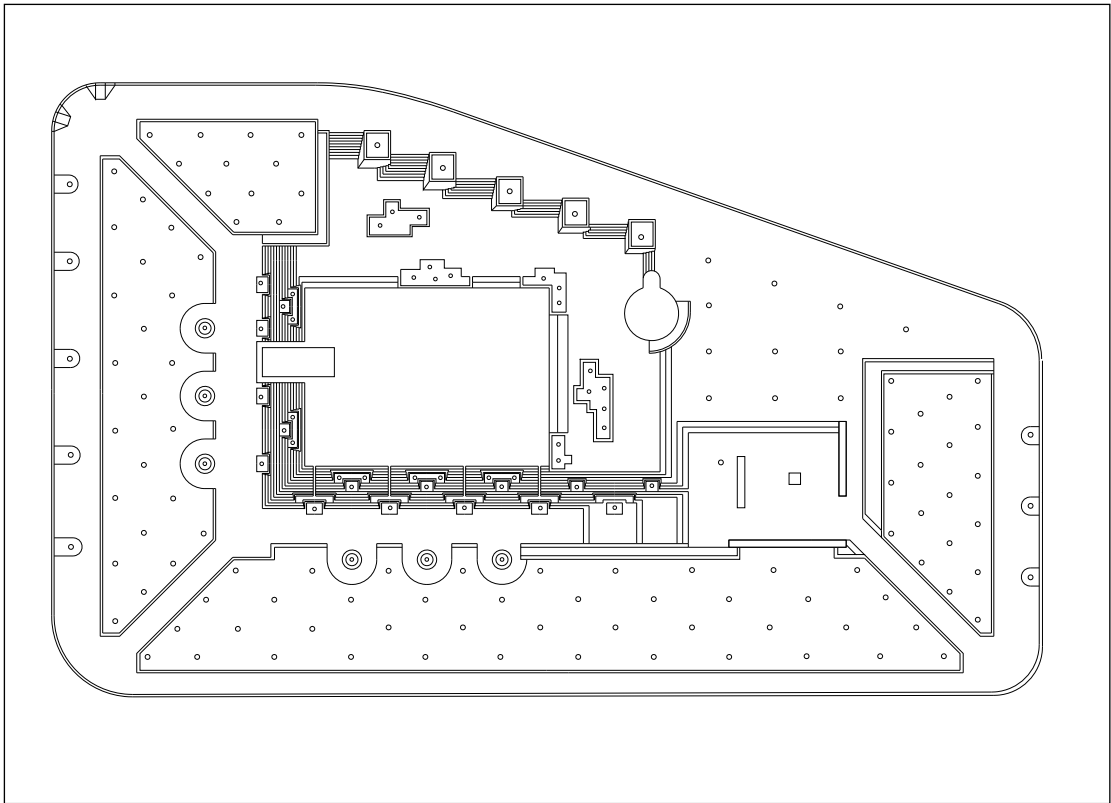

EXISTING PARK DESIGN

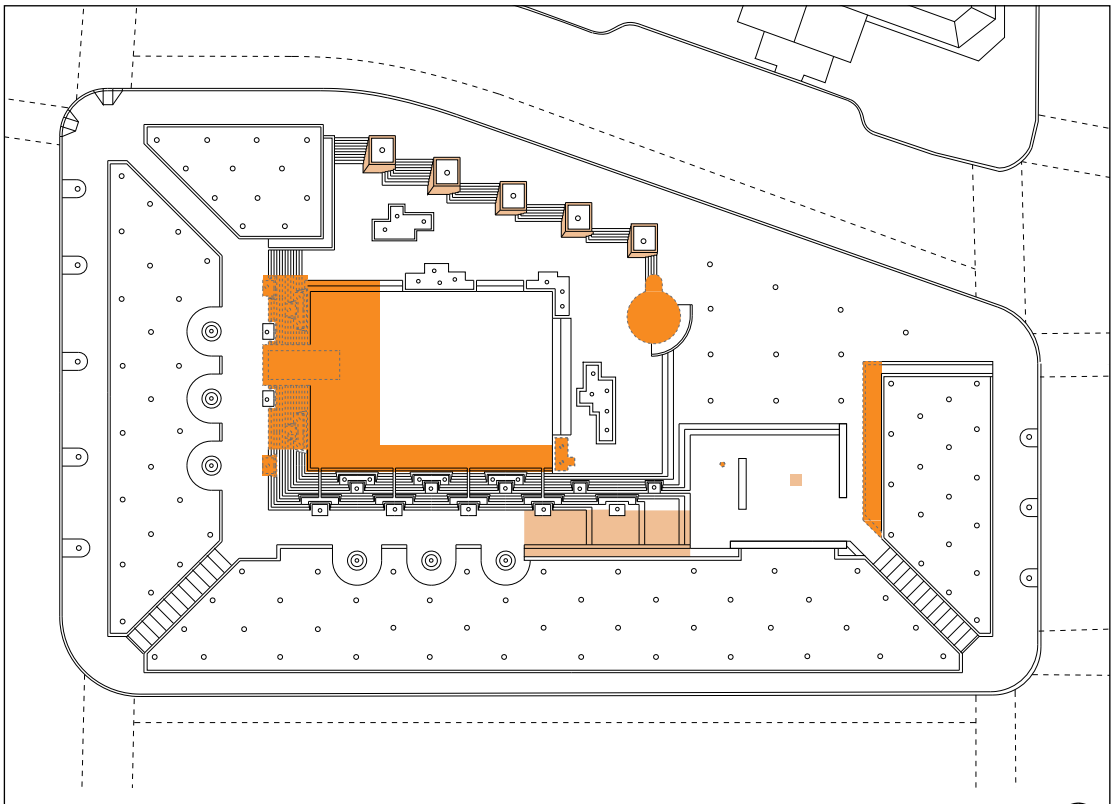

POOL AND PLAZA CONCEPT - FEBRUARY 2017

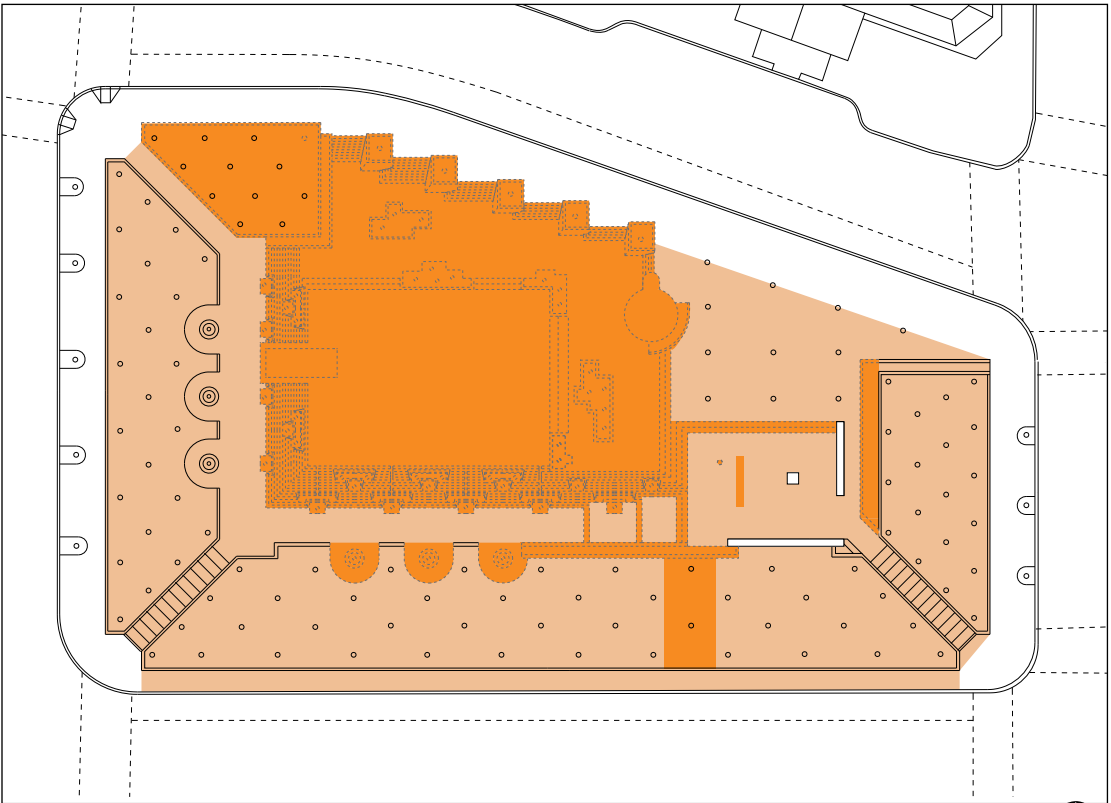

OCTOBER 2016 CONCEPT

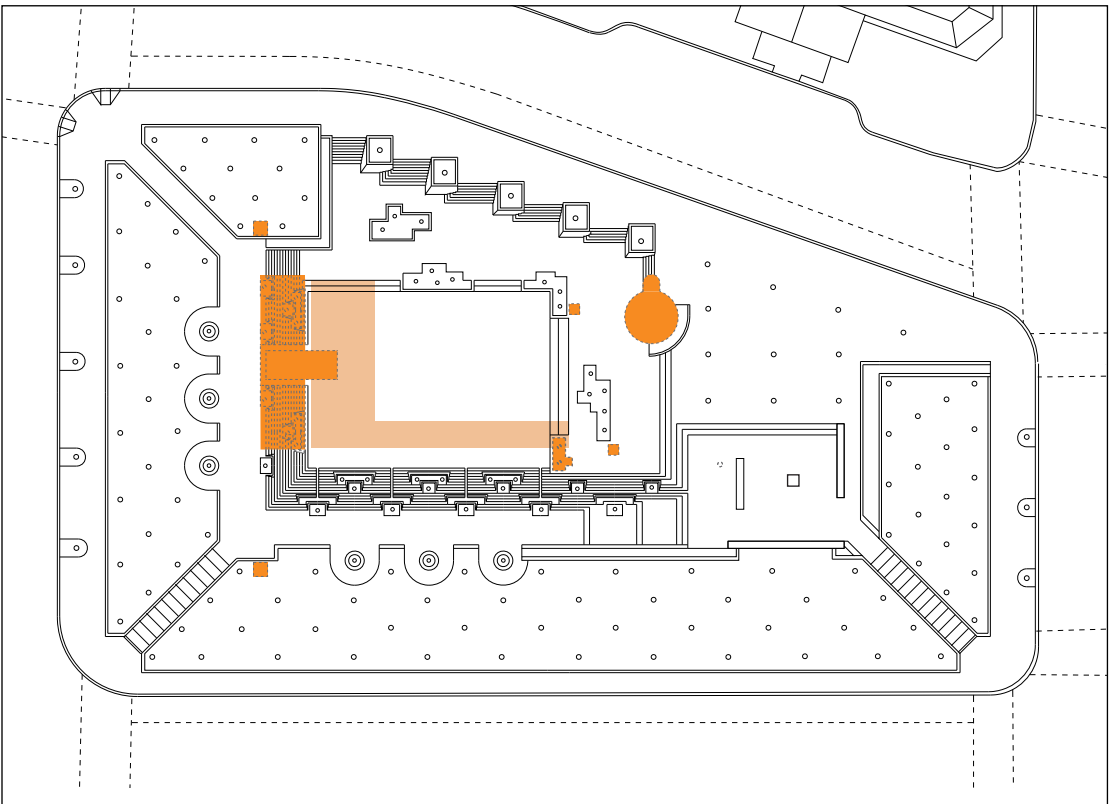

RESTORED POOL CONCEPT



## Next Steps

- Receive comments from National Capital Planning Commission (July 13, 2017)
- Development Assessment of Effects
- Identify Potential Mitigation Measures



# Concept Comparisons

## Sections

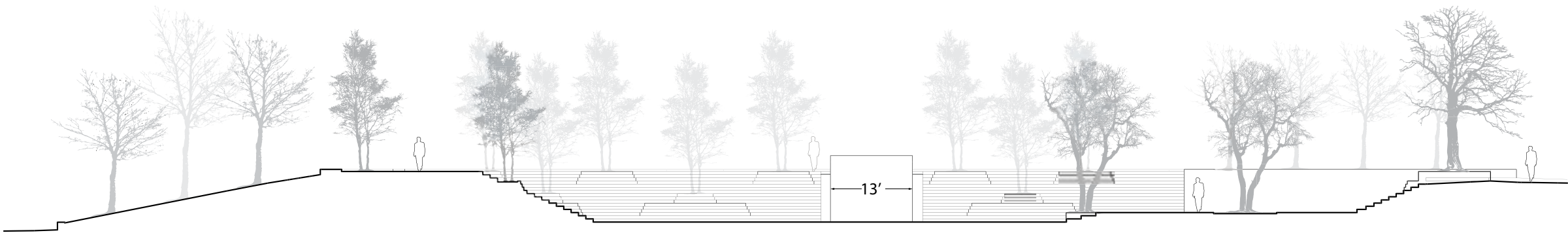

Existing section facing West

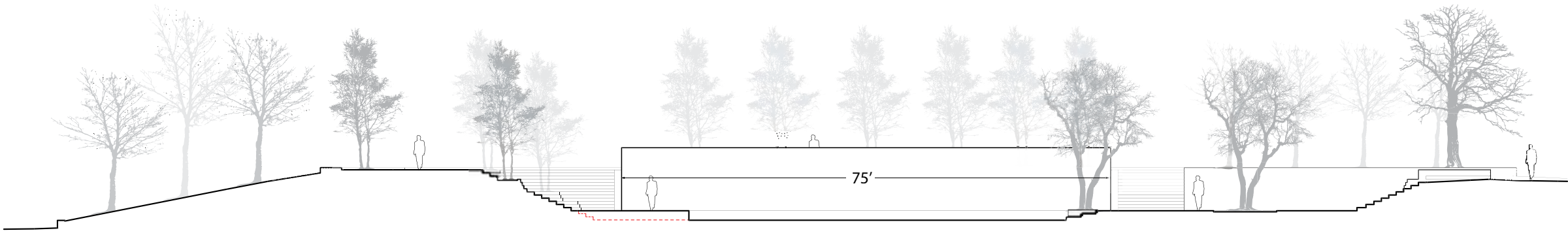

Pool and Plaza Concept section facing West

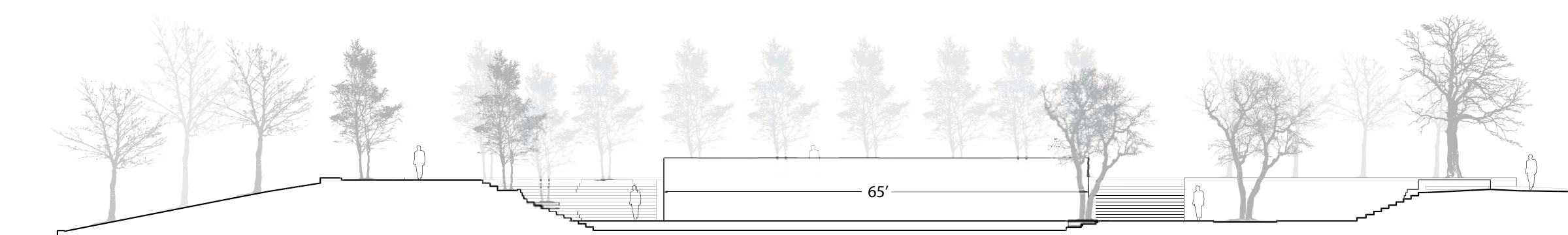

Restored Pool Concept section facing West

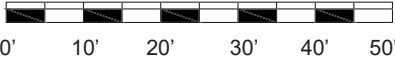



# Concept Comparisons

## Sections

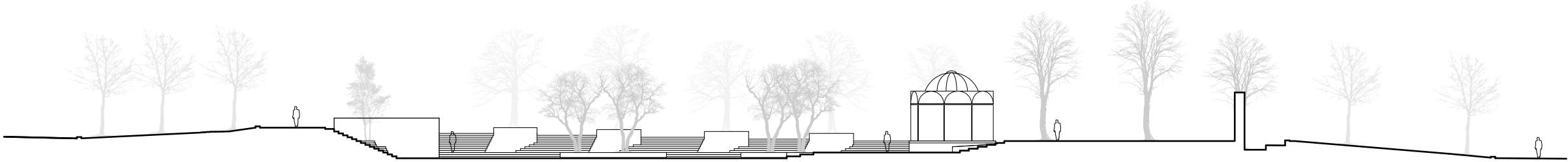

Existing section facing North

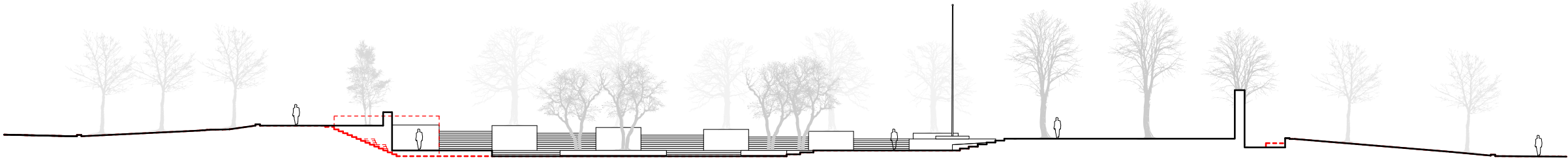

Pool and Plaza Concept section facing North

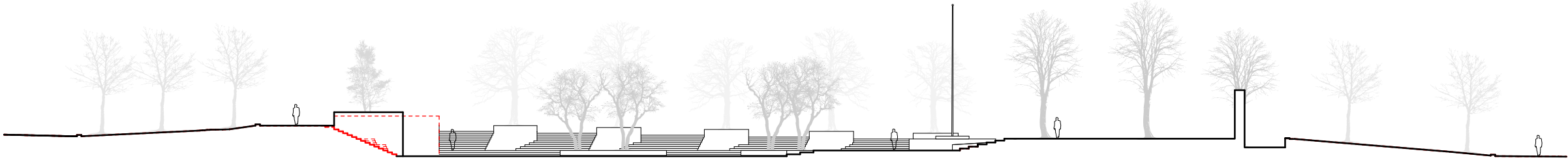

Restored Pool Concept section facing North

