



plaza from the northeast in the evening

PLAZA TO A FORGOTTEN WAR

U.S. NATIONAL WORLD WAR I MEMORIAL

The Plaza to a Forgotten War is a memorial and urban park dedicated to the heroic sacrifices made by Americans during World War I. An expansive, linear field of inground fiber-optic lights fills the center of the site, forming a dense and seemingly endless grid of illuminated markers that conveys the staggering scale of losses endured. Sculptural cast-bronze pillars march down the field of lights, their weathering skins carrying milled imagery of the novel war machines that rendered this conflict so unprecedentedly destructive. The bronze pillars support precious, cast-glass monoliths, their translucent surfaces inscribed with intimate letters from servicemen and women torn between hope and despair. Linear benches provide visitors a place of contemplation, inviting them to rest and share in a collective sense of remembrance. Allées of Pin Oaks bracket the granite-paved plaza and provide shade, leading to a small grove next to the restored Pershing Memorial where the General solemnly stands watch over the field of lights. Evoking the rolling battlefields of Europe, sloped meadows embrace the plaza's perimeter like clasping hands, creating a soft, undulating buffer that bursts into a sea of crimson poppies every spring. Acting as an informal counterpoint to the strict formality of the memorial itself, the northern half of the site transforms into a great lawn bordered by the mature trees of Pennsylvania Avenue, a greenspace offering visual repose designed for recreation and programmed events. The site's landscape features weave together the carefully choreographed layers of meaning, creating an inviting and sustainable urban park that devotedly holds onto the memory of a momentous war while accommodating the vibrancy of contemporary life — a dignified memorial plaza that faithfully upholds Washington's distinguished legacy of monuments paying tribute to our nation's unsung heroes.

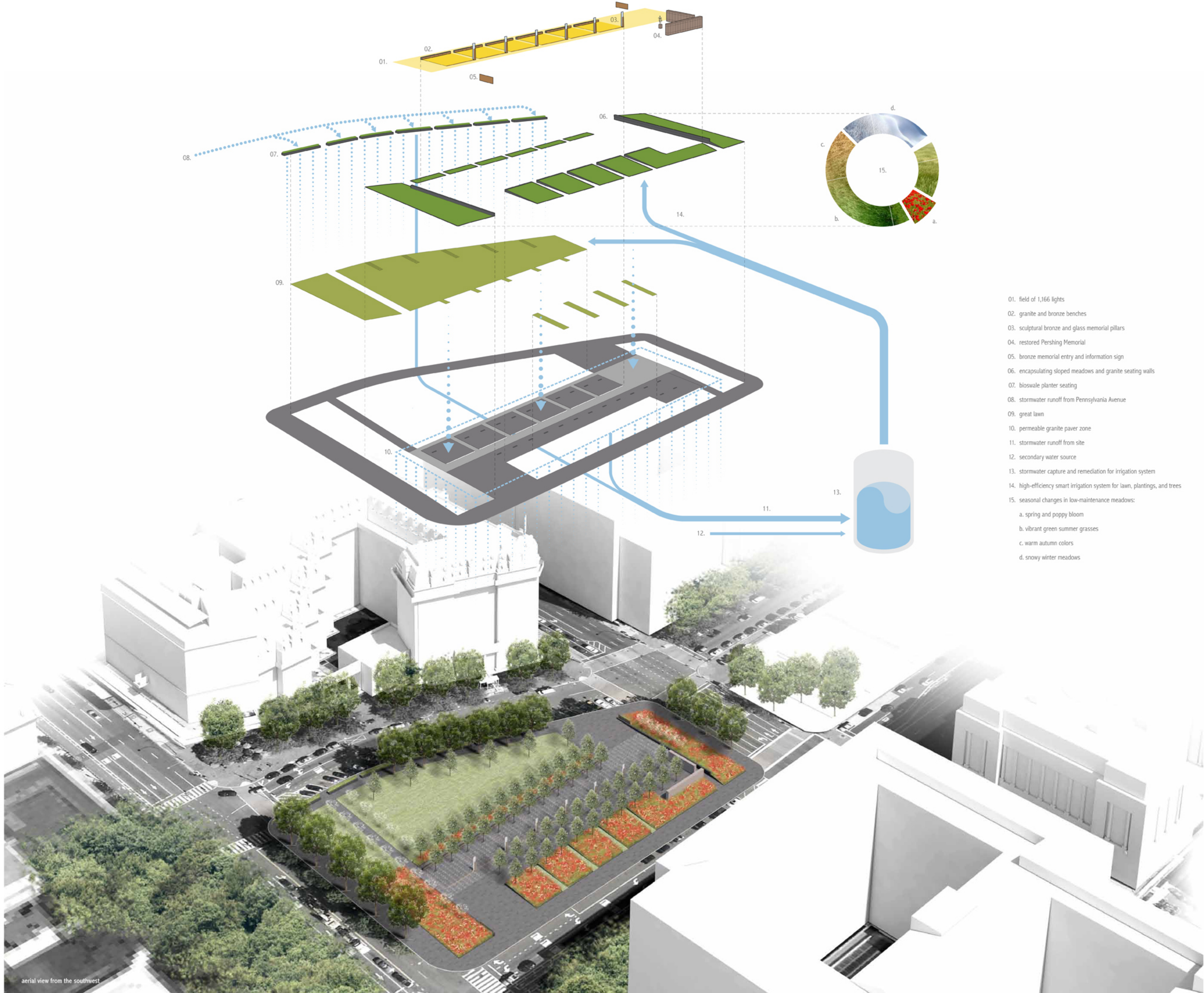

aerial view from the southwest

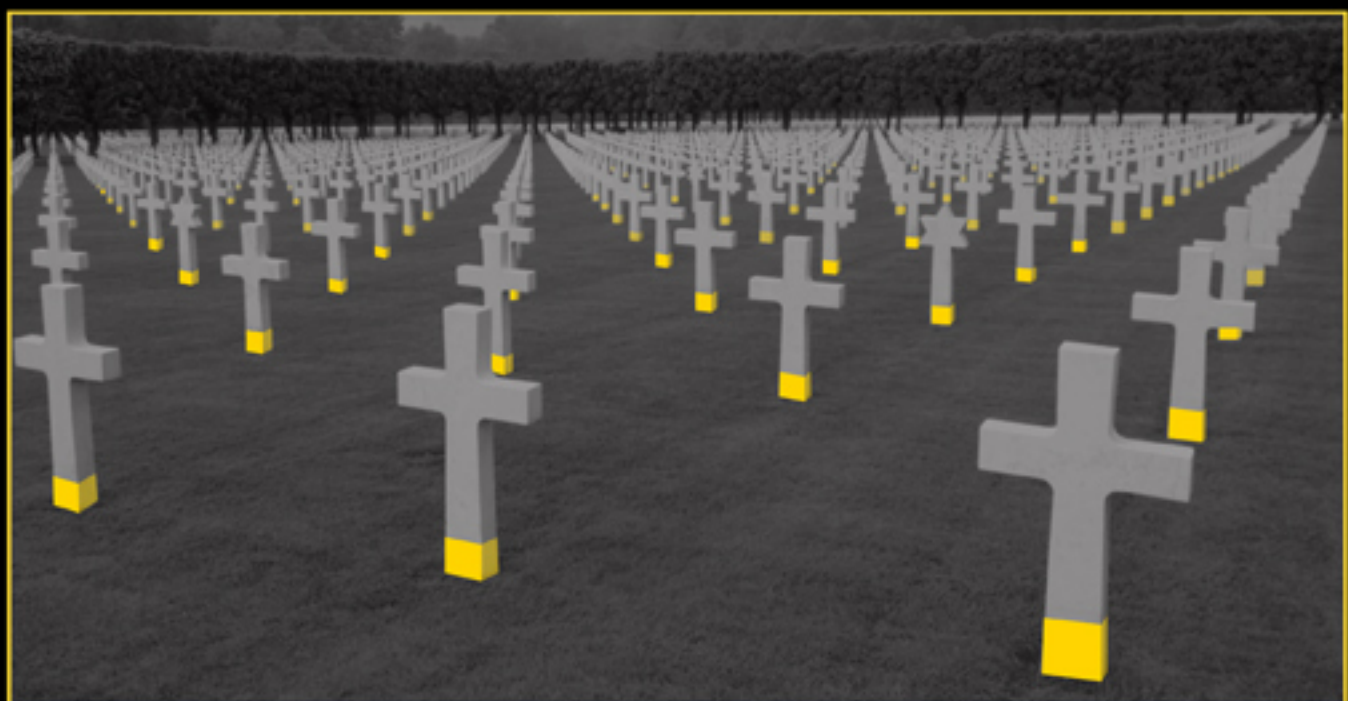

conceptual inspiration: expansive grid of an American military cemetery in Europe

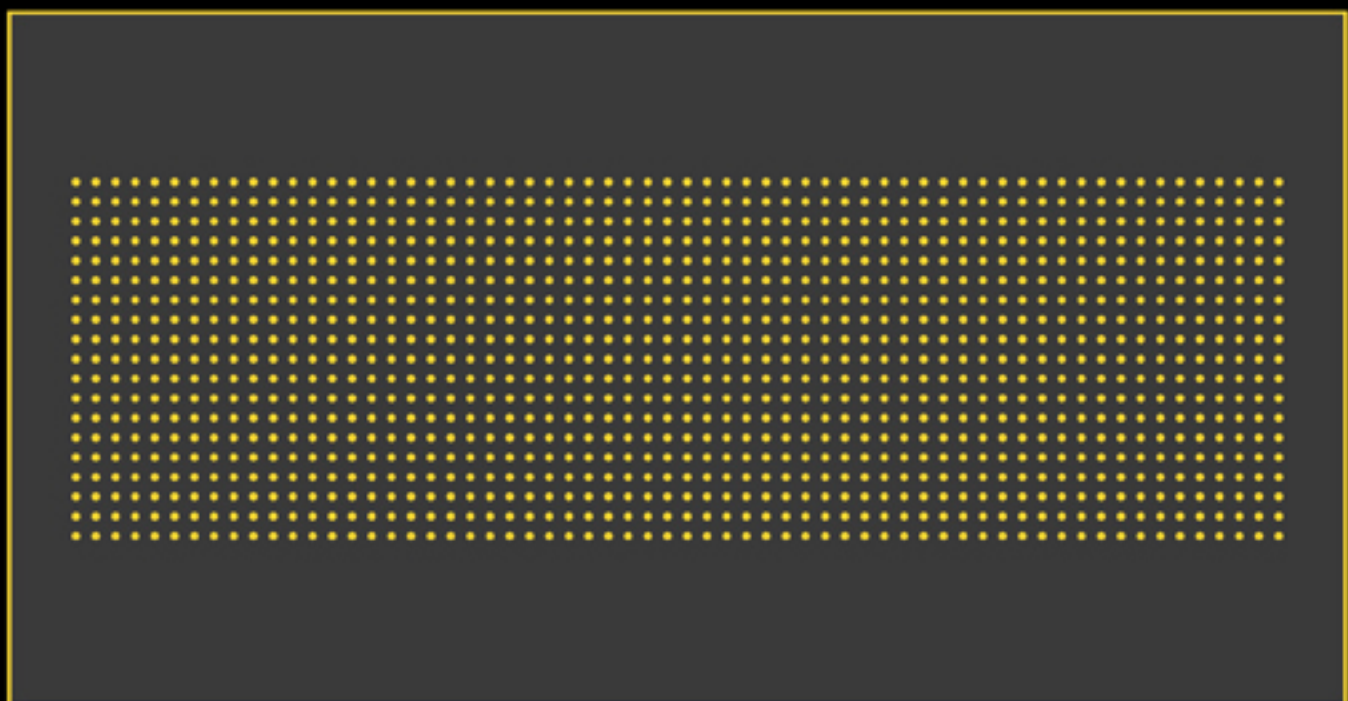

memorial concept: abstract field of lights

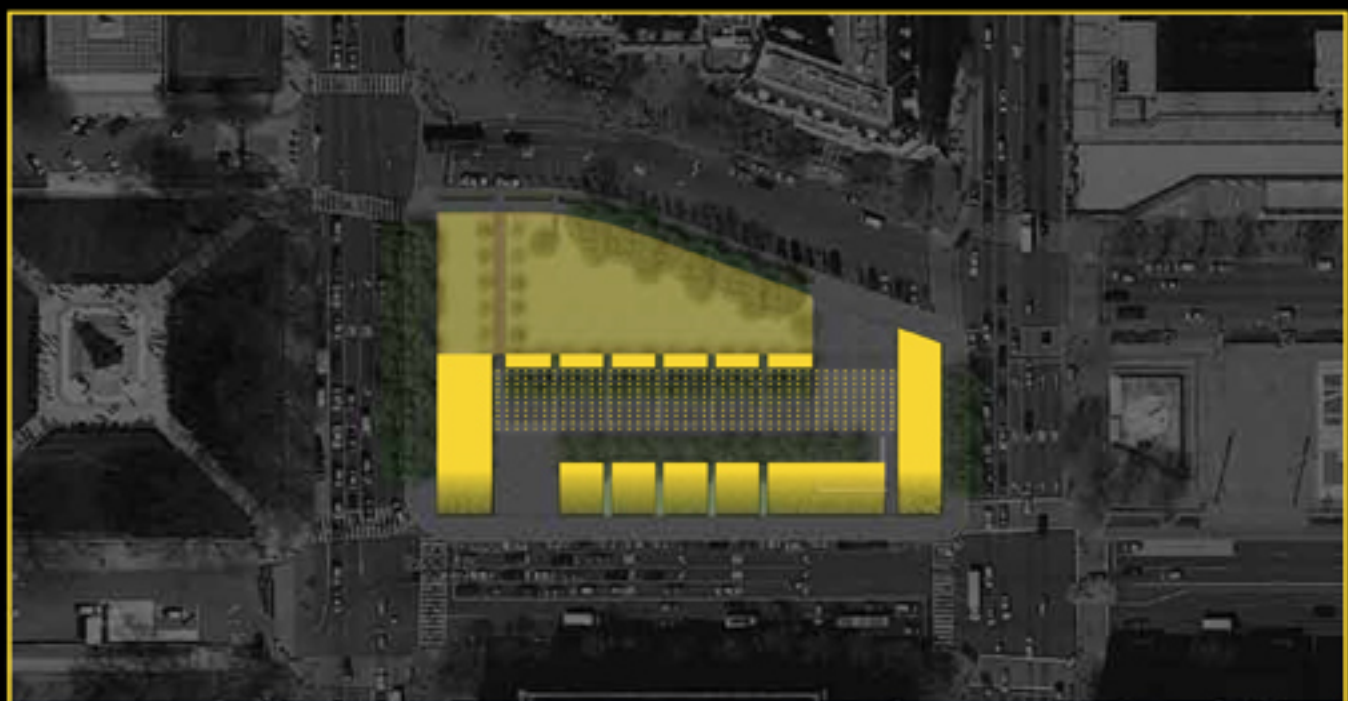

projection on site: field of 1,166 lights (one per hundred lives lost) embraced by sloping meadows

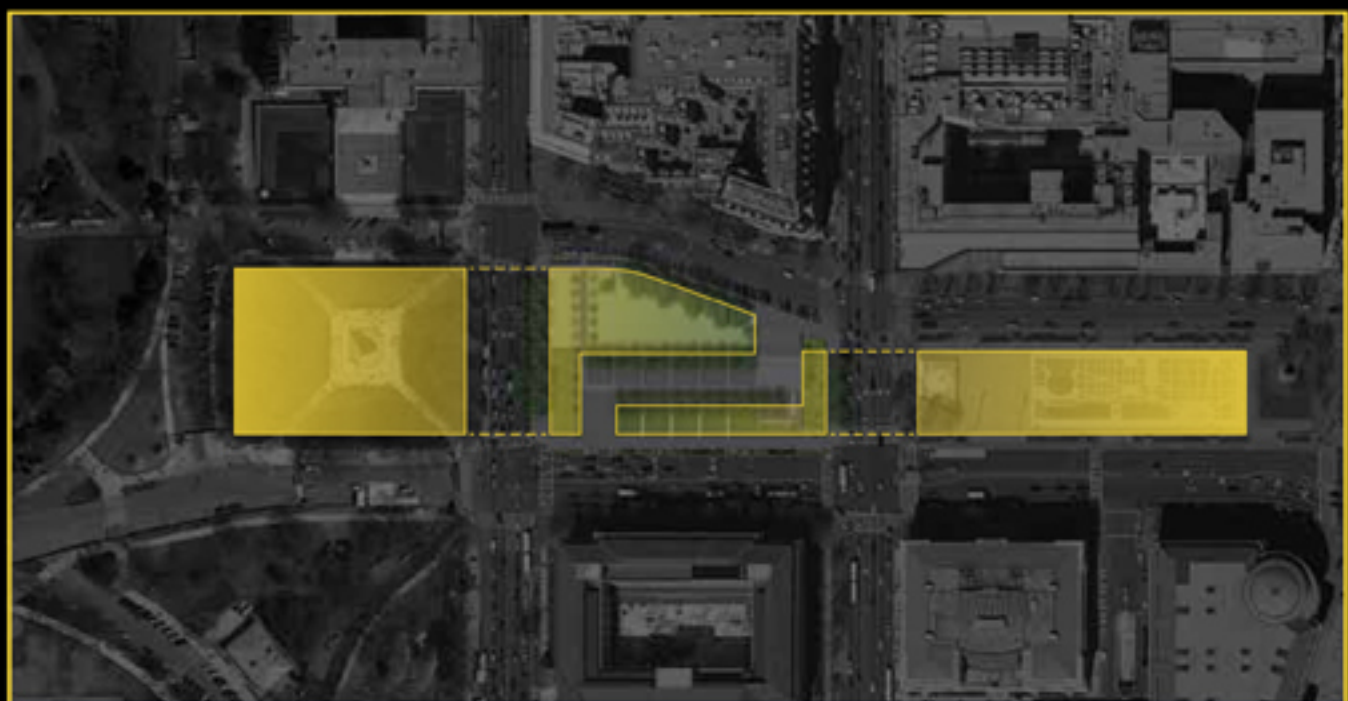

site in context: response to adjacent public spaces



Pershing Memorial from the southeast in autumn

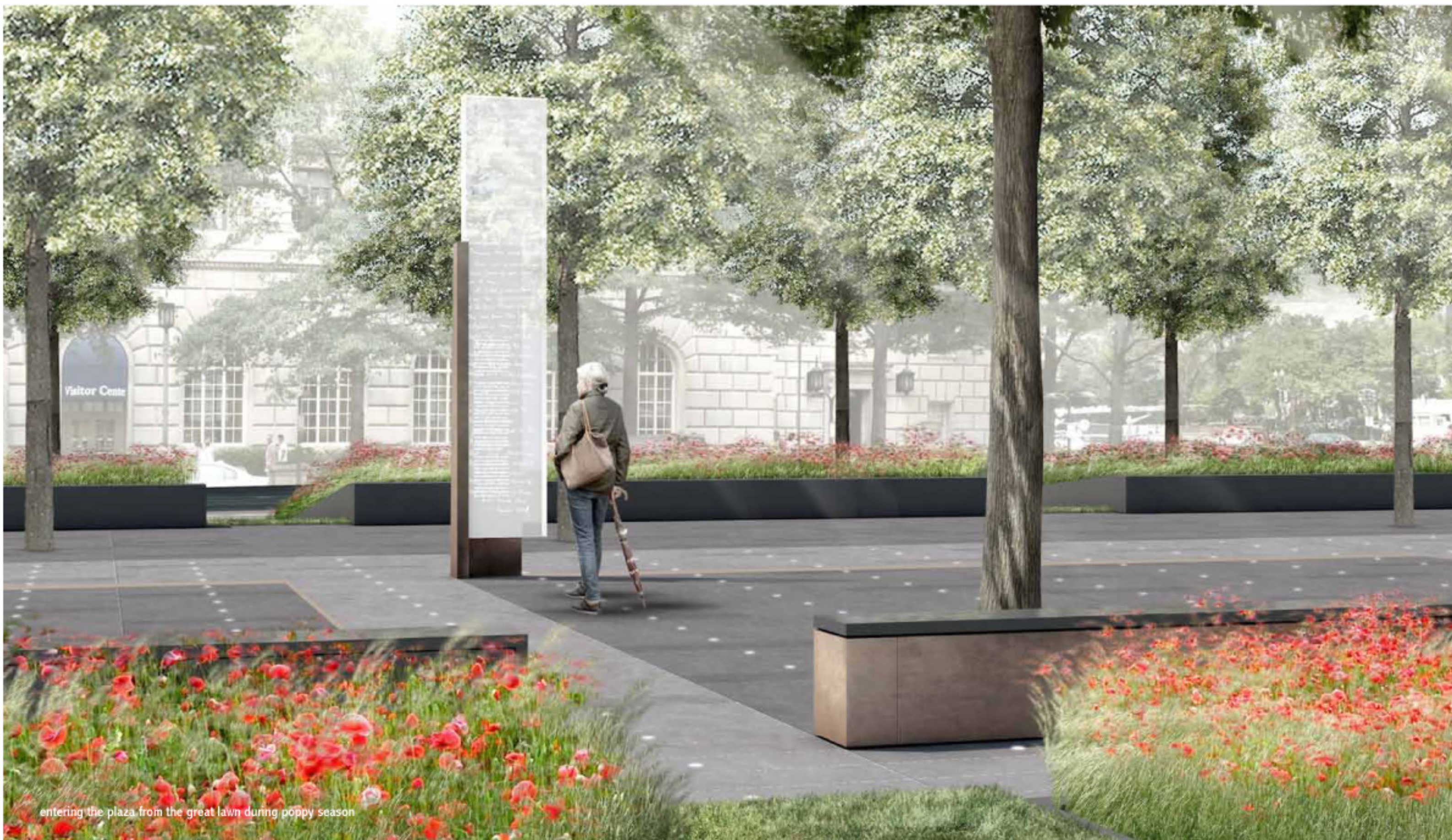
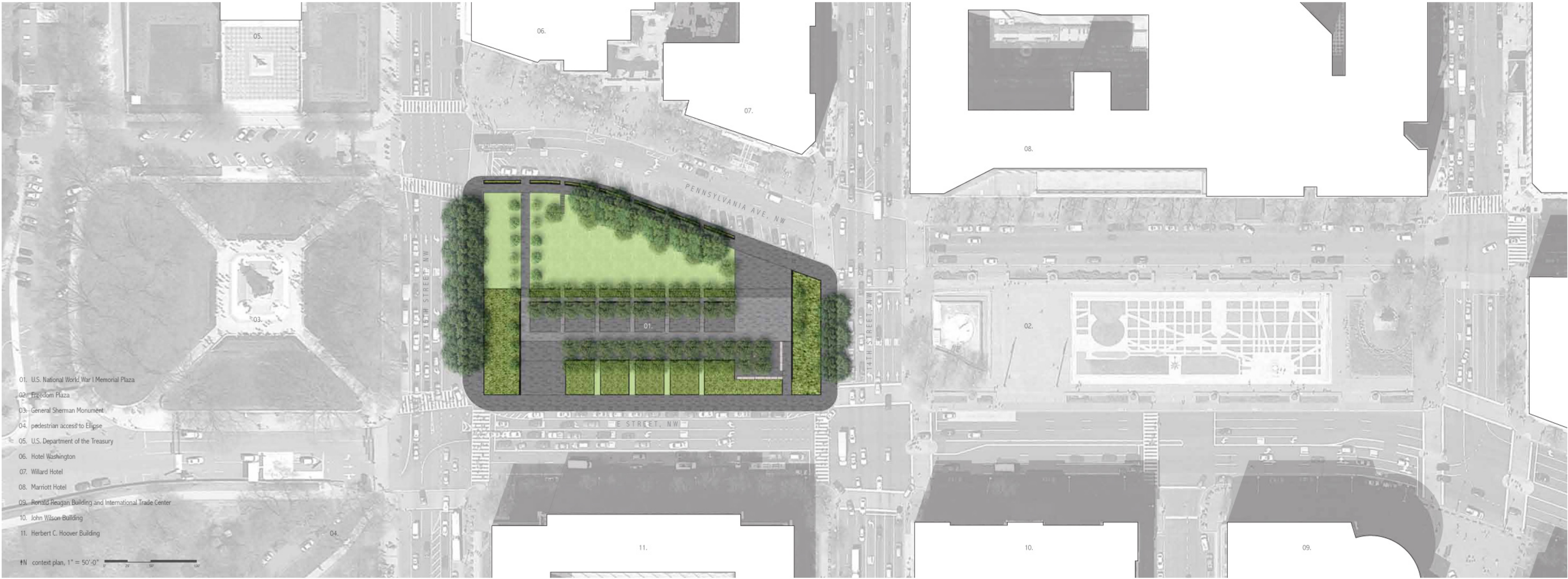

perspective view of the plaza from the great lawn during peony season



perspective view of the plaza from south-sloping meadows on a summer afternoon

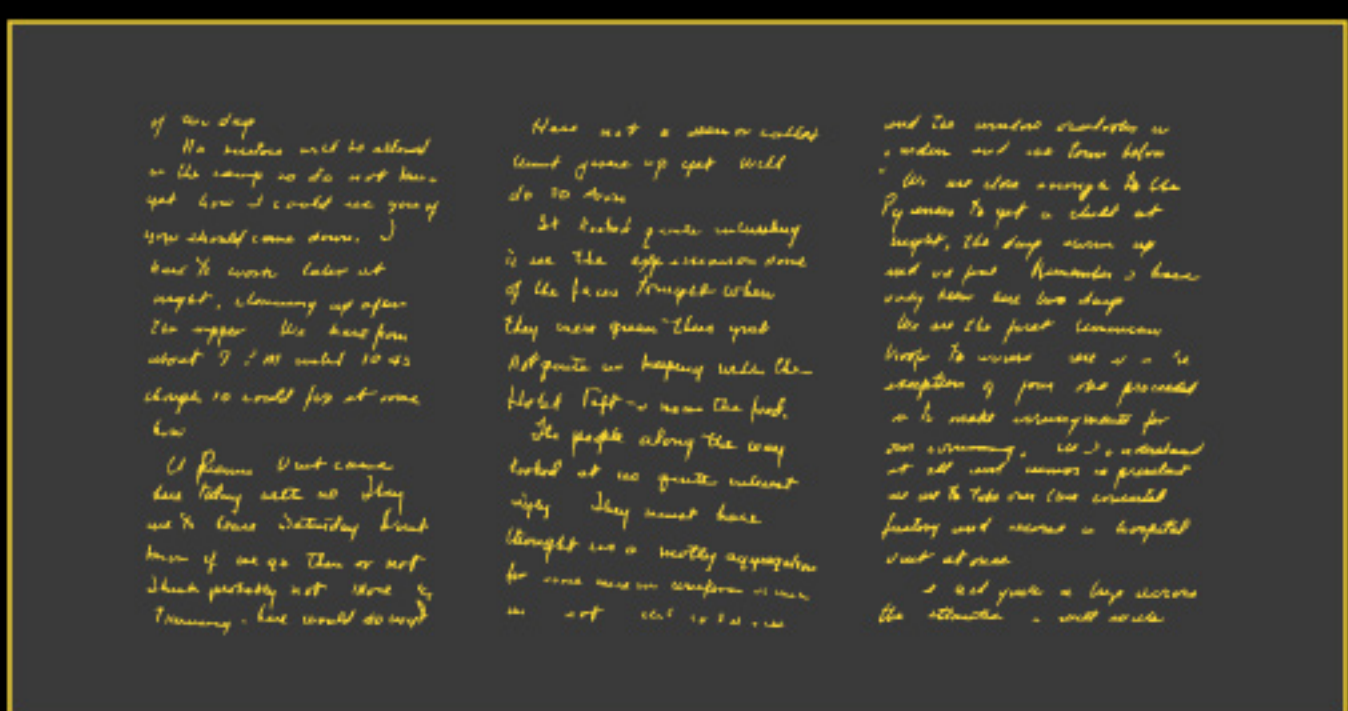

humanizing the war: handwritten letters from servicemen and women etched onto glass monoliths

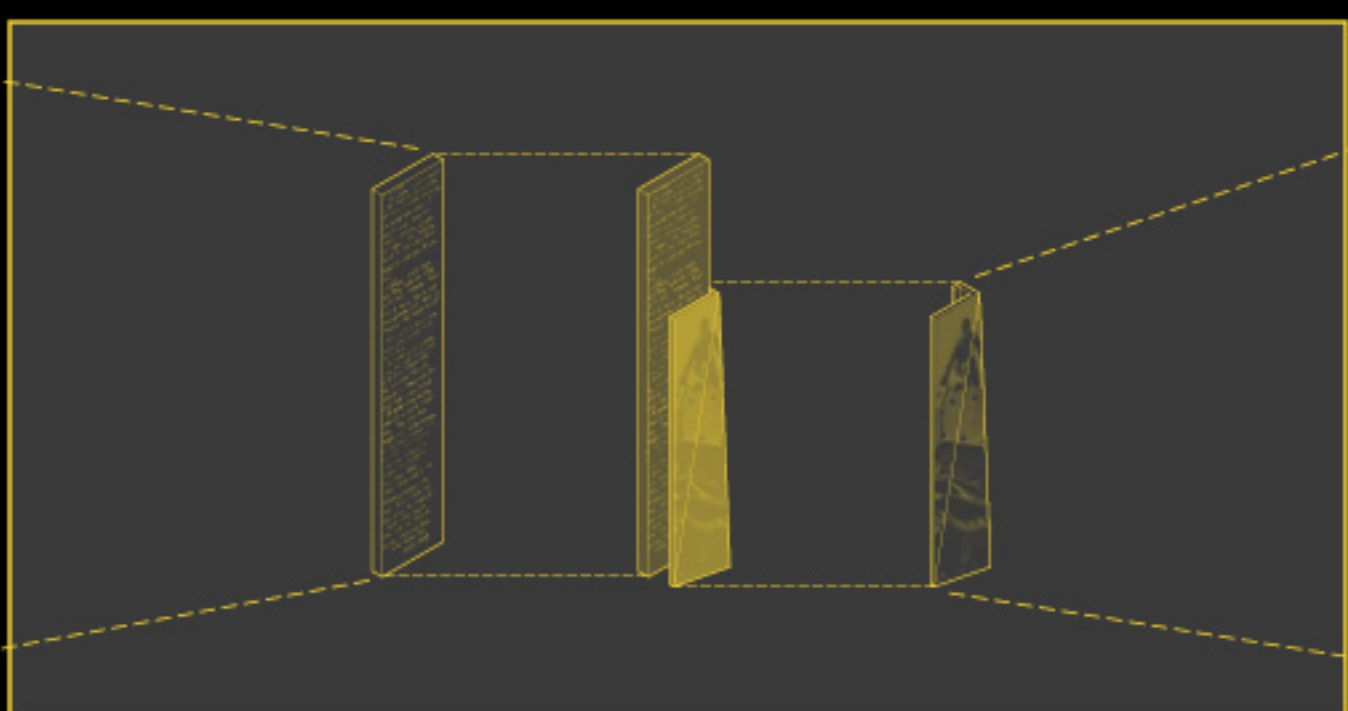

assembly: pillar components representing the fragility of life and the destructive machines of war



conveying devastation: war machine photographs milled onto cast bronze bases

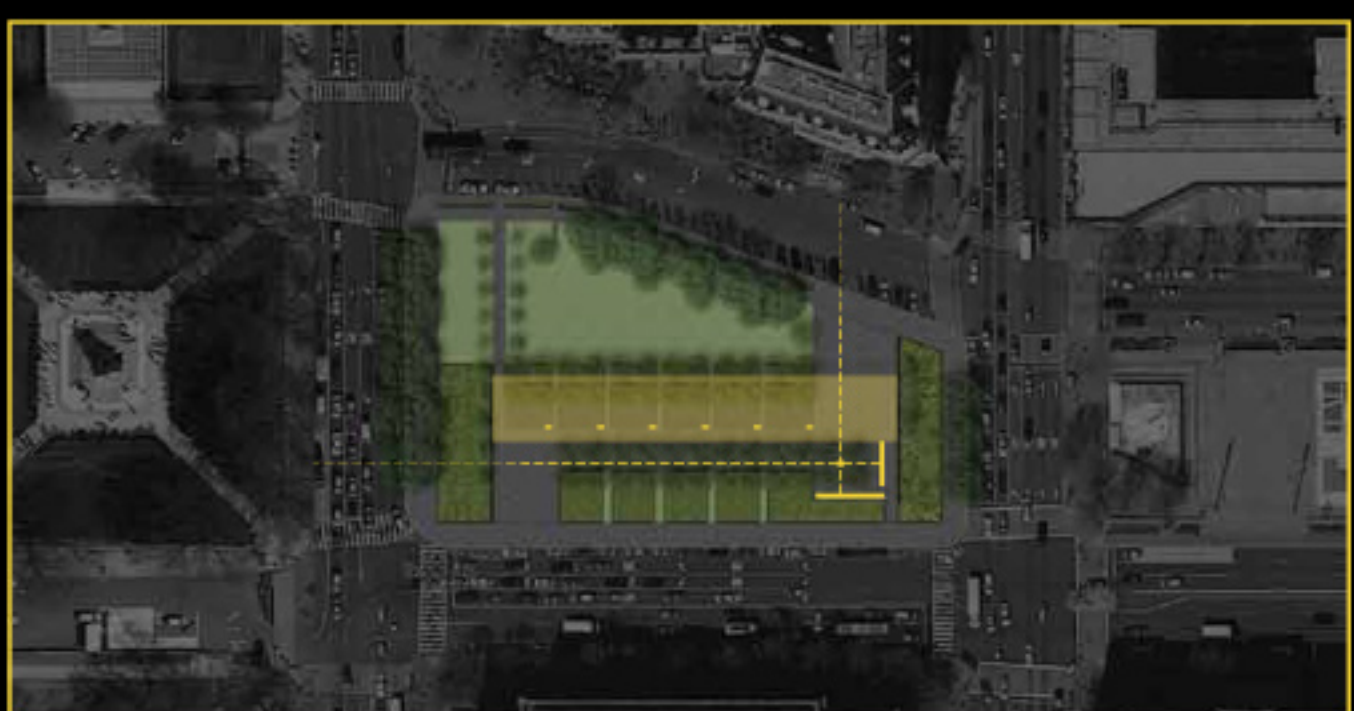

integration: Pershing Memorial location relative to new memorial features and main plaza entry points

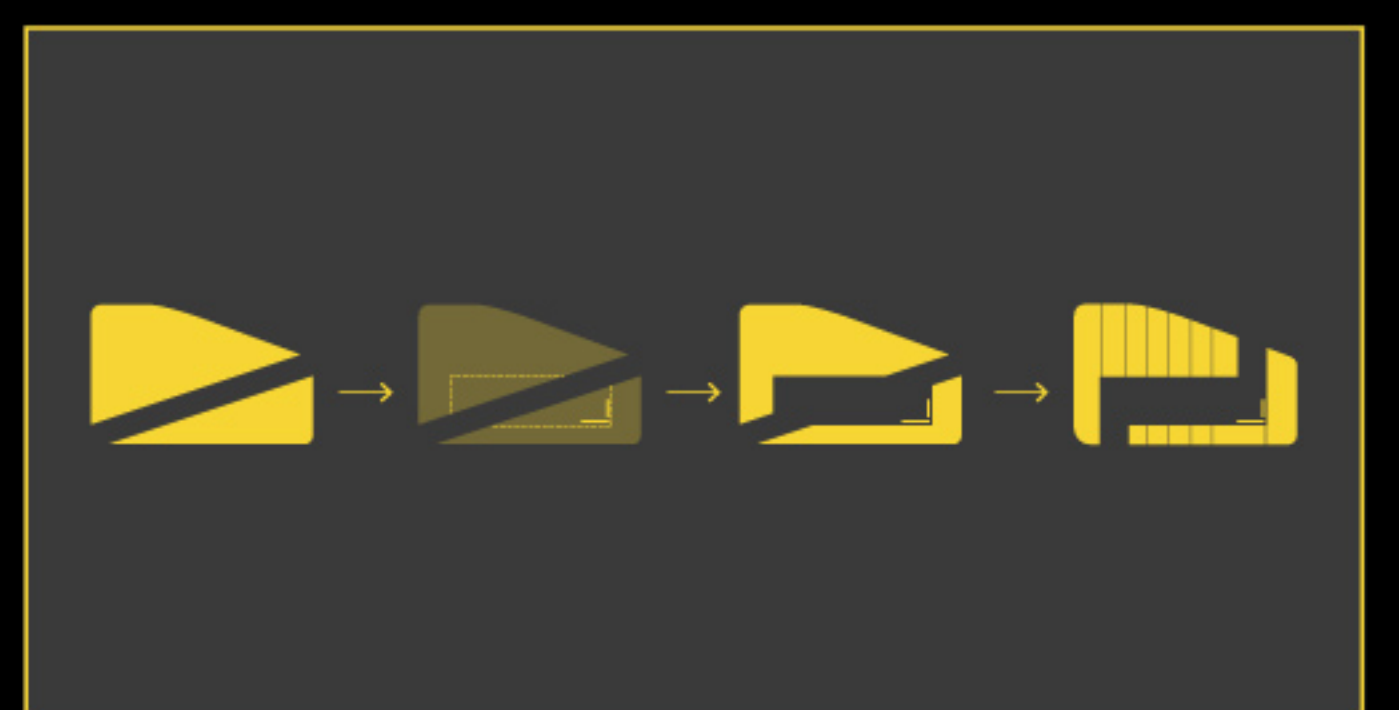
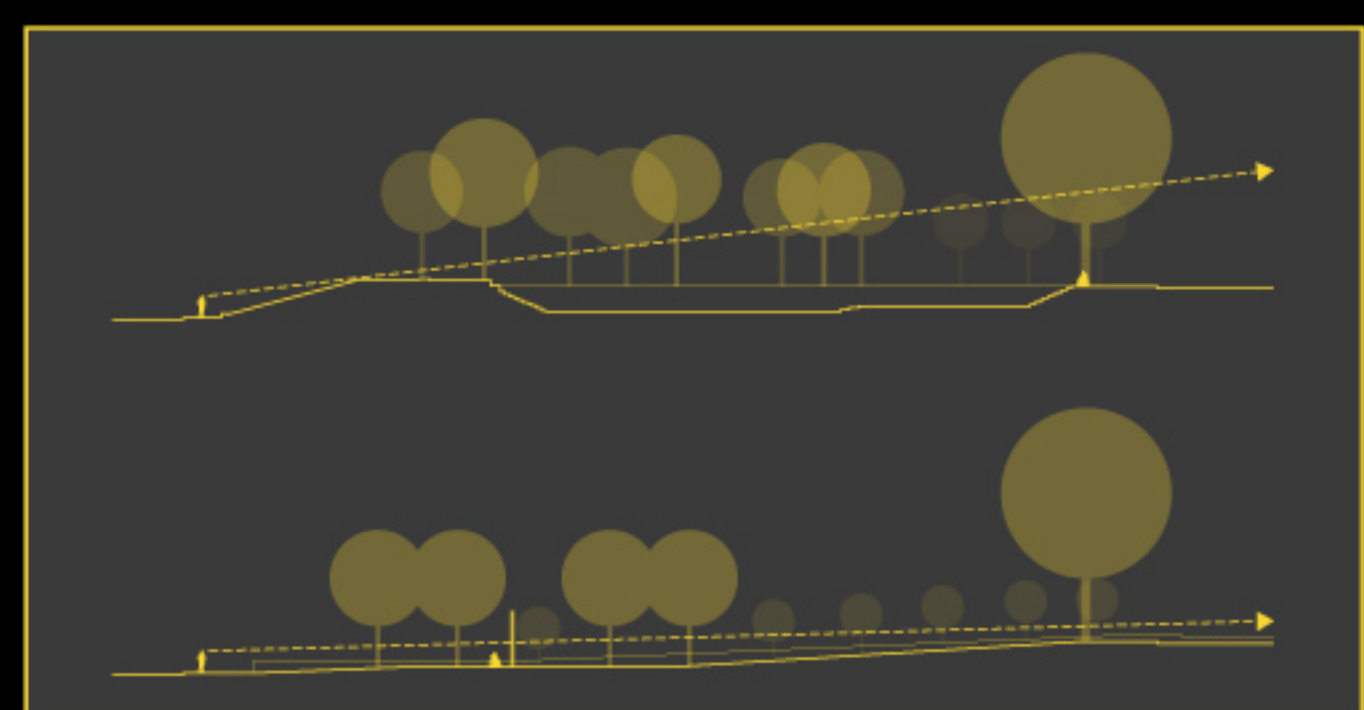
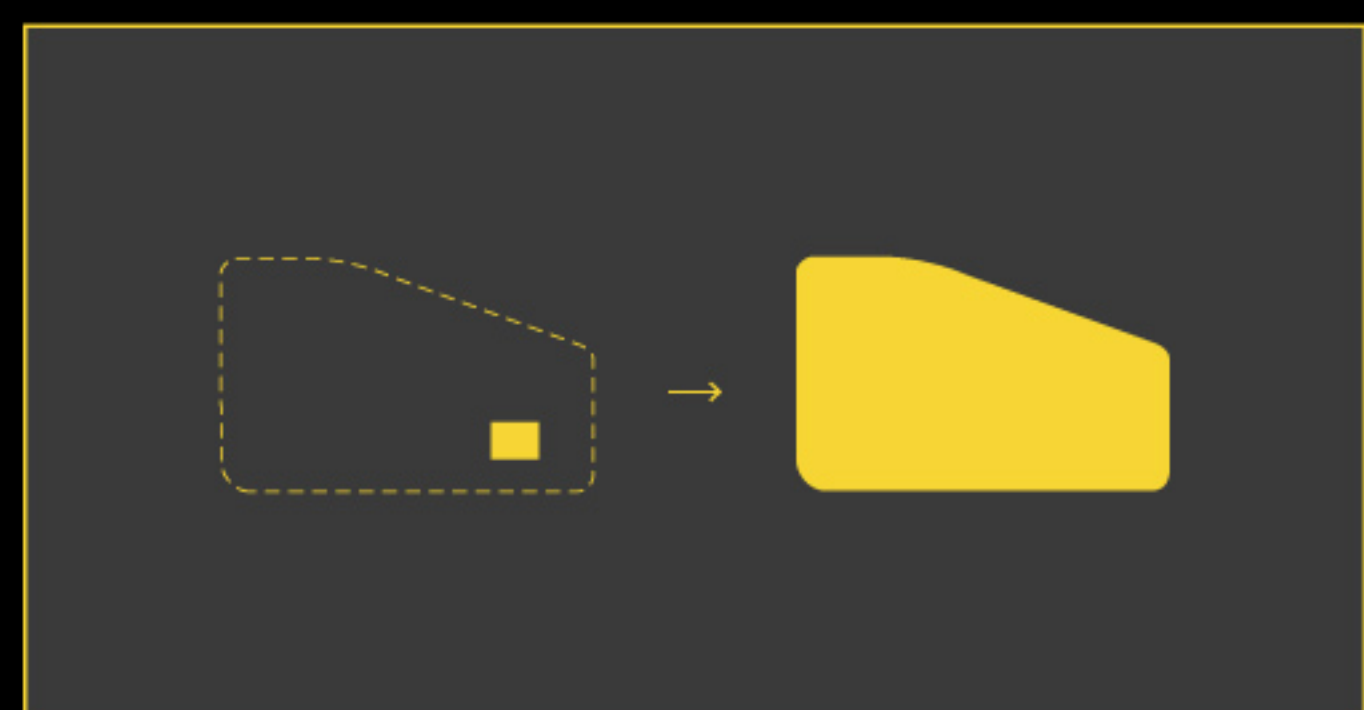



view from site's northern edge to U.S. Capitol

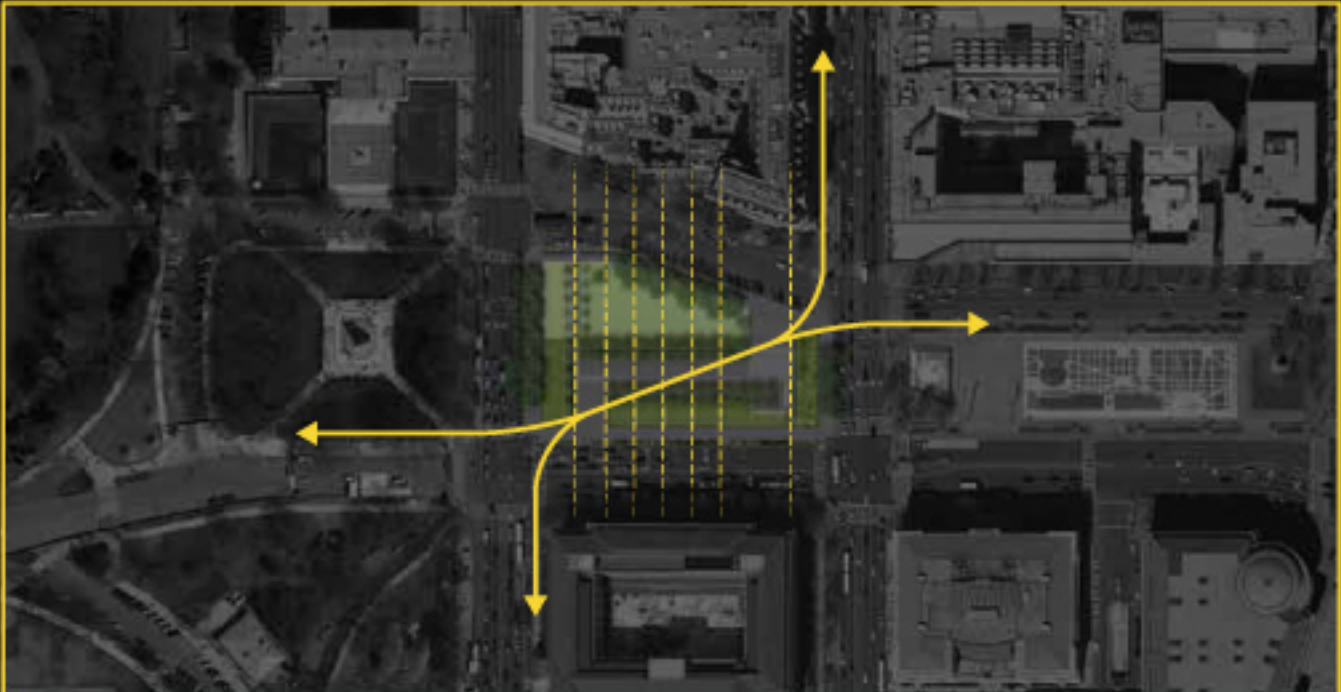
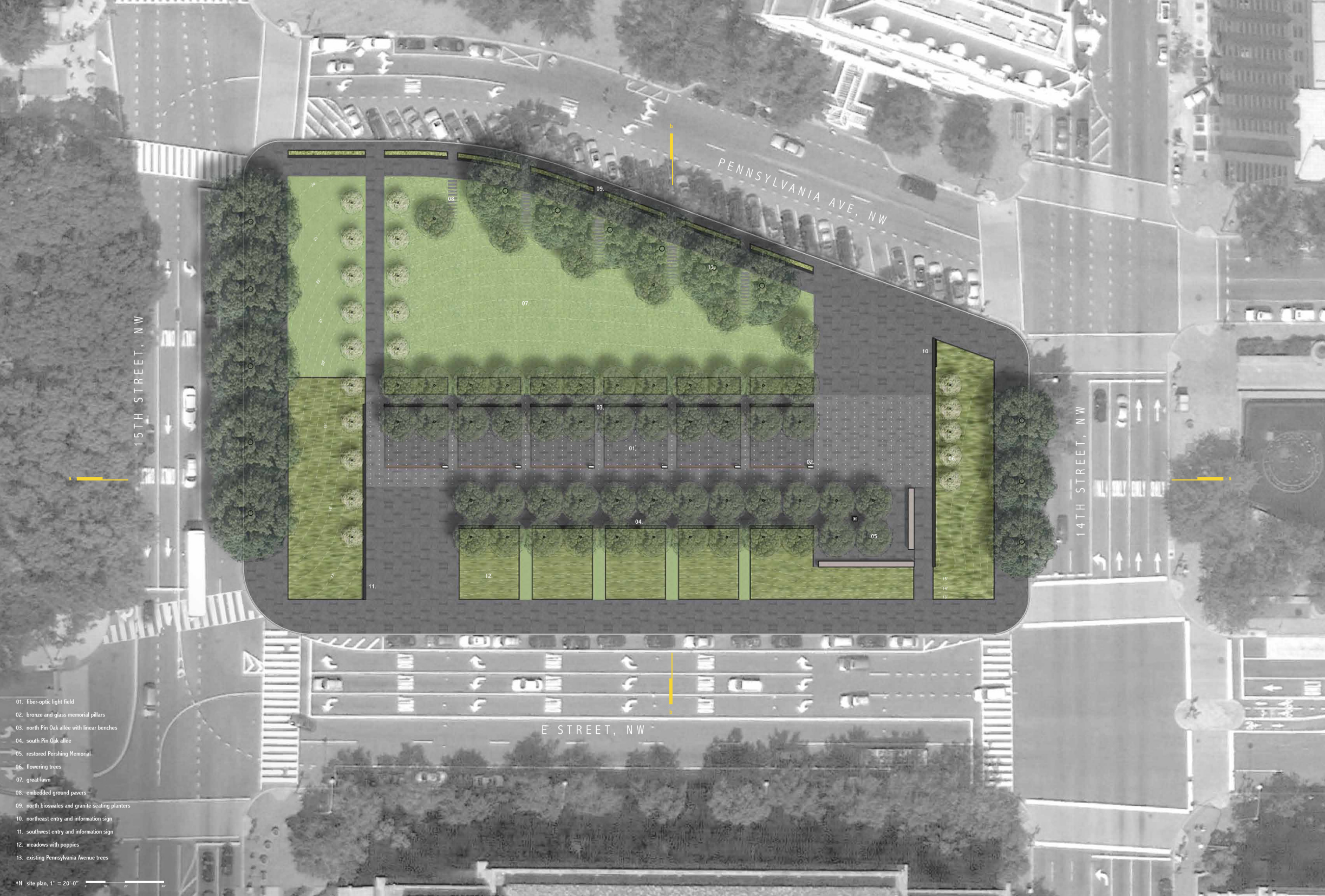

circulation: strengthened pedestrian connections through site from Pennsylvania Avenue to Ellipse

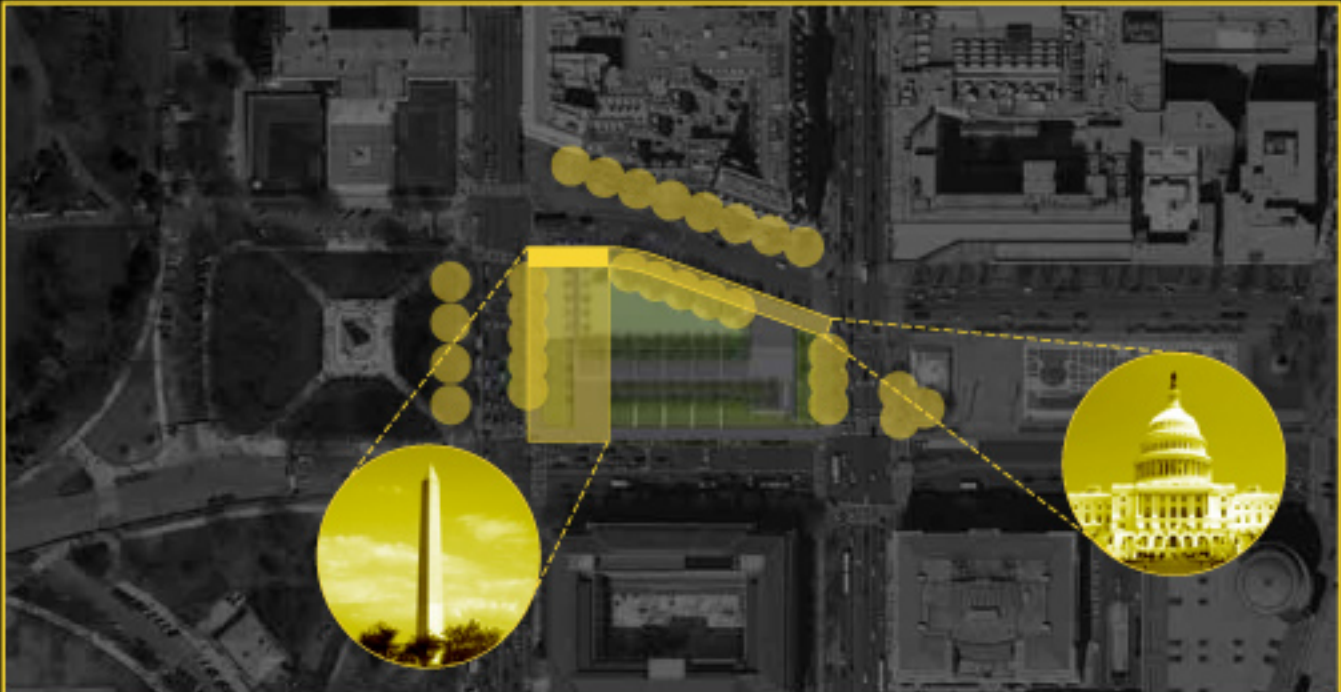

views: sensitivity to historic view corridors and surrounding established tree plantings



accessibility: fully accessible site with gently sloping paths for safe and easy site traversal

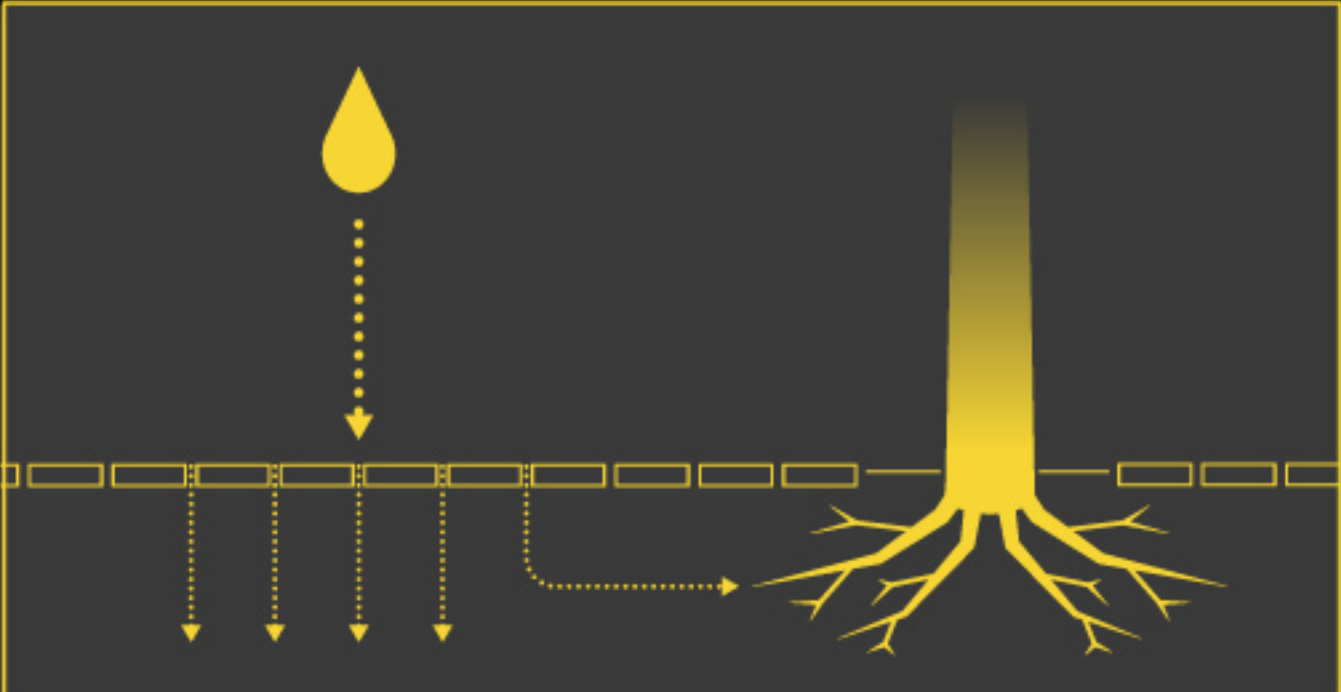

ecology: suspended permeable paver system for on-site stormwater capture and uniform tree growth