

Attachment B

Agency Coordination and Correspondence



United States Department of the Interior

FISH AND WILDLIFE SERVICE

Mississippi Field Office
6578 Dogwood View Parkway, Suite A
Jackson, Mississippi 39213



July 24, 2014

IN REPLY REFER TO:
2014-I-709

Mr. Mike Goff
Headwaters
Post Office Box 2836
Ridgeland, Mississippi 39157

Dear Mr. Goff:

The Fish and Wildlife Service (Service) has reviewed the information in your letter dated July 15, 2014, regarding the proposed Craftsman's Guild of Mississippi pedestrian walkway project in Madison County, Mississippi. Our comments are submitted in accordance with the Endangered Species Act (ESA) (87 Stat. 884, as amended; 16 U.S.C. 1531 et seq.).

Based on the information provided in your letter, the Service has determined that the proposed project will have "No Effect" on federally listed species or their habitats. No further consultation under the ESA is required with this office unless there are changes in the scope or location of the proposed project.

If you have any questions, please contact David Felder in our office, telephone: (601) 321-1131, or visit our website at <http://www.fws.gov/mississippiES/>.

Sincerely,

for Stephen M. Ricks
Field Supervisor
MS Field Office



MISSISSIPPI
DEPARTMENT OF WILDLIFE, FISHERIES, AND PARKS

Sam Polles, Ph.D.
Executive Director

August 4, 2014

Headwaters, Inc.
P.O. Box 2836
Ridgeland, MS 39158-2836

Re: Multi-use Trail R# 10348
Craftsman's Guild of Mississippi
Madison County, Mississippi

To Mr. Mike Goff:

In response to your request for information dated July 15, 2014, we have searched our database for occurrences of state or federally listed species and species of special concern that occur within 2 miles of the site of the proposed project. Please find our concerns and recommendations below.

The following species of concern may occur within 2 miles of the proposed project area:

SCIENTIFIC NAME	COMMON NAME	FED	STATE	STATE RANK
Hexalectris spicata	Crested Coralroot			S2
Polyodon spathula	Paddlefish			S3
Obovaria jacksoniana	Southern Hickorynut			S1

State Rank

S1 — Critically imperiled in Mississippi because of extreme rarity (5 or fewer occurrences or very few remaining individuals or acres) or because of some factor(s) making it vulnerable to extirpation.

S2 — Imperiled in Mississippi because of rarity (6 to 20 occurrences or few remaining individuals or acres) or because of some factor(s) making it vulnerable to extirpation.

S3 — Rare or uncommon in Mississippi (on the order of 21 to 100 occurrences).

State and Federal Status

LE Endangered — A species which is in danger of extinction throughout all or a significant portion of its range.

LT Threatened — A species likely to become endangered in foreseeable future throughout all or a significant portion of its range.

Based on information provided, we conclude that if best management practices are properly implemented, monitored, and maintained (particularly measures to prevent, or at

least, minimize negative impacts to water quality), the proposed project likely poses no threat to listed species or their habitats.

Recommendations:

We recommend that best management practices be properly implemented, monitored, and maintained for compliance, specifically measures that will prevent suspended silt and contaminants from leaving the site in stormwater run-off as this may negatively affect water quality and habitat conditions within nearby streams and waterbodies.

Please feel free to contact us if we can provide any additional information, resources, or assistance that will help minimize negative impacts to the species and/or ecological communities identified in this review. We are happy to work with you to ensure that our state's precious natural heritage is conserved and preserved for future Mississippians.

Sincerely,

A handwritten signature in blue ink, appearing to read 'Jennifer Frey', with a checkmark-like flourish at the end.

Jennifer Frey, Database Manager
Mississippi Natural Heritage Program
(601) 576-6049

The Mississippi Natural Heritage Program (MNHP) has compiled a database that is the most complete source of information about Mississippi's rare, threatened, and endangered plants, animals, and ecological communities. The quantity and quality of data collected by MNHP are dependent on the research and observations of many individuals and organizations. In many cases, this information is not the result of comprehensive or site-specific field surveys; most natural areas in Mississippi have not been thoroughly surveyed and new occurrences of plant and animal species are often discovered. Heritage reports summarize the existing information known to the MNHP at the time of the request and cannot always be considered a definitive statement on the presence, absence or condition of biological elements on a particular site.

United States Department of Agriculture



Natural Resources Conservation Service
175 A-Commercial Parkway
Canton, MS 39046
(601) 859-4272 Ext. 3
(601) 859-7091 fax

July 31, 2014

Headwaters, Inc.
P.O. Box 2836
Ridgeland, MS 39158

RE: Craftsman's Guild of Mississippi
Multi-use Trail
Madison County, Mississippi

Dear Mr. Goff,

I have reviewed the parcel of land located in partial Section 27 and 28, Township 7 North, Range 2 East, Madison County, Mississippi. There are no government program contracts or concerns from our agency in the aforementioned parcel. Also, because the property is within the city limits of Ridgeland, it is exempt from any prime farmland designations.

If further assistance is needed, please feel free to call.

A handwritten signature in blue ink that reads "Phillip Archie".

Phillip Archie
District Conservationist

REQUEST FOR CULTURAL RESOURCES ASSESSMENT

Forwarding of this completed form to the Mississippi State Historic Preservation Office constitutes a request for Cultural Resources Assessment in accordance with 36 CFR 800. This assessment is required for all projects which are funded, assisted, or licensed by a Federal agency.

Applicant CRAFTSMEN'S GUILD OF MISS. County of project MANSON
Applicant's address 950 RICE ROAD City VIDGEZAND Zip 39157
Contact person and name of organization NANCY PERKINS, CRAFTSMEN'S GUILD OF MISS.
Phone 601-856-7546 Cell Phone * 601-953-6777
Contact person's address, if different from applicant _____ email nancy@mscrafter.com
Street/P.O. Box _____ City _____ Zip _____

Federal agency and program (required): _____

Type of involvement (check one): Permit ☐ Grant ☒
Loan ☐ Other ☐

Signature of applicant or contact person requesting this assessment:

Nancy W. Perkins Date 2/10/14

1. Project Description and Location (Please describe project. If structure is involved, provide physical address)

MULTI-USE TRAIL CONNECTING THE EXISTING MULTI-USE TRAILS AND PARKING LOT AT THE NACHEZ TRACE TO THE MSCRAFT CENTER
If the program involves more than one project, complete separate assessment for each. If more space is needed to provide a description of the proposed project, please attach a separate sheet. 950 RICE RD.

- Has the identical project been previously submitted for a cultural resource assessment? If YES, enclose copy of State Historic Preservation Officer's comments, if available. YES ☐ NO ☒
- Attach a 7.5' USGS quadrangle map, or portion thereof, indicating the precise location and/or boundaries of the project area and the acreage involved. Please include the name of the quad map, if not otherwise indicated.
- Approximately how many acres are in the project area? ACRE(s) > 1/2 < 2
NOT YET SURVEYED
- If the project is in a non-urban area, please indicate the section, township, and range, if not otherwise indicated on the map provided. LATITUDE 32° 25' 25" N
LONGITUDE 90° 05' 19" W
Section 27 Township _____ Range _____
- To your knowledge, has a cultural resources survey been conducted in the project area? If YES, attach survey report. NO
- Describe the present use and condition of the property.

NATURAL FOREST CONDITION, UPLAND-NATIONAL PARK AREA OF INTEREST

Please include photo(s) of the project area, if available, in its current condition.
Use of printed digital images is acceptable if print quality is good.

2. Buildings and Structures

- Will the project involve an addition to, destruction, alteration, or renovation of any structure? If NO, proceed to Section 3. If yes, please include photo of building YES ☐ NO ☒
- What is the approximate date of construction of the existing structure, if known? _____
- Is affected structure 45 years old or older? If NO, proceed to Section 3. YES ☐ NO ☐
- Have plans and specifications for the renovation, alteration, or addition been completed? YES ☐ NO ☐

If YES, attach plans and specifications (plans for a new structure to replace a demolished one need not be attached). Please include photos of front and rear elevations, as well as the location of any proposed additions/alterations.

- Will construction take place adjacent to any structure which is approximately fifty years old or older? If YES, give address of structure(s), and date(s) of construction, if known. YES ☐ NO ☐

If the building(s) or structure(s) is located in a National Register and/or local historic district, if known, name the district. _____

Please include photos of the front façade of structure(s) and indicate on the project map the location(s) in relation to the project. Use of printed digital images are acceptable.

3. Ground Disturbing Activities

- Has the ground at the project location been previously developed, graded, or disturbed? If YES, describe the nature of the disturbed/developed portion (graded, farmed, etc.). YES ☐ NO ☐
THERE IS A PARKING LOT AND EXISTING TRAIL ON ONE END AND AN EXISTING WALKWAY ON THE OTHER WITH NO KNOWN DISTURBANCES IN BETWEEN
- Will this project necessitate the acquisition of fill material? YES ☐ NO ☒
If YES, approximately how many cubic yards of material will be acquired? Cu. Yds. _____
- Has the site from which fill material will be acquired been selected? YES ☐ NO ☐ N/A
Clearly indicate borrow area(s) on project map and give approximate size in acres of each borrow site.
- Has material been taken from the borrow area(s) for other projects? YES ☐ NO ☐ N/A
- Does this project involve road/street construction? If YES, does the project involve any of the following? YES ☐ NO ☒

☐ New right-of-way ☐ New road construction ☐ Repaving ☐ Widening/change of alignment

Mail completed form to:

**Mississippi Department of Archives and History
Review and Compliance Officer
P.O. Box 571
Jackson, Mississippi 39205-0571**

Phone: (601) 576-6940

USGS 7.5-Minute Quadrangle Map
Mississippi Craft Center Parking Improvements
Natchez Trace Parking, Multi-Use Path Connector:

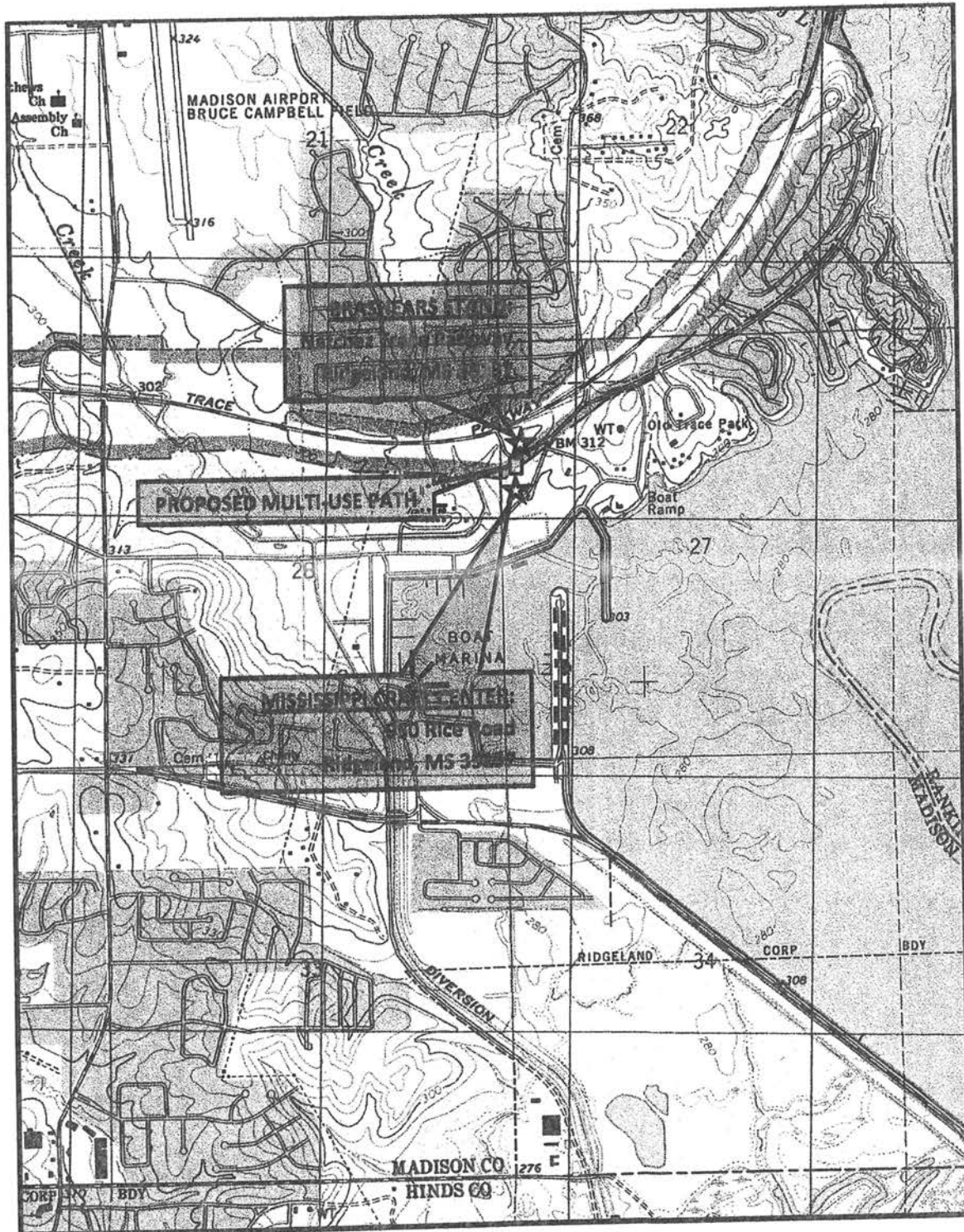

Proposed Multi-use Path To Link the Natchez Trace Multi-use Path With the Mississippi Craft Center

Notes:

Not drawn to scale;
Natchez Trace mile 104.5, approx.
Prepared by: Samuel Holder, M.S.,
Environmental Consultant;
February 9, 2014

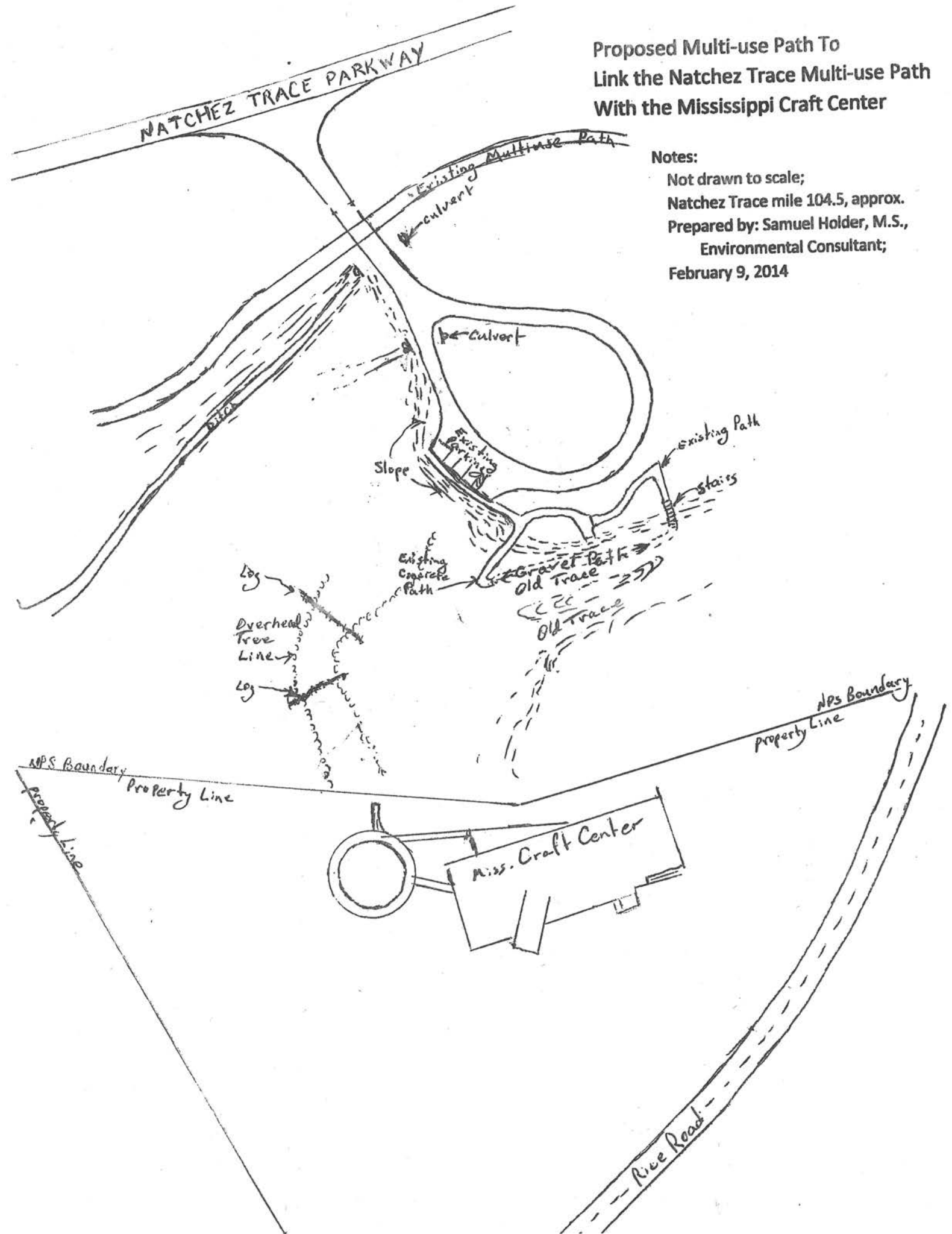



PO Box 571, Jackson, MS 39205-0571
601-576-6850 • Fax 601-576-6975
mdah.state.ms.us
H.T. Holmes, Director

February 19, 2014

Ms. Nancy Perkins
Craftsmen's Guild of Mississippi
950 Rice Road
Ridgeland, Mississippi 39157

RE: Proposed multi-use trail connecting existing trails and parking lot at the Natchez Trace to the Mississippi Craft Center, MDAH Project Log #02-056-14, Madison County

Dear Ms. Perkins:

We have reviewed request for a cultural resources assessment, received on February 11, 2014, for the above referenced undertaking, pursuant to our responsibilities under Section 106 of the National Historic Preservation Act and 36 CFR Part 800. After review, it is our opinion that no cultural resources listed in or eligible for listing in the National Register of Historic Places are likely to be directly or visually affected. We recommend that you obtain permission from the Natchez Trace Parkway. With the Parkway's permission, we have no reservations with the undertaking.

There remains the possibility that unrecorded cultural resources may be encountered during the project. Should this occur, we would appreciate your contacting this office immediately in order that we may offer appropriate comments under 36 CFR 800.13.

If you need any additional information, please call me at (601) 576-6538.

Sincerely,

A handwritten signature in dark ink, appearing to read "Greg", is written above the printed name.

Greg Williamson
Review and Compliance Officer

FOR: H.T. Holmes
State Historic Preservation Officer



June 18, 2013

Ms. Nancy Perkins
Executive Director
Craftsmen's Guild of Mississippi, Inc.
Mississippi Craft Center
950 Rice Road
Ridgeland, MS 39157

RE: Natchez Trace Parkway Multi-Use Trail Connector
Mississippi Craft Center

Dear Ms. Perkins,

The City of Ridgeland is committed to supporting the Mississippi Craft Center by acting as the Local Public Agency in their efforts to improve and expand parking facilities and provide better accommodations at one of Mississippi's finest attractions. In addition to the parking improvements, the City also supports the proposal of a multi-use path connecting the Natchez Trace Parkway's parking area at Brashears Stand with the Craft Center campus. Here in Ridgeland we promote a high quality living environment and an enthusiasm for fitness that can be found in our extensive multi-use trail system. We feel that the proposed connector path offers valuable connectivity to our trail system.

We have no objection to proceeding with the development of this project, and we are committed to helping the Craft Center develop a reasonable alternative based upon the outcome of an environmental assessment.

Sincerely,

Gene F. McGee, Mayor
City of Ridgeland

mailing address: p.o. box 217 • ridgeland, ms 39158
street address: 304 highway 51 • ridgeland, ms 39157
ph: 601.856.7113 • www.ridgelandms.org

Gene F. McGee, cmo - mayor • Paula Tierce, city clerk

board of aldermen: D.I. Smith - at - large • Ken Heard, cmo - ward 1 • Chuck Gautier - ward 2 • Kevin Holder - ward 3
Brian P. Ramsey - ward 4 • Scott Jones, mayor pro tempore - ward 5 • Wesley Hamlin - ward 6



From: ithompson@choctawnation.com
Sent: Monday, August 11, 2014 2:59 PM
Subject: RE: Invitation to Review the 2014 Recreational Trails Projects (MS Craft Center Trail Connector))

The Choctaw Nation of Oklahoma thanks FHWA for consultation on the proposed Mississippi Craft Center Trail Connector Trail. The proposed project is within lands ceded by the Choctaw Nation to the United States by treaty. Human remains or archaeological materials found in or around the project location may potentially be culturally affiliated with the Choctaw Nation of Oklahoma. From the information provided, it appears that the project lies on or very near a surviving original segment of the Natchez Trace. Also, several significant archaeological sites are located within less than half a mile. In order for the Choctaw Nation Historic Preservation Department to comment upon potential affect, please indicate the current level of disturbance within the proposed trail corridor.

Thank you for your time and assistance.

Sincerely,

Ian Thompson PhD, RPA
THPO, Tribal Archaeologist,
Director, Historic Preservation Dept.
Choctaw Nation of Oklahoma
PO Drawer 1210
Durant, OK 74701
1-800-522-6170 ext. 2216

From: claiborne.barnwell@dot.gov [mailto:claiborne.barnwell@dot.gov]
Sent: Thursday, July 17, 2014 3:16 PM
To: chief@jenachoctaw.org; kcarleton@choctaw.org; nagpra.106@earthlink.net; HPO@chickasaw.net; da_nammasters@aol.com; earlii@tunica.org; ebarbry@tunica.org; ebandy@quapawtribe.com; Ian Thompson; jlambert@quapawtribe.com; lmccormickjbc@centurytel.net; pfoster@tunica.org
Cc: bgray@mdot.ms.gov; junderwood@mdot.ms.gov; kthurman@mdot.ms.gov; Christy.Poon-Atkins@dot.gov; Randal.Jansen@dot.gov
Subject: Invitation to Review the 2014 Recreational Trails Projects (e-mail #1of 4)

Greetings,

Attached for your consideration and comments are the 2014 Recreational Trails Projects (16) that have been selected by the Mississippi Department of Wildlife, Fisheries, and Parks. Due to the size of these proposals I am sending the information in four separate e-mails. This e-mail contains Projects 1, 2, & 3.

No resources are anticipated to be impacted due to the un-intrusive nature of the proposed projects. However, should inadvertent discoveries be

incurred, the construction activities would cease and appropriate consultation would be undertaken.

Let me know should you require additional information; your assistance is greatly appreciated.

With regards,
Claiborne

E. Claiborne Barnwell, PE
Project Development Team Leader
FHWA, Mississippi Division
tele: 601.965.4217
cell: 601.259.9085
claiborne.barnwell@dot.gov
 **Please consider the environment before printing**

This message is intended only for the use of the individual or entity to which it is addressed and may contain information that is privileged, confidential and exempt from disclosure. If you have received this message in error, you are hereby notified that we do not consent to any reading, dissemination, distribution or copying of this message. If you have received this communication in error, please notify the sender immediately and destroy the transmitted information. Please note that any view or opinions presented in this email are solely those of the author and do not necessarily represent those of the Choctaw Nation.



Preserving America's Heritage

September 1, 2015

Ms. Mary Risser
Superintendent
Nation Park Service
Natchez Trace Parkway
2680 Natchez Trace Parkway
Tupelo, Mississippi 38804

Ref: Construction of Boardwalk to Connect the Mississippi Craft Center to the Brashear's Stand/Old Trace Interpretive Area of the Natchez Trace Parkway
Madison County, Mississippi

Dear Ms. Risser:

The Advisory Council on Historic Preservation (ACHP) has received your notification and supporting documentation regarding the adverse effects of the referenced undertaking on a property or properties listed or eligible for listing in the National Register of Historic Places. Based upon the information provided, we have concluded that Appendix A, *Criteria for Council Involvement in Reviewing Individual Section 106 Cases*, of our regulations, "Protection of Historic Properties" (36 CFR Part 800), does not apply to this undertaking. Accordingly, we do not believe that our participation in the consultation to resolve adverse effects is needed. However, if we receive a request for participation from the State Historic Preservation Officer (SHPO), Tribal Historic Preservation Officer (THPO), affected Indian tribe, a consulting party, or other party, we may reconsider this decision. Additionally, should circumstances change, and it is determined that our participation is needed to conclude the consultation process, please notify us.

Pursuant to 36 CFR §800.6(b)(1)(iv), you will need to file the final Memorandum of Agreement (MOA), developed in consultation with the Mississippi State Historic Preservation Office (SHPO), and any other consulting parties, and related documentation with the ACHP at the conclusion of the consultation process. The filing of the MOA, and supporting documentation with the ACHP is required in order to complete the requirements of Section 106 of the National Historic Preservation Act.

Thank you for providing us with the notification of adverse effect. If you have any questions or require further assistance, please contact Ms. Katherine Kerr at 202-517-0216 or via e-mail at kkerr@achp.gov.

Sincerely,

Artisha Thompson
Historic Preservation Technician
Office of Federal Agency Programs

ADVISORY COUNCIL ON HISTORIC PRESERVATION

401 F Street NW, Suite 308 □ Washington, DC 20001-2637
Phone: 202-517-0200 □ Fax: 202-517-6381 □ achp@achp.gov □ www.achp.gov