

STATE	PROJECT	SHEET NUMBER
WY	THE GRAND CANYON OF THE YELLOWSTONE OVERLOOKS AND TRAILS PROJECT	M.01

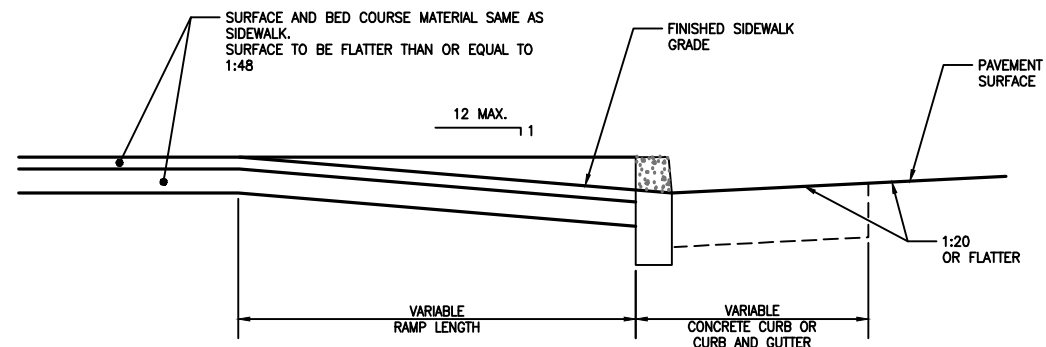

RAMP TYPICAL SECTION

NTS

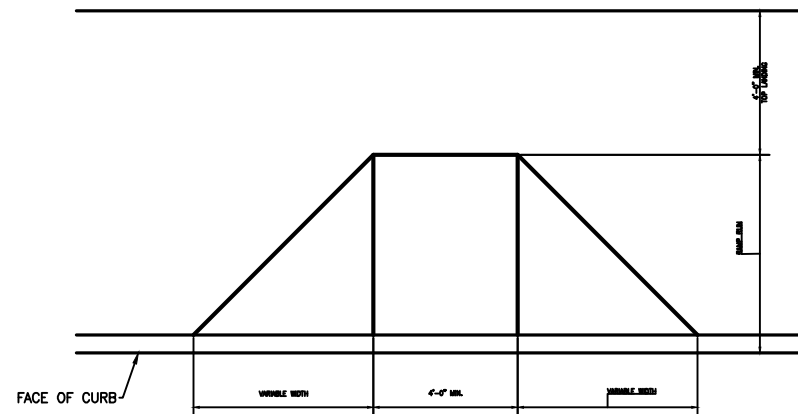

PERPENDICULAR CURB RAMP

NTS

- NOTE:**
1. THE MAXIMUM CROSS SLOPES OF RAMPS MUST NOT EXCEED 2% IN ANY DIRECTION.
 2. USE A COARSE BROOM FINISH RUNNING PERPENDICULAR TO THE SLOPE TO CREATE A SLIP RESISTANT SURFACE ON CONCRETE RAMP SURFACES, EXCLUSIVE OF THE DETECTABLE WARNING FIELDS.
 3. CONSTRUCT CURB RAMP PERPENDICULAR TO THE CURB. AVOID SKEWING THE RAMP FACE.
 4. CONSTRUCT RAMP TRANSITIONS BETWEEN WALKS, GUTTER, OR STREETS THAT ARE FLUSH AND FREE OF ABRUPT VERTICAL CHANGES NOT TO EXCEED 1/2".
 5. LOCATE DRAINAGE INLETS AND MANHOLES OUTSIDE OF RAMP WALKING SURFACES OR LANDINGS.

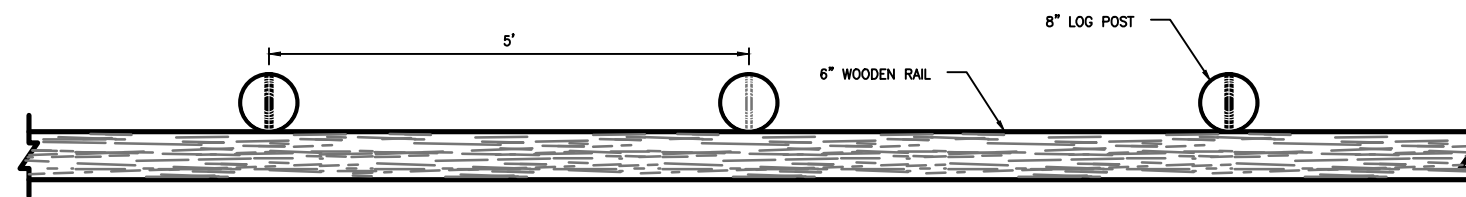

PLAN VIEW

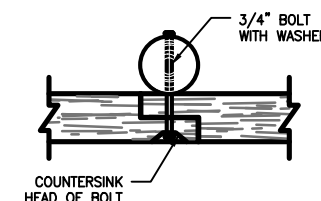

RAIL CONNECTION DETAIL

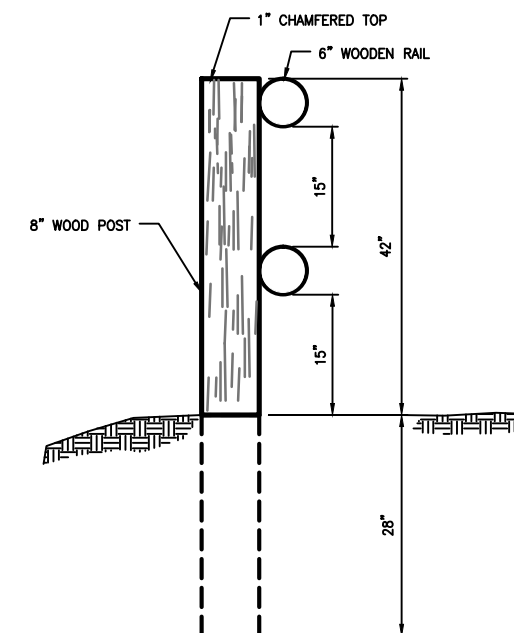

SECTION

PEDESTRIAN RAILING TYPE 3 POST AND RAIL DETAIL

NTS

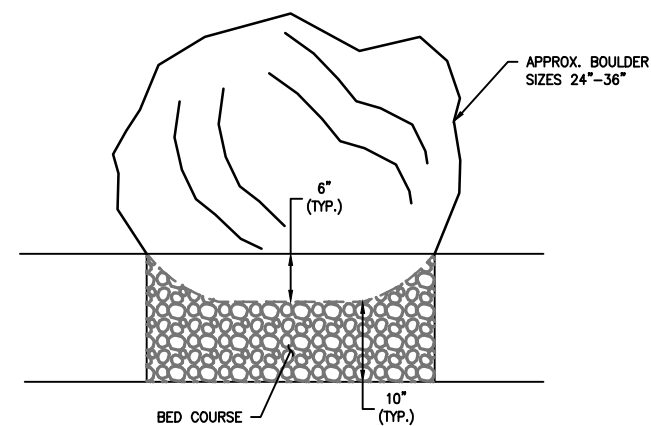

LANDSCAPE BOULDER

NTS

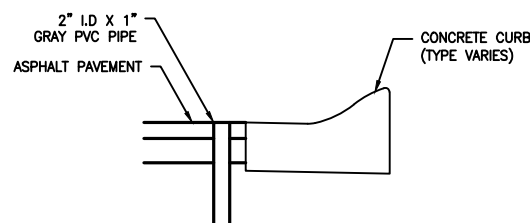

SNOW POLE HOLDER DETAIL

NTS

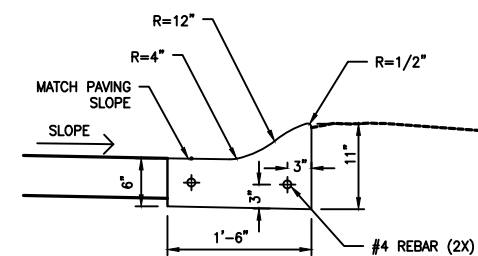

CURB, CONCRETE, 11\"/>

NTS

TITLE OF SHEET	SCHMATIC DESIGN SET
DETAILS	DATE 8/8/15
YELLOWSTONE NATIONAL PARK	SHEET 1 OF XX

STATE	PROJECT	SHEET NUMBER
WY	THE GRAND CANYON OF THE YELLOWSTONE OVERLOOKS AND TRAILS PROJECT	M.02

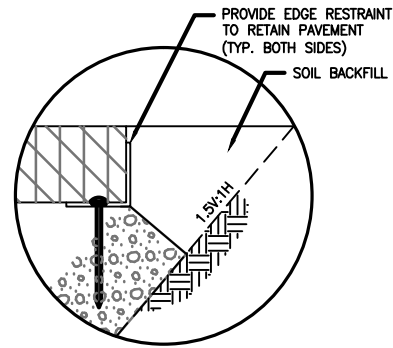

**TRAIL PAVING EDGE RESTRAINT -
CUT CONDITION**

NTS

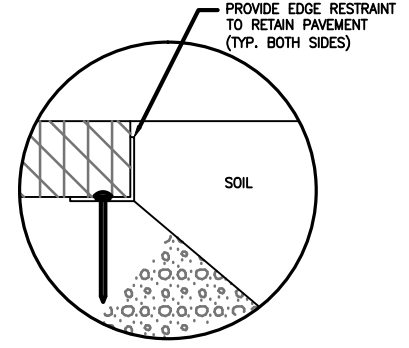

**TRAIL PAVING EDGE RESTRAINT -
FILL CONDITION**

NTS

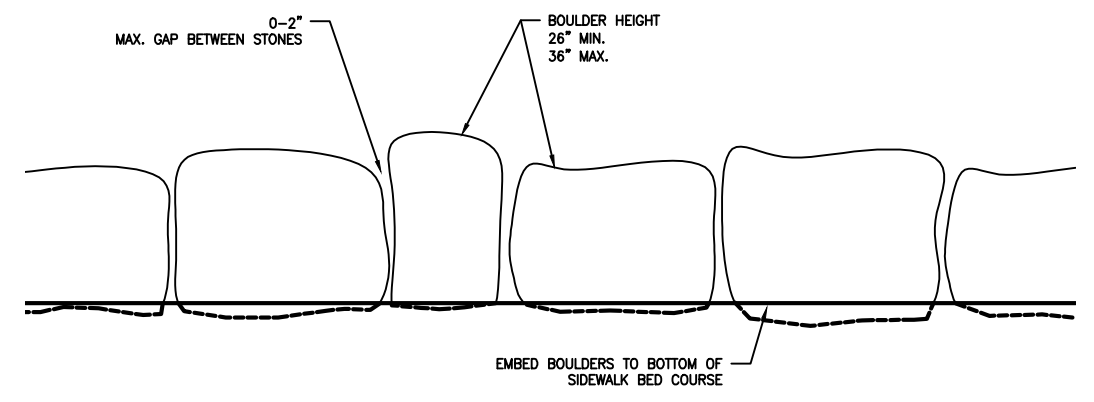

BOULDER SLOPE SUPPORT

NTS

K:\project\32400\32470.Dwg\Phase 1\M.O.1-M.OX.dwg [B.Base.US] 15 June 2015 5:06 PM

TITLE OF SHEET	SCHMATIC DESIGN SET
DETAILS	DATE 8/8/15
YELLOWSTONE NATIONAL PARK	SHEET 2 OF XX