

Public Scoping for the Placement of “Abraham Lincoln: The Man”

In 2015, Saint-Gaudens NHS plans to place a bronze cast of “Abraham Lincoln: The Man” on the park landscape. The placement of the sculpture will commemorate the park’s 50th anniversary as a National Park, but it will also bring one of Saint-Gaudens’s most important works onto the park landscape, enhancing interpretive opportunities as well as the experience of visitors to the park. The Lincoln was the first major work Saint-Gaudens completed after moving to Cornish in 1885 and the man he used as a model was a local resident with Lincoln-esque proportions.

This scoping process is designed to engage the public to help evaluate locations where the sculpture may be placed on the park landscape. The National Park Service has identified several locations where placement of the sculpture may be suitable. Some locations offer better interpretive opportunities, some offer strong architectural arguments, some provide for outstanding visitor accessibility and visibility of the work. All sites have advantages and disadvantages. We invite the public to comment on the advantages and disadvantages of each of the sites.

To help visualize how the sculpture would look in each location, park staff prepared a mock-up of “Abraham Lincoln: The Man” out of wood (Saint-Gaudens was known to do the same thing, dragging wooden models around his estate to gain perspective that can only be had out-of-doors). Park staff moved the mock-up around to the different potential locations. Photos of the mock-up in those locations are included in this document to help facilitate comment and discussion. The mock-up is to provide a sense of general location as well as the final sculpture’s massing.

Details about “Abraham Lincoln: The Man”

Height: 16 feet (bronze figure is 12 feet high, stone base is 4 feet high)

Length: 8 feet

Width: 5 feet

Composition: The figure and accompanying chair of state will be composed of cast bronze. The base will be composed of stone.

The park will be accepting feedback via the National Park Service Planning, Environment, and Public Comment website until March 2. Visit www.parkplanning.nps.gov/saga to leave a comment.

Location 1: Behind the Farragut Shelter

This location is behind the wall of the shelter where the Farragut Monument is housed. In the summer, the wall is backed with a thick carpet of vines and is surrounded by lawn. The figure would look to the south and receive relatively consistent illumination throughout the day. The location is in proximity to the park visitor center as well as several administrative buildings. It is a very visible location where the sculpture would be easily viewed as people walked the path to and from the visitor center, from the visitor center patio, from the Birch Allee, and from portions of the large lawn.



Location 1: Behind the Farragut Enclosure. Photo taken from visitor center path.



Location 1: Behind the Farragut Enclosure. Photo taken from Visitor Center patio through young birches.

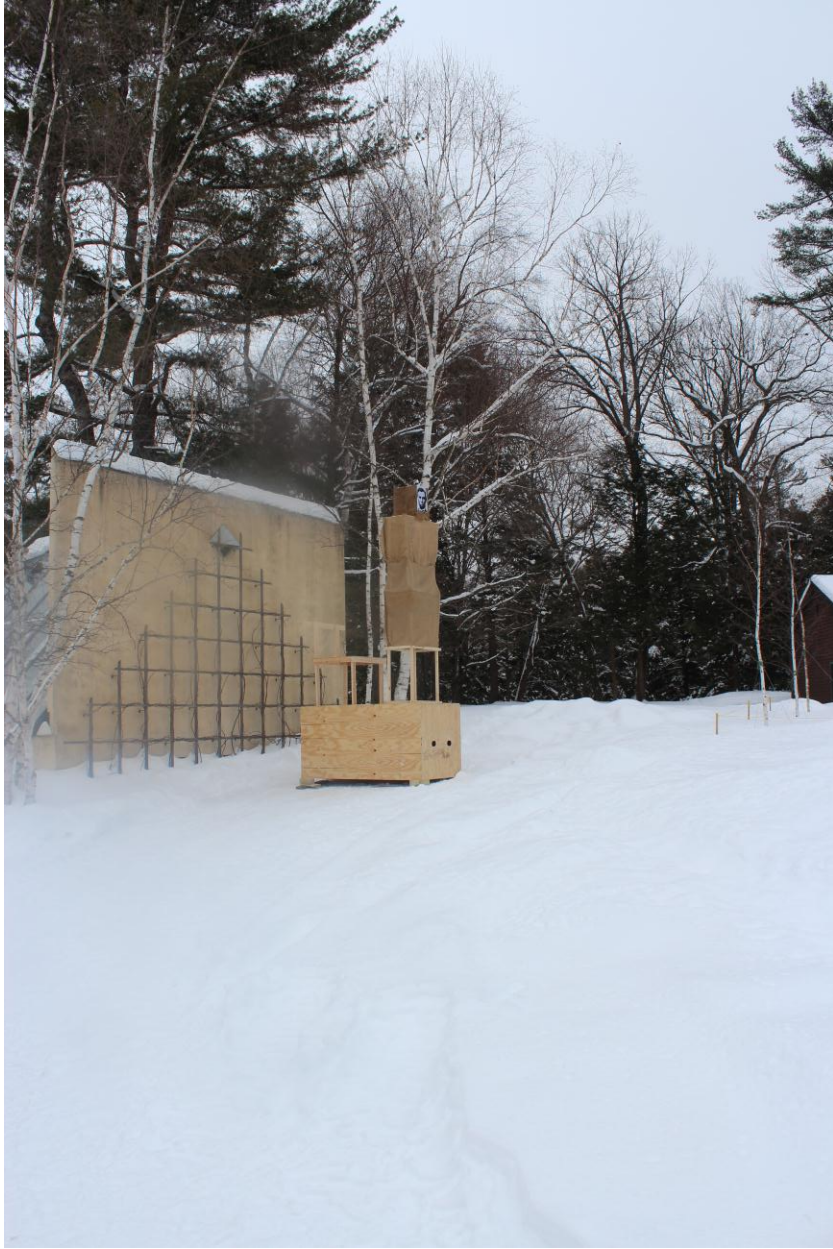

Location 1: Behind the Farragut Enclosure. Photo taken from lawn southwest of the Farragut Enclosure.

Location 2: Birch Allee Extension

Location 2 is close to Location 1 but is oriented differently. The sculpture would be placed near the extension of the Birch Allee in front of the visitor center on axis with the larger, established Allee. The front of the statue would face west. The Birch Allee extension would provide the backdrop for the sculpture and the figure would look down the older established Allee. The location is in proximity to the park visitor center as well as several administrative buildings. It is a very visible location where the sculpture would be easily viewed as people walked the path to and from the visitor center, from the visitor center patio, from the Birch Allee, and from portions of the large lawn.



Location 2: Birch Allee Extension. Photo taken from lawn in front of established Birch Allee. The building in the background is the Visitor Center.

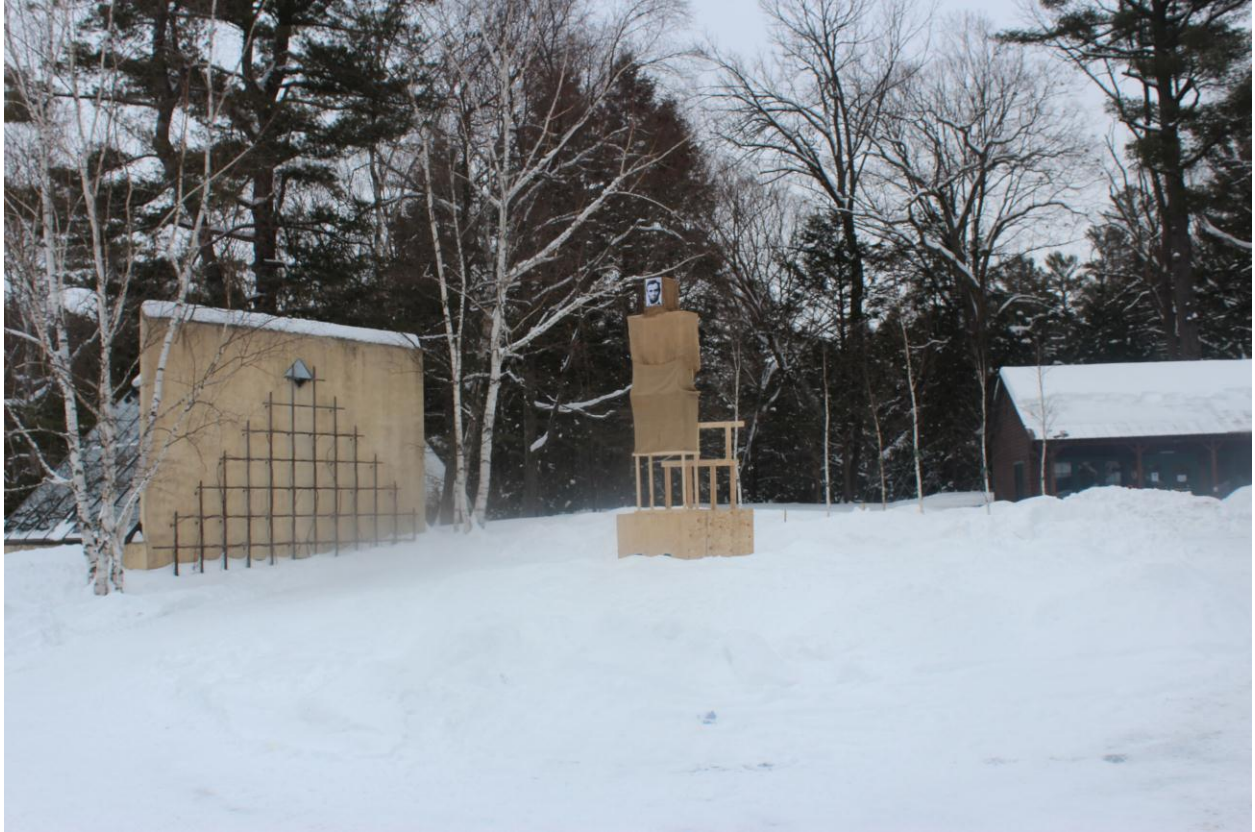

Location 2: The Birch Allee Extension. Photo taken from the path to the Visitor Center, southwest of the monument.



Location 2: The Birch Allee Extension. Photo taken from the Visitor Center patio looking down the allee extension to the established Birch Allee.

Location 3: The Shaw Memorial Bowling Green

In this location, the piece would share the large bowling green hedge room with the Shaw Memorial. The Shaw Memorial sits on the east end of the bowling green facing west; the Lincoln would sit on the west end of the bowling green facing east. The piece would be bounded on three sides by hedges between 14 and 20 feet in height; in the back, the hedges would be 8-10 feet from the back of the piece and 14 feet on the sides. Unlike locations 1 and 2, this location is secluded and contemplative rather than open and prominent. Light will illuminate the piece from the right for a portion of the day and from behind in the latter part of the day.



Location 3: Shaw Memorial Bowling Green. Photo is taken from in front of the Shaw Memorial, looking west.



Location 3: Shaw Memorial Bowling Green. Photo taken from the center of the bowling green looking west.



Location 3: Shaw Memorial Bowling Green. Photo taken looking east towards Shaw Memorial.



Location 3: Shaw Memorial Bowling Green. Photo taken from the entrance to the bowling green hedge room.

Location 4: New Gallery Lawn

This location is near the New Gallery on the great lawn. The figure would back up to the woods of the Blow-Me-Up Brook ravine and look south across the great lawn. The figure faces south and would be illuminated from the front for the majority of the day. This is a moderately visible location; the figure would be visible from the lawn, the Birch Allee, and as visitors walk out of the New Gallery complex but not as visible to visitors walking to the visitor center.



Location 4: New Gallery Lawn. Photo taken from the entrance to the Farragut courtyard, looking northwest.



Location 4: New Gallery Lawn. Photo taken from the Birch Allee, looking across the lawn to the northeast.



Location 4: New Gallery Lawn. Photo taken from the path to the visitor center, looking north.

Locations are identified on this map by Location number.

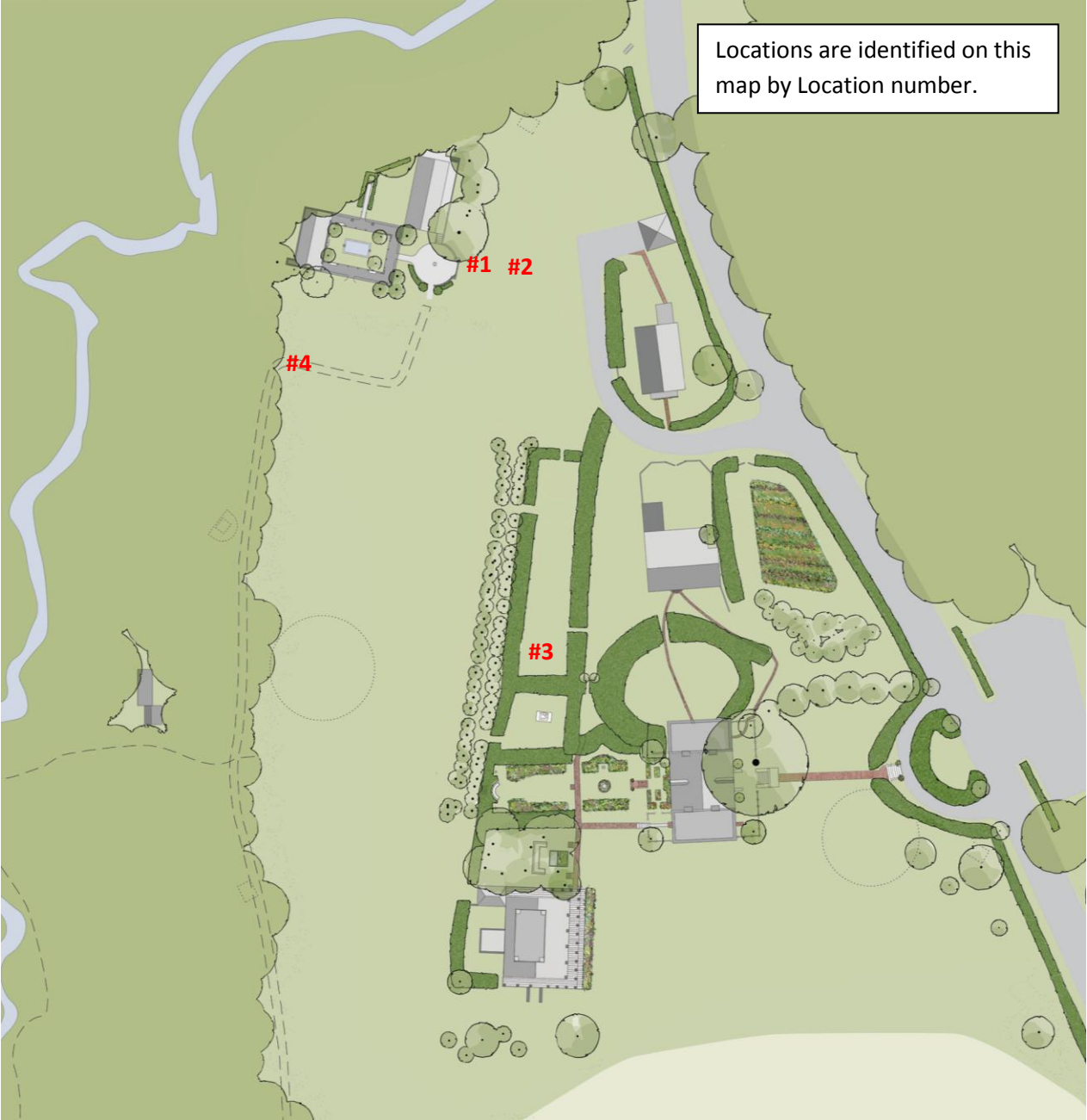

END OF DOCUMENT