



The John F. Kennedy Center for the Performing Arts Expansion Project

National Capital Planning Commission
September 12, 2013

STEVEN HOLL ARCHITECTS



The John F. Kennedy Center for the Performing Arts Expansion Project

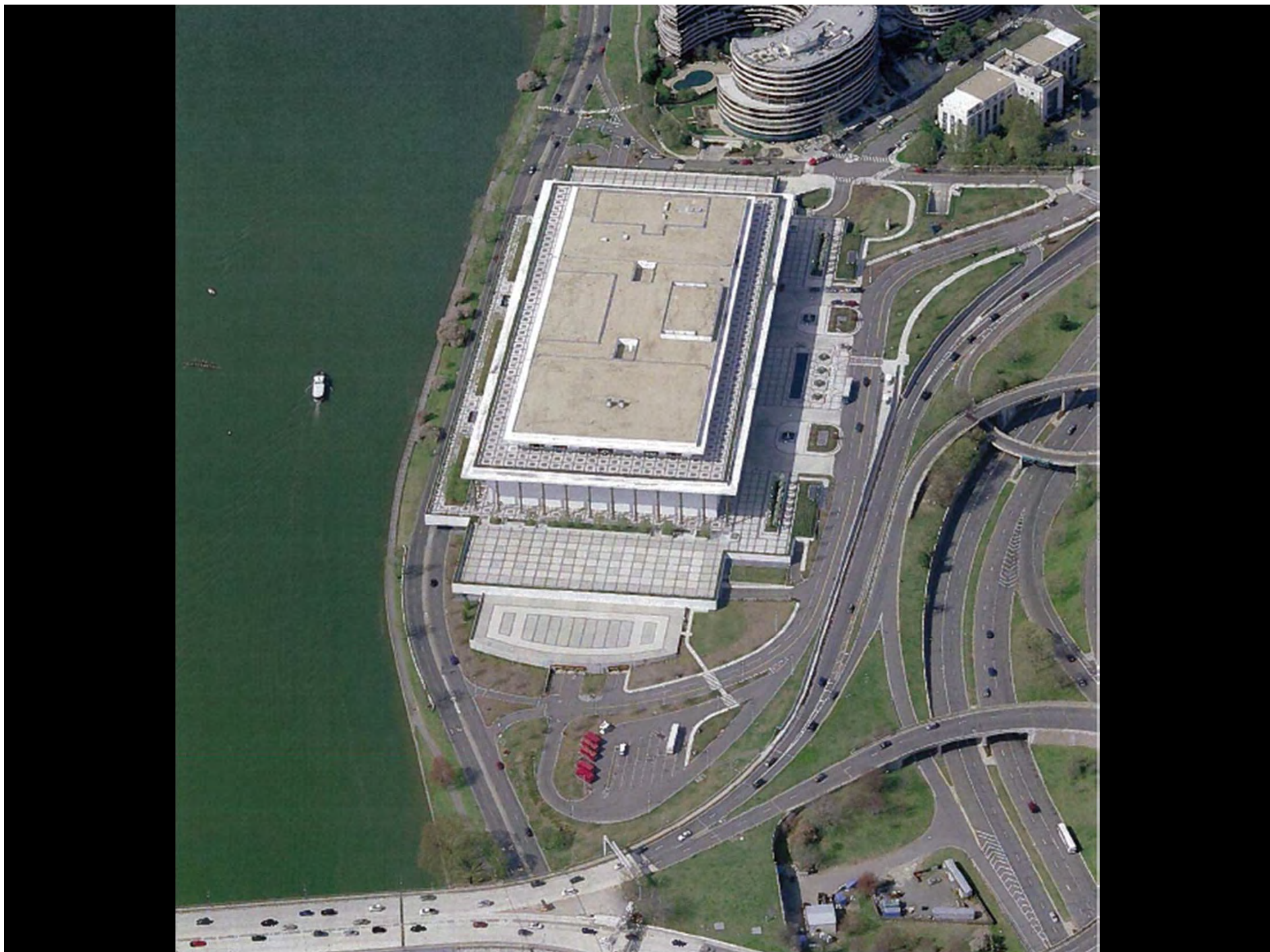

The John F. Kennedy Center for the Performing Arts Expansion

5 STRATEGIES



3 PAVILIONS: a) Entry Pavilion
b) Glissando Pavilion
c) River Pavilion



FUSION WITH LANDSCAPE AND RIVER



INSTRUMENT WITH NATURAL LIGHT



MATERIAL INNOVATION / RELATION



ECOLOGICAL INTEGRATION

The John F. Kennedy Center for the Performing Arts Expansion

5 STRATEGIES



- 3 PAVILIONS: a) Entry Pavilion
b) Glissando Pavilion
c) River Pavilion

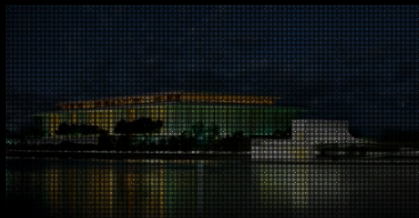

FUSION WITH LANDSCAPE AND RIVER



INSTRUMENT WITH NATURAL LIGHT



MATERIAL INNOVATION /RELATION

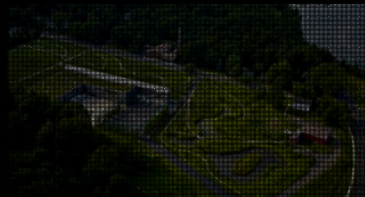

ECOLOGICAL INTEGRATION

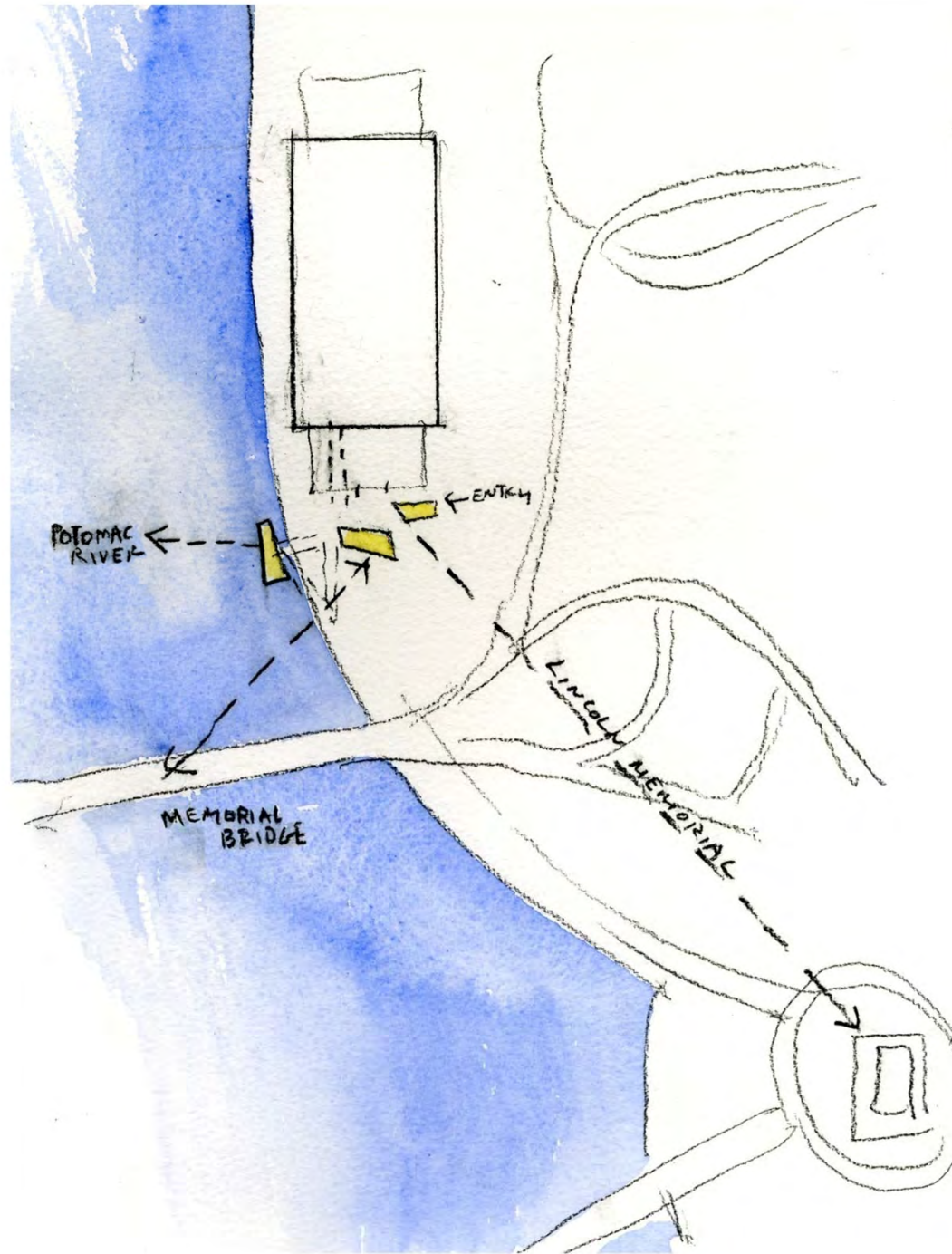

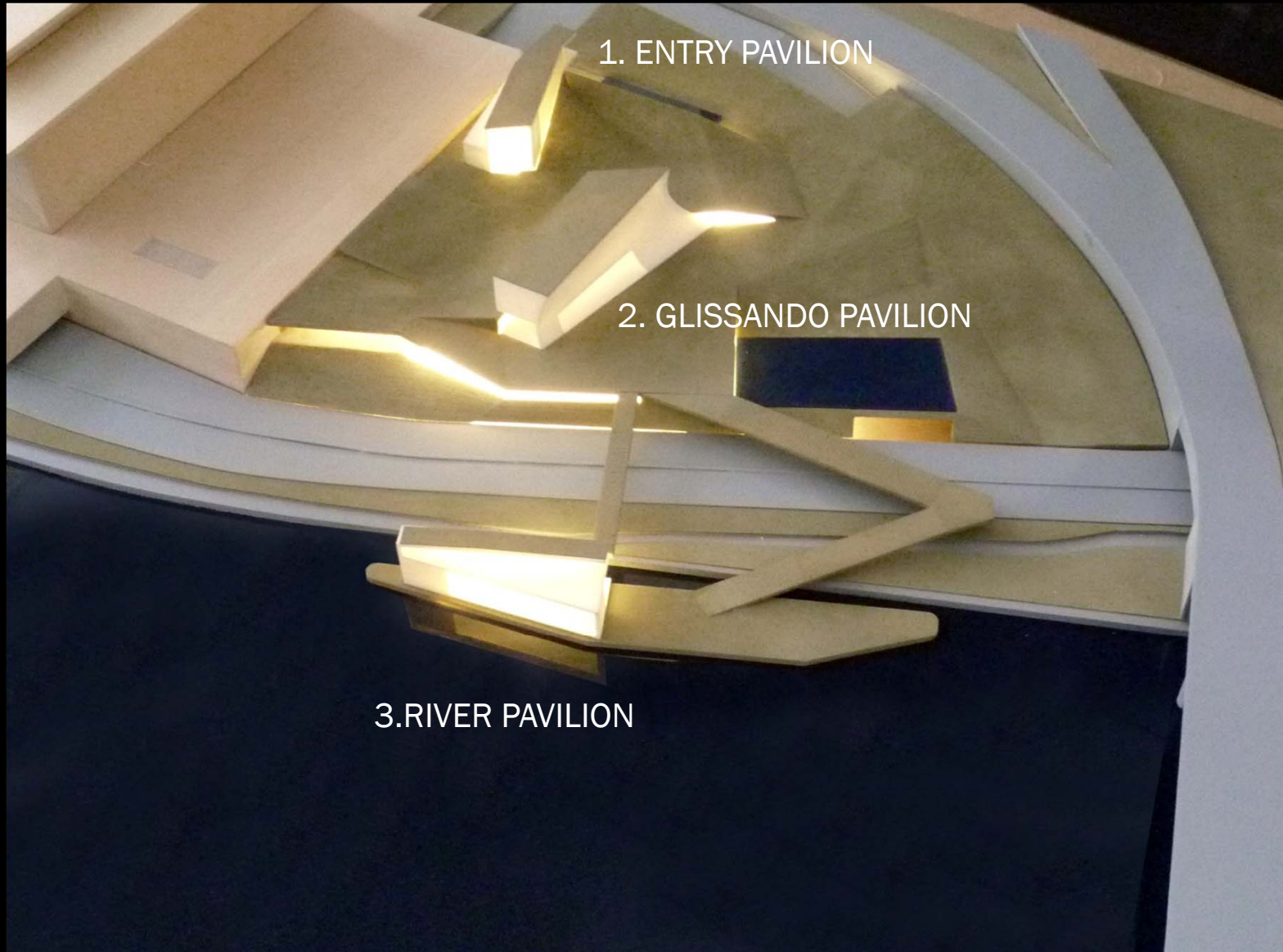

1. ENTRY PAVILION

2. GLISSANDO PAVILION

3. RIVER PAVILION

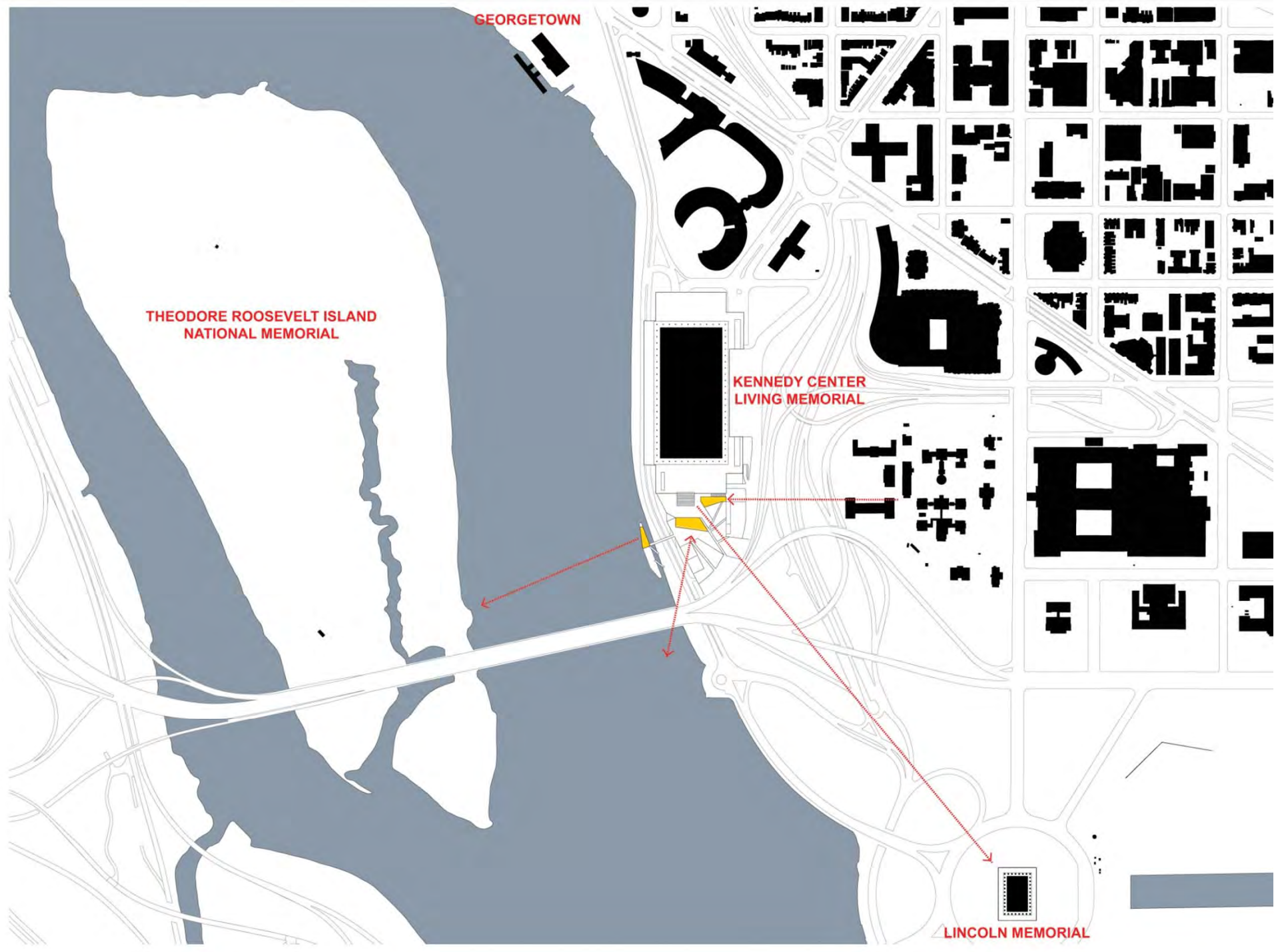

GEORGETOWN

THEODORE ROOSEVELT ISLAND
NATIONAL MEMORIAL

KENNEDY CENTER
LIVING MEMORIAL

LINCOLN MEMORIAL

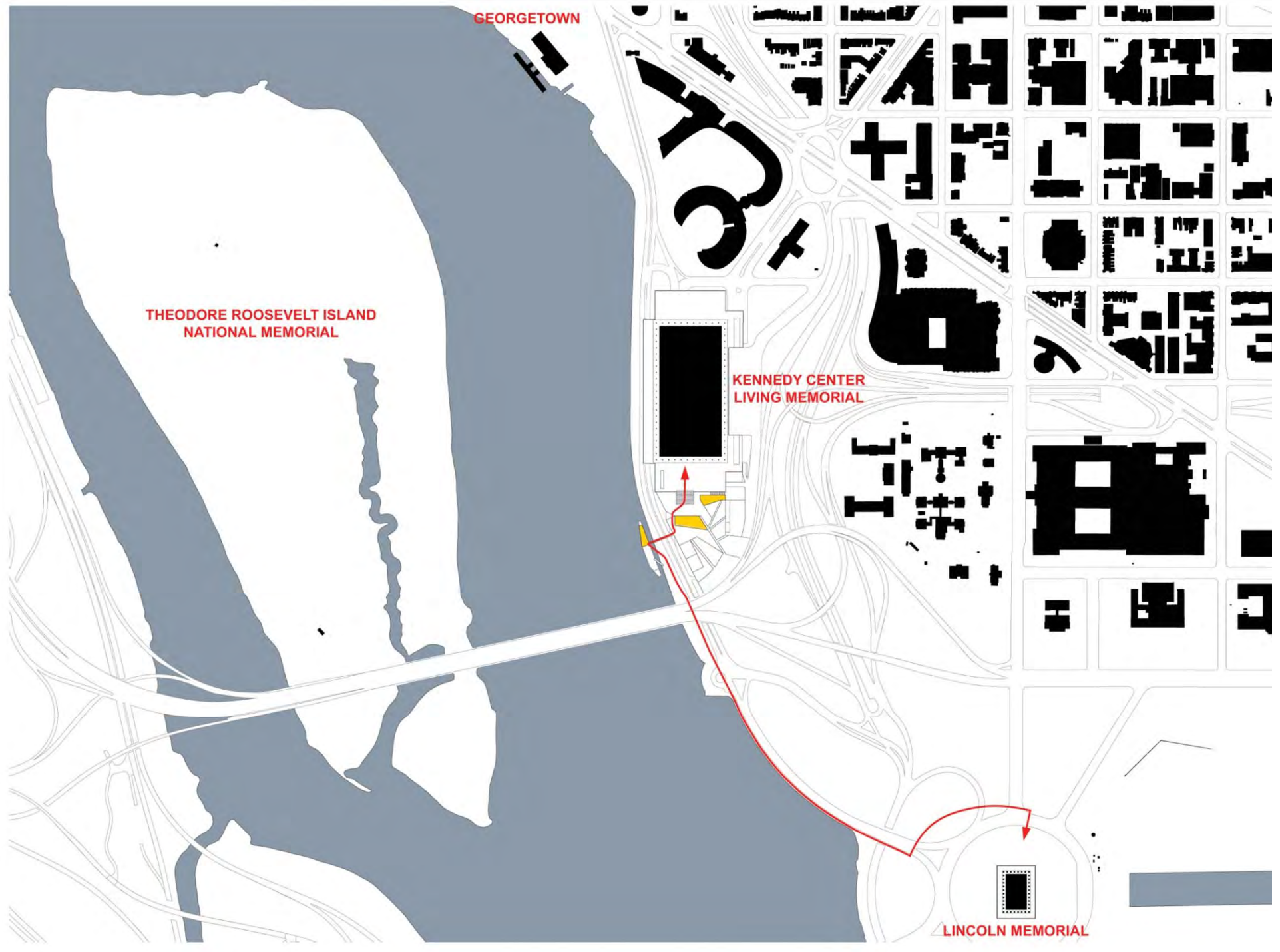

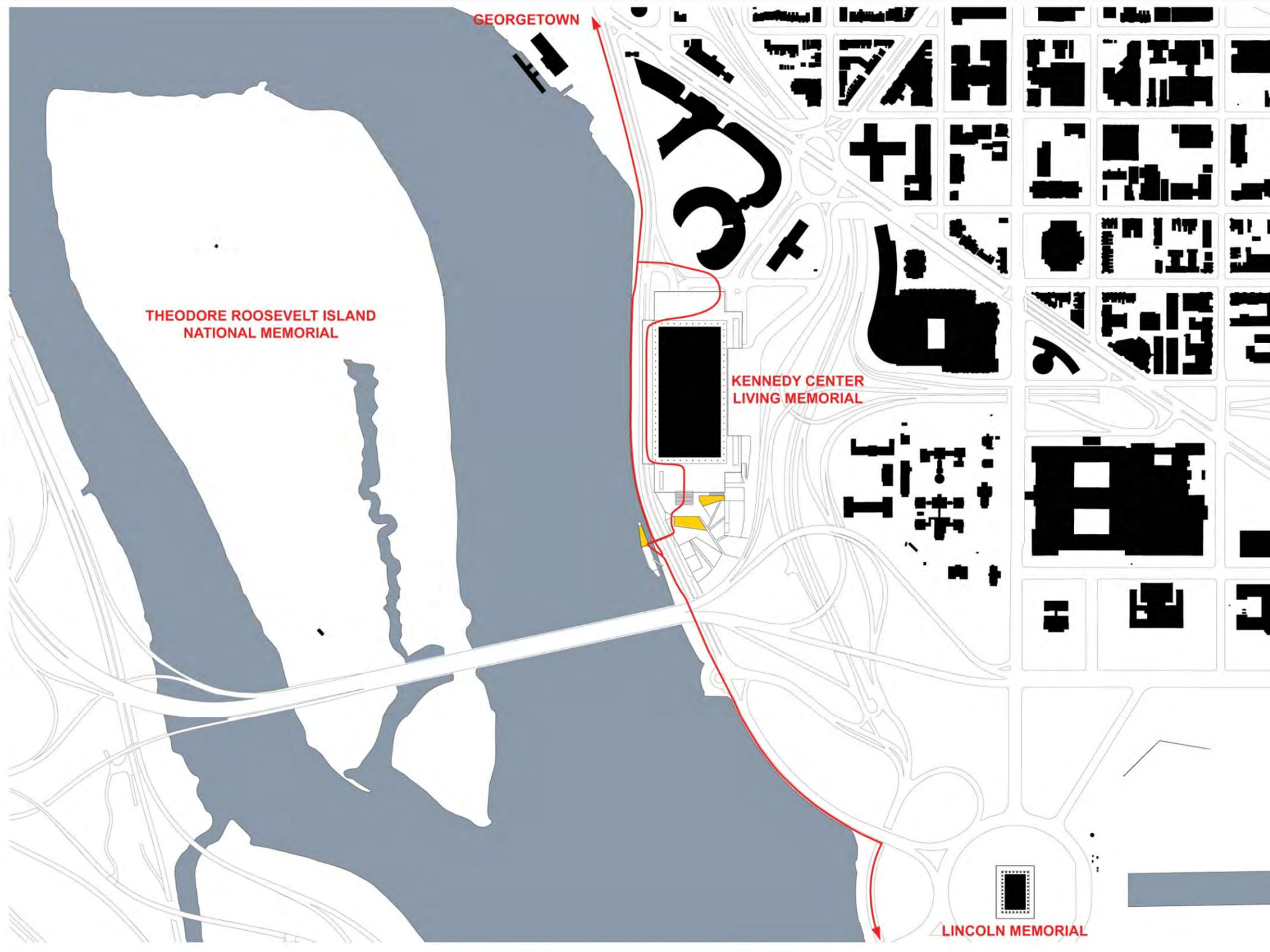

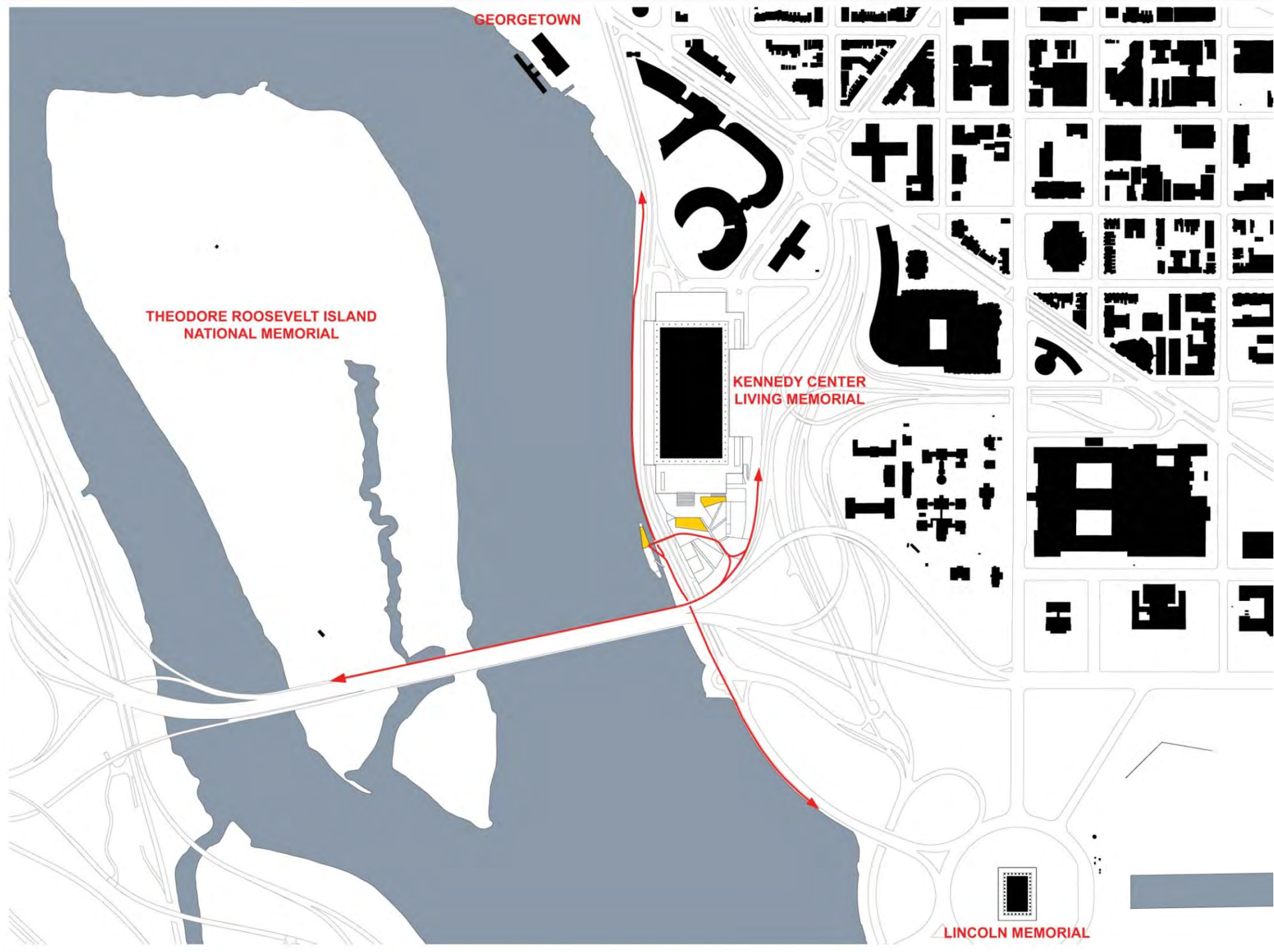

GEORGETOWN

THEODORE ROOSEVELT ISLAND
NATIONAL MEMORIAL

KENNEDY CENTER
LIVING MEMORIAL

LINCOLN MEMORIAL

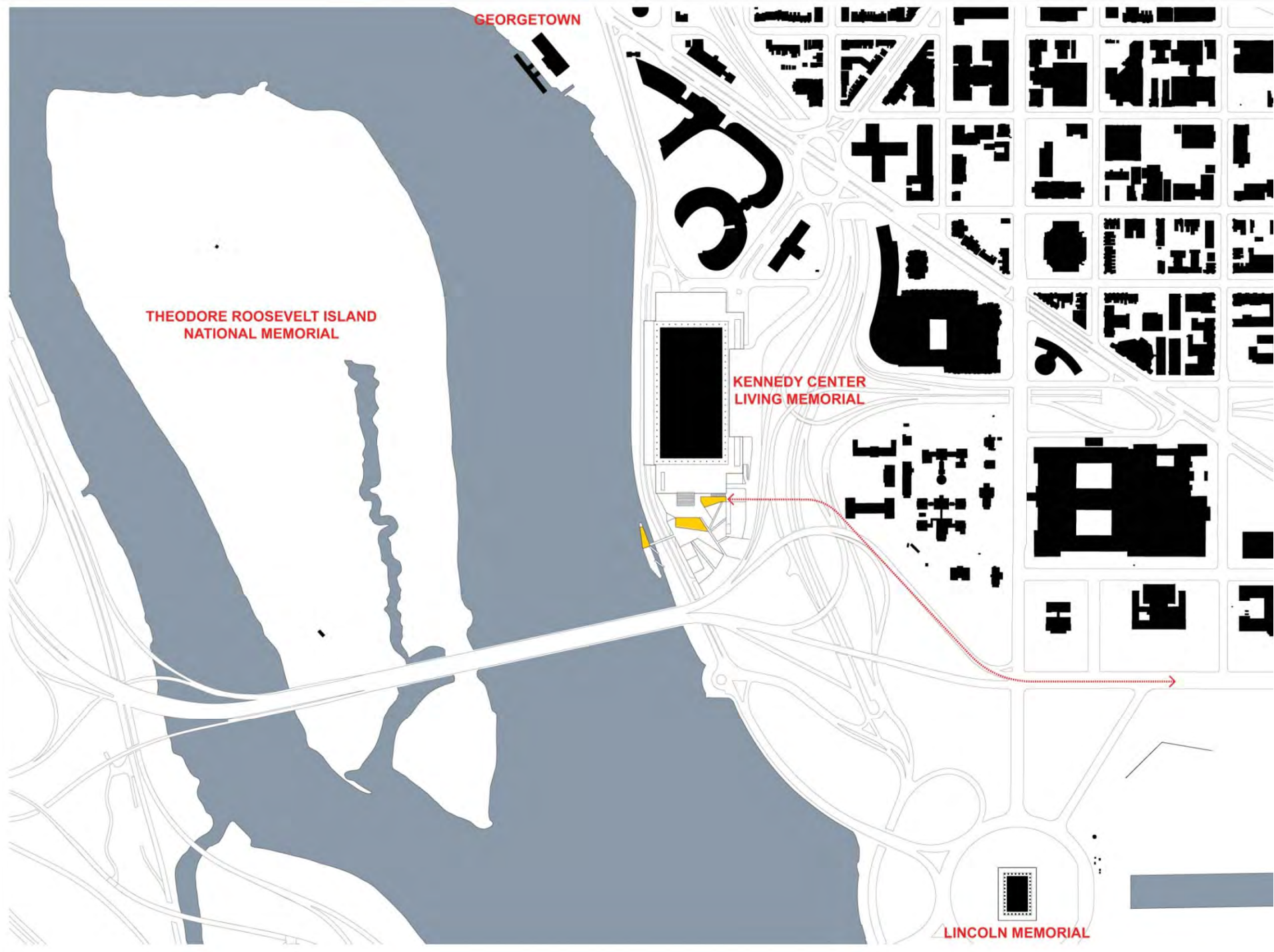

GEORGETOWN

THEODORE ROOSEVELT ISLAND
NATIONAL MEMORIAL

KENNEDY CENTER
LIVING MEMORIAL

LINCOLN MEMORIAL

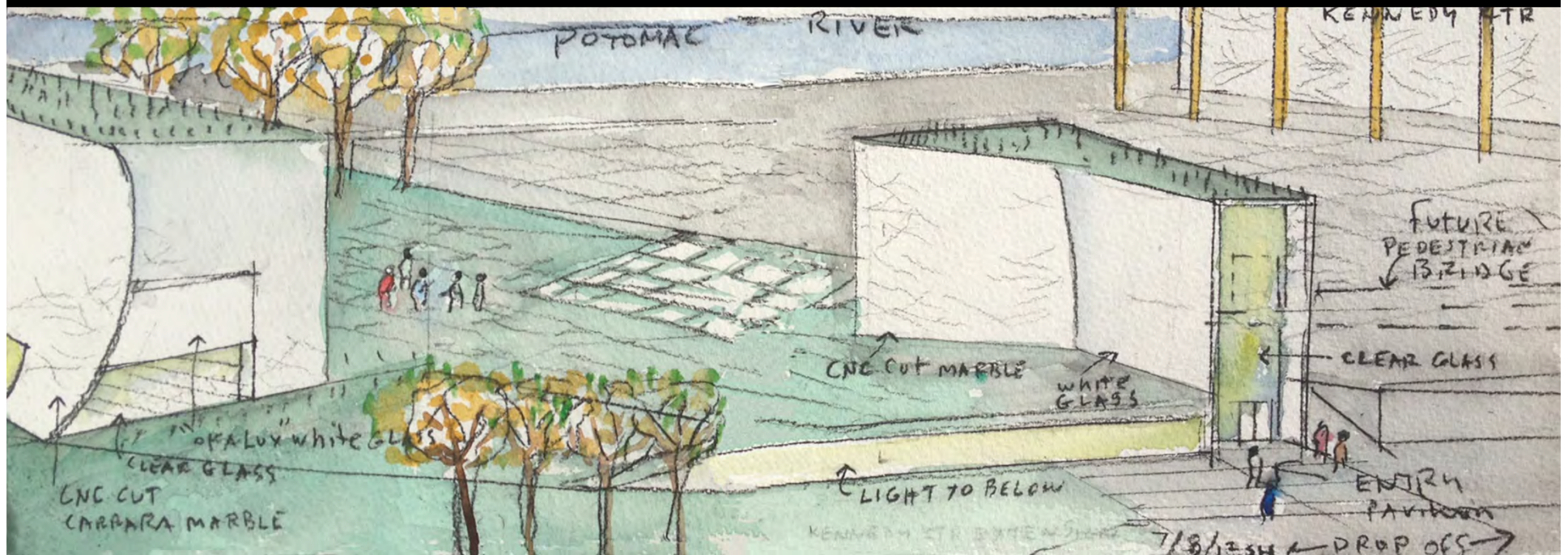

Entry Pavilion

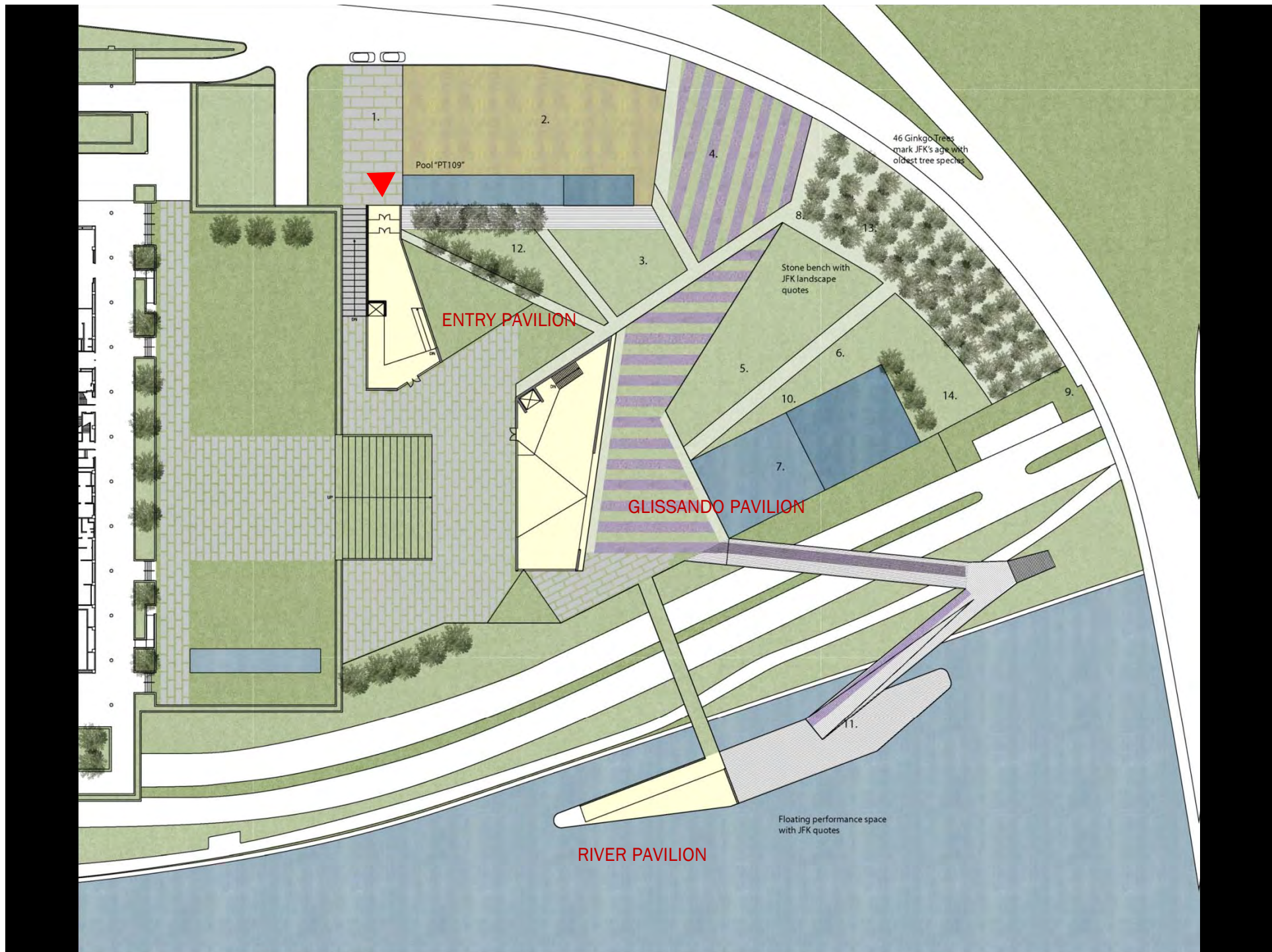



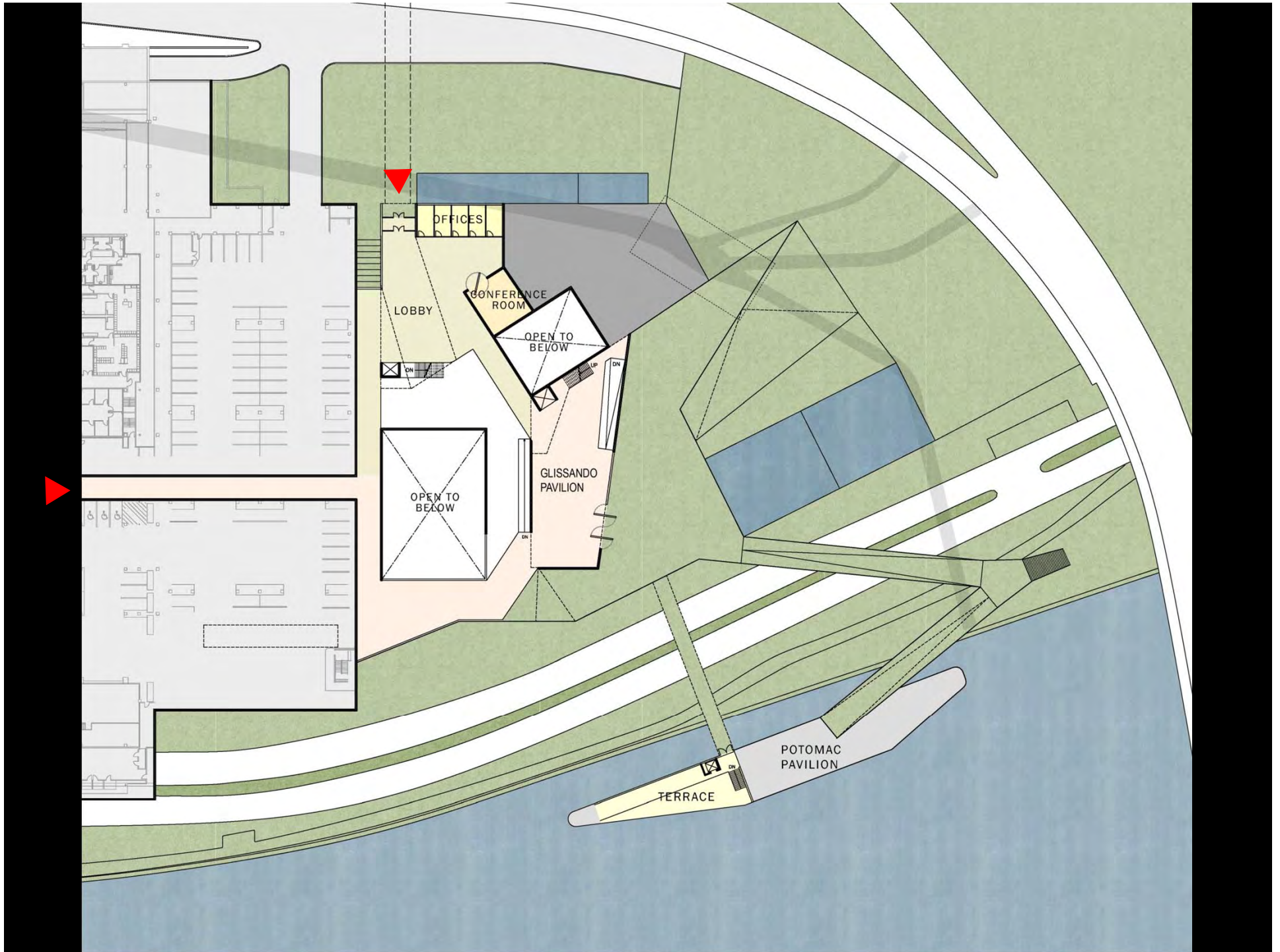





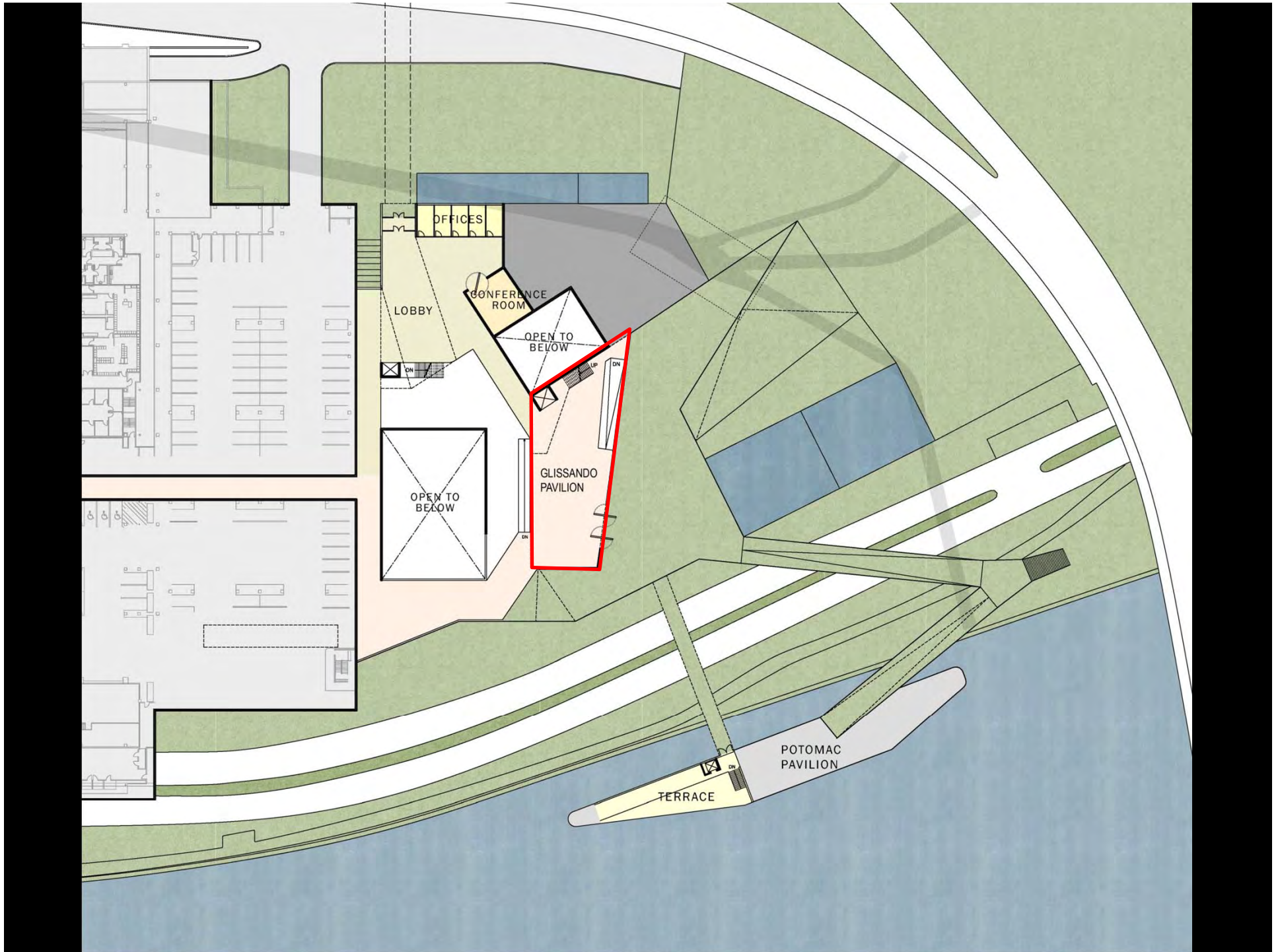

GLISSANDO
PAVILION
KEENE
CENTER
EXHIBITION
(PARIS)
6/28/12
S.H.

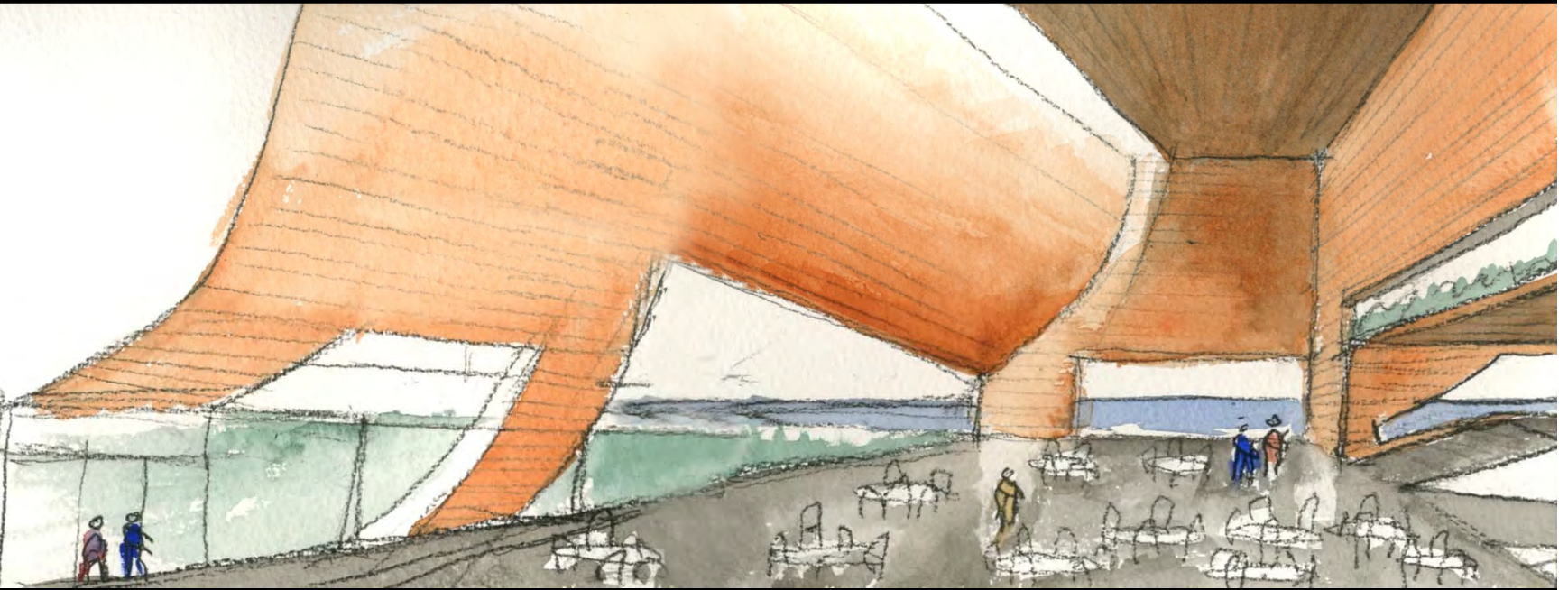



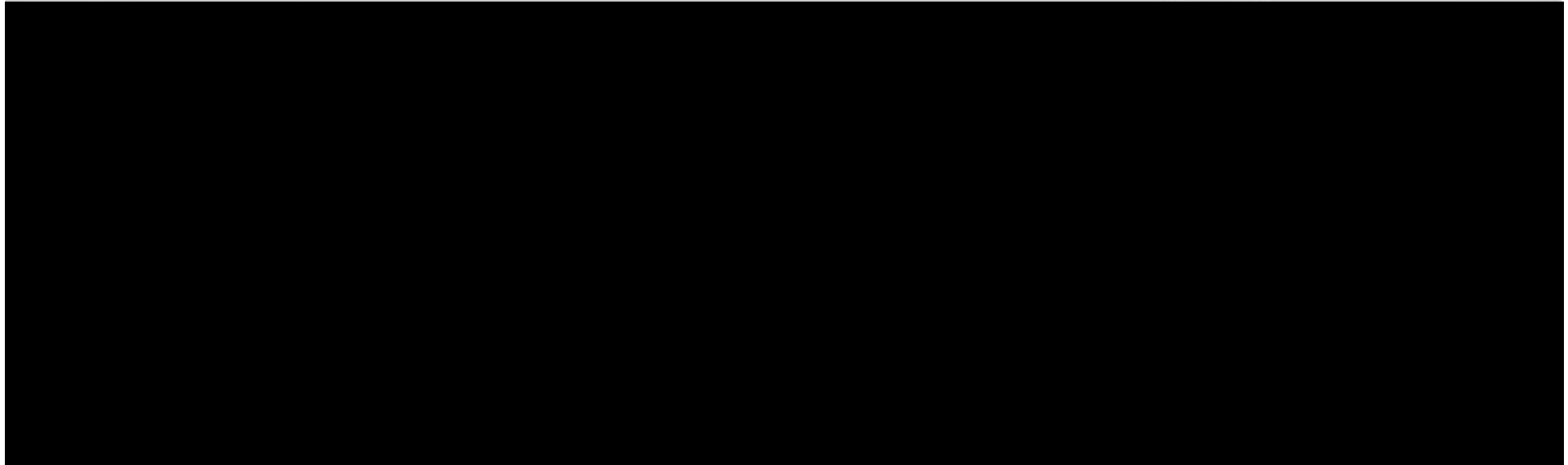
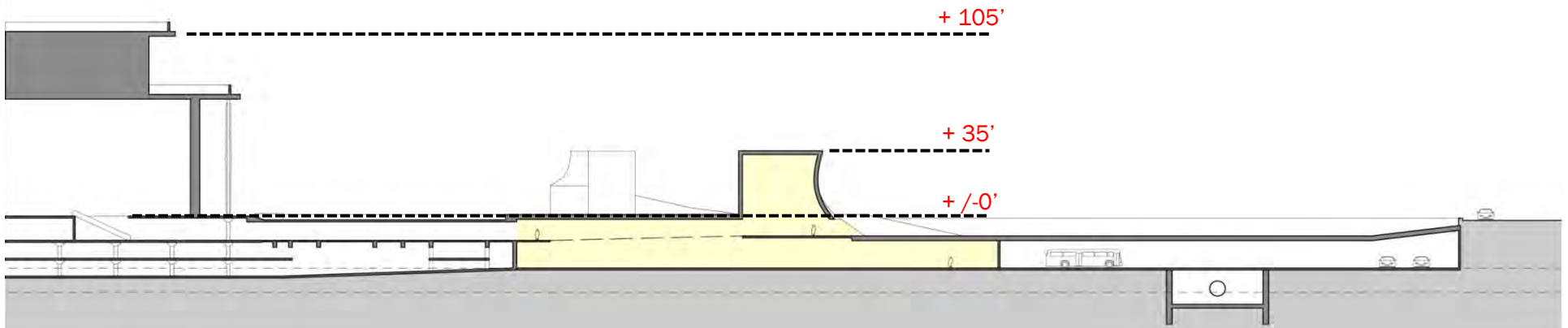



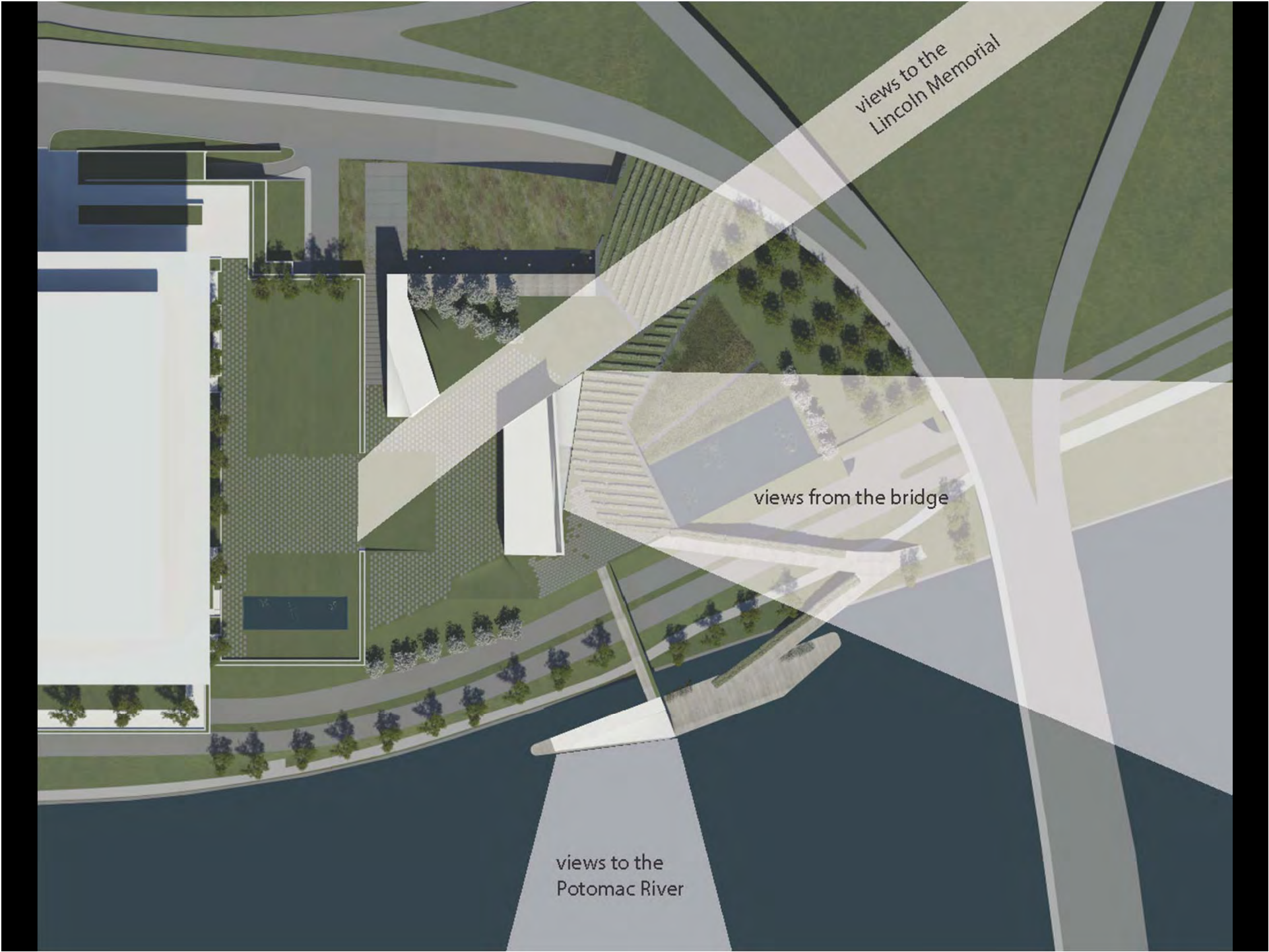

This architectural site plan illustrates a waterfront development project. The plan features a large, light-colored building complex on the left, a green landscaped area with a small pond in the center, and a bridge crossing the Potomac River at the bottom. Three semi-transparent, light-colored triangular overlays highlight specific view corridors: one pointing towards the Lincoln Memorial, another from the bridge, and a third towards the Potomac River. The plan includes various landscape elements like trees, paths, and parking lots, as well as infrastructure like roads and a bridge.

views to the
Lincoln Memorial

views from the bridge

views to the
Potomac River

