



Development Concept Plan

Ebey's Landing National Historical Reserve GMP/EIS

SOUTH GATEWAY

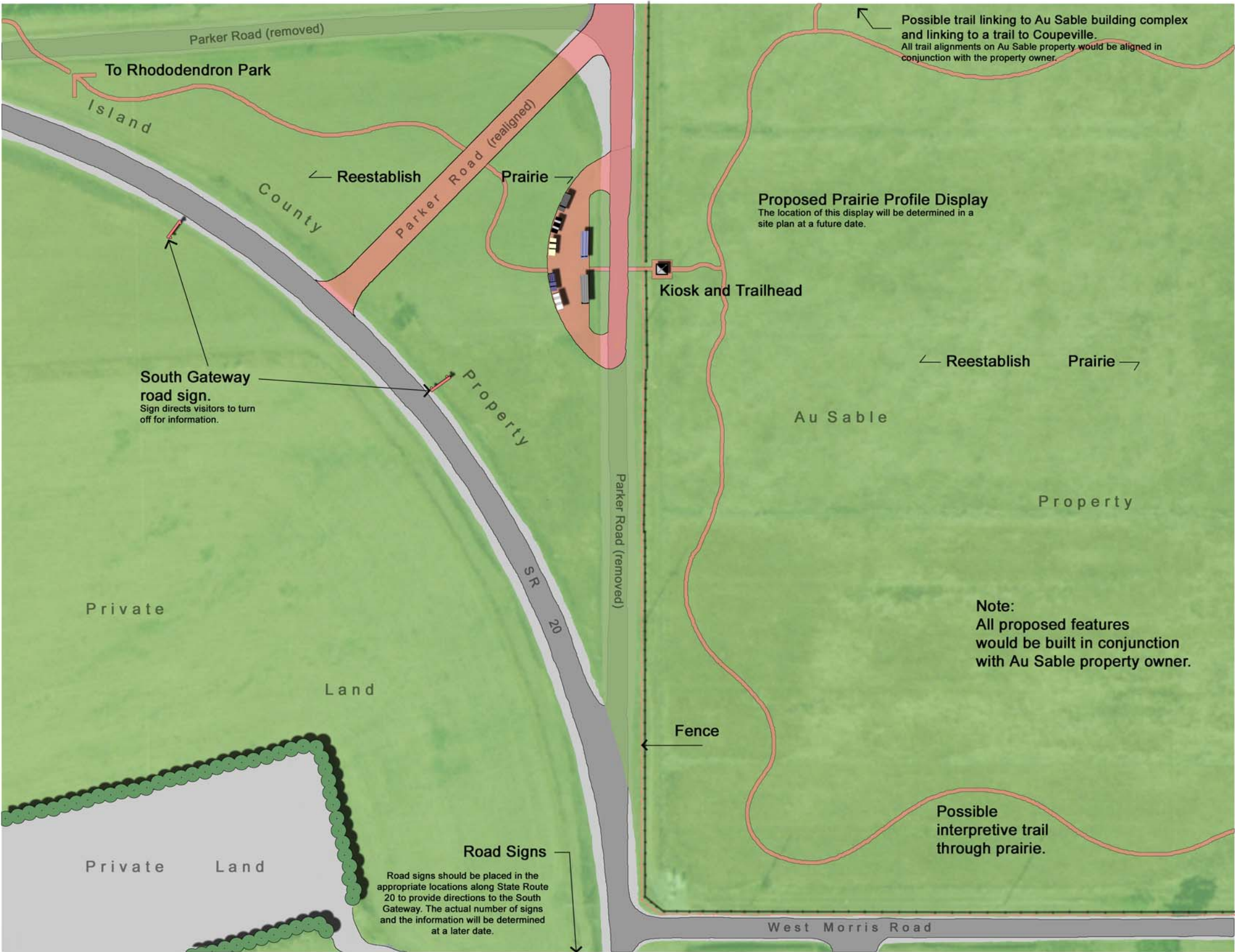

Figure 15

Produced by
National Park Service, Pacific West Region
Planning Program
Seattle, Washington
January 2005

Notes:
Aerial photograph was derived from NPS
Geographic Information Systems. The overlay
graphics were produced by Michael J. Hankinson
using Photoshop 7.0.

Information presented in this plan is based on
the draft GMP.

Existing Landscape Character



The South Gateway is rural in character despite its proximity to State Route 20 (SR 20). Today, the surrounding landscape is largely open, with some patches of agricultural land, remnant prairie, and buildings. The open space as seen in the picture above, is located on Island County land between SR 20 and Parker Road.



This is an image of Parker Road, which remains as a two-lane paved rural road with minimal shoulders and side ditches.



In addition to the roads and open spaces, fences and buildings characterize the landscape. In this area, fences are simple wooden posts strung with wire. Buildings are primarily domestic and rural in character. The Au Sable property is in the background.

Development Concept Plan Proposals

