

#### VOLUME (SITE 1):

CUT = 39.2 CY

GRAVEL = 39.2 CY

#### DISTURBANCE AREA (SITES 1&2):

##### WETLAND:

TEMPORARY: = 0.23 AC

PERMANENT: = 0.03 AC

##### UPLAND:

TEMPORARY: = 0.35 AC

PERMANENT: = 0.04 AC

## PLAN

SCALE: 1"=40'

### LEGEND:

- EXISTING PIPELINE
- PIPELINE ROW
- TEMPORARY WORKSPACE
- WETLAND BOUNDARY
- INDEX CONTOUR
- INTERMEDIARY CONTOUR
- ACCESS ROAD EDGE
- GEOWEB MAT
- CULVERT

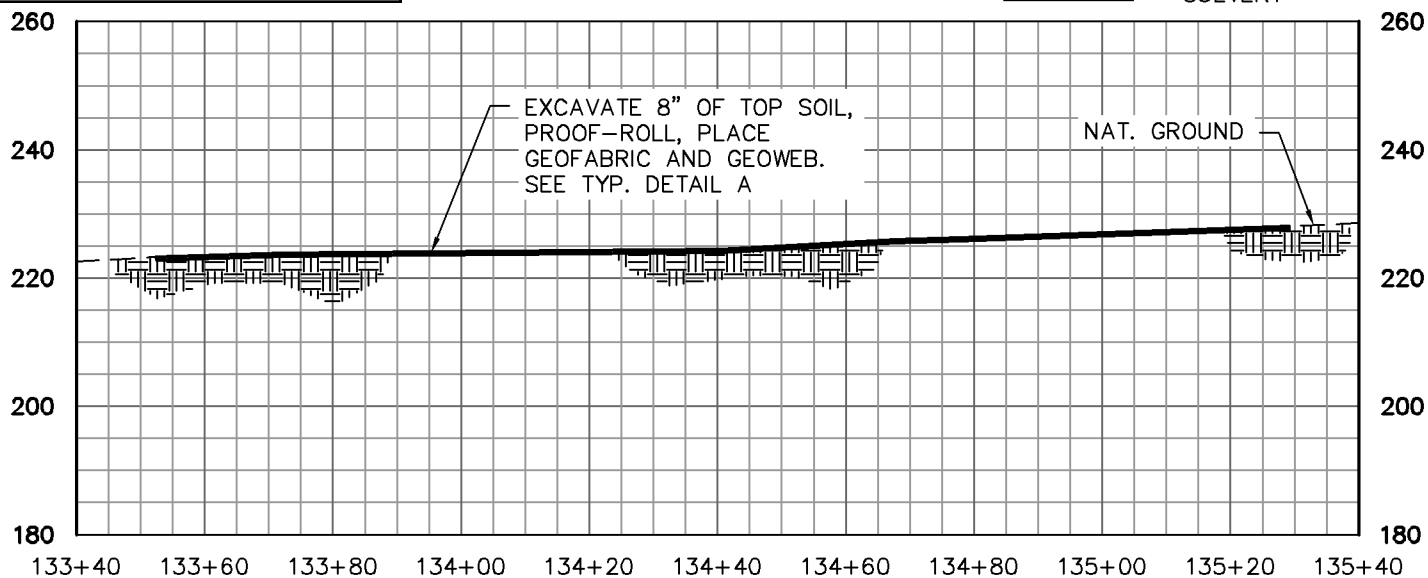

## PROFILE

SCALE: 1"=30'

## SITE 1

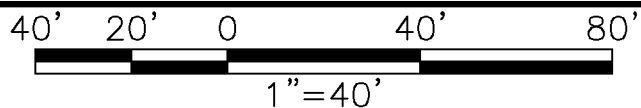

Tennessee  
Gas Pipeline  
an El Paso company

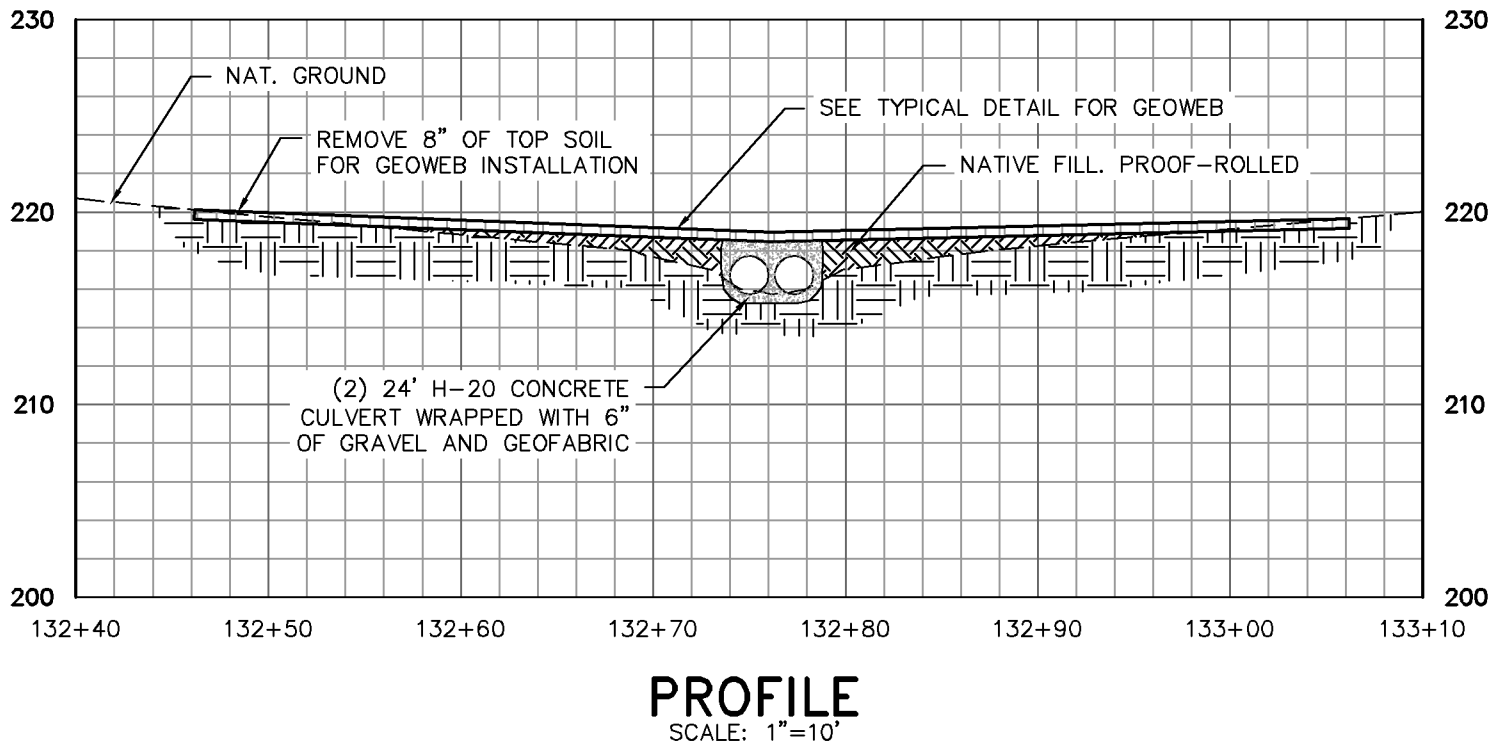
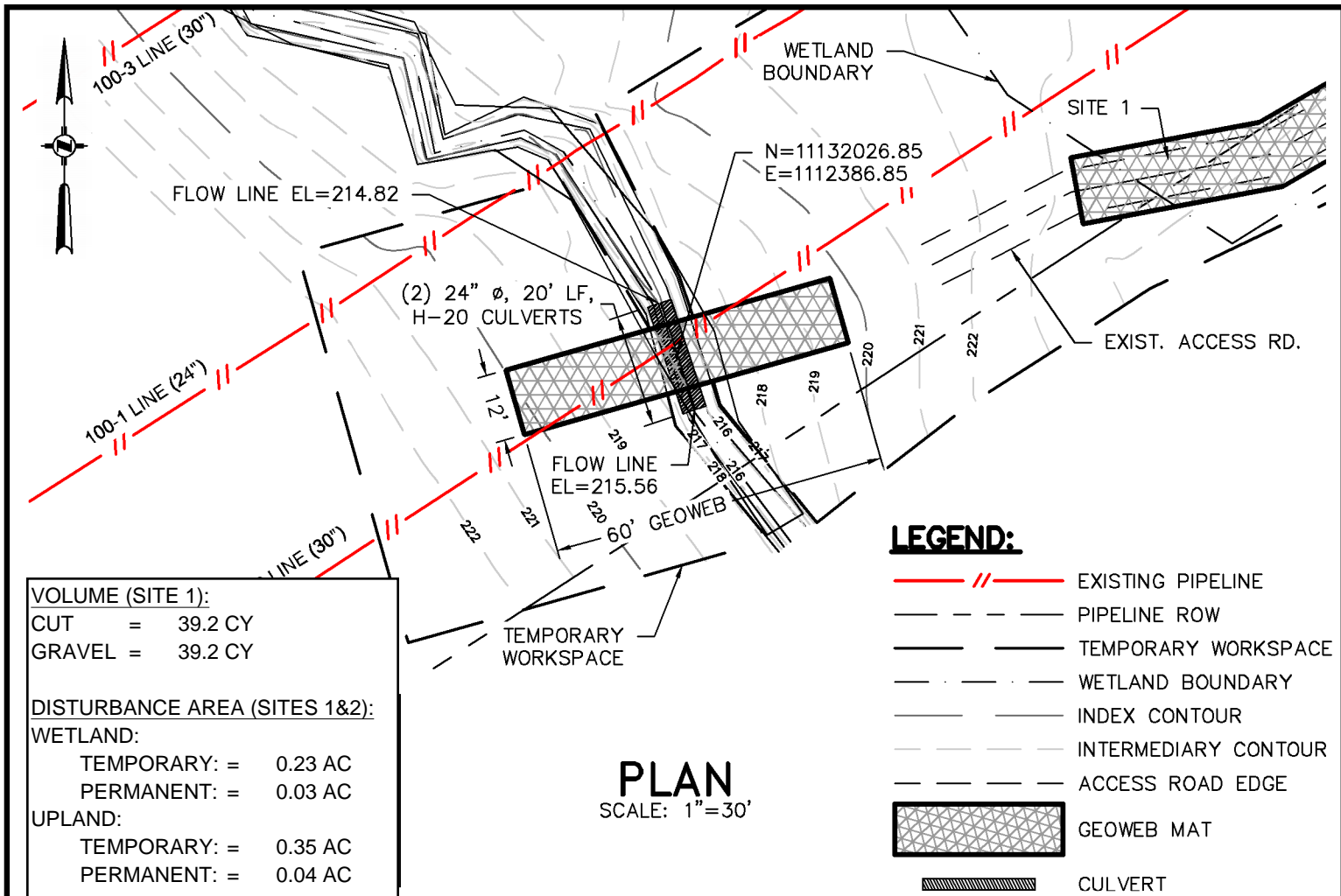

**SITE 2**

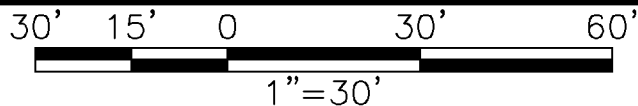

**Tennessee  
Gas Pipeline**  
 an El Paso company

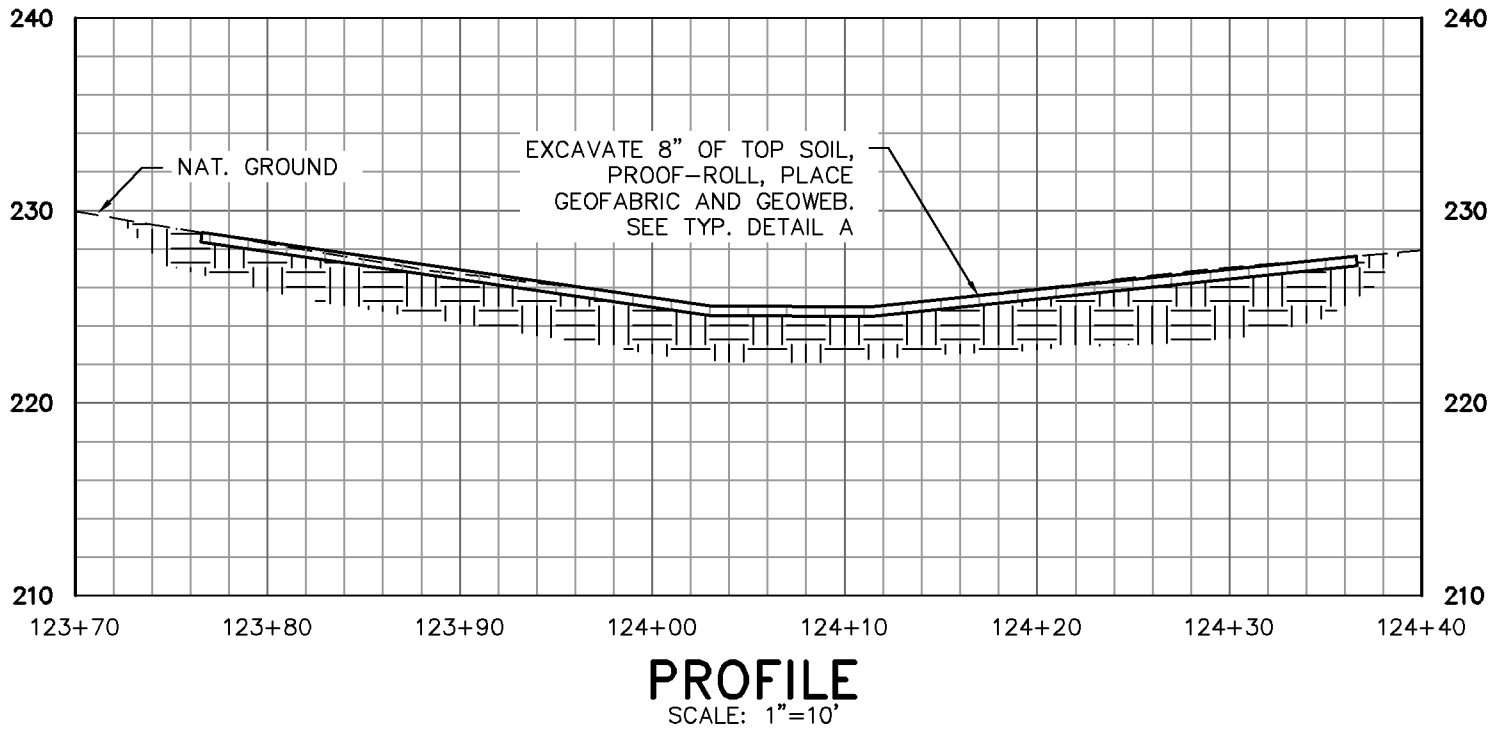
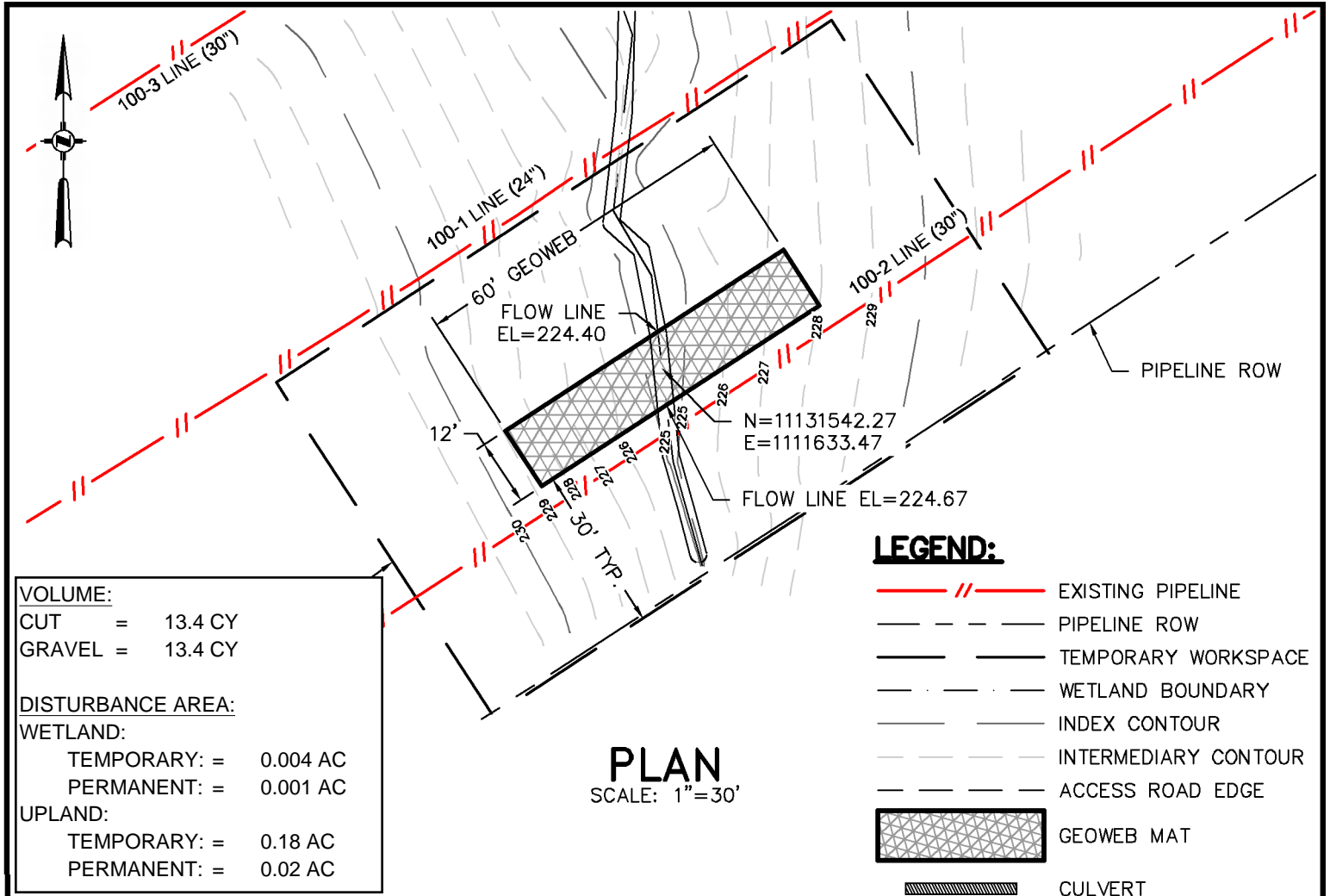

**SITE 3**

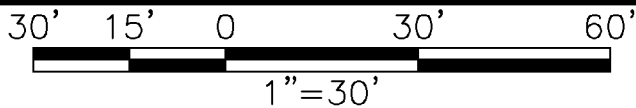

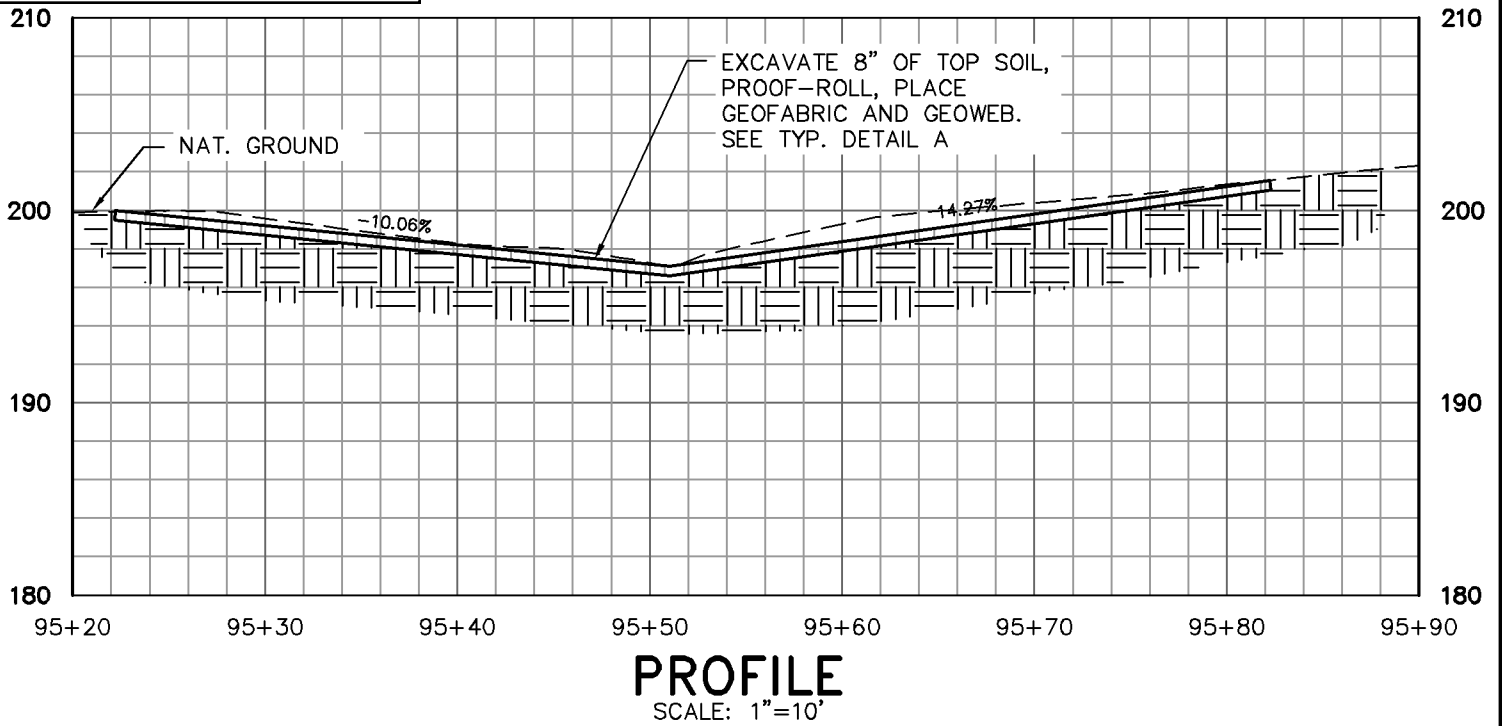
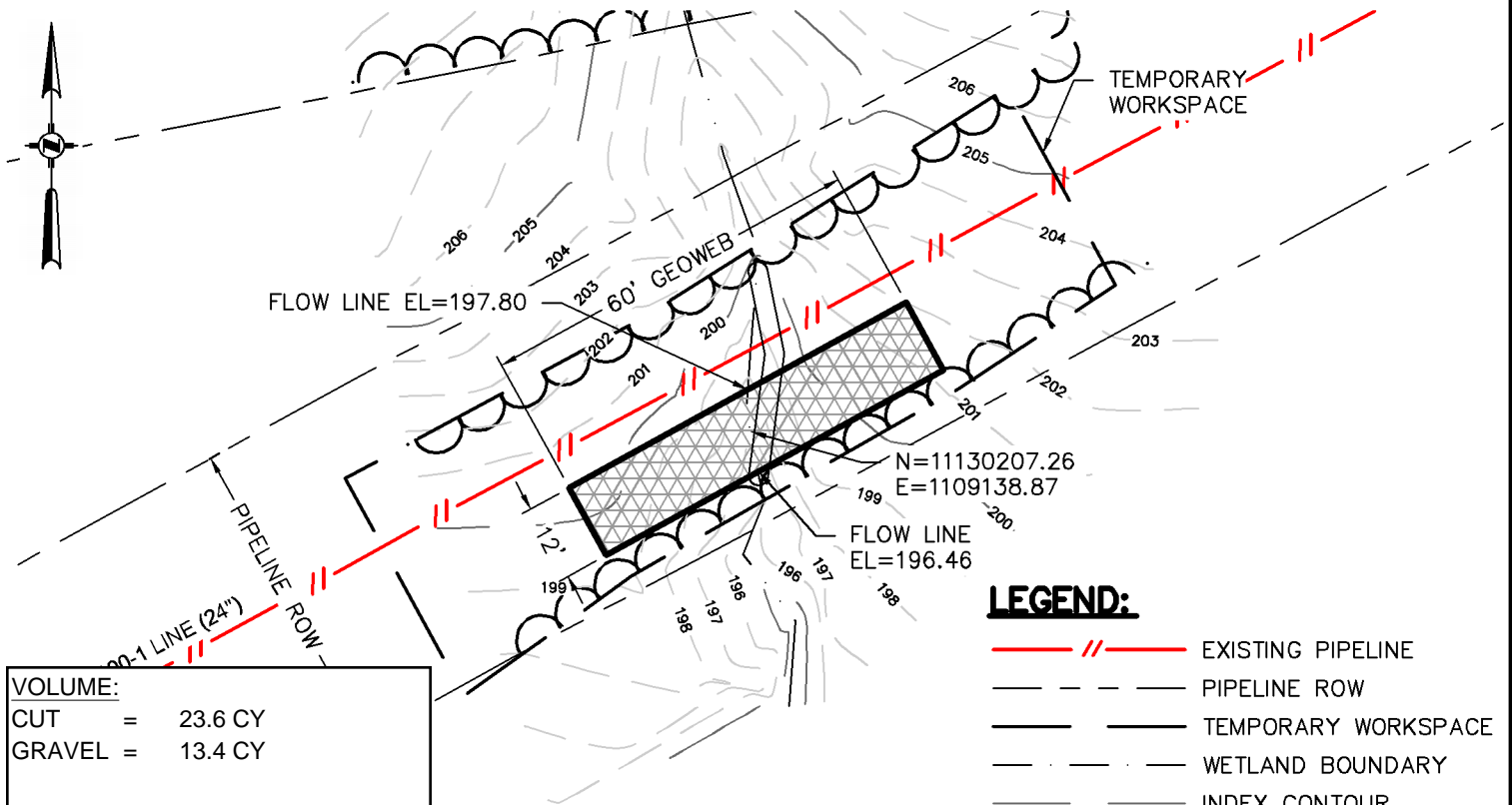

**SITE 4**

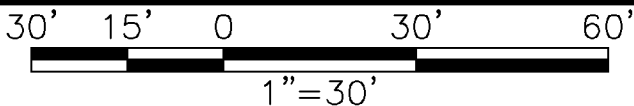

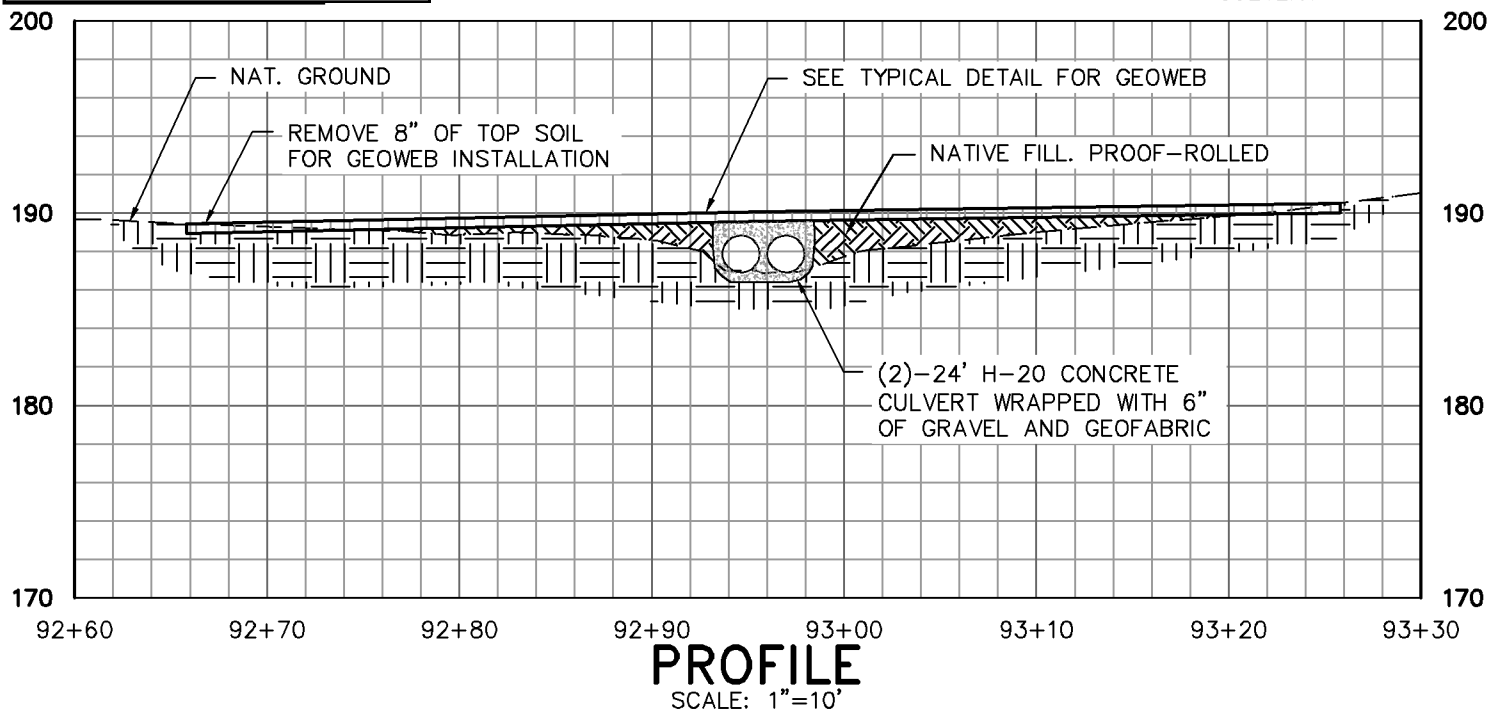
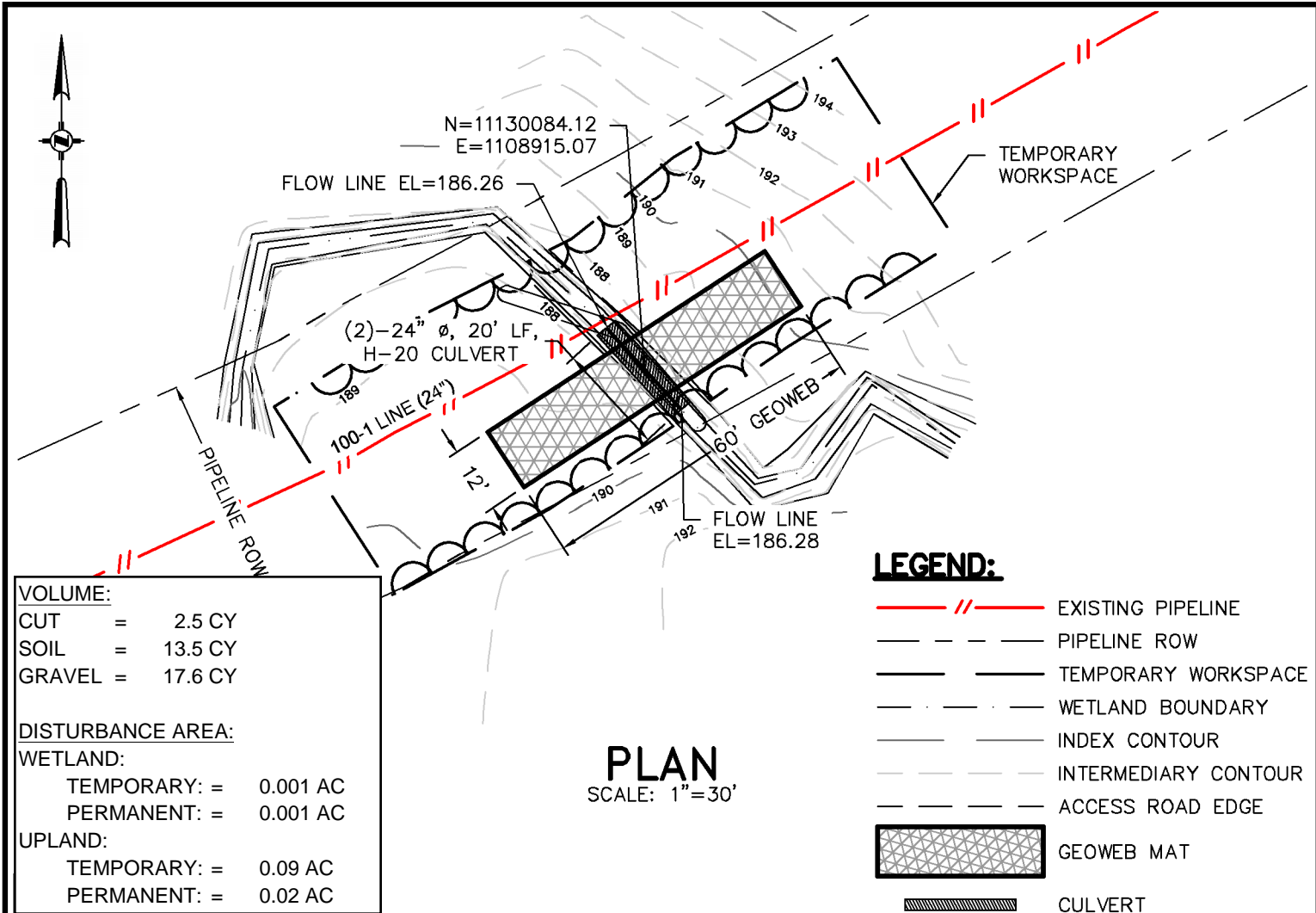

**SITE 5**

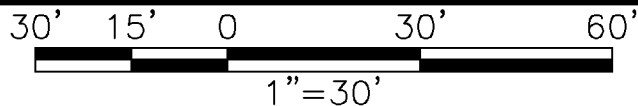

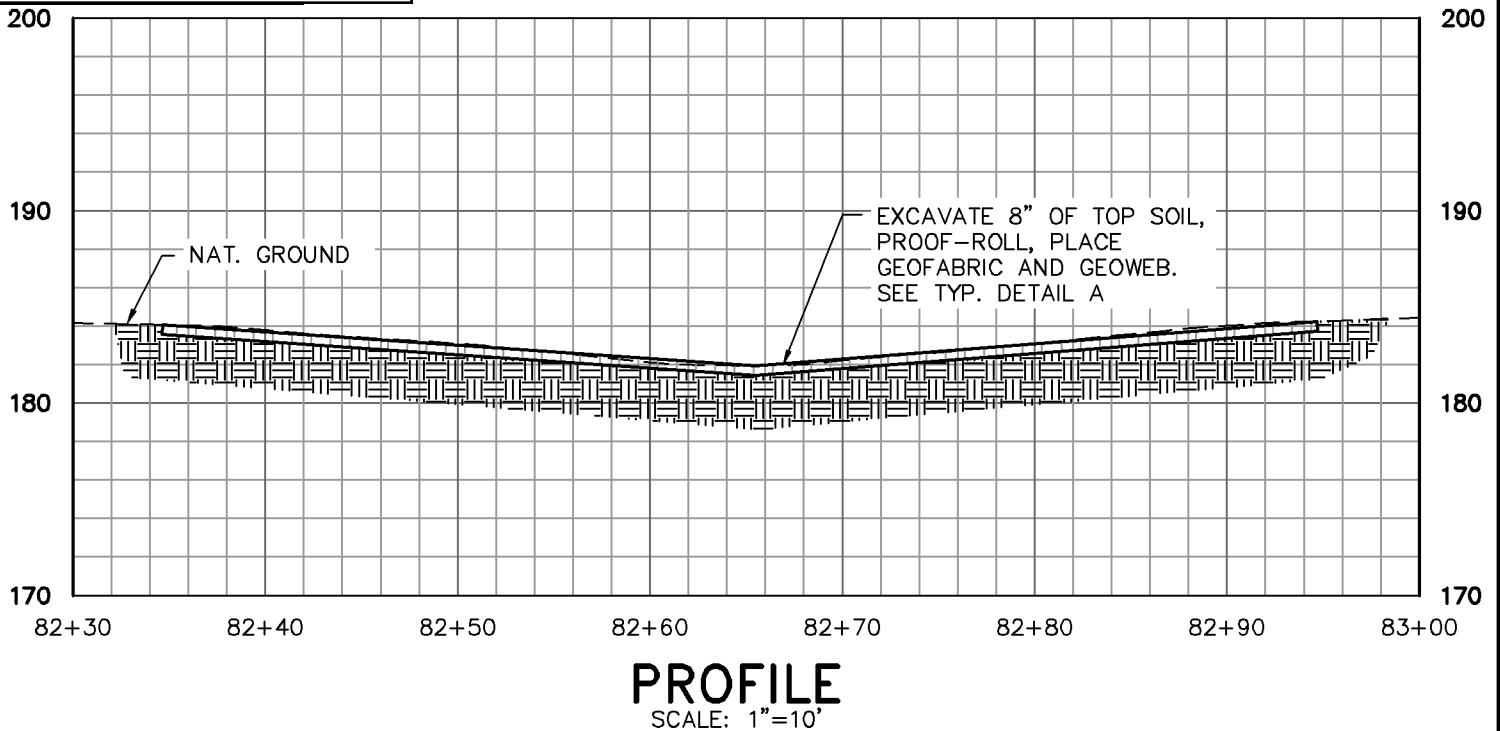
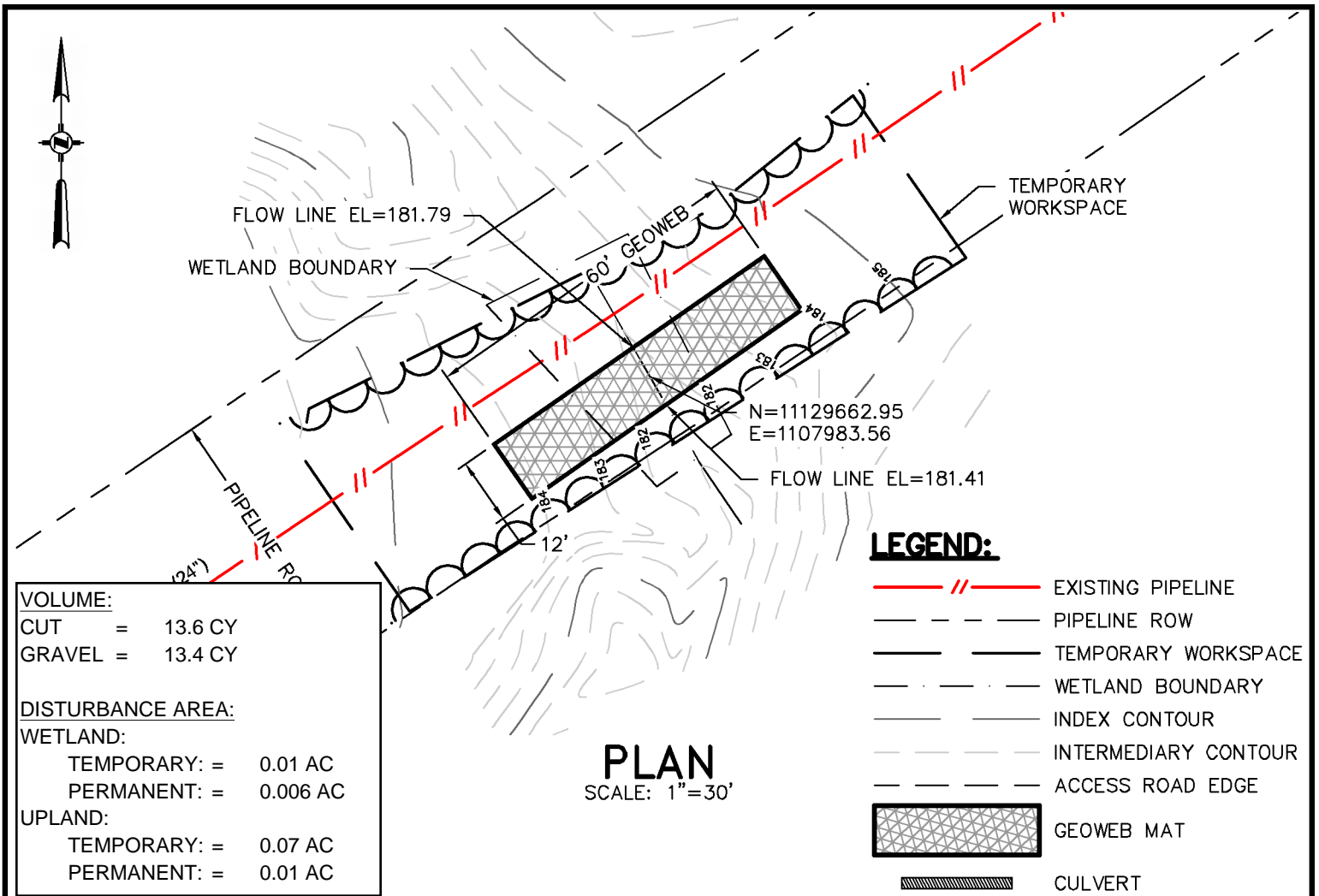

**SITE 6**

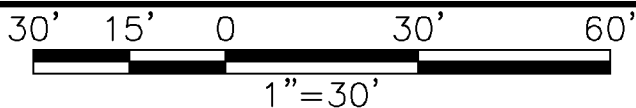

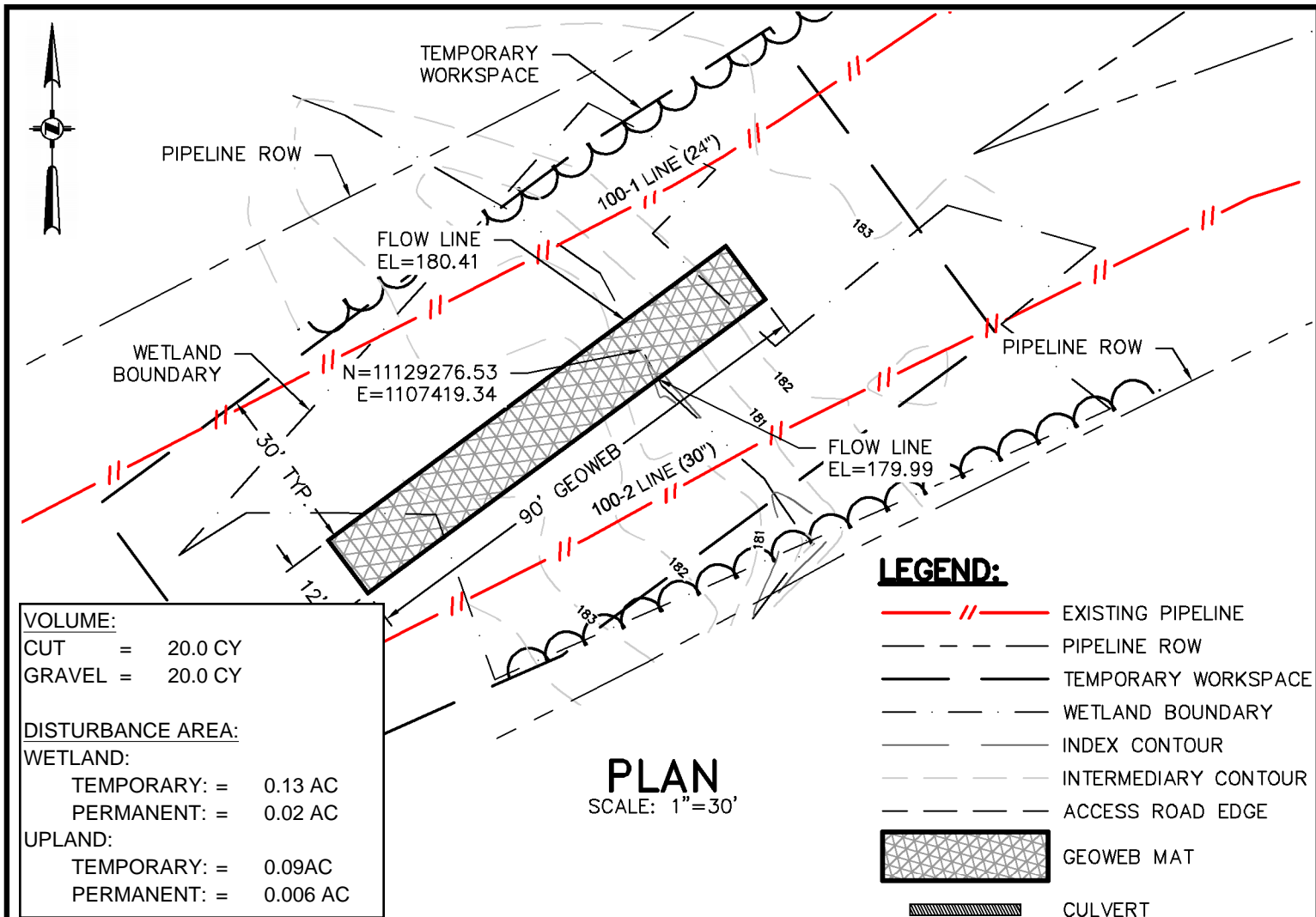

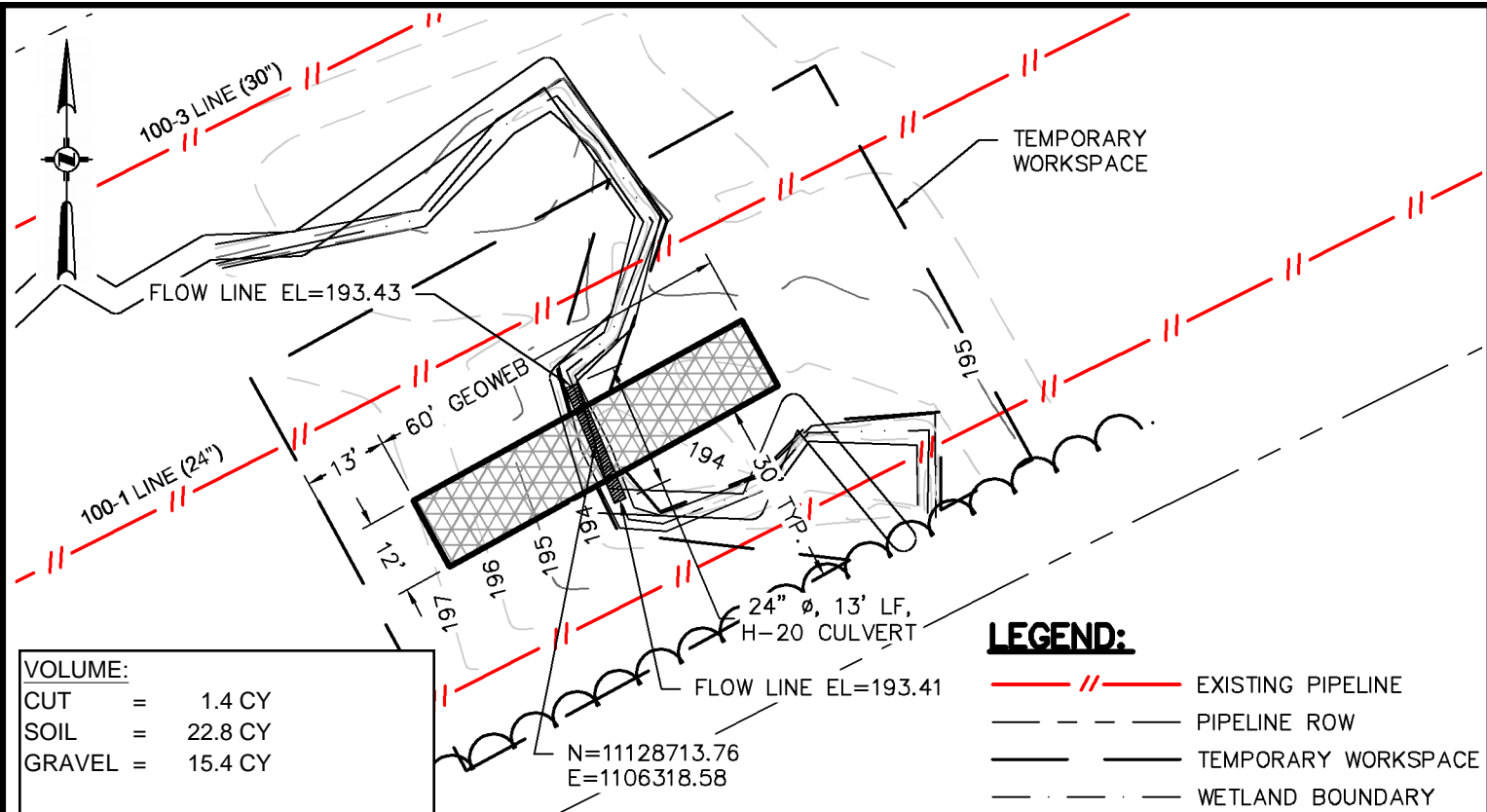

**VOLUME:**

CUT	=	1.4 CY
SOIL	=	22.8 CY
GRAVEL	=	15.4 CY

**DISTURBANCE AREA:**

**WETLAND:**

TEMPORARY:	=	0.004 AC
PERMANENT:	=	0.001 AC

**UPLAND:**

TEMPORARY:	=	0.13 AC
PERMANENT:	=	0.02 AC

- LEGEND:**
- EXISTING PIPELINE
  - PIPELINE ROW
  - TEMPORARY WORKSPACE
  - WETLAND BOUNDARY
  - INDEX CONTOUR
  - INTERMEDIARY CONTOUR
  - ACCESS ROAD EDGE
  - GEOWEB MAT
  - CULVERT

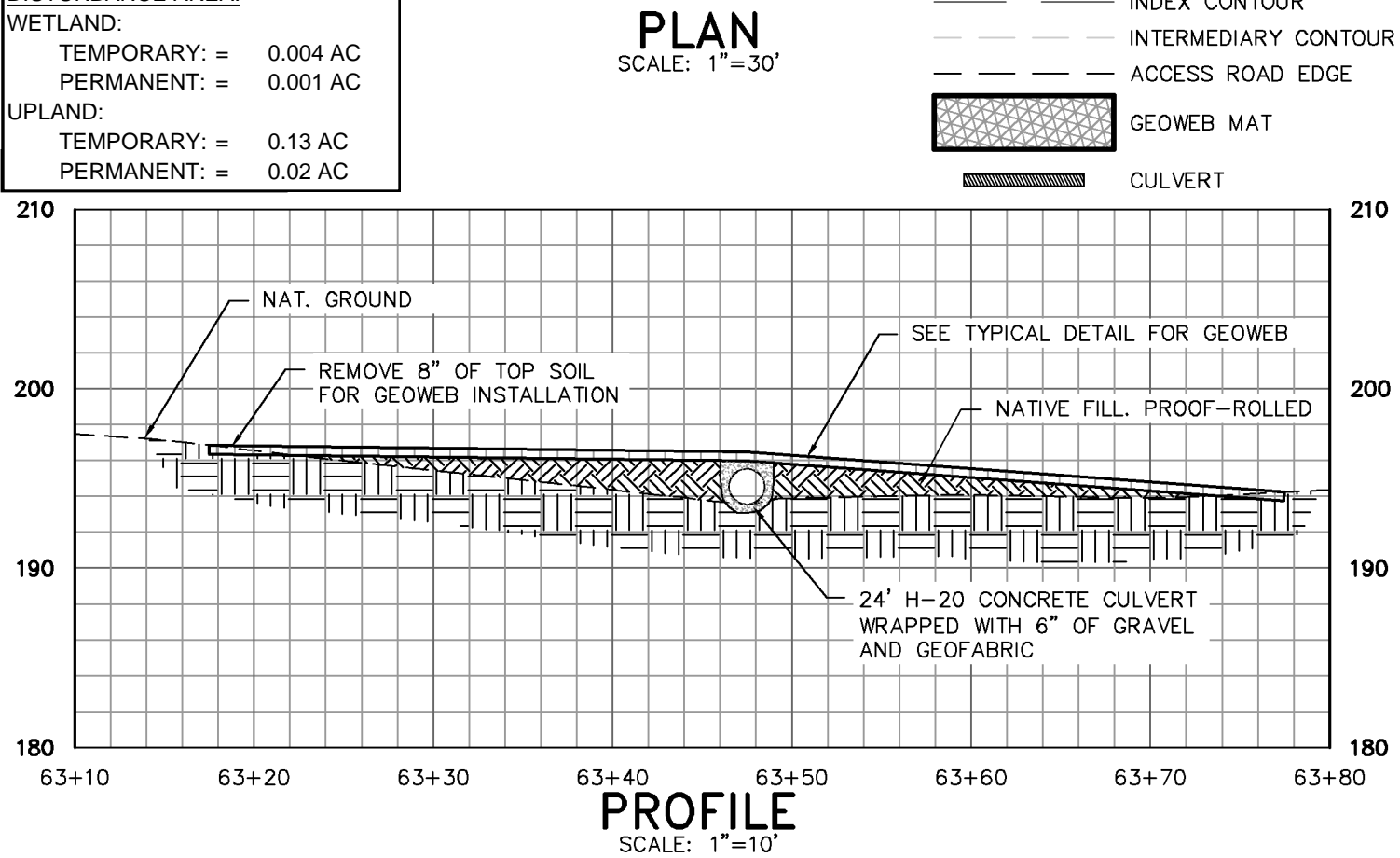

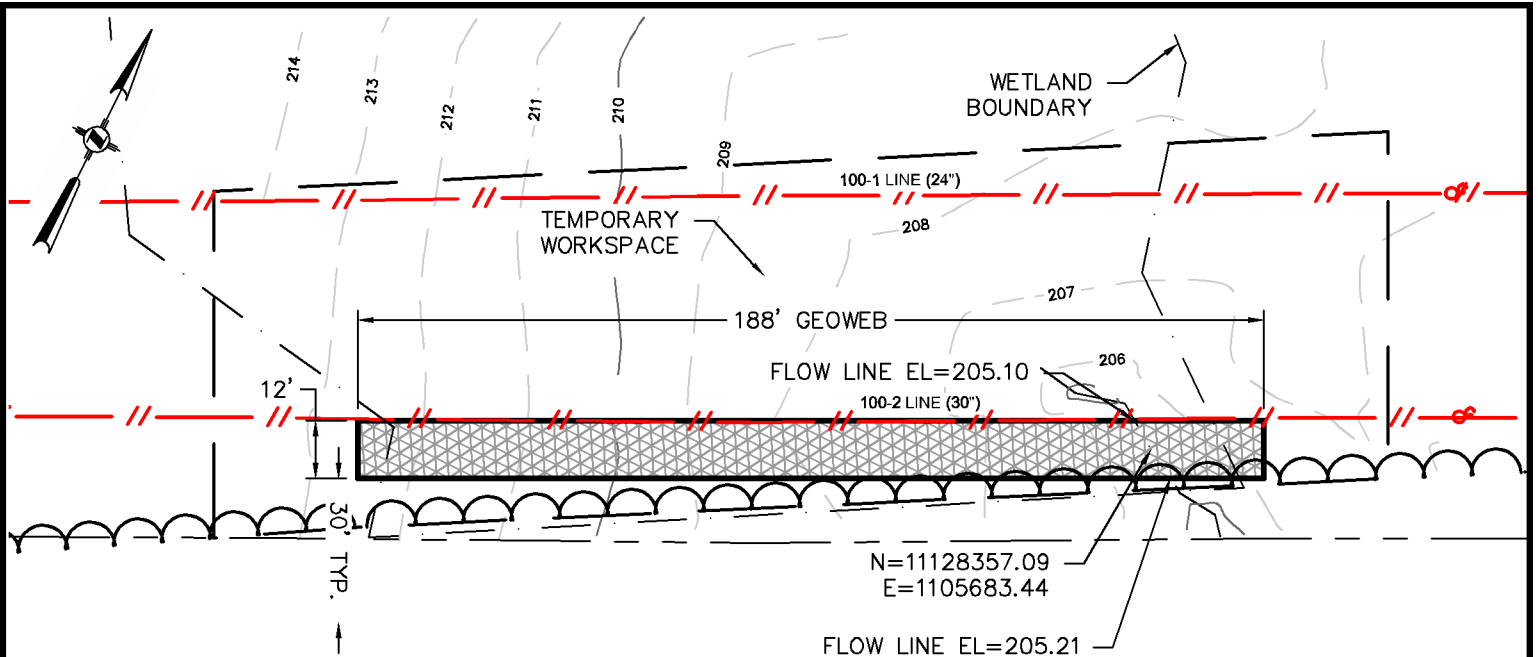

**VOLUME:**

CUT = 41.9 CY  
GRAVEL = 41.9 CY

**DISTURBANCE AREA:**

**WETLAND:**

TEMPORARY: = 0.25 AC  
PERMANENT: = 0.05 AC

**UPLAND:**

TEMPORARY: = 0.10 AC  
PERMANENT: = 0.004 AC

**PLAN**  
SCALE: 1"=40'

**LEGEND:**

- // — EXISTING PIPELINE
- - - PIPELINE ROW
- — — TEMPORARY WORKSPACE
- - - WETLAND BOUNDARY
- - - INDEX CONTOUR
- - - INTERMEDIARY CONTOUR
- - - ACCESS ROAD EDGE
- GEOWEB MAT
- CULVERT

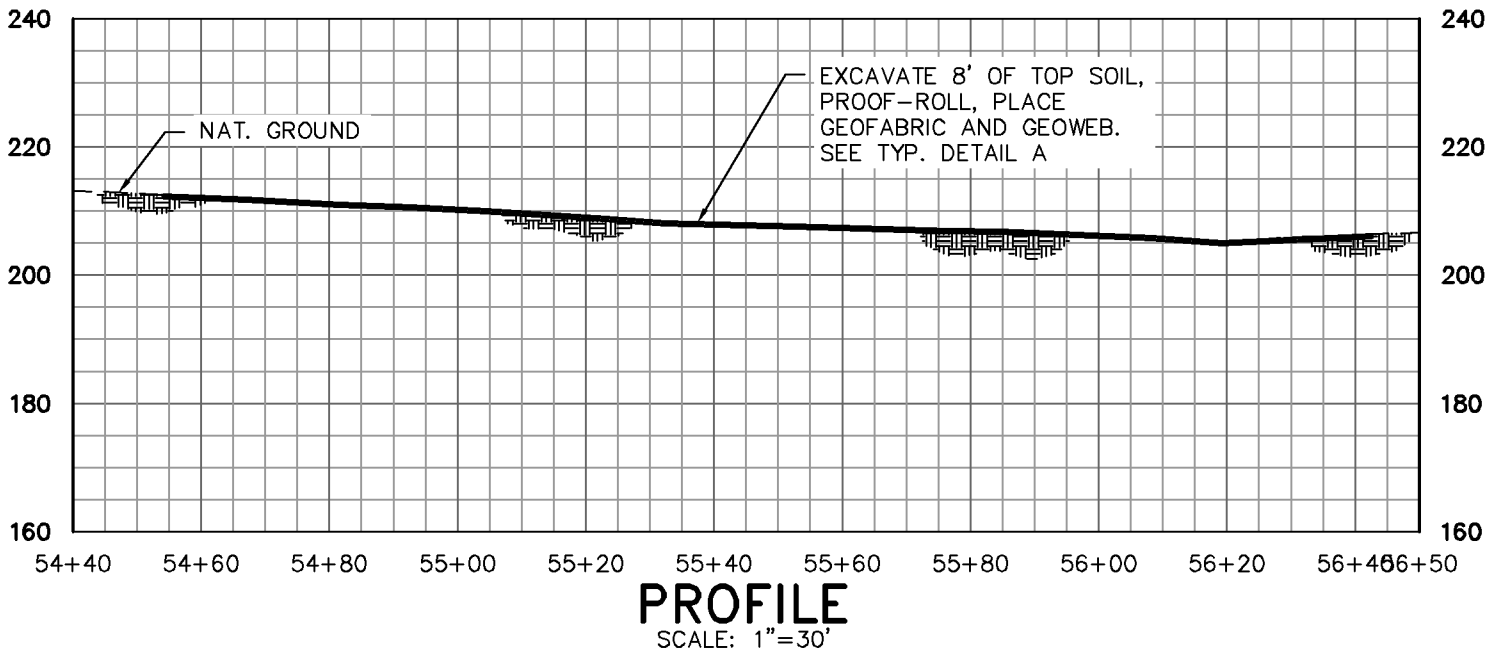

**SITE 9**

