

APPENDIX D. DETAILED BUILDING PROGRAM



NICODEMUS - DETAILED BUILDING PROGRAM

PROGRAMMATIC COMPONENT	NAME	SQ. FT. REQ'D.	USE	
ADMINISTRATION	Superintendent	140	Office	
	Admin Assistant	150	Office	
	Small Conference	64	Meeting	
	Community Planner	64	Cubicle	
	Admin. Clerk	48	Desk	
	Restroom	48	Restroom	
	Break Room	80	General	
	Janitor	20	Building Services	
	Mechanical	80	Building Services	
	ASSIGNABLE SQ. FT.	694		
	Circulation	175		
	SUBTOTAL	869		
	Interior Walls	90		
		1,000	TOTAL ADMINISTRATION EXCLUDING EXTERIOR WALLS (ADMIN. IS LOCATED IN EXISTING NHS BLDG.)	
		1,150	TOTAL ADMINISTRATION INCLUDING EXTERIOR WALLS (ADMIN. IS LOCATED IN NEW FACILITY)	

PROGRAMMATIC COMPONENT	NAME	SQ. FT. REQ'D.	USE	
VISITOR CENTER	Chief of Interpretation	120	Office	
	Front Counter	128	Office/Reception	
	Historian	64	Cubicle	
	Interp. Ranger	64	Cubicle	
	Park Guide	40	Desk	
	Step	40	Desk	
	Conf./Library/Resources	252	Meeting	
	Interpretive Storage	224	Storage/Work Room	
	Archives Storage	36	Storage Closet	
	Chair Storage	42	Storage Closet	
	Public Restrooms / Janitor	460	Restroom/Services	
	Mechanical/Electrical	225	Building Services	
	Airlock	156	General	
	Exhibit Area	750	Exhibit/Interpretive	
	Bookstore	180	Mercantile	
	Break Room	140	General	
	AV / Video	540	Exhibit/Interpretive	
	Archival Storage*	160	Storage	
	ASSIGNABLE SQ. FT.	3,621		
	Circulation	905		
	SUBTOTAL	4,526		
	Interior Walls	452		
		4,978	TOTAL ADMINISTRATION EXCLUDING EXTERIOR WALLS (V.C. IS LOCATED IN EXISTING NHS BLDG.)	
		5,475	TOTAL ADMINISTRATION INCLUDING EXTERIOR WALLS (V.C. IS LOCATED IN NEW FACILITY)	

* = Program space that was added after the A/E team returned from the initial site visit

PROGRAMMATIC COMPONENT	NAME	SQ. FT. REQ'D.	USE	
MAINTENANCE	Chief of Facilities Maint.	120	Office	
	Maintenance	64	Cubicle	
	Shared Maintenance	64	Cubicle	
	Step	48	Desk	
	Restroom	48	Restroom	
	Janitor	24	Building Services	
	2-Bay Garage	650	Garage	
	Storage - Maint. Equip.	1,200	Storage	
	ASSIGNABLE SQ. FT.	2,218		
	Circulation	554		
	SUBTOTAL	2,772		
	Interior & Exterior Walls	277		
		3,050	TOTAL ADMINISTRATION (MAINTENANCE IS LOCATED IN NEW FACILITY)	

EXISTING NHS BUILDINGS		
BUILDING	USABLE SQ. FT.	NOTES
AME Church	950	
First Baptist Church	1,480	Sq. ft. includes the Sanctuary only
School House No.1	776	Sq. ft. includes the Classroom, Kitchen and Coatroom only
Township Hall	2,350	2,350 sq. ft. is not inclusive of the stage. With the stage included you would have 3,219 sq. ft.
St. Francis Hotel	1,052	Sq. ft includes first floor only (Storage, Porch, Bedroom (3), DR, Kitchen and Back Porch

SUMMARY AND OPTIONS:

1. Visitor Center and Administrative program combined in one new building would equal approximately **6,200 sq ft.** There are some efficiencies of use of space in that the restroom, break room, janitor and mechanical room could be eliminated from the Administrative program since these are also included in the Visitor Center Program.
2. Visitor Center and Administrative program are broken out into two separate new buildings. The square footage totals would equal what's shown in the tables in yellow: **1,150** square feet for the Administration building and **5,475** square feet for the Visitor Center.
3. The Maintenance program would be in a separate new building in all cases. The square footage would equal approximately **3,050** square feet.
4. If a Visitor Contact Station is used in lieu of a full Visitor Center, the square footage requirement would be approximately **4,375** square feet if a new facility

APPENDIX E. NICODEMUS HABS/CLR MAPS



Existing Conditions Documentation
Potential Archeological Resources

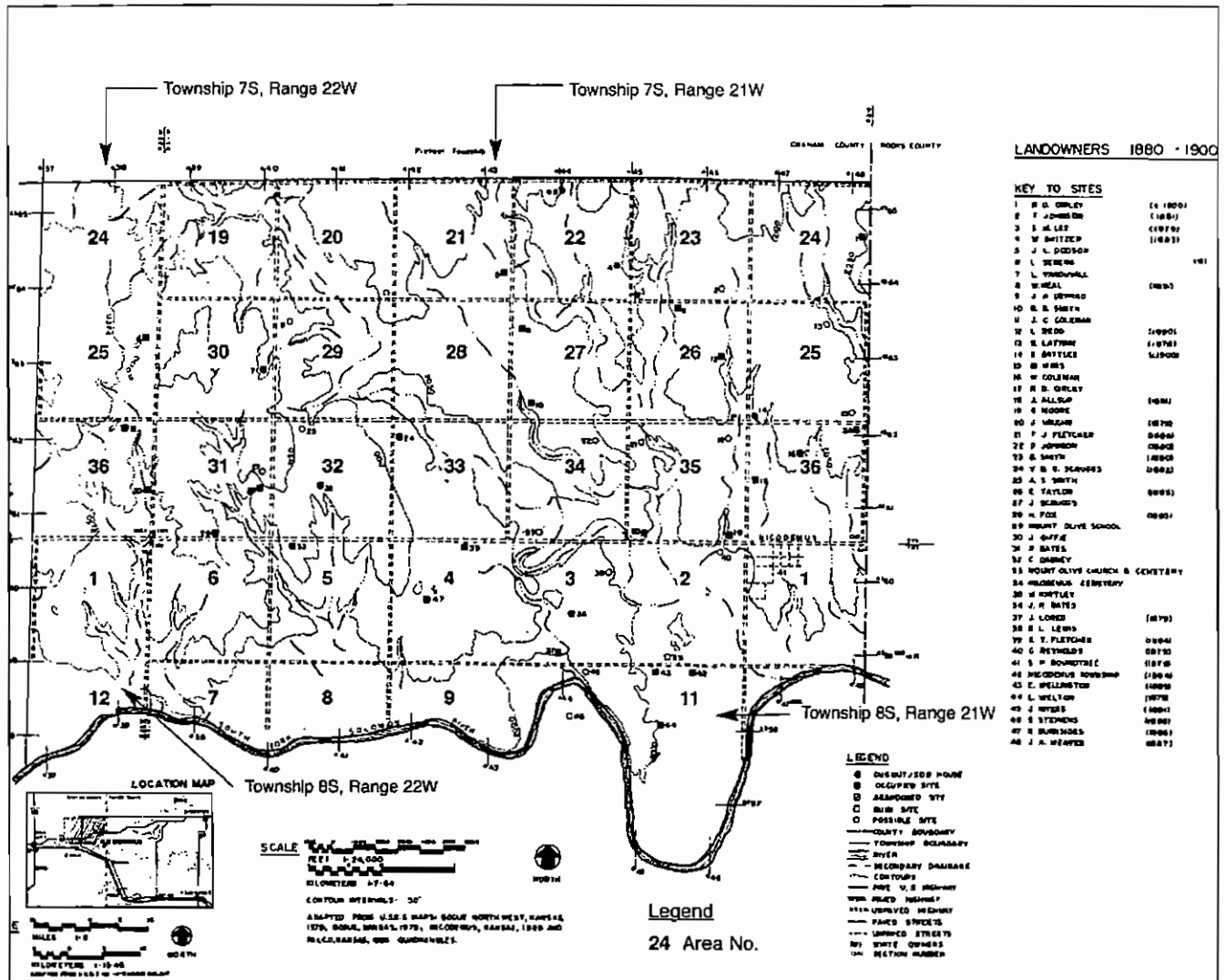

(Source: Historic American Buildings Survey, 1983.)

Figure 120.
Settlement sites with landowners, Nicodemus Township ca. 1880-1900.

Existing Conditions Documentation
Potential Archeological Resources

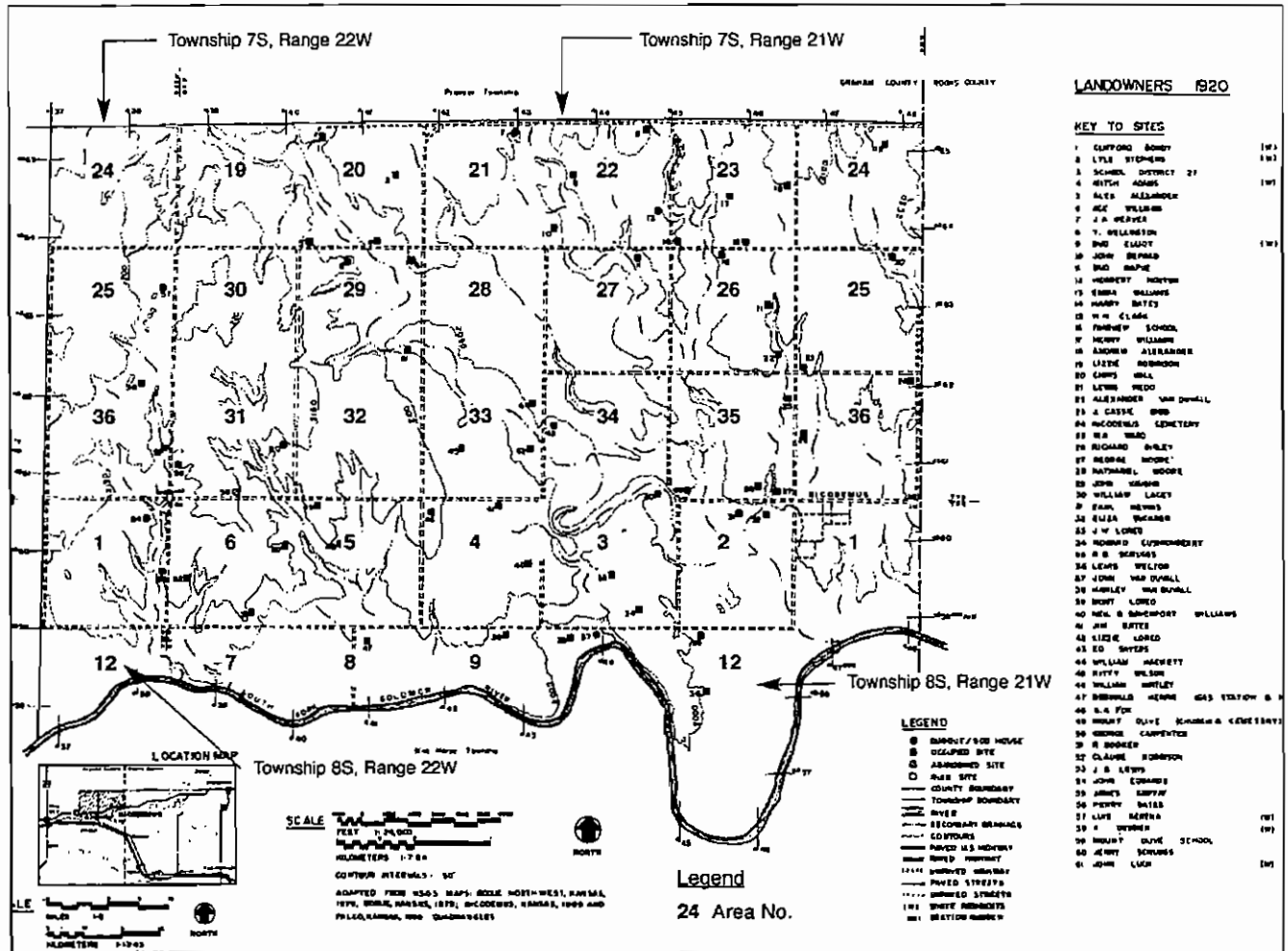

(Source: Historic American Buildings Survey, 1983.)

Figure 121.
Settlement sites with landowners, Nicodemus Township ca. 1920.

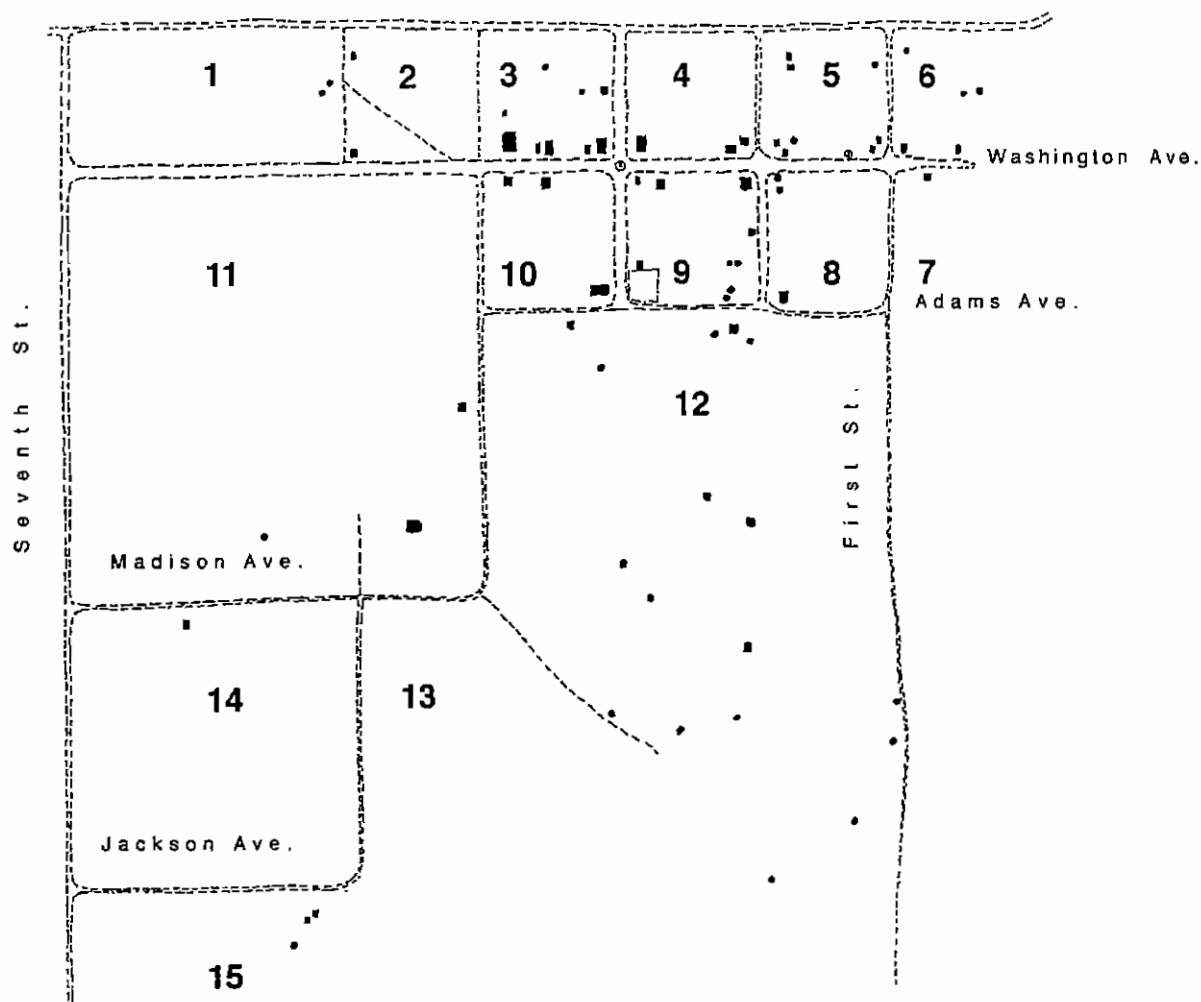

Map Sources

Photograph: "An early view of Nicodemus, Kansas, ca. 1885", (Kansas State Historical Society) and "Nicodemus Kansas, Townsite Plan - Circa 1877-1890" by Historic American Building Survey, National Park Service, from Promised Land on the Solomon: Black Settlement at Nicodemus, Kansas, (US Department of the Interior, National Park Service, Rocky Mountain Region, 1984); "Topographic, Boundary, Feature Survey-Cultural Landscape Report," from survey dated November 11, 1999 by Forgy Surveying.

Legend

- buildings/structures
- dugout/sod-up
- ===== unpaved roads/lanes
- unpaved paths
- fence
- ⊙ well
- 1 area

North
not to scale

Nicodemus National Historic Site
Cultural Landscape Report

Nicodemus Townsite
Potential Archeological
Resources
circa 1879-1888

Figure 123.

Townsite archeological potential, features likely extant 1879-1888.

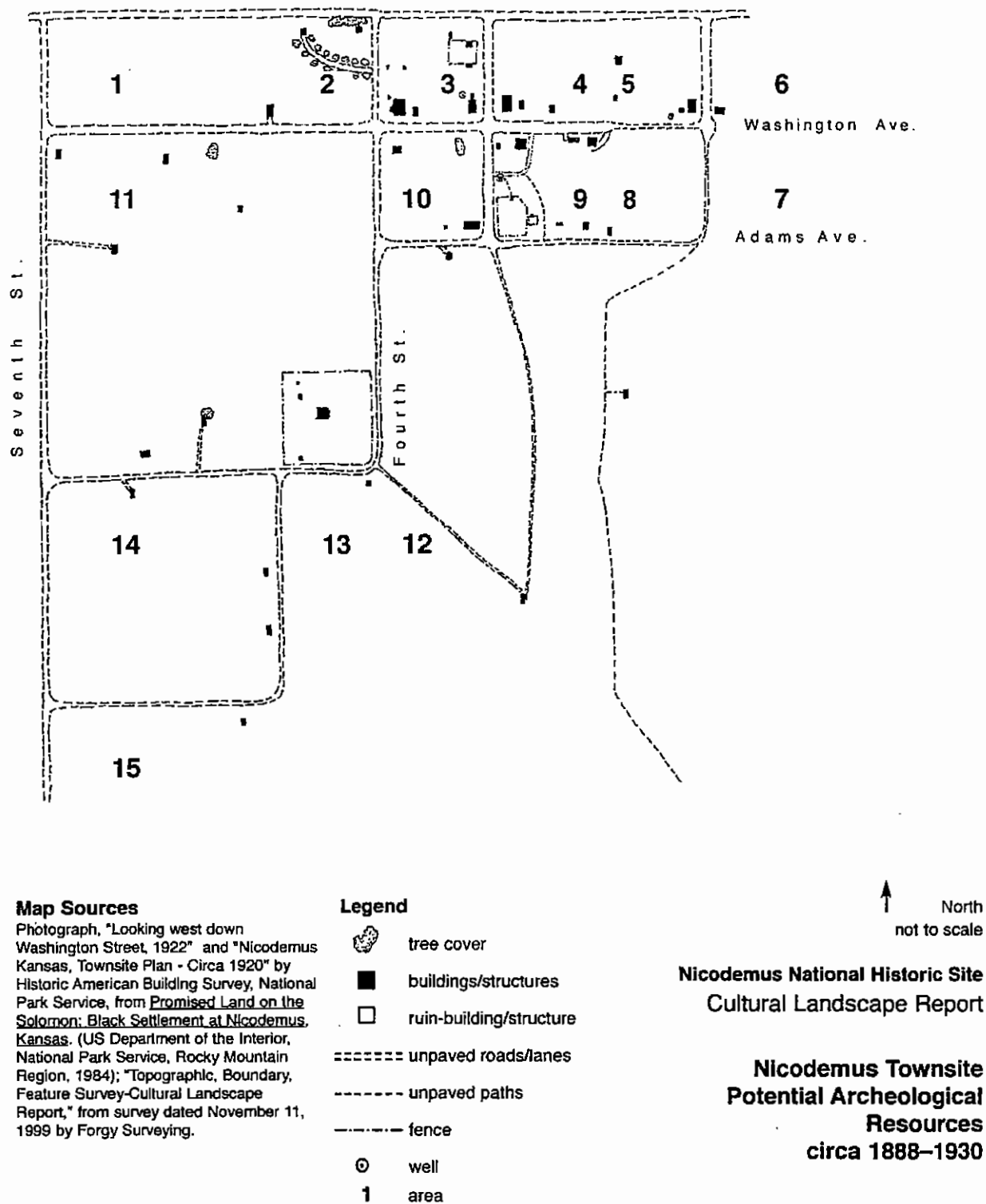

Figure 124.
 Townsite archeological potential, features likely extant 1888-1930.

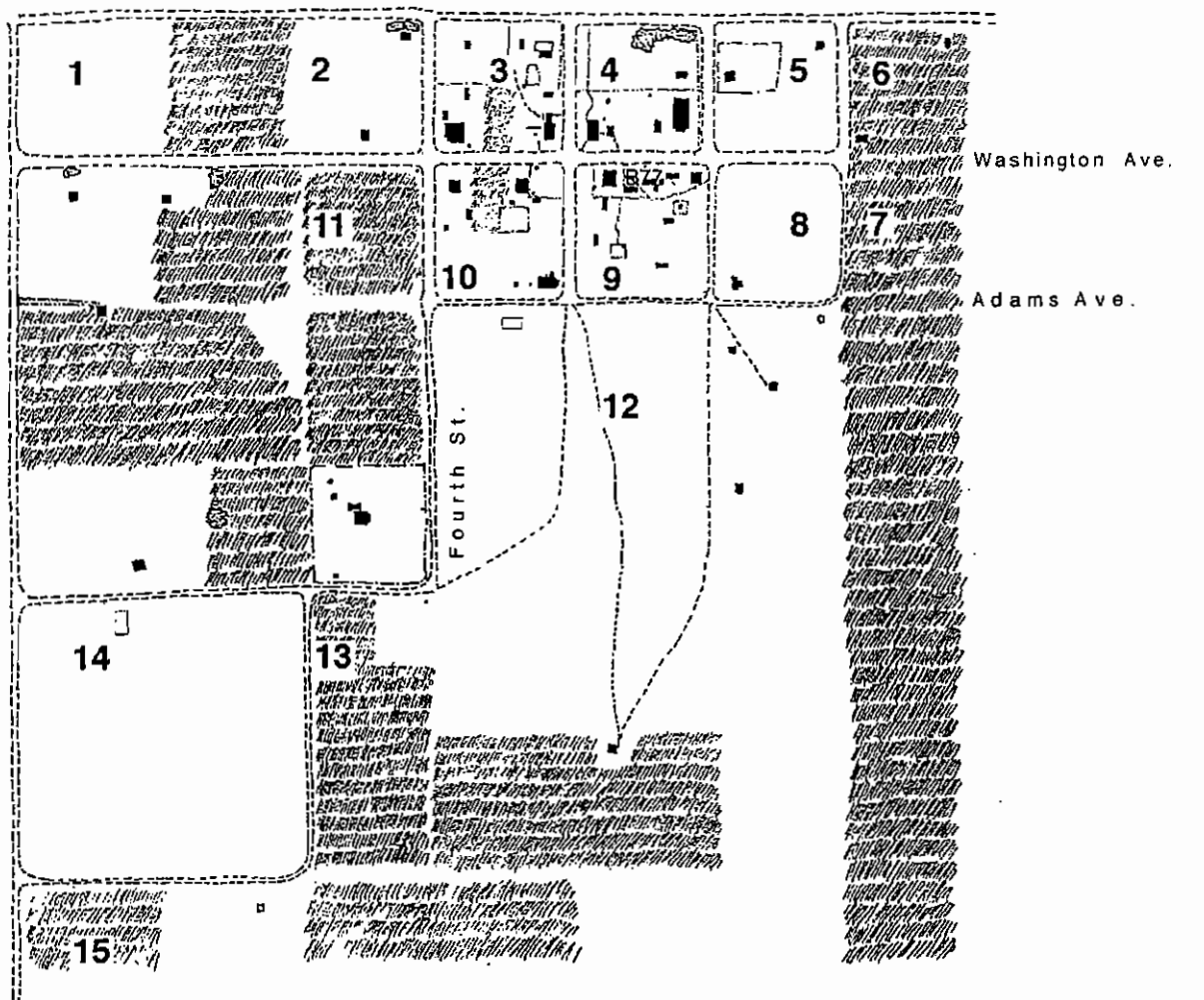
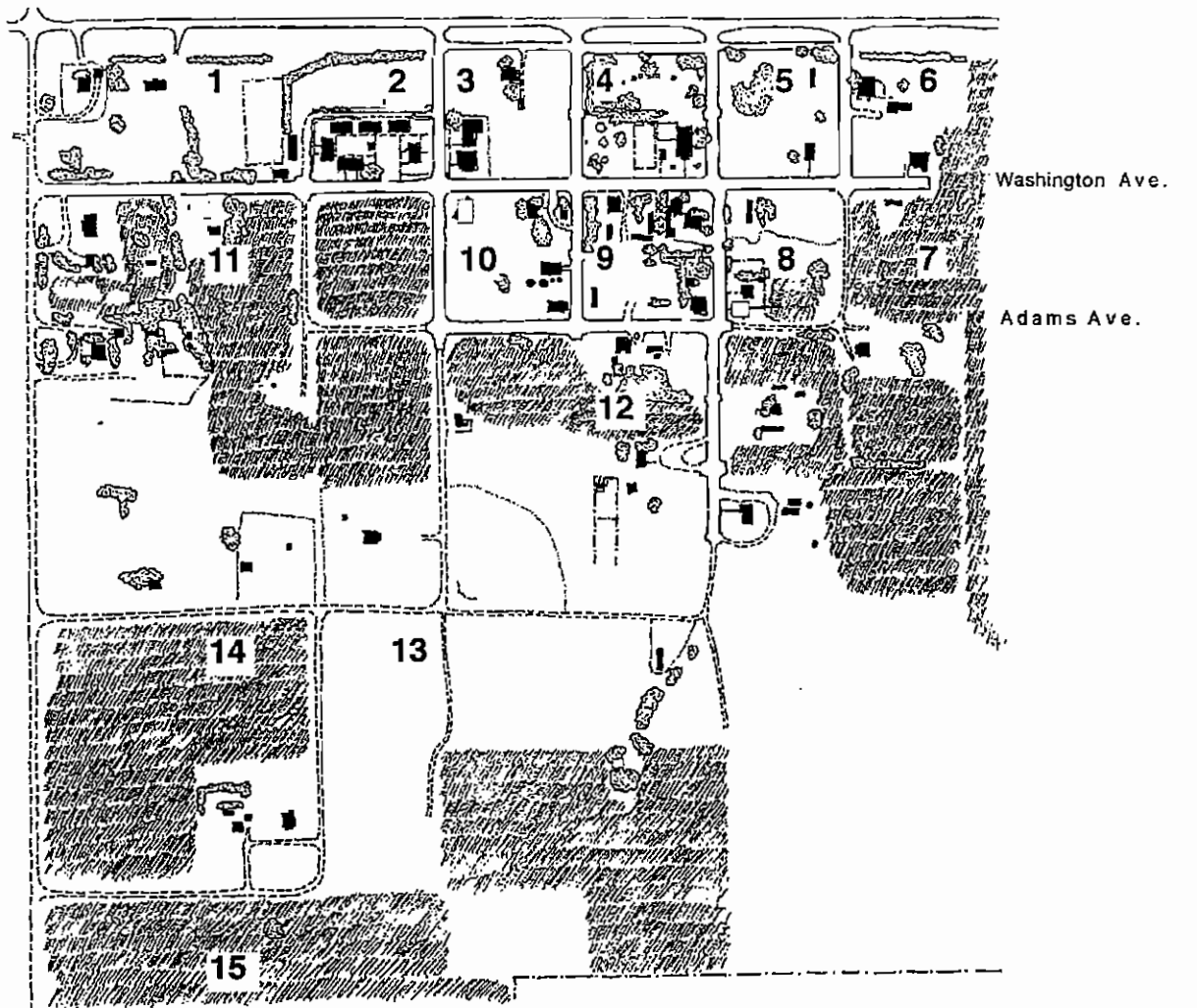









Figure 125.
Townsite archeological potential, features likely extant 1945-1955.



Map Sources

"Topographic, Boundary, Feature Survey-Cultural Landscape Report," from survey dated November 11, 1999 by Forgy Surveying.

Legend

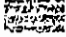
-  tree cover
-  buildings/structures
-  ruin-building/structure
-  paved roads
-  unpaved roads/lanes
-  unpaved paths
-  fence
-  crop cover/fields
- 1** area

↑ North
not to scale

Nicodemus National Historic Site
Cultural Landscape Report

Nicodemus Townsite
Potential Archeological
Resources
circa 1956-1972

Figure 126. Townsite archeological potential. Features likely extant ca. 1956-2002.

Figure 126.
Townsite archeological potential, features likely extant 1956-2002.

APPENDIX F. USGS MAP





Produced by the United States Geological Survey
North American Datum of 1983 (NAD83)
World Geodetic System of 1984 (WGS84), Projection and
1 000-meter grid, Universal Transverse Mercator, Zone 14S
10 000-foot ticks: Kansas Coordinate System of 1983
(north zone)

Imagery.....NAP, July 2008
Roads.....National Transportation Dataset, 2005 - 2008
Names.....National Hydrography Dataset, 2008
Hydrography.....National Hydrography Dataset, 2008
Contours.....National Elevation Dataset, 2006

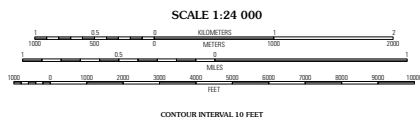
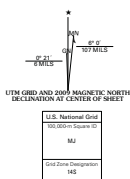

This map was produced to conform with version 0.5.10 of the
draft USGS Standards for 7.5-Minute Quadrangle Maps.
A metadata file associated with this product is also draft version 0.5.10

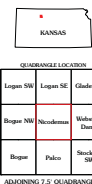

ROAD CLASSIFICATION
Interstate Route
US Route
Ramp
State Route
Local Road
4WD
State Route

NICODEMUS, KS
2009