



United States Department of the Interior

NATIONAL PARK SERVICE

National Mall & Memorial Parks

900 Ohio Drive, S.W.

Washington, D.C. 20024-2000



D66 (NCR-NAMA)

August 19, 2011

Mr. David Maloney
State Historic Preservation Officer
District of Columbia, Office of Planning
1100 4th Street SW, Suite E650
Washington D.C. 20024

Subject: Rehabilitation of U.S. Reservation 149

Dear Mr. Maloney:

The National Park Service (NPS) wishes to initiate consultation with the District of Columbia State Historic Preservation Office under Section 106 of the National Historic Preservation Act regarding rehabilitation of U.S. Reservation 149, an undertaking, in accordance with 36 CFR 800.3 of the regulations of the Advisory Council on Historic Preservation. Park staff discussed this project briefly with Andrew Lewis, of your office, on August 3rd, 2011.

The National Park Service (NPS), in partnership with the Historic Dupont Circle Main Streets (HDCMS), proposes to rehabilitate US Reservation 149, which is managed by NPS. This triangular park is located across from the Dupont North Metro Station on Q Street NW between 20th Street and Connecticut Avenue. The purpose of the project is to repair and replace existing features in kind, and to add two new features (a fence and a rounded corner) in order to enhance both aesthetics and visitor use. Specifically, the project would include: repairs to damaged flagstone, curbs, and concrete flat work; replacement of existing, tulip-style trash receptacles with Victor Stanley models; turf restoration of the compacted soil areas; restoration of the existing benches; replacement of a cherry tree and installation of a Chinese fringe tree; a rounded corner on the south side of the park; and a new wrought iron fence, with a design used at other reservations, to remedy the existing social paths (compacted soil areas) caused by pedestrian traffic to and from the Dupont Metro Station.

Reservation 149 is listed on the National Register of Historic Places as a contributing feature of the L'Enfant Plan of Washington, D.C., as one of three developed parklets along Connecticut Avenue that contain plantings, seating, and lighting. The area of potential effect includes the immediate area of Reservation 149, as bounded by Connecticut Avenue NW and Q and 20th Streets NW (see enclosed map).

TAKE PRIDE[®]
IN AMERICA 

NPS anticipates a finding of no adverse effect for this undertaking, and is seeking public comment in order to complete its assessment. Notification of the project was mailed to relevant stakeholders on August 11, 2011, and information about the project, including historic planting plans, is posted on the Planning, Environment, and Public Comment (PEPC) website – www.parkplanning/nps.gov/DupontTrianglePark). Park staff will, concurrently, review the proposal under the National Environmental Policy Act.

If you have any questions, please contact Jennifer Talken-Spaulding, Acting Chief of Resource Management and Cultural Program Manager, National Mall and Memorial Parks at (202) 245-4693.

Sincerely,



Robert A. Vogel
Superintendent
National Mall and Memorial Parks

Enclosures: (1) Drawings and site photos
(2) APE map

cc: Ms. Katry Harris, Advisory Council on Historic Preservation
Mr. Doug Jacobs, National Capital Region

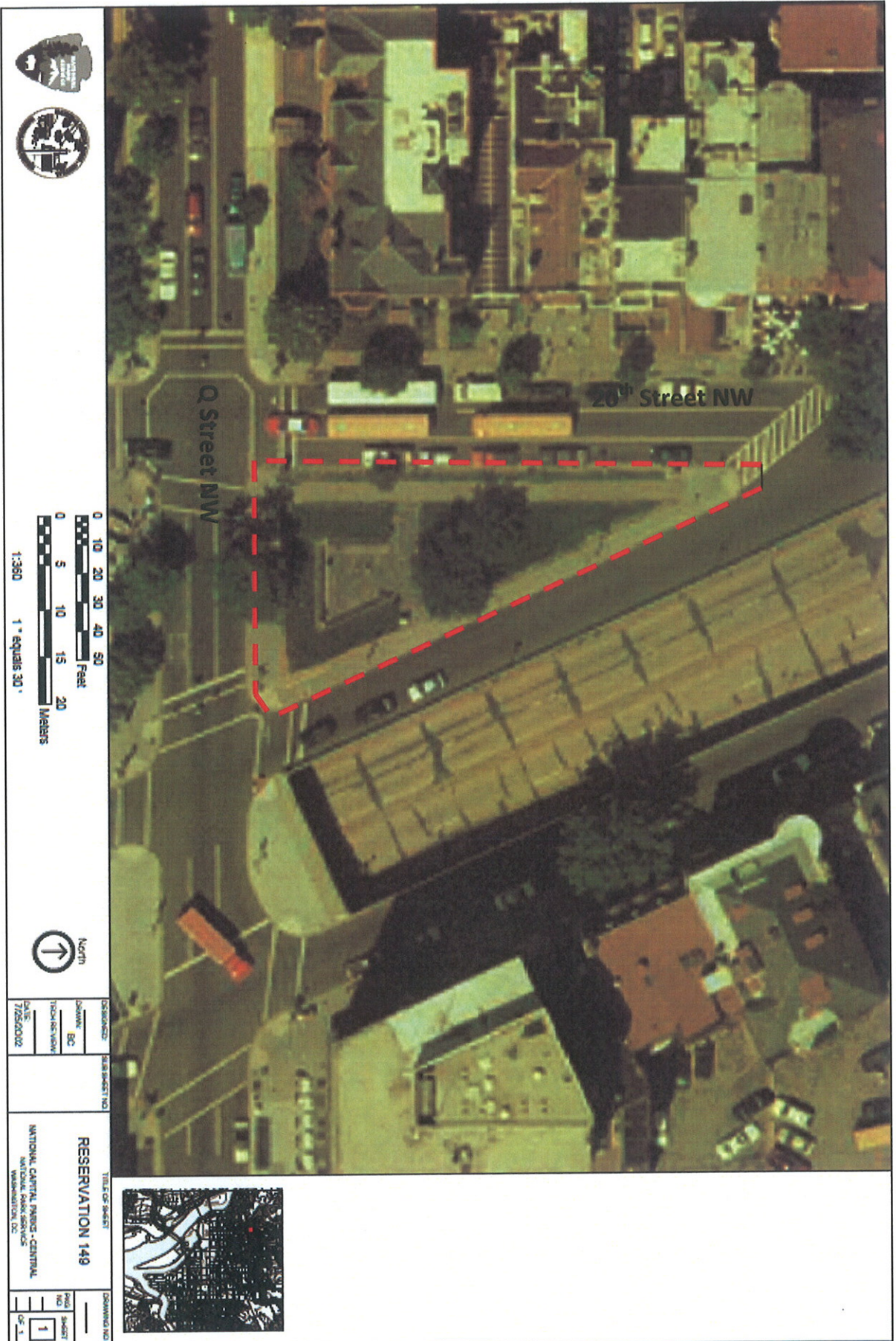

The Area of Potential Effects (APE) for the proposed Reservation 149 rehabilitation is marked by the red dotted line

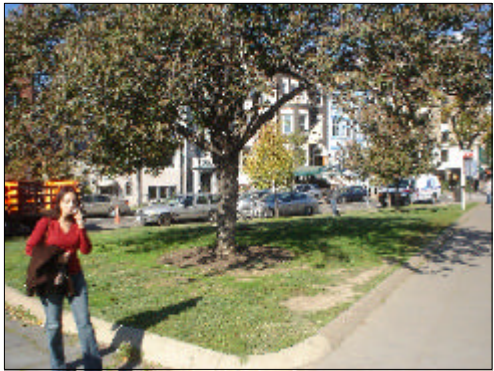

RESERVATION 149 RENOVATION

WASHINGTON, D.C.

HLS	
FIRM: HUNT LAUDI STUDIO	
1504 SWANN ST. N.W. WASHINGTON DC 20009 202 986 1182 WWW.HUNTLAUDISTUDIO.COM	
REVISION:	
PROJECT FACE:	
SCHEMATIC DESIGN	
PROJECT ADDRESS:	
DUPONT CIRCLE NW WASHINGTON, D.C.	
RESERVATION 149	COVER SHEET
PROJECT:	DRAWING:
SCALE:	
DESIGNED BY: JH/LL	
DRAWN BY: MR/SS	
CHECKED BY: JH	
DATE: FEBRUARY 2007	
SHEET:	
A-0	

[illegible]

PROJECT ADDRESS:
DUPONT CIRCLE, NW
WASHINGTON, D.C.

PROJECT: TRIANGLE PARK AT DUPONT CIRCLE
DRAWING: SITE PLAN

SCALE:	
DESIGNED BY:	JH/LL
DRAWN BY:	LL
CHECKED BY:	JH
DATE:	MARCH 2007

SHEET:

A-1

CONCRETE CURB: +/- 435 F

SLATE: +/- 650 SF

☒ EXISTING CURB SHOULD BE RESTORED

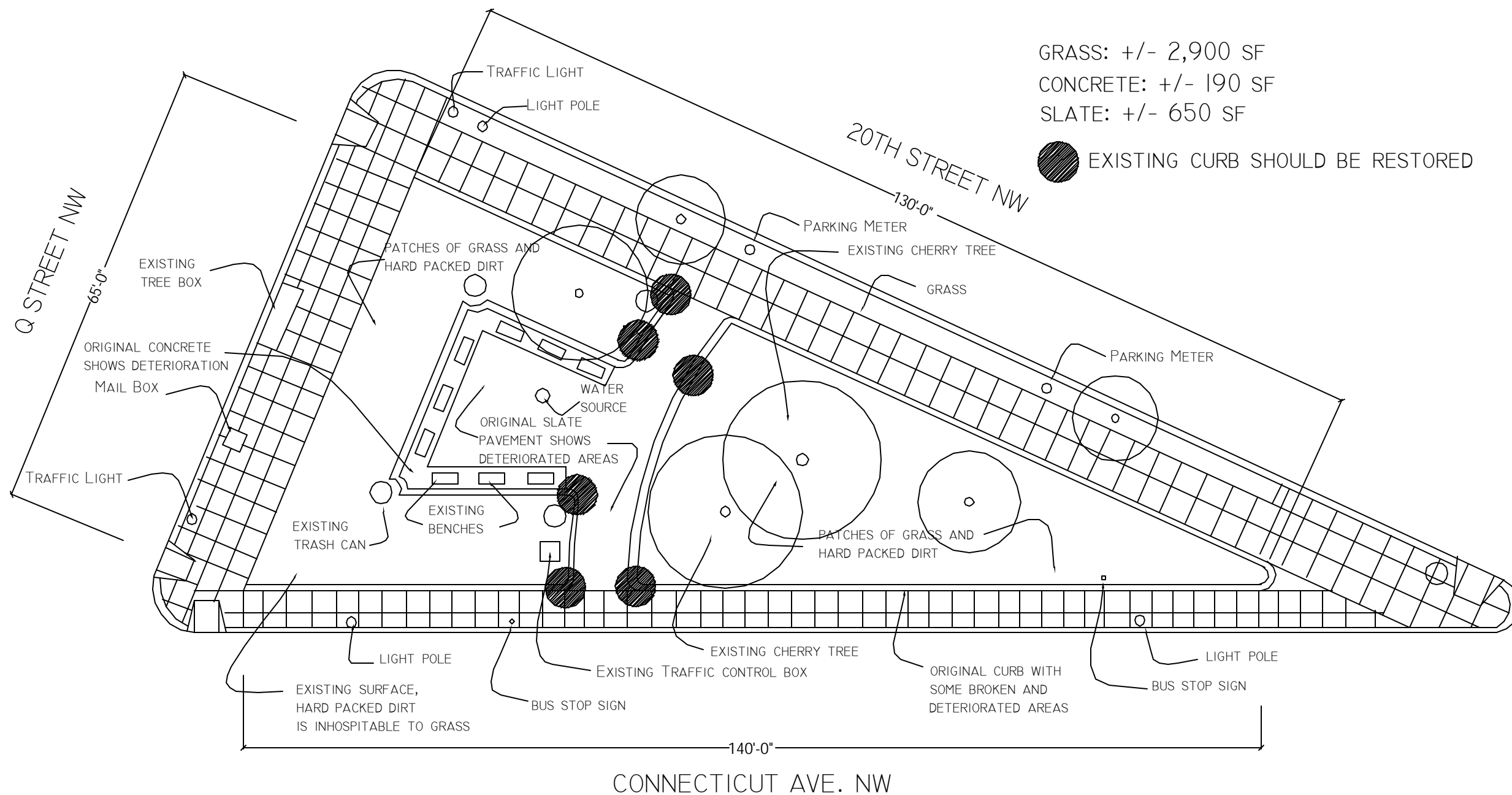

AREAS

SOFT SCAPE: +/- 2,900 SF
HARD SCAPE: +/- 840 SF
CONCRETE CURB: +/- 500 F
NEW CONCRETE CURB: +/- 60 F

GRASS: +/- 2,900 SF
CONCRETE: +/- 190 SF
SLATE: +/- 650 SF
IRON FENCE: +/- 140 F

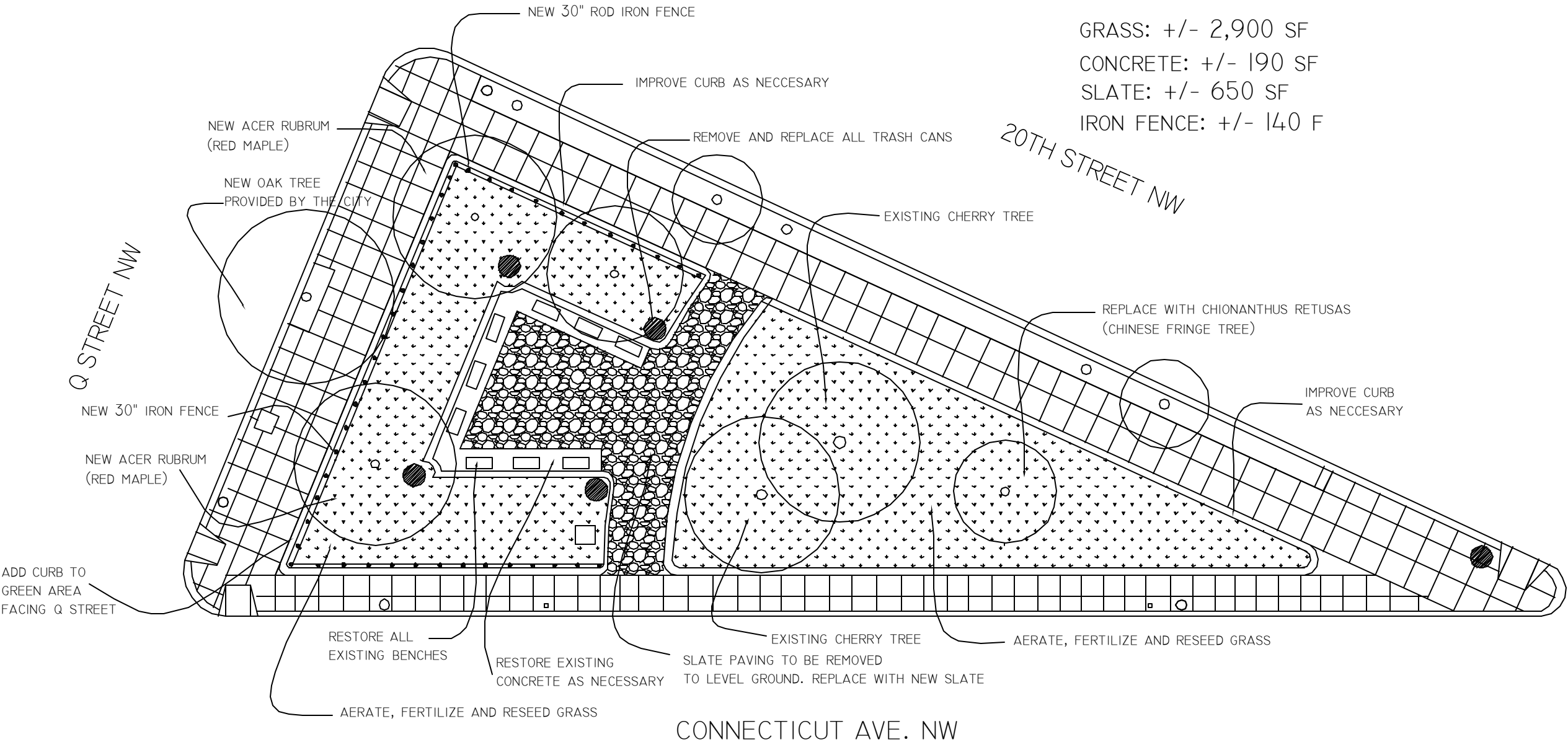

CONNECTICUT AVE. NW

20TH STREET NW

Q STREET NW



SOFT SCAPE: +/- 2,900 SF
HARD SCAPE: +/- 840 SF
CONCRETE CURB: +/- 500 F
NEW CONCRETE CURB: +/- 60 F

GRASS: +/- 2,900 SF
CONCRETE: +/- 190 SF
SLATE: +/- 650 SF
IRON FENCE: +/- 140 F

CONNECTICUT AVE. NW



FIRM:

HUNT
LAUDI
STUDIO

1504 SWANN ST. N.W.
WASHINGTON DC 2009
202 986 1182
WWW.HUNTLAUDISTUDIO.COM

[illegible]

PROJECT FACE:

SCHEMATIC
DESIGN

PROJECT ADDRESS:
DUPONT CIRCLE, NW
WASHINGTON, D.C.

PROJECT
TRIANGLE PARK AT DUPONT
CIRCLE

DRAWING

NEW PLAN-OPTION 3

SCALE:	1/16" = 1'
DESIGNED BY:	JH/LL
DRAWN BY:	LL
CHECKED BY:	JH
DATE:	MARCH 2007
SHEET:	

A-5

SOFT SCAPE: +/- 2,900 SF
HARD SCAPE: +/- 840 SF
CONCRETE CURB: +/- 500 F
NEW CONCRETE CURB: +/- 60 F

GRASS: +/- 2,900 SF
CONCRETE: +/- 190 SF
SLATE: +/- 650 SF
IRON FENCE: +/- 140 F