



IN REPLY REFER TO:
L7615(YOSE-PM)

United States Department of the Interior

NATIONAL PARK SERVICE

Yosemite National Park
P. O. Box 577
Yosemite, California 95389

Memorandum

To: Annette Catamec, Project Manager, Yosemite National Park

From: Superintendent, Yosemite National Park

Subject: NEPA and NHPA Clearance: 2011-004 Ahwahnee Hotel Kitchen FRP Board Installation (34451)

The Executive Leadership Team has reviewed the proposed project/action and completed its environmental assessment documentation, and we have determined that there:

- Will not be any effect on threatened, endangered, or rare species and/or their critical habitat.
- Will not be any effect on historical, cultural, or archeological resources.
- Will not be serious or long-term undesirable environmental or visual effects.

The subject proposed project, therefore, is now cleared for all NEPA and NHPA compliance requirements as presented above. Project plans and specifications are approved and construction can commence.

For the proposed project actions to be within compliance requirements during construction and/or project implementation, the following mitigations must be adhered to:

- No mitigations identified.

For complete compliance information see PEPC Project 34451.

If you have any questions, please let me know.

//Don L. Neubacher//
Don L. Neubacher

Enclosure (with attachments)

cc: Statutory Compliance File

*The signed original of this document is on file at
Environmental Planning and Compliance Office
Yosemite National Park.*



Categorical Exclusion Form

Project: 2011-004 Ahwahnee Hotel Kitchen FRP Board Installation

PEPC Project Number: 34451

Project Description:

The purpose of this project is to install Fiberglass Reinforced Plastic (FRP) on the interior vertical walls of the kitchen of The Ahwahnee, located in Yosemite National Park. FRP will provide a cleanable wall surface that is industry standard in commercial kitchens.

Originally built in 1927, The Ahwahnee is a National Historic Landmark, and as such, all maintenance work must meet the Secretary of the Interior's Standards for the Treatment of Historic Properties. The kitchen of The Ahwahnee has historic significance as it contributes to the overall building's significance and requires attention to detail to prevent damage to the walls that are original features. The FRP installation is designed to be fully reversible if deemed necessary in the future. Additionally, the FRP has the potential to protect the historic plaster walls from damage caused by grease, dirt, water and steam.

This project would install approximately 425 linear feet of FRP that would reach eight feet in height. The FRP will be smooth surface and basic white in color. Standard PVC trim molding will be installed to seal corners, edges, and divisions. FRP panels will be attached with standard adhesive, and moisture sealed on the top and bottom edges with sealant. In addition to a standard adhesive applied to the panel backing, individual panels may need additional anchor by pre-drilling small holes in the wall and inserting plastic "tack" fasteners. This will be done to a minimal extent and only where deemed necessary to achieve a secure FRP attachment. Any wall repairs will be done prior to attaching the FRP board.

There are some walls in the kitchen that have an irregular finish that is historic and character defining. To protect these walls and install FRP properly, a thin sheet of plywood (3/16" or 1/4") will be attached to these walls and sealed around the perimeter. FRP will be installed over the plywood to provide a cleanable, smooth surface. FRP will not be installed in areas designated for cooking.

FRP currently exists in the pot washing room. The existing walls in the kitchen are a mixture of painted plaster lath, concrete, drywall, and plywood and are difficult to maintain in a clean condition. All wall bumpers, shelves, fire extinguishers, and other items that may be attached to the walls will be removed and reinstalled after the FRP is installed. No interior windows will be blocked with the FRP installation.

Justification: The existing walls of The Ahwahnee kitchen are difficult to keep clean and moisture free. The installation of FRP on many of the interior walls will bring the kitchen to current standards for cleanable surfaces in commercial kitchens, and protect the historic walls from potential damage. Smooth and easily cleanable surfaces in commercial kitchens are a code requirement under Food and Drug Administration US Food Code (see Chapter 6 in Project Review Package).

Special Considerations: The FRP shall be installed in a manner such that the installation is fully reversible as The Ahwahnee is a National Historic Landmark.

Operational Concerns: The installation of FRP will occur during the hotel closure period when much of the kitchen equipment will be replaced and relocated. This is the optimal time to install FRP as the installation will not complicate regular kitchen operation, and areas may be more accessible for FRP installation.

Project Locations:

- Mariposa, CA

Mitigation(s):

- No mitigations identified.

Describe the category used to exclude action from further NEPA analysis and indicate the number of the category (see Section 3-4 of DO-12):

C.4 Routine maintenance and repairs to cultural resource sites, structures, utilities and grounds under an approved Historic Structures Preservation Guide or Cyclic Maintenance Guide; or if the action would not adversely affect the cultural resource.

On the basis of the environmental impact information in the statutory compliance file, with which I am familiar, I am categorically excluding the described project from further NEPA analysis. No exceptional circumstances (e.g. all boxes in the ESF are marked "no") or conditions in Section 3-6 apply, and the action is fully described in Section 3-4 of DO-12.

Superintendent //Don L. Neubacher//

Date 2/6/11

*The signed original of this document is on file at the
Environmental Planning and Compliance Office in
Yosemite National Park.*



National Park Service
U.S. Department of the Interior

Yosemite National Park
Date: 02/01/2011

ENVIRONMENTAL SCREENING FORM (ESF)

DO-12 APPENDIX 1

Date Form Initiated: 01/31/2011

Updated May 2007 - per 2004 Departmental Manual revisions and proposed Director's Order 12 changes

A. PROJECT INFORMATION

Park Name: Yosemite National Park
Project Title: 2011-004 Ahwahnee Hotel Kitchen FRP Board Installation
PEPC Project Number: 34451
Project Type: Facility Maintenance (FM)
Project Location: Mariposa, California
Project Leader: Annette Catamec

Is project a hot topic (controversial or sensitive issues that should be brought to attention of Regional Director)? No

C. RESOURCE EFFECTS TO CONSIDER:

Identify potential effects to the following physical, natural, or cultural resources	No Effect	Negligible Effects	Minor Effects	Exceeds Minor Effects	Data Needed to Determine/Notes
1. Geologic resources – soils, bedrock, streambeds, etc.	No				
2. From geohazards	No				
3. Air quality		Negligible			Negligible impacts during the installation of the FRP board.
4. Soundscapes		Negligible			Temporary construction noises while the installation occurs.
5. Water quality or quantity	No				
6. Streamflow characteristics	No				

Identify potential effects to the following physical, natural, or cultural resources	No Effect	Negligible Effects	Minor Effects	Exceeds Minor Effects	Data Needed to Determine/Notes
7. Marine or estuarine resources	No				
8. Floodplains or wetlands	No				
9. Land use, including occupancy, income, values, ownership, type of use	No				
10. Rare or unusual vegetation – old growth timber, riparian, alpine	No				
11. Species of special concern (plant or animal; state or federal listed or proposed for listing) or their habitat	No				
12. Unique ecosystems, biosphere reserves, World Heritage Sites	No				Yosemite National Park is a World Heritage Site.
13. Unique or important wildlife or wildlife habitat	No				
14. Unique or important fish or fish habitat	No				
15. Introduce or promote non-native species (plant or animal)	No				
16. Recreation resources, including supply, demand, visitation, activities, etc.	No				
17. Visitor experience, aesthetic resources	No				
18. Archeological resources	No				
19. Prehistoric/historic structure		Negligible			Ahwahnee Hotel is a National Historic Landmark.
20. Cultural landscapes	No				

Identify potential effects to the following physical, natural, or cultural resources	No Effect	Negligible Effects	Minor Effects	Exceeds Minor Effects	Data Needed to Determine/Notes
21. Ethnographic resources	No				
22. Museum collections (objects, specimens, and archival and manuscript collections)	No				
23. Socioeconomics, including employment, occupation, income changes, tax base, infrastructure	No				
24. Minority and low income populations, ethnography, size, migration patterns, etc.	No				
25. Energy resources	No				
26. Other agency or tribal land use plans or policies	No				
27. Resource, including energy, conservation potential, sustainability	No				
28. Urban quality, gateway communities, etc.	No				
29. Long-term management of resources or land/resource productivity	No				
30. Other important environment resources (e.g. geothermal, paleontological resources)?	No				

D. MANDATORY CRITERIA

Mandatory Criteria: If implemented, would the proposal:	Yes	No	N/A	Comment or Data Needed to Determine
A. Have significant impacts on public health or safety?		No		
B. Have significant impacts on such natural resources and unique geographic characteristics as historic or cultural resources; park, recreation, or refuge lands; wilderness areas; wild or scenic rivers; national natural landmarks; sole or principal drinking water aquifers; prime farmlands; wetlands (Executive Order 11990); floodplains (Executive Order 11988); national monuments; migratory birds; and other ecologically significant or critical areas?		No		Mitigated; the assessment of effect is "No Adverse Effect."
C. Have highly controversial environmental effects or involve unresolved conflicts concerning alternative uses of available resources (NEPA section 102(2)(E))?		No		
D. Have highly uncertain and potentially significant environmental effects or involve unique or unknown environmental risks?		No		
E. Establish a precedent for future action or represent a decision in principle about future actions with potentially significant environmental effects?		No		
F. Have a direct relationship to other actions with individually insignificant, but cumulatively significant, environmental effects?		No		
G. Have significant impacts on properties listed or eligible for listing on the National Register of Historic Places, as determined by either the bureau or office?		No		
H. Have significant impacts on species listed or proposed to be listed on the List of Endangered or Threatened Species, or have significant impacts on designated Critical Habitat for these species?		No		
I. Violate a federal law, or a state, local, or tribal law or requirement imposed for the protection of the environment?		No		

Mandatory Criteria: If implemented, would the proposal:	Yes	No	N/A	Comment or Data Needed to Determine
J. Have a disproportionately high and adverse effect on low income or minority populations (Executive Order 12898)?		No		
K. Limit access to and ceremonial use of Indian sacred sites on federal lands by Indian religious practitioners or significantly adversely affect the physical integrity of such sacred sites (Executive Order 13007)?		No		
L. Contribute to the introduction, continued existence, or spread of noxious weeds or non-native invasive species known to occur in the area or actions that may promote the introduction, growth, or expansion of the range of such species (Federal Noxious Weed Control Act and Executive Order 13112)?		No		

For the purpose of interpreting these procedures within the NPS, any action that has the potential to violate the NPS Organic Act by impairing park resources or values would constitute an action that triggers the DOI exception for actions that threaten to violate a federal law for protection of the environment.

E. OTHER INFORMATION

1. Are personnel preparing this form familiar with the site? Yes
2. Did personnel conduct a site visit? No
3. Is the project in an approved plan such as a General Management Plan or an Implementation Plan with an accompanying NEPA document? No
4. Are there any interested or affected agencies or parties? No
5. Has consultation with all affected agencies or tribes been completed? N/A
6. Are there any connected, cumulative, or similar actions as part of the proposed action? (*e.g., other development projects in area or identified in GMP, adequate/available utilities to accomplish project*) No

E. INTERDISCIPLINARY TEAM SIGNATORIES

<u>Interdisciplinary Team</u>	<u>Field of Expertise</u>
Don L. Neubacher	Superintendent
Kathleen Morse	Chief of Planning
Randy Fong	Acting Chief of Project Management
Katariina Tuovinen	Chief of Administration Management
Ed Walls	Chief of Facilities Management
Joe Meyer	Acting Chief of Resources Management & Science
Marty Nielson	Chief of Business and Revenue Management
Tom Medema	Chief of Interpretation and Education
Charles Cuvelier	Chief of Visitor and Resource Protection
Annette Catamec	Project Leader
Elexis Mayer	Environmental Planning and Compliance Program Manager
Elexis Mayer	Acting Historic Preservation Officer
Renea Kennec	NEPA Specialist

F. SUPERVISORY SIGNATORY

Based on the environmental impact information contained in the statutory compliance file and in this environmental screening form, environmental documentation for this stage of the subject project is complete.

Recommended:

Compliance Specialists	Date
<u>//Renea Kennec//</u> Compliance Specialist – Renea Kennec	<u>2/1/11</u>
<u>//Sue Clark//</u> Compliance Program Manager – Elexis Mayer	<u>2/1/11</u>
<u>//Randy Fong//</u> Acting Chief, Project Management – Randy Fong	<u>2/3/11</u>

Approved:

Superintendent	Date
<u>//Don L. Neubacher//</u> Don L. Neubacher	<u>2/4/11</u>

*The signed original of this document is on file at the
Environmental Planning and Compliance Office in
Yosemite National Park.*



National Park Service
U.S. Department of the Interior

Yosemite National Park
Date: 02/01/2011

PARK ESF ADDENDUM

Today's Date: February 1, 2011

PROJECT INFORMATION

Park Name: Yosemite National Park
Project Title: 2011-004 Ahwahnee Hotel Kitchen FRP Board Installation
PEPC Project Number: 34451
Project Type: Facility Maintenance (FM)
Project Location: Mariposa, California
Project Leader: Annette Catamec

PARK ESF ADDENDUM QUESTIONS & ANSWERS

ESF Addendum Questions	Yes	No	N/A	Data Needed to Determine/Notes
SPECIAL STATUS SPECIES CHECKLIST				
Listed or proposed threatened or endangered species (Federal or State)?		No		
Species of special concern (Federal or State)?		No		
Park rare plants or vegetation?		No		
Potential habitat for any special-status species listed above?		No		
NATIONAL HISTORIC PRESERVATION ACT CHECKLIST				
Entail ground disturbance?		No		
Are any archeological or ethnographic sites located within the area of potential effect?		No		
Entail alteration of a historic structure or cultural landscape?	Yes			The FRP board will be fully removable and has the potential to protect the historic plaster walls.
Has a National Register form been completed?	Yes			

ESF Addendum Questions	Yes	No	N/A	Data Needed to Determine/Notes
Are there any structures on the park's List of Classified Structures in the area of potential effect?	Yes			List of Classified Structures #55943.
WILD AND SCENIC RIVERS ACT CHECKLIST				
Fall within a wild and scenic river corridor? (Name the river corridor)	Yes			Merced River.
Fall within the bed and banks AND will affect the free-flow of the river?		No		
Have the possibility of affecting water quality of the area?		No		
Remain consistent with its river segment classification?	Yes			
Fall on a tributary of a Wild and Scenic River?		No		
Will the project encroach or intrude upon the Wild and Scenic River corridor		No		
Will the project unreasonably diminish scenic, recreational, or fish and wildlife values		No		
Consistent with the provisions in the Merced River Plan Settlement Agreement?	Yes			
WILDERNESS ACT CHECKLIST				
Within designated Wilderness?		No		
Within a Potential Wilderness Addition?		No		



Example of FRP panel installation

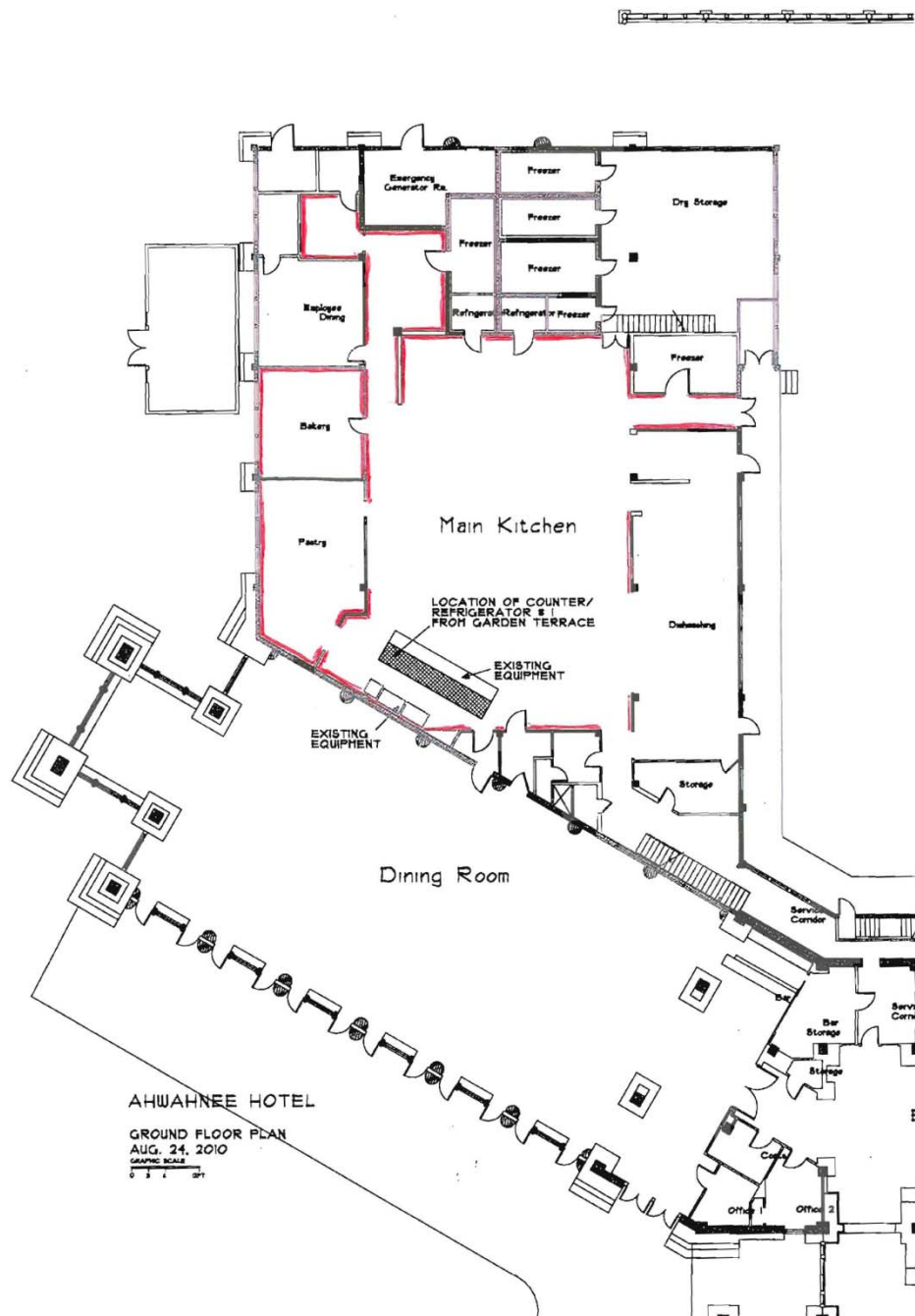

Red lines indicate that a wall will have FRPs installed



National Park Service
U.S. Department of the Interior

Yosemite National Park
Date: 02/01/2011

ASSESSMENT OF ACTIONS HAVING AN EFFECT ON CULTURAL RESOURCES

A. DESCRIPTION OF UNDERTAKING

1. **Park:** Yosemite National Park

2. **Project Description:**

Project Name: 2011-004 Ahwahnee Hotel Kitchen FRP Board Installation

Date: February 1, 2011

PEPC Project ID Number: 34451

3. **Has the area of potential effects been surveyed to identify cultural resources?**

☐ No
☒ Yes

Source or reference: Ahwahnee Hotel National Historic Landmark.

Check here if no known cultural resources will be affected. (If this is because area has been disturbed, please explain or attach additional information to show the disturbance was so

☒ extensive as to preclude intact cultural deposits.)

4. **Potentially Affected Resource(s):**

Historical structures/resources affected?

Name and number(s): Ahwahnee Hotel National Historical Landmark

Location: Yosemite Valley

NR status: 7 - A designated National Historic Landmark

5. **The proposed action will: (check as many as apply)**

☐ Yes Destroy, remove, or alter features/elements from a historic structure

☐ No Replace historic features/elements in kind

☐ Yes Add non-historic features/elements to a historic structure

☐ No Alter or remove features/elements of a historic setting or environment (inc. terrain)

☐ No Add non-historic features/elements (inc. visual, audible, or atmospheric) to a historic setting or cultural landscape

☐ No Disturb, destroy, or make archeological resources inaccessible

- No Disturb, destroy, or make ethnographic resources inaccessible
- No Potentially affect presently unidentified cultural resources
- No Begin or contribute to deterioration of historic features, terrain, setting, landscape elements, or archeological or ethnographic resources
- No Involve a real property transaction (exchange, sale, or lease of land or structures)
- Other (please specify): _____

6. Supporting Study Data:

Prepared by: Renea Kennec **Date Prepared:** 2/1/2011 **Telephone:** 209-379-1038

B. REVIEWS BY CULTURAL RESOURCE SPECIALISTS

The park Acting Historic Preservation Officer requested review by the park's cultural resource specialist/advisors as indicated by check-off boxes or as follows:

[X] Historical Architect
Name: Gabrielle Harlan
Date: 02/01/2011

Check if project does not involve ground disturbance []
Assessment of Effect: No Historic Properties Affected X No Adverse Effect Adverse Effect Streamlined Review
Recommendations for conditions or stipulations:
Doc Method: Park Specific Programmatic Agreement

[X] Historical Landscape Architect
Name: David Humphrey
Date: 02/01/2011
Comments: None.

Check if project does not involve ground disturbance []
Assessment of Effect: No Historic Properties Affected X No Adverse Effect Adverse Effect Streamlined Review
Recommendations for conditions or stipulations: None.
Doc Method: Park Specific Programmatic Agreement

No Reviews From: Curator, Archeologist, Historian, 106 Advisor, Other Advisor, Anthropologist

C. PARK SECTION 106 COORDINATOR'S REVIEW AND RECOMMENDATIONS

1. Assessment of Effect:

_____ No Historic Properties Affected X No Adverse Effect _____ Adverse Effect

2. Documentation Method:

☐ A. STANDARD 36 CFR PART 800 CONSULTATION

Further consultation under 36 CFR Part 800 is needed.

☐ B. STREAMLINED REVIEW UNDER THE 2008 SERVICEWIDE PROGRAMMATIC AGREEMENT (PA)

The above action meets all conditions for a streamlined review under section III of the 2008 Servicewide PA for Section 106 compliance.

APPLICABLE STREAMLINED REVIEW Criteria
(Specify 1-16 of the list of streamlined review criteria.)

☐ C. PLAN-RELATED UNDERTAKING

Consultation and review of the proposed undertaking were completed in the context of a plan review process, in accordance with the 2008 Servicewide PA and 36 CFR Part 800.
Specify plan/EA/EIS:

☒ D. UNDERTAKING RELATED TO ANOTHER AGREEMENT

The proposed undertaking is covered for Section 106 purposes under another document such as a statewide agreement established in accord with 36 CFR 800.7 or counterpart regulations.
Specify: 1999 Programmatic Agreement

☐ E. COMBINED NEPA/NHPA Document

Documentation is required for the preparation of an EA/FONSI or an EIS/ROD has been developed and used so as also to meet the requirements of 36 CFR 800.3 through 800.6

☐ F. No Potential to Cause Effects [800.3(a)(1)]

☐ G. Memo to SHPO/THPO

☐ H. Memo to ACHP

4. Stipulations and Conditions:

Following are listed any stipulations or conditions necessary to ensure that the assessment of effect above is consistent with 36 CFR Part 800 criteria of effect or to avoid or reduce potential adverse effects.

5. Mitigations/Treatment Measures:

Measures to prevent or minimize loss or impairment of historic/prehistoric properties:
(Remember that setting, location, and use may be relevant.)

No Assessment of Effect mitigations identified.

D. SUPERINTENDENT'S APPROVAL

The proposed work conforms to the NPS *Management Policies* and *Cultural Resource Management Guideline*, and I have reviewed and approve the recommendations, stipulations, or conditions noted in Section C of this form.

Signature of Acting Historic Preservation Officer //Sue Clark//

Date: 2/1/11

Signature of Superintendent //Don L. Neubacher//

Date: 2/3/11

*The signed original of this document is on file at the
Environmental Planning and Compliance Office in
Yosemite National Park.*