

## **APPENDIX B: SUPPORTIVE CONCEPT DESIGN GRAPHICS**



Figure 1: Georgetown Canal Plan Zone Key





Figure 2: Proposed Concept Designs from Mile 0.00 to Mile 0.28

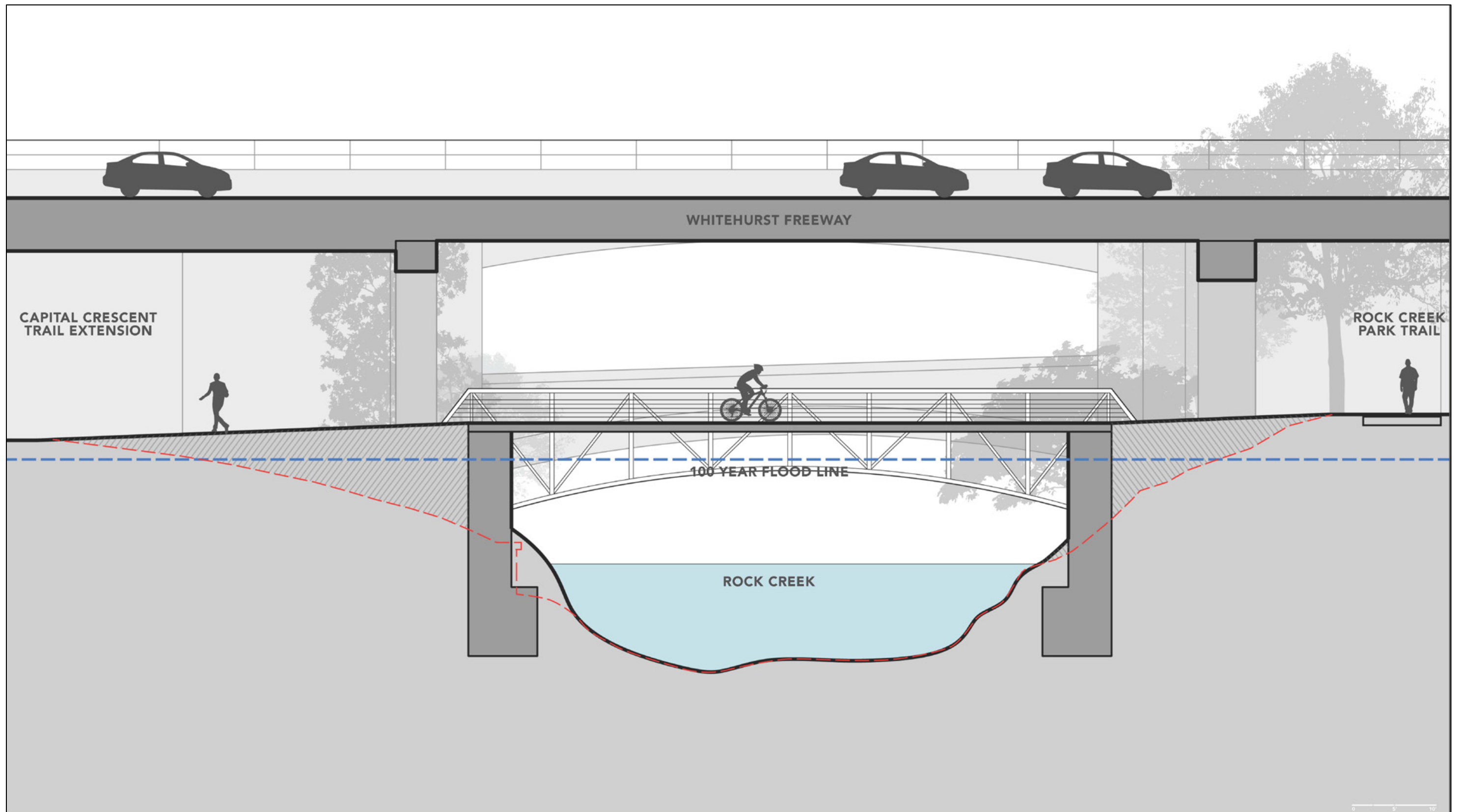

Figure 3: Proposed K Street Bridge Bicycle and Pedestrian Crossing



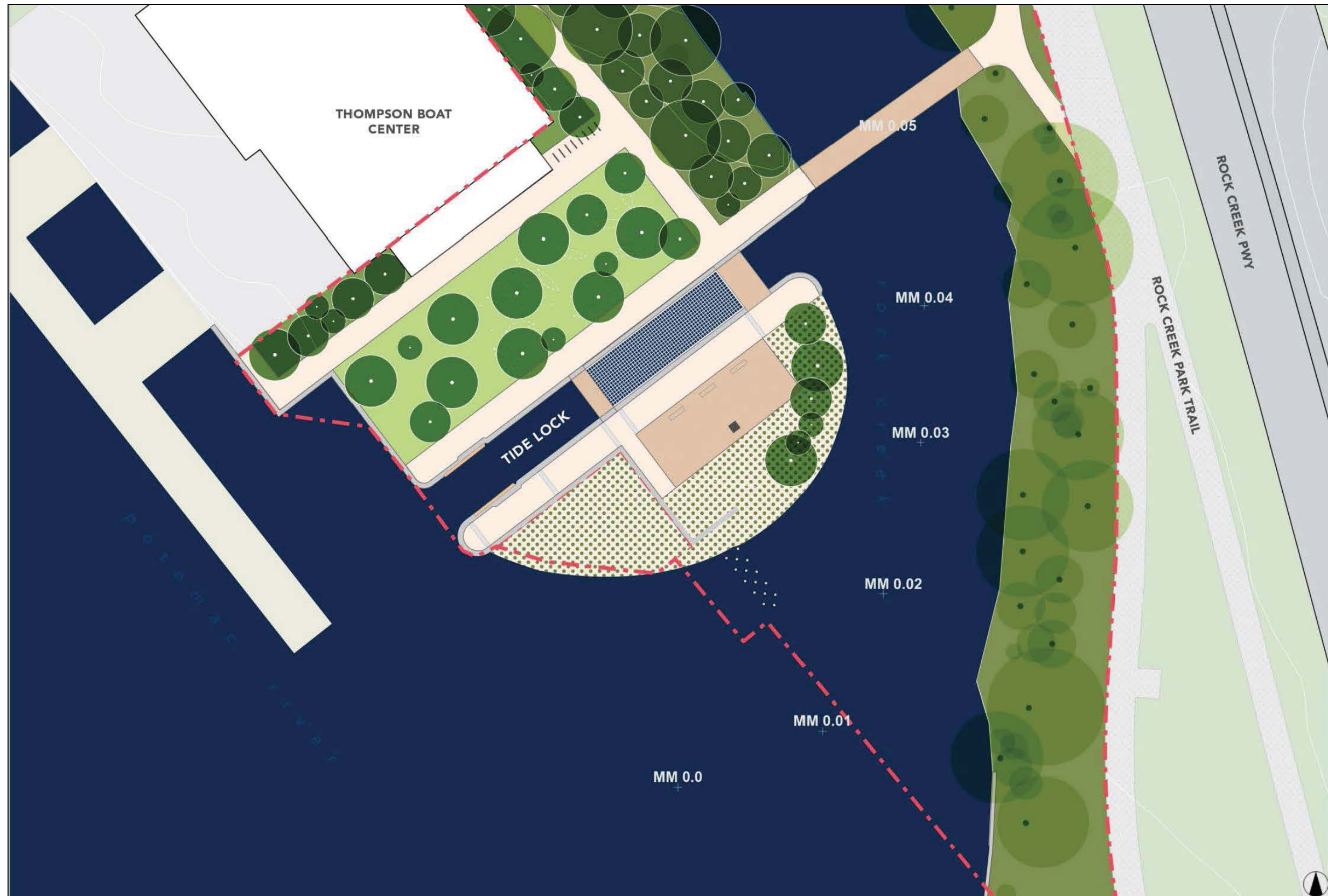

Figure 4: Proposed Concept Designs at Mile Marker Zero (Mile 0.00 - Mile 0.06)



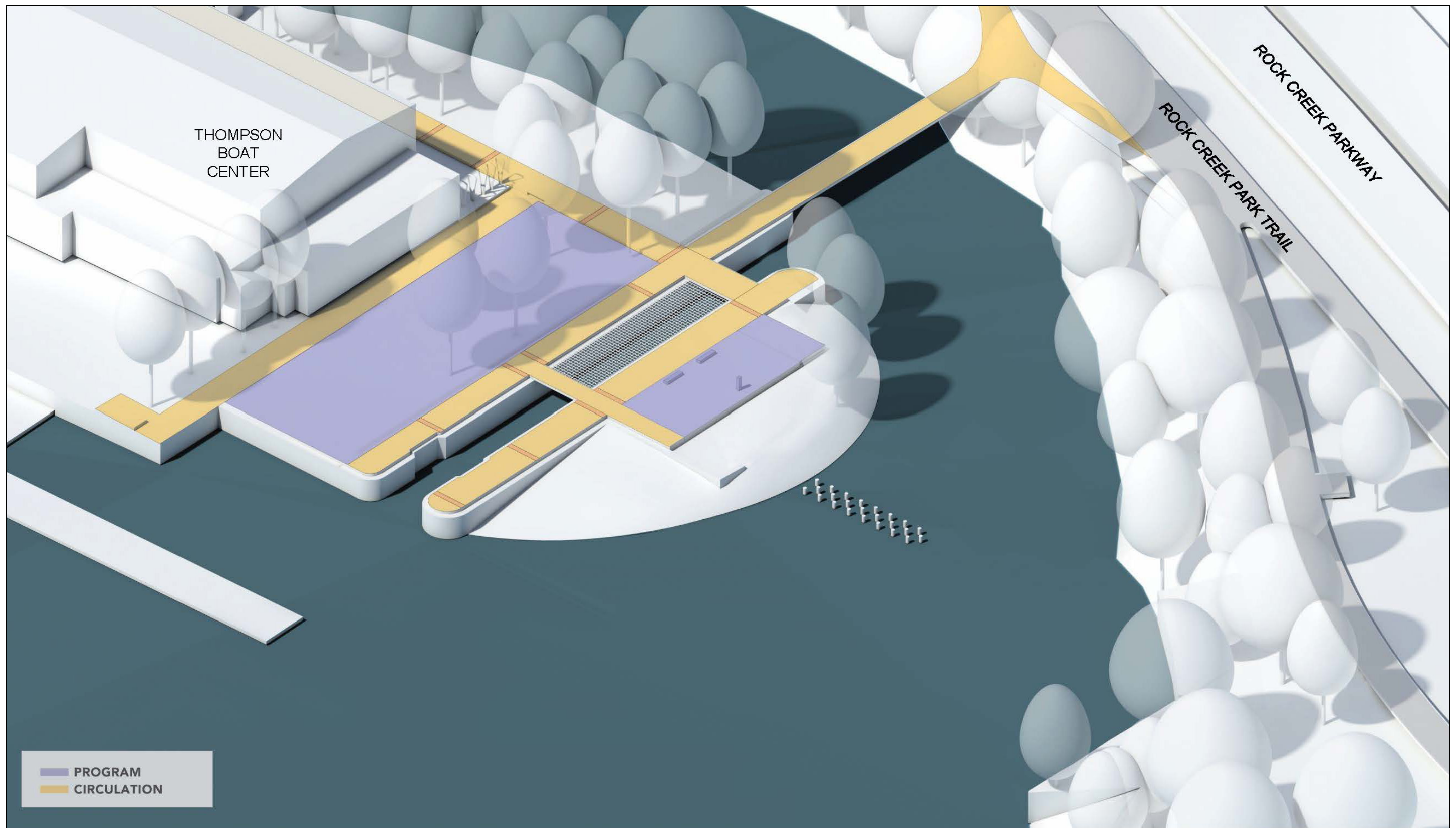

Figure 5: Axonometric Rendering of Concept Designs at Mile Marker Zero





Figure 6: Proposed Concept Designs from Mile 0.28 to Mile 0.59



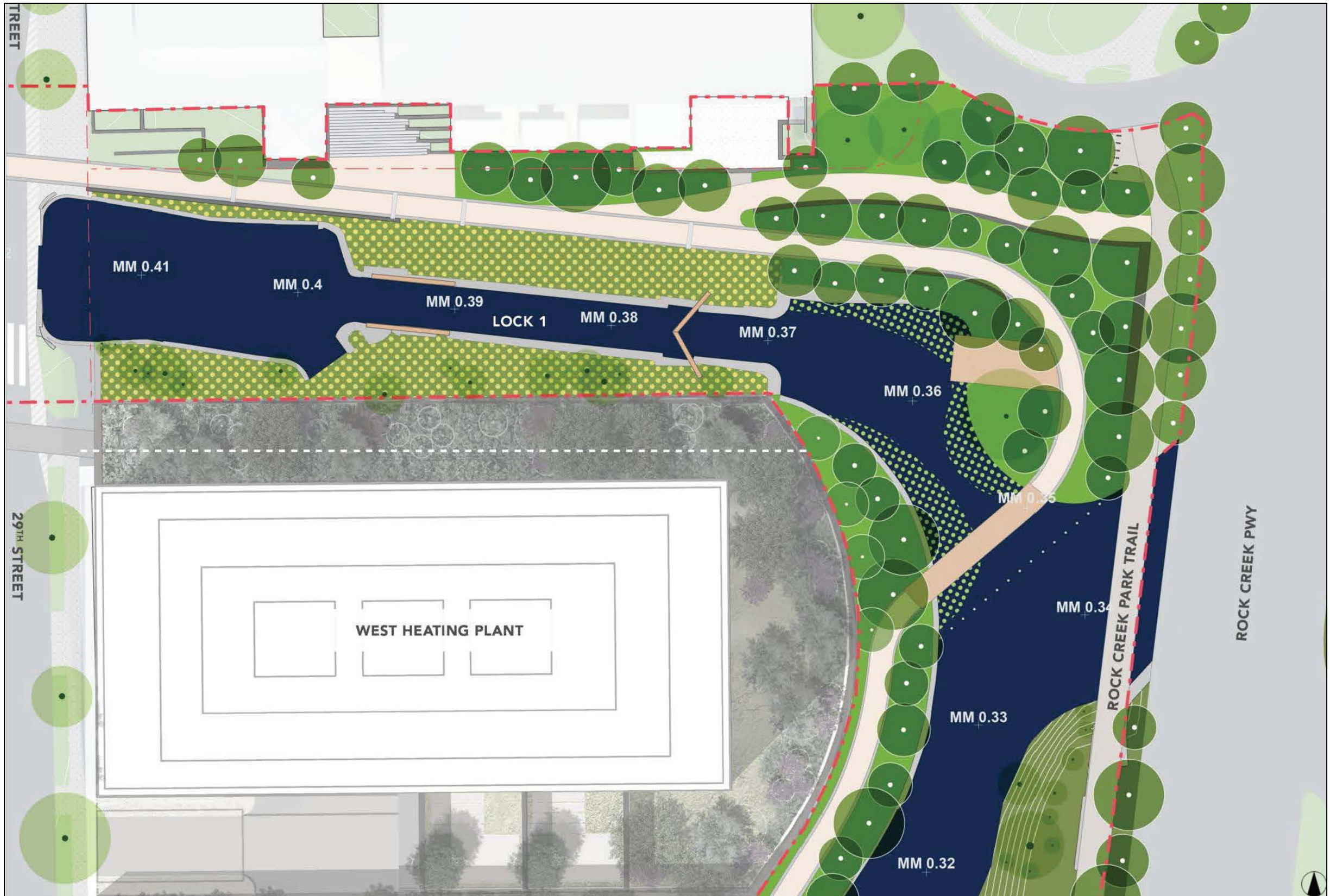
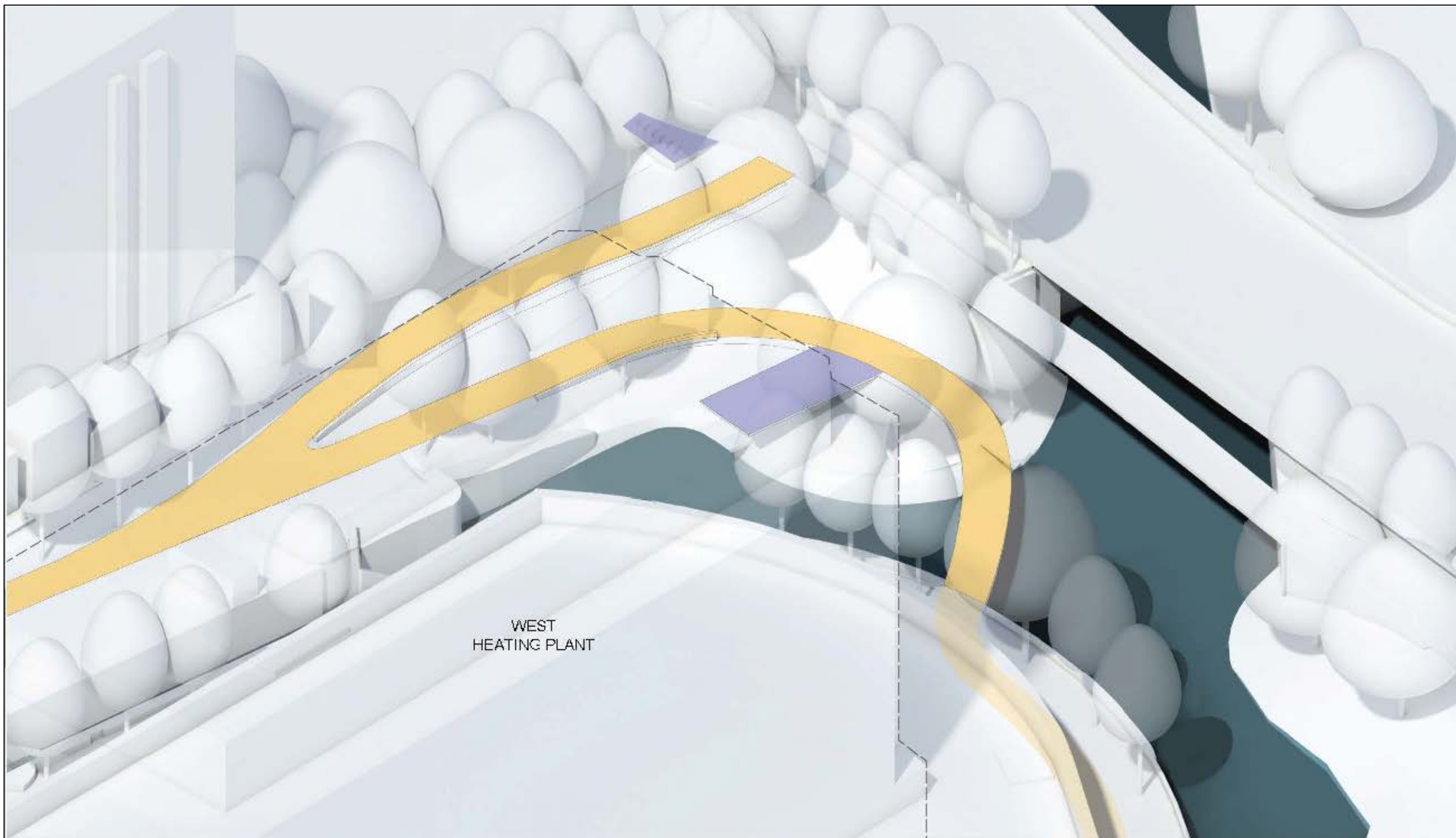

Figure 7: Proposed Concept Designs at the Rock Creek Confluence (Mile 0.32 - Mile 0.42)





**Figure 8: Axonometric Rendering of Concept Designs at Rock Creek Confluence**



Figure 9: Proposed Concept Design at The Locks (Mile 0.46 - Mile 0.53)



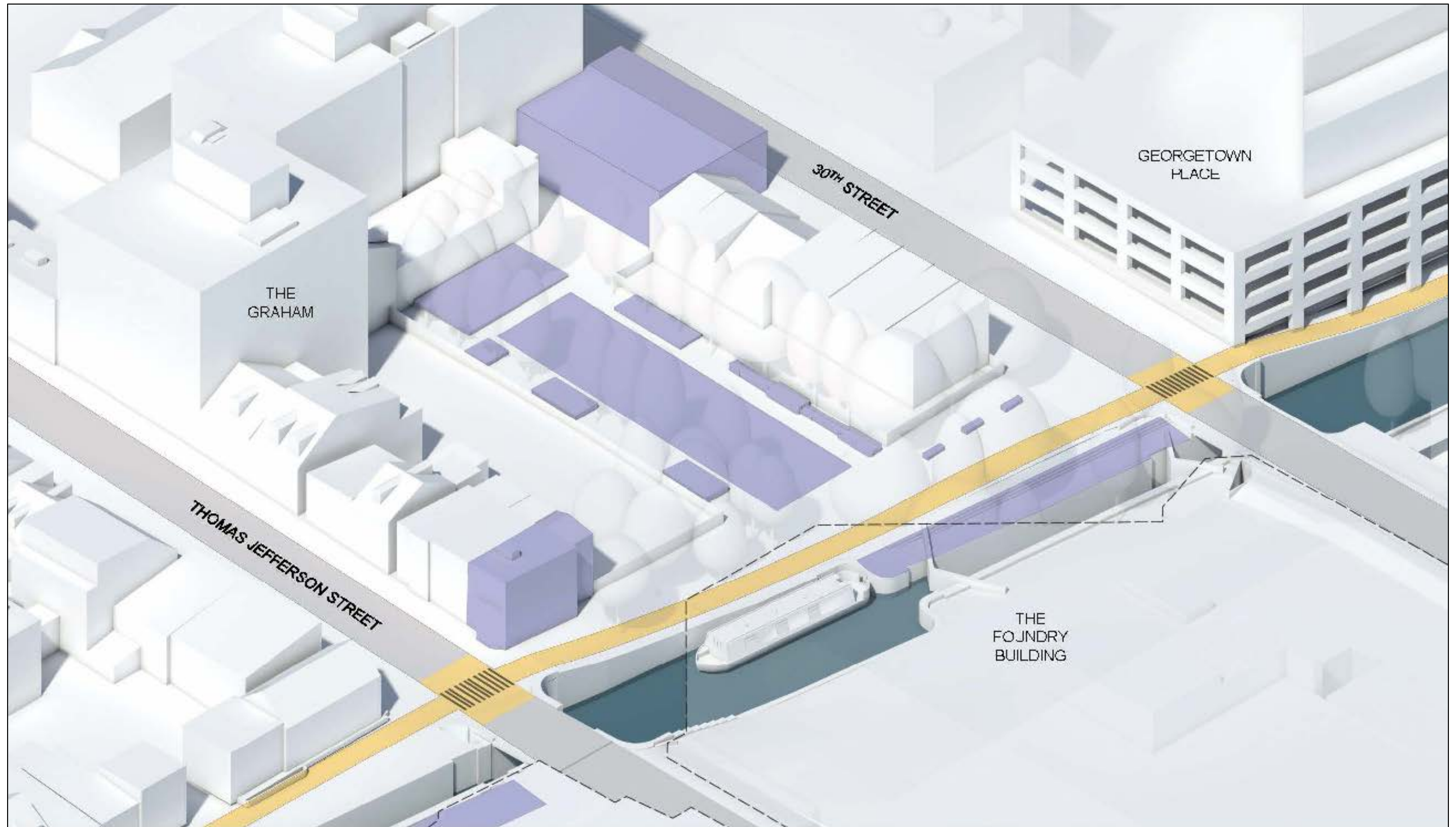

Figure 10: Axonometric Rendering of Concept Designs at The Locks



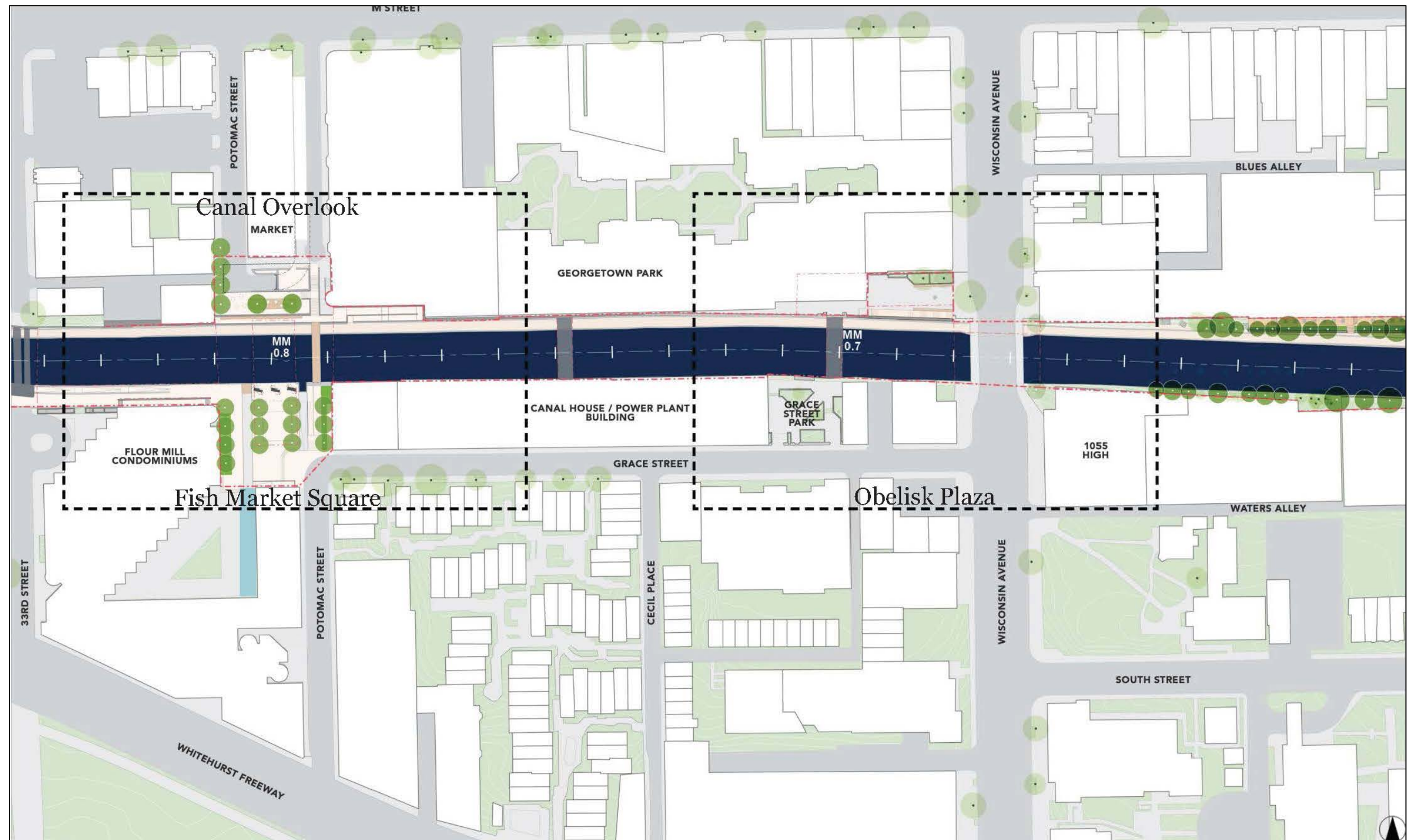

Figure 11: Proposed Concept Designs at the Obelisk Plaza (Mile 0.65 - Mile 0.72)





Figure 12: Proposed Concept Designs from Mile 0.59 to Mile 0.85



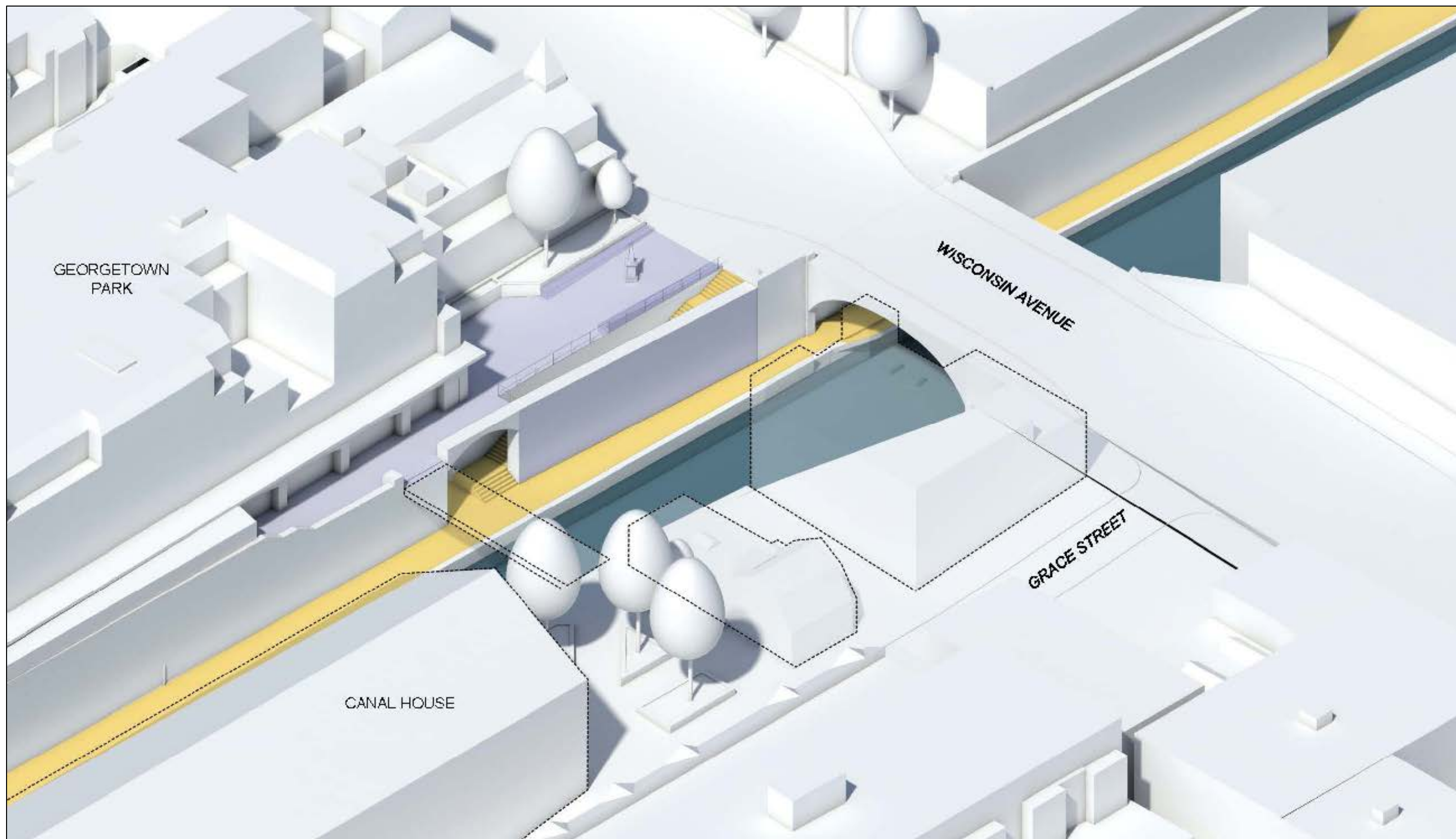

Figure 13: Axonometric Rendering of Concept Designs at The Obelisk Plaza



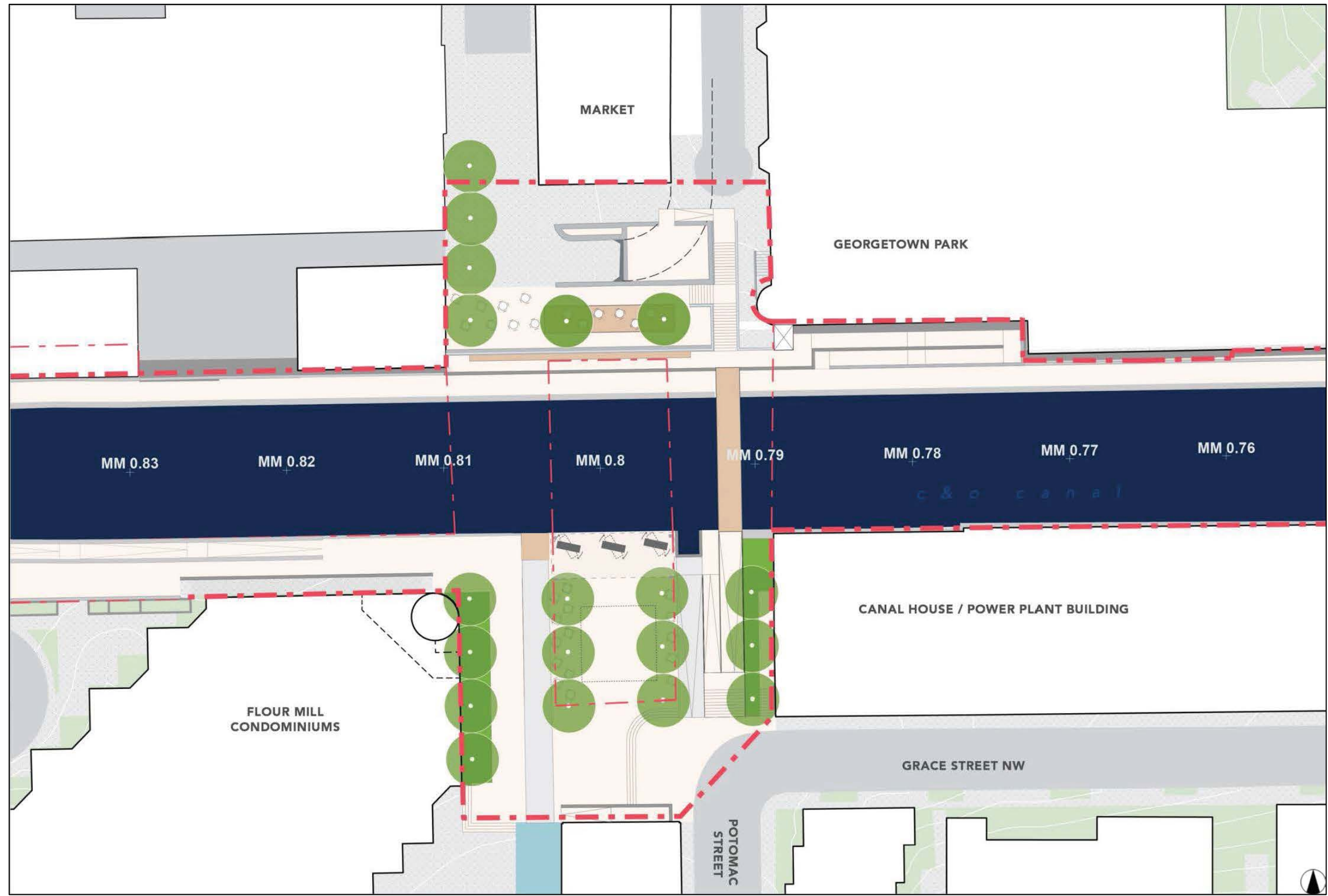

Figure 14: Proposed Concept Designs at the Canal Overlook and Fish Market Square (Mile 0.76 - Mile 0.83)



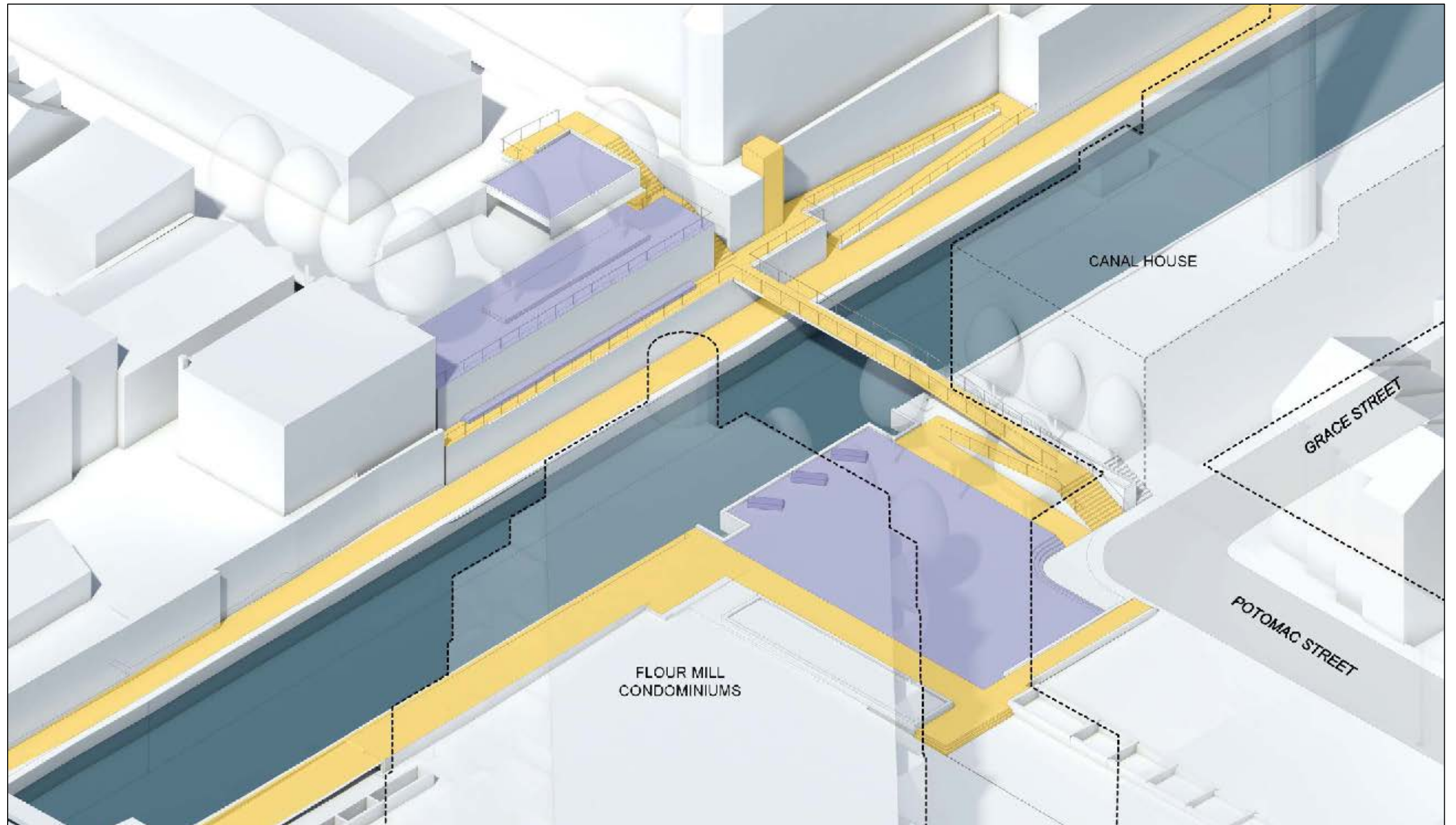

Figure 15: Axonometric Rendering of Concept Designs at the Canal Overlook and Fish Market Square



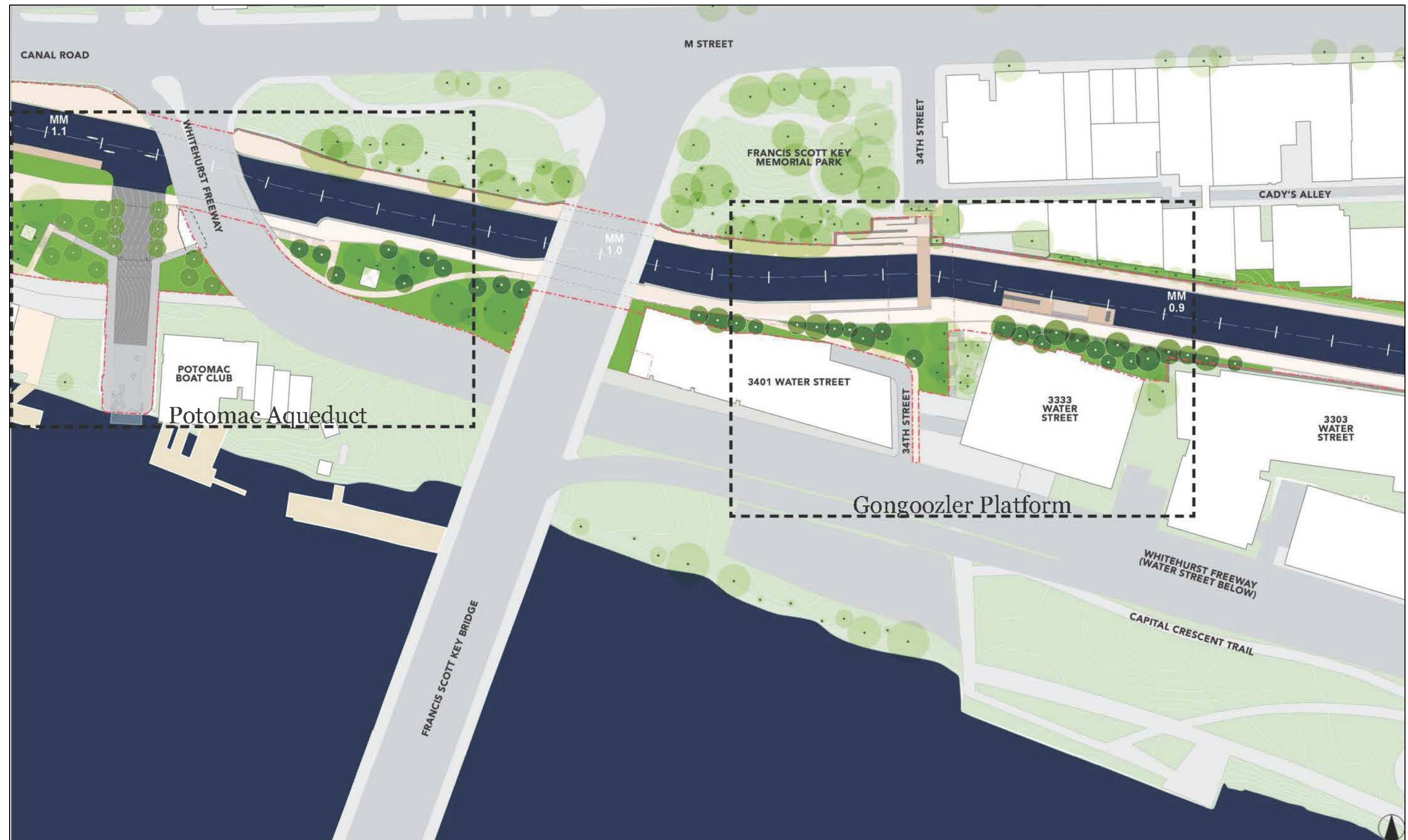

Figure 16: Proposed Concept Designs from Mile 0.85 to Mile 1.12



Figure 17: Proposed Concept Designs in the Vicinity of the Proposed Gongoozler Platform (Mile 0.90 - Mile 0.97)



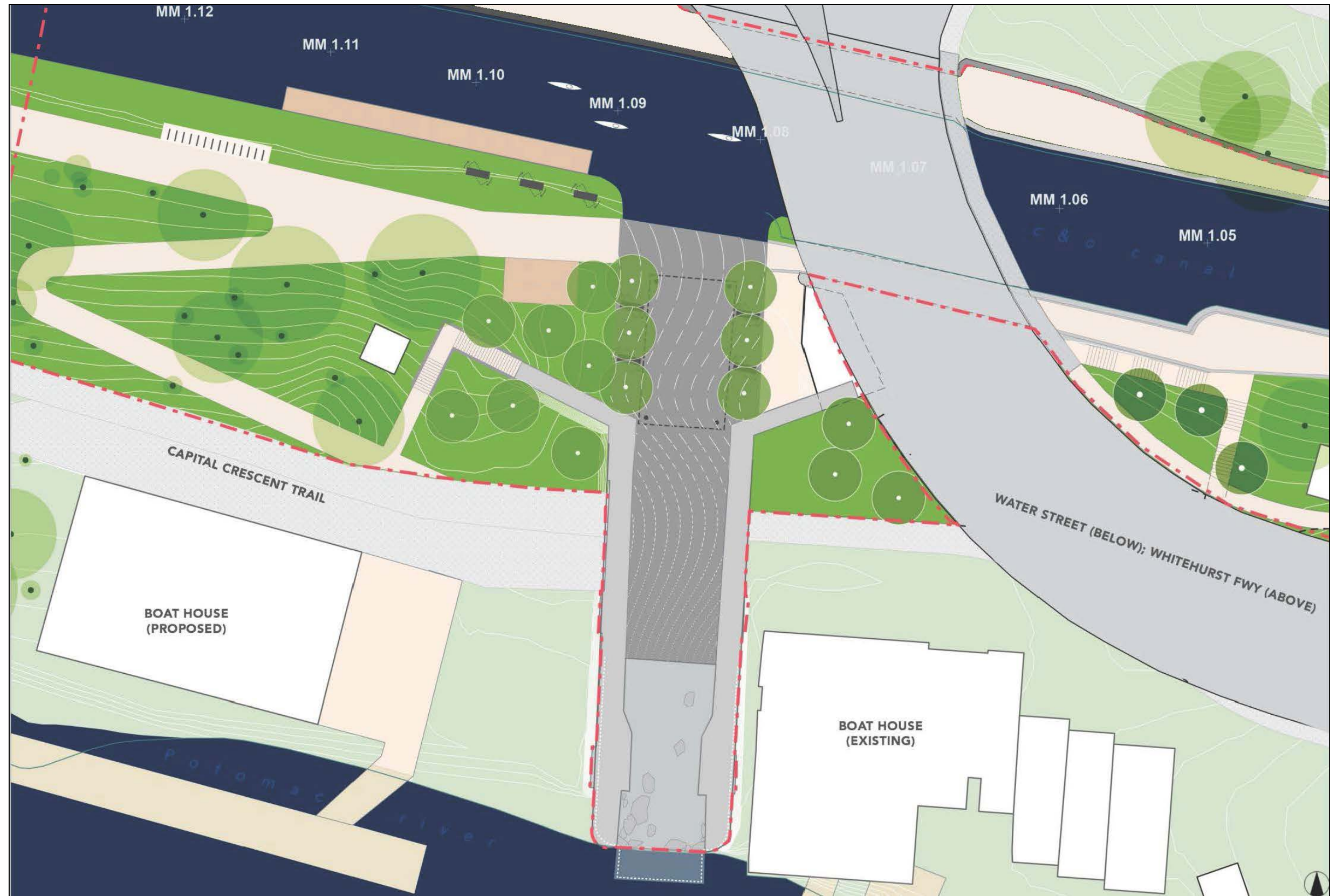

Figure 18: Proposed Concept Designs in the vicinity of the Potomac Aqueduct (Mile 1.05 - Mile 1.12)



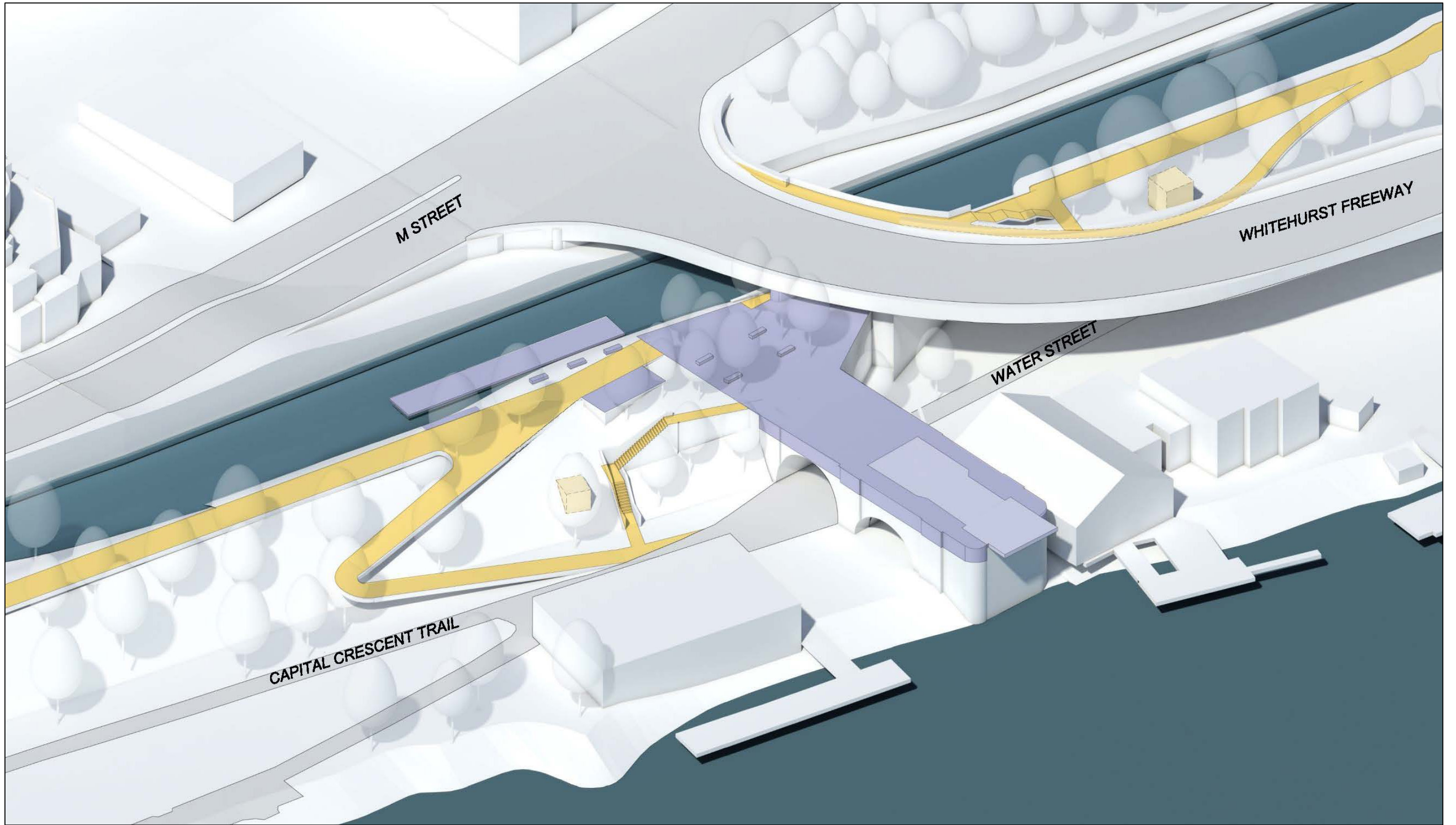

Figure 19: Axonometric Rendering of Concept Designs at the Potomac Aqueduct



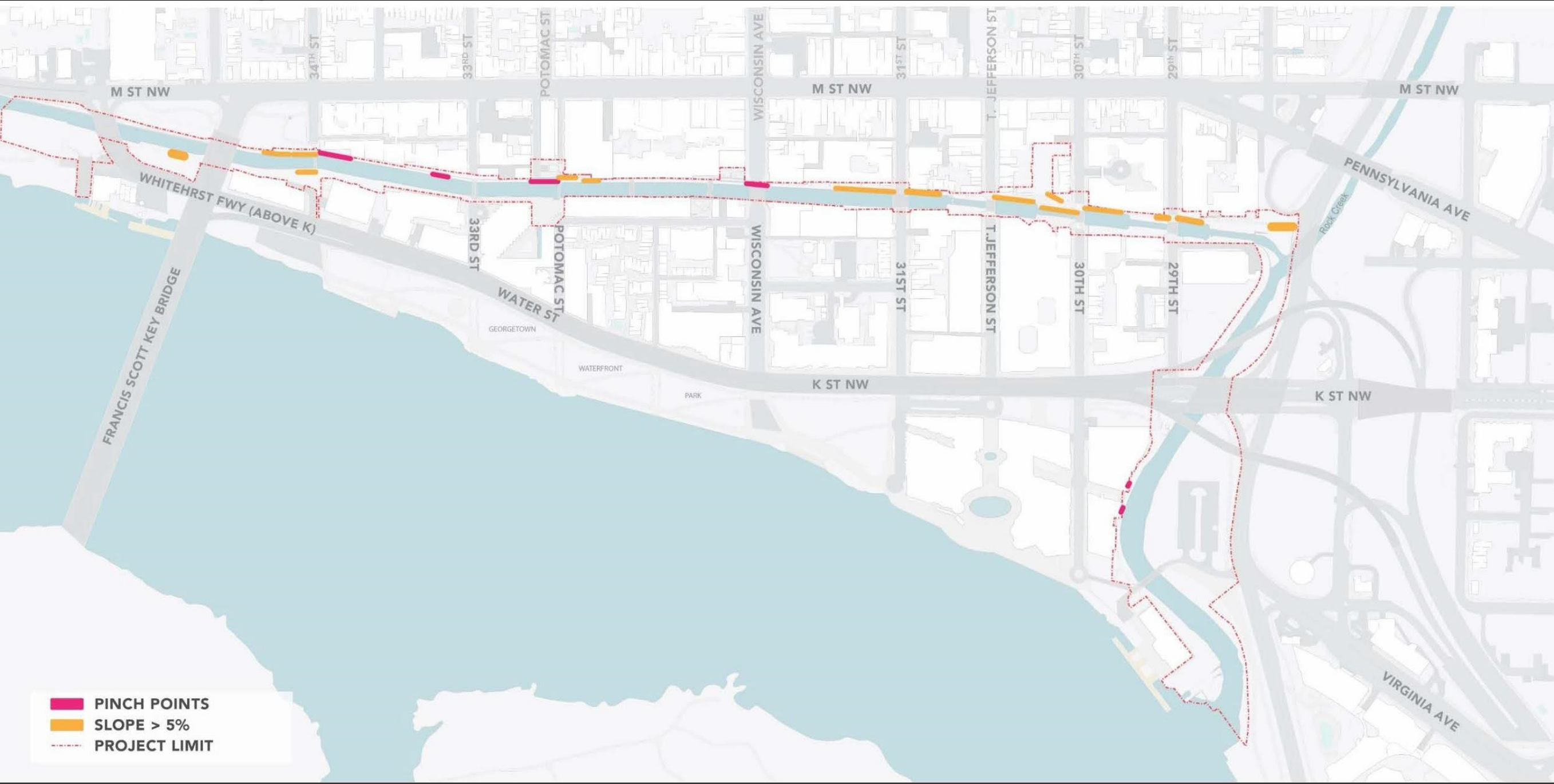

Figure 20: Proposed Towpath and Pathway Widening and Regrading Areas





**Figure 21: Current Accessibility Conditions in the project area**



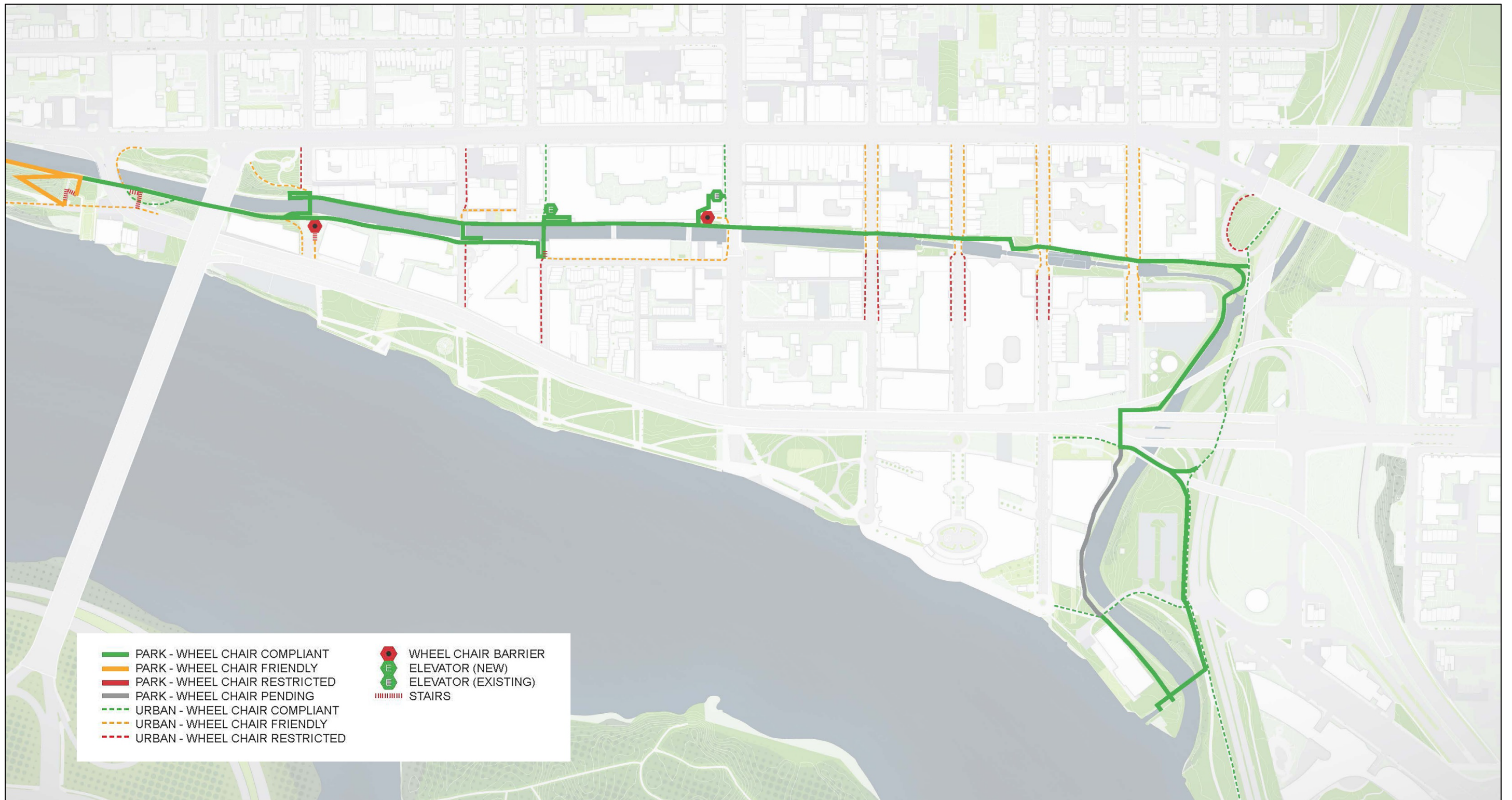

**Figure 22: Accessibility Conditions under the Georgetown Canal Plan**