

# GEORGETOWN CANAL PLAN

C&O CANAL  
NATIONAL HISTORICAL PARK  
CONSULTING PARTIES MEETING #3

October 23, 2019



# MEETING AGENDA

1. Review Project
2. Purpose and Need
3. Area of Potential Effect
4. Identified Resources
5. Alternatives and Adverse Effects
6. Next Steps

# SECTION 106 AND NEPA COORDINATION

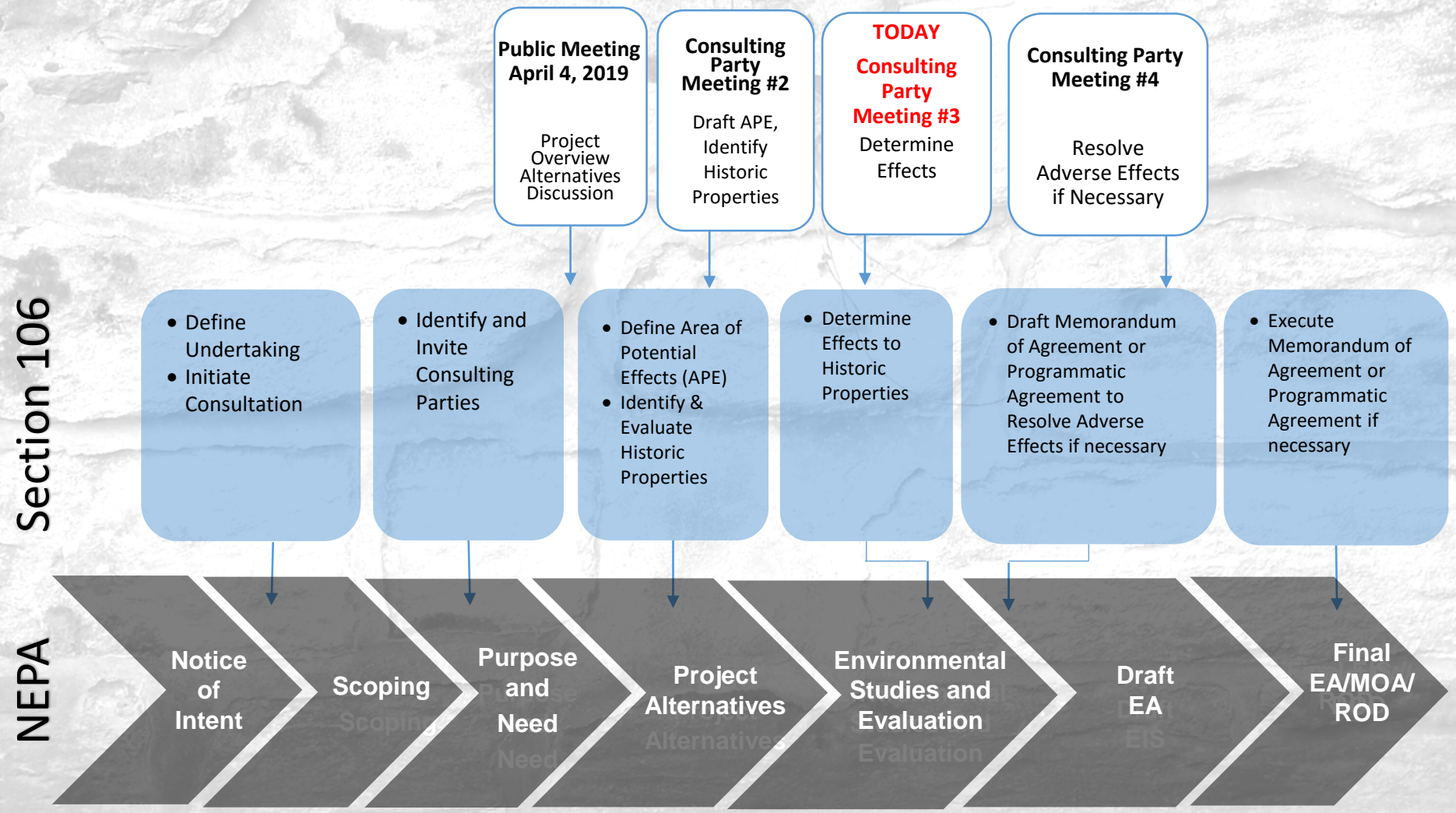

# PROJECT BACKGROUND AND LOCATION

4



The plan will focus on **addressing deferred maintenance issues and related safety** and **accessibility** concerns associated with the towpath; **improving connections** between Georgetown and the C&O Canal towpath; **enhancing visitor experience** through increased signage and optimizing underutilized areas.

- Portions of the towpath are uneven, narrow, and poorly lit, creating potential safety hazards;
- Visitors with limited mobility can only access the towpath from Grace Street, NW (south of the canal). All other access points are not compliant with the Architectural Barriers Act Accessibility Standards (ABAAS);
- Many access points to the towpath are not readily visible or unknown due to lack of signage;
- The park desires to expand opportunities for interpretation, education, and cultural programming;
- The park has limited amenities and facilities for visitor comfort such as seating, drinking fountains, and rest rooms; and
- Several plazas along the canal are underutilized and could be developed to provide additional recreational activities.

# DRAFT AREA OF POTENTIAL EFFECT (APE)

7

Expanded based on Consulting  
Party comments from CP  
Meeting #2

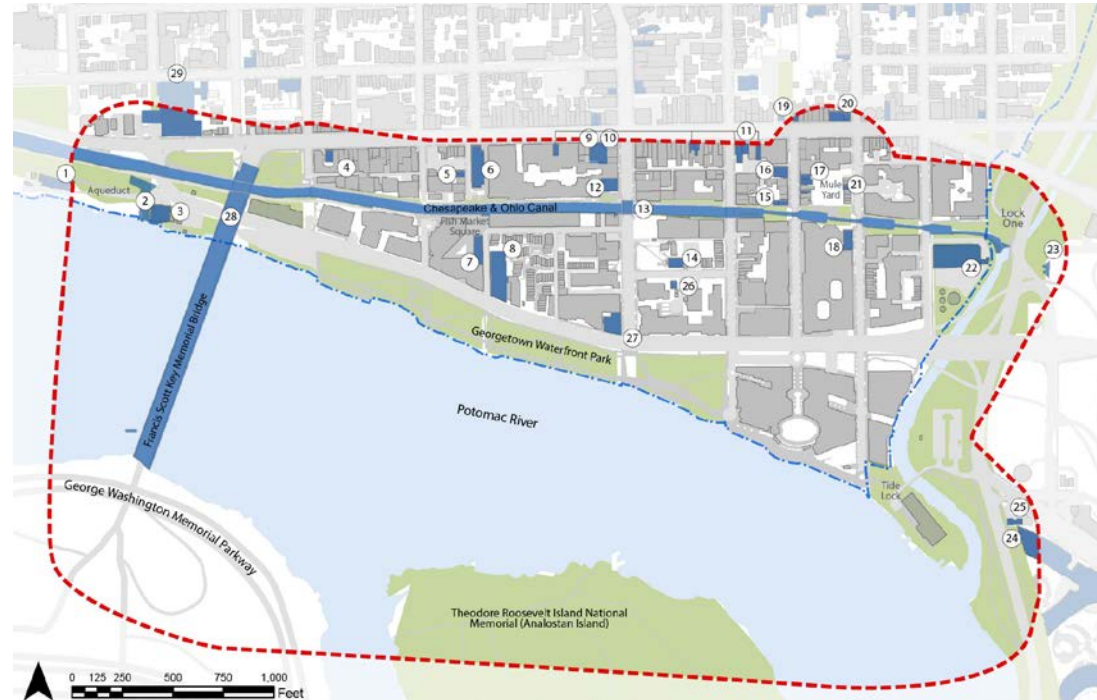

## Key



Draft APE Boundary (300 ft)



Individually Listed Properties



Georgetown National Historic Landmark  
District

## Individually Listed Properties\*

- |   |   |                                      |
|---|---|--------------------------------------|
| 1. Washington Canoe Club                      | 9. Old Engine Company No. 5                     | 17. Nicholas Hedges & Federal Houses |
| 2. Potomac Aqueduct Bridge<br>Abutment & Pier | 10. City Tavern                                 | 18. Duvall Foundry                   |
| 3. Potomac Boat Club                          | 11. Georgetown Commercial Bldgs.                | 19. Loughborough-Patterson House     |
| 4. Forrest-Marbury House                      | 12. Vigilant Fire House                         | 20. Thomas Sim Lee Corner            |
| 5. Joseph Carleton House                      | 13. Wisconsin Ave. Bridge and Canal<br>Monument | 21. Henry McCleery House             |
| 6. Georgetown Market                          | 14. Grace Church                                | 22. West Heating Plant               |
| 7. Bomford Mill                               | 15. Potomac Masonic Lodge No. 5                 | 23. Godey Lime Kilns                 |
| 8. D.C. Paper Mfg. Company                    | 16. Adams-Mason Houses                          | 24. Watergate Complex                |
|   |   | 25. Key Bridge                       |

\* Listed or determined eligible for listing in the National Register and/or DC Inventory

# HISTORIC DISTRICTS

8

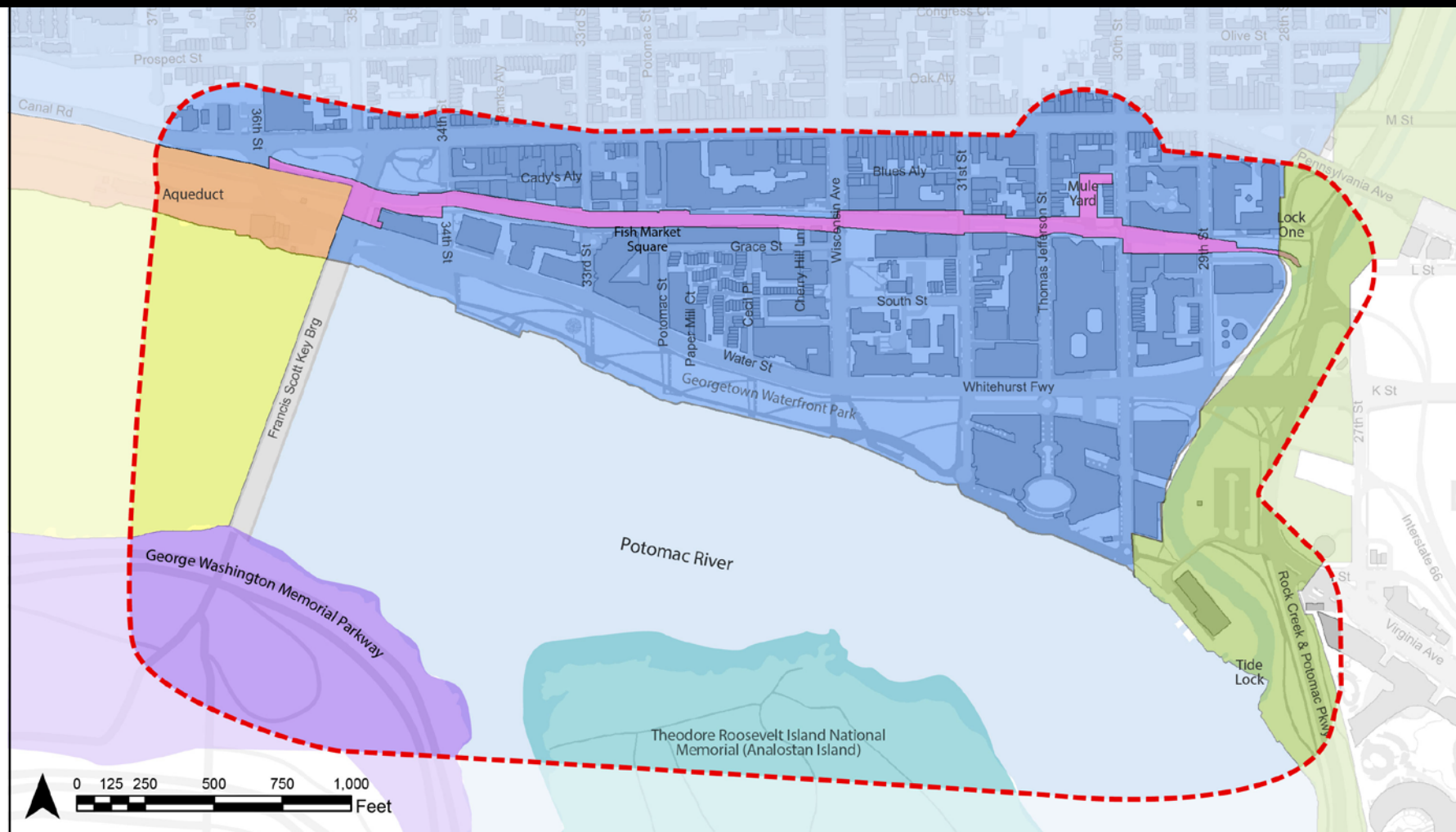

## Key

- |   |   |   |  |
|---|---|---|--|
|  | Chesapeake and Ohio Canal National Historical Park      |  | C&O Canal and Potomac Gorge overlap                            |
|  | Rock Creek and Potomac Parkway                          |  | Theodore Roosevelt Island National Memorial (Analostan Island) |
|  | Georgetown National Historic Landmark District          |  | George Washington Memorial Parkway                             |
|  | The Potomac Gorge (Potomac Palisades) Historic District |  | Draft APE Boundary (300 ft)                                    |

# ARCHAEOLOGY

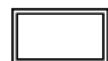
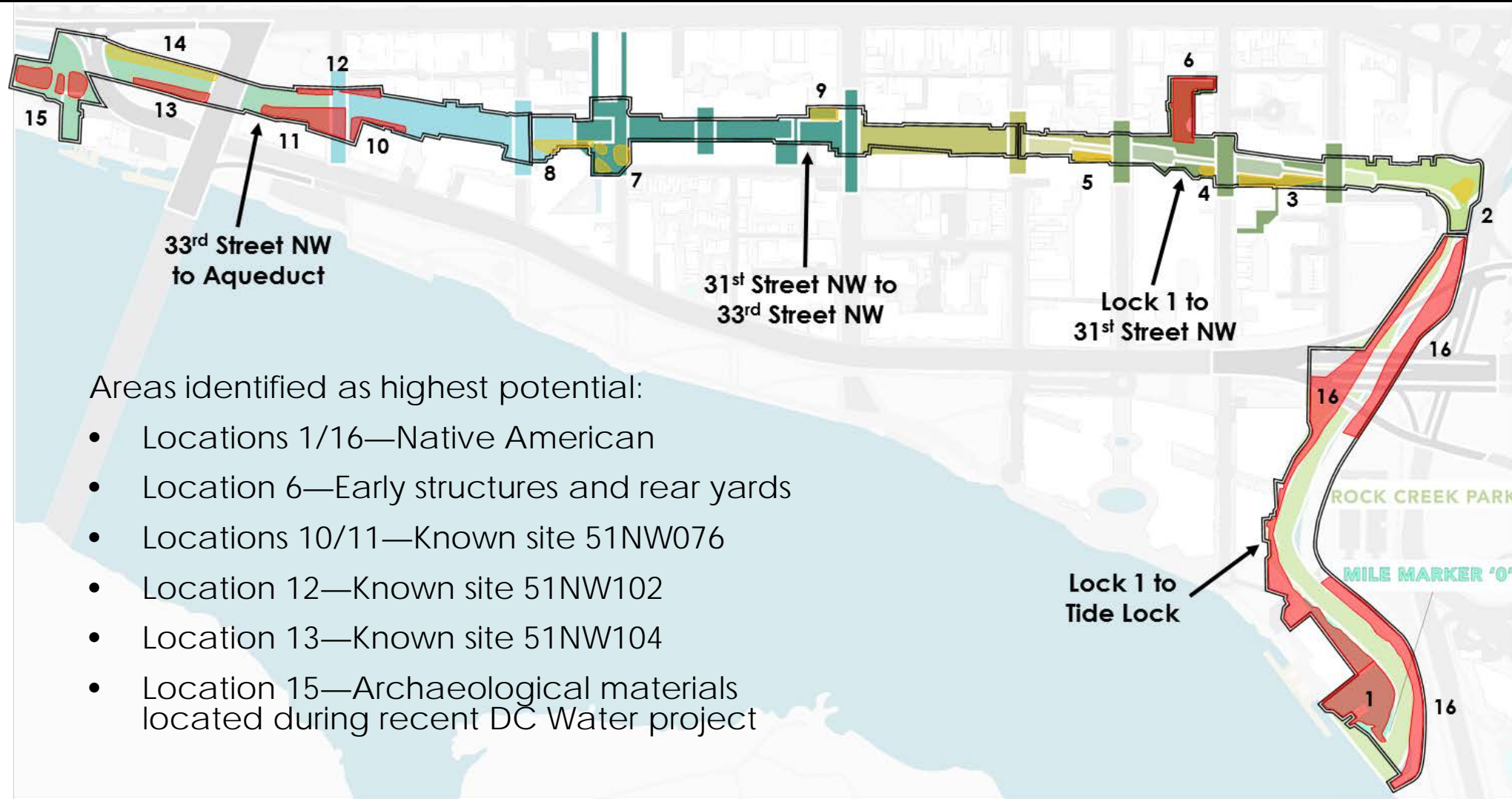

Study Area Boundaries



Areas of High Archaeological Potential



Area of Moderate Archaeological Potential

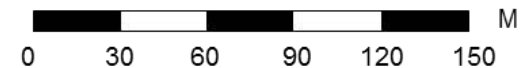

## Potential adverse effect/impacts to historic resources:

- alterations that are inconsistent with the *Secretary's Standards for the Treatment of Historic Properties*, including alterations to the towpath, stone abutments, retaining walls, canal prism or locks;
- physical destruction or damage of historic towpath, stone abutments, retaining walls, canal prism or locks;
- damage or impacts to significant vegetation including urban exotics, princess trees, red maples, weeping willows and small leaf Lindens at Lock No. 4;
- intrusions to views and vistas along the canal;
- addressing handicap accessibility while minimizing physical destruction or damage of historic fabric of the towpath or bridges; and
- introduction of new elements that diminish the Canal's integrity.

## 1. No Action Alternative



Immediate Repairs  
&  
Current Operations & Maintenance

## 2. Build Alternative



*Un-Lock the Potential*  
Base Repair & Rehabilitation

## 1. *Actions Common to All*

- Canal Infrastructure Repairs and Rehab
- Riparian Planting and Stream Bank Restoration
- Towpath and Pathway Enhancements
- Interpretive and Wayfinding Signage

## 2. *Zone A*

- Mile-Marker Zero

## 3. *Zone B*

- Rock Creek Confluence
- The Locks

## 4. *Zone C*

- The Obelisk Plaza
- The Canal Overlook
- Fish Market Plaza

## 5. *Zone D*

- Gongoozler Platform
- Potomac Aqueduct



# 1. ACTIONS COMMON TO ALL

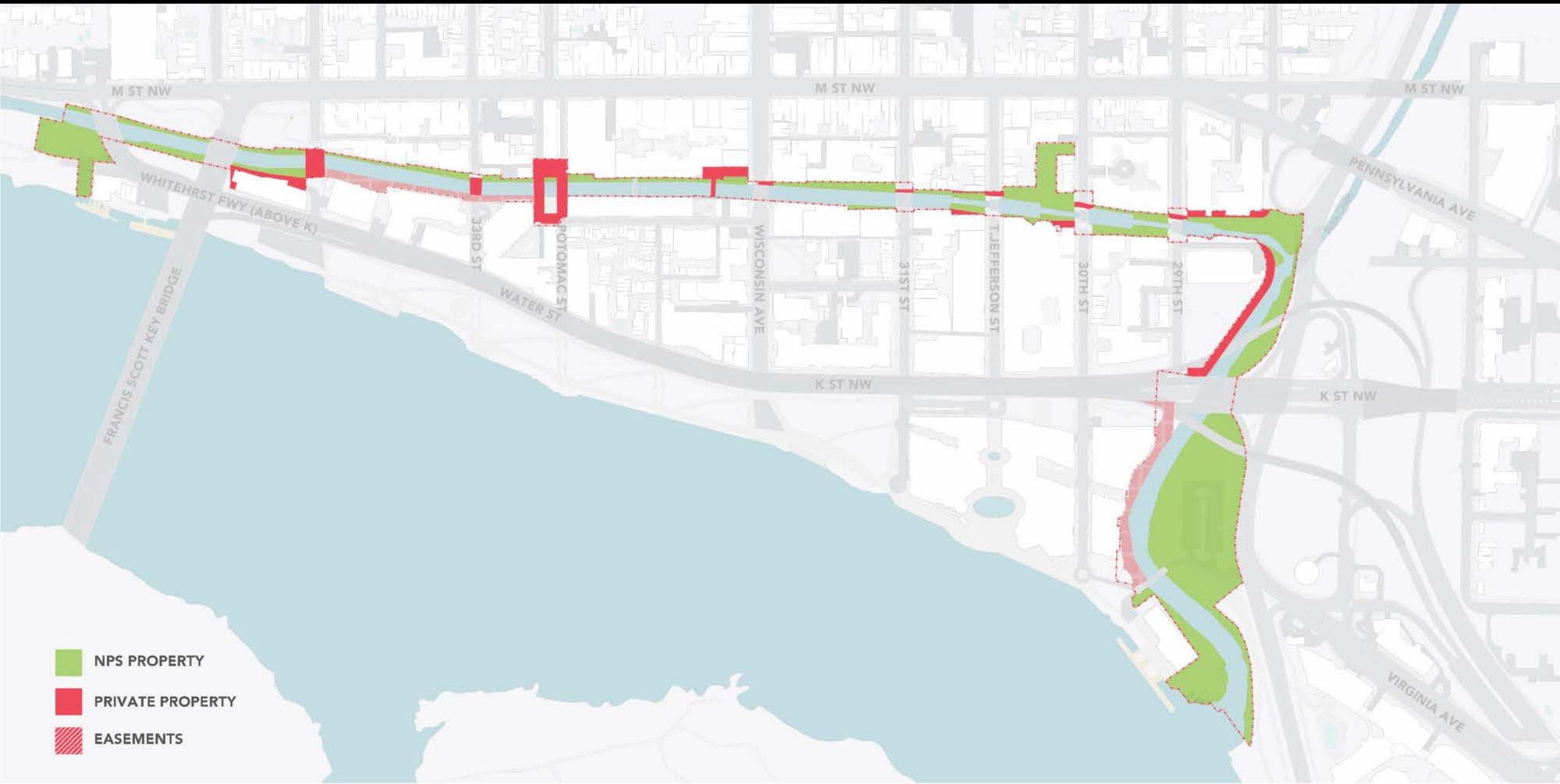



Riparian/Stream Bank Restoration	Mile marker(s)	Zone/Key Area	Project Type - Title			Figure Reference
	0.00 - 0.21	Zone A	Stabilization - Stream Bank Riparian Planting			4
	0.06 - 0.13	Zone A	Repairs - West Stream Bank Timber Sheeting			4
	0.21 - 0.23	Zone A	Repairs - East Stream Bank Stone Armoring			4
	0.26 - 0.33	Zone A Zone B	Stabilization - East Stream Bank Riparian Planting			4, 6
	0.34 - 0.37	Zone B Rock Creek Confluence	Stabilization - Stream Bank Riparian Planting			6, 7
Existing, Relocated, and Proposed new Trees	Mile marker(s)	Zone	Existing Trees	Removed Trees	New Trees (Portion on private property)	Relocated Trees
	0.00 - 0.28	Zone A	185	15	200 (140*)	8
	0.28 - 0.59	Zone B	75	20	145 (25*)	6
	0.59 - 0.85	Zone C	42	22	40 (2*)	0
	0.26 - 0.33	Zone D	40	20	50 (20*)	0

# TOWPATH ENHANCEMENTS

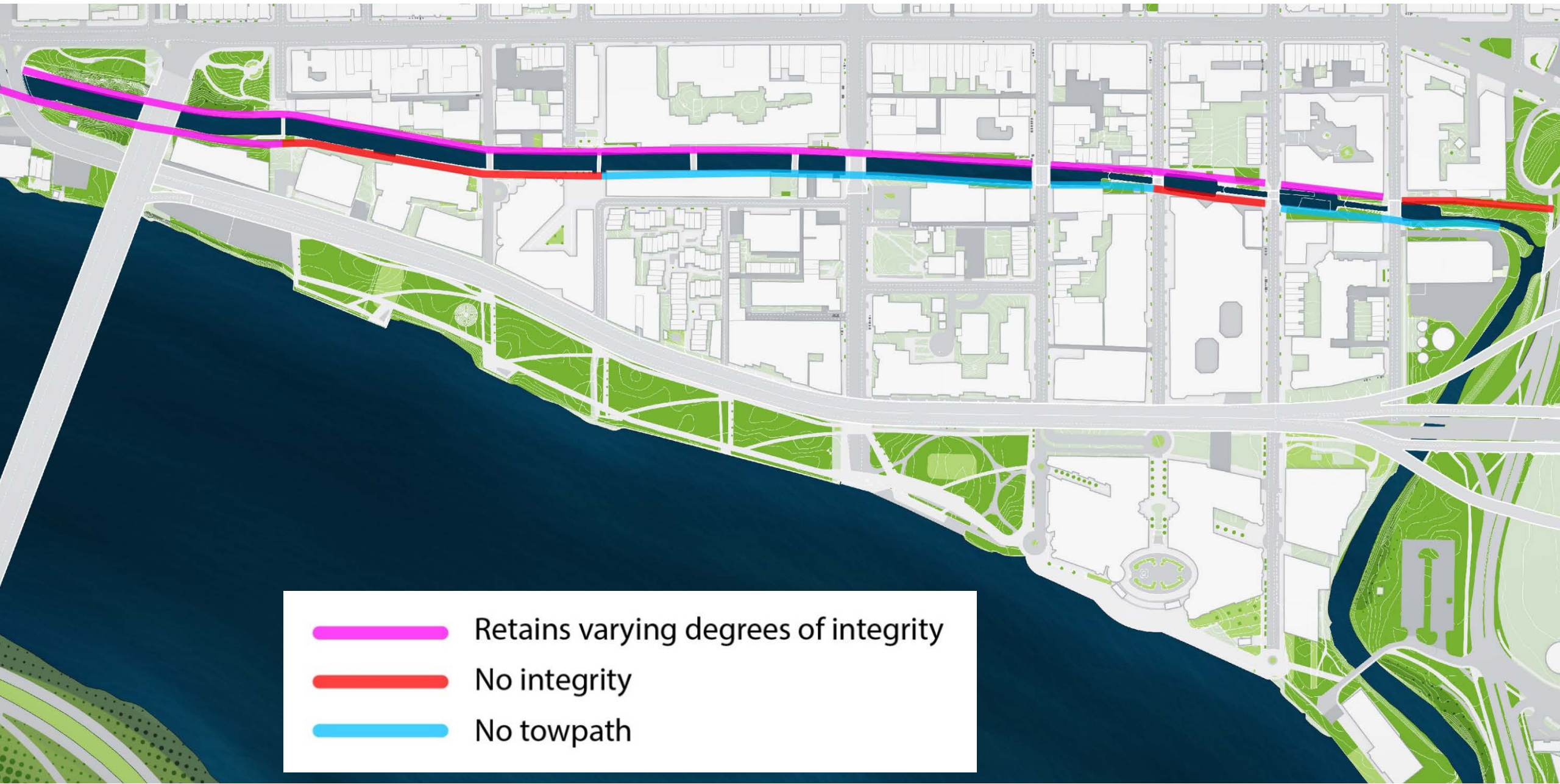



-  Retains varying degrees of integrity
-  No integrity
-  No towpath

# EXISTING CONDITONS



Brick at Lock 2



Brick and Stone at 31<sup>st</sup> St



Gravel at Key



Packed Gravel under Wisconsin



Looking east from  
Potomac St Bridge

# PINCH POINTS

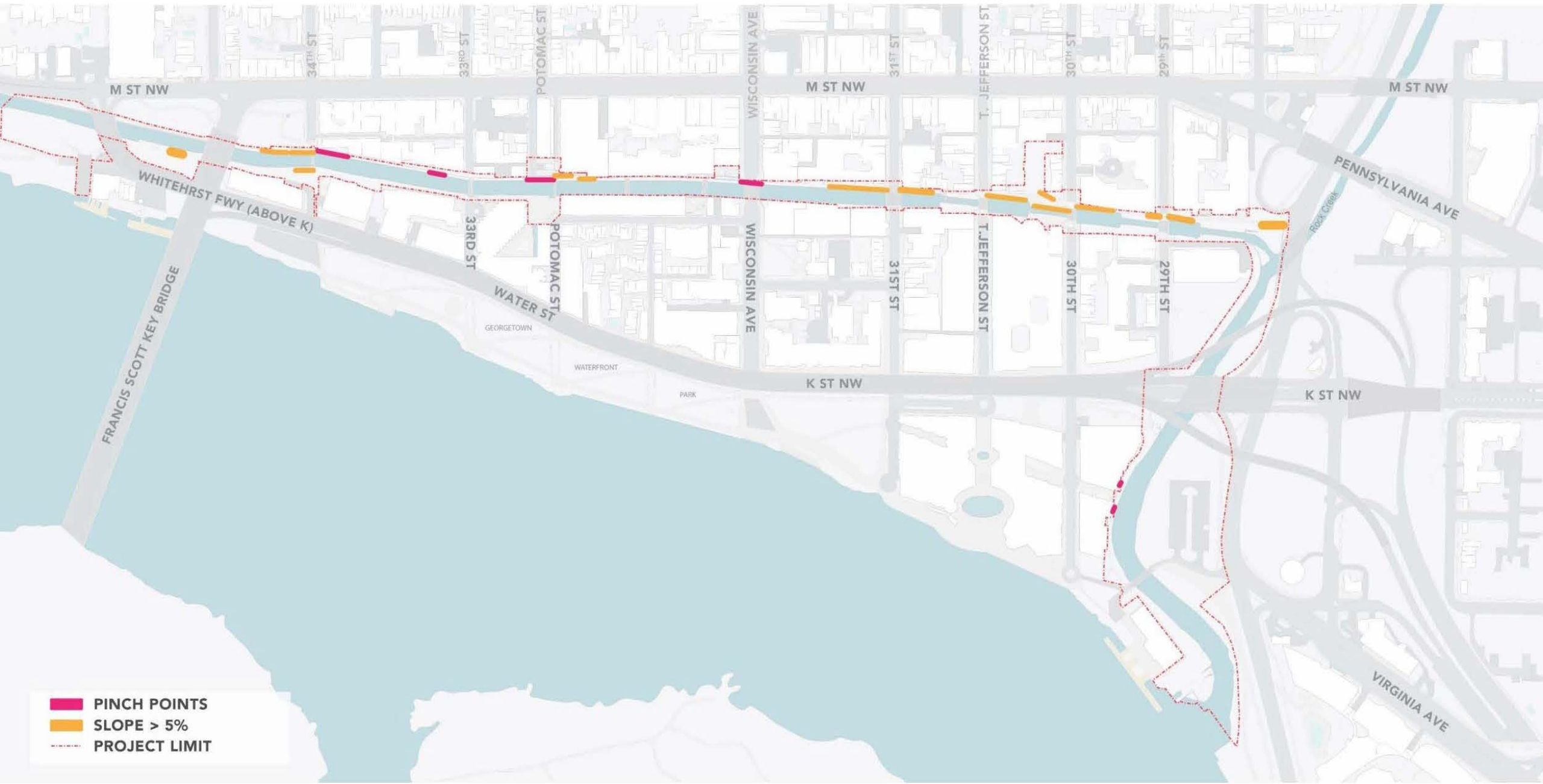

# TOWPATH: ASSESSMENT OF EFFECTS



Resource	Adverse Effects
C&O Canal NHP	<ul style="list-style-type: none"> <li>• Widening Towpath</li> <li>• Adding Signage</li> </ul>
Rock Creek and Potomac Parkway	No Adverse Effect
Georgetown NHL District	No Adverse Effect
The Potomac Gorge	No Adverse Effect
Theodore Roosevelt Island	No Adverse Effect
GWMP	No Adverse Effect
Individually Listed Resources	No Adverse Effect

2. ZONE A



# EXISTING CONDITIONS



# ZONE A: ASSESSMENT OF EFFECTS



Resource	Adverse Effects
C&O Canal NHP	No Adverse Effect
Rock Creek and Potomac Parkway	Adding Vegetation Along Parkway
Georgetown NHL District	No Adverse Effect
The Potomac Gorge	No Adverse Effect
Theodore Roosevelt Island	No Adverse Effect
GWMP	No Adverse Effect
Individually Listed Resources	No Adverse Effect

# MILE-MARKER ZERO



# EXISTING CONDITIONS

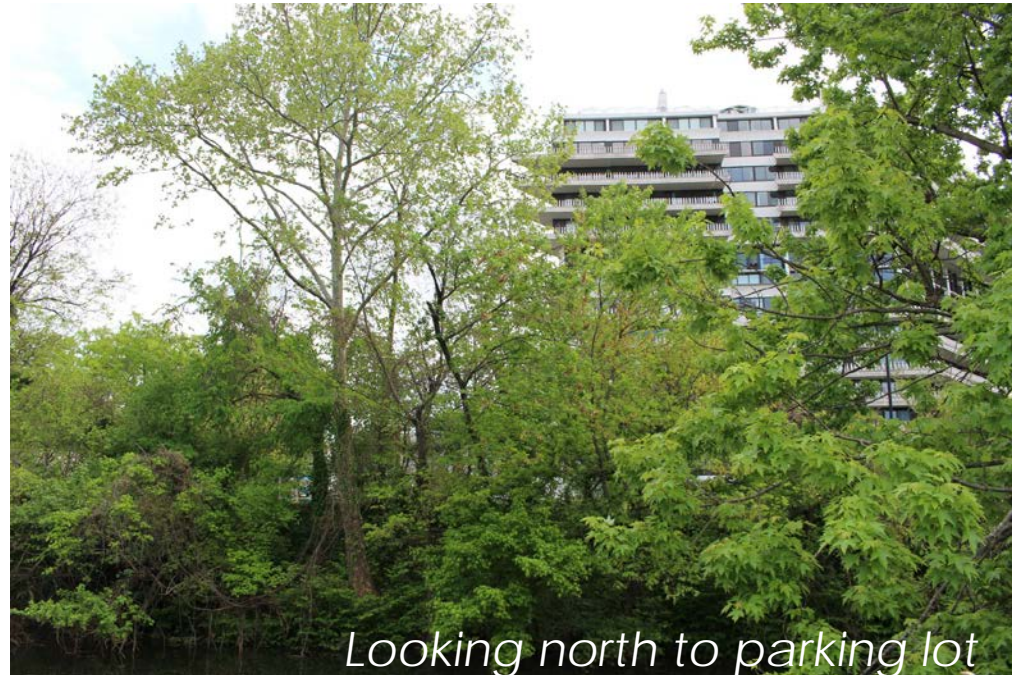

# MILE MARKER ZERO

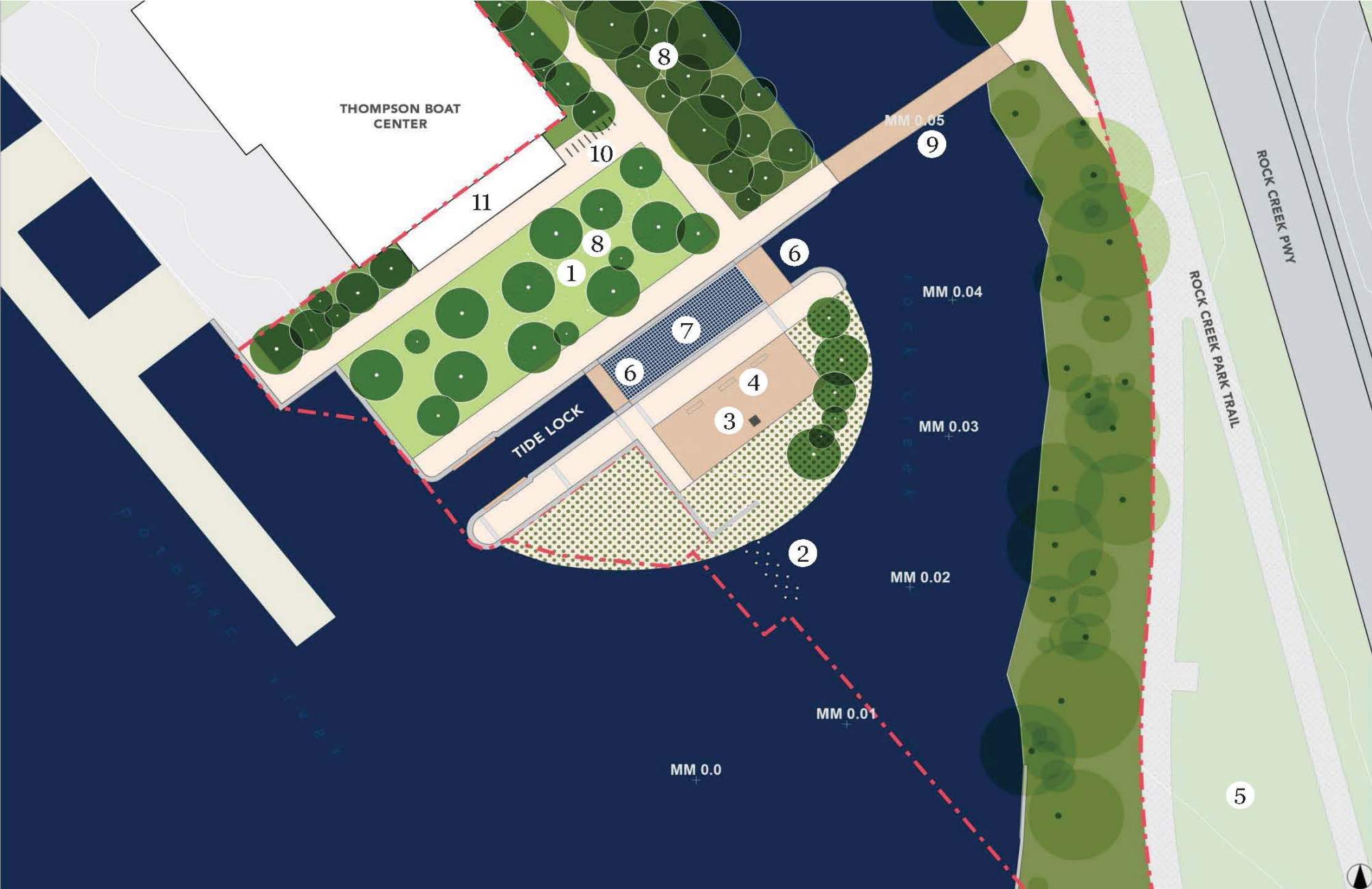

# MILE-MARKER ZERO: ASSESSMENT OF EFFECTS



Looking south



Looking north

Resource	Adverse Effects
C&O Canal NHP	<ul style="list-style-type: none"> <li>Adding Two Tide Lock Bridges</li> <li>Adding Tide Lock Nets</li> <li>Adding Mole Platform</li> </ul>
Rock Creek and Potomac Parkway	<ul style="list-style-type: none"> <li>Adding New Bridge</li> <li>Adding Recreational Equipment</li> </ul>
Georgetown NHL District	No Adverse Effect
The Potomac Gorge	No Adverse Effect
Theodore Roosevelt Island	No Adverse Effect
GWMP	No Adverse Effect
Individually Listed Resources	No Adverse Effect

2. ZONE B



# EXISTING CONDITIONS



# ZONE B: ASSESSMENT OF EFFECTS



Resource	Adverse Effects
C&O Canal NHP	Adding Me Amo Grove
Rock Creek and Potomac Parkway	No Adverse Effect
Georgetown NHL District	No Adverse Effect
The Potomac Gorge	No Adverse Effect
Theodore Roosevelt Island	No Adverse Effect
GWMP	No Adverse Effect
Individually Listed Resources	No Adverse Effect

# ROCK CREEK CONFLUENCE



# ROCK CREEK CONFLUENCE

33



*Looking southwest*

JAMES  
CORNER  
FIELD  
OPERATIONS

# ROCK CREEK CONFLUENCE

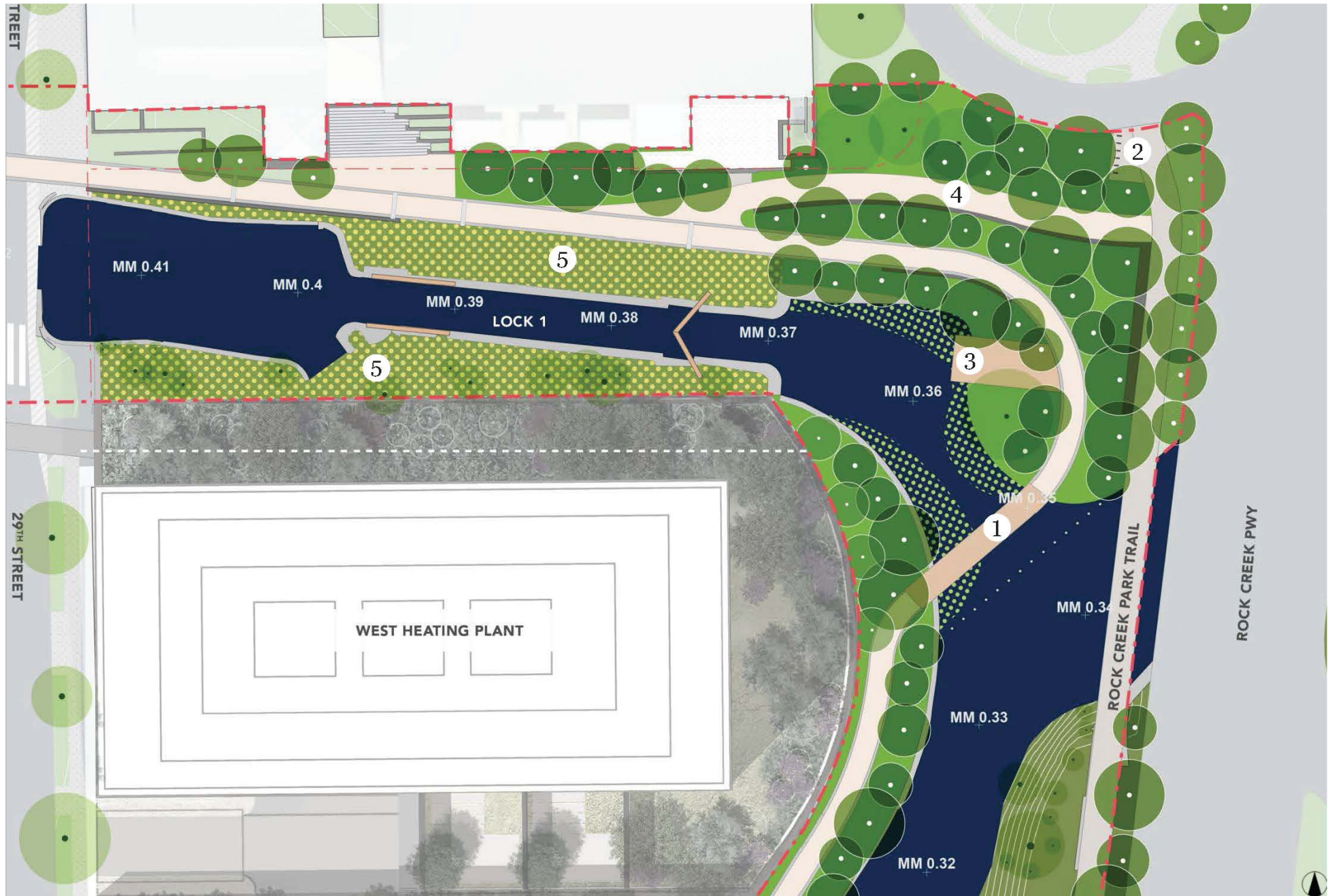

# ROCK CREEK CONFLUENCE: ASSESSMENT OF EFFECTS



Resource	Adverse Effects
C&O Canal NHP	<ul style="list-style-type: none"> <li>• Adding New Bridge</li> <li>• Adding Platform</li> </ul>
Rock Creek and Potomac Parkway	No Adverse Effect
Georgetown NHL District	No Adverse Effect
The Potomac Gorge	No Adverse Effect
Theodore Roosevelt Island	No Adverse Effect
GWMP	No Adverse Effect
Individually Listed Resources	No Adverse Effect

# THE LOCKS



# EXISTING CONDITIONS



# THE LOCKS



# THE LOCKS: ASSESSMENT OF EFFECTS



(HSW, c. 1950s)

Resource	Adverse Effects
C&O Canal NHP	No Adverse Effect
Rock Creek and Potomac Parkway	No Adverse Effect
Georgetown NHL District	No Adverse Effect
The Potomac Gorge	No Adverse Effect
Theodore Roosevelt Island	No Adverse Effect
GWMP	No Adverse Effect
Individually Listed Resources	No Adverse Effect

3. ZONE C

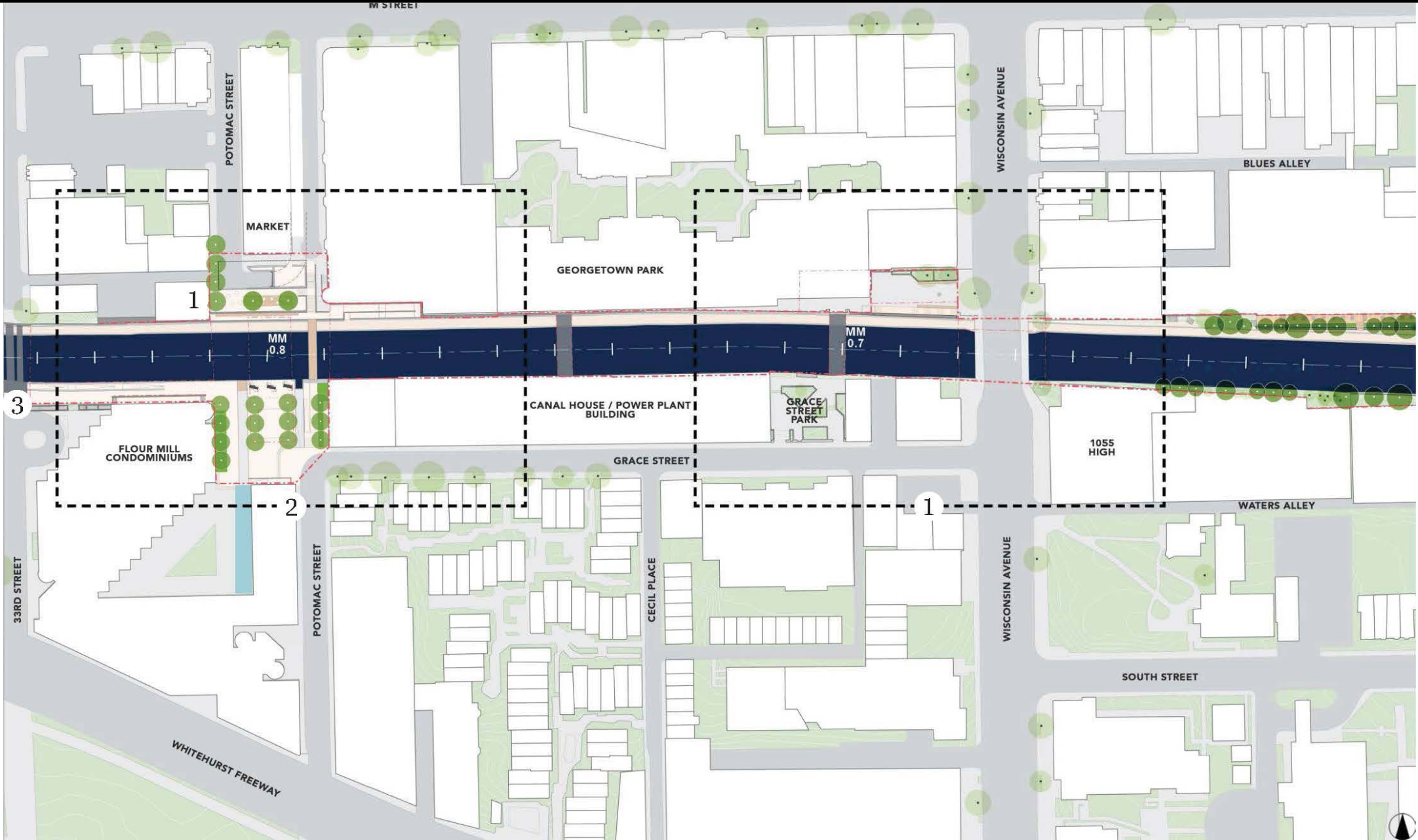

# THE OBELISK PLAZA



# EXISTING CONDITIONS



Vegetation



Looking north



Entrance to Georgetown Park



Looking east at Wisconsin Ave



Obelisk

# THE OBELISK PLAZA



# THE OBELISK PLAZA: ASSESSMENT OF EFFECTS



(HSW, 1923-1927)

Resource	Adverse Effects
C&O Canal NHP	<ul style="list-style-type: none"> <li>Moving Obelisk</li> <li>Widening Arch in Retaining Wall</li> </ul>
Rock Creek and Potomac Parkway	No Adverse Effect
Georgetown NHL District	Moving Obelisk
The Potomac Gorge	No Adverse Effect
Theodore Roosevelt Island	No Adverse Effect
GWMP	No Adverse Effect
Individually Listed Resources	Wisconsin Avenue Bridge: Moving Obelisk

# THE CANAL OVERLOOK



# EXISTING CONDITIONS



Looking east



Looking northeast



Looking northwest



Looking northeast



Non-Compliant  
Ramp

# THE CANAL OVERLOOK

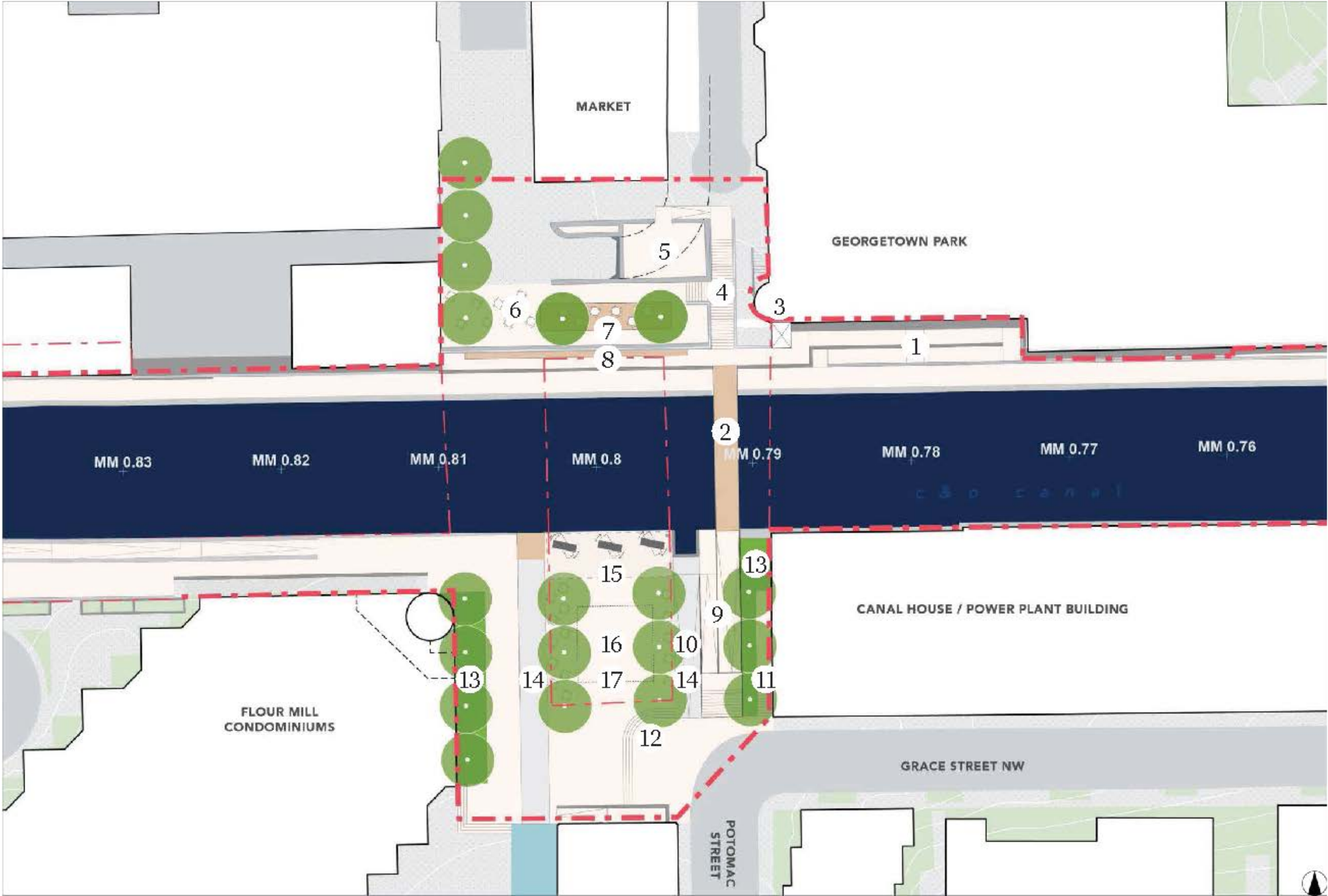

# THE CANAL OVERLOOK: ASSESSMENT OF EFFECTS



(LOC, 1925)

Resource	Direct Effects
C&O Canal NHP	Replacing Potomac Street Bridge with Lower and Wider Bridge
Rock Creek and Potomac Parkway	No Adverse Effect
Georgetown NHL District	No Adverse Effect
The Potomac Gorge	No Adverse Effect
Theodore Roosevelt Island	No Adverse Effect
GWMP	No Adverse Effect
Individually Listed Resources	No Adverse Effect

# FISH MARKET SQUARE



# EXISTING CONDITIONS

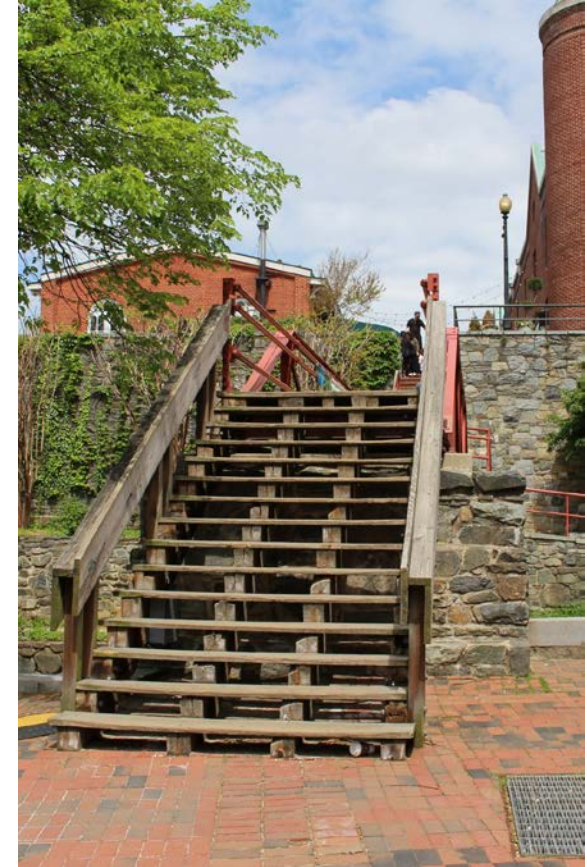

# FISH MARKET SQUARE

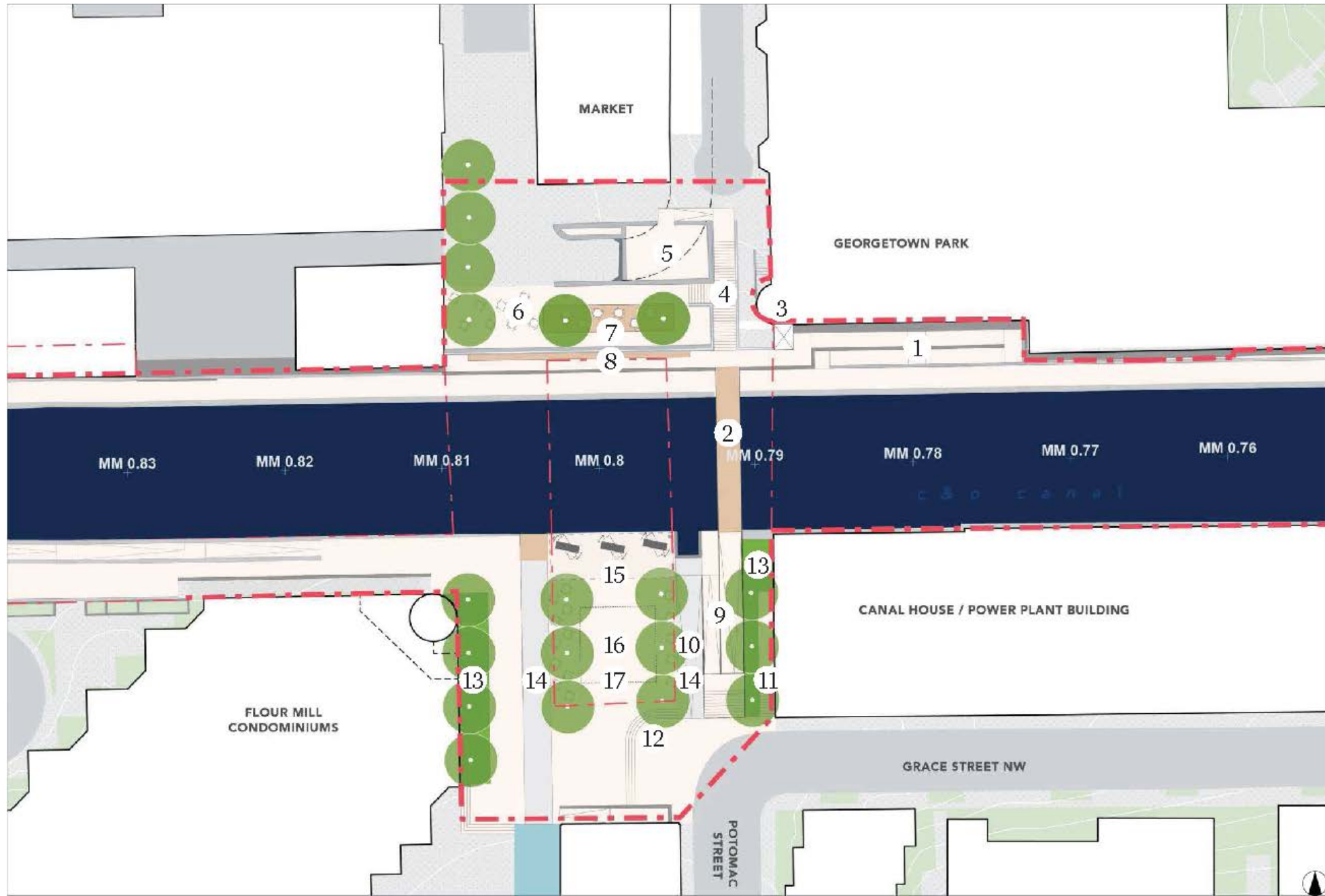

# FISH MARKET PLAZA: ASSESSMENT OF EFFECTS

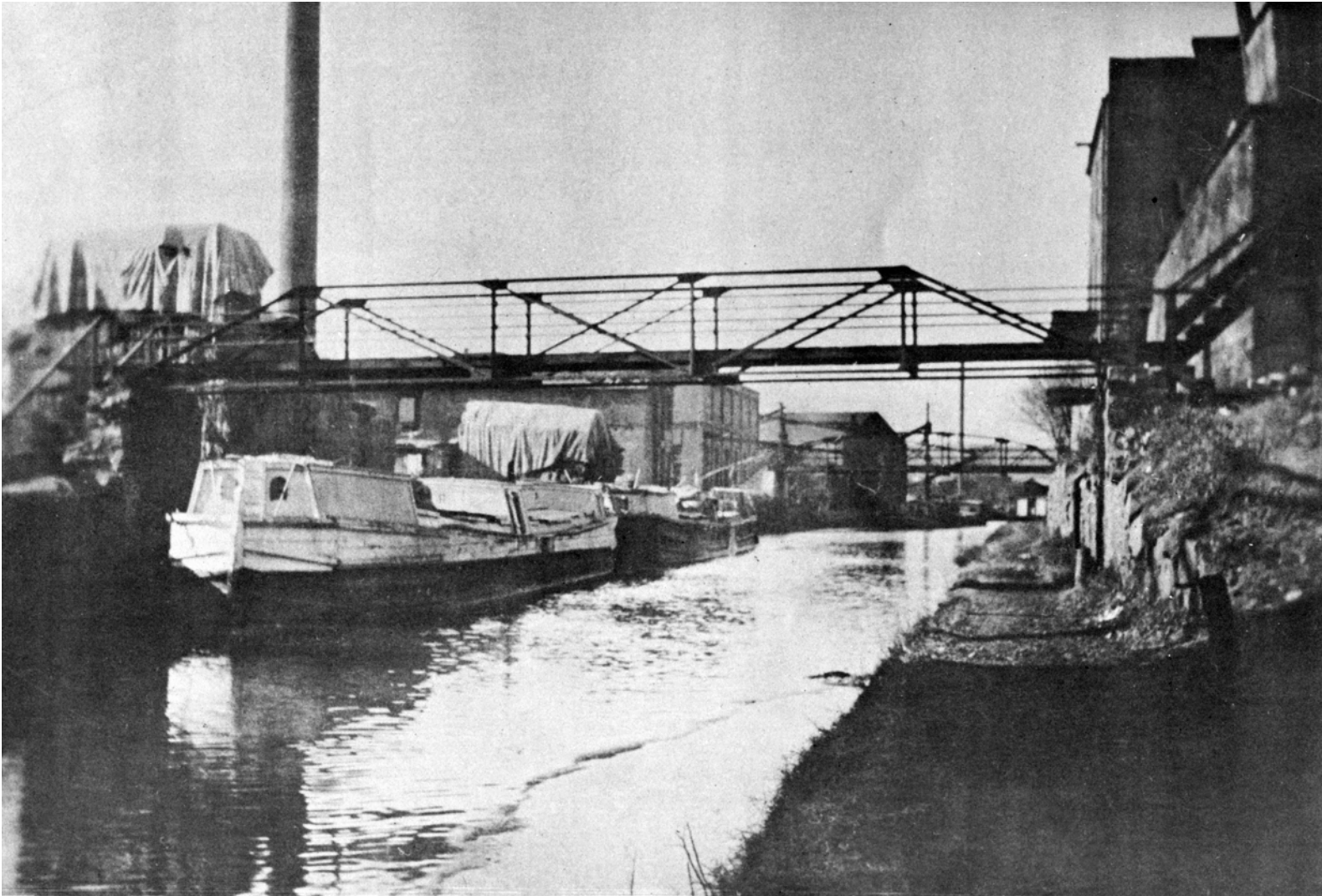

(LOC, ND)

Resource	Direct Effects
C&O Canal NHP	Adding Permanent Seating
Rock Creek and Potomac Parkway	No Adverse Effect
Georgetown NHL District	No Adverse Effect
The Potomac Gorge	No Adverse Effect
Theodore Roosevelt Island	No Adverse Effect
GWMP	No Adverse Effect
Individually Listed Resources	No Adverse Effect

# 5. ZONE D

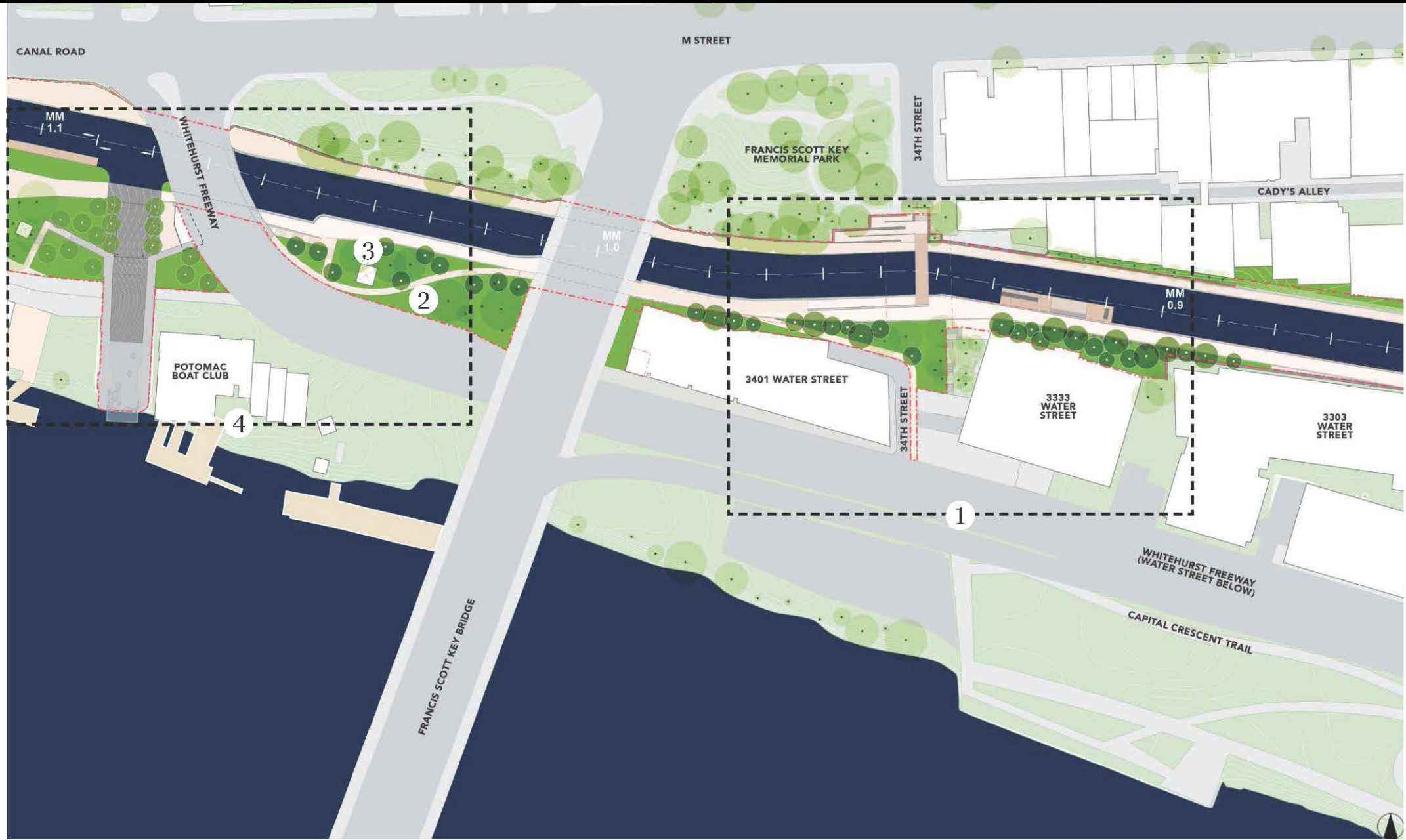

# GONGOOZLER PLATFORM

54



# EXISTING CONDITIONS



# THE GONGOOZLER PLATFORM





(HSW, 1870-1890)

Resource	Direct Effects
C&O Canal NHP	Adding Platform
Rock Creek and Potomac Parkway	No Adverse Effect
Georgetown NHL District	Adding Platform
The Potomac Gorge	No Adverse Effect
Theodore Roosevelt Island	No Adverse Effect
GWMP	No Adverse Effect
Individually Listed Resources	No Adverse Effect

# POTOMAC AQUEDUCT

58



# EXISTING CONDITIONS



*Looking southeast*



*Looking northwest*



*Looking south*

# POTOMAC AQUEDUCT

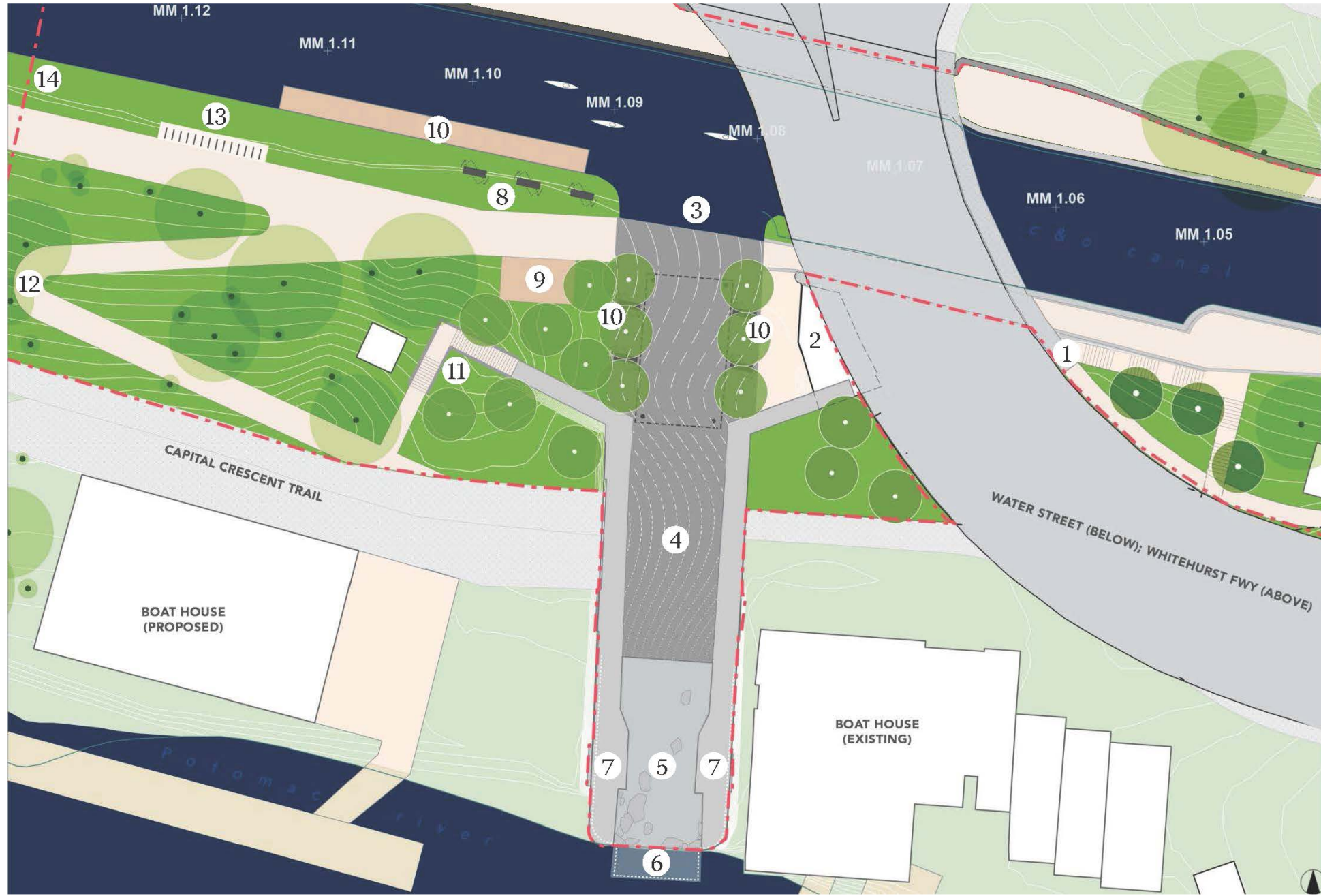

# POTOMAC AQUEDUCT: ASSESSMENT OF EFFECTS



(HSW, 1866-1870)

Resource	Adverse Effects
C&O Canal NHP	<ul style="list-style-type: none"> <li>Adding Art Platform</li> <li>Adding Aqueduct Hardscape</li> <li>Adding Bike Rack</li> <li>Adding Permanent Seating</li> <li>Adding Canoe Launch</li> </ul>
Rock Creek and Potomac Parkway	No Adverse Effect
Georgetown NHL District	Adding Canoe Launch
The Potomac Gorge	No Adverse Effect
Theodore Roosevelt Island	No Adverse Effect
GWMP	No Adverse Effect
Individually Listed Resources	Potomac Aqueduct: <ul style="list-style-type: none"> <li>Adding Art Platform</li> <li>Adding Aqueduct Hardscape</li> <li>Adding Permanent Seating</li> </ul>

# TEMPORARY AND CUMULATIVE EFFECTS

Temporary Effects	Construction Effects	C&O Canal NHP, Rock Creek and Potomac Parkway, Georgetown NHL District, The Potomac Gorge, Washington Canoe Club, Potomac Aqueduct, Potomac Boat Club, Joseph Carlton House, Georgetown Market, Bomford Mills, DC Paper Mill, Vigilant Firehouse, Wisconsin Avenue Bridge, Potomac Masonic Lodge No. 5, Adams-Mason House, Nicholas Hedges & Federal Houses, Henry McCleery House, West Heating Plant, Francis Scott Key Bridge
Cumulative Effects	Potomac River Tunnel	C&O Canal NHP, Georgetown NHL District, The Potomac Gorge



# DETERMINATION OF EFFECT

Number	Historic Resource	Adverse Effect	Temporary Adverse Effects	Cumulative Adverse Effects
1	Washington Canoe Club	No Adverse Effect	Adverse Effect: Construction	No Adverse Effect
2	Potomac Aqueduct	Adverse Effect: Adding Art Platform, Aqueduct Hardscape, Overlook, Bike Rack, Permanent Seating, Canoe Launch, and Reconfiguring Stair	Adverse Effect: Construction	No Adverse Effect
3	Potomac Boat Club	No Adverse Effect	Adverse Effect: Construction	No Adverse Effect
4	Forrest-Marbury House	No Adverse Effect	No Adverse Effect	No Adverse Effect
5	Joseph Carleton House	No Adverse Effect	Adverse Effect: Construction	No Adverse Effect
6	Georgetown Market	No Adverse Effect	Adverse Effect: Construction	No Adverse Effect
7	Bomford Mill (Pioneer Flour Mills; Flour Mill)	No Adverse Effect	Adverse Effect: Construction	No Adverse Effect
8	District of Columbia Paper Manufacturing Company (Paper Mill)	No Adverse Effect	Adverse Effect: Construction	No Adverse Effect
9	Old Engine Company No. 5 (Bank of Columbia, Georgetown Town Hall & Mayor's Office)	No Adverse Effect	No Adverse Effect	No Adverse Effect
10	City Tavern	No Adverse Effect	No Adverse Effect	No Adverse Effect
11	Georgetown Commercial Buildings, M Street and Wisconsin Avenue	No Adverse Effect	No Adverse Effect	No Adverse Effect
12	Vigilant Firehouse	No Adverse Effect	Adverse Effect: Construction	No Adverse Effect
13	Wisconsin Avenue Bridge (High Street Bridge)	Adverse Effect: Moving Obelisk	Adverse Effect: Construction	No Adverse Effect
14	Grace Church (Grace Protestant Episcopal Church)	No Adverse Effect	No Adverse Effect	No Adverse Effect
15	Potomac Masonic Lodge No. 5	No Adverse Effect	Adverse Effect: Construction	No Adverse Effect

16	Adams-Mason Houses	No Adverse Effect	Adverse Effect: Construction	No Adverse Effect
17	Nicholas Hedges & Federal Houses	No Adverse Effect	Adverse Effect: Construction	No Adverse Effect
18	Duvall Foundry	No Adverse Effect	No Adverse Effect	No Adverse Effect
19	Loughborough-Patterson House	No Adverse Effect	No Adverse Effect	No Adverse Effect
20	Thomas Sim Lee Corner	No Adverse Effect	No Adverse Effect	No Adverse Effect
21	Henry McCleery House	No Adverse Effect	Adverse Effect: Construction	No Adverse Effect
22	West Heating Plant	No Adverse Effect	Adverse Effect: Construction	No Adverse Effect
23	Godey Lime Kilns	No Adverse Effect	No Adverse Effect	No Adverse Effect
24	Watergate Complex	No Adverse Effect	No Adverse Effect	No Adverse Effect
25	Higgins Service Station (Watergate Exxon, Rock Creek Valero)	No Adverse Effect	No Adverse Effect	No Adverse Effect
26	Brickyard Hill House	No Adverse Effect	No Adverse Effect	No Adverse Effect
27	Dodge Warehouses (and Adjacent Structures)	No Adverse Effect	No Adverse Effect	No Adverse Effect
28	Francis Scott Key Bridge	No Adverse Effect	Adverse Effect: Construction	No Adverse Effect
29	Capital Traction Company Union Station (Georgetown Car Barn; Exorcist Stairs)	No Adverse Effect	No Adverse Effect	No Adverse Effect

Milestone	Date
Assessment of Effects	October 16, 2019
EA Released to Public	October 16, 2019
Consulting Parties Meeting	November 2019
MOA/PA	November 2019
Preparation of Decision Document	December 2019

## **Submit comments electronically:**

Comments can be submitted electronically on or before November at the National Park Service's Planning, Environmental and Public Comments (PEPC) website at: [parkplanning.nps.gov/Georgetowncanalplan](https://parkplanning.nps.gov/Georgetowncanalplan)

## **Submit written comments to:**

C&O Canal National Historical Park Headquarters  
1850 Dual Highway | Suite 100  
Hagerstown, MD 21740

A scenic view of a canal in an industrial district. The canal is flanked by brick buildings and a stone wall. A bridge crosses the water, and the scene is reflected in the calm water. The text "THANK YOU" is overlaid in the center.

THANK  
YOU