

## Commonalities: Action Alternatives 1 and 2

- Restore the fenced area around the house to 1922 historic character for full interpretation and compatibility with the Historic Structure Report
- Improve access, wayfinding, and parking for visitors and staff
- Relocate parking including buses, large vehicles, and overflow
- Provide bicycle access from neighborhood
- Manage fields with local farmers as hay and crops
- Provide interpretive trails around fields and to the the farm pond
- Consider management of rural character of setting (potential visual buffer, etc.)

## Differences: parking, visitor orientation and contact, farm, accessible trails, etc.

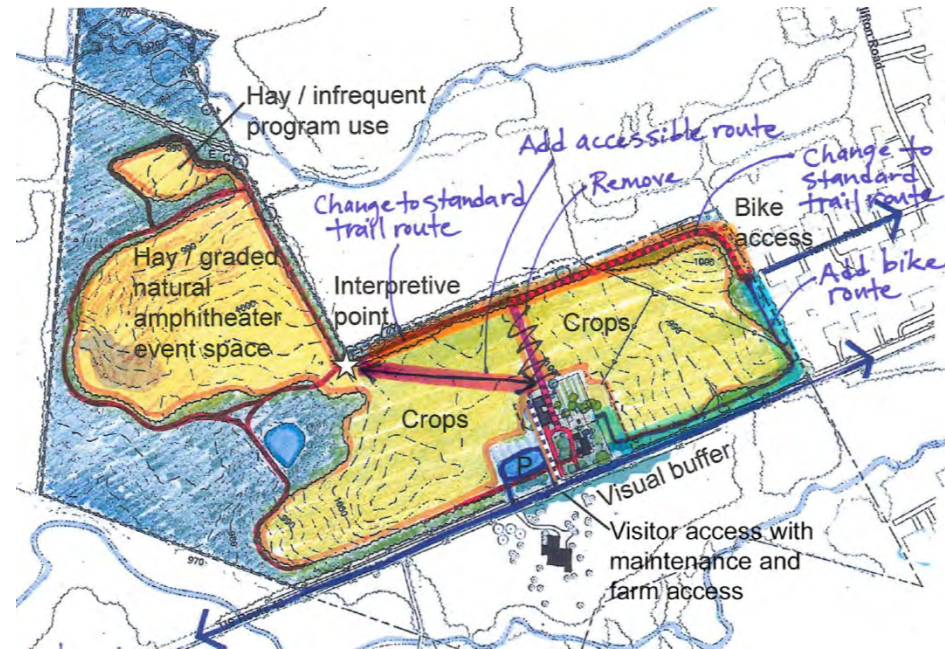

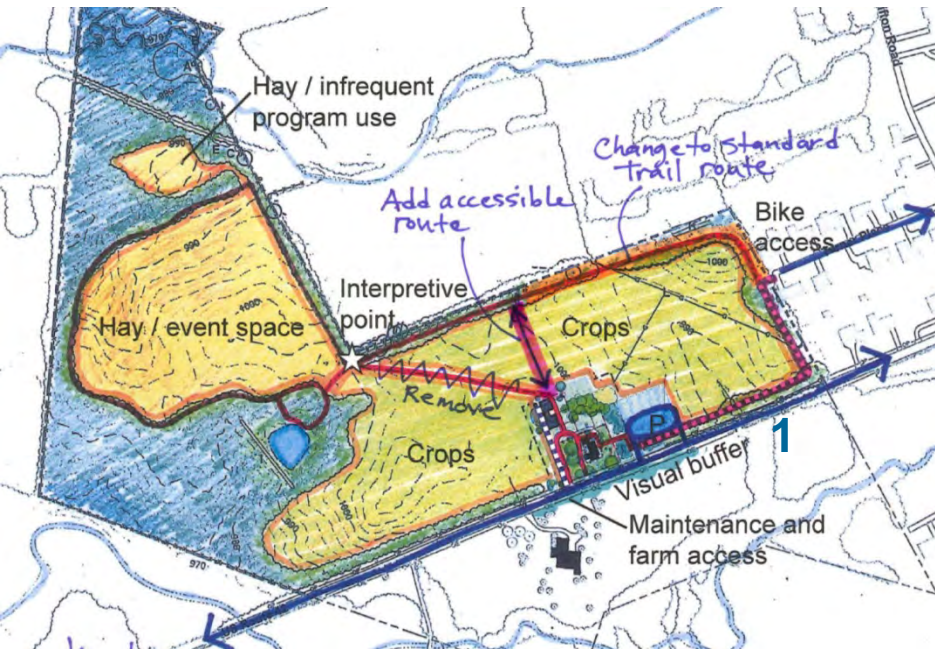

# Alternative 1: Recapture Historic Character of Core, Expand Site Access

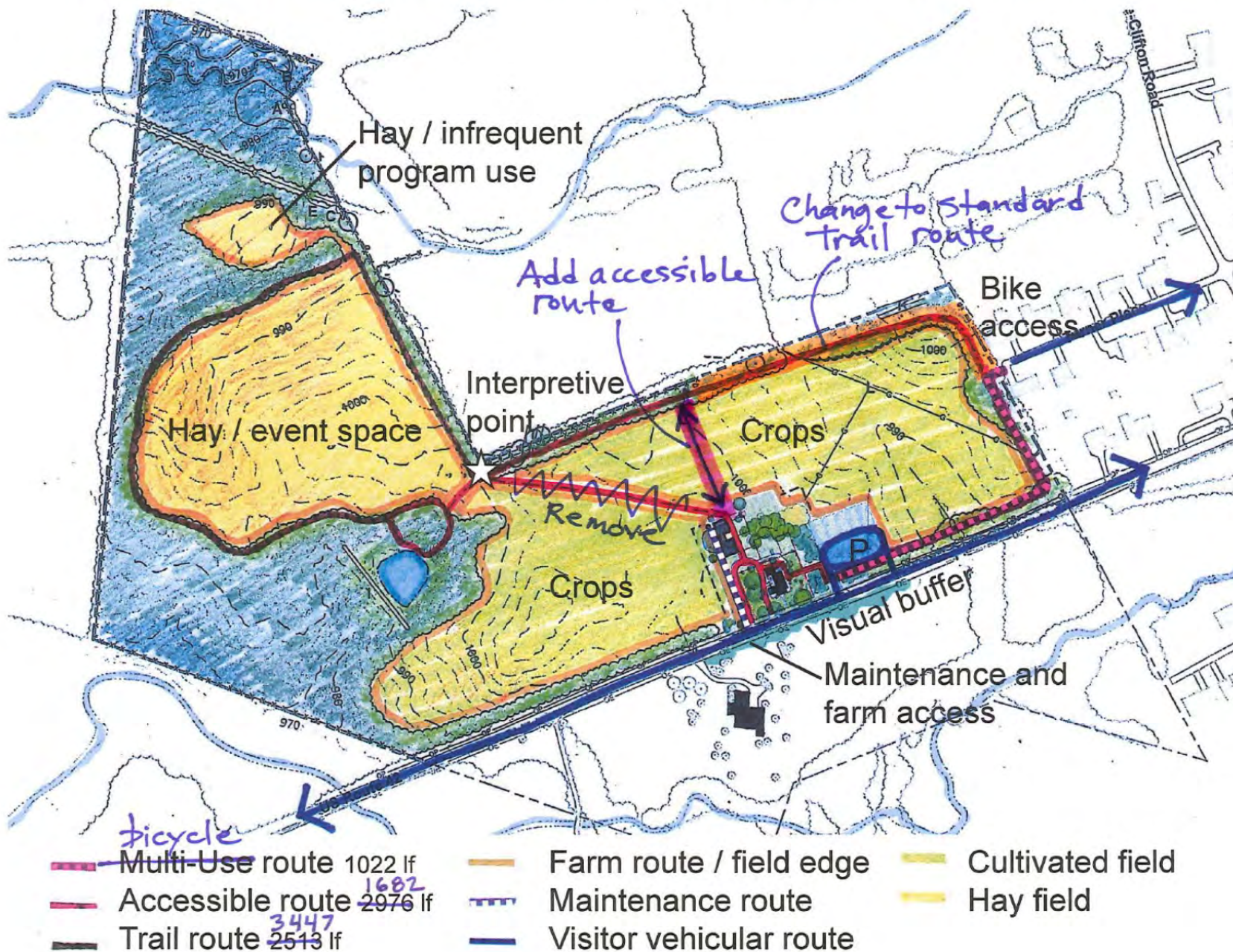



# Alternative 1: Recapture Historic Character of Core, Expand Site Access



1. Parking, overflow, bike racks, visitor orientation, and main access relocated to east
2. Vegetation management for selective views
3. Restored ornamental and domestic features
4. Interpretive feature (former outbuildings), possible alternative visitor orientation
5. Barnyard interpreted with fences for programmatic space
6. Picnic grove with trees/turf in former garden/existing woods
7. Comfort station, shelter, and maintenance
8. Maintenance access
9. Farm access
10. Screen plantings/visual buffer

	Overflow parking		Lawn		Orn. Metal fence		Arrival route
	Parking		Rough turf		Picket fence		Visitor orient.
	Visitor route		Field edge buffer		Post and wire/rail fence		New dec. tree
							New fruit tree
							Existing tree
							Shrub or bed



## Alternative 2: Recapture Historic Character and Features of Core, Expand Site Access and Programs

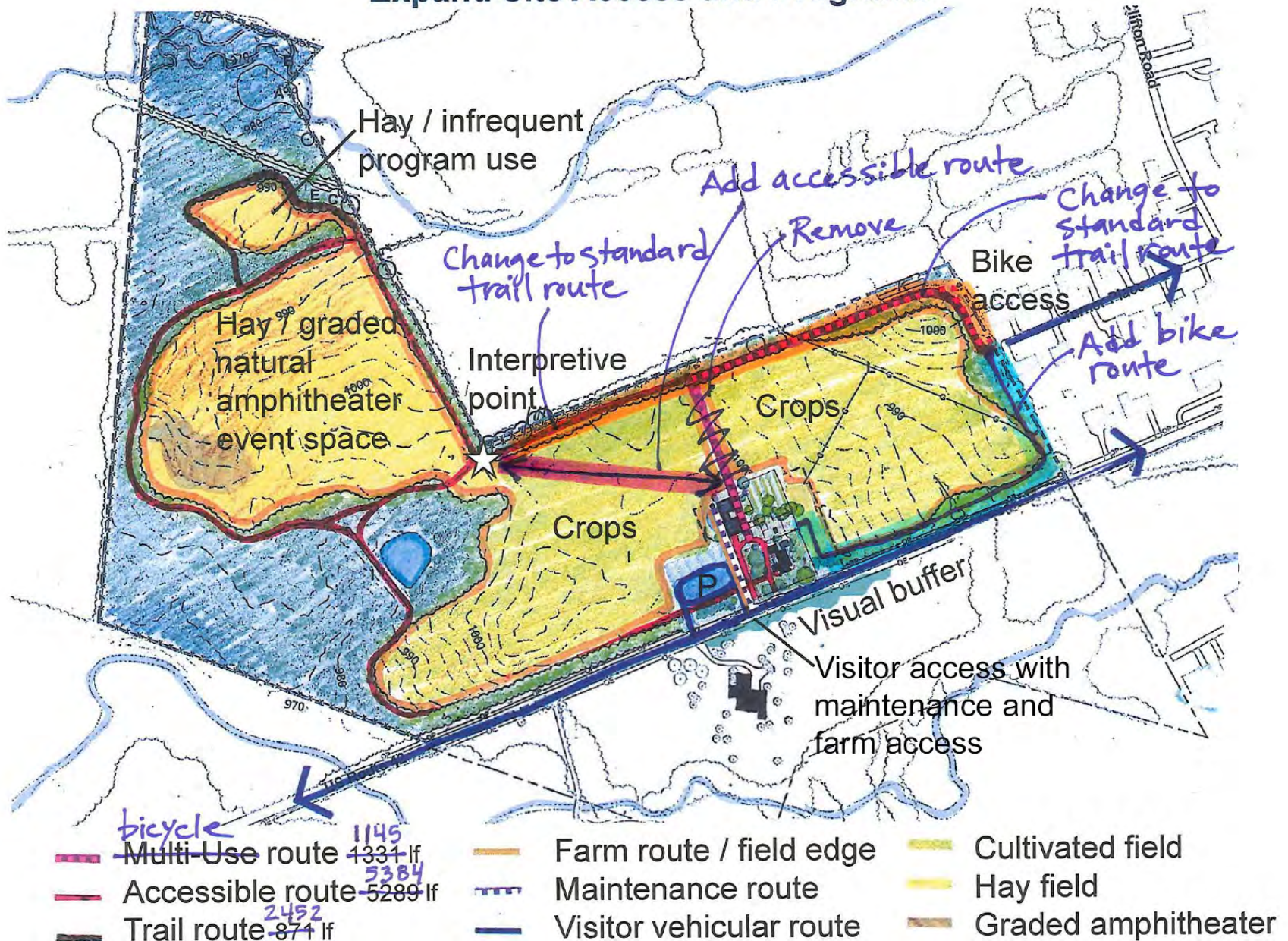



## Alternative 2: Recapture Historic Character and Features of Core,

### Expand Site Access and Programs

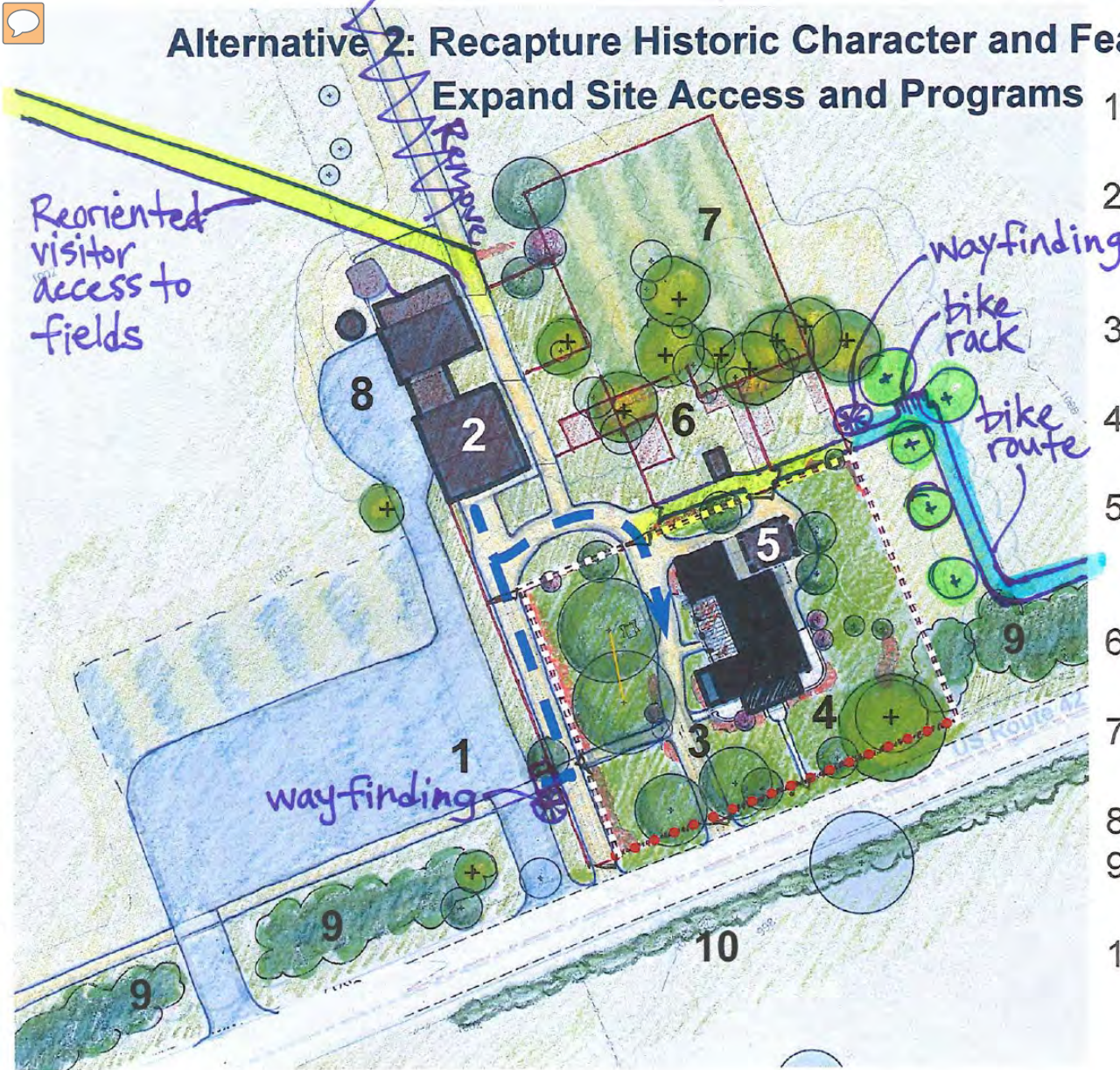

1. Parking, overflow, and main visitor access relocated to west
2. Visitor orientation, bathrooms, shelter, offices, and maintenance at former barns
3. Access to front of house with sloped walk from drive
4. Restored ornamental and domestic features
5. Summer kitchen shell with compatible rustic tables for program/picnic support
6. Rehabilitated barnyard with multi-use benches/tables
7. Interpretive garden with selective clearing of trees
8. Maintenance and farm access
9. Vegetation management for selective views
10. Screen plantings/visual buffer

- Arrival Route
- New dec. tree
- New fruit tree
- Existing tree
- Shrub or bed

- Overflow parking
- Parking
- Visitor route
- Lawn
- Rough turf
- Field edge buffer
- Orn. Metal fence
- Picket fence
- Post and wire/rail fence



## Preferred Alternative 2

### NPS Preferred Alternative (CLR)

- for development of proposed landscape treatment

### Environmentally Preferable Alternative (EA)

- in consideration of greater impacts and benefits

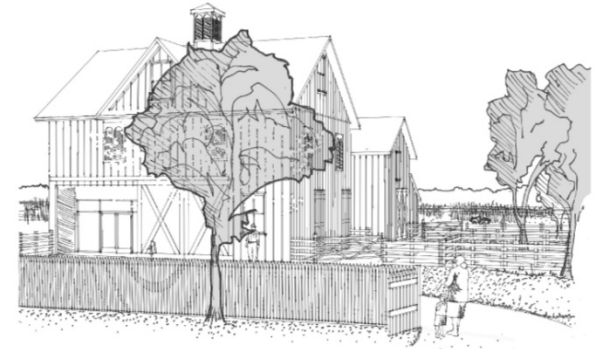

D. The visitor contact station is in the location of the historic barn complex. Visitors can walk into the fields or return to the house from this area. (source: QEA, 2017)



F. Addition of the visitor contact station, canopy trees, and fencing helps to redefine the spatial definition of the Homestead when viewed from the fields. (source: QEA, 2017)

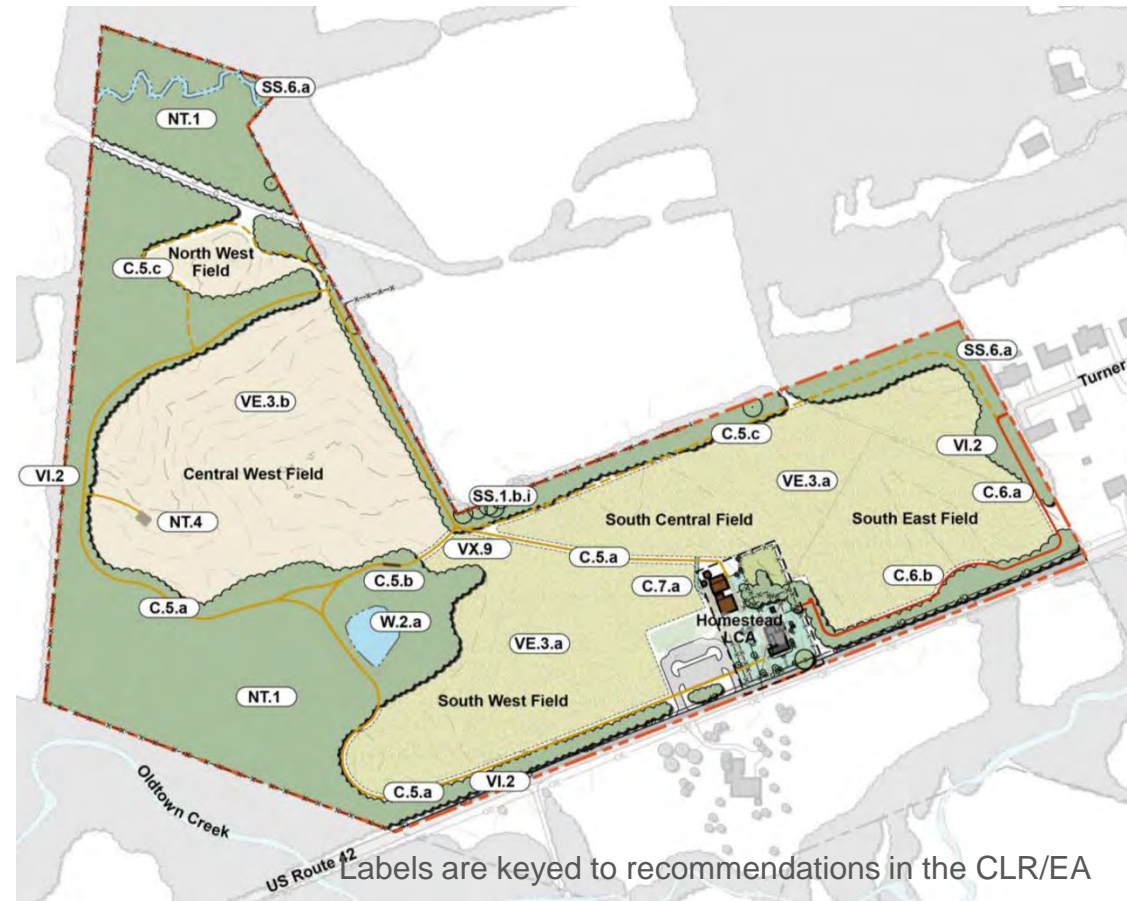





# Preferred Alternative Homestead Landscape Plan

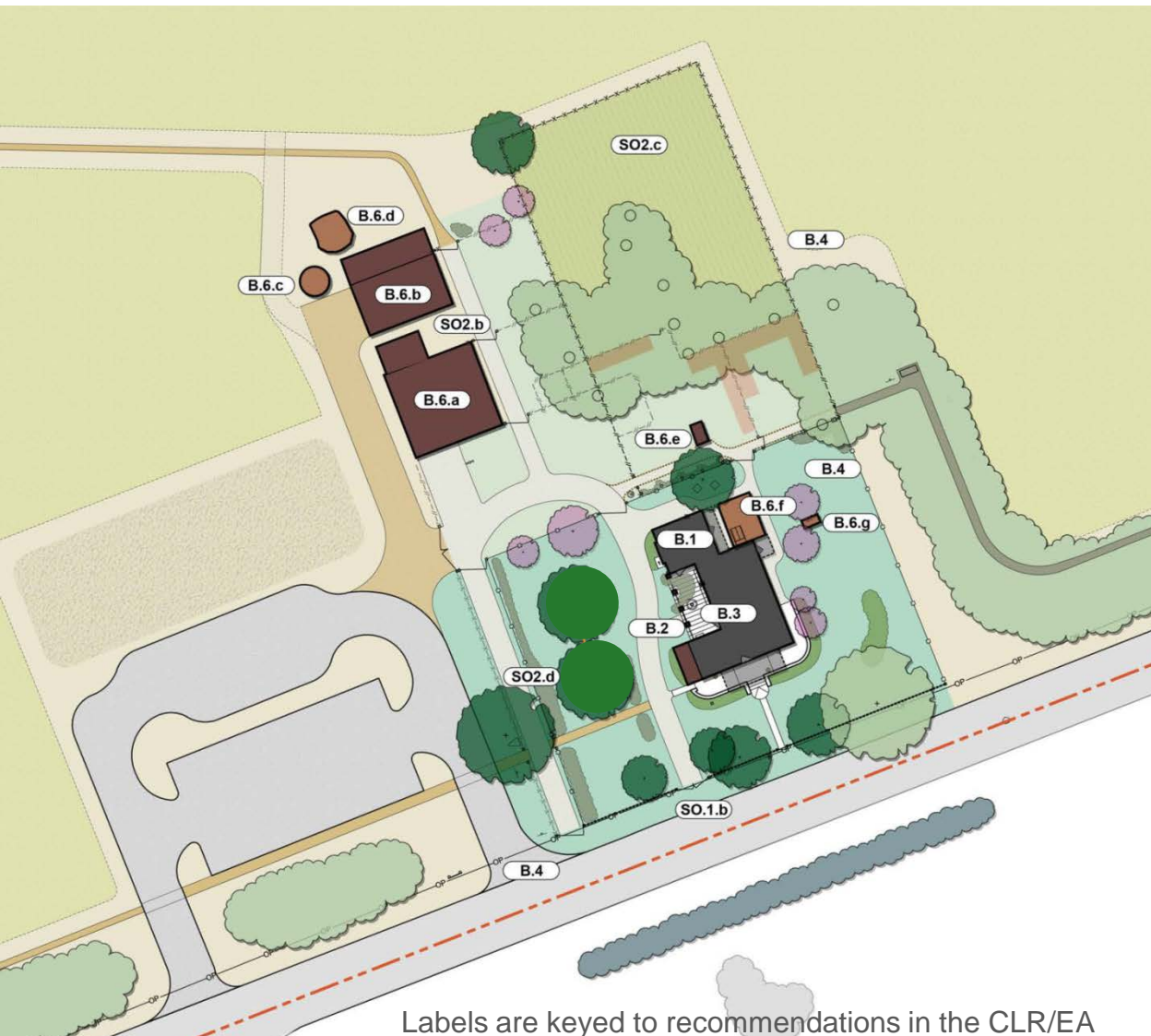

Labels are keyed to recommendations in the CLR/EA

## Key

- National Monument boundary
- Preserve existing building
- Preserve existing roofline
- Add compatible building
- Add interpretive landscape feature
- Install concrete paving
- Add maintenance route (dark crushed stone) (C.7.b)
- Maintain mown field edges
- Construct compacted earth path (C.2.d)
- Reconstruct historic route (crushed fines of limestone)
- Construct new path (dark crushed stone)
- Construct bicycle route (C.6.a)
- Establish overflow parking (fallow field/meadow)
- Retain woodland
- Retain fallow agricultural field/meadow
- Establish active agricultural field
- Maintain rough turf (VE.4.a)
- Maintain mown turf around the house (VE.1.c)
- Add deciduous tree
- Add fruit or flowering tree
- Retain deciduous tree
- Retain tree in woodland (VE.4.c)
- Install shrub bed or vines
- Install vegetable garden
- Install planting bed
- Consider planting trees to protect viewshed
- Construct stationary wooden benches and tables
- Install split rail and wire fence (SS.5.a)
- Install post and wire fence (SS.5.b)
- Install wood picket fence (SS.5.c)
- Install custom steel and wood fence (SS.5.i)
- Install fence gate





## Preferred Alternative Landscape Concept Sketches



C. Upon arrival, visitors can glimpse the rehabilitated vegetation and conservatory across the Youngsholm side yard. (source: QEA, 2017)



B. Restoration of small-scale elements such as fences, gates, and hitching post will enhance the historic character of the landscape. (source: QEA, 2017)

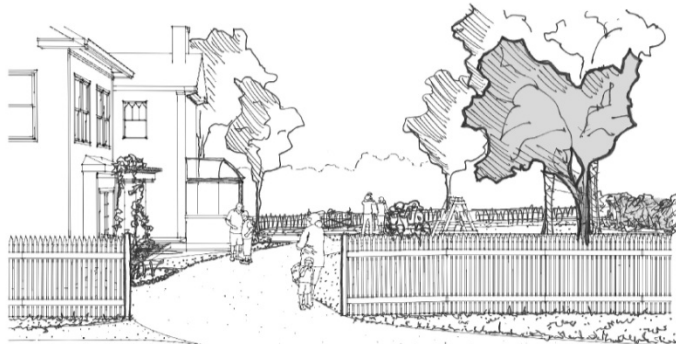

E. Picket fencing defines the boundary between the home grounds and the barnyard and pens. Lawn with trees, shrubs, rustic outdoor furniture, and a clothesline indicate the domestic character of the landscape. (source: QEA, 2017)





*Youngsholm  
Cultural Landscape Report,  
Environmental Assessment,  
and Schematic Design*

*Thank you!  
We welcome your thoughts*



QUINN EVANS  
ARCHITECTS



**Public Open House**

**Charles Young Buffalo Soldiers National Monument**

Wilberforce, Ohio - Wednesday, June 21, 2017