

Modification to the Second Division Memorial



CONTENTS

Introduction	3
Project Report	4
Selected Scheme	10

Introduction and Description

Located within the open lawn at the southwest corner of the Ellipse facing Constitution Ave NW, the Second Division Memorial was originally constructed in 1936 to honor those of the Second Army Division who gave their lives in World War I. The memorial was designed by renowned sculptor James Earle Fraser and architect John Russell Pope and consists of a monumental tripartite granite wall with a rectangular opening that frames the central focal element: the flaming sword, an eighteen-foot-high gilded bronze sculpture of a hand grasping a flaming sword designed by Fraser. The hilt of the sword is decorated with the insignia of the Second Division, which features a head of a Native American chief on a star. The memorial is most directly accessed from the path at the corner of 17th Street NW and Constitution Ave NW.

The architectural granite panels feature wreaths carved in relief and engraved V-cut recessed inscriptions filled with gold leaf listing the battles fought by the Second Division. The memorial is elevated on a granite platform three steps above grade. The tripartite wall is further distinguished by a stepped base and molded cornice above.

An addition to the memorial by architects Otto Eggers and Daniel Higgins was completed in 1962. Eggers and Higgins designed two similarly inscribed granite wing walls on either side of the central panel to honor the men of the Second Division who died in World War II and the Korean War.

The memorial is architecturally and historically significant as a commemorative memorial designed by sculptor James Earle Fraser and architect John Russell Pope and is a contributing

structure to the National Mall Historic District, listed in the National Register of Historic Places.

The pink granite walls and platform of the memorial create three distinct zones. The central zone is defined by the monumental tripartite granite panels that frame the sword and commemorate lives lost in World War I. The east and west zones are defined by the granite wing walls that commemorate lives lost in World War II (on the west wall) and the Korean War (on the east wall). The wing walls express a welcoming gesture and are punctuated by end granite pedestals with flagpoles.

In summary, the carefully designed memorial establishes a hierarchy between the central panel framing the sword and the complementary wing walls and flag poles that define the east and west spaces.

Purpose and Need

The Memorial Modification Project seeks to modify the existing memorial design to allow for future inscriptions that honor the courage and sacrifice of the Second Division in military campaigns since the Korean War. Currently, no panels are available for such inscriptions. The intention is to provide panels for the recognition of three known military campaigns with the opportunity to accommodate inscriptions for future campaigns. There is also a need for an expanded platform that can accommodate public ceremonies and encourage visitors to walk up onto the memorial to view the inscriptions. Four design options are proposed that allow for additional inscriptions to be carved at two new plinth stones standing on the platform of the memorial.

Design Options

Option A

This option maintains the design integrity of the existing memorial while providing two granite plinths strategically placed in line with the central panel. The placement of these granite blocks emphasizes the three zones articulated in the original design of the memorial. Their size matches the stone platform panel on which they sit, and their height is limited to the height of the wing walls without the coping stone. This option is a minimalist design approach with limited intervention, however, the free-standing stone plinths provide multiple surfaces for inscription. The landscape surrounding the memorial would not be affected.

Option B:

Like Option A, this design concept emphasizes the three zones of the existing memorial while increasing the height of the plinth stones to match the height of the wing walls including the coping stone. This option maintains the hierarchy established in Option A but provides more surface area for inscriptions. The landscape surrounding the memorial would not be affected.

Option C:

This option maintains the design integrity of the memorial by continuing to emphasize the three zones. However, the plinth stones are aligned with the point where the wing walls meet the central tripartite panel, creating a narrower space between the plinths and the wing walls, especially at the flagpole pedestals. The size of the plinth stones matches the larger stone platform panel on which they sit, and, like Option B, their height is the same level as the wing walls including the

coping stone. This option provides more surface area for inscriptions but lacks the sense of proportion and hierarchy between the wing walls and the plinths. The landscape surrounding the memorial would not be affected.

Option D - Selected Scheme

This option maintains the design integrity of the memorial by emphasizing the three zones. However, the central part of the platform is extended and distinguished by two stone plinths aligned with the point where the wing walls meet the central tripartite panel. The height of the plinth matches the wing walls without the coping stone. This option maintains the hierarchy as established in Options A and B, provides more surface area for inscriptions, and meets the full purpose and need of the project by extending the platform of the memorial, creating a welcoming space for visitors and an enlarged space to accommodate public ceremonies. In addition, this option would provide an opportunity to make the memorial accessible for all visitors. Accessibility concepts and accessible paths are also proposed for this option. Option D would affect the existing landscape and planting beds in front of the memorial. The 1975 NPS Landscape Development Plan for the memorial calls for floral displays to be placed around the base of the monument, which may be recreated following the memorial modification.

Project Report

Description of Agency/Mission: The NPS is the applicant submitting the proposed project on behalf of the Second Indianhead Division Association Memorial Foundation. The Association is a non-profit 501 (c)(3) organization.

Description of Project Area: The Project Area surrounds the Second Indianhead Division Memorial, located within the open lawn at the southwest corner of the Ellipse facing Constitution Ave NW. The area extends from the landscaping behind the memorial to the sidewalk along Constitution Ave NW, representing the maximum extent of area potentially effected by the modification project and accessible path options.

Schedule: Completion Fall 2021

Project Cost Estimate: \$900,000

Public Engagement: Public outreach will occur through the NEPA and Section 106 processes, as well as opportunities to raise issues or concerns at NCPC or the U.S. Commission of Fine Arts. Coordination with the local community, including the relevant ANC and District agencies, will occur through the Section 106 consultation process.

Coordination with Federal, State, and Local Jurisdictions: The NPS is submitting the project for concept review at CFA and NCPC. Additionally, the NPS has initiated Section 106 consultation with the DC SHPO and is hosting a Section 106 consulting parties meeting on October 15, 2019 that is open to relevant stakeholders and the public.

Historic Preservation and Natural Resources: The NPS will adhere to the National Environmental Policy Act (NEPA) and Section 106 of the National Historic Preservation Act (Section 106). The NPS is currently developing design concepts and is determining the appropriate level of NEPA compliance. The project will likely fall under a categorical exclusion for NEPA. Both the NEPA and Section 106 planning processes are anticipated to be completed by spring 2020. The NPS initiated consultation with the DC SHPO on August 28, 2019. The NPS will hold a Section 106 consulting parties meeting on October 15, 2019. The Second Division Memorial is listed as a contributing object in the National Mall Historic District nomination.

Flooding: The proposed project will not address the Second Division Memorial’s resiliency to flood impacts. The modification is to the existing memorial.

Stormwater Management: Based on Federal requirements, stormwater review is triggered if there is land disturbance equal to or more than 5,000 square feet. All options proposed for the modification of the memorial will disturb less than 5,000 square feet and will not increase the stormwater runoff or impact the floodplain. The proposed extension of the memorial, as shown in Option D, would contribute an additional 291 square feet of paved surface area. The curvilinear accessible pathway option would measure 3,716 square feet and the rectilinear pathway option would measure 1,521 square feet.

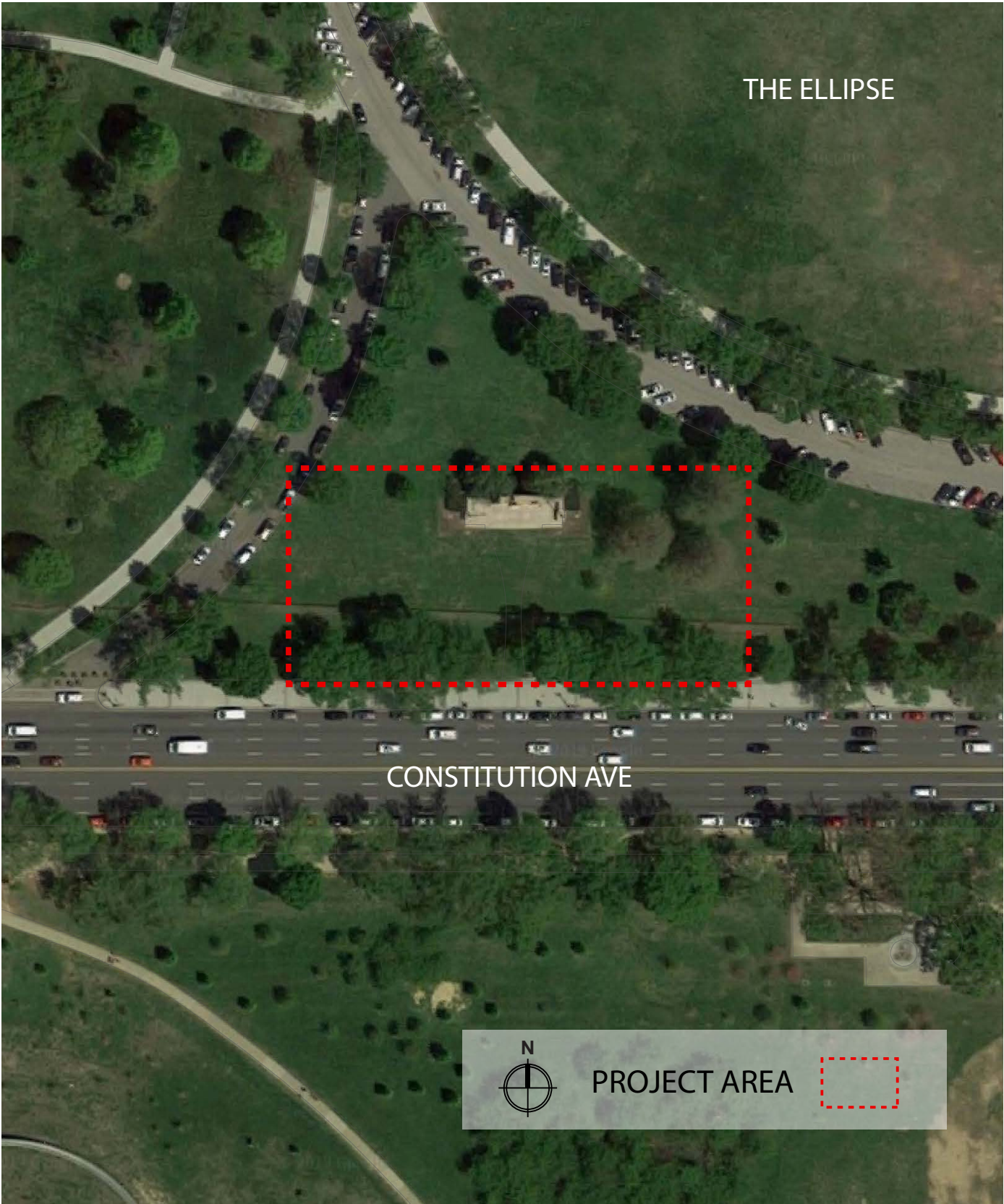



MEMORIAL CHRONOLOGY - ORIGINAL ELEVATION AND PLAN

ORIGINAL MEMORIAL, 1936



SOUTH ELEVATION - NTS

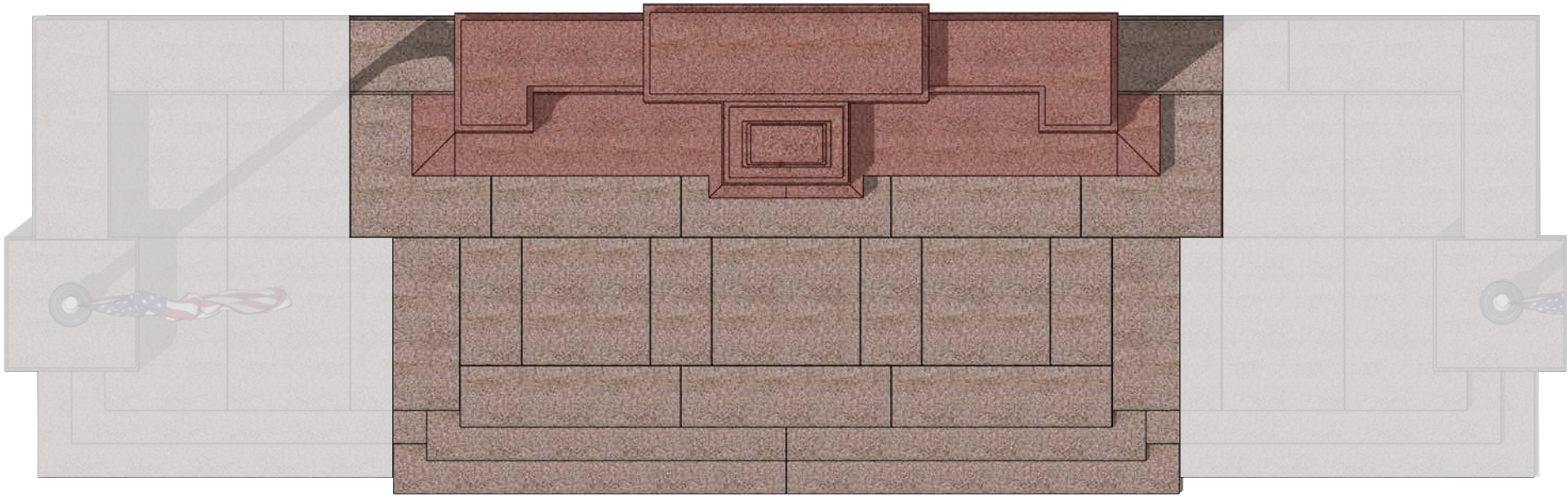

PLAN VIEW - NTS

MEMORIAL CHRONOLOGY - ADDITION TO ELEVATION AND PLAN

MEMORIAL ADDITION, 1962

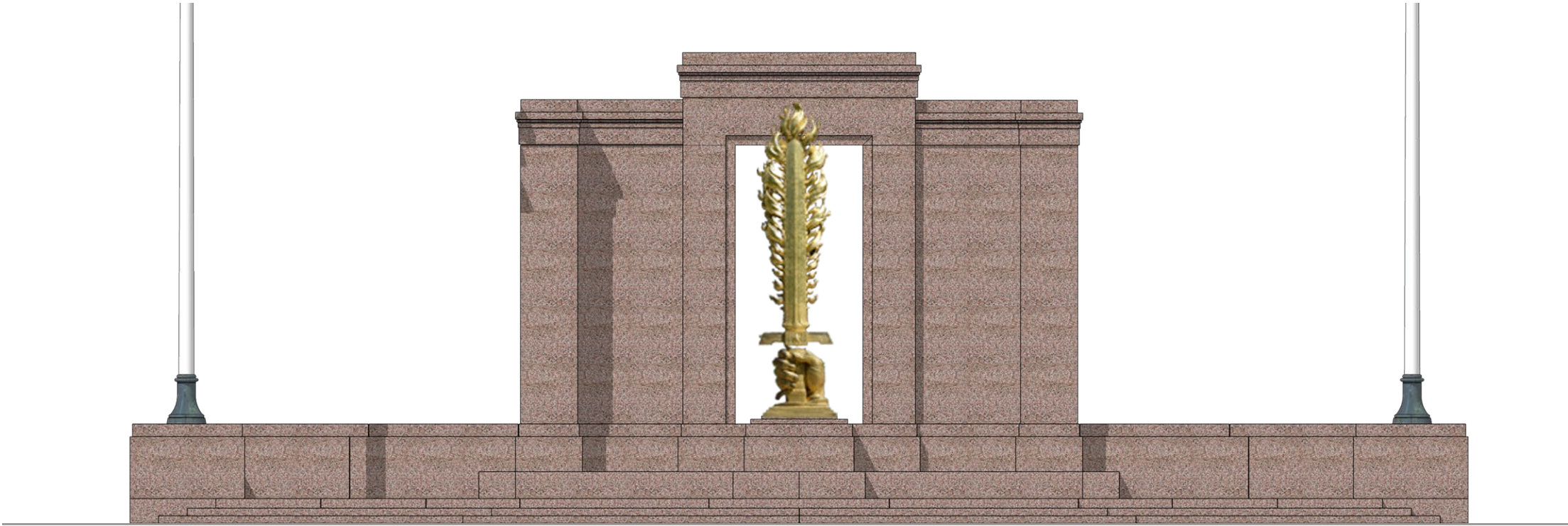

SOUTH ELEVATION - NTS

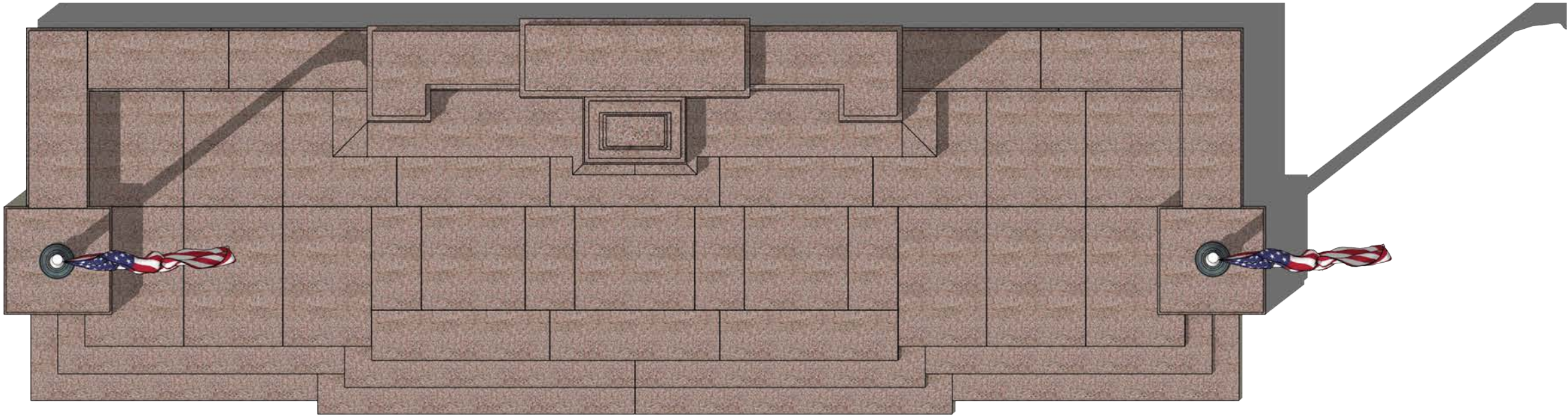

PLAN VIEW - NTS

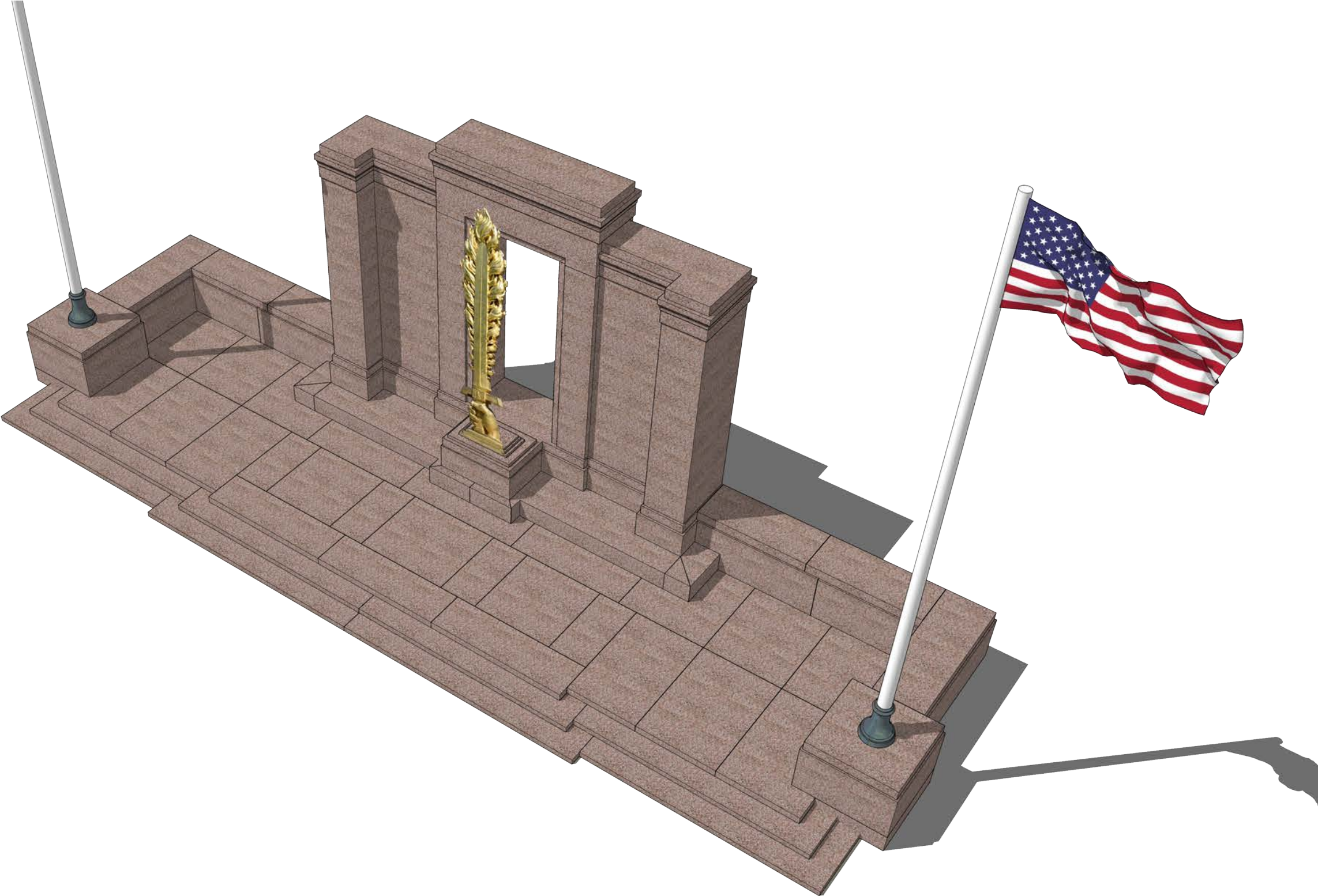

EXISTING MEMORIAL - ELEVATION AND PLAN

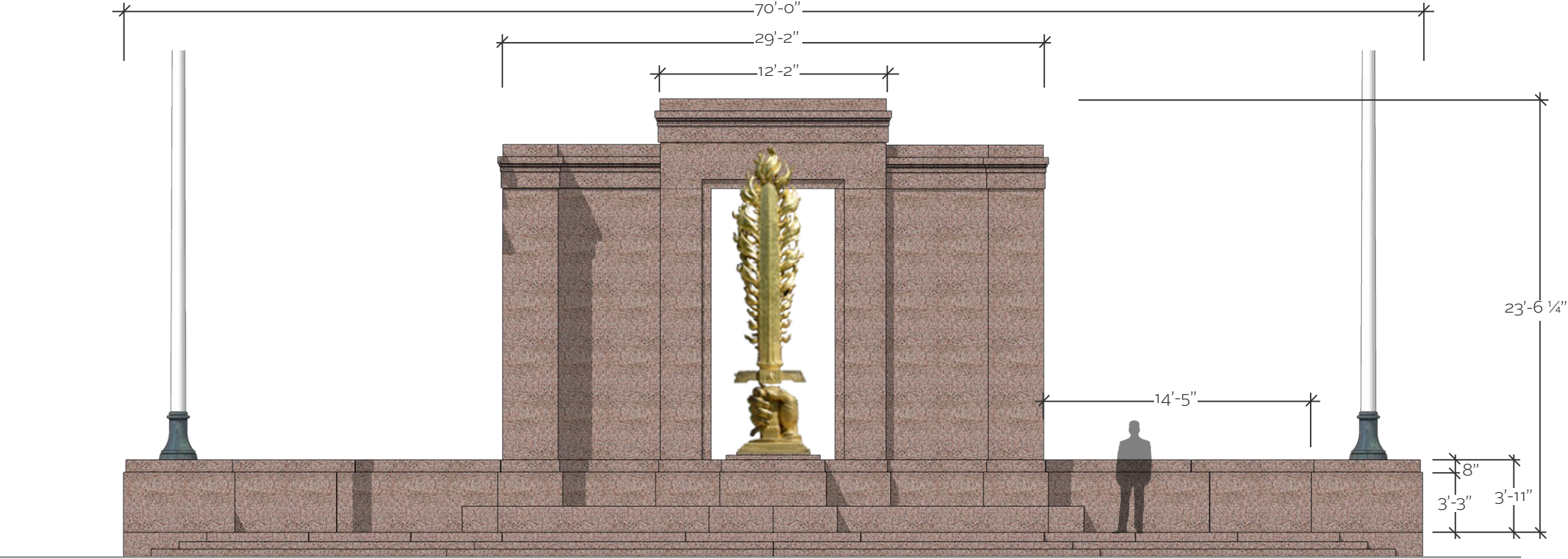

SOUTH ELEVATION - NTS

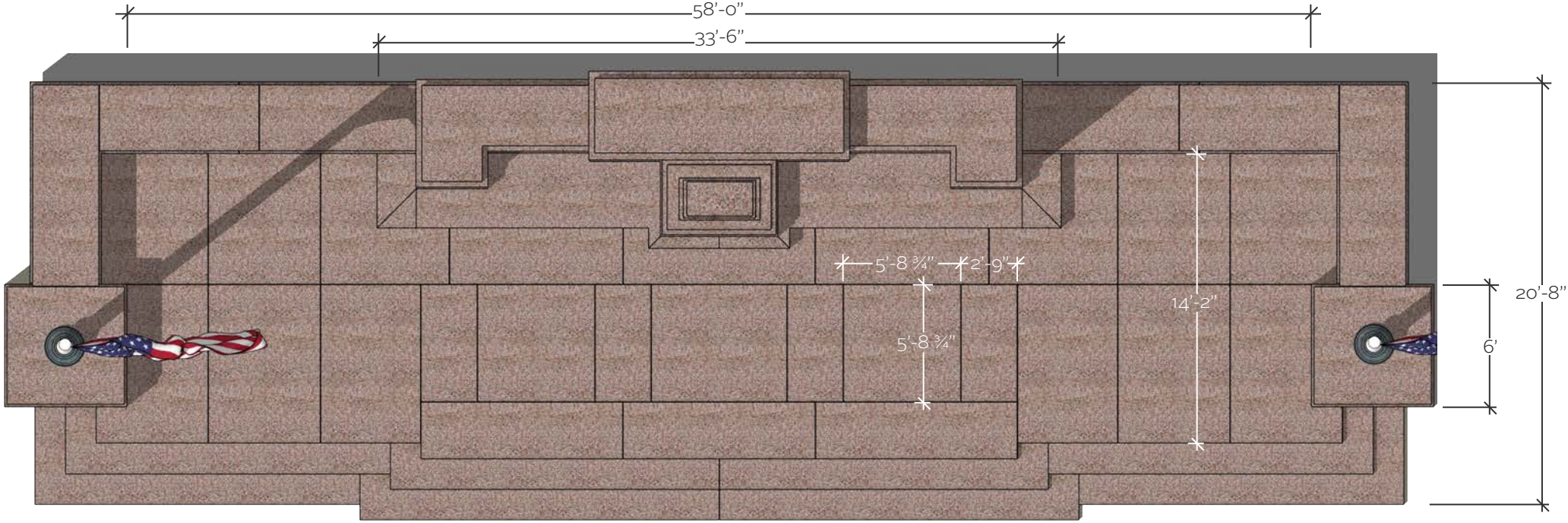

PLAN VIEW - NTS

SELECTED SCHEME

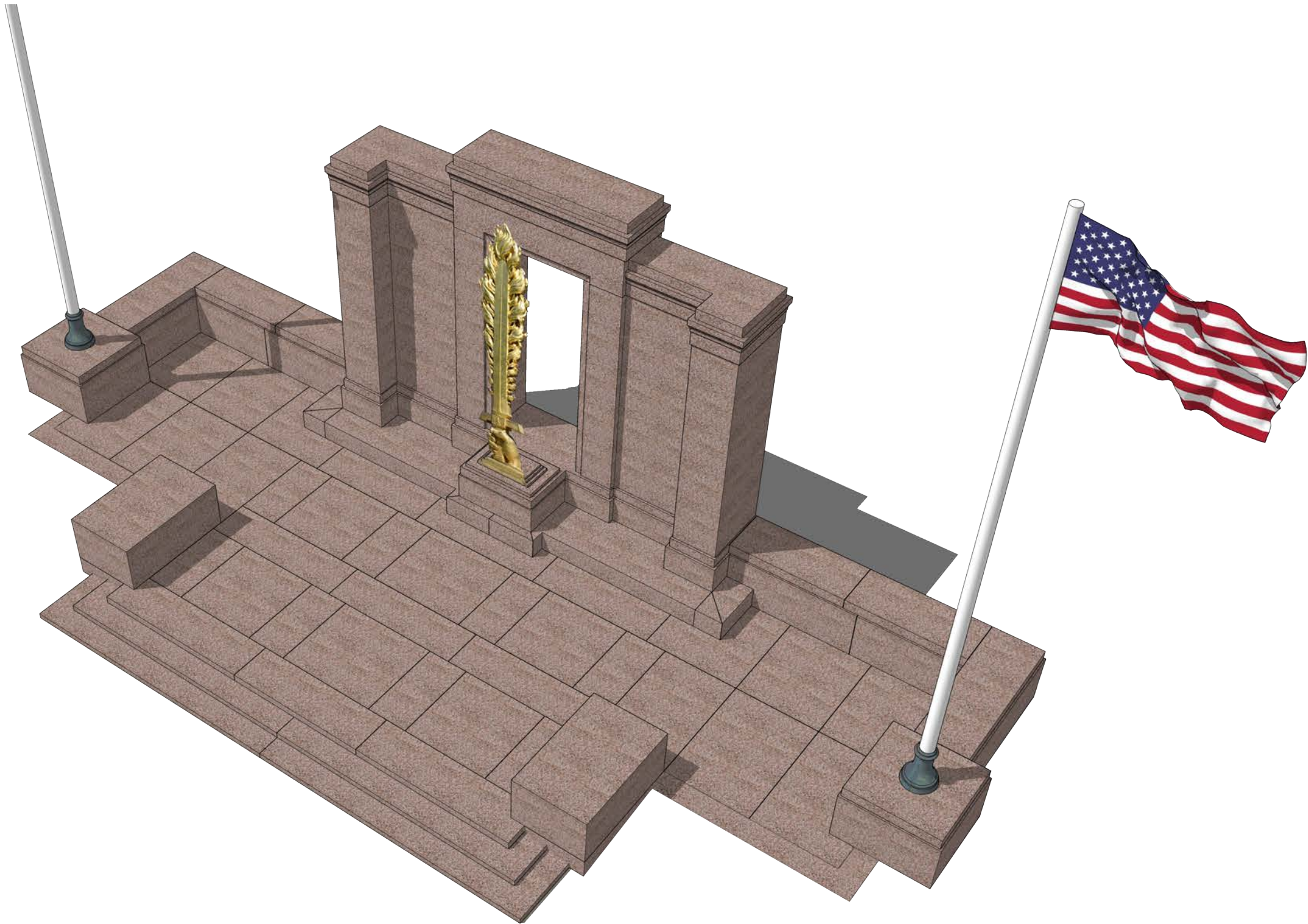

SELECTED SCHEME - ELEVATION AND PLAN

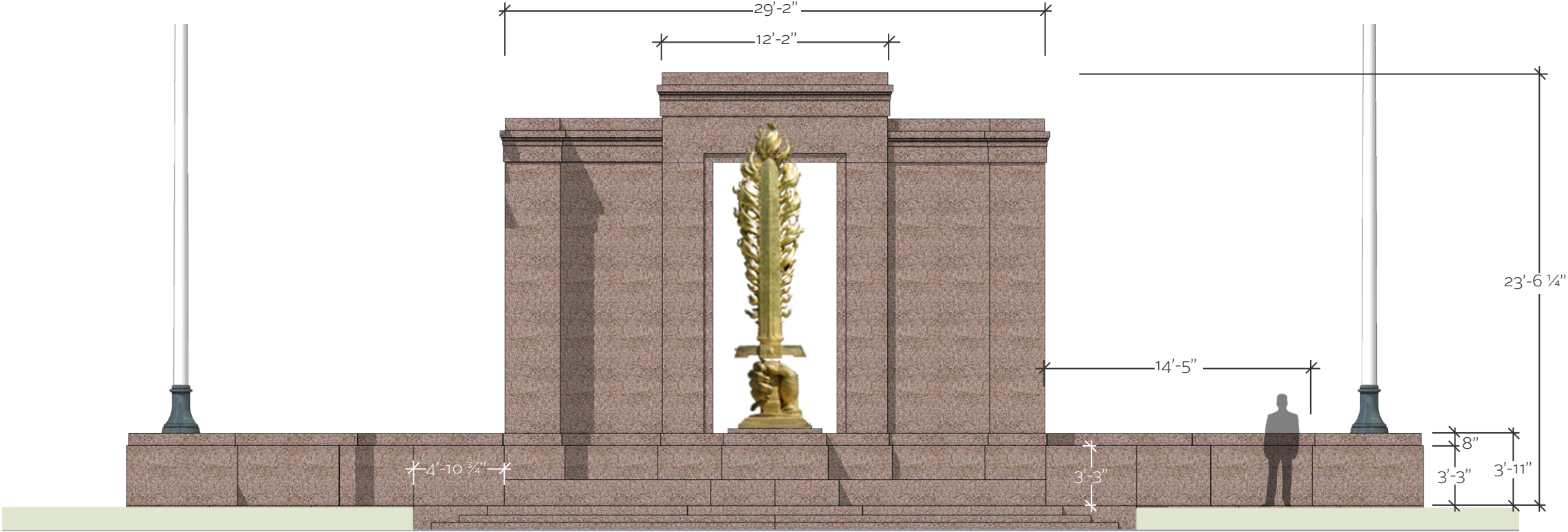

SOUTH ELEVATION - NTS

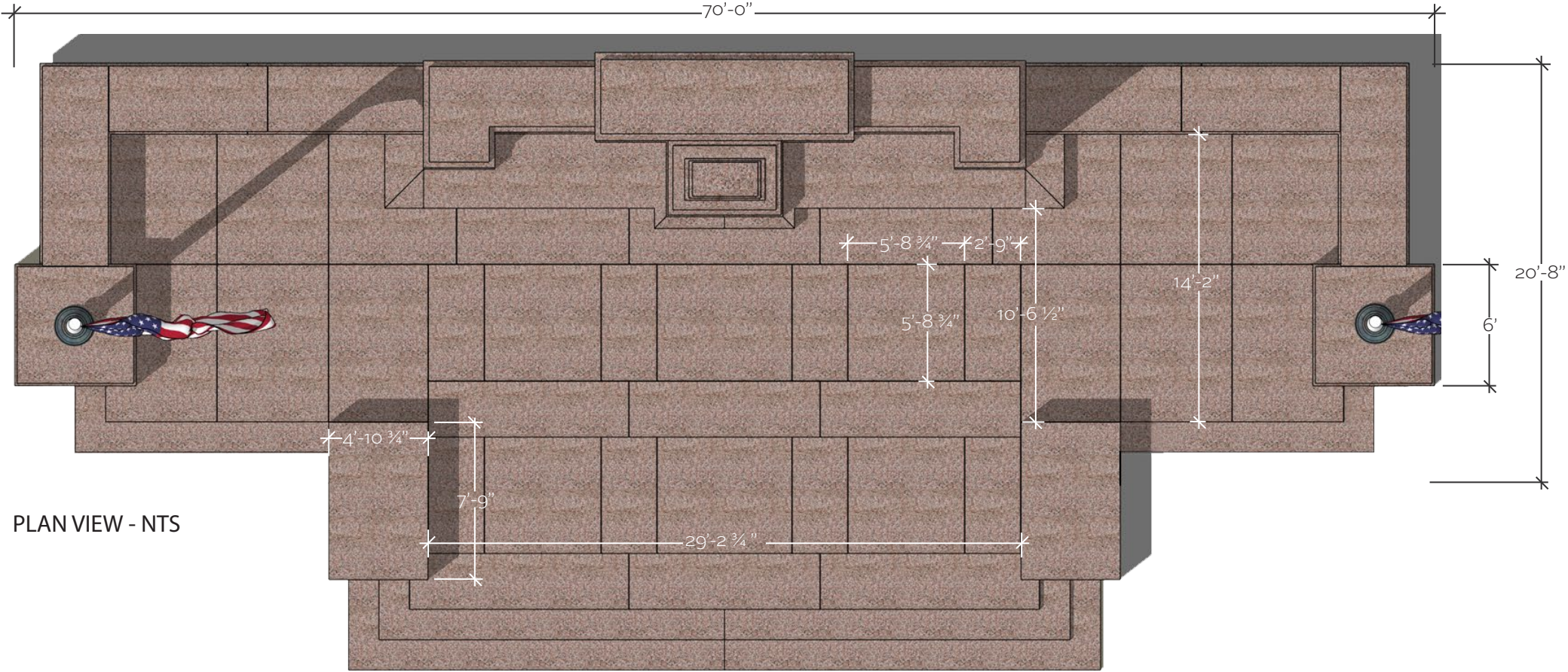

PLAN VIEW - NTS

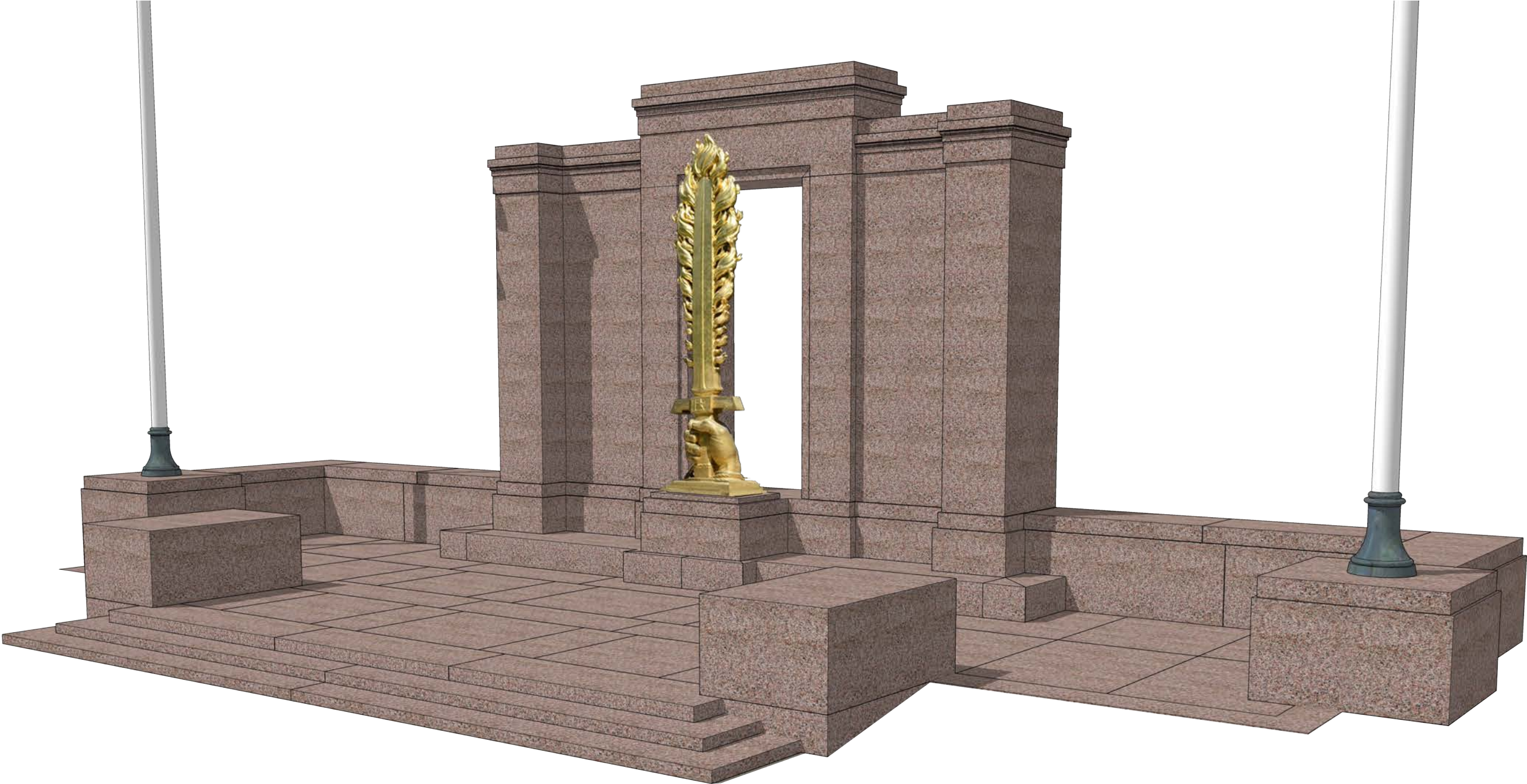

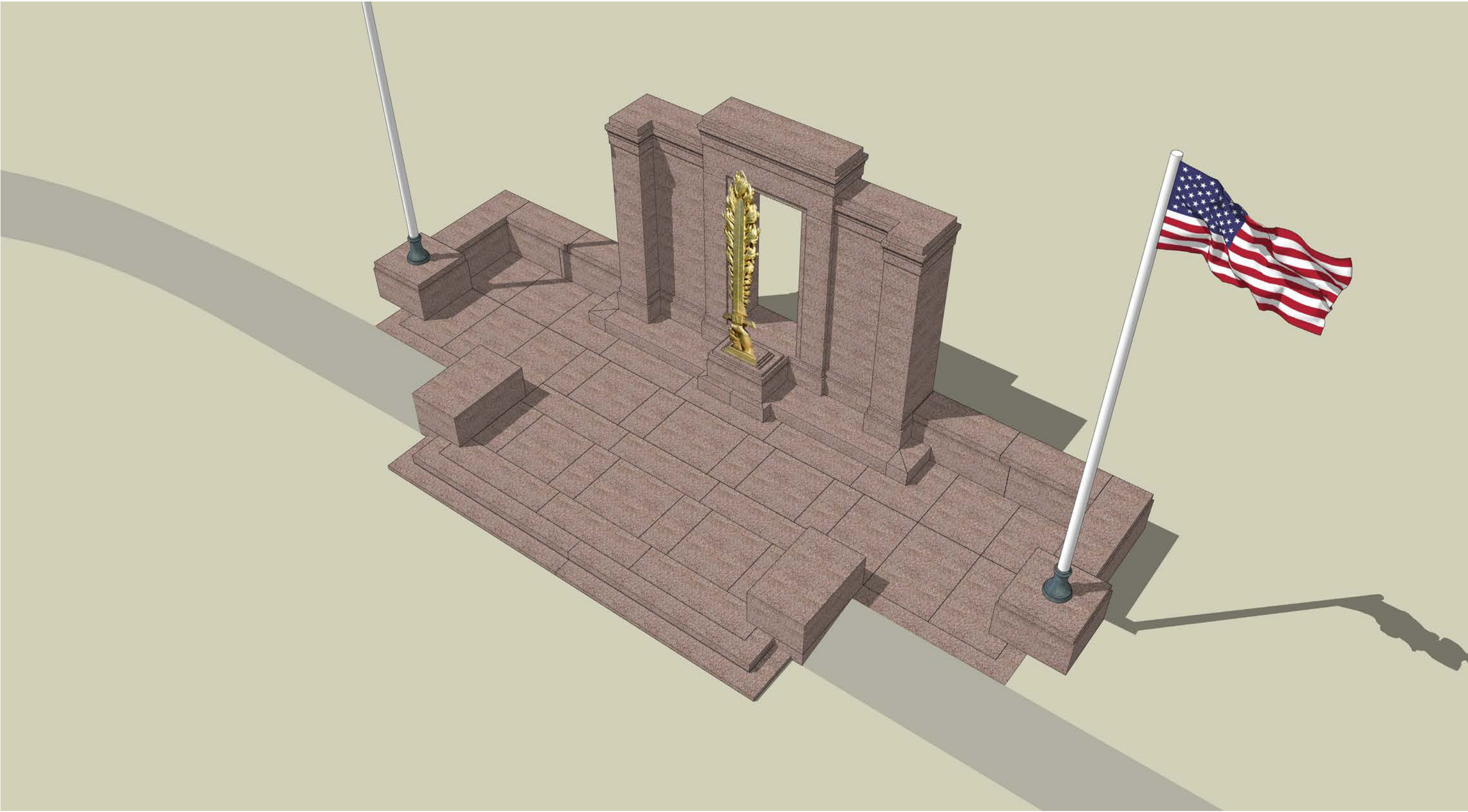

SELECTED SCHEME - EXPANSION CHRONOLOGY

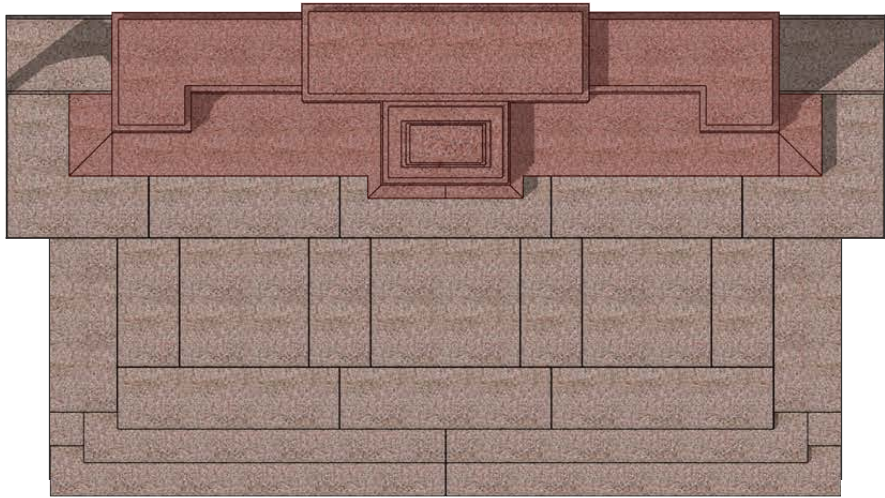

ORIGINAL MEMORIAL

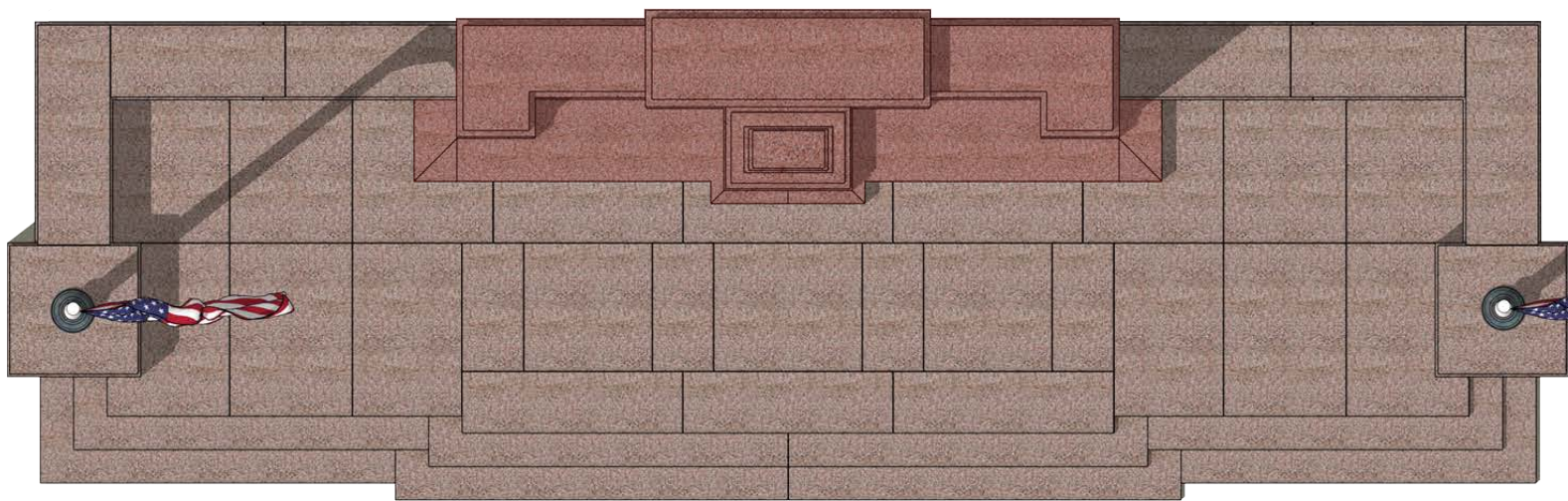

CURRENT MEMORIAL ADDITION

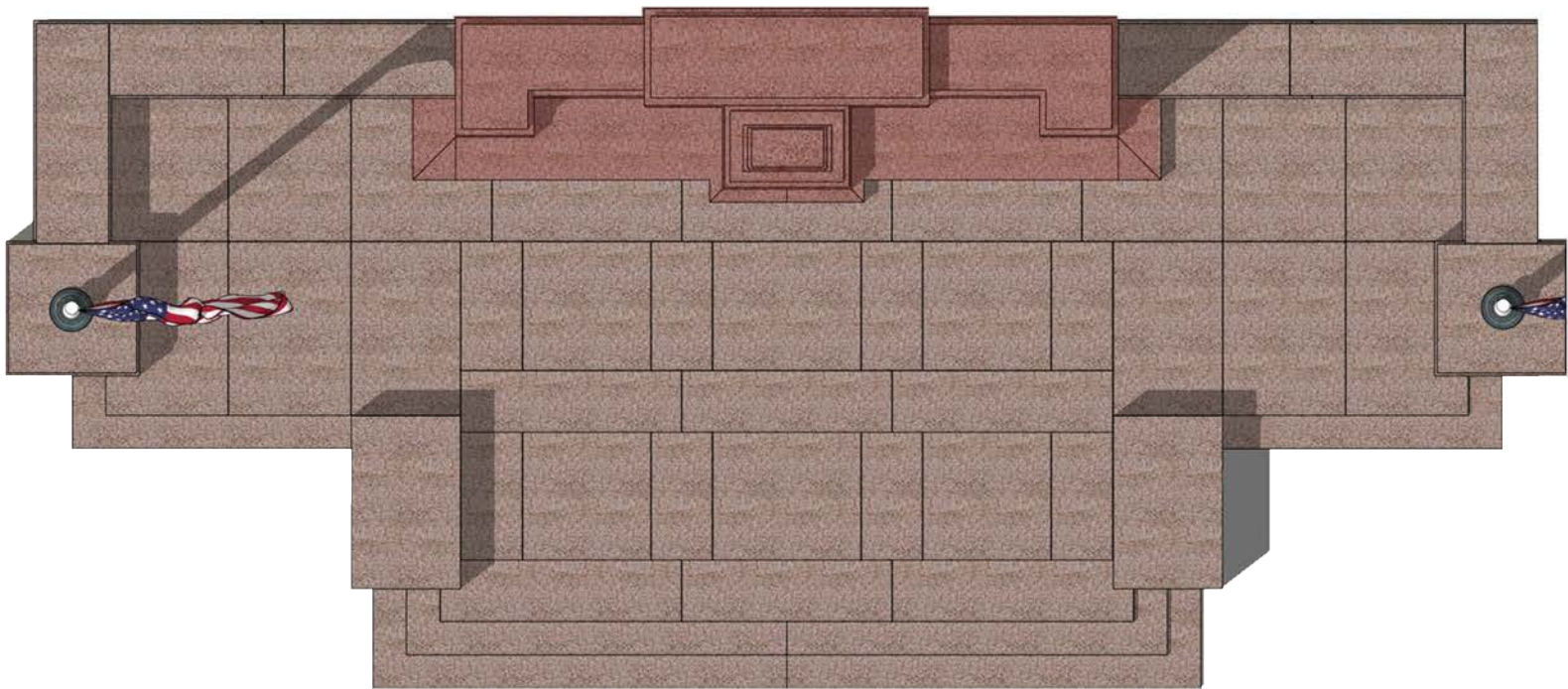

PROPOSED EXPANSION

PREFERRED OPTION D - PLINTH ELEVATIONS CONCEPT

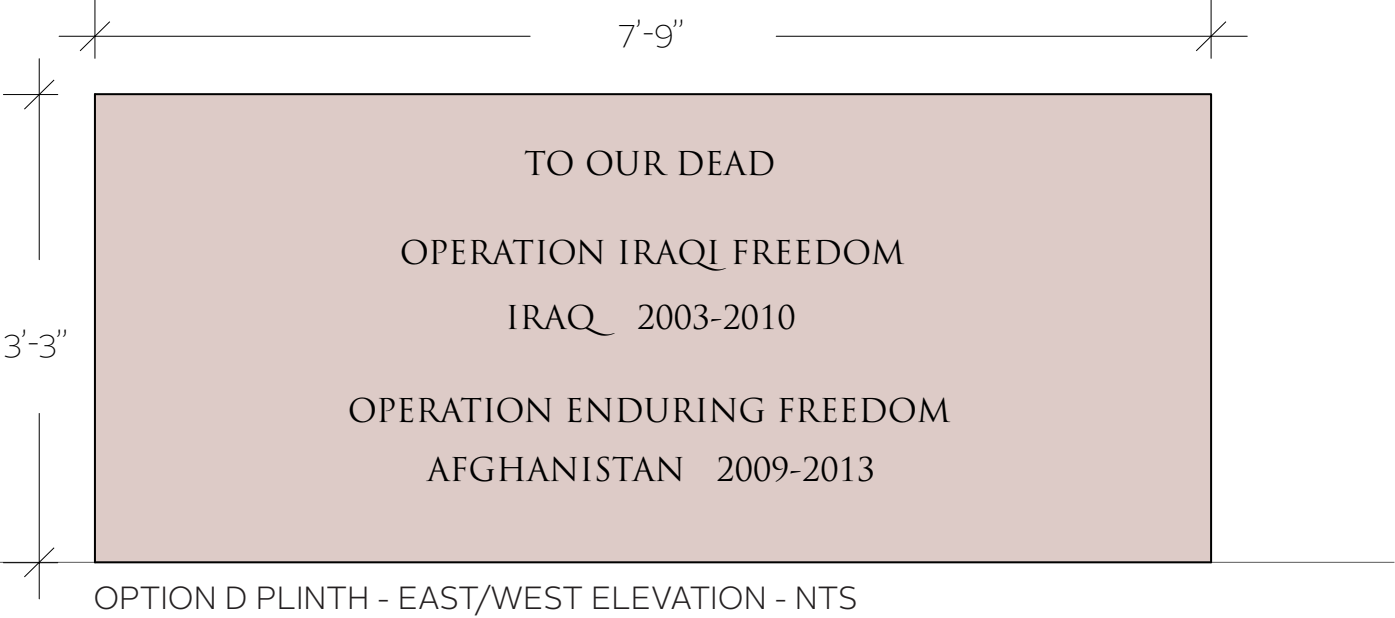
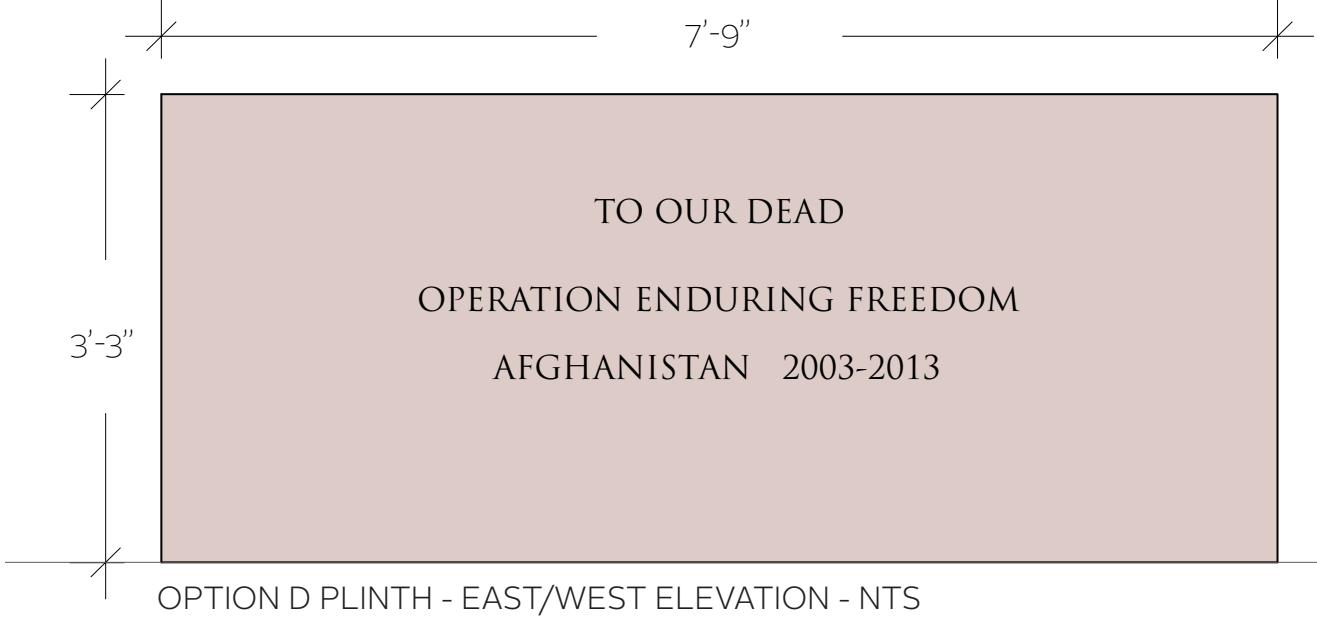
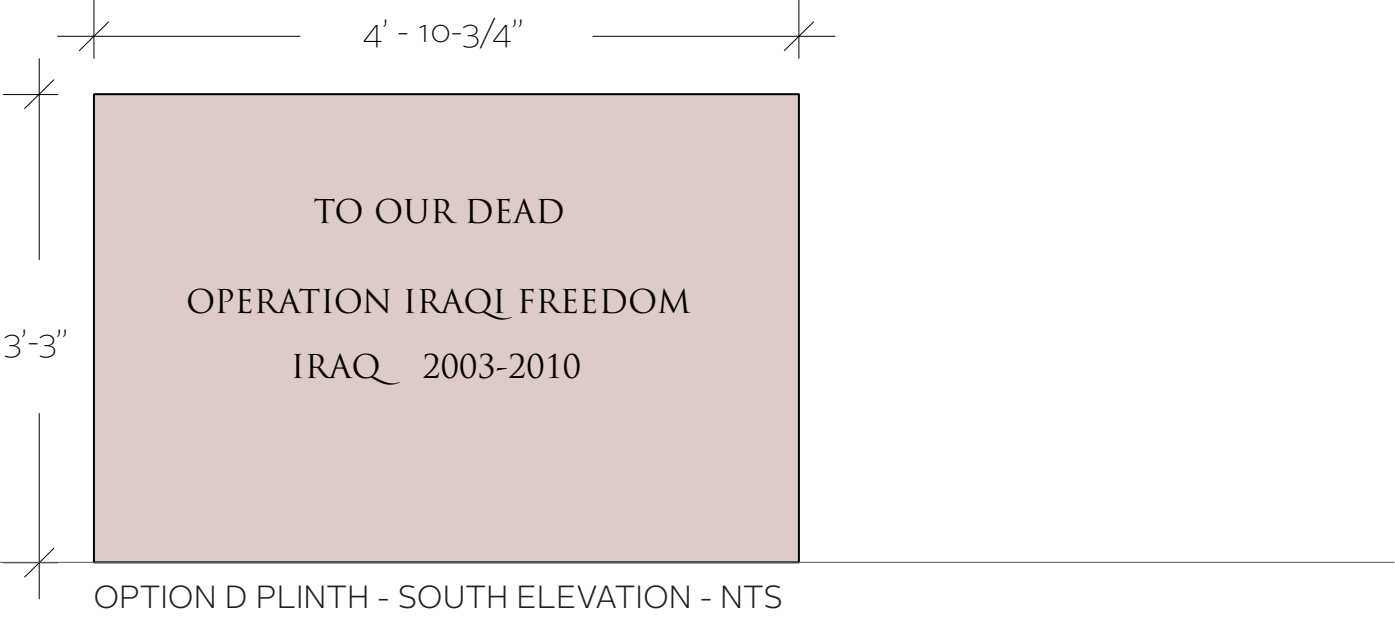
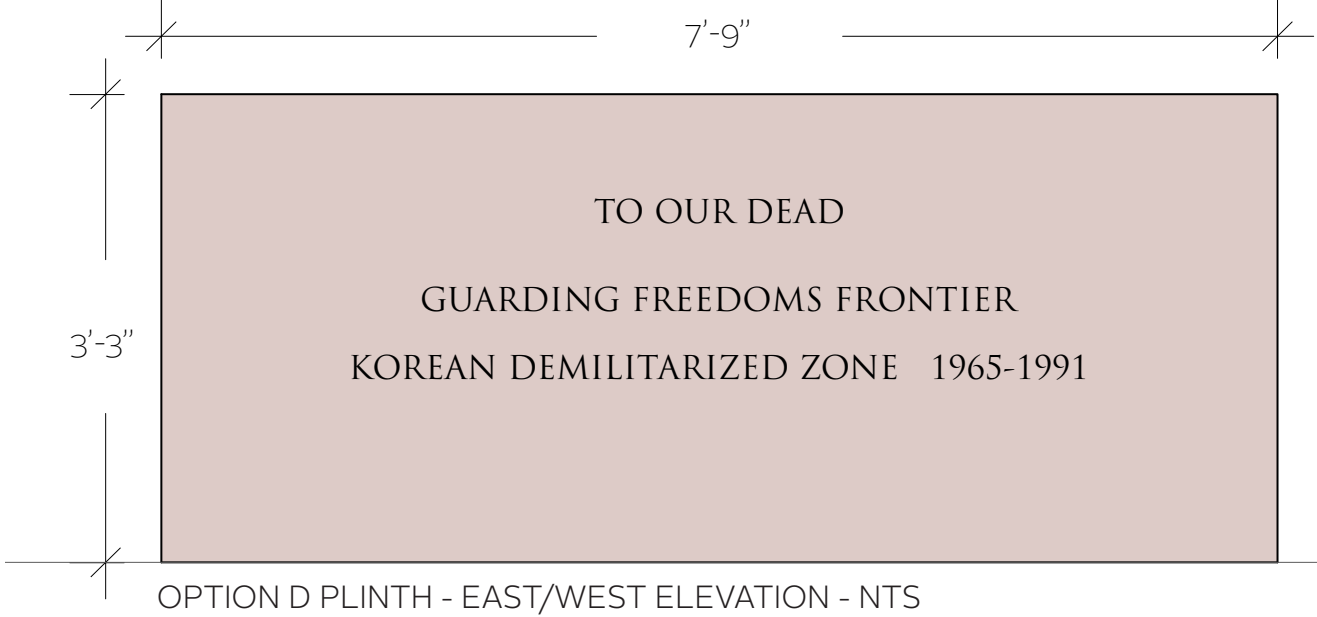

PREFERRED OPTION D - PLINTH ELEVATIONS CONCEPT

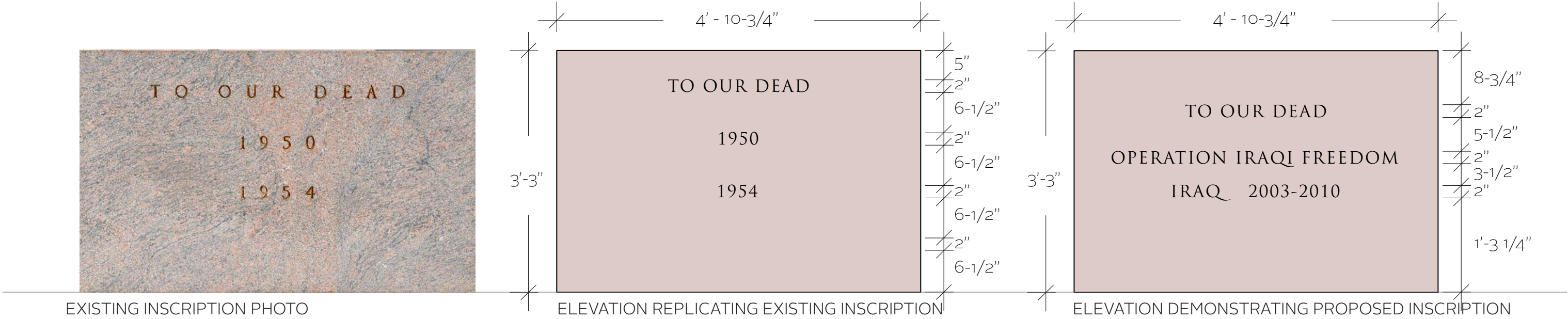

EXISTING INSCRIPTION REFERENCE IMAGES





Photo of current topographic conditions at the memorial. Land is fairly flat and would not require extensive landscape grading to accomplish an access route.

ACCESSIBILITY CONCEPTS

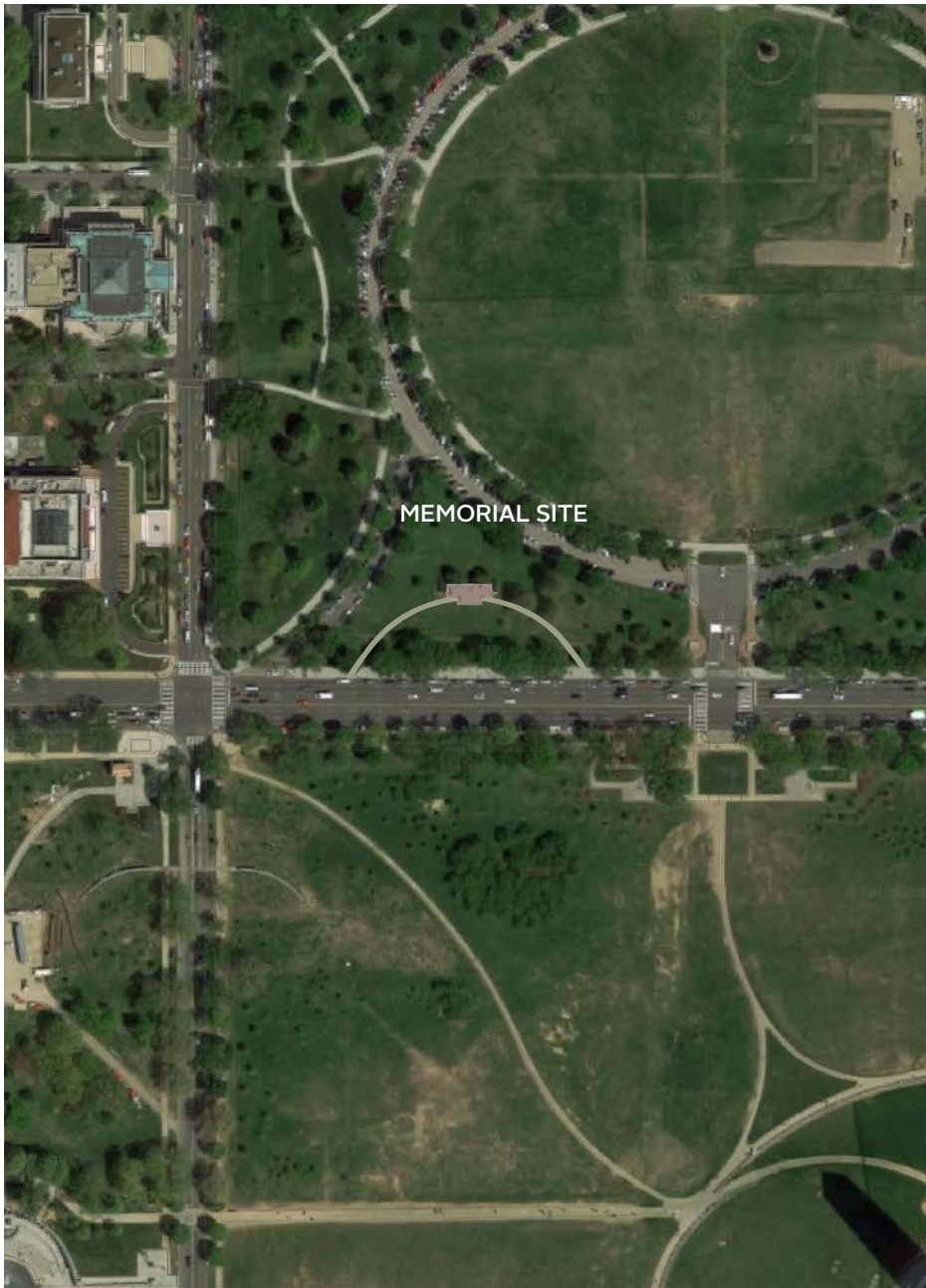

CURVILINEAR ACCESSIBLE PATH SITE PLAN



CURVILINEAR APPROACH

ACCESSIBILITY CONCEPTS



EXISTING SIDEWALK ADJACENT TO MEMORIAL SITE



ADJACENT CURVILINEAR PATH



SECOND INDIANHEAD DIVISION MEMORIAL, WASHINGTON, DC

**BEYER
BLINDER
BELLE**